

## HIGH SPEED RAIL (LONDON – WEST MIDLANDS) ACT 2017

### HIGH SPEED RAIL (LONDON – WEST MIDLANDS) GENERAL VESTING DECLARATION No. 813

This **GENERAL VESTING DECLARATION** is executed on  
by the Secretary of State for Transport (“the Acquiring Authority”). 7th January 2022

#### WHEREAS:

- (1) On 23 February 2017 the High Speed Rail (London – West Midlands) Act 2017 (“the High Speed Rail Act”) received Royal Assent authorising the Acquiring Authority to acquire the land specified in the Schedule hereto.
- (2) Section 4(1) of the High Speed Rail Act authorises the Acquiring Authority to acquire compulsorily so much of the land within the limits of the High Speed Rail Act as may be required for Phase One purposes<sup>1</sup>.
- (3) Section 4(4) of the High Speed Rail Act provides that the Compulsory Purchase (Vesting Declarations) Act 1981 (“the 1981 Act”) applies as if the High Speed Rail Act were a compulsory purchase order and paragraph 3<sup>2</sup> of Schedule 6 to the High Speed Rail Act provides that the 1981 Act shall have effect subject to the modifications specified in that paragraph.
- (4) Notice pursuant to section 3A<sup>3</sup> of the 1981 Act was first published on 10 December 2021. That notice included the particulars specified in section 3A(3) of the 1981 Act.
- (5) By paragraph 4(2) of Schedule 6 to the High Speed Rail Act, Parts 2 and 3 of Schedule 2 to the Acquisition of Land Act 1981 (exception of minerals from compulsory purchase and regulation of working of mines and minerals underlying an authorised undertaking) have effect in relation to land to which Section 4(1) of the High Speed Rail Act applies as if it were comprised in a compulsory purchase order providing for the incorporation with that Order of those Parts of that Schedule.
- (6) Paragraph 2(1) of Part 2 of Schedule 2 to the Acquisition of Land Act 1981 provides that an acquiring authority<sup>4</sup> shall not be entitled to any mines under the land comprised in the compulsory purchase order unless they have been expressly purchased, and all mines under the land are to be deemed to be excepted out of the conveyance of that land unless expressly named and conveyed. Paragraph 3 of Part 3 of Schedule 2 to the Acquisition of Land Act 1981 makes provision where the owner of any mines or minerals in the land desires to work them.

---

1 Phase One Purposes has meaning given by section 67 of the High Speed Rail Act.

2 Paragraph 3 as substituted by section 11 of, and paragraph 6 of Schedule 14 to, the High Speed Rail Act.

3 Section 3A of the 1981 Act as inserted by paragraph 3(a) of Schedule 6 to the High Speed Rail Act as substituted by section 11 of, and paragraphs 6 and 7 of Schedule 14 to, that Act.

4 Paragraph 4(3) of Schedule 6 to the High Speed Rail Act provides for Parts 2 and 3 of the Acquisition of Land Act 1981 to have effect as if references to the acquiring authority were to the Nominated Undertaker appointed under section 45(1) of the High Speed Rail Act.

- (7) It is expedient that such mines and minerals should be vested in the Acquiring Authority and the Acquiring Authority is to expressly purchase the Land and the freehold mines and minerals comprised in the Land, together with the right to take possession of the mines and minerals, to win and work them and all related ancillary rights.

**NOW THIS DEED WITNESSETH** that, in exercise of the powers conferred on it by section 4 of the 1981 Act, the Acquiring Authority hereby declares:-

1. The Land and the freehold mines and minerals comprised in the Land described in the Schedule hereto (being part of the land authorised to be acquired by the High Speed Rail Act) and more particularly delineated and shown coloured pink on the plan annexed hereto, together with the right to enter upon and take possession of the land and mines and minerals, to win and work such mines and minerals and all related ancillary rights comprised therein<sup>5</sup>, shall vest in the Acquiring Authority as from the end of the period of 3 months from the date on which the service of notices required by section 6<sup>6</sup> of the 1981 Act is completed.

For the purposes of Section 2(2) of the 1981 Act, the specified period in relation to the land comprised in this declaration is one year and one day.

---

5 Paragraph 4(2) of Schedule 6 to the High Speed Rail Act applies Parts 2 and 3 of Schedule 2 to the Acquisition of Land Act 1981 (exception of minerals from compulsory purchase and regulation of working of mines or minerals underlying and authorised undertaking) to land to which Section 4(1) of the High Speed Rail Act applies, as if it were comprised in a compulsory purchase order providing for the incorporation with that Order of those Parts of that Schedule.

6 Section 6 as modified by paragraph 3(c) of Schedule 6 to the High Speed Rail Act, as substituted by section 11 of, and paragraph 6 of Schedule 14 to, that Act.

## SCHEDULE

District of Warwick

(1) Plot No.	(2) Description
55281	All interests in 3,926.81 square metres, or thereabouts, of agricultural land (Kenilworth Road, A429) including all those mines and minerals beneath being part of HM land Registry title number WK451674
55282	All interests in 22,615.58 square metres, or thereabouts, of agricultural land, watercourse (Canley Brook), private road and verges (Kenilworth Road, A429) including all those mines and minerals beneath being part of HM land Registry title number WK451674
55283	All interests in 14,449.42 square metres, or thereabouts, of agricultural land (Kenilworth Road, A429) including all those mines and minerals beneath being part of HM land Registry title number WK451674
55878	All interests in 715.75 square metres, or thereabouts, of agricultural land (Kenilworth Road, A429) including all those mines and minerals beneath being part of HM land Registry title number WK275167
55879	All interests in 12,794.92 square metres, or thereabouts, of agricultural land (Kenilworth Road, A429) including all those mines and minerals beneath being part of HM land Registry title number WK451674
55880	All interests in 9,328.25 square metres, or thereabouts, of agricultural land (Kenilworth Road, A429) including all those mines and minerals beneath being part of HM land Registry title number WK451674
55912	All interests in 32.49 square metres, or thereabouts, of camping and caravan site (The Meadow Farm) (Dalehouse Lane) including all those mines and minerals beneath being part of Land Registry title number WK261885

**IN WITNESS WHEREOF** the Secretary of State for Transport has hereunto set its corporate seal on the day in the year first written above.

The **CORPORATE SEAL** of the SECRETARY OF STATE FOR TRANSPORT hereunto affixed to this deed is authenticated by



Authorised Signatory



SEAL REF  
DfT GP / 1070

Dated: 7<sup>th</sup> January 2022

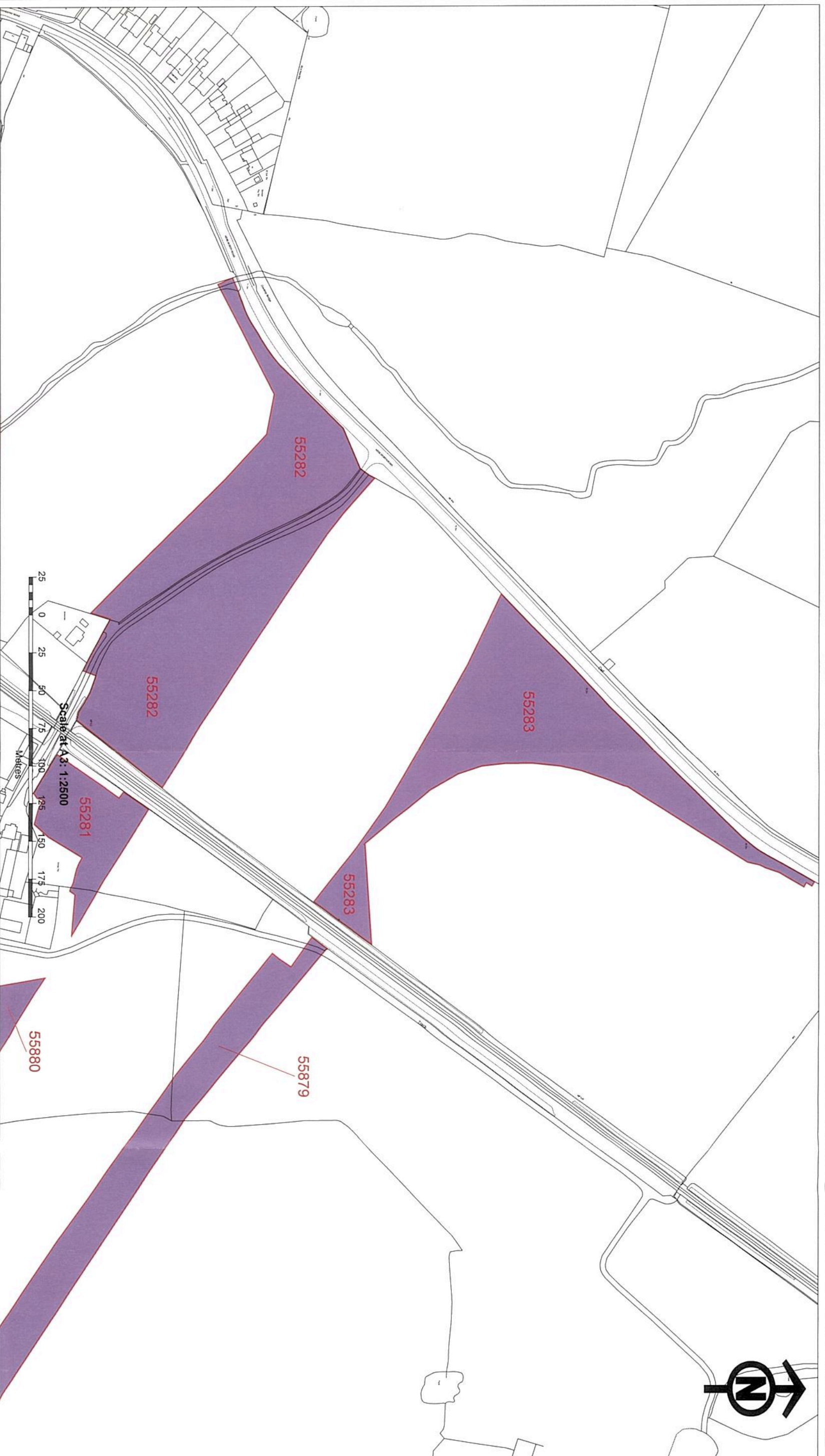

**SEAL REF**  
DFT GP / 1030

The CORPORATE SEAL of the  
SECRETARY OF STATE  
hereunto affixed to this deed  
is authenticated by

Authorised by the Secretary of State for Transport

Dated 7th January 2022

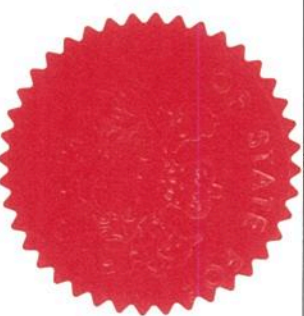

CENTRE POINT: 430,285, 273, 901





The CORPORATE SEAL of the  
SECRETARY OF STATE  
hereunto affixed to this deed  
is authenticated by

Authorised by the Secretary of State for Transport

Dated 7th January 2022



CENTRE POINT: 430 421, 273 625

© Crown copyright and database rights 2021. Ordnance Survey Licence Number: 100048190  
Displayed authority from the Controller of HMSO and © Crown Copyright Ordnance Survey





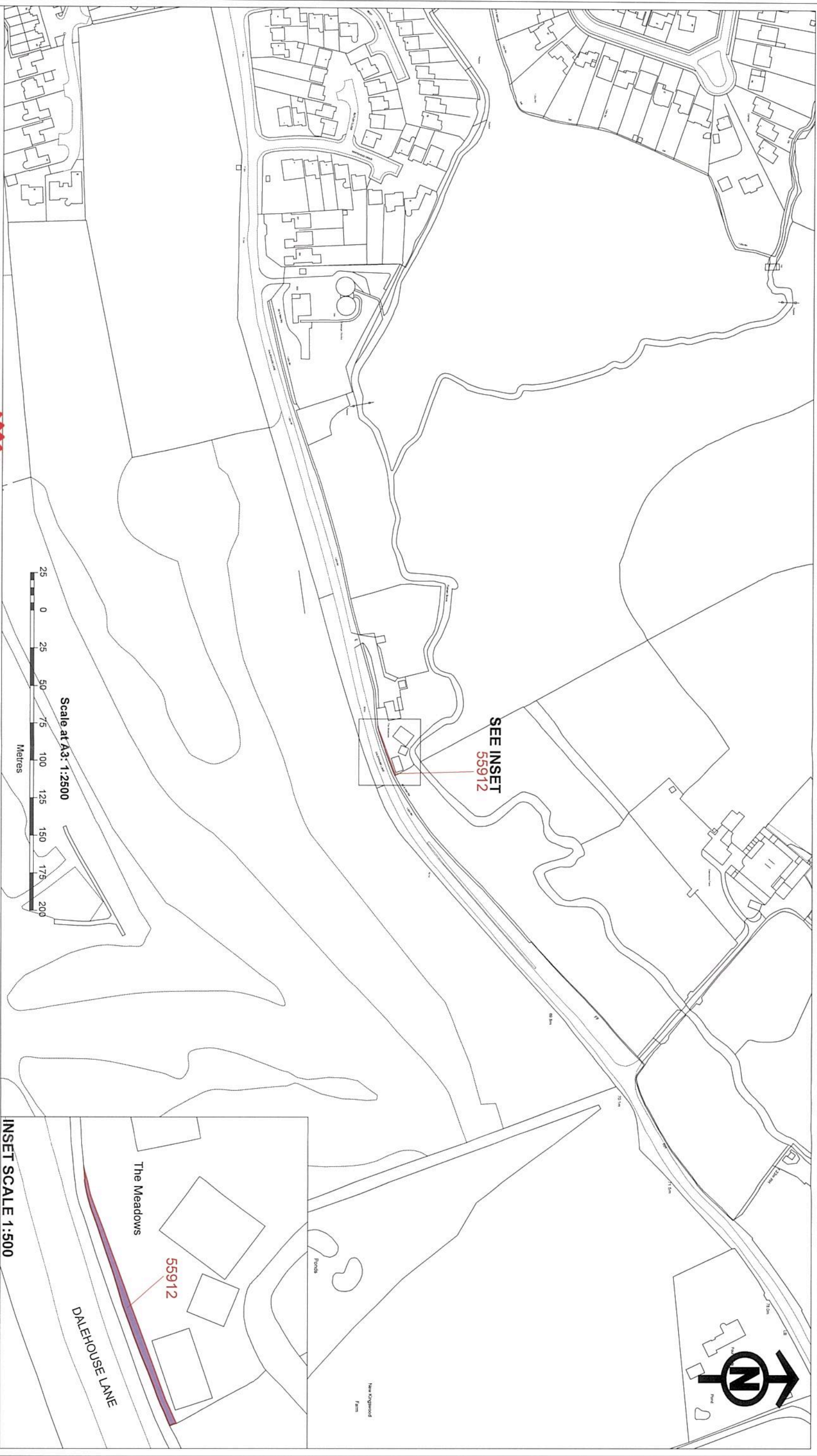

The CORPORATE SEAL of the  
SECRETARY OF STATE  
hereunto affixed to this deed  
is authenticated by

Authorised by the Secretary of State for Transport

Dated 7th January 2012

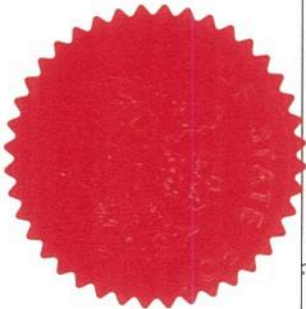

**SEAL REF**  
BFT GP/11070

CENTRE POINT: 430 836, 273 091

