

HIGH SPEED RAIL (LONDON – WEST MIDLANDS) ACT 2017

HIGH SPEED RAIL (LONDON – WEST MIDLANDS) GENERAL VESTING DECLARATION No. 596

This **GENERAL VESTING DECLARATION** is executed on 13th October 2021 by the Secretary of State for Transport (“the Acquiring Authority”).

WHEREAS:

- (1) On 23 February 2017 the High Speed Rail (London – West Midlands) Act 2017 (“the High Speed Rail Act”) received Royal Assent authorising the Acquiring Authority to acquire the land specified in the Schedule hereto.
- (2) Section 4(1) of the High Speed Rail Act authorises the Acquiring Authority to acquire compulsorily so much of the land within the limits of the High Speed Rail Act as may be required for Phase One purposes¹.
- (3) Section 4(4) of the High Speed Rail Act provides that the Compulsory Purchase (Vesting Declarations) Act 1981 (“the 1981 Act”) applies as if the High Speed Rail Act were a compulsory purchase order and paragraph 3² of Schedule 6 to the High Speed Rail Act provides that the 1981 Act shall have effect subject to the modifications specified in that paragraph.
- (4) Notice pursuant to section 3A³ of the 1981 Act was first published on 13 September 2021. That notice included the particulars specified in section 3A(3) of the 1981 Act.
- (5) By paragraph 4(2) of Schedule 6 to the High Speed Rail Act, Parts 2 and 3 of Schedule 2 to the Acquisition of Land Act 1981 (exception of minerals from compulsory purchase and regulation of working of mines and minerals underlying an authorised undertaking) have effect in relation to land to which Section 4(1) of the High Speed Rail Act applies as if it were comprised in a compulsory purchase order providing for the incorporation with that Order of those Parts of that Schedule.
- (6) Paragraph 2(1) of Part 2 of Schedule 2 to the Acquisition of Land Act 1981 provides that an acquiring authority⁴ shall not be entitled to any mines under the land comprised in the compulsory purchase order unless they have been expressly purchased, and all mines under the land are to be deemed to be excepted out of the conveyance of that land unless expressly named and conveyed. Paragraph 3 of Part 3 of Schedule 2 to the Acquisition of Land Act 1981 makes provision where the owner of any mines or minerals in the land desires to work them.

1 Phase One Purposes has meaning given by section 67 of the High Speed Rail Act.

2 Paragraph 3 as substituted by section 11 of, and paragraph 6 of Schedule 14 to, the High Speed Rail Act.

3 Section 3A of the 1981 Act as inserted by paragraph 3(a) of Schedule 6 to the High Speed Rail Act as substituted by section 11 of, and paragraphs 6 and 7 of Schedule 14 to, that Act.

4 Paragraph 4(3) of Schedule 6 to the High Speed Rail Act provides for Parts 2 and 3 of the Acquisition of Land Act 1981 to have effect as if references to the acquiring authority were to the Nominated Undertaker appointed under section 45(1) of the High Speed Rail Act.

- (7) It is expedient that such mines and minerals should be vested in the Acquiring Authority and the Acquiring Authority is to expressly purchase the Land and the freehold mines and minerals comprised in the Land, together with the right to take possession of the mines and minerals, to win and work them and all related ancillary rights.

NOW THIS DEED WITNESSETH that, in exercise of the powers conferred on it by section 4 of the 1981 Act, the Acquiring Authority hereby declares:-

1. The Land and the freehold mines and minerals comprised in the Land described in the Schedule hereto (being part of the land authorised to be acquired by the High Speed Rail Act) and more particularly delineated and shown coloured pink on the plan annexed hereto, together with the right to enter upon and take possession of the land and mines and minerals, to win and work such mines and minerals and all related ancillary rights comprised therein⁵, shall vest in the Acquiring Authority as from the end of the period of 4 months from the date on which the service of notices required by section 6⁶ of the 1981 Act is completed.

For the purposes of Section 2(2) of the 1981 Act, the specified period in relation to the land comprised in this declaration is one year and one day.

5 Paragraph 4(2) of Schedule 6 to the High Speed Rail Act applies Parts 2 and 3 of Schedule 2 to the Acquisition of Land Act 1981 (exception of minerals from compulsory purchase and regulation of working of mines or minerals underlying and authorised undertaking) to land to which Section 4(1) of the High Speed Rail Act applies, as if it were comprised in a compulsory purchase order providing for the incorporation with that Order of those Parts of that Schedule.

6 Section 6 as modified by paragraph 3(c) of Schedule 6 to the High Speed Rail Act, as substituted by section 11 of, and paragraph 6 of Schedule 14 to, that Act.

SCHEDULE

West Northamptonshire

(1) Plot No.	(2) Description
66632	All those interests in 1617.0 square metres, or thereabouts, of agricultural land (Culworth Grounds Farm) including all those mines and minerals beneath being part of HM land Registry title number NN272059
66636	All those interests in 15117.4 square metres, or thereabouts, of agricultural land and woodland (Banbury Lane) including all those mines and minerals beneath being part of HM land Registry title number NN172256
69773	All those interests in 1125.8 square metres, or thereabouts, of agricultural land, woodland, drain and dismantled railway (Banbury Lane) including all those mines and minerals beneath being part of HM land Registry title number NN172256
69774	All those interests in 376.5 square metres, or thereabouts, of dismantled railway and woodland (Culworth Grounds Farm) including all those mines and minerals beneath being part of HM land Registry title number NN272059
69776	All those interests in 19140.5 square metres, or thereabouts, of agricultural land, hedgerow, pond and drain (Culworth Grounds Farm) including all those mines and minerals beneath being part of HM land Registry title number NN272059
69777	All those interests in 9677.7 square metres, or thereabouts, of agricultural land (Culworth Grounds Farm) including all those mines and minerals beneath being part of HM land Registry title number NN272059
69800	All those interests in 7875.6 square metres, or thereabouts, of agricultural land and woodland (Culworth Grounds Farm) including all those mines and minerals beneath being part of HM land Registry title number NN272059
69801	All those interests in 14.7 square metres, or thereabouts, of agricultural land and woodland (Culworth Grounds Farm) including all those mines and minerals beneath being part of HM land Registry title number NN272059
69802	All those interests in 327.6 square metres, or thereabouts, of access track (Culworth Grounds Farm) including all those mines and minerals beneath being part of HM land Registry title number NN272059
69803	All those interests in 293.7 square metres, or thereabouts, of agricultural land and dismantled railway (Culworth Grounds Farm) including all those mines and minerals beneath being part of HM land Registry title number NN272059
69804	All those interests in 966.2 square metres, or thereabouts, of agricultural land and woodland (Culworth Grounds Farm) including all those mines and minerals beneath being part of HM land Registry title number NN272059
69805	All those interests in 70.0 square metres, or thereabouts, of access track (Culworth Grounds Farm) including all those mines and minerals beneath being part of HM land Registry title number NN272059
69806	All those interests in 706.1 square metres, or thereabouts, of gallops (Culworth Grounds Farm) including all those mines and minerals beneath being part of HM land Registry title number NN272059
69807	All those interests in 210.2 square metres, or thereabouts, of agricultural land (Culworth Grounds Farm) including all those mines and minerals beneath being part of HM land Registry title number NN272059
71139	All those interests in 336.9 square metres, or thereabouts, of agricultural

	land and woodland (Culworth Grounds Farm) including all those mines and minerals beneath being part of HM land Registry title number NN272059
71141	All those interests in 5543.5 square metres, or thereabouts, of dismantled railway and woodland (Culworth Grounds Farm) including all those mines and minerals beneath being part of HM land Registry title number NN272059
71142	All those interests in 1415.4 square metres, or thereabouts, of dismantled railway and woodland (Culworth Grounds Farm) including all those mines and minerals beneath being part of HM land Registry title number NN272059
71143	All those interests in 5.6 square metres, or thereabouts, of dismantled railway and woodland (Culworth Grounds Farm) including all those mines and minerals beneath being part of HM land Registry title number NN272059
71144	All those interests in 249.2 square metres, or thereabouts, of access track and dismantled railway (Culworth Grounds Farm) including all those mines and minerals beneath being part of HM land Registry title number NN272059
71145	All those interests in 15.5 square metres, or thereabouts, of access track (Culworth Grounds Farm) including all those mines and minerals beneath being part of HM land Registry title number NN272059

IN WITNESS WHEREOF the Secretary of State for Transport has hereunto set its corporate seal on the day in the year first written above.

The **CORPORATE SEAL** of the SECRETARY OF STATE FOR TRANSPORT hereunto affixed to this deed is authenticated by

.....

Authorised Signatory

SEAL REF
DIT GPI



701

Dated: 13th October 2021

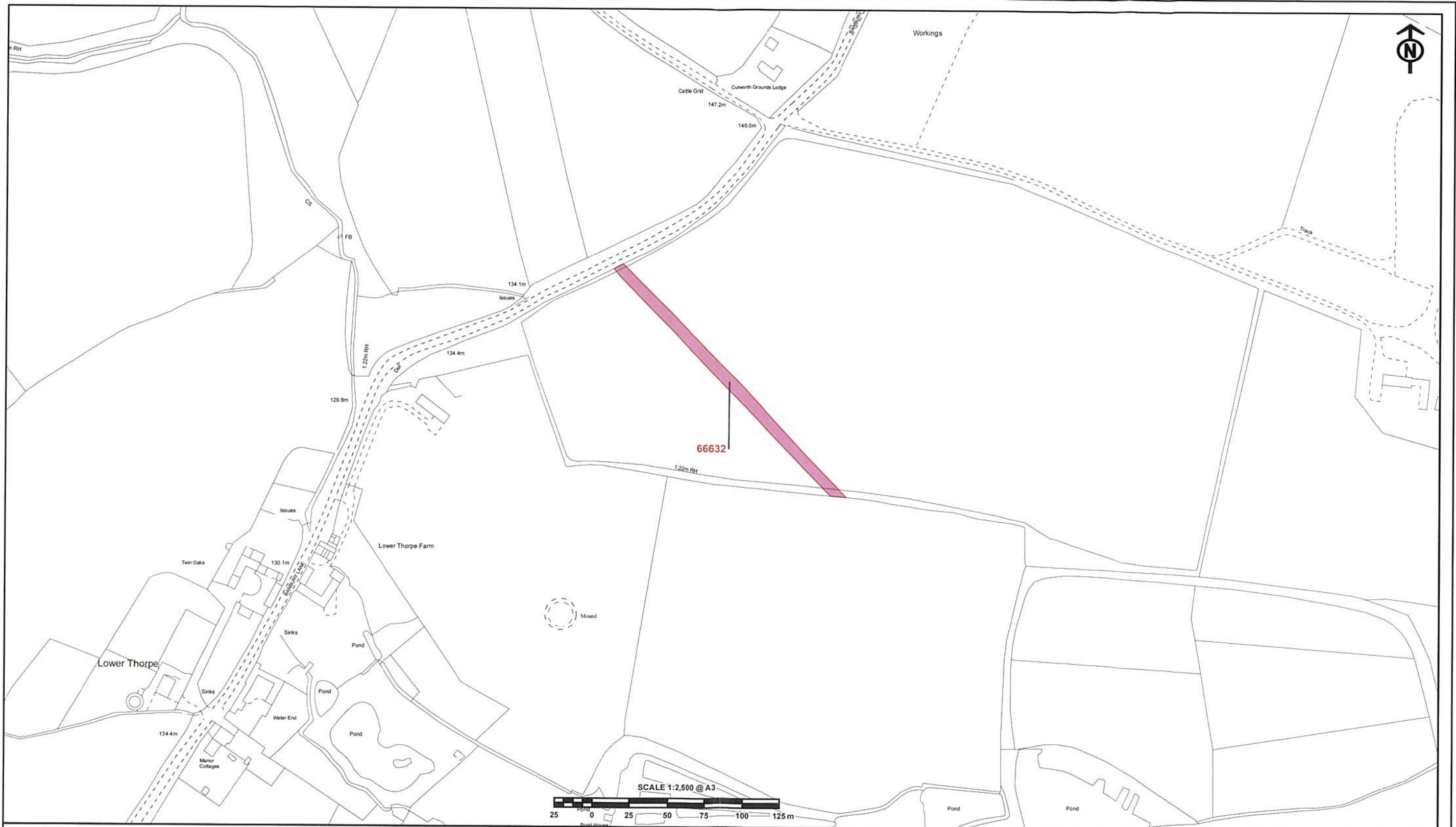

The CORPORATE SEAL of the
SECRETARY OF STATE
hereunto affixed to this deed
is authenticated by

Authorised by the Secretary of State for Transport

Dated 13th October 2021

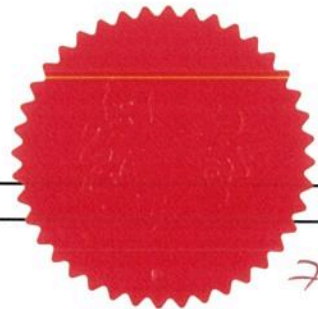

SEAL REF
DIT GP1

701

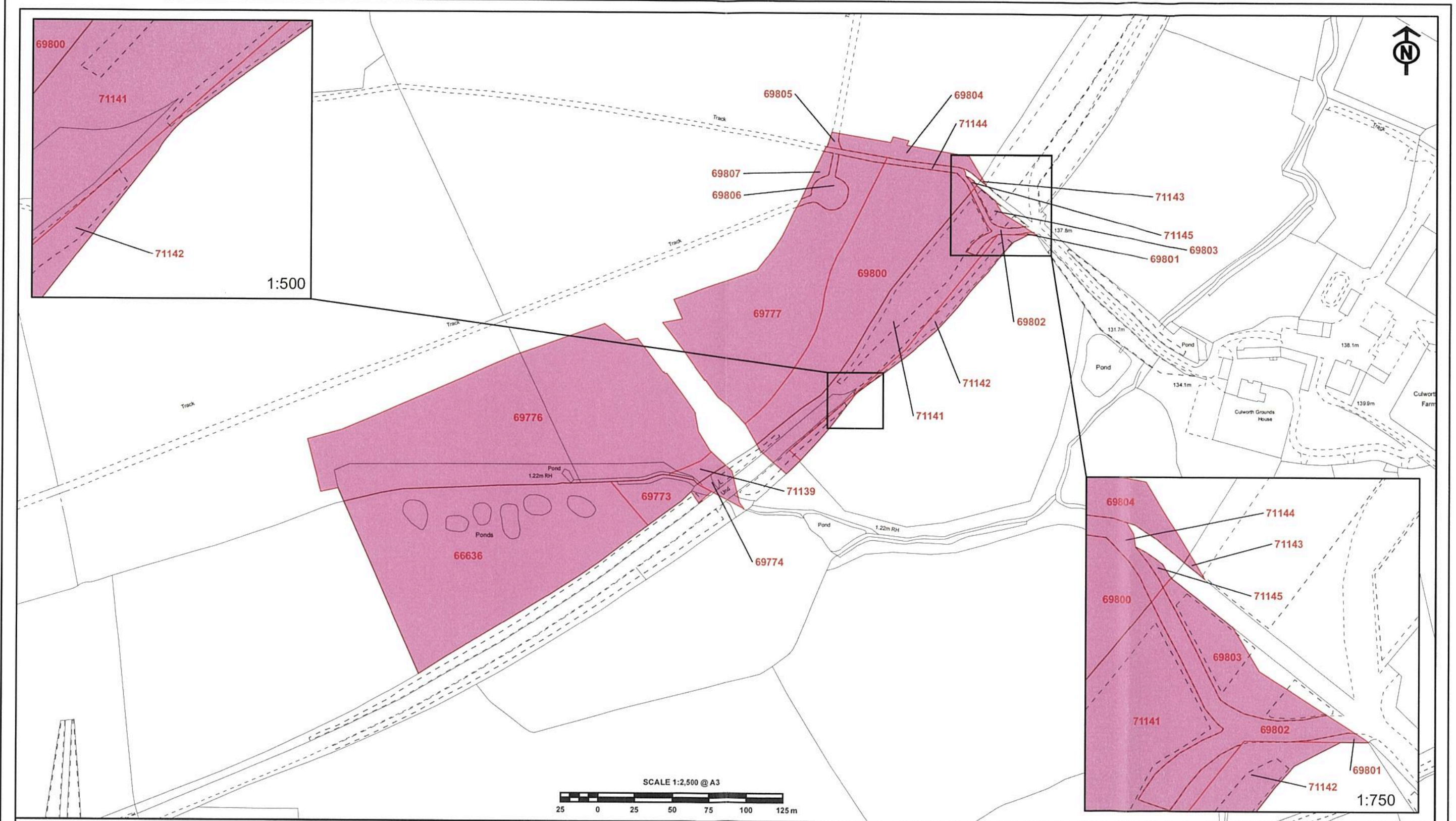

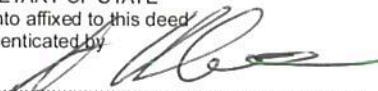
The CORPORATE SEAL of the
SECRETARY OF STATE
hereunto affixed to this deed
is authenticated by

Authorised by the Secretary of State for Transport
Dated 13th October 2021



SEAL REF
DfT GP/1

201

