



Notice of variation and consolidation with introductory note

The Environmental Permitting (England & Wales) Regulations 2016

Moy Park Limited
Hall Farm Poultry Unit
Hall Farm
Langar Lane
Langar
Nottinghamshire
NG13 9HB

Variation application number

EPR/XP3606MV/V002

Permit number

EPR/XP3606MV

Hall Farm Poultry Unit

Permit number EPR/XP3606MV

Introductory note

This introductory note does not form a part of the notice.

Under the Environmental Permitting (England & Wales) Regulations 2016 (schedule 5, part 1, paragraph 19) a variation may comprise a consolidated permit reflecting the variations and a notice specifying the variations included in that consolidated permit.

Schedule 1 of the notice specifies the conditions that have been varied and schedule 2 comprises a consolidated permit which reflects the variations being made. All the conditions of the permit have been varied and are subject to the right of appeal.

This variation authorises the following changes:

- An increase in bird numbers from 172,000 to 410,000 broiler places.
- Installation of four additional poultry houses, numbered 5 to 8.
- Extension of the installation boundary to accommodate the additional poultry houses.
- Relocation of two existing biomass boilers.
- Addition of a carcass incinerator to Table S1.1, previously agreed as a minor operational change.

We have reviewed all housing at this installation against the best available techniques (BAT) conclusions as defined in the 'Intensive Rearing of Poultry or Pigs (IRPP) BAT Conclusions' document, dated 21/02/17. The permit conditions and schedules ensure the compliance of the housing with this BAT Conclusions document.

The varied installation is operated as follows:

Hall Farm Poultry Unit is situated approximately 1.5 kilometres south of the village of Langar, Nottinghamshire. The installation is approximately centred on National Grid Reference SK 72131 32978.

The installation is operated by Moy Park Limited and comprises eight poultry houses, numbered one to eight, which provide a combined capacity for 410,000 broiler places. Birds are housed at one day old and depopulated at approximately forty-two days of age, which is done on an all-in, all-out basis. The break between crops for clean out and turn-around is approximately seven days, resulting in seven cycles per annum.

Before bird arrival, poultry houses are pre-warmed using hot water heaters fed by four biomass boilers, with an aggregated thermal rated input of 0.776 MWth, with back up Liquid Petroleum Gas (LPG) heaters. The biomass boilers burn clean virgin woodchip and meet the technical criteria to be eligible for the Renewable Heat Incentive. Floors are covered to a minimum depth of 2 cm of bulk wood shavings.

House 1 is ventilated via a full tunnel ventilation system, where air is drawn into the building via inlets mounted in the side walls and exhausted at large volume, slow speed from the rear gable.

Houses 2 to 4 are ventilated via an air mixing combi-tunnel ventilation system, which comprises roof mounted fans blowing air into the building through a positive pressure system, which is then released via two variable speed fans mounted in the rear gable. Above minimum ventilation the system changes over to a traditional tunnel system where air is drawn into the building via inlets mounted in the side walls and exhausted at slow speed from the rear gable.

Houses 5 to 8 are ventilated by roof fans with side wall inlets, with an emission point higher than 5.5 metres above ground level and an efflux speed of 11 metres per second. Houses also have gable end fans which are operated infrequently to maintain temperature, typically in the summer months.

At the end of the growing cycle, houses are depopulated and internal equipment is dry cleaned with compressed air before the removal of litter. Spent litter is removed in covered trailers and spread on third party land. The houses are then washed and disinfected. Drainage from the houses and water from cleaning

out is channelled to underground collection tanks. Roof water from the houses discharges to a ditch to the north-east of the installation boundary, via a rainwater harvesting pond. Water draining from the yard (excluding periods of washout when water from the yard drains to the underground tanks) is directed to the same ditch.

The land around the site is predominantly agricultural, and the surrounding topography is relatively flat and low lying. Associated food is stored on the installation in sealed food bins. Water is via a nipple drinking system, fitted with cups to reduce leakage and spills. Mortalities are collected daily and stored in sealed vermin proof containers, awaiting removal by a licensed collection agent, under the National Fallen Stock Scheme. A licensed carcass incinerator is also installed on site for disposal of fallen stock, if required, although this is used on a limited and/or emergency basis.

There are three Sites of Special Scientific Interest (SSSI) within 5km of the installation, and seven other nature conservation sites within 2km, comprising of Local Wildlife Sites (LWS). An assessment of the impact of emissions has been carried out and the installation is considered to have no adverse effect on the nature conservation sites.

This permit implements the requirements of the European Union Directive on Industrial Emissions.

The schedules specify the changes made to the permit.

The status log of a permit sets out the permitting history, including any changes to the permit reference number.

Status log of the permit		
Description	Date	Comments
Application EPR/RP3031ME/A001	Duly made 22/01/07	
Additional information received		Received 26/07/07
Permit determined	18/07/07	
Application EPR/RP3031ME/V002	Duly made 10/11/10	
Additional information request	23/02/11	23/02/11
Variation issued	25/02/11	
Application EPR/RP3031ME/V003 (variation and consolidation)	Duly made 21/08/14	Application to vary the permit to add 4 biomass boilers, increase bird numbers, remove a named partner, and update the permit to modern conditions to include the requirements of IED.
Additional information received	28/09/14	Response to request for Information confirming whether manure / slurry is spread to Operator owned land.
Variation determined EPR/RP3031ME	30/10/14	Varied and consolidated permit issued in modern condition format.
Variation determined EPR/RP3031ME/V004	16/09/2020	Environment Agency initiated variation for Intensive Farming BAT compliance permit review
Application EPR/XP3606MV/T001 (full transfer of permit EPR/RP3031ME)	Duly made 07/12/21	Application to transfer the permit in full to Moy Park Limited.
Transfer determined EPR/XP3606MV	08/12/21	Full transfer of permit complete.
Application EPR/XP3606MV/V002 (variation and consolidation)	Duly made 16/12/21	Application to increase bird numbers from 172,000 to 410,000 broiler places, install four additional poultry houses, extend the permit boundary and relocate two existing biomass boilers.
Additional information received	17/12/21	Revised dust management plan.

Status log of the permit		
Description	Date	Comments
Additional information received	07/01/2022	Confirmation with regards to the operation of the carcass incinerator, revised site drainage plan, accident risk assessment and technical standards document.
Additional information received	11/01/22	Confirmation regarding the storage of fuel for use in the carcass incinerator and revised site drainage plan.
Variation determined EPR/XP3606MV (Billing reference: AP3206MT)	24/02/22	Varied and consolidated permit issued in modern condition format.

End of introductory note

Notice of variation and consolidation

The Environmental Permitting (England and Wales) Regulations 2016

The Environment Agency in exercise of its powers under regulation 20 of the Environmental Permitting (England and Wales) Regulations 2016 varies and consolidates

Permit number

EPR/XP3606MV

Issued to

Moy Park Limited (“the operator”)

whose registered office is

The Food Park

39 Seagoe Industrial Park

Craigavon

BT63 5QE

company registration number NI004842

to operate an installation at

Hall Farm Poultry Unit

Hall Farm

Langar Lane

Langar

Nottinghamshire

NG13 9HB

to the extent set out in the schedules.

The notice shall take effect from 24/02/2022

Name	Date
Tom Tartelin	24/02/2022

Authorised on behalf of the Environment Agency

Schedule 1

All conditions have been varied by the consolidated permit EPR/XP3606MV as a result of the application made by the operator.

Schedule 2 – consolidated permit

Consolidated permit issued as a separate document.

Permit

The Environmental Permitting (England and Wales) Regulations 2016

Permit number

EPR/XP3606MV

This is the consolidated permit referred to in the variation and consolidation notice for application EPR/XP3606MV/V002 authorising,

Moy Park Limited (“the operator”),

whose registered office is

The Food Park

39 Seagoe Industrial Park

Craigavon

BT63 5QE

company registration number NI004842

to operate an installation at

Hall Farm Poultry Unit

Hall Farm

Langar Lane

Langar

Nottinghamshire

NG13 9HB

to the extent authorised by and subject to the conditions of this permit.

Name	Date
Tom Tartelin	24/02/2022

Authorised on behalf of the Environment Agency

Conditions

1 Management

1.1 General management

- 1.1.1 The operator shall manage and operate the activities:
- (a) in accordance with a written management system that identifies and minimises risks of pollution, so far as is reasonably practicable, including those risks arising from operations, maintenance, accidents, incidents, non-conformances, closure and those drawn to the attention of the operator as a result of complaints; and
 - (b) using sufficient competent persons and resources.
- 1.1.2 Records demonstrating compliance with condition 1.1.1 shall be maintained.
- 1.1.3 Any person having duties that are or may be affected by the matters set out in this permit shall have convenient access to a copy of the permit.

1.2 Energy efficiency

- 1.2.1 The operator shall:
- (a) take appropriate measures to ensure that energy is used efficiently in the activities; and
 - (b) maintain records of fuel and energy consumption used in the activities.

1.3 Efficient use of raw materials

- 1.3.1 The operator shall:
- (a) take appropriate measures to ensure that raw materials and water are used efficiently in the activities; and
 - (b) maintain records of raw materials and water used in the activities.

1.4 Avoidance, recovery and disposal of wastes produced by the activities

- 1.4.1 The operator shall take appropriate measures to ensure that the waste hierarchy referred to in Article 4 of the Waste Framework Directive is applied to the generation of waste by the activities and that;
- (a) any waste generated by the activities is treated in accordance with the waste hierarchy referred to in Article 4 of the Waste Framework Directive; and
 - (b) where disposal is necessary, this is undertaken in a manner which minimises its impact on the environment.

2 Operations

2.1 Permitted activities

- 2.1.1 The only activity authorised by the permit is the activity specified in schedule 1 table S1.1 (the “activities”).

2.2 The site

- 2.2.1 The activities shall not extend beyond the site, being the land shown edged in green on the site plan at schedule 7 to this permit.

2.3 Operating techniques

- 2.3.1 The activities shall, subject to the conditions of this permit, be operated using the techniques and in the manner described in the documentation specified in schedule 1, table S1.2, unless otherwise agreed in writing by the Environment Agency.
- 2.3.2 If notified by the Environment Agency that the activities are giving rise to pollution, the operator shall submit to the Environment Agency for approval within the period specified, a revision of any plan or other documentation ("plan") specified in schedule 1, table S1.2 or otherwise required under this permit which identifies and minimises the risks of pollution relevant to that plan, and shall implement the approved revised plan in place of the original from the date of approval, unless otherwise agreed in writing by the Environment Agency.
- 2.3.3 The operator shall maintain and implement a system to record the number of animal places and animal movements.
- 2.3.4 The operator shall ensure that a diet formulation and nutritional strategy is used to reduce the total nitrogen and total phosphorus excreted.
- 2.3.5 The operator shall take appropriate measures in disposal or recovery of solid manure or slurry to prevent, or where this is not practicable, to minimise pollution.
- 2.3.6 Any raw materials or fuels listed in schedule 2 table S2.1 shall conform to the specifications set out in that table.
- 2.3.7 The operator shall ensure that where waste produced by the activities is sent to a relevant waste operation, that operation is provided with the following information, prior to the receipt of the waste:
- (a) the nature of the process producing the waste;
 - (b) the composition of the waste;
 - (c) the handling requirements of the waste;
 - (d) the hazardous property associated with the waste, if applicable; and
 - (e) the waste code of the waste.

2.4 Improvement programme

- 2.4.1 The operator shall complete the improvements specified in schedule 1 table S1.3 by the date specified in that table unless otherwise agreed in writing by the Environment Agency.
- 2.4.2 Except in the case of an improvement which consists only of a submission to the Environment Agency, the operator shall notify the Environment Agency within 14 days of completion of each improvement.

3 Emissions and monitoring

3.1 Emissions to water, air or land

- 3.1.1 There shall be no point source emissions to water, air or land except from the sources and emission points specified in tables S3.1 and S3.2.
- 3.1.2 The limits given in schedule 3 shall not be exceeded.
- 3.1.3 Periodic monitoring shall be carried out at least once every 5 years for groundwater and 10 years for soil, unless such monitoring is based on a systematic appraisal of the risk of contamination.

3.2 Emissions of substances not controlled by emission limits

- 3.2.1 Emissions of substances not controlled by emission limits shall not cause pollution. The operator shall not be taken to have breached this condition if appropriate measures, including, but not limited to, those specified in any approved emissions management plan, have been taken to prevent or where that is not practicable, to minimise, those emissions.
- 3.2.2 The operator shall:
- (a) if notified by the Environment Agency that the activities are giving rise to pollution, submit to the Environment Agency for approval within the period specified, an emissions management plan which identifies and minimises the risks of pollution from emissions of substances not controlled by emission limits; and
 - (b) implement the approved emissions management plan, from the date of approval, unless otherwise agreed in writing by the Environment Agency.
- 3.2.3 All liquids in containers, whose emission to water or land could cause pollution, shall be provided with secondary containment, unless the operator has used other appropriate measures to prevent or where that is not practicable, to minimise, leakage and spillage from the primary container.

3.3 Odour

- 3.3.1 Emissions from the activities shall be free from odour at levels likely to cause pollution outside the site, as perceived by an authorised officer of the Environment Agency, unless the operator has used appropriate measures, including, but not limited to, those specified in any approved odour management plan, to prevent or where that is not practicable to minimise the odour.
- 3.3.2 The operator shall:
- (a) if notified by the Environment Agency that the activities are giving rise to pollution outside the site due to odour, submit to the Environment Agency for approval within the period specified, an odour management plan which identifies and minimises the risks of pollution from odour; and
 - (b) implement the approved odour management plan, from the date of approval, unless otherwise agreed in writing by the Environment Agency.

3.4 Noise and vibration

- 3.4.1 Emissions from the activities shall be free from noise and vibration at levels likely to cause pollution outside the site, as perceived by an authorised officer of the Environment Agency, unless the operator has used appropriate measures, including, but not limited to, those specified in any approved noise and vibration management plan to prevent or where that is not practicable to minimise the noise and vibration.
- 3.4.2 The operator shall:
- (a) if notified by the Environment Agency that the activities are giving rise to pollution outside the site due to noise and vibration, submit to the Environment Agency for approval within the period specified, a noise and vibration management plan which identifies and minimises the risks of pollution from noise and vibration; and
 - (b) implement the approved noise and vibration management plan, from the date of approval, unless otherwise agreed in writing by the Environment Agency.

3.5 Monitoring

- 3.5.1 The operator shall, unless otherwise agreed in writing by the Environment Agency, undertake the monitoring specified in the following tables in schedule 3 to this permit:
- (a) point source emissions specified in tables S3.1 and S3.2; and
 - (b) process monitoring specified in table S3.3.

- 3.5.2 The operator shall maintain records of all monitoring required by this permit including records of the taking and analysis of samples, instrument measurements (periodic and continual), calibrations, examinations, tests and surveys and any assessment or evaluation made on the basis of such data.
- 3.5.3 Monitoring equipment, techniques, personnel and organisations employed for the emissions monitoring programme and the environmental or other monitoring specified in condition 3.5.1 shall have either MCERTS certification or MCERTS accreditation (as appropriate), where available, unless otherwise agreed in writing by the Environment Agency.

3.6 Pests

- 3.6.1 The activities shall not give rise to the presence of pests which are likely to cause pollution, hazard or annoyance outside the boundary of the site. The operator shall not be taken to have breached this condition if appropriate measures, including, but not limited to, those specified in any approved pests management plan, have been taken to prevent or where that is not practicable, to minimise the presence of pests on the site.
- 3.6.2 The operator shall:
- (a) if notified by the Environment Agency, submit to the Environment Agency for approval within the period specified, a pests management plan which identifies and minimises risks of pollution, hazard or annoyance from pests; and
 - (b) implement the pests management plan, from the date of approval, unless otherwise agreed in writing by the Environment Agency.

4 Information

4.1 Records

- 4.1.1 All records required to be made by schedules 3, 4 and 5 to this permit shall:
- (a) be legible;
 - (b) be made as soon as reasonably practicable;
 - (c) if amended, be amended in such a way that the original and any subsequent amendments remain legible, or are capable of retrieval; and
 - (d) be retained, unless otherwise agreed in writing by the Environment Agency, for at least 6 years from the date when the records were made, or in the case of the following records until permit surrender:
 - (i) off-site environmental effects; and
 - (ii) matters which affect the condition of the land and groundwater.
- 4.1.2 The operator shall maintain convenient access, in either electronic or hard copy, to the records, plans and management system required to be maintained by this permit.

4.2 Reporting

- 4.2.1 The operator shall send all reports and notifications required by the permit to the Environment Agency using the contact details supplied in writing by the Environment Agency.
- 4.2.2 For the following activities referenced in schedule 1, table S1.1 a report or reports on the performance of the activities over the previous year shall be submitted to the Environment Agency by 31 January (or other date agreed in writing by the Environment Agency) each year. The report(s) shall include as a minimum:
- (a) a review of the results of the monitoring and assessment carried out in accordance with the permit including an interpretive review of that data.

- 4.2.3 Within 28 days of the end of the reporting period the operator shall, unless otherwise agreed in writing by the Environment Agency, submit reports of the monitoring and assessment carried out in accordance with the conditions of this permit, as follows:
- (a) in respect of the parameters and emission points specified in schedule 4 table S4.1;
 - (b) for the reporting periods specified in schedule 4 table S4.1 and using the forms specified in schedule 4 table S4.2; and
 - (c) giving the information from such results and assessments as may be required by the forms specified in those tables.
- 4.2.4 The operator shall, unless notice under this condition has been served within the preceding four years, submit to the Environment Agency, within six months of receipt of a written notice, a report assessing whether there are other appropriate measures that could be taken to prevent, or where that is not practicable, to minimise pollution.

4.3 Notifications

4.3.1 In the event:

- (a) that the operation of the activities gives rise to an incident or accident which significantly affects or may significantly affect the environment, the operator must immediately :-
 - (i) inform the Environment Agency,
 - (ii) take the measures necessary to limit the environmental consequences of such an incident or accident, and
 - (iii) take the measures necessary to prevent further possible incidents or accidents; and
- (b) of a breach of any permit condition the operator must immediately :-
 - (i) inform the Environment Agency, and
 - (ii) take the measures necessary to ensure that compliance is restored within the shortest possible time;
- (c) of a breach of permit condition which poses an immediate danger to human health or threatens to cause an immediate significant adverse effect on the environment, the operator must immediately suspend the operation of the activities or the relevant part of it until compliance with the permit conditions has been restored.

4.3.2 Any information provided under condition 4.3.1 shall be confirmed by sending the information listed in schedule 5 to this permit within the time period specified in that schedule.

4.3.3 Where the Environment Agency has requested in writing that it shall be notified when the operator is to undertake monitoring and/or spot sampling, the operator shall inform the Environment Agency when the relevant monitoring and/or spot sampling is to take place. The operator shall provide this information to the Environment Agency at least 14 days before the date the monitoring is to be undertaken.

4.3.4 The Environment Agency shall be notified within 14 days of the occurrence of the following matters, except where such disclosure is prohibited by Stock Exchange rules:

Where the operator is a registered company:

- (a) any change in the operator's trading name, registered name or registered office address; and
- (b) any steps taken with a view to the operator going into administration, entering into a company voluntary arrangement or being wound up.

Where the operator is a corporate body other than a registered company:

- (c) any change in the operator's name or address; and
- (d) any steps taken with a view to the dissolution of the operator.

In any other case:

- (e) the death of any of the named operators (where the operator consists of more than one named individual);
- (f) any change in the operator's name(s) or address(es); and
- (g) any steps taken with a view to the operator, or any one of them, going into bankruptcy, entering into a composition or arrangement with creditors, or, in the case of them being in a partnership, dissolving the partnership.

4.3.5 Where the operator proposes to make a change in the nature or functioning, or an extension of the activities, which may have consequences for the environment and the change is not otherwise the subject of an application for approval under the Regulations or this permit:

- (a) the Environment Agency shall be notified at least 14 days before making the change; and
- (b) the notification shall contain a description of the proposed change in operation.

4.3.6 The Environment Agency shall be given at least 14 days' notice before implementation of any part of the site closure plan.

4.4 Interpretation

4.4.1 In this permit the expressions listed in schedule 6 shall have the meaning given in that schedule.

4.4.2 In this permit references to reports and notifications mean written reports and notifications, except where reference is made to notification being made "immediately", in which case it may be provided by telephone.

Schedule 1 – Operations

Table S1.1 Activities		
Activity listed in Schedule 1 of the EP Regulations	Description of specified activity	Limits of specified activity
Section 6.9 A(1)(a)(i) Rearing of poultry intensively in an installation with more than 40,000 places	The rearing of poultry in a facility with a capacity for 410,000 broiler places.	From receipt of birds, raw materials and fuels onto the site to removal of birds and associated wastes from site.
Directly Associated Activity	Description of specified activity	Limits of specified activity
Biomass boiler	Operation of 4 biomass boilers with an aggregated thermal rated input not exceeding 0.776 MWth, for site heating requirements, burning biomass fuel not comprising waste or animal carcasses.	From receipt of raw materials and fuels, to release of combustion products to air and associated wastes removed from site.
Carcass incineration	Operation of an Incinerator for carcass disposal Animal and Plant Health Agency (APHA) approved < 50 kg/hr.	From receipt of raw materials, fuels and input of carcasses to release of combustion products to air and associated wastes removed from site.

Table S1.2 Operating techniques		
Description	Parts	Date Received
Application EPR/RP3031ME/A001	The responses to sections B2.3.1, B2.3.2, B2.3.3, B2.6.1, B2.6.2, B2.6.3, B2.7.1 and B2.7.2 in the Application.	22/01/07
Variation application EPR/RP3031ME/V002	Sections C2 and C3 and associated supporting documents.	10/11/10
Request for information EPR/RP3031ME/V002 dated 26/01/11	Response to request for Information confirming the absence of pollution within the new area of the site.	23/02/11
Variation application EPR/RP3031ME/V003	Responses to Parts C2 and C3 of the application form and all referenced supporting documentation.	21/08/14
Additional information EPR/RP3031ME/V003 requested 26/10/14	Response to request for Information confirming whether manure / slurry is spread to Operator owned land.	28/09/14
Request for minor operational change by operator.	Request for a minor operational change for the installation of a carcass incinerator at Hall Farm poultry unit. Assessed and approved.	08/11/18
Application EPR/XP3606MV/V002 (variation and consolidation)	Responses to sections 4, 6, 7 and 8 of Part C3.5 of the application form and referenced supporting documentation, and additional information received in response to not duly made request for information, including: <ul style="list-style-type: none"> • Summary of Environment Management System • Environmental risk assessment • Raw materials inventory • Confirmation of compliance with all relevant best available techniques (BAT) conclusions as defined in the intensive rearing of poultry or pigs (IRPP) BAT conclusions document, dated 21/02/17 • Clarification regarding bird numbers and ventilation • Site plan 	16/12/21
Additional information requested 16/12/21	Response to Request for Information providing a revised dust management plan.	17/12/21
Additional information requested 22/12/21	Response to Request for Information confirming operation of the carcass incinerator and providing a revised technical standards document and accident risk assessment.	07/01/22
Additional information requested 11/01/22	Response to Request for Information confirming storage of fuel for the carcass incinerator and revised site drainage plan.	11/01/22

Table S1.3 Improvement programme requirements		
Reference	Requirement	Date
IC1	The operator shall protect the feed storage facilities from collision damage to comply with the requirements of S3.3 of TGN How to Comply, Version 1.	Completed
IC2	A written plan shall be submitted to the Agency for approval, following a review of all site drainage at the installation. The plan should take into account the appropriate measures for the management of drainage systems and run-off in S3.3 of TGN How to Comply, Version 1, and include a timetable for any improvements to the drainage system. The notification requirements of condition 2.5.2 shall be deemed to have been complied with on submission of the plan.	Completed

Table S1.3 Improvement programme requirements

Reference	Requirement	Date
	The plan shall be implemented by the operator from the date of approval in writing by the Agency subject to such amendments or additions as notified by the Agency.	
IC3	<p>A written plan shall be submitted to the Agency for approval following a review of existing poultry housing and management practices at the installation. The plan shall take into account the appropriate measures in [S5.2.1 & S5.2.2] [S6.2.1 & S6.2.2] of TGN How to Comply, Version 1. The plan shall identify measures to reduce emissions to all media, the likely cost of such measures and a proposed timetable for their implementation.</p> <p>Include if identified by no answer in the application. The plan shall include specific reference to drinkers and troughs, which shall be designed to prevent leakage. The notification requirements of condition 2.5.2 shall be deemed to have been complied with on submission of the plan.</p> <p>The plan shall be implemented by the operator from the date of approval in writing by the Agency subject to such amendments or additions as notified by the Agency.</p>	Completed

Schedule 2 – Waste types, raw materials and fuels

Table S2.1 Raw materials and fuels	
Raw materials and fuel description	Specification
Fuel for biomass boiler units	Biomass chips or pellets comprising virgin timber, straw, miscanthus; or a combination of these.

Schedule 3 – Emissions and monitoring

Table S3.1 Point source emissions to air – emission limits and monitoring requirements						
Emission point ref. & location	Source	Parameter	Limit (including unit)	Reference period	Monitoring frequency	Monitoring standard or method
High velocity roof fan outlets on poultry houses as shown on the site drainage plan in schedule 7	Poultry houses 5 to 8	---	---	---	---	---
Gable end fan outlet as shown on the site drainage plan in schedule 7	Poultry house 1 to 8	---	---	---	---	---
Exhaust from standby generator as shown on the site drainage plan in Schedule 7	Standby Generator	---	---	---	---	---
Vent from oil tank as shown on the site drainage plan in Schedule 7	Diesel tank	---	---	---	---	---
Emissions from 4 biomass boilers as shown on the site drainage plan in Schedule 7	Aggregated 0.776 MWth biomass boiler	---	---	---	---	---
Chimney from carcass incinerator as shown on the site drainage plan in Schedule 7	Carcass incinerator	---	---	---	---	---

Table S3.2 Point Source emissions to water (other than sewer) and land – emission limits and monitoring requirements						
Emission point ref. & location	Source	Parameter	Limit (incl. unit)	Reference Period	Monitoring frequency	Monitoring standard or method
Outlet to surface water to the north-east of the site, as indicated on the site drainage plan in Schedule 7	Roof water from poultry houses 1 – 8, via a rainwater harvesting pond prior to discharge	---	---	---	---	---
Outlet to surface water to the north-east of the site, as indicated on the site drainage plan in Schedule 7	Water draining from yard (excluding poultry house wash out periods)	---	---	---	---	---

Table S3.3 Process monitoring requirements

Emission point reference or source or description of point of measurement	Parameter	Limit (incl. Unit)	Monitoring frequency (1)	Monitoring standard or method
Broilers in houses 1 to 8 (Naturally ventilated or fan ventilated fully littered floor, non-leaking drinkers)	kg N excreted/animal place/year	0.6 kg N/animal place/year	Annually	Estimation by using manure analysis for total nitrogen content
	kg P ₂ O ₅ excreted/animal place/year	0.25 kg/P ₂ O ₅ animal place/year	Annually	Estimation by using manure analysis for total phosphorus content
	kg NH ₃ /animal place/year	0.08 kg NH ₃ /animal place/year	Annually	Estimation using emission factors
	Dust	n/a	Annually	Estimation using emission factors

Schedule 4 – Reporting

Parameters, for which reports shall be made, in accordance with conditions of this permit, are listed below.

Table S4.1 Reporting of monitoring data			
Parameter	Emission or monitoring point/reference	Reporting period	Period begins
Process monitoring Parameters as required by condition 3.5.1	-	Every 12 months	1 January

Table S4.2 Reporting forms		
Media/parameter	Reporting format	Date of form
kg NH ₃ /animal place/year	Form Process Monitoring 1 or other form as agreed in writing by the Environment Agency	24/02/22
kg N excreted/animal place/year	Form Process Monitoring 1 or other form as agreed in writing by the Environment Agency	24/02/22
kg P ₂ O ₅ excreted/animal place/year	Form Process Monitoring 1 or other form as agreed in writing by the Environment Agency	24/02/22
Dust atmospheric mass emission	Form Process Monitoring 1 or other form as agreed in writing by the Environment Agency	24/02/22

Schedule 5 – Notification

These pages outline the information that the operator must provide.

Units of measurement used in information supplied under Part A and B requirements shall be appropriate to the circumstances of the emission. Where appropriate, a comparison should be made of actual emissions and authorised emission limits.

If any information is considered commercially confidential, it should be separated from non-confidential information, supplied on a separate sheet and accompanied by an application for commercial confidentiality under the provisions of the EP Regulations.

Part A

Permit number	
Name of operator	
Location of facility	
Time and date of the detection	

(a) Notification requirements for any malfunction, breakdown or failure of equipment or techniques, accident, or emission of a substance not controlled by an emission limit which has caused, is causing or may cause significant pollution	
To be notified within 24 hours of detection	
Date and time of the event	
Reference or description of the location of the event	
Description of where any release into the environment took place	
Substances(s) potentially released	
Best estimate of the quantity or rate of release of substances	
Measures taken, or intended to be taken, to stop any emission	
Description of the failure or accident.	

(b) Notification requirements for the breach of a limit	
To be notified within 24 hours of detection	
Emission point reference/ source	
Parameter(s)	
Limit	
Measured value and uncertainty	
Date and time of monitoring	
Measures taken, or intended to be taken, to stop the emission	

Time periods for notification following detection of a breach of a limit	
Parameter	Notification period

(c) Notification requirements for the breach of permit conditions not related to limits	
To be notified within 24 hours of detection	
Condition breached	
Date, time and duration of breach	
Details of the permit breach i.e. what happened including impacts observed.	
Measures taken, or intended to be taken, to restore permit compliance.	

(d) Notification requirements for the detection of any significant adverse environmental effect	
To be notified within 24 hours of detection	
Description of where the effect on the environment was detected	
Substances(s) detected	
Concentrations of substances detected	
Date of monitoring/sampling	

Part B – to be submitted as soon as practicable

Any more accurate information on the matters for notification under Part A.	
Measures taken, or intended to be taken, to prevent a recurrence of the incident	
Measures taken, or intended to be taken, to rectify, limit or prevent any pollution of the environment which has been or may be caused by the emission	
The dates of any unauthorised emissions from the facility in the preceding 24 months.	
Name*	
Post	
Signature	
Date	

* authorised to sign on behalf of the operator

Schedule 6 – Interpretation

“accident” means an accident that may result in pollution.

“Animal and Plant Health Agency (APHA)” is the government agency that licences small on farm incinerators; formerly known as the Animal Health and Veterinary Laboratories Agency.

“application” means the application for this permit, together with any additional information supplied by the operator as part of the application and any response to a notice served under Schedule 5 to the EP Regulations.

“authorised officer” means any person authorised by the Environment Agency under section 108(1) of The Environment Act 1995 to exercise, in accordance with the terms of any such authorisation, any power specified in section 108(4) of that Act.

“building” means a construction that has the objective of providing sheltering cover and minimising emissions of noise, particulate matter, odour and litter.

“emissions to land” includes emissions to groundwater.

“emissions of substances not controlled by emission limits” means emissions of substances to air, water or land from the activities, either from the emission points specified in schedule 3 or from other localised or diffuse sources, which are not controlled by an emission limit.

“EP Regulations” means The Environmental Permitting (England and Wales) Regulations SI 2016 No.1154 and words and expressions used in this permit which are also used in the Regulations have the same meanings as in those Regulations.

“Existing housing” means housing that is not defined as new housing.

“groundwater” means all water, which is below the surface of the ground in the saturation zone and in direct contact with the ground or subsoil.

“Hazardous property” has the meaning in Annex III of the Waste Framework Directive.

“Industrial Emissions Directive” means DIRECTIVE 2010/75/EU OF THE EUROPEAN PARLIAMENT AND OF THE COUNCIL of 24 November 2010 on industrial emissions, as read in accordance with Schedule 1A to the Environmental Permitting (England and Wales) Regulations 2016.

“List of Wastes” means the list of wastes established by Commission Decision 2000/532/EC replacing Decision 94/3/EC establishing a list of wastes pursuant to Article 1(a) of Council Directive 75/442/EEC on waste and Council Decision 94/904/EC establishing a list of hazardous waste pursuant to Article 1(4) of Council Directive 91/689/EEC on hazardous waste, as amended from time to time.

“Manure and slurry” have the following meaning:

- Manures may be either slurries or solid manures.
- Slurries consist of excreta produced by livestock whilst in a yard or building mixed with rainwater and wash water and, in some cases, waste bedding and feed. Slurries can be pumped or discharged by gravity.
- Slurry includes duck effluent, seepage from manure and wash water.
- Solid manures include farmyard manure (FYM) and comprise material from straw-based housing systems, excreta with lots of straw/sawdust/woodchips in it, or solids from mechanical separators.
- Most poultry systems produce solid manure (litter).
- Solid manure can generally be stacked.

“New housing” means housing first permitted at the installation following the publication of the intensive rearing of poultry or pigs (IRPP) best available techniques (BAT) conclusions document dated 21/02/17, or a complete replacement of existing housing after 21/02/17.

“MCERTS” means the Environment Agency’s Monitoring Certification Scheme.

“pests” means Birds, Vermin and Insects.

“virgin timber” means timber from

- Whole trees and the woody parts of trees including branches and bark derived from forestry works, woodland management, tree surgery and other similar operations (it does not include clippings or trimmings that consist primarily of foliage);
- Virgin wood processing (e.g. wood offcuts, shavings or sawdust from sawmills) or timber product manufacture dealing in virgin timber.
- If virgin timber is mixed with waste timber or any other waste, the mixed load is classed as waste.

“Waste code” means the six digit code referable to a type of waste in accordance with the List of Wastes and in relation to hazardous waste, includes the asterisk

“Waste Framework Directive” or “WFD” means Waste Framework Directive 2008/98/EC of the European Parliament and of the Council on waste.

“year” means calendar year ending 31 December.

Schedule 7 – Site plan

Site plan - showing installation boundary as referred to in condition 2.2.1.

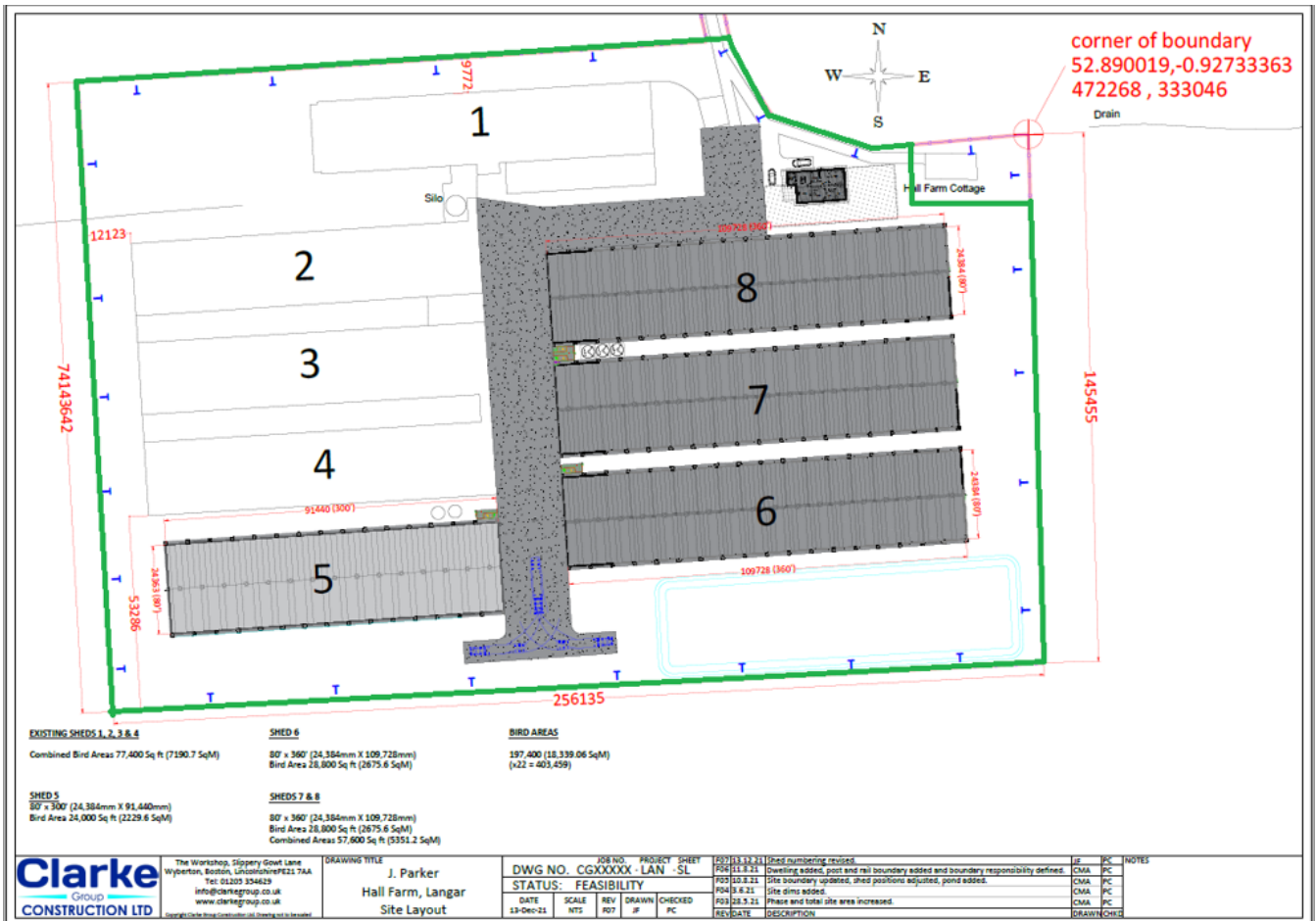

©Crown Copyright. All rights reserved. Environment Agency, 10024198, 2022.

Site drainage plan

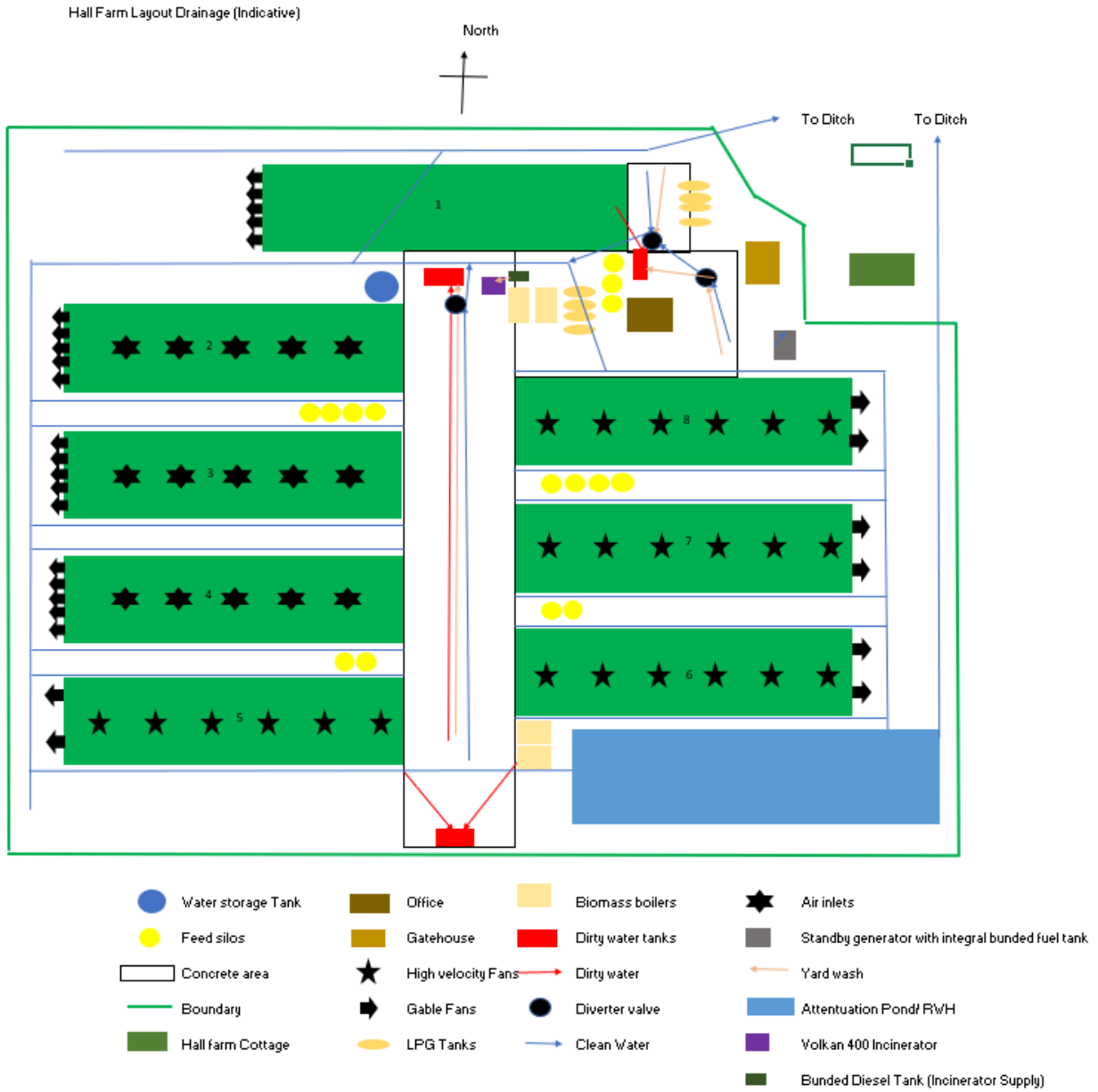

END OF PERMIT