

HIGH SPEED RAIL (LONDON – WEST MIDLANDS) ACT 2017

HIGH SPEED RAIL (LONDON – WEST MIDLANDS) GENERAL VESTING DECLARATION No. 780

This **GENERAL VESTING DECLARATION** is executed on 06 DECEMBER 2021 by the Secretary of State for Transport ("the Authority").

WHEREAS:

- (1) On 23 February 2017 the High Speed Rail (London – West Midlands) Act 2017 ("the High Speed Rail Act") received Royal Assent authorising the Authority to acquire the land specified in the Schedule hereto.
- (2) Section 4(1) of the High Speed Rail Act authorises the Authority to acquire compulsorily so much of the land within the limits of the High Speed Rail Act as may be required for Phase One purposes¹.
- (3) Section 4(4) of the High Speed Rail Act provides that the Compulsory Purchase (Vesting Declarations) Act 1981 ("the 1981 Act") applies as if the High Speed Rail Act were a compulsory purchase order and paragraph 3² of Schedule 6 to the High Speed Rail Act provides that the 1981 Act shall have effect subject to the modifications specified in that paragraph.
- (4) Notice pursuant to section 3A³ of the 1981 Act was first published on 19 November 2021. That notice included the particulars specified in section 3A(3) of the 1981 Act.

NOW THIS DEED WITNESSETH that, in exercise of the powers conferred on it by section 4 of the 1981 Act, the Authority hereby declares:-

1. The land described in the Schedule hereto (being part of the land authorised to be acquired by the High Speed Rail Act) and more particularly delineated and shown coloured pink on the plan annexed hereto, together with the right to enter upon and take possession of the land, shall vest in the Authority as from the end of the period of 4 months from the date on which the service of notices required by section 6⁴ of the 1981 Act is completed.

For the purposes of Section 2(2) of the 1981 Act, the specified period in relation to the land comprised in this declaration is one year and one day.

1 Phase One Purposes has meaning given by section 67 of the High Speed Rail Act

2 Paragraph 3 as substituted by section 11 of, and paragraph 6 of Schedule 14 to, the High Speed Rail Act.

3 Section 3A of the 1981 Act as inserted by paragraph 3(a) of Schedule 6 to the High Speed Rail Act as substituted by section 11 of, and paragraphs 6 and 7 of Schedule 14 to, that Act.

4 Section 6 as modified by paragraph 3(c) of Schedule 6 to the High Speed Rail Act, as substituted by section 11 of, and paragraph 6 of Schedule 14 to, that Act

SCHEDULE

Buckinghamshire

(1) Plot No.	(2) Description
66040	All interests in 495.5 square metres, or thereabouts, of agricultural land (Shepherds Furze Farm)
66043	All interests in 6767.8 square metres, or thereabouts, of woodland, pond and drain (Calvert Jubilee)
66045	All interests in 4750.5 square metres, or thereabouts, of public road, verges and access splay (Gawcott Road)
66046	All interests in 21.8 square metres, or thereabouts, of verge (Steeple Claydon Road)
66047	All interests in 14172.1 square metres, or thereabouts, of woodland and dismantled railway (Calvert Jubilee)
66048	All interests in 4261.2 square metres, or thereabouts, of agricultural land and hedgerows (Shepherds Furze Farm)
66049	All interests in 40.6 square metres, or thereabouts, of bridge carrying verge (Steeple Claydon Road) over disused railway, works and land (Bicester to Bletchley Line)
66050	All interests in 21739.4 square metres, or thereabouts, of woodland, grassland and public footpath (TWY/4/1) (Great Moor Sailing Club)
66051	All interests in 7193.0 square metres, or thereabouts, of woodland and access splays (Calvert Jubilee)
66052	All interests in 16538.9 square metres, or thereabouts, of disused railway, works and land, drain and public footpath (TWY/4/1) (Bicester to Bletchley Line)
66053	All interests in 64194.0 square metres, or thereabouts, of railway, works and land, woodland, access tracks and culvert carrying drain (Aylesbury Link)
66054	All interests in 20988.5 square metres, or thereabouts, of agricultural land, hedgerow and drain (Shepherds Furze Farm)
66055	All interests in 284.1 square metres, or thereabouts, of bridge carrying public road and verges (Gawcott Road) over disused railway (Bicester to Bletchley Line)
66056	All interests in 664.3 square metres, or thereabouts, of woodland (Gawcott Road)
66058	All interests in 2233.2 square metres, or thereabouts, of agricultural land (Portway Farm)
66060	All interests in 1329.7 square metres, or thereabouts, of public road, verges and access splay (Gawcott Road)
66061	All interests in 3158.6 square metres, or thereabouts, of woodland and dismantled railway (Gawcott Road)
66062	All interests in 6.5 square metres, or thereabouts, of agricultural land (Shepherds Furze Farm)
66063	All interests in 278.5 square metres, or thereabouts, of access track and verges (Aylesbury Link)
66064	All interests in 18.5 square metres, or thereabouts, of hedgerow (Gawcott Road)
66068	All interests in 9634.6 square metres, or thereabouts, of agricultural land (Portway Farm)
66069	All interests in 191.2 square metres, or thereabouts, of hedgerow

	(Shepherds Furze Farm)
66071	All interests in 194.3 square metres, or thereabouts, of hedgerow (Addison Road)
66075	All interests in 13486.6 square metres, or thereabouts, of agricultural land and construction site (Portway Farm)
66077	All interests in 606.1 square metres, or thereabouts, of agricultural land, woodland and dismantled railway (Portway Farm)
66090	All interests in 14994.5 square metres, or thereabouts, of agricultural land, hedgerow and drain (Portway Farm)
66093	All interests in 4928.8 square metres, or thereabouts, of agricultural land, woodland and dismantled railway (Portway Farm)
66098	All interests in 9981.2 square metres, or thereabouts, of agricultural land and copse (Elm Tree Farm)
66103	All interests in 6314.8 square metres, or thereabouts, of agricultural land (Portway Farm)
66108	All interests in 332.8 square metres, or thereabouts, of public road and verges (Gawcott Road)
66117	All interests in 280.8 square metres, or thereabouts, of hedgerow (Portway Farm)
66118	All interests in 346.8 square metres, or thereabouts, of access track (Portway Farm)
66126	All interests in 7153.3 square metres, or thereabouts, of agricultural land and public footpath (TWY/18/2) (Portway Farm)
66129	All interests in 233.7 square metres, or thereabouts, of verge (West Street)
69191	All interests in 12589.6 square metres, or thereabouts, of woodland and dismantled railway (Calvert Jubilee)
69193	All interests in 236.6 square metres, or thereabouts, of woodland, agricultural land and public footpath (TWY/5/1) (Gawcott Road)
69194	All interests in 2969.7 square metres, or thereabouts, of hedgerow, access track and access splay (Shepherds Furze Farm)
69198	All interests in 1333.0 square metres, or thereabouts, of construction site (Portway Farm)
69199	All interests in 3730.6 square metres, or thereabouts, of agricultural land and drain (Portway Farm)
70223	All interests in 18358.2 square metres, or thereabouts, of agricultural land, woodland, hedgerow, pond and drain (Shepherds Furze Farm)
70224	All interests in 1117.5 square metres, or thereabouts, of agricultural land and access road (Shepherds Furze Farm)
70226	All interests in 1650.2 square metres, or thereabouts, of agricultural land and hedgerows (Portway Farm)
70227	All interests in 4011.0 square metres, or thereabouts, of agricultural land (Portway Farm)
70229	All interests in 30073.8 square metres, or thereabouts, of agricultural land, construction site, drain and public footpath (TWY/4/1) (Portway Farm)
70230	All interests in 21746.5 square metres, or thereabouts, of agricultural land, drain and public footpath (TWY/4/1) (Portway Farm)
70237	All interests in 405.0 square metres, or thereabouts, of agricultural land (Portway Farm)
70238	All interests in 32301.5 square metres, or thereabouts, of agricultural land, watercourse and public footpath (TWY/18/2) (Portway Farm)
70239	All interests in 1723.6 square metres, or thereabouts, of agricultural land (Portway Farm)
70240	All interests in 1791.2 square metres, or thereabouts, of agricultural land (Portway Farm)
70243	All interests in 1820.1 square metres, or thereabouts, of agricultural land

	(Portway Farm)
70341	All interests in 139.6 square metres, or thereabouts, of agricultural land and access track (Shepherds Furze Farm)
70342	All interests in 268.4 square metres, or thereabouts, of access track (Shepherds Furze Farm)
70343	All interests in 641.5 square metres, or thereabouts, of agricultural land (Shepherds Furze Farm)
70903	All interests in 1309.1 square metres, or thereabouts, of dismantled railway and woodland (Gawcott Road)
70906	All interests in 674.8 square metres, or thereabouts, of dismantled railway and construction site (Portway Farm)
71343	All interests in 7.3 square metres, or thereabouts, of agricultural land (Portway Farm)
71344	All interests in 11.3 square metres, or thereabouts, of agricultural land (Portway Farm)
71346	All interests in 2.2 square metres, or thereabouts, of agricultural land (Portway Farm)
71362	All interests in 956.5 square metres, or thereabouts, of agricultural land (Elm Tree Farm)
71365	All interests in 343.5 square metres, or thereabouts, of agricultural land and drain (Addison Road)
71366	All interests in 942.8 square metres, or thereabouts, of agricultural land (Elm Tree Farm)
71693	All interests in 47.1 square metres, or thereabouts, of woodland (Calvert Jubilee)
71694	All interests in 1227.7 square metres, or thereabouts, of railway, works and land (Aylesbury Link)
71695	All interests in 15.0 square metres, or thereabouts, of woodland (Calvert Jubilee)
71697	All interests in 267.3 square metres, or thereabouts, of grassland and woodland (Calvert Jubilee)
71698	All interests in 326.2 square metres, or thereabouts, of grassland and woodland (Calvert Jubilee)

IN WITNESS WHEREOF the Secretary of State for Transport has hereunto set its corporate seal on the day in the year first written above.

The **CORPORATE SEAL** of the SECRETARY OF STATE FOR TRANSPORT hereunto affixed to this deed is authenticated by



.....
Authorised Signatory



SEAL REF
DfT GP / 0925

Dated: 06 DECEMBER 2021

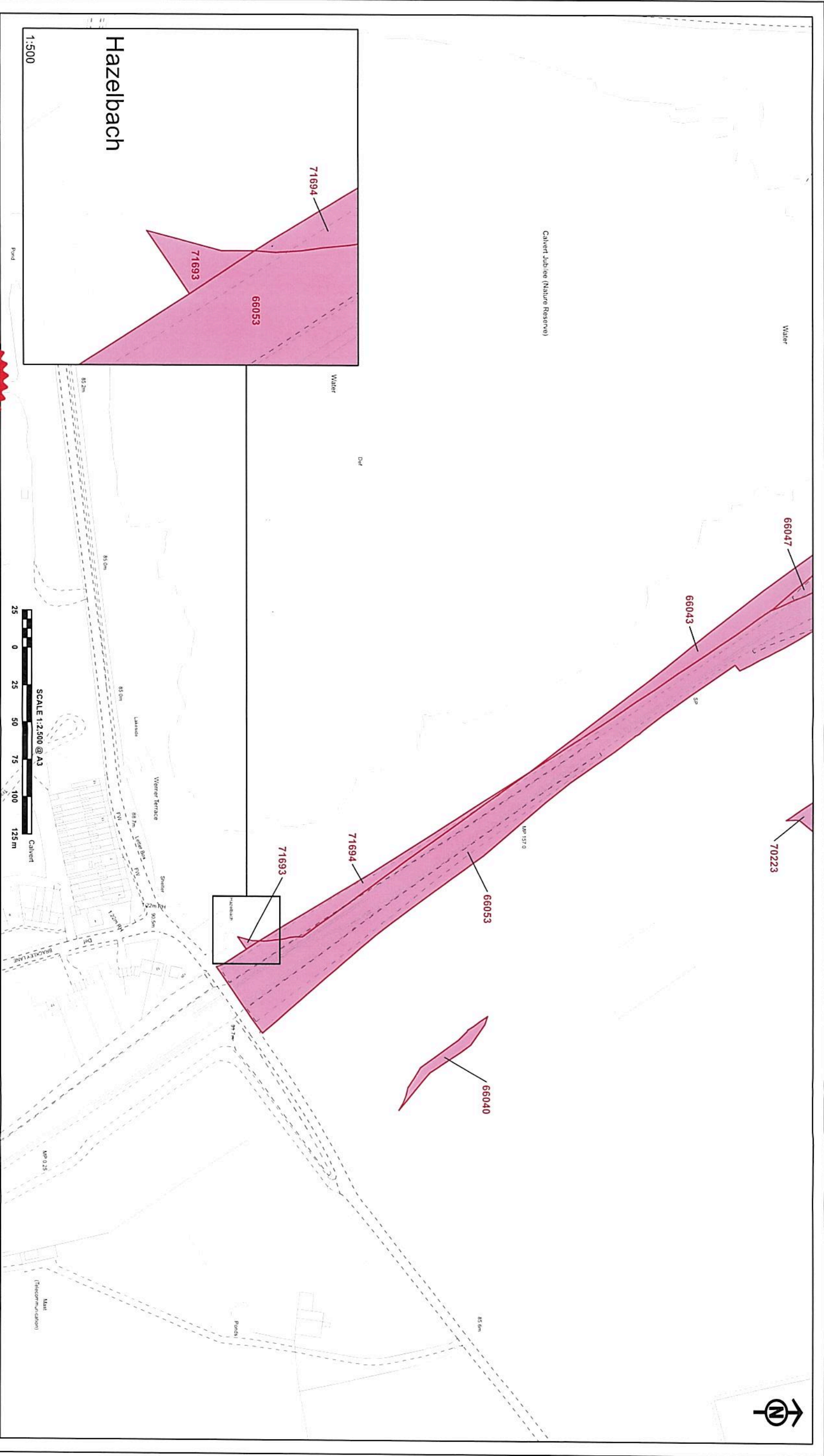

The CORPORATE SEAL of the
SECRETARY OF STATE
hereunto affixed to this deed
is authenticated by

Authorised by the Secretary of State for Transport

Dated 06 DECEMBER 2021



0925

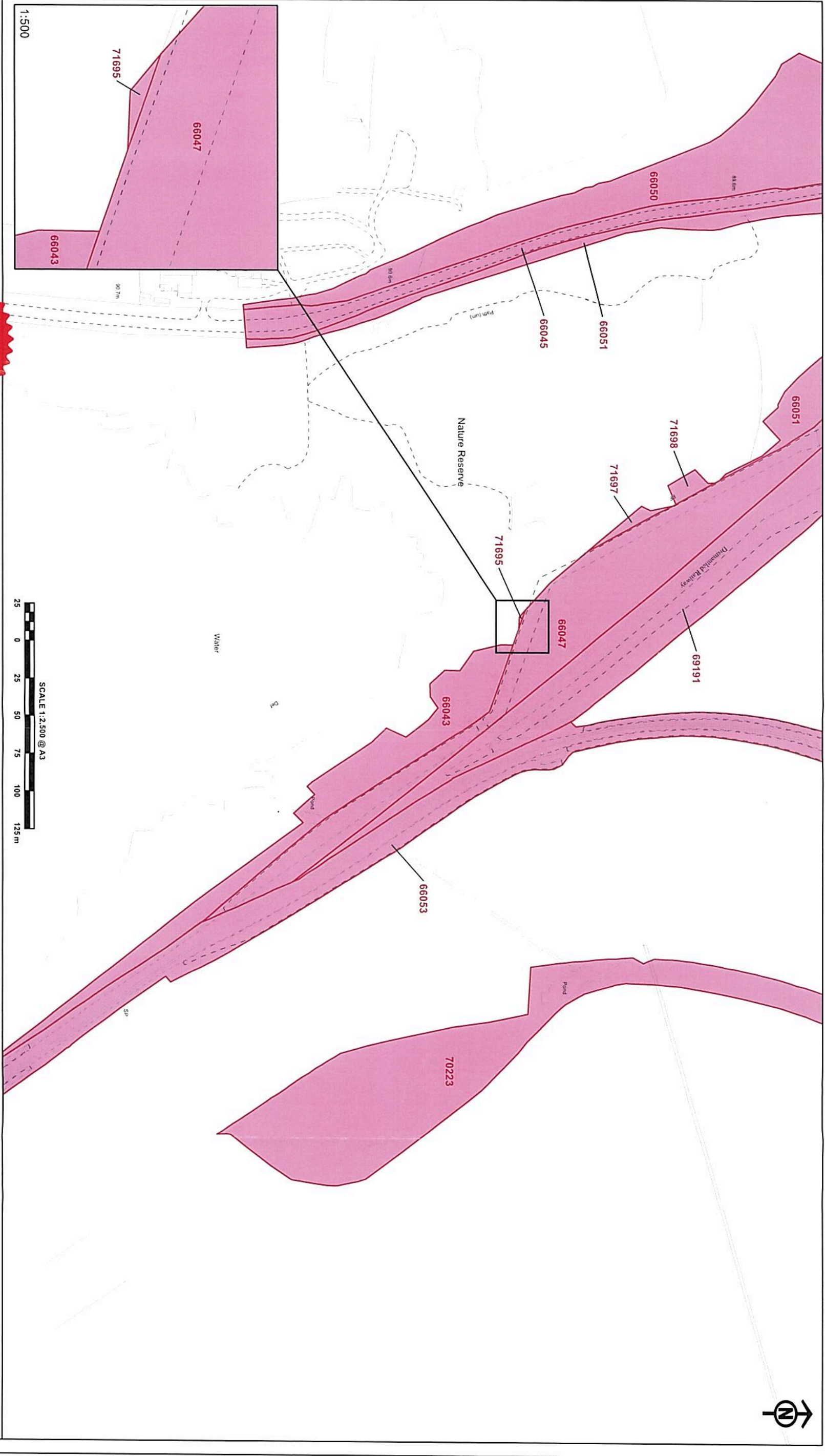

The CORPORATE SEAL of the
SECRETARY OF STATE
hereunto affixed to this deed
is authenticated by

.....
Authorised by the Secretary of State for Transport

Dated 06 DECEMBER 2021

CENTRE POINT: 468,368, 225,317

© Crown copyright and database right 2021. Ordnance Survey, Licence Number: 100019196
© Crown copyright material is reproduced with the permission of Land Registry under
Approved Licence from the Controller of HMSO and the Crown Copyright Licensing Scheme

HSS2-HS2-GI-TEM-000-000030 Ref: C241_157_01

0125

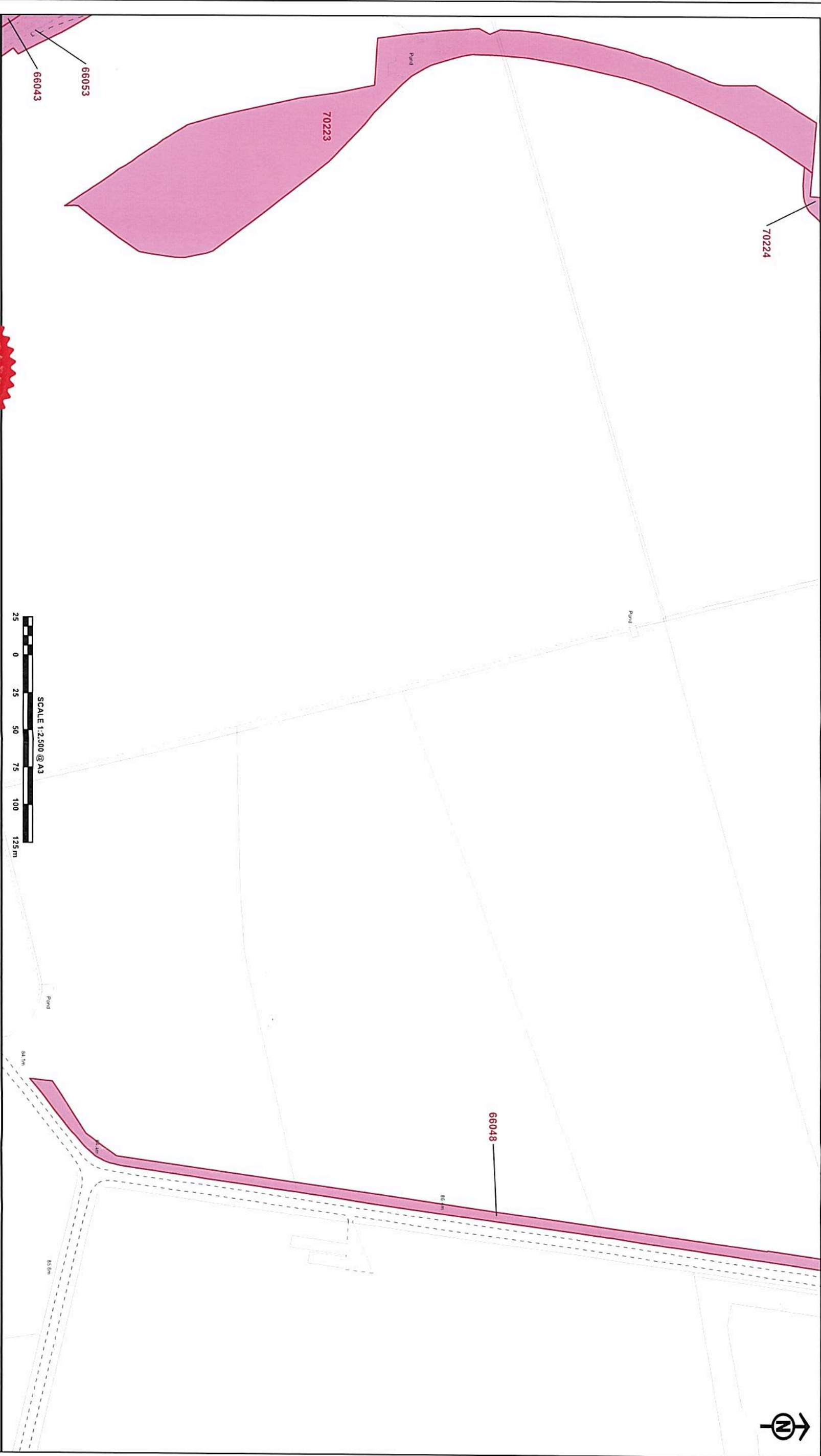

The CORPORATE SEAL of the
SECRETARY OF STATE
hereunto affixed to this deed
is authenticated by

Authorised by the Secretary of State for Transport

Dated 06 DECEMBER 2021

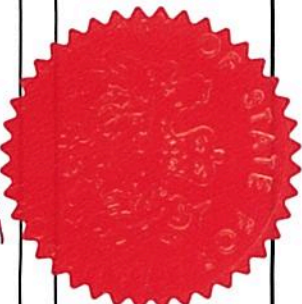

0925

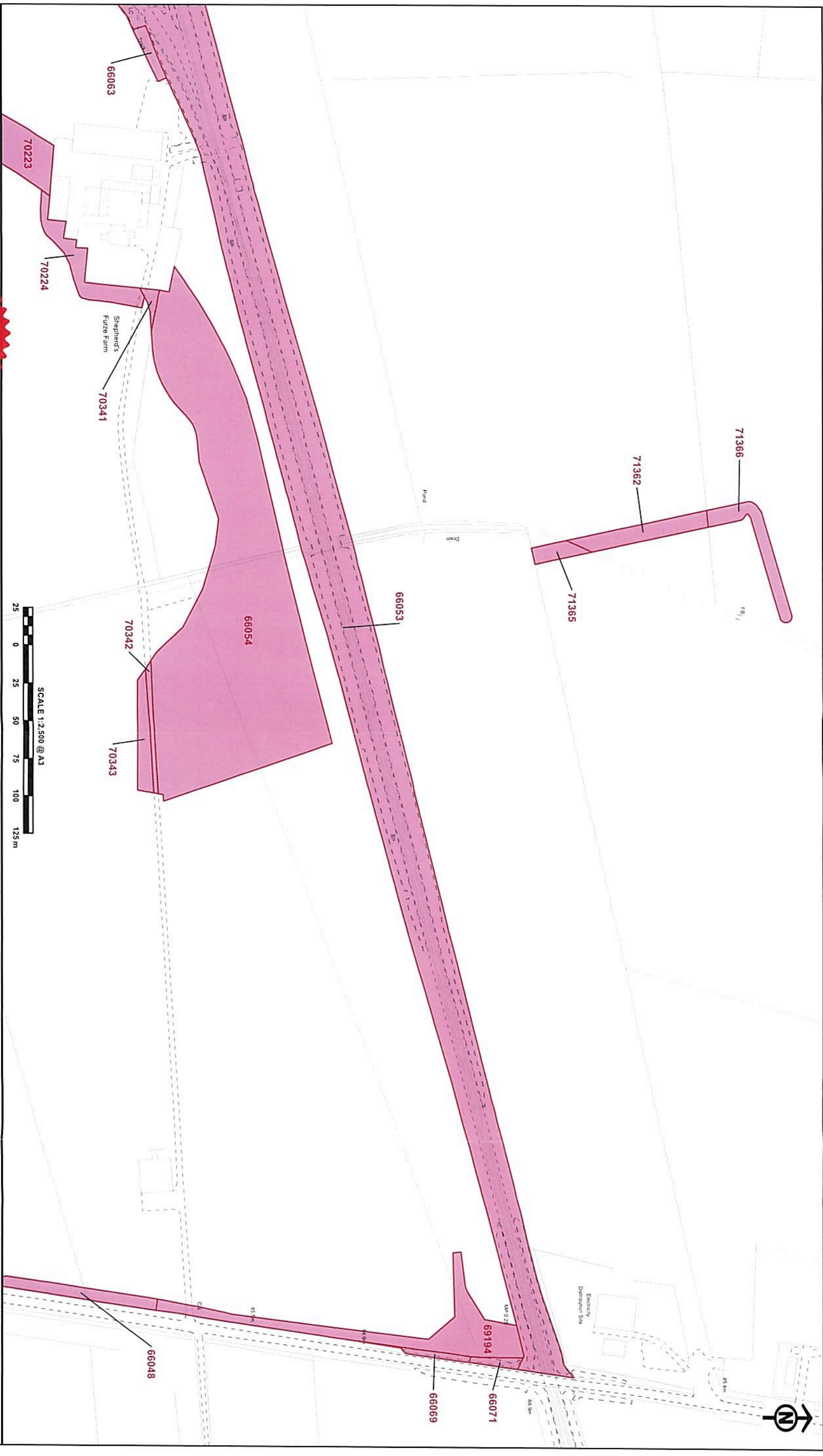

The CORPORATE SEAL of the
SECRETARY OF STATE
hereunto affixed to this deed
is authenticated by

Authorised by the Secretary of State for Transport

Dated 06 December 2021

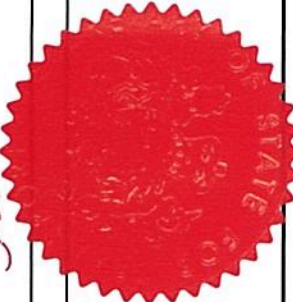

0925

CENTRE POINT: 469,032, 225,853

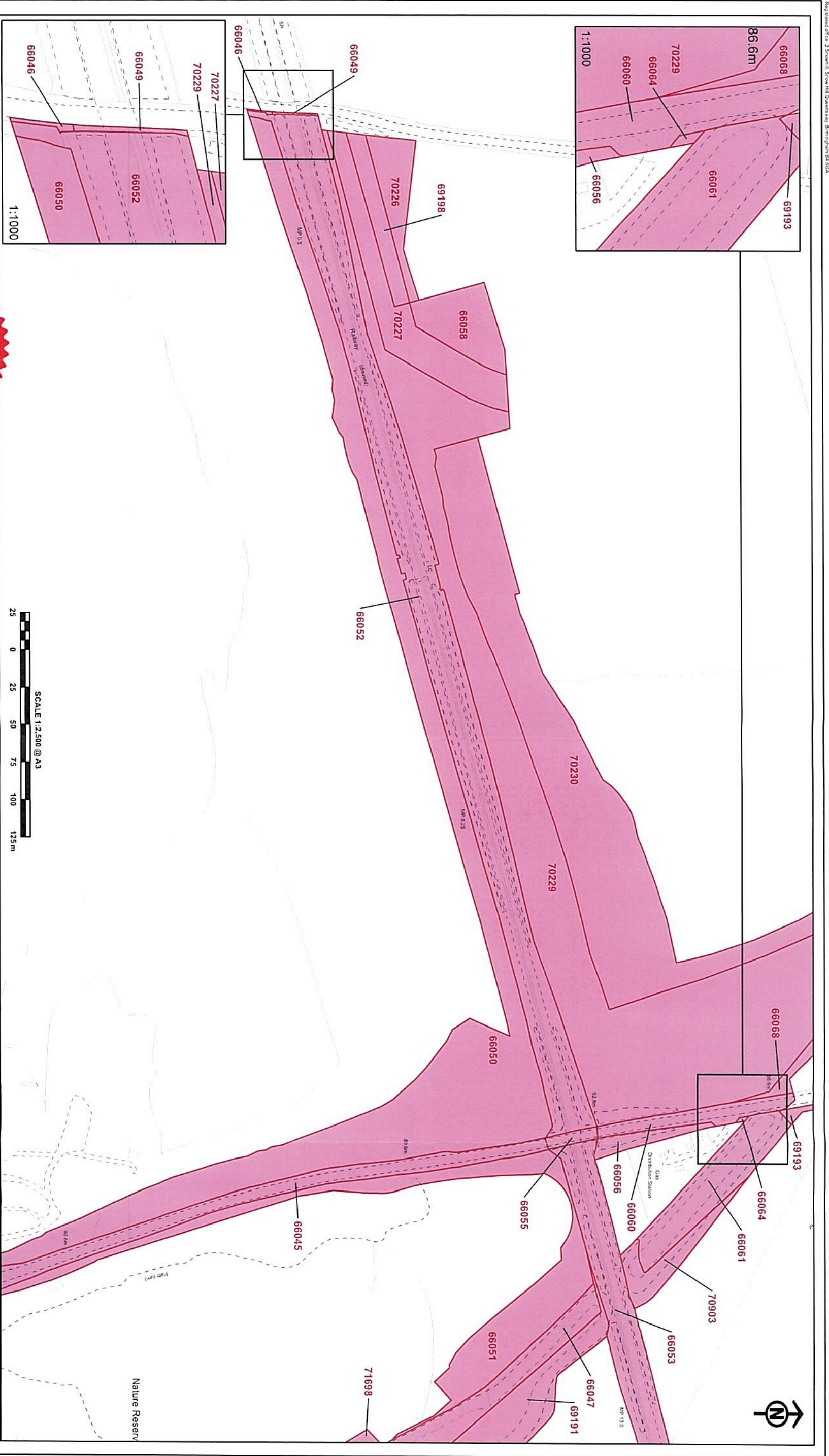

The CORPORATE SEAL of the
SECRETARY OF STATE
hereunto affixed to this deed
is authenticated by

Authorised by the Secretary of State for Transport
Dated 06 DECEMBER 2011



0925

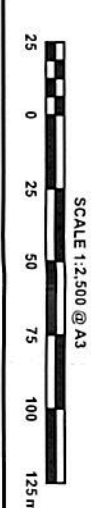
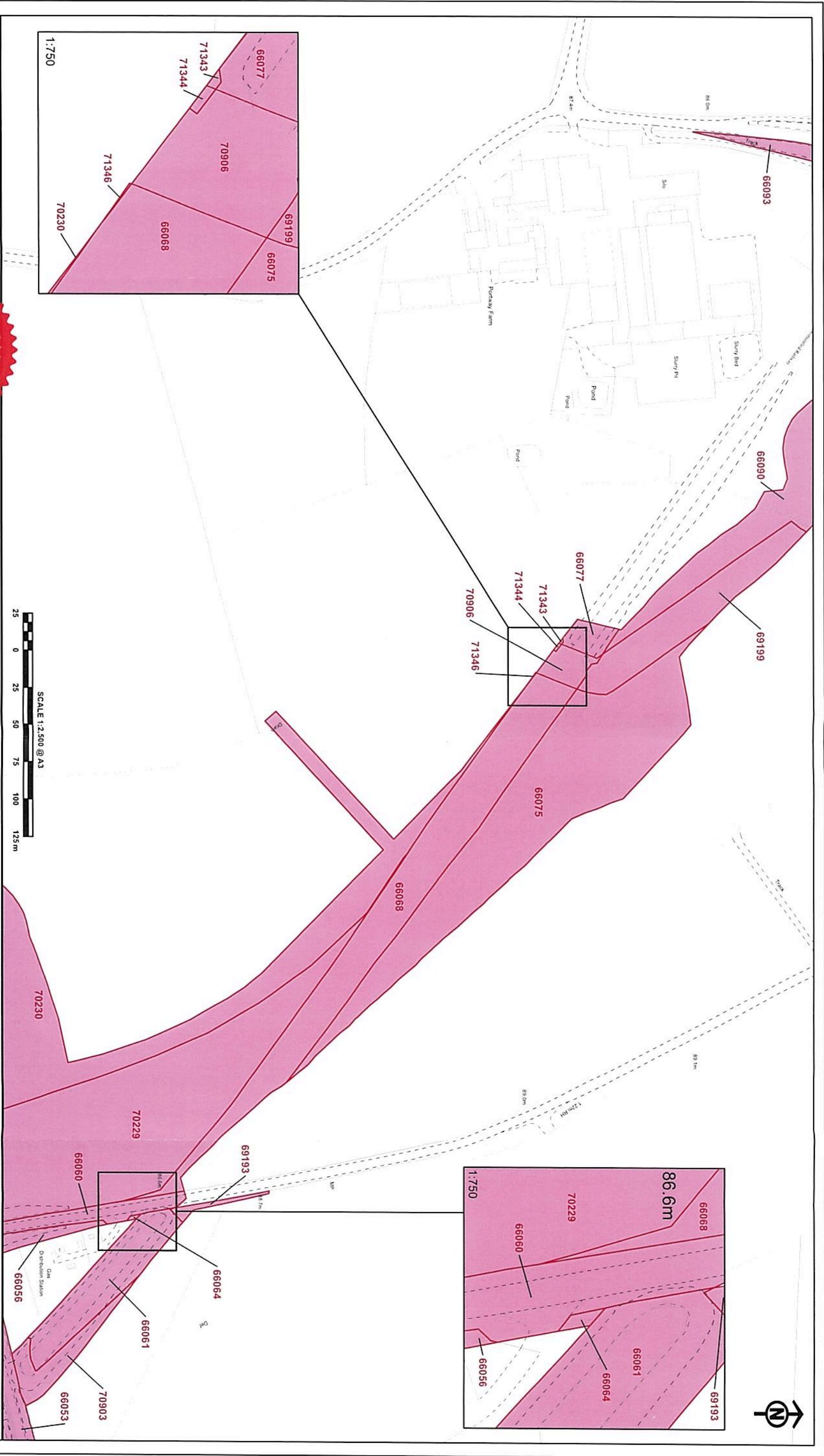

The CORPORATE SEAL of the
SECRETARY OF STATE
hereunto affixed to this deed
is authenticated by

Authorized by the Secretary of State for Transport

Dated 06 DECEMBER 2021



0925

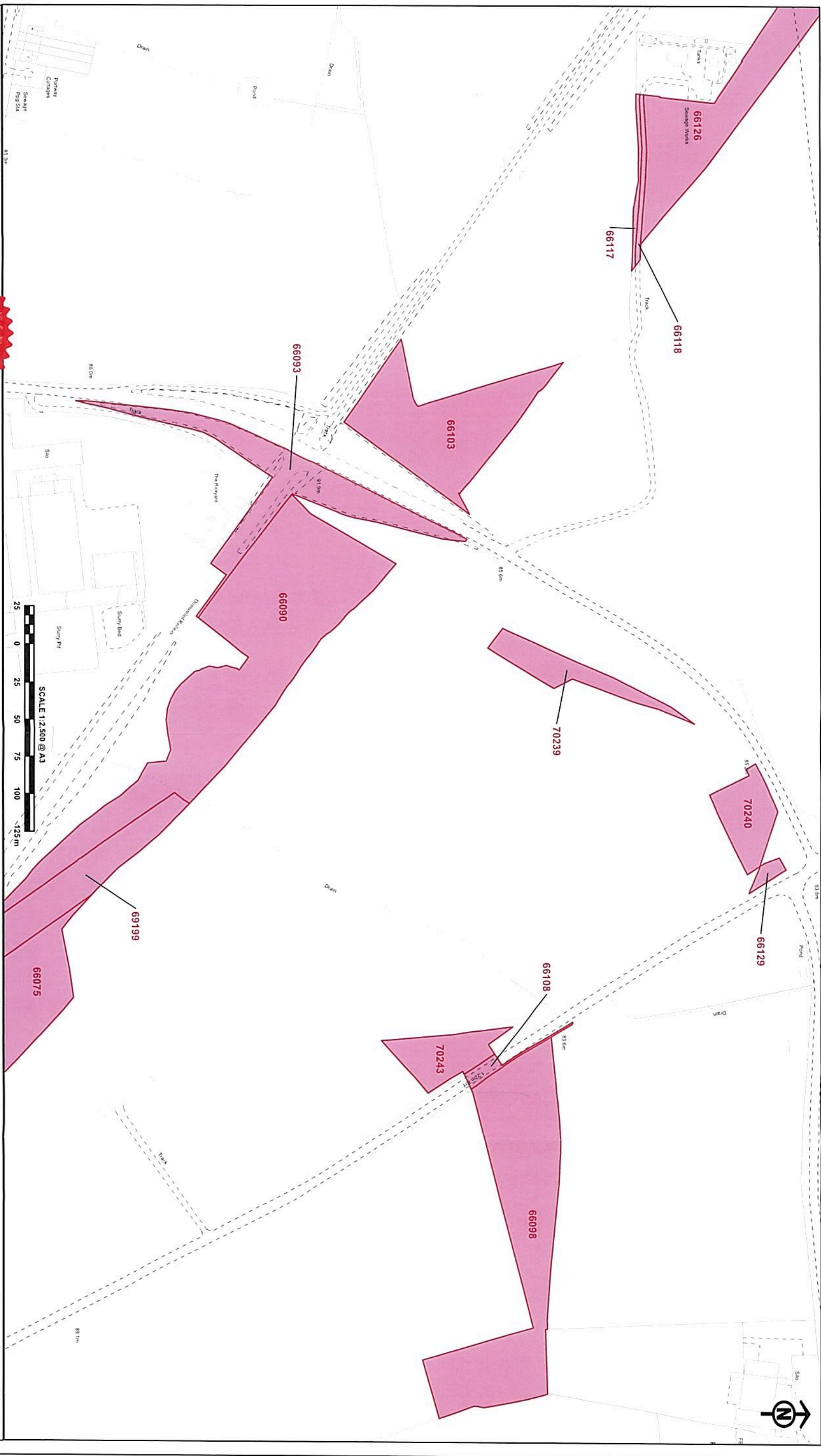

The CORPORATE SEAL of the
SECRETARY OF STATE
hereunto affixed to this deed
is authenticated by

Authorised by the Secretary of State for Transport

Dated 06 DECEMBER 2021



0925

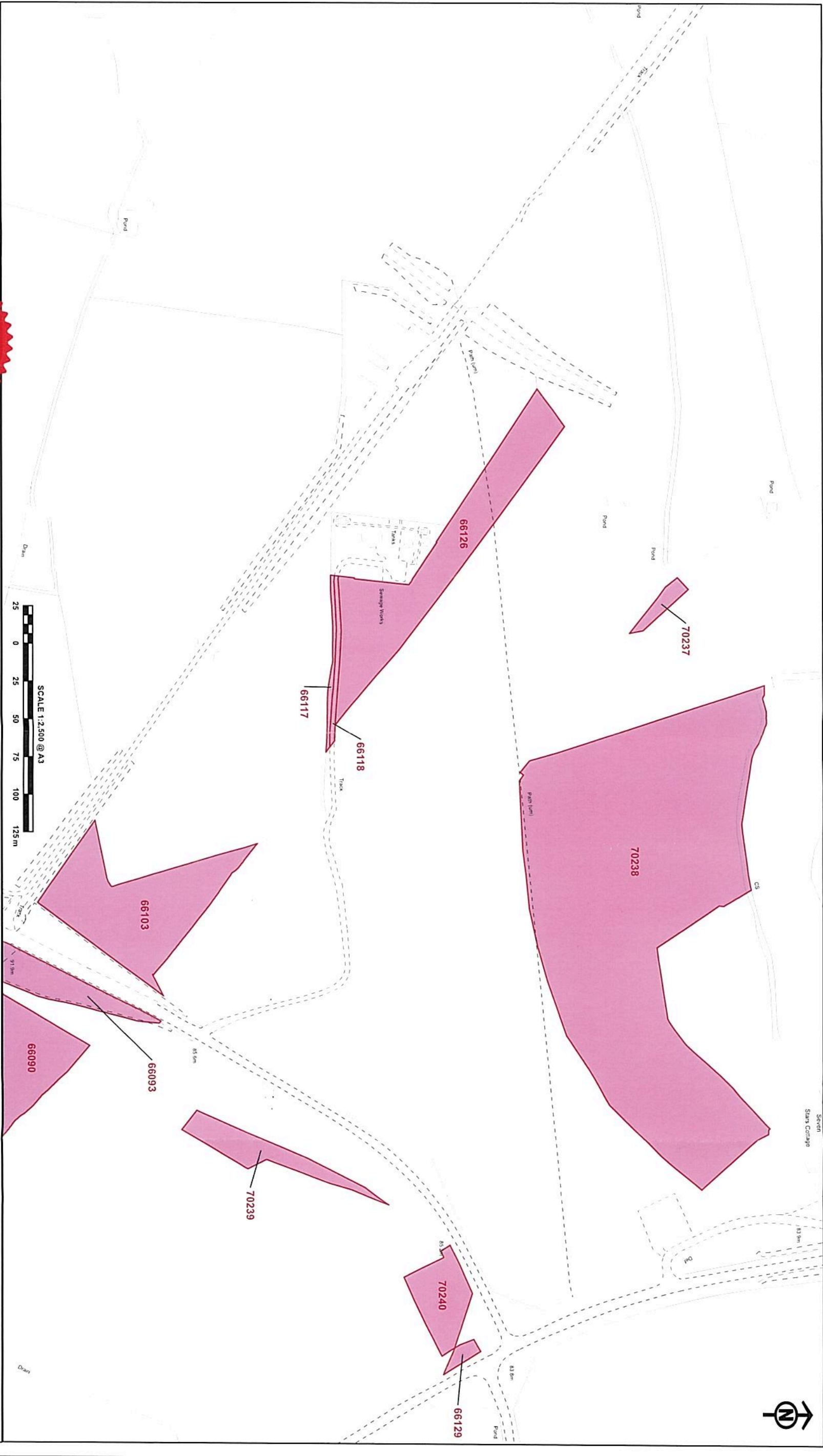

The CORPORATE SEAL of the
SECRETARY OF STATE
hereunto affixed to this deed
is authenticated by

Authorised by the Secretary of State for Transport

Dated 06 December 2021

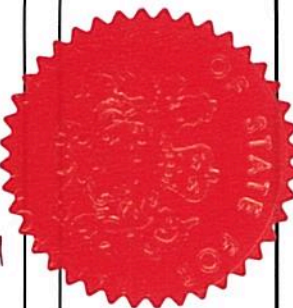

0925

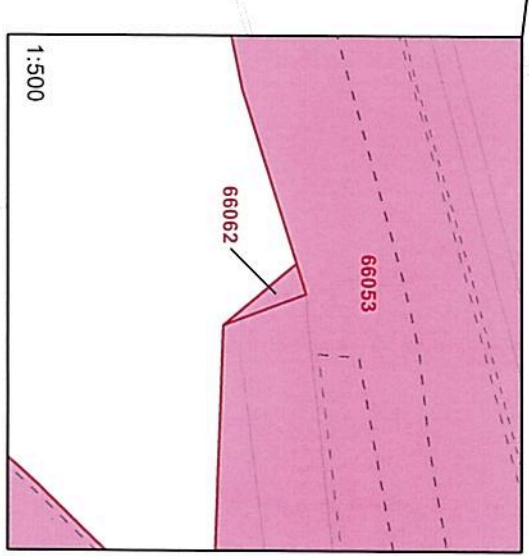
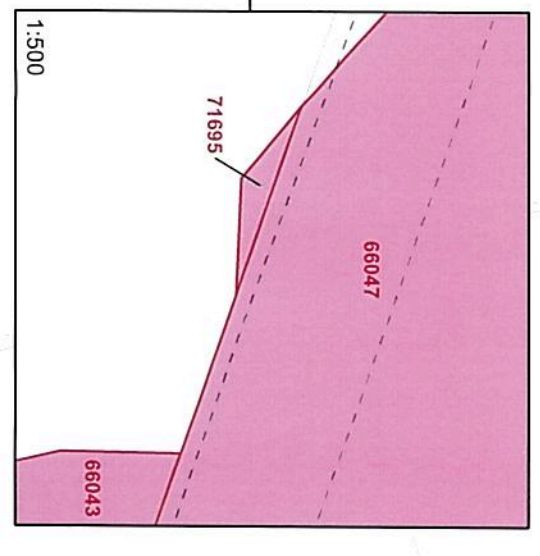
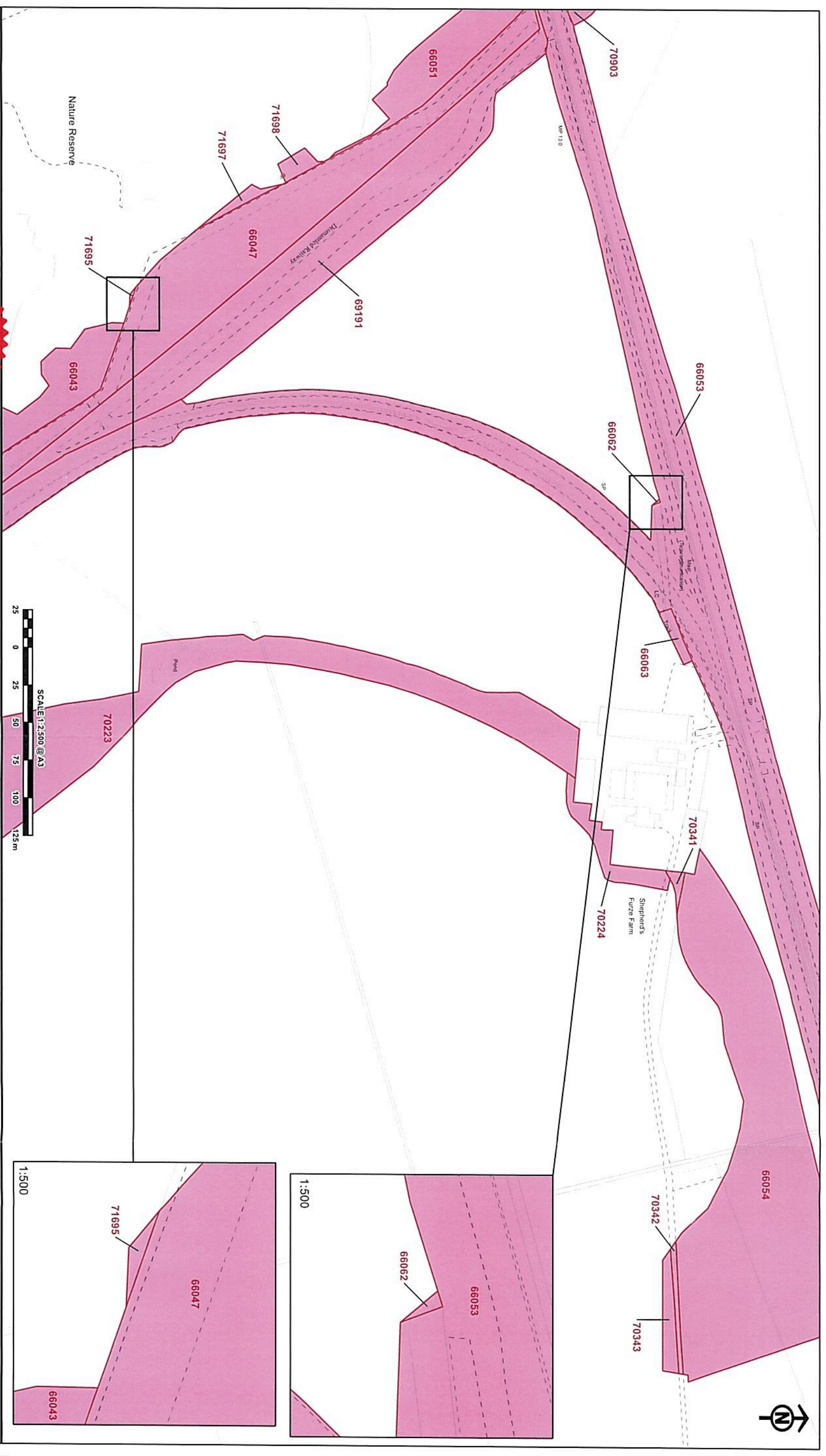

CENTRE POINT: 468 549, 225 502

The CORPORATE SEAL of the
SECRETARY OF STATE
hereunto affixed to this deed
is authenticated by

Authorised by the Secretary of State for Transport

Dated 06 DECEMBER 2021



0925

