

## Amended map of the proposed modifications

1. Revised map IOW 4a and table showing a modification to route sections IOW-4-S002 and IOW-4-S003. The modification is to move the main route of the trail to bypass an area of the path that has been lost to a landslide and follow a route that is less susceptible to erosion.
2. Revised map IOW 4a also shows a modification to include the area north of the route at IOW-4-S012 to IOW-4-S018 as additional landward margin (depicted in magenta wash). Revised attribute table also included.

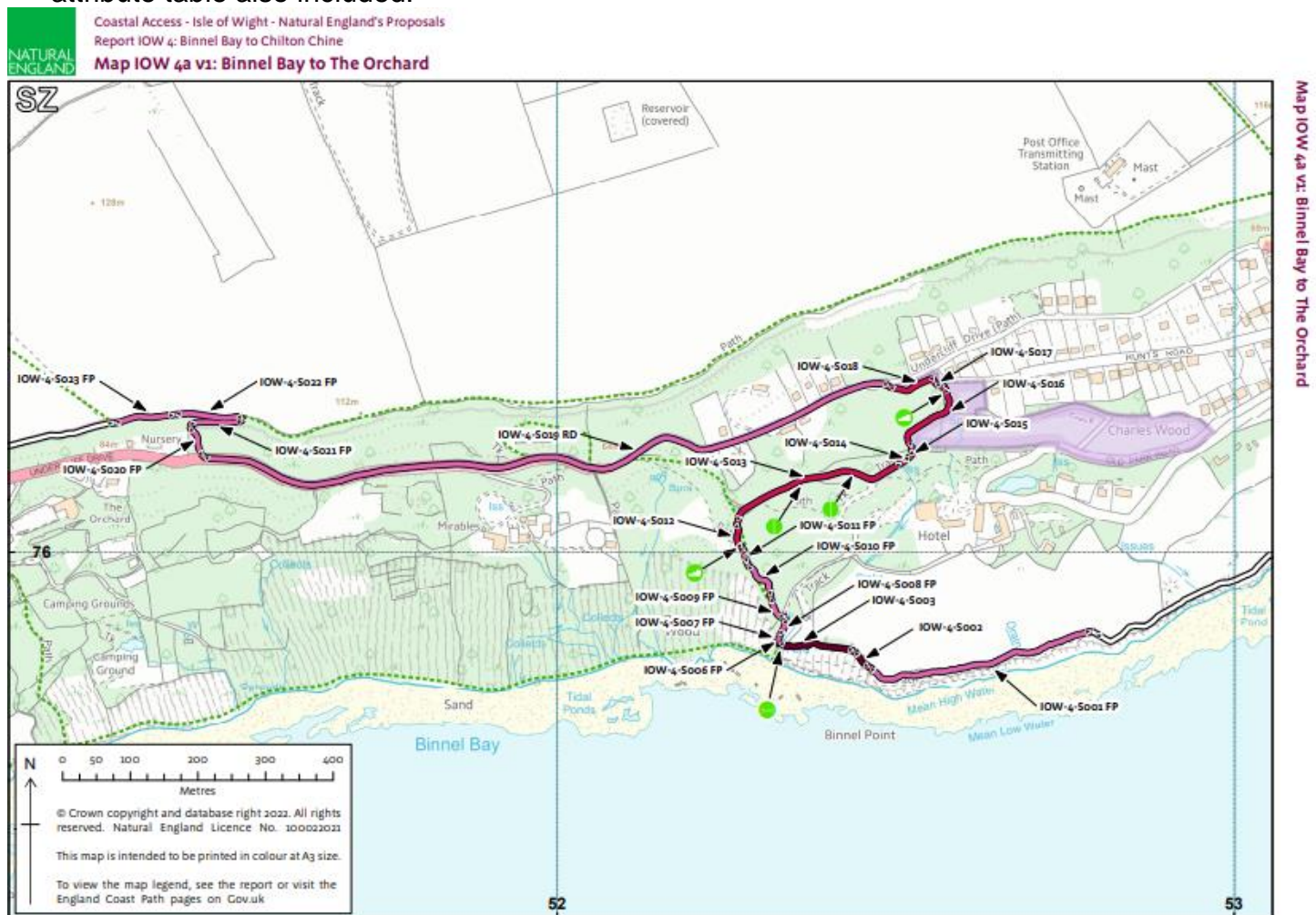

Modified route at IOW-4-S002 and IOW-4-S003.

1	2	3	4	5a	5b	5c	6
Map(s)	Route section number(s)	Current status of route section(s)	Roll-back proposed? (See Part 7 of Overview)	Landward margin contains coastal land type?	Proposal to specify landward boundary of margin (See maps)	Reason for landward boundary proposal	Explanatory notes
IOW 4a	IOW-4-S002	Not an existing walked route	Yes - See table 4.3.3	No	Fence line	Clarity and cohesion	
IOW 4a	IOW-4-S003	Not an existing walked route	Yes - See table 4.3.3	No	Other	Clarity and cohesion	Scrub-Dense scrub and trees at landward edge of path

Additional landward margin

1	2	3	4	5a	5b	5c	6
Map(s)	Route section number(s)	Current status of route section(s)	Roll-back proposed? (See Part 7 of Overview)	Landward margin contains coastal land type?	Proposal to specify landward boundary of margin (See maps)	Reason for landward boundary proposal	Explanatory notes
IOW 4a	IOW-4-S012 to IOW-4-S015*	Other existing walked route	Yes - See table 4.3.3	No			
IOW 4a	IOW-4-S016 to IOW-4-S018*	Other existing walked route	Yes - See table 4.3.3	No	Other	Additional landward area	Landward boundary is the landward edge of the Isle of Wight Council owned land

- Revised Map 5I and table showing modification to the route at IOW-5-S062. The modification is to move the main route of the trail to bypass an area of the path that has been lost to coastal erosion.

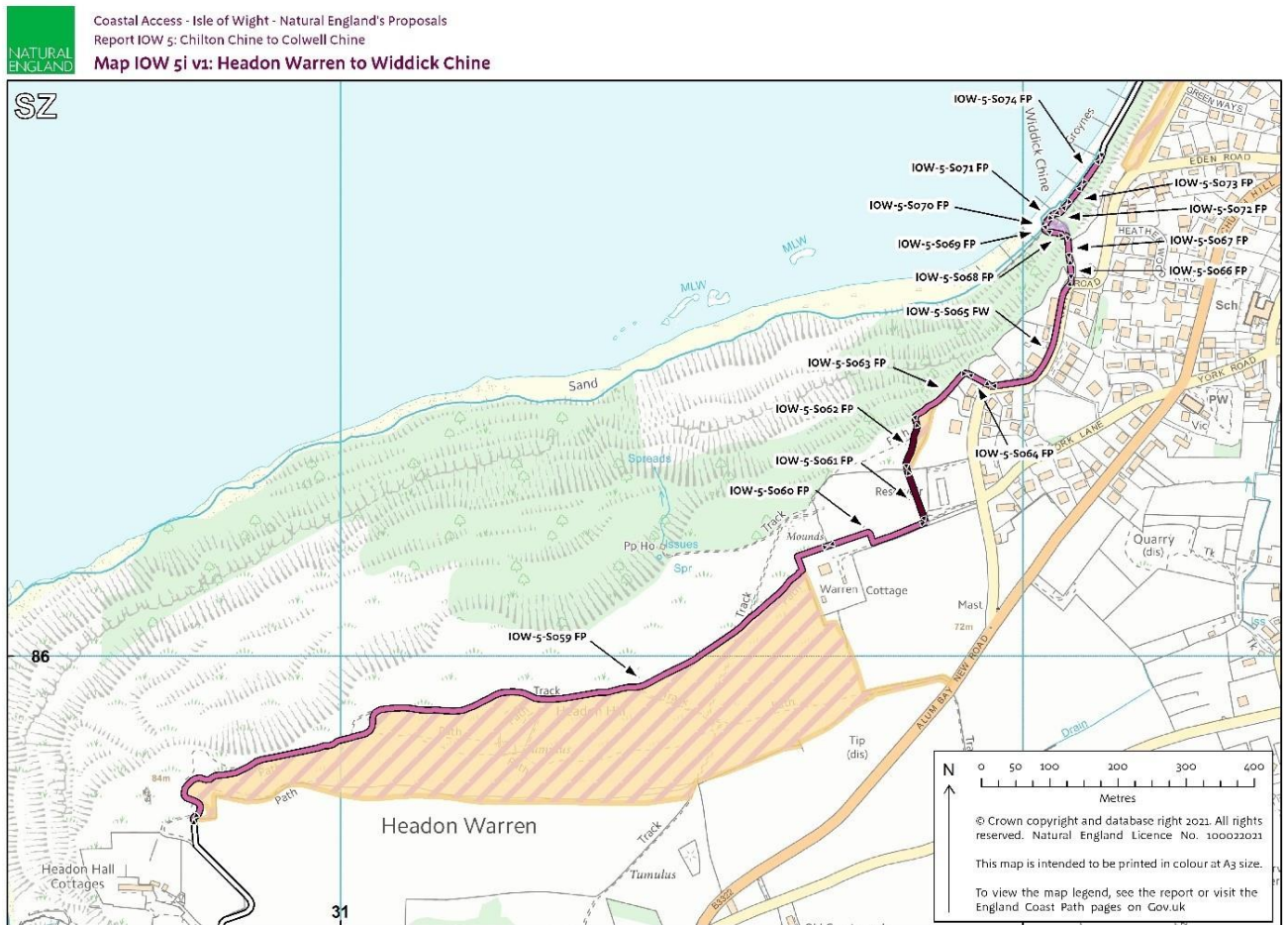

Modification to the route at IOW-5-S062

1	2	3	4	5a	5b	5c	6
Map(s)	Route section number(s)	Current status of route section(s)	Roll-back proposed? (See Part 7 of Overview)	Landward margin contains coastal land type?	Proposal to specify landward boundary of margin (See maps)	Reason for landward boundary proposal	Explanatory notes

IOW 5i	IOW-5-S060	Public footpath	Yes - See table 5.3.3	No	Fence line	Clarity and cohesion	
IOW 5i	IOW-5-S061	Not an existing walked route	Yes - See table 5.3.3	No			
IOW 5i	IOW-5-S062	Not an existing walked route	Yes - See table 5.3.3	No	Hedgerow	Clarity and cohesion	
IOW 5i	IOW-5-S063 & IOW-5-S064	Public footpath	Yes - See table 5.3.3	No			

4. Revised Map IOW 4h and table showing two modifications to the route at IOW-4-S087 to IOW-4-S088b. The first modification is to realign the junction of IOW-4-S087 and IOW-4-S088a 15 metres further back from the road to minimise use of a field gate which is used to contain livestock. The second modification is to realign IOW-4-S088b to a previously agreed route set out in the planning application agreement for the adjacent development at Atherfield Bay Holiday Camp.



Coastal Access - Isle of Wight - Natural England's Proposals  
Report IOW 4: Binnel Bay to Chilton Chine

**Map IOW 4h: Shepherd's Chine to Brightstone Bay**

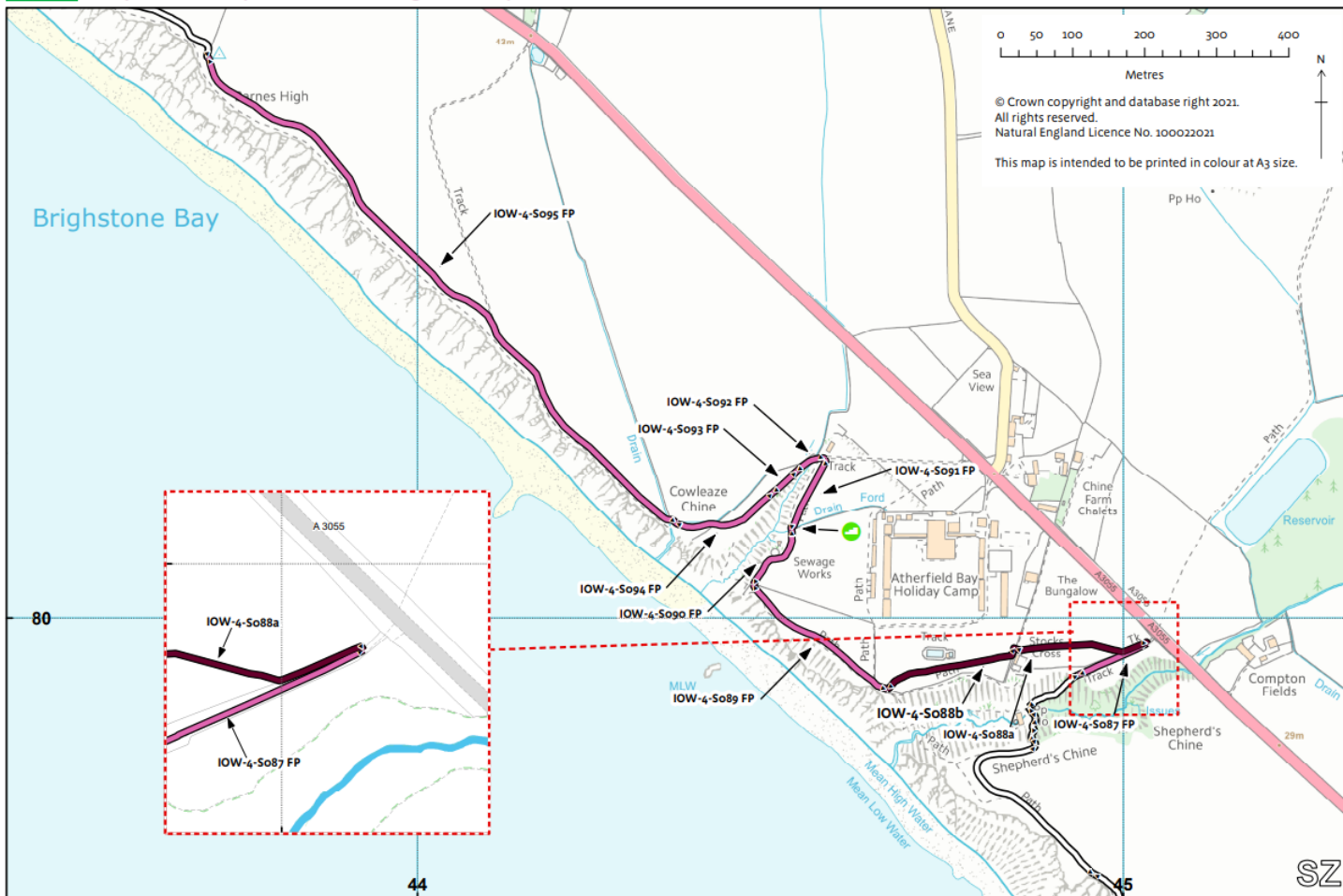

Map IOW 4h Shepherd's Chine to Brighstone Bay- IOW-4-SO87 to IOW-4-SO88

1	2	3	4	5a	5b	5c	6
<b>Map(s)</b>	<b>Route section number(s)</b>	<b>Current status of route section(s)</b>	<b>Roll-back proposed? (See Part 7 of Overview)</b>	<b>Landward margin contains coastal land type?</b>	<b>Proposal to specify landward boundary of margin (See maps)</b>	<b>Reason for landward boundary proposal</b>	<b>Explanatory notes</b>
<b>IOW 4h</b>	<b>IOW-4-S087*</b>	<b>Public footpath</b>	<b>Yes - See table 4.3.3</b>				
<b>IOW 4h</b>	<b>IOW-4-S088a*</b>	<b>Not an existing walked route</b>	<b>Yes - See table 4.3.3</b>	<b>No</b>	<b>Fence line</b>	<b>Clarity and cohesion</b>	
<b>IOW 4h</b>	<b>IOW-4-S088b*</b>	<b>Not an existing walked route</b>	<b>Yes - See table 4.3.3</b>				

\*NOTE: S088a and S088b will be dedicated as a PRow in the future as it is part of the planning application agreement

- Revised Map IOW 4j and table show a modification to the route at IOW-4-S110 to IOW-4-S113 as a result of further discussions with the landowners to realign the permissive path to the south of Brighstone Holiday Park as the original path had fallen into disrepair.

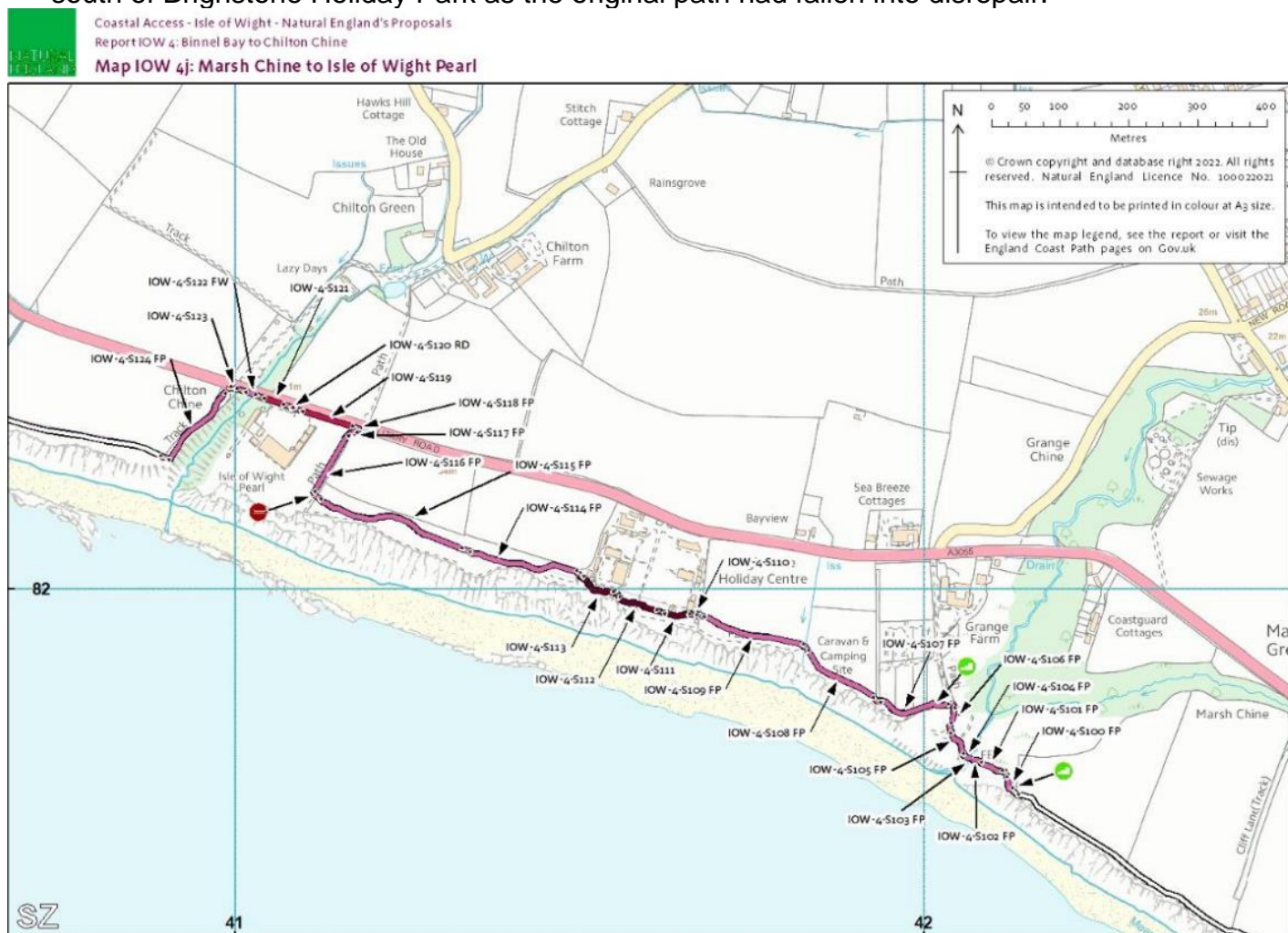

Map IOW 4j Marsh Chine to Isle of Wight Pearl- IOW-4-S109 to IOW-4-S114

1	2	3	4	5a	5b	5c	6
Map(s)	Route section number(s)	Current status of route section(s)	Roll-back proposed? (See Part 7 of Overview)	Landward margin contains coastal land type?	Proposal to specify landward boundary of margin (See maps)	Reason for landward boundary proposal	Explanatory notes
IOW4j	IOW-4-S109	Public footpath	Yes- See table 4.3.3	No	Fence line	Clarity and cohesion	
IOW 4j	IOW-4-S110*	Not an existing walked route	Yes - See table 4.3.3	No	Fence line	Clarity and cohesion	
IOW 4j	IOW-4-S111*	Not an existing walked route	Yes - See table 4.3.3	No	Edge of path	Clarity and cohesion	
IOW 4j	IOW-4-S112*	Not an existing walked route	Yes - See table 4.3.3	No	Fence line	Clarity and cohesion	
IOW 4j	IOW-4-S113*	Not an existing walked route	Yes - See table 4.3.3	No	Edge of path	Clarity and cohesion	
IOW 4j	IOW-4-S114*	Public footpath	Yes - See table 4.3.3	No			



6. Revised Map IOW 4d and table showing modification to the route IOW-4-S048 through to IOW-4-S060. This modification is to realign the route so that users don't pass through the Blackgang overflow car park which can become busy during certain points of the year.



Coastal Access - Isle of Wight - Natural England's Proposals  
 Report IOW 4: Binnel Bay to Chilton Chine  
**Map IOW 4d: Gore Cliff to The Seater**



Map IOW 4d: Gore Cliff to The Seater

Map IOW 4d Gore Cliff to The Saeter- IOW-4-S058 to IOW-4-S059

1	2	3	4	5a	5b	5c	6
Map(s)	Route section number(s)	Current status of route section(s)	Roll-back proposed? (See Part 7 of Overview)	Landward margin contains coastal land type?	Proposal to specify landward boundary of margin (See maps)	Reason for landward boundary proposal	Explanatory notes
IOW 4d	IOW-4-S058*	Public footpath	Yes- See table 4.3.3	No	Hedgerow	Clarity and cohesion	
IOW 4d	IOW-4-S059a*	Other existing walked route	Yes - See table 4.3.3	No	Hedgerow	Clarity and cohesion	
IOW 4d	IOW-4-S059b*	Other existing walked route	Yes - See table 4.3.3	No	Edge of verge	Clarity and cohesion	

- Revised Map IOW 5C and table showing modification to the route IOW-5-S010 to realign the path through the National Trust car park. This is due to the path seaward of the car park being subject to coastal erosion.

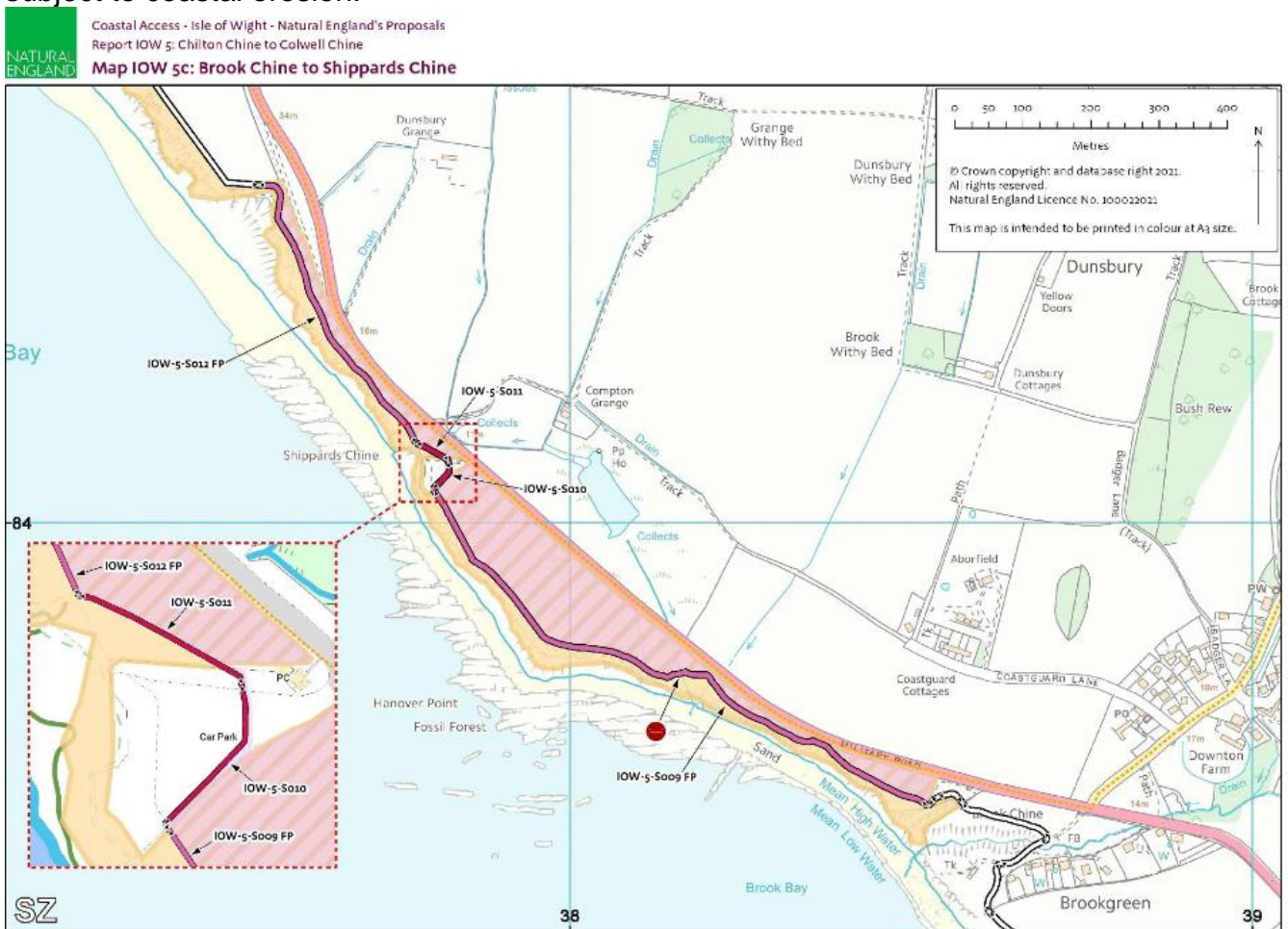

Map IOW 5c Brook Chine to Shippards Chine- IOW-5-SO10 to IOW-5-SO11

1	2	3	4	5a	5b	5c	6
Map(s)	Route section number(s)	Current status of route section(s)	Roll-back proposed? (See Part 7 of Overview)	Landward margin contains coastal land type?	Proposal to specify landward boundary of margin (See maps)	Reason for landward boundary proposal	Explanatory notes
IOW 5c	IOW-5-S010	Other existing walked route	Yes - See table 5.3.3	No			
IOW 5c	IOW-5-S011	Other existing walked route	Yes - See table 5.3.3	No	Other	Additional landward area	Landward boundary is the edge of the CRoW open access land
IOW 5c	IOW-5-S012	Public footpath	Yes - See table 5.3.3	No	Other	Additional landward area	Landward boundary is the edge of the CRoW open access land

8. Revised Maps IOW 5e and 5f along with tables show modification to the route at IOW-5-S030 to realign the path along an existing walked route due to the original proposed path becoming unwalkable due to coastal erosion. Modification is also shown to the landward margin IOW-5-S035 where the land north of the route is now depicted as Countryside Rights of Way open access land and is now shown as additional landward margin after agreement between Natural England and the landowner

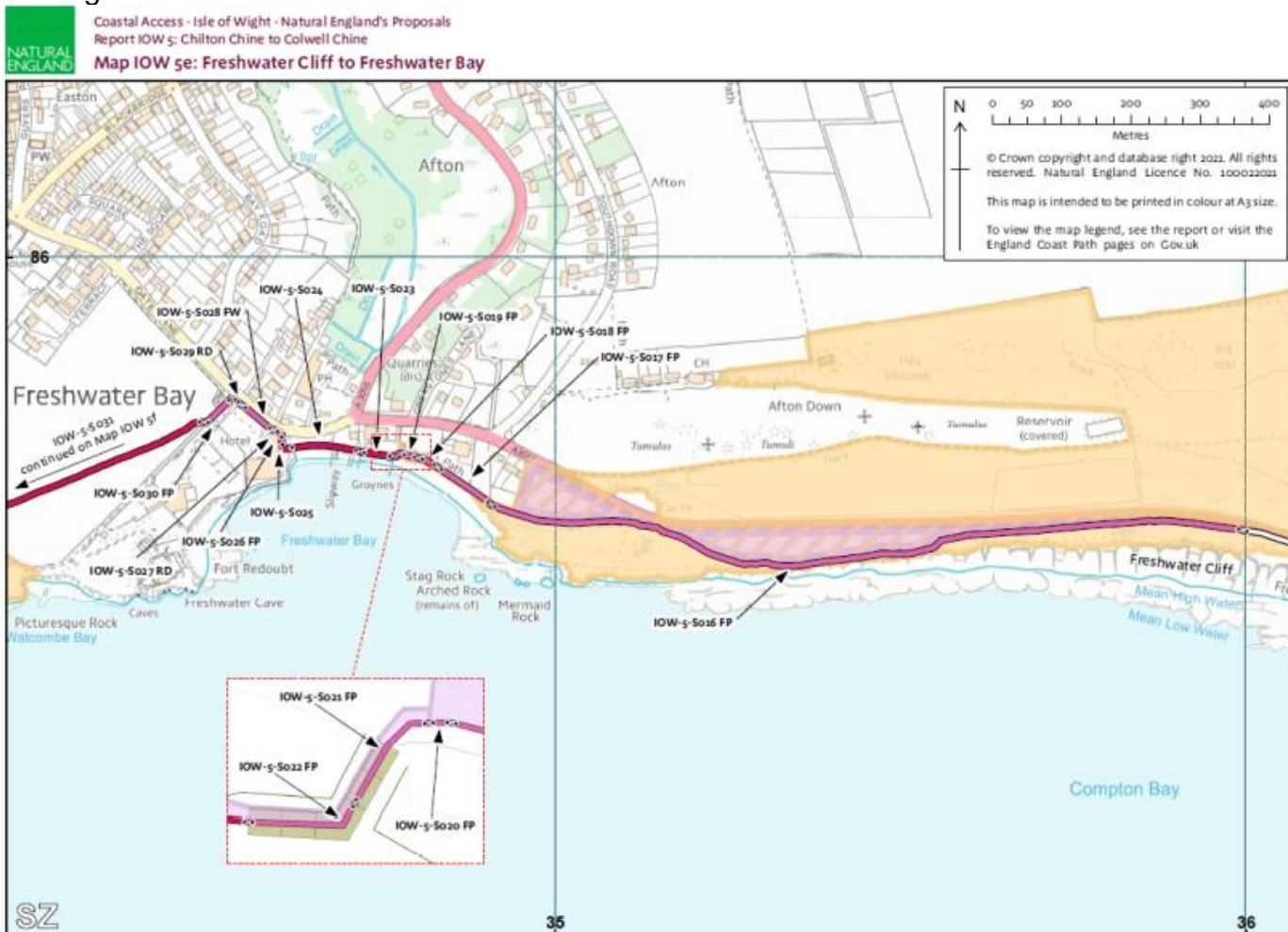

Map IOW 5f: Freshwater Bay to Tennyson Down

