

# Notice of variation and consolidation with introductory note

**The Environmental Permitting (England & Wales) Regulations 2016**

---

Cranswick Convenience Foods Limited  
Sutton Fields Convenience Food Production  
71-72 Helsinki Road  
Sutton Fields Industrial Estate  
Kingston upon Hull  
HU7 0YW

**Variation application number**

EPR/KP3733AN/V004

**Permit number**

EPR/KP3733AN

# Sutton Fields Convenience Food Production

## Permit number EPR/KP3733AN

### Introductory note

#### **This introductory note does not form a part of the notice**

Under the Environmental Permitting (England & Wales) Regulations 2016 (schedule 5, part 1, paragraph 19) a variation may comprise a consolidated permit reflecting the variations and a notice specifying the variations included in that consolidated permit.

Schedule 1 of the notice specifies the conditions that have been varied and schedule 2 comprises a consolidated permit which reflects the variations being made. Only the variations specified in schedule 1 are subject to a right of appeal.

The schedules specify the changes made to the permit.

#### **Changes introduced by this variation (V004):**

- Addition of a new cooked chicken product processing line with a finished production capacity of 160 tonnes per day.
- Addition of a new 3.6MWth natural gas fired boiler, subject to the requirements of MCPD.
- Addition of a new 2.9MWth natural gas fired thermal oil heating plant, subject to the requirements of MCPD.
- Associated changes to existing building and infrastructure - including drainage systems, additional storage tanks and refrigeration plant.
- An increase in the discharge to sewer from S3, subject to a Trade Effluent Consent from Yorkshire Water Services.
- An update to the listed activity, at the request of the Operator, to reflect a change to the Regulations and provide a more apt description of the permitted activities, based on the raw materials processed.

#### **The main features of the Installation:**

Sutton Fields Convenience Food Production is a processing and packaging plant, producing ready to eat, convenience food products. The facility is located on the Sutton Fields Industrial Estate which lies approximately 3km north of the city of Hull.

The site produces around 91,000 tonnes of cooked, chilled and processed products per year.

The main operations on site are the receipt of raw fresh and frozen meat (such as pork, beef and chicken), processing by mincing, slicing, mixing and blending with other ingredients (such as coatings, marinades, herbs and spices), and cooking (by hot oil/steam oven, grilling, and/or frying), to produce packaged meat products for human consumption.

Raw materials are brought onto site and unloaded into a refrigerated goods area where they are checked for quality, temperature, and quantity. The raw materials are then stored in chilled storage prior to being processed.

Cooking takes place on site in steam ovens and frying lines. The food processing machinery used includes blenders, tumblers, mincers, conveyors, cookers, slicers and packing machines. Once cooked, in order to extend the shelf life, meat products are packed into modified atmosphere packaging. Despatch of the finished product is undertaken from the despatch area using refrigerated transport to various regional distribution centres.

The key emission points arise from steam/hot water boilers and heaters, thermal oil heater, ovens, and fryers.

Cooking is undertaken using steam ovens/grills (1.4MWth), hot oil heated fryers (3 x 0.605MWth) and a hot oil/steam oven (0.9MWth), all fired on natural gas.

Heat, hot water and steam used in the process are also generated by 2 x 1.3 MWth and 1 x 3.6 MWth boilers, 3 x 0.250 MWth hot water heaters and 1 x 2.9 MWth thermal oil heating plant, all fired on natural gas.

The site is based on hard standing with an enclosed drainage system that runs to an interceptor before discharge to sewer. Frequent cleaning of the process machinery and building fabric is undertaken using food grade chemicals.

Water is used to clean down the facility and the resulting effluent runs to an enclosed drainage system, which has catch pots to capture any solids not removed by the dry-cleaning processes.

Effluent produced during the process mainly comes from the wash down and cleaning of processing areas, this results in only light meat contamination. Effluent is discharged to sewer in accordance with the terms of a trade effluent discharge consent with Yorkshire Water.

The status log of a permit sets out the permitting history, including any changes to the permit reference number.

<b>Status log of the permit</b>		
<b>Description</b>	<b>Date</b>	<b>Comments</b>
Application EPR/KP3733AN/A001	Duly made 23/03/15	Application for a Food & Drink Installation.
Additional Information	22/04/15	Confirmation of boiler/heater sizes
Permit determined EPR/KP3733AN	11/06/15	Permit issued to Cranswick Convenience Foods Limited
Notified of change of Registered office	13/08/19	Registered office changed to Crane Court, Hesslewood Office Park, Ferriby Road, Hessle, HU13 0PA
Variation issued EPR/KP3733AN	29/08/19	Varied permit issued to Cranswick Convenience Foods Limited
Application EPR/KP3733AN/V004 (variation and consolidation)	Duly made 20/07/20	Application to vary and consolidate (not modernised)
Additional information	27/07/20	Site condition report
Additional information	04/08/20 and 17/08/20	Combustion plant information.
Variation determined EPR/KP3733AN	23/09/20	Varied permit issued
Application for a variation EPR/KP3733AN/V004	Duly made 03/11/21	Application for a variation to add a new chicken process line, combustion plant, refrigeration plant and other associated changes to on-site infrastructure.
Variation determined EPR/KP3733AN [Billing ref: DP3702LZ]	11/01/22	Varied and consolidated permit issued.

End of introductory note

# Notice of variation and consolidation

## The Environmental Permitting (England and Wales) Regulations 2016

The Environment Agency in exercise of its powers under regulation 20 of the Environmental Permitting (England and Wales) Regulations 2016 varies

### Permit number

EPR/KP3733AN

### Issued to

**Cranswick Convenience Foods Limited** (“the operator”)

whose registered office is

**Crane Court  
Hesslewood Office Park  
Ferriby Road  
Hessle  
HU13 0PA**

company registration number **02239912**

to operate a regulated facility at

**Sutton Fields Convenience Food Production  
71-72 Helsinki Road  
Sutton Fields Industrial Estate  
Kingston upon Hull  
HU7 0YW**

to the extent set out in the schedules.

The notice shall take effect from 11/01/2022

Name	Date
Philip Lamb	11/01/2022

Authorised on behalf of the Environment Agency

## **Schedule 1**

The following conditions have been varied by consolidated permit reference EPR/KP3733AN/V004, as a result of the application made by the operator:

- Condition 3.1.4 has been added to reflect the requirements under the Medium Combustion Plant Directive.
- Conditions 3.5.2, 3.5.3 and 3.5.4 have been added to reflect the requirement for calibration, certification etc., and means of access to monitoring points.
- Table S1.1, as referenced in condition 2.1.1, has been amended to reflect the more apt listed activity reference, with production capacity (AR1), and addition of new combustion plant (AR6).
- Table S1.2, as reference in conditions 2.3.1 and 2.3.2, has been updated to reflect the operating techniques for this variation.
- Table S1.3, as referenced in condition 2.4.1, has been updated to reflect the improvement programme requirements for this variation.
- Table S3.1, as referenced in conditions 3.1.1, 3.5.1 and 3.5.4, has been updated to reflect the addition of new air emission points (A7 – A24).
- Table S4.1, as referenced in condition 4.2.3, has been updated to reflect the requirement for reporting of emissions monitoring from A7 & A8.
- Table S4.4, as referenced in conditions 4.2.2 and 4.2.3, has been updated to reflect new reporting form for emissions to air.
- The interpretation in Schedule 6, as referenced in condition 4.4.1, has been updated.
- The site plan in Schedule 7, as referenced in condition 2.2.1, has been updated.

## **Schedule 2 – consolidated permit**

Consolidated permit issued as a separate document.

# Permit

## The Environmental Permitting (England and Wales) Regulations 2016

### Permit number

**EPR/KP3733AN**

This is the consolidated permit referred to in the variation and consolidation notice for application EPR/KP3733AN/V004 authorising,

**Cranswick Convenience Foods Limited** (“the operator”),

whose registered office is

**Crane Court  
Hesslewood Office Park  
Ferriby Road  
Hessle  
HU13 0PA**

company registration number **02239912**

to operate an installation at

**Sutton Fields Convenience Food Production  
71-72 Helsinki Road  
Sutton Fields Industrial Estate  
Kingston upon Hull  
HU7 0YW**

to the extent authorised by and subject to the conditions of this permit.

Name	Date
Philip Lamb	11/01/2022

Authorised on behalf of the Environment Agency

# Conditions

## 1 Management

### 1.1 General management

- 1.1.1 The operator shall manage and operate the activities:
- (a) in accordance with a written management system that identifies and minimises risks of pollution, including those arising from operations, maintenance, accidents, incidents, non-conformances, closure and those drawn to the attention of the operator as a result of complaints; and
  - (b) using sufficient competent persons and resources.
- 1.1.2 Records demonstrating compliance with condition 1.1.1 shall be maintained.
- 1.1.3 Any person having duties that are or may be affected by the matters set out in this permit shall have convenient access to a copy of it kept at or near the place where those duties are carried out.

### 1.2 Energy efficiency

- 1.2.1 The operator shall:
- (a) take appropriate measures to ensure that energy is used efficiently in the activities;
  - (b) review and record at least every four years whether there are suitable opportunities to improve the energy efficiency of the activities; and
  - (c) take any further appropriate measures identified by a review.

### 1.3 Efficient use of raw materials

- 1.3.1 The operator shall:
- (a) take appropriate measures to ensure that raw materials and water are used efficiently in the activities;
  - (b) maintain records of raw materials and water used in the activities;
  - (c) review and record at least every four years whether there are suitable alternative materials that could reduce environmental impact or opportunities to improve the efficiency of raw material and water use; and
  - (d) take any further appropriate measures identified by a review.

### 1.4 Avoidance, recovery and disposal of wastes produced by the activities

- 1.4.1 The operator shall take appropriate measures to ensure that:
- (a) the waste hierarchy referred to in Article 4 of the Waste Framework Directive is applied to the generation of waste by the activities; and
  - (b) any waste generated by the activities is treated in accordance with the waste hierarchy referred to in Article 4 of the Waste Framework Directive; and
  - (c) where disposal is necessary, this is undertaken in a manner which minimises its impact on the environment.
- 1.4.2 The operator shall review and record at least every four years whether changes to those measures should be made and take any further appropriate measures identified by a review.

## **2 Operations**

### **2.1 Permitted activities**

2.1.1 The operator is only authorised to carry out the activities specified in schedule 1 table S1.1 (the “activities”).

### **2.2 The site**

2.2.1 The activities shall not extend beyond the site, being the land shown edged in green on the site plan at schedule 7 to this permit.

### **2.3 Operating techniques**

2.3.1 The activities shall, subject to the conditions of this permit, be operated using the techniques and in the manner described in the documentation specified in schedule 1, table S1.2, unless otherwise agreed in writing by the Environment Agency.

2.3.2 If notified by the Environment Agency that the activities are giving rise to pollution, the operator shall submit to the Environment Agency for approval within the period specified, a revision of any plan or other documentation (“plan”) specified in schedule 1, table S1.2 or otherwise required under this permit which identifies and minimises the risks of pollution relevant to that plan, and shall implement the approved revised plan in place of the original from the date of approval, unless otherwise agreed in writing by the Environment Agency.

2.3.3 Any raw materials or fuels listed in schedule 2 table S2.1 shall conform to the specifications set out in that table.

2.3.4 The operator shall ensure that where waste produced by the activities is sent to a relevant waste operation, that operation is provided with the following information, prior to the receipt of the waste:

- (a) the nature of the process producing the waste;
- (b) the composition of the waste;
- (c) the handling requirements of the waste;
- (d) the hazardous property associated with the waste, if applicable; and
- (e) the waste code of the waste.

### **2.4 Improvement programme**

2.4.1 The operator shall complete the improvements specified in schedule 1 table S1.3 by the date specified in that table unless otherwise agreed in writing by the Environment Agency.

2.4.2 Except in the case of an improvement which consists only of a submission to the Environment Agency, the operator shall notify the Environment Agency within 14 days of completion of each improvement.

## **3 Emissions and monitoring**

### **3.1 Emissions to water, air or land**

3.1.1 There shall be no point source emissions to water, air or land except from the sources and emission points listed in schedule 3 tables S3.1 and S3.2.

3.1.2 The limits given in schedule 3 shall not be exceeded.



- 3.1.3 Periodic monitoring shall be carried out at least once every 5 years for groundwater and 10 years for soil, unless such monitoring is based on a systematic appraisal of the risk of contamination.
- 3.1.4 For the operation of the new boilers (emission points A7 & A8); the first monitoring measurements shall be carried out within four months of permit issue, or of the date when the MCP is first put into operation, whichever is later.

## **3.2 Emissions of substances not controlled by emission limits**

- 3.2.1 Emissions of substances not controlled by emission limits (excluding odour) shall not cause pollution. The operator shall not be taken to have breached this condition if appropriate measures, including, but not limited to, those specified in any approved emissions management plan, have been taken to prevent or where that is not practicable, to minimise, those emissions.
- 3.2.2 The operator shall:
- (a) if notified by the Environment Agency that the activities are giving rise to pollution, submit to the Environment Agency for approval within the period specified, an emissions management plan which identifies and minimises the risks of pollution from emissions of substances not controlled by emission limits;
  - (b) implement the approved emissions management plan, from the date of approval, unless otherwise agreed in writing by the Environment Agency.
- 3.2.3 All liquids in containers, whose emission to water or land could cause pollution, shall be provided with secondary containment, unless the operator has used other appropriate measures to prevent or where that is not practicable, to minimise, leakage and spillage from the primary container.

## **3.3 Odour**

- 3.3.1 Emissions from the activities shall be free from odour at levels likely to cause pollution outside the site, as perceived by an authorised officer of the Environment Agency, unless the operator has used appropriate measures, including, but not limited to, those specified in any approved odour management plan, to prevent or where that is not practicable to minimise the odour.
- 3.3.2 The operator shall:
- (a) if notified by the Environment Agency that the activities are giving rise to pollution outside the site due to odour, submit to the Environment Agency for approval within the period specified, an odour management plan which identifies and minimises the risks of pollution from odour;
  - (b) implement the approved odour management plan, from the date of approval, unless otherwise agreed in writing by the Environment Agency.

## **3.4 Noise and vibration**

- 3.4.1 Emissions from the activities shall be free from noise and vibration at levels likely to cause pollution outside the site, as perceived by an authorised officer of the Environment Agency, unless the operator has used appropriate measures, including, but not limited to, those specified in any approved noise and vibration management plan to prevent or where that is not practicable to minimise the noise and vibration.
- 3.4.2 The operator shall:
- (a) if notified by the Environment Agency that the activities are giving rise to pollution outside the site due to noise and vibration, submit to the Environment Agency for approval within the period specified, a noise and vibration management plan which identifies and minimises the risks of pollution from noise and vibration;
  - (b) implement the approved noise and vibration management plan, from the date of approval, unless otherwise agreed in writing by the Environment Agency.

## **3.5 Monitoring**

- 3.5.1 The operator shall, unless otherwise agreed in writing by the Environment Agency, undertake the monitoring specified in the following tables in schedule 3 to this permit:
- (a) point source emissions specified in tables S3.1 and S3.2.
- 3.5.2 The operator shall maintain records of all monitoring required by this permit including records of the taking and analysis of samples, instrument measurements (periodic and continual), calibrations, examinations, tests and surveys and any assessment or evaluation made on the basis of such data.
- 3.5.3 Monitoring equipment, techniques, personnel and organisations employed for the emissions monitoring programme and the environmental or other monitoring specified in condition 3.5.1 shall have either MCERTS certification or MCERTS accreditation (as appropriate), where available, unless otherwise agreed in writing by the Environment Agency.
- 3.5.4 Permanent means of access shall be provided to enable sampling/monitoring to be carried out in relation to the emission points specified in schedule 3 tables S3.1 and S3.2 unless otherwise agreed in writing by the Environment Agency.

## **3.6 Pests**

- 3.6.1 The activities shall not give rise to the presence of pests which are likely to cause pollution, hazard or annoyance outside the boundary of the site. The operator shall not be taken to have breached this condition if appropriate measures, including, but not limited to, those specified in any approved pests management plan, have been taken to prevent or where that is not practicable, to minimise the presence of pests on the site.
- 3.6.2 The operator shall:
- (a) if notified by the Environment Agency, submit to the Environment Agency for approval within the period specified, a pests management plan which identifies and minimises risks of pollution from pests;
  - (b) implement the pests management plan, from the date of approval, unless otherwise agreed in writing by the Environment Agency.

# **4 Information**

## **4.1 Records**

- 4.1.1 All records required to be made by this permit shall:
- (a) be legible;
  - (b) be made as soon as reasonably practicable;
  - (c) if amended, be amended in such a way that the original and any subsequent amendments remain legible, or are capable of retrieval; and
  - (d) be retained, unless otherwise agreed in writing by the Environment Agency, for at least 6 years from the date when the records were made, or in the case of the following records until permit surrender:
    - (i) off-site environmental effects; and
    - (ii) matters which affect the condition of the land and groundwater.
- 4.1.2 The operator shall keep on site all records, plans and the management system required to be maintained by this permit, unless otherwise agreed in writing by the Environment Agency.

## 4.2 Reporting

- 4.2.1 The operator shall send all reports and notifications required by the permit to the Environment Agency using the contact details supplied in writing by the Environment Agency.
- 4.2.2 A report or reports on the performance of the activities over the previous year shall be submitted to the Environment Agency by 31 January (or other date agreed in writing by the Environment Agency) each year. The report(s) shall include as a minimum:
- (a) a review of the results of the monitoring and assessment carried out in accordance with the permit including an interpretive review of that data;
  - (b) the annual production /treatment data set out in schedule 4 table S4.2; and
  - (c) the performance parameters set out in schedule 4 table S4.3 using the forms specified in table S4.4 of that schedule.
- 4.2.3 Within 28 days of the end of the reporting period the operator shall, unless otherwise agreed in writing by the Environment Agency, submit reports of the monitoring and assessment carried out in accordance with the conditions of this permit, as follows:
- (a) in respect of the parameters and emission points specified in schedule 4 table S4.1;
  - (b) for the reporting periods specified in schedule 4 table S4.1 and using the forms specified in schedule 4 table S4.4; and
  - (c) giving the information from such results and assessments as may be required by the forms specified in those tables.
- 4.2.4 The operator shall, unless notice under this condition has been served within the preceding four years, submit to the Environment Agency, within six months of receipt of a written notice, a report assessing whether there are other appropriate measures that could be taken to prevent, or where that is not practicable, to minimise pollution.

## 4.3 Notifications

- 4.3.1 In the event:
- (a) that the operation of the activities gives rise to an incident or accident which significantly affects or may significantly affect the environment, the operator must immediately—
    - (i) inform the Environment Agency,
    - (ii) take the measures necessary to limit the environmental consequences of such an incident or accident, and
    - (iii) take the measures necessary to prevent further possible incidents or accidents;
  - (b) of a breach of any permit condition the operator must immediately—
    - (i) inform the Environment Agency, and
    - (ii) take the measures necessary to ensure that compliance is restored within the shortest possible time;
  - (c) of a breach of permit condition which poses an immediate danger to human health or threatens to cause an immediate significant adverse effect on the environment, the operator must immediately suspend the operation of the activities or the relevant part of it until compliance with the permit conditions has been restored.
- 4.3.2 Any information provided under condition 4.3.1 shall be confirmed by sending the information listed in schedule 5 to this permit within the time period specified in that schedule.
- 4.3.3 The Environment Agency shall be notified within 14 days of the occurrence of the following matters, except where such disclosure is prohibited by Stock Exchange rules:

Where the operator is a registered company:

- (a) any change in the operator's trading name, registered name or registered office address; and
- (b) any steps taken with a view to the operator going into administration, entering into a company voluntary arrangement or being wound up.

Where the operator is a corporate body other than a registered company:

- (c) any change in the operator's name or address; and
- (d) any steps taken with a view to the dissolution of the operator.

In any other case:

- (e) the death of any of the named operators (where the operator consists of more than one named individual);
- (f) any change in the operator's name(s) or address(es); and
- (g) any steps taken with a view to the operator, or any one of them, going into bankruptcy, entering into a composition or arrangement with creditors, or, in the case of them being in a partnership, dissolving the partnership.

4.3.4 Where the operator proposes to make a change in the nature or functioning, or an extension of the activities, which may have consequences for the environment and the change is not otherwise the subject of an application for approval under the Regulations or this permit:

- (a) the Environment Agency shall be notified at least 14 days before making the change; and
- (b) the notification shall contain a description of the proposed change in operation.

4.3.5 The Environment Agency shall be given at least 14 days notice before implementation of any part of the site closure plan.

4.3.6 Where the operator has entered into a climate change agreement with the Government, the Environment Agency shall be notified within one month of:

- (a) a decision by the Secretary of State not to re-certify the agreement;
- (b) a decision by either the operator or the Secretary of State to terminate the agreement; and
- (c) any subsequent decision by the Secretary of State to re-certify such an agreement.

## **4.4 Interpretation**

4.4.1 In this permit the expressions listed in schedule 6 shall have the meaning given in that schedule.

4.4.2 In this permit references to reports and notifications mean written reports and notifications, except where reference is made to notification being made "immediately", in which case it may be provided by telephone.

# Schedule 1 – Operations

Table S1.1 Activities			
Activity reference	Activity listed in Schedule 1 of the EP Regulations	Description of specified activity	Limits of specified activity
AR1	<p><b>Section 6.8 Part A(1)(d)(iii)</b>  <i>Treatment and processing of animal and vegetable raw materials, intended for the production of food or feed, both in combined and separate products, with a finished product production capacity greater than</i>  <i>(aa) 75 tonnes per day, as A is equal to 10 or more; where 'A' is the proportion of animal material in percent of weight of the finished product production capacity.</i></p>	Treatment and processing of animal and vegetable raw materials, intended for the production of food or feed, both in combined and separate products, with a finished product production capacity greater than 75 tonnes per day.	<p>From receipt and storage of raw materials to despatch of finished packaged product.</p> <p>The total aggregated finished production capacity is 260 tonnes per day.</p>
<b>Directly Associated Activity</b>			
AR2	Storage and handling of waste materials	Handling, storage, transfer and dispatch of waste from the listed activities and directly associated activities	From the generation of waste to the offsite disposal of waste
AR3	Refrigeration Plant	Generation of refrigerant for activities such as chilling and refrigerated storage	From receipt of carcasses and other finished goods to despatch of finished goods from the Installation
AR4	Product packaging	Product packaging	From finished product creation to final despatch
AR5	Storage and handling of chemicals	Handling and storage of chemicals for cleaning, fuelling and equipment maintenance	--
AR6	Steam, heat, hot water and electrical power supply	<p>2 x 1.3 MWth and 1 x 3.6 MWth natural gas fired boilers</p> <p>3 x 0.250 MWth hot water heaters</p> <p>1 x 2.9 MWth natural gas fired thermal oil heating plant</p>	From receipt of fuels to emission of combustion gases

Table S1.2 Operating techniques		
Description	Parts	Date Received
Application EPR/KP3733AN/A001	Part B2 and B3 of the application and supporting documents.  Additional information received regarding environmental risk assessment, baseline data, emission points to sewer and air (Emails dated 10/02/2015).	Duly Made 23/03/2015
EPR/KP3733AN/A001 Additional information	Additional information received by email regarding boiler/heater sizes.	22/04/2015

<b>Table S1.2 Operating techniques</b>		
<b>Description</b>	<b>Parts</b>	<b>Date Received</b>
Application EPR/KP3733AN/V003	Sutton Fields BAT statement, BAT/SF – July 2020 Version 1	17/07/2020
Application EPR/KP3733AN/V004	All sections and supporting information of Section C2 and C3 including Environmental Risk Assessment, Operating Techniques, Energy Efficiency, Energy Use, and Waste Avoidance.	Duly made 03/11/2021

<b>Table S1.3 Improvement programme requirements</b>		
<b>Reference</b>	<b>Requirement</b>	<b>Date</b>
IC3 Odour management	<p>The Operator shall submit a written odour management plan to the Environment Agency for approval. The plan must contain the appropriate measures for odour control specified in H4 Odour Management - How to comply with your environmental permit, and must contain dates for the implementation of individual measures.</p> <p>This management plan shall also include the activities and process permitted by consolidation notice EPR/KP3733AN/V004.</p> <p>The notification requirements of condition 2.4.2 will be deemed to have been complied with on submission of the plan. The plan must be implemented as approved, and from the date stipulated by the Environment Agency.</p>	11/07/2022
IC4 Ozone depleting substances	<p>The Operator shall submit a written plan on achieving BAT 9, of the Best Available Techniques (BAT) Conclusions for the Food, Drink and Milk Industries, to the Environment Agency for approval.</p> <p>“BAT 9 - In order to prevent emissions of ozone-depleting substances and of substances with a high global warming potential from cooling and freezing, BAT is to use refrigerants without ozone depletion potential and with a low global warming potential.”</p> <p>The notification requirements of condition 2.4.2 will be deemed to have been complied with on submission of the plan. The plan must be implemented as approved, and from the date stipulated by the Environment Agency.</p>	Complete
IC5a Air emissions	<p>The Operator shall submit a H1 assessment for all point source emissions to air.</p> <p>This may be completed using monitored data or the manufacturer’s data for the plant.</p> <p>The notification requirements of condition 2.4.2 will be deemed to have been complied with on submission of the assessment.</p>	Complete
IC5b Air emissions	<p>If air emissions do not screen out in the H1 assessment (under IC5a) the operator shall submit detailed air emission modelling report and model input files to the Environment Agency for technical assessment.</p> <p>Where the air dispersion modelling determines impacts are significant the Operator must include proposals for appropriate measures to mitigate the impact of the emissions, including emission limits, monitoring frequencies and methods, and dates for implementation of individual measures.</p> <p>The notification requirements of condition 2.4.2 will be deemed to have been complied with on submission of the report.</p> <p>The Operator must implement the individual measures as agreed, and from the date stipulated by the Environment Agency.</p>	Complete

<b>Table S1.3 Improvement programme requirements</b>		
<b>Reference</b>	<b>Requirement</b>	<b>Date</b>
IC6 Site plan	The Operator shall submit a revised plan/drawing that clearly shows the locations of each of the point source emissions to air and sewer. The points shall be labelled as they are in this permit.	Complete
IC7	<p>The Operator shall undertake representative monitoring of the emission concentrations of VOCs from the fryer lines emissions points (A9 – A14 in Table S3.1).</p> <p>The results of the monitoring shall be used to undertake a Quantitative Risk Assessment (using H1 or a similar methodology) to assess the emission concentrations against any appropriate EAL/DNEL.</p> <p>The results of the assessment shall be submitted to the Environment Agency for review and approval in writing.</p>	Within 9 months of completion of full commissioning of the fryers.

## Schedule 2 – Waste types, raw materials and fuels

Table S2.1 Raw materials and fuels	
Raw materials and fuel description	Specification
--	--



## Schedule 3 – Emissions and monitoring

Table S3.1 Point source emissions to air – emission limits and monitoring requirements						
Emission point ref. & location on site plan in Schedule 7	Source	Parameter	Limit (including unit)	Reference period	Monitoring frequency	Monitoring standard or method
A3	Gas Boiler Stack (1.3 MWth)	Products of combustion	No limit set	--	--	--
A4	Gas Boiler Stack (1.3 MWth)	Products of combustion	No limit set	--	--	--
A5	Water heaters (x3 0.25 MWth)	Products of combustion	No limit set	--	--	--
A6	Oven outlet	Products of combustion	No limit set	--	--	--
A7	3.6 MWth boiler	Oxides of nitrogen (NO and NO <sub>2</sub> expressed as NO <sub>2</sub> )	100 mg/m <sup>3</sup>	Periodic	Every three years	EN 14792
		Carbon monoxide	No limit set	Periodic	Every three years	EN 15058
A8	2.9 MWth thermal oil heater	Oxides of nitrogen (NO and NO <sub>2</sub> expressed as NO <sub>2</sub> )	100 mg/m <sup>3</sup>	Periodic	Every three years	EN 14792
		Carbon monoxide	No limit set	Periodic	Every three years	EN 15058
A9 – A14	Fryer vents	No parameters set	No limit set	--	--	--
A15 – A17	Oven vents	No parameters set	No limit set	--	--	--
A18 – A24	Relief valves, safety vents and local exhaust ventilation	No parameters set	No limit set	--	--	--

<b>Table S3.2 Point source emissions to sewer, effluent treatment plant or other transfers off-site– emission limits and monitoring requirements</b>						
<b>Emission point ref. &amp; location on site plan in Schedule 7</b>	<b>Source</b>	<b>Parameter</b>	<b>Limit (incl. unit)</b>	<b>Reference Period</b>	<b>Monitoring frequency</b>	<b>Monitoring standard or method</b>
S1 (West discharge) – Emission to Yorkshire Water foul sewer	Process Effluent and site drainage	No parameters set	No limit set	--	--	--
S2 (East discharge) - Emission to Yorkshire Water foul sewer						
S3 (Aquarius discharge) - Emission to Yorkshire Water foul sewer						

## Schedule 4 – Reporting

Parameters, for which reports shall be made, in accordance with conditions of this permit, are listed below.

<b>Table S4.1 Reporting of monitoring data</b>			
<b>Parameter</b>	<b>Emission or monitoring point/reference</b>	<b>Reporting period</b>	<b>Period begins</b>
Point source emissions to air  Parameters as required by condition 3.5.1	A7 & A8	First monitoring undertaken in accordance with Condition 3.1.4 to be reported within 3 months, and then every 3 years thereafter.	From first monitoring requirements in accordance with Condition 3.1.4

<b>Table S4.2: Annual production/treatment</b>	
<b>Parameter</b>	<b>Units</b>
Total product	tonnes

<b>Table S4.3 Performance parameters</b>		
<b>Parameter</b>	<b>Frequency of assessment</b>	<b>Units</b>
Water usage	Annually	m <sup>3</sup> /tonne of product
Energy usage	Annually	MWh/tonne of product
Total raw material used	Annually	tonnes

<b>Table S4.4 Reporting forms</b>		
<b>Media/parameter</b>	<b>Reporting format</b>	<b>Date of form</b>
Point source emissions to air	Emissions to Air Reporting Form, or other form as agreed in writing by the Environment Agency	Version 1, 08/03/2021
Water usage	Form Water Usage 1 or other form as agreed in writing by the Environment Agency	--
Energy usage	Form Energy 1 or other form as agreed in writing by the Environment Agency	--
Other performance indicators	Form Performance 1 or other form as agreed in writing by the Environment Agency	--

# Schedule 5 – Notification

These pages outline the information that the operator must provide.

Units of measurement used in information supplied under Part A and B requirements shall be appropriate to the circumstances of the emission. Where appropriate, a comparison should be made of actual emissions and authorised emission limits.

If any information is considered commercially confidential, it should be separated from non-confidential information, supplied on a separate sheet and accompanied by an application for commercial confidentiality under the provisions of the EP Regulations.

## Part A

Permit Number	
Name of operator	
Location of Facility	
Time and date of the detection	

<b>(a) Notification requirements for any malfunction, breakdown or failure of equipment or techniques, accident, or emission of a substance not controlled by an emission limit which has caused, is causing or may cause significant pollution</b>	
<b>To be notified within 24 hours of detection</b>	
Date and time of the event	
Reference or description of the location of the event	
Description of where any release into the environment took place	
Substances(s) potentially released	
Best estimate of the quantity or rate of release of substances	
Measures taken, or intended to be taken, to stop any emission	
Description of the failure or accident.	

<b>(b) Notification requirements for the breach of a limit</b>	
<b>To be notified within 24 hours of detection unless otherwise specified below</b>	
Emission point reference/ source	
Parameter(s)	
Limit	
Measured value and uncertainty	
Date and time of monitoring	

<b>(b) Notification requirements for the breach of a limit</b>	
<b>To be notified within 24 hours of detection unless otherwise specified below</b>	
Measures taken, or intended to be taken, to stop the emission	

<b>Time periods for notification following detection of a breach of a limit</b>	
<b>Parameter</b>	<b>Notification period</b>

<b>(c) Notification requirements for the detection of any significant adverse environmental effect</b>	
<b>To be notified within 24 hours of detection</b>	
Description of where the effect on the environment was detected	
Substances(s) detected	
Concentrations of substances detected	
Date of monitoring/sampling	

## Part B – to be submitted as soon as practicable

Any more accurate information on the matters for notification under Part A.	
Measures taken, or intended to be taken, to prevent a recurrence of the incident	
Measures taken, or intended to be taken, to rectify, limit or prevent any pollution of the environment which has been or may be caused by the emission	
The dates of any unauthorised emissions from the facility in the preceding 24 months.	

Name*	
Post	
Signature	
Date	

\* authorised to sign on behalf of the operator

## Schedule 6 – Interpretation

“accident” means an accident that may result in pollution.

“application” means the application for this permit, together with any additional information supplied by the operator as part of the application and any response to a notice served under Schedule 5 to the EP Regulations.

“authorised officer” means any person authorised by the Environment Agency under section 108(1) of The Environment Act 1995 to exercise, in accordance with the terms of any such authorisation, any power specified in section 108(4) of that Act.

“Best Available Techniques (BAT) Conclusions for the Food, Drink and Milk Industries” means C/2019/7989 Commission Implementing Decision (EU) 2019/2013 of 12 November 2019 establishing best available techniques (BAT) conclusions for the food, drink and milk industries, under Directive 2010/75/EU of the European Parliament and of the Council.

“EP Regulations” means The Environmental Permitting (England and Wales) Regulations SI 2016 No.1154 and words and expressions used in this permit which are also used in the Regulations have the same meanings as in those Regulations.

“emissions of substances not controlled by emission limits” means emissions of substances to air, water or land from the activities, either from the emission points specified in schedule 3 or from other localised or diffuse sources, which are not controlled by an emission limit.

“groundwater” means all water, which is below the surface of the ground in the saturation zone and in direct contact with the ground or subsoil.

“Industrial Emissions Directive” means DIRECTIVE 2010/75/EU OF THE EUROPEAN PARLIAMENT AND OF THE COUNCIL of 24 November 2010 on industrial emissions

“MCERTS” means the Environment Agency’s Monitoring Certification Scheme.

“Medium Combustion Plant” or “MCP” means a combustion plant with a rated thermal input equal to or greater than 1 MW but less than 50 MW.

“Medium Combustion Plant Directive” or “MCPD” means Directive 2015/2193/EU of the European Parliament and of the Council on the limitation of emissions of certain pollutants into the air from medium combustion plants, as read in accordance with Schedule 1A to the Environmental Permitting (England and Wales) Regulations 2016.

“Pests” means Birds, Vermin and Insects.

“quarter” means a calendar year quarter commencing on 1 January, 1 April, 1 July or 1 October.

Where a minimum limit is set for any emission parameter, for example pH, reference to exceeding the limit shall mean that the parameter shall not be less than that limit.

Unless otherwise stated, any references in this permit to concentrations of substances in emissions into air means:

- in relation to emissions from combustion processes, the concentration in dry air at a temperature of 273K, at a pressure of 101.3 kPa and with an oxygen content of 3% dry for liquid and gaseous fuels, 6% dry for solid fuels; and/or
- in relation to emissions from non-combustion sources, the concentration at a temperature of 273K and at a pressure of 101.3 kPa, with no correction for water vapour content.

“year” means calendar year ending 31 December.

# Schedule 7 – Site plan

## Installation boundary

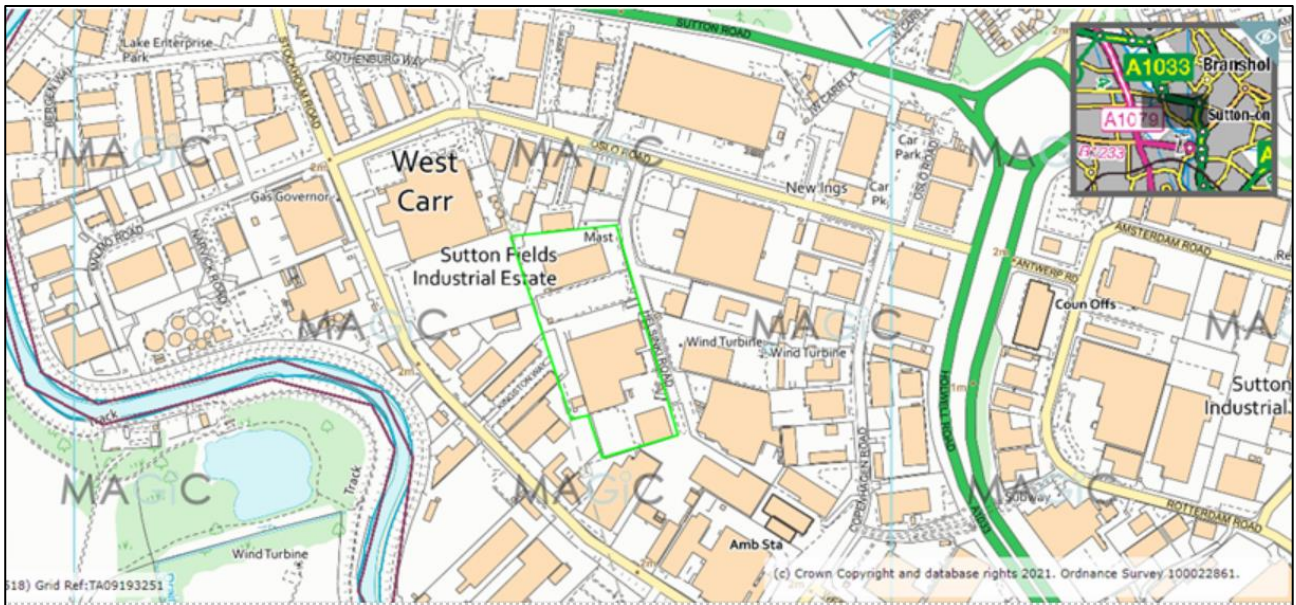

“©Crown Copyright. All rights reserved. Environment Agency, 100024198, 2021”.

# Emission points

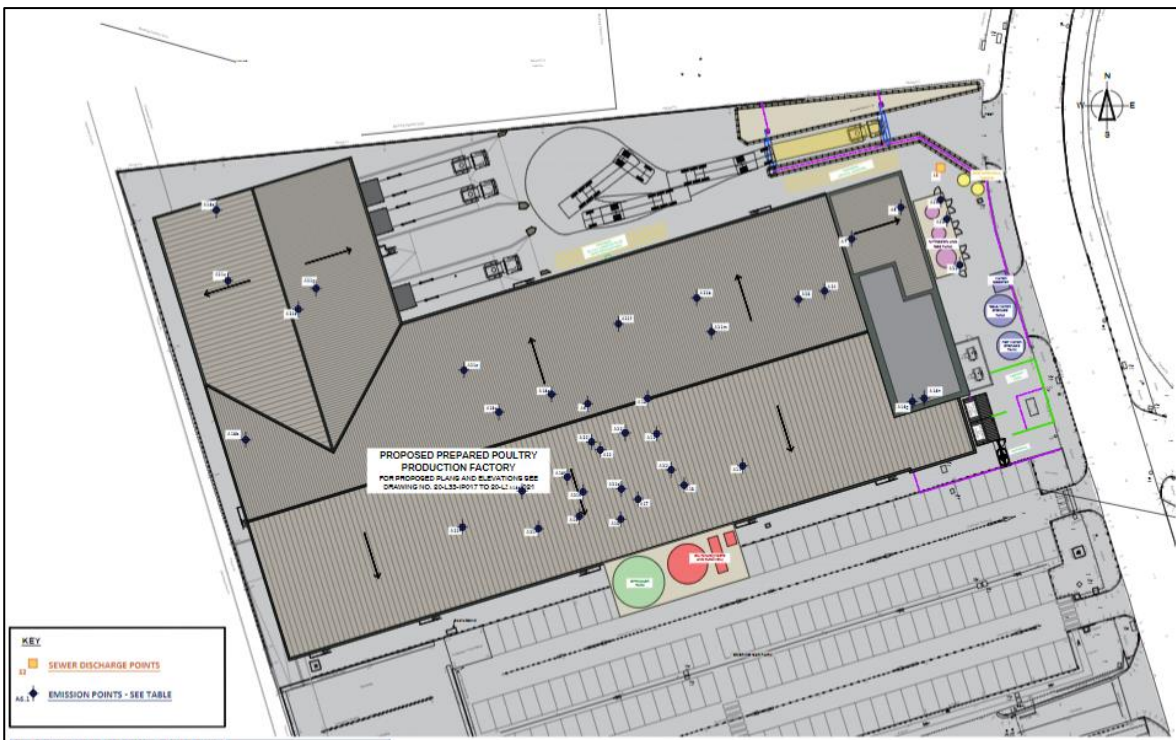
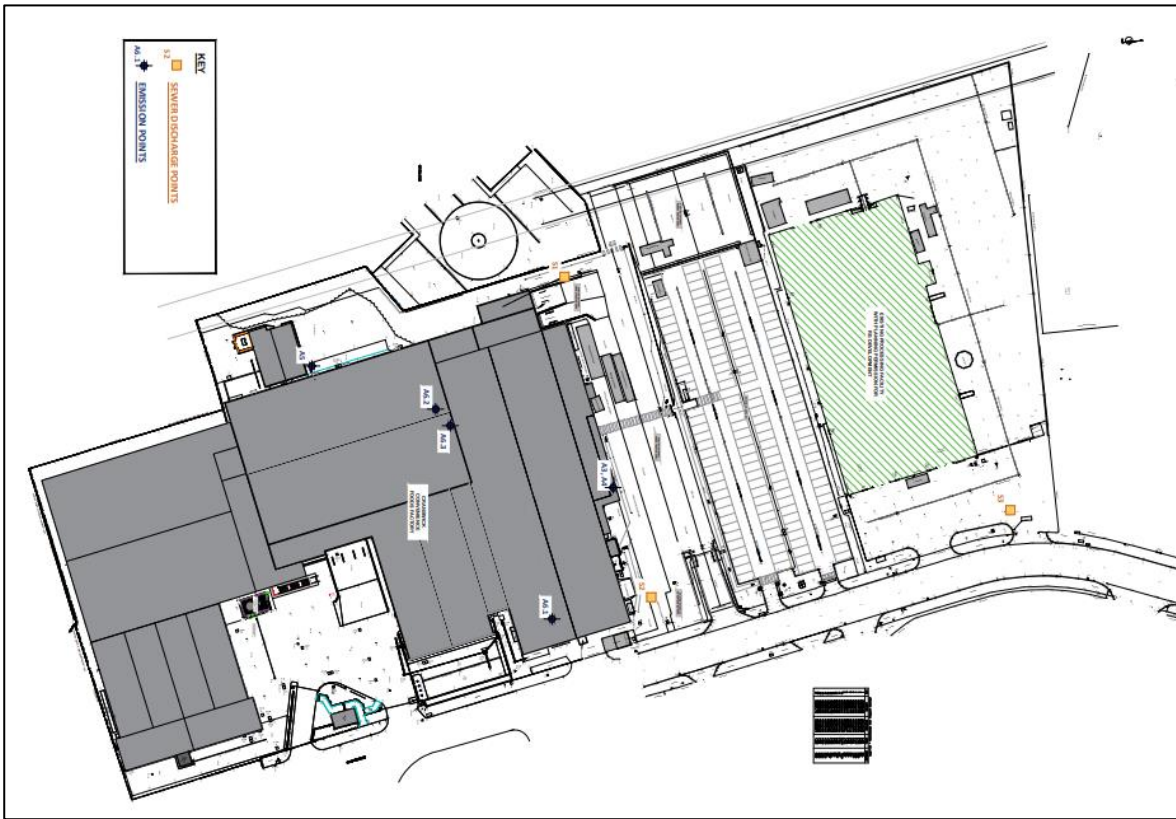

“Reproduced by permission of the operator”

END OF PERMIT



## Emissions to Air Reporting Form

**Permit number:** EPR/KP3733AN

**Operator:** Cranswick Convenience Foods Ltd

**Facility name:** Sutton Fields Convenience Food Production

**Emissions to Air Reporting Form: version 1, 08/03/2021**

Reporting of emissions to air for the period from [DD/MM/YY] to [DD/MM/YY]

Emission point	Substance / parameter	Emission Limit Value	Reference period	Test method <sup>1</sup>	Result <sup>2</sup>	Sample dates and times <sup>3</sup>	Uncertainty <sup>4</sup>
A7	Oxides of nitrogen (NO and NO <sub>2</sub> expressed as NO <sub>2</sub> )	100 mg/m <sup>3</sup>	Periodic				
A7	Carbon monoxide	No limit set	Periodic				
A8	Oxides of nitrogen (NO and NO <sub>2</sub> expressed as NO <sub>2</sub> )	100 mg/m <sup>3</sup>	Periodic				
A8	Carbon monoxide	No limit set	Periodic				

**Signed:** [Name]

**Date:** [DD/MM/YY]

(Authorised to sign as representative of the operator)

---

**Guidance for use:** Use this form to report your monitoring results.

Example text is shown in bracketed grey italics. Replace the example text by entering your own site specific information. Complete columns 1 to 5 using the information from schedule 3 of your permit. Complete columns 6 to 8 with your monitoring data. Add additional rows as necessary.

- <sup>1</sup> Where an internationally recognised standard test method is used, give the reference number. Where another method that has been formally agreed with the Environment Agency, give the appropriate identifier. In other cases state the principal technique, for example gas chromatography.
- <sup>2</sup> Give the result as the maximum value (or the minimum value in the case of a limit that is expressed as a minimum) obtained during the reporting period, expressed in the same terms as the emission limit value. Where the emission limit value is expressed as a range, give the result as the 'minimum to maximum' of the measured values.
- <sup>3</sup> For non-continuous measurements give the date and time of the sample that produced the result. For continuous measurements give the percentage of the process operating time covered by the result.
- <sup>4</sup> Complete if the uncertainty associated with the result is not a 95% confidence interval. Leave blank for 95% confidence intervals.