

## HIGH SPEED RAIL (LONDON – WEST MIDLANDS) ACT 2017

### HIGH SPEED RAIL (LONDON – WEST MIDLANDS) GENERAL VESTING DECLARATION No. 201

This **GENERAL VESTING DECLARATION** is executed on *2nd July 2019*  
by the Secretary of State for Transport ("the Authority").

#### WHEREAS:

- (1) On 23 February 2017 the High Speed Rail (London – West Midlands) Act 2017 ("the High Speed Rail Act") received Royal Assent authorising the Authority to acquire the land specified in the Schedule hereto.
- (2) Section 4(1) of the High Speed Rail Act authorises the Authority to acquire compulsorily so much of the land within the limits of the High Speed Rail Act as may be required for Phase One purposes<sup>1</sup>.
- (3) Section 4(4) of the High Speed Rail Act provides that the Compulsory Purchase (Vesting Declarations) Act 1981 ("the 1981 Act") applies as if the High Speed Rail Act were a compulsory purchase order and paragraph 3<sup>2</sup> of Schedule 6 to the High Speed Rail Act provides that the 1981 Act shall have effect subject to the modifications specified in that paragraph.
- (4) Notice pursuant to section 3A<sup>3</sup> of the 1981 Act was first published on 20 June 2019. That notice included the particulars specified in section 3A(3) of the 1981 Act.

**NOW THIS DEED WITNESSETH** that, in exercise of the powers conferred on it by section 4 of the 1981 Act, the Authority hereby declares:-

1. The land described in the Schedule hereto (being part of the land authorised to be acquired by the High Speed Rail Act) and more particularly delineated and shown coloured pink on the plan annexed hereto, together with the right to enter upon and take possession of the land, shall vest in the Authority as from the end of the period of 3 months from the date on which the service of notices required by section 6<sup>4</sup> of the 1981 Act is completed.

For the purposes of Section 2(2) of the 1981 Act, the specified period in relation to the land comprised in this declaration is one year and one day.

---

1 Phase One Purposes has meaning given by section 67 of the High Speed Rail Act

2 Paragraph 3 as substituted by section 11 of, and paragraph 6 of Schedule 14 to, the High Speed Rail Act.

3 Section 3A of the 1981 Act as inserted by paragraph 3(a) of Schedule 6 to the High Speed Rail Act as substituted by section 11 of, and paragraphs 6 and 7 of Schedule 14 to, that Act.

4 Section 6 as modified by paragraph 3(c) of Schedule 6 to the High Speed Rail Act, as substituted by section 11 of, and paragraph 6 of Schedule 14 to, that Act

## SCHEDULE

District of Stratford-on-Avon

<b>(1) Plot No</b>	<b>(2) Plot Description</b>
46597	All interests in 6.0 square metres, or thereabouts, of footbridge over watercourse (Lower Radbourne Farm)
46598	All interests in 313977.0 square metres, or thereabouts, of agricultural land, woodland, hedgerows, watercourses, access track, pond, public footpaths (SM95 and SM96) and public bridleway (SM96a) (Lower Radbourne Farm)
46600	All interests in 3757.4 square metres, or thereabouts, of agricultural land (Lower Radbourne Farm)
46601	All interests in 5296.2 square metres, or thereabouts, of access road (unnamed road off Welsh Road)
46603	All interests in 461.0 square metres, or thereabouts, of verge (unnamed road off Welsh Road)
49954	All interests in 332.3 square metres, or thereabouts, of access track and verge (Wills Pastures Road)

**IN WITNESS WHEREOF** the Secretary of State for Transport has hereunto set its corporate seal on the day in the year first written above.

The **CORPORATE SEAL** of the SECRETARY OF STATE FOR TRANSPORT hereunto affixed to this deed is authenticated by



Authorised Signatory

Dated: 2nd July 2019

SEAL REF NO.

DT/231





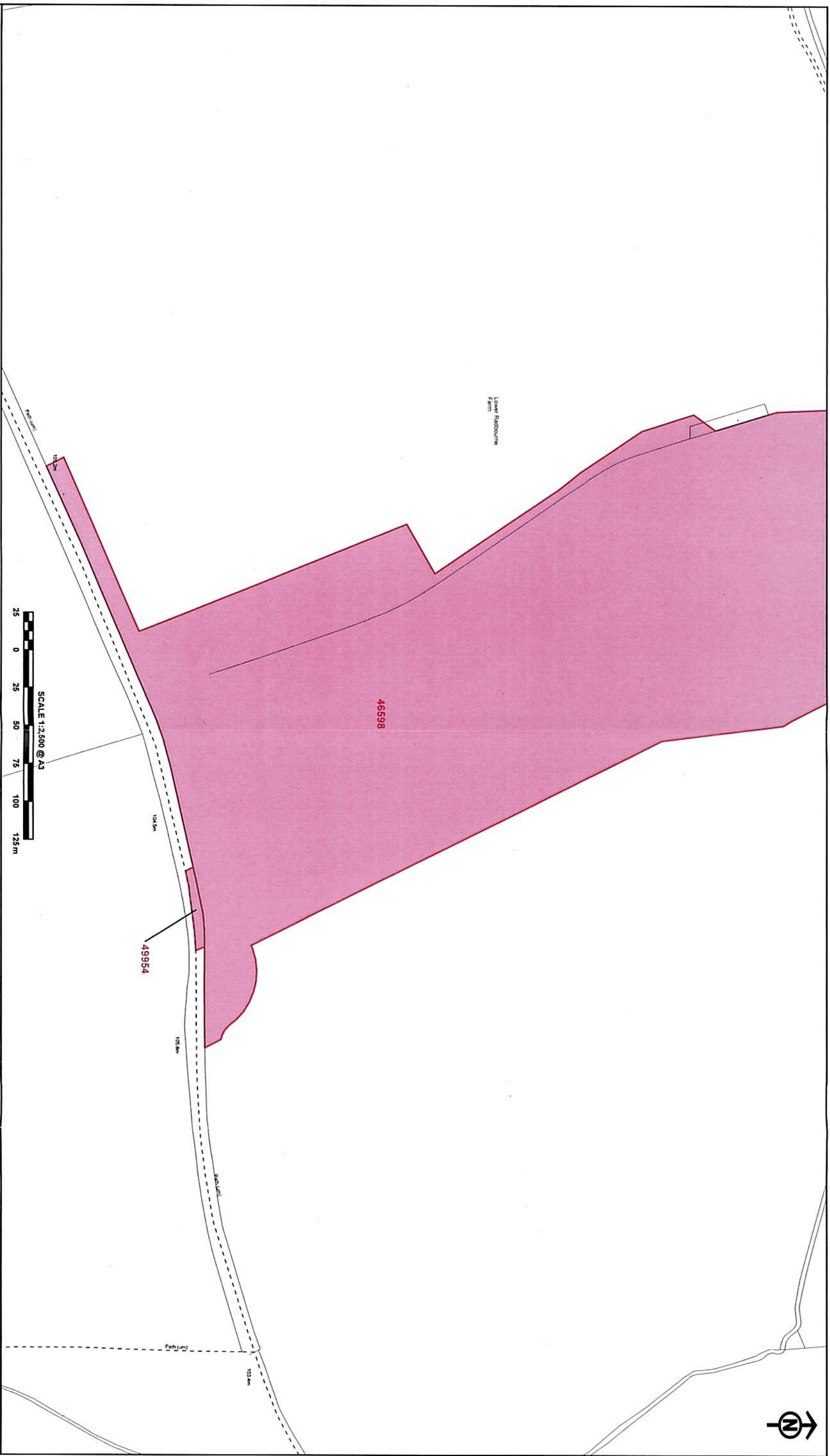

The CORPORATE SEAL of the  
SECRETARY OF STATE  
hereunto affixed to this deed  
is authenticated by

Authorised by the Secretary of State for Transport  
Dated 3rd July 2019

SEAL REF No:  
DT/1231



© Crown copyright and database right. 2018 Ordnance Survey Licence Number: 10004196.  
This Crown copyright material is reproduced with the permission of Land Registry under  
Assignment Authority from the Controller of HMSO and the Crown Copyright Commission.



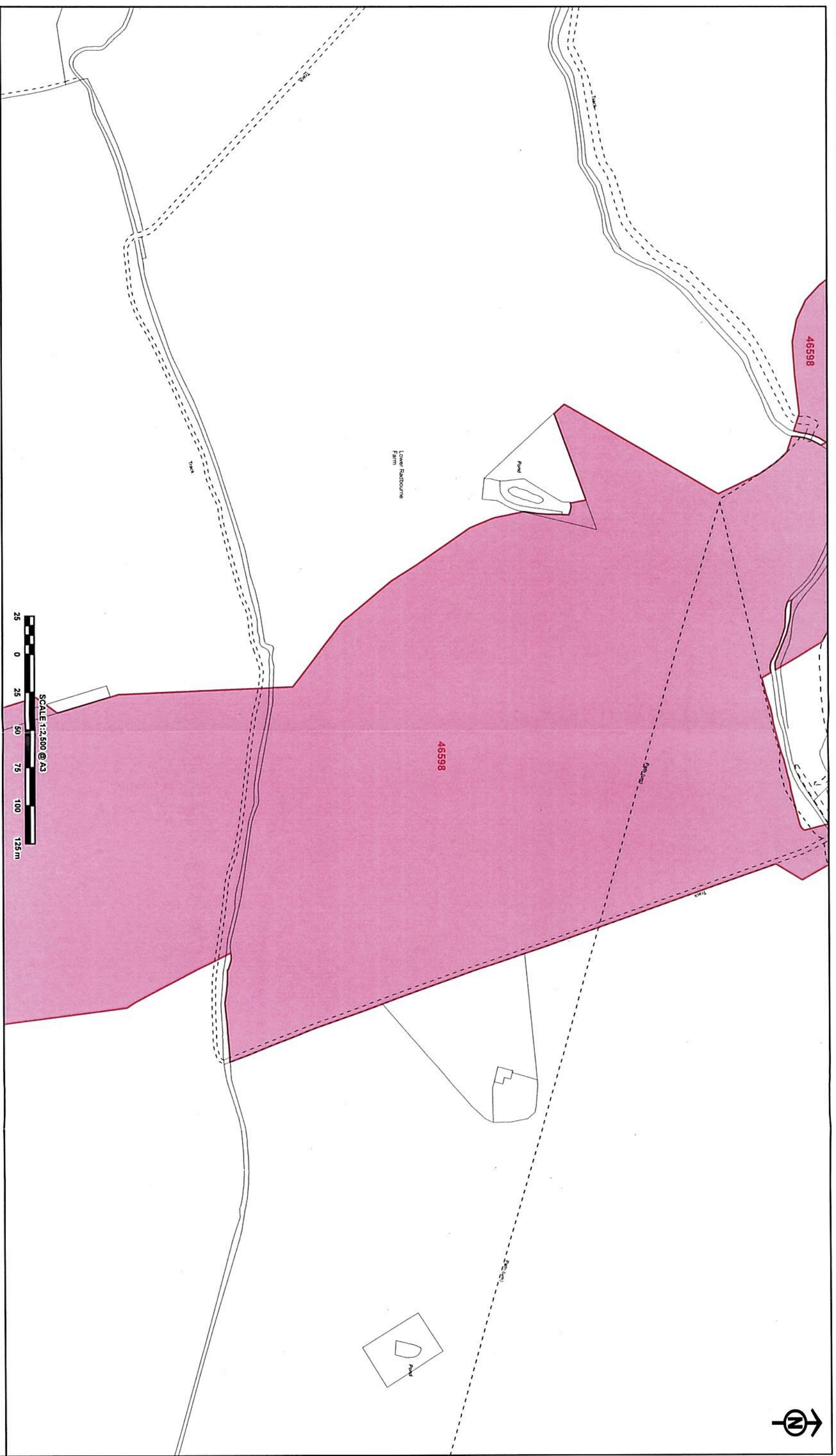

The CORPORATE SEAL of the  
SECRETARY OF STATE  
hereunto affixed to this deed  
is authenticated by

Authorised by the Secretary of State for Transport  
Dated 2nd July 2019

SEAL REF No

DT1/231







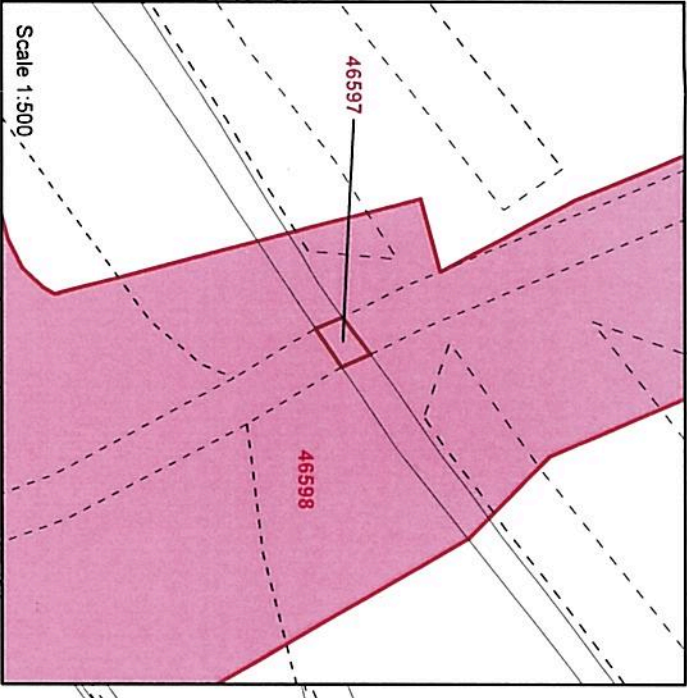
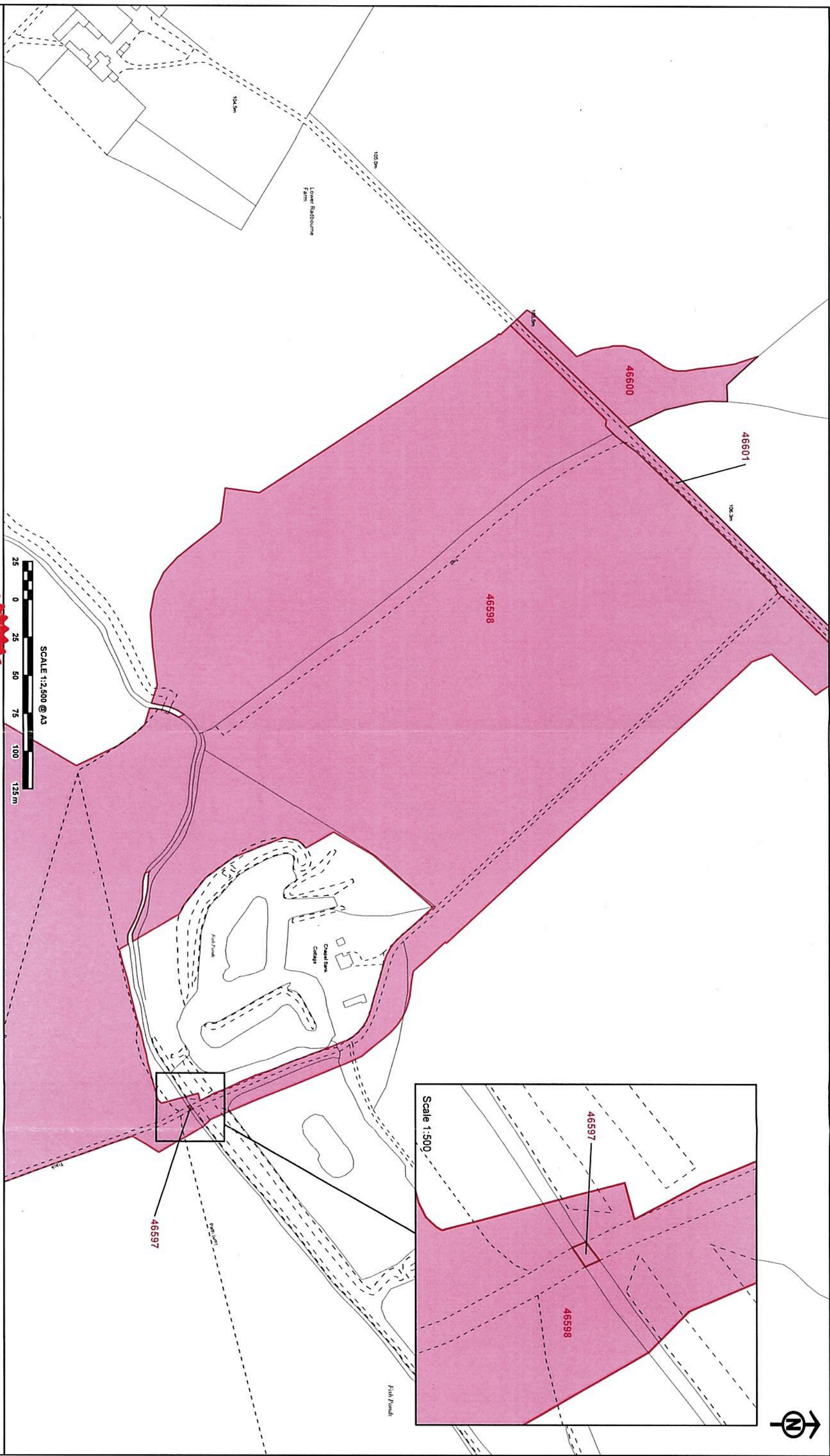

The CORPORATE SEAL of the  
SECRETARY OF STATE  
hereunto affixed to this deed  
is authenticated by

SEAL REF NO

Authorised by the Secretary of State for Transport  
Dated 2nd July 2019

DA11231

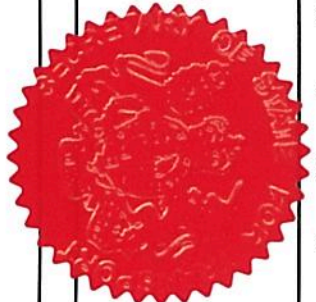

© Crown copyright and database right, 2018 Ordnance Survey, Licence Number: 100049196  
Reproduced by permission of the Controller of Her Majesty's Stationery Office under the Crown Copyright Collective Licence



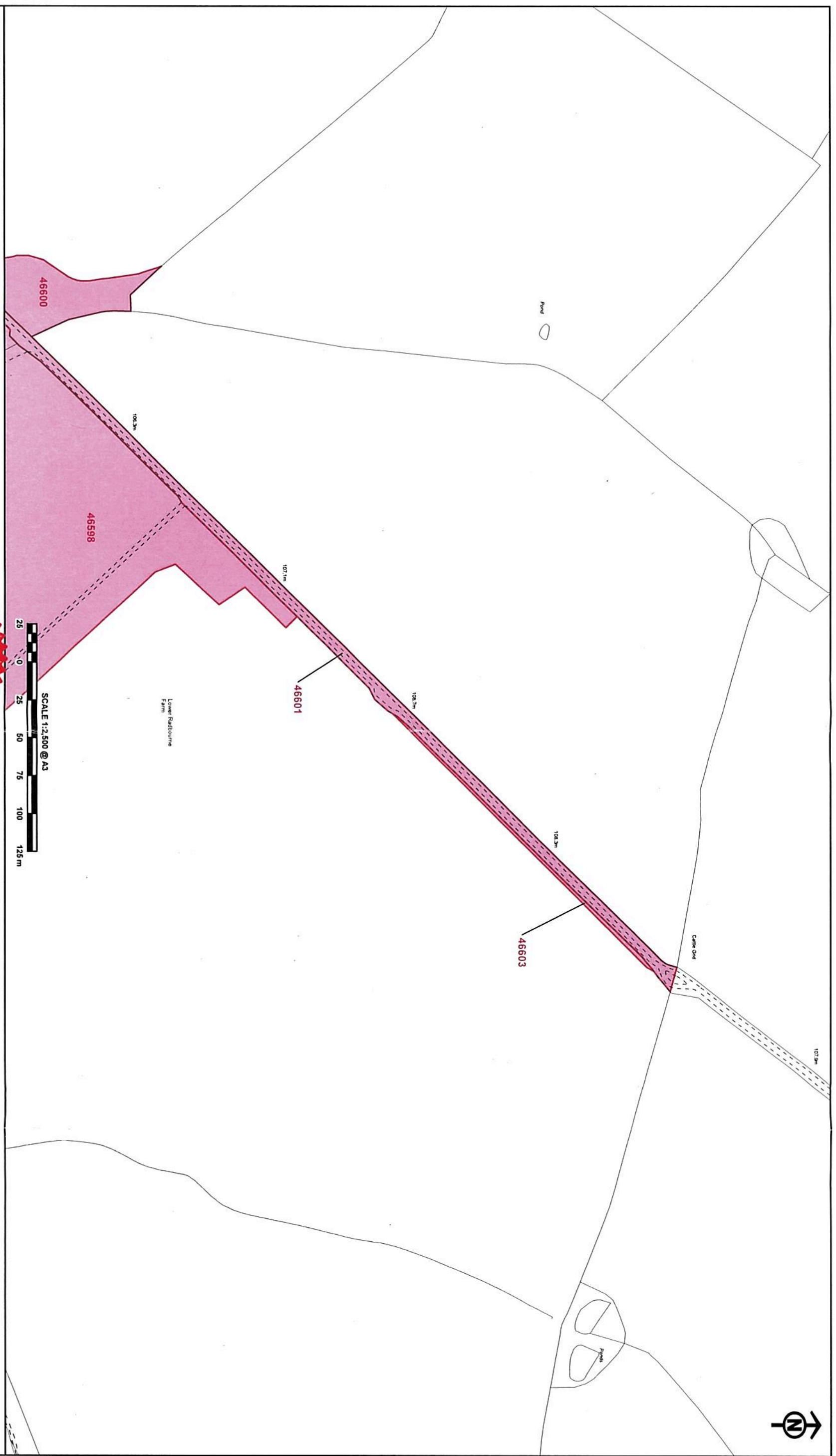

The CORPORATE SEAL of the  
SECRETARY OF STATE  
hereunto affixed to this deed  
is authenticated by

Authorised by the Secretary of State for Transport  
Dated 2nd July 2019.

SEAL REF NO  
DAT1231



