

HIGH SPEED RAIL (LONDON – WEST MIDLANDS) ACT 2017

HIGH SPEED RAIL (LONDON – WEST MIDLANDS) GENERAL VESTING DECLARATION No. 235

This **GENERAL VESTING DECLARATION** is executed on
by the Secretary of State for Transport ("the Authority").

15 August 2019

WHEREAS:

- (1) On 23 February 2017 the High Speed Rail (London – West Midlands) Act 2017 ("the High Speed Rail Act") received Royal Assent authorising the Authority to acquire the land specified in the Schedule hereto.
- (2) Section 4(1) of the High Speed Rail Act authorises the Authority to acquire compulsorily so much of the land within the limits of the High Speed Rail Act as may be required for Phase One purposes¹.
- (3) Section 4(4) of the High Speed Rail Act provides that the Compulsory Purchase (Vesting Declarations) Act 1981 ("the 1981 Act") applies as if the High Speed Rail Act were a compulsory purchase order and paragraph 3² of Schedule 6 to the High Speed Rail Act provides that the 1981 Act shall have effect subject to the modifications specified in that paragraph.
- (4) Notice pursuant to section 3A³ of the 1981 Act was first published on 29 July 2019. That notice included the particulars specified in section 3A(3) of the 1981 Act.

NOW THIS DEED WITNESSETH that, in exercise of the powers conferred on it by section 4 of the 1981 Act, the Authority hereby declares:-

1. The land described in the Schedule hereto (being part of the land authorised to be acquired by the High Speed Rail Act) and more particularly delineated and shown coloured pink on the plan annexed hereto, together with the right to enter upon and take possession of the land, shall vest in the Authority as from the end of the period of 3 MONTHS from the date on which the service of notices required by section 6⁴ of the 1981 Act is completed.

For the purposes of Section 2(2) of the 1981 Act, the specified period in relation to the land comprised in this declaration is one year and one day.

1 Phase One Purposes has meaning given by section 67 of the High Speed Rail Act

2 Paragraph 3 as substituted by section 11 of, and paragraph 6 of Schedule 14 to, the High Speed Rail Act.

3 Section 3A of the 1981 Act as inserted by paragraph 3(a) of Schedule 6 to the High Speed Rail Act as substituted by section 11 of, and paragraphs 6 and 7 of Schedule 14 to, that Act.

4 Section 6 as modified by paragraph 3(c) of Schedule 6 to the High Speed Rail Act, as substituted by section 11 of, and paragraph 6 of Schedule 14 to, that Act

SCHEDULE

District of Warwick

(1) Plot No	(2) Plot Description
28802	All interests in 14,766.71 square metres, or thereabouts, of woodland (Welsh Road)
28805	All interests in 4,055.32 square metres, or thereabouts, of agricultural land and wooded area (Welsh Road)
28806	All interests in 12,790.43 square metres, or thereabouts, of public road and verges (Welsh Road)
28807	All interests in 2,719.98 square metres, or thereabouts, of agricultural land (Welsh Road)
28808	All interests in 20.86 square metres, or thereabouts, of wooded area (Welsh Road Farm) (Welsh Road)
28809	All interests in 358.14 square metres, or thereabouts, of agricultural land (Welsh Road)
28810	All interests in 186,604.49 square metres, or thereabouts, of agricultural land, reservoir, woodland (Burnt Firs), garden and track (Burnt Heath Farm) (Welsh Road, Fosse Way, B4455 and Long Itchington Road)
28812	All interests in 52,052.37 square metres, or thereabouts, of public roads and verges (Fosse Way, B4455, Long Itchington Road, Radford Road and Welsh Road), cycle path and woodland (The Lias Line and Offchurch Greenway)
28814	All interests in 2,310.91 square metres, or thereabouts, of agricultural land (Bunkers Hill Farm) (Welsh Road)
28816	All interests in 3,085.16 square metres, or thereabouts, of agricultural land and public footpath (W125) (Fosse Way, B4455)
28817	All interests in 16,514.88 square metres, or thereabouts, of agricultural land (Fosse Way, B4455)
28818	All interests in 2,075.09 square metres, or thereabouts, of agricultural land (Welsh Road)
28820	All interests in 66,163.1 square metres, or thereabouts, of agricultural land (Burnt Heath Farm) (Fosse Way, B4455 and Long Itchington Road)
28821	All interests in 4,820.55 square metres, or thereabouts, of agricultural land (Burnt Heath Farm) (Fosse Way, B4455 and Long Itchington Road)
28822	All interests in 75,425.25 square metres, or thereabouts, of agricultural land (Burnt Heath Farm) (Fosse Way, B4455 and Long Itchington Road)
28823	All interests in 10,622.45 square metres, or thereabouts, of dismantled railway, wooded area and cycle path (The Offchurch Greenway) (Long Itchington Road)
28924	All interests in 1,572.7 square metres, or thereabouts, of public road and verges (Ridgeway Lane)
28926	All interests in 122,405.41 square metres, or thereabouts, of agricultural land, private access road and wooded area (Welsh Road and Ridgeway Lane)
28927	All interests in 1,083.11 square metres, or thereabouts, of car park and wooded area (Welsh Road)

IN WITNESS WHEREOF the Secretary of State for Transport has hereunto set its corporate seal on the day in the year first written above.

The **CORPORATE SEAL** of the SECRETARY OF STATE FOR TRANSPORT hereunto affixed to this deed is authenticated by

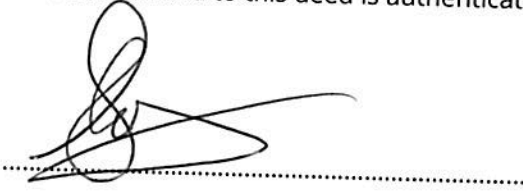

Authorised Signatory

Dated: 15 August 2019

SEAL REF NO
DfT/ 9258



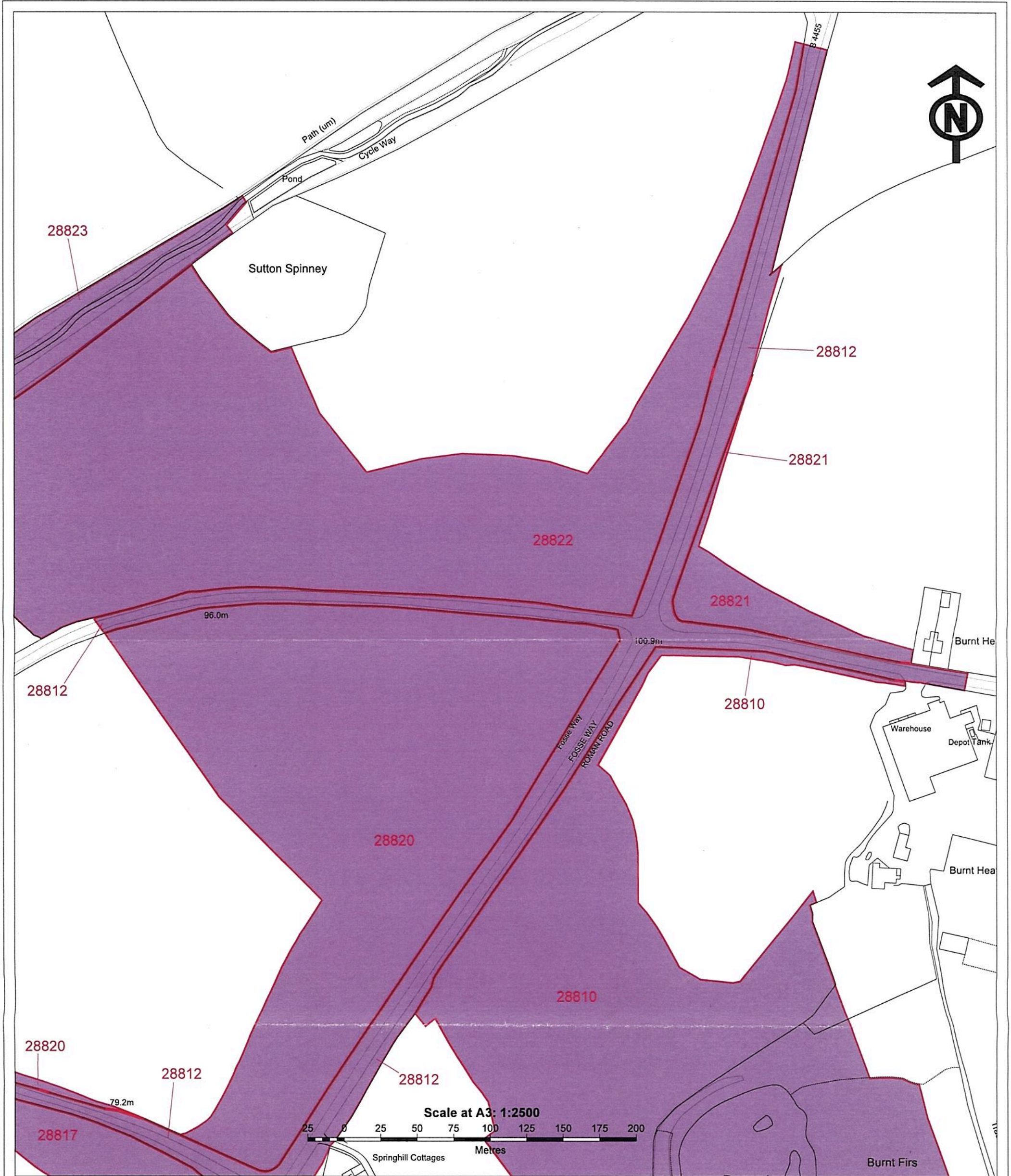

The CORPORATE SEAL of the
SECRETARY OF STATE
hereunto affixed to this deed
is authenticated by

.....
Authorised by the Secretary of State for Transport

Dated 15/August 2019

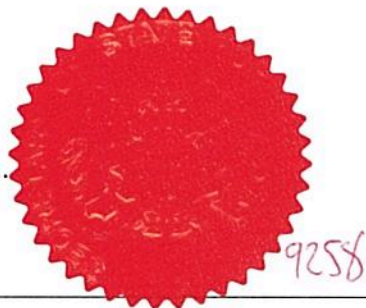

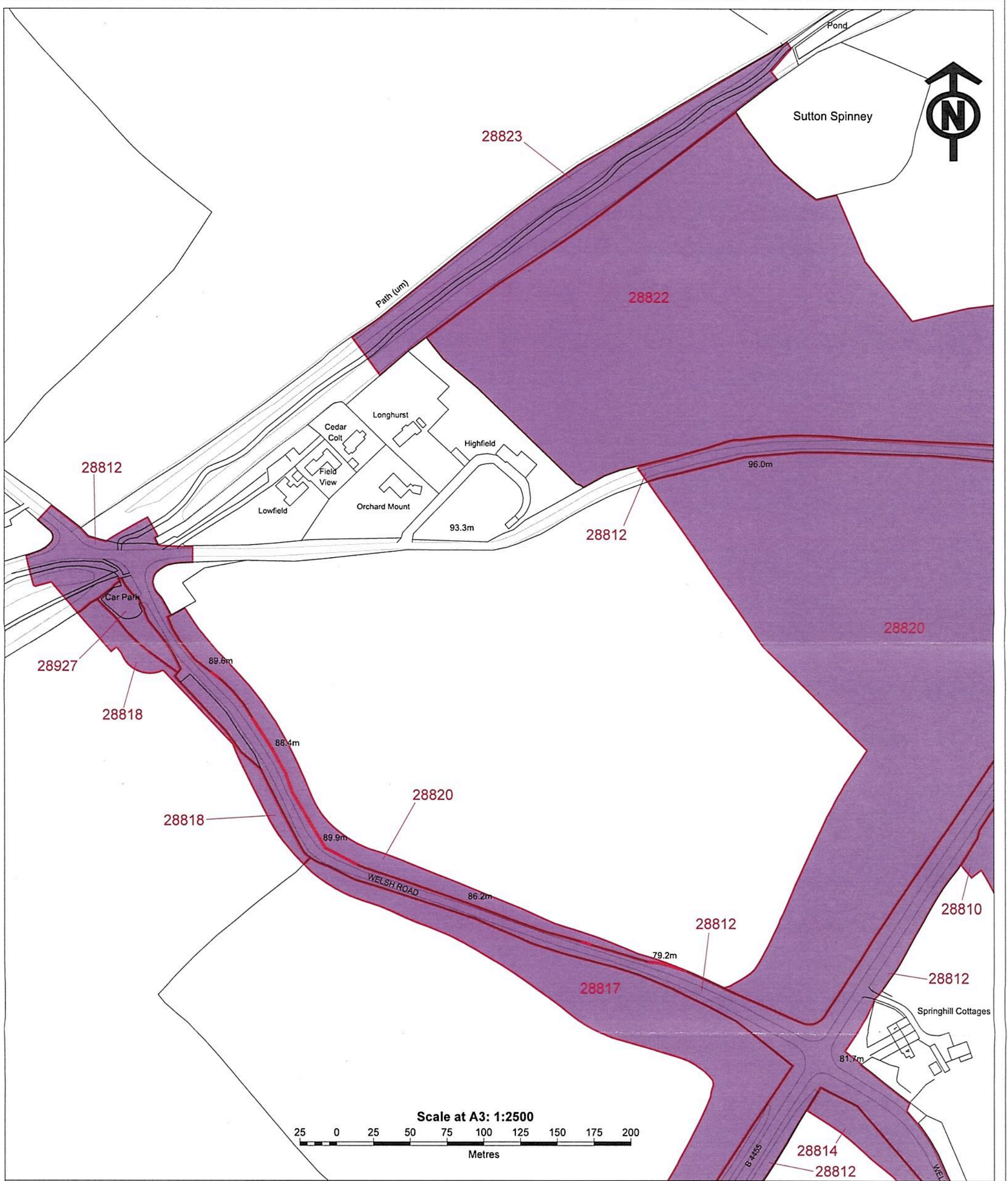

The CORPORATE SEAL of the
SECRETARY OF STATE
hereunto affixed to this deed
is authenticated by

.....
Authorised by the Secretary of State for Transport

Dated 15 August 2019



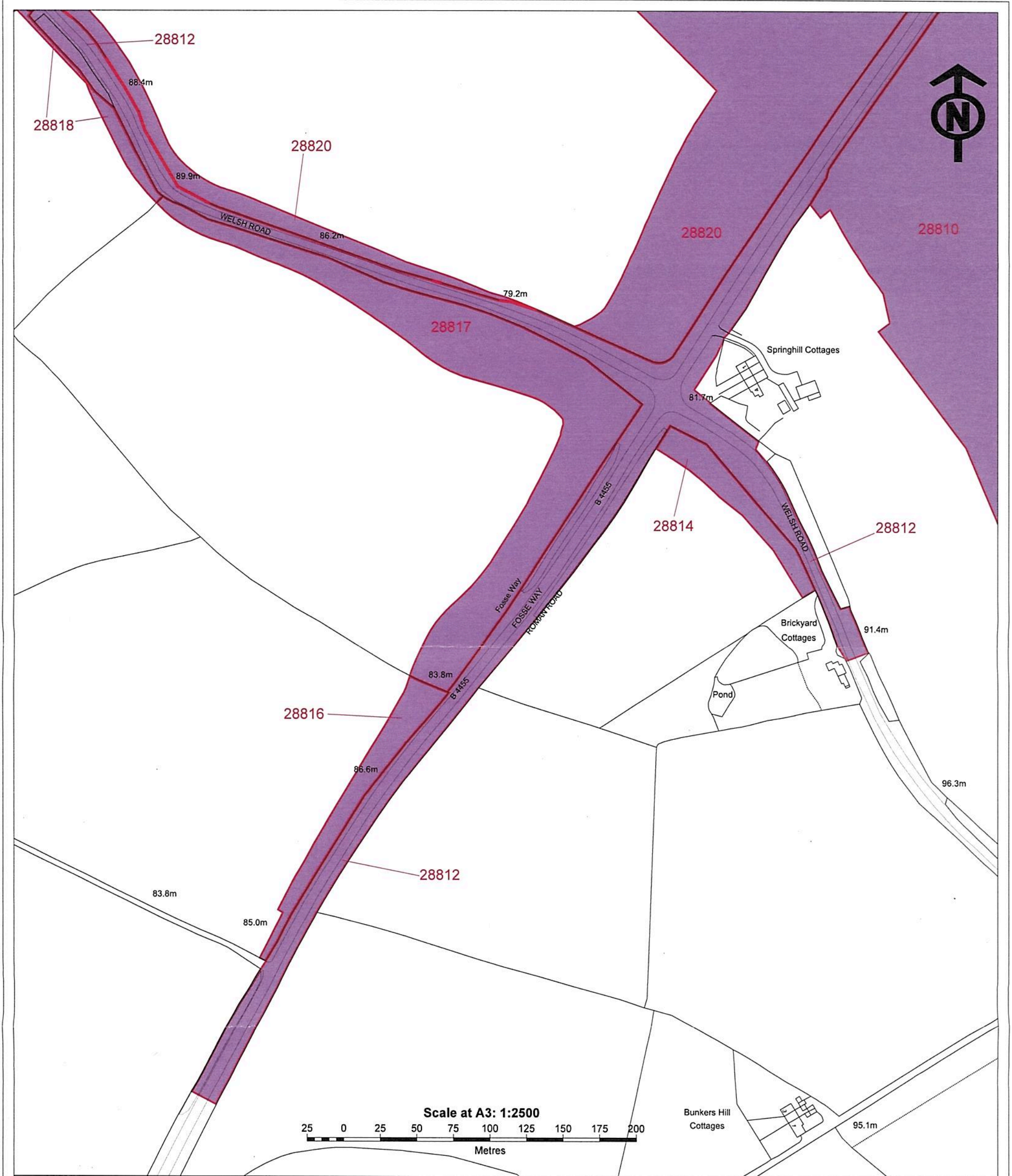

The CORPORATE SEAL of the
SECRETARY OF STATE
hereunto affixed to this deed
is authenticated by

.....
Authorised by the Secretary of State for Transport

Dated 15 August 2019



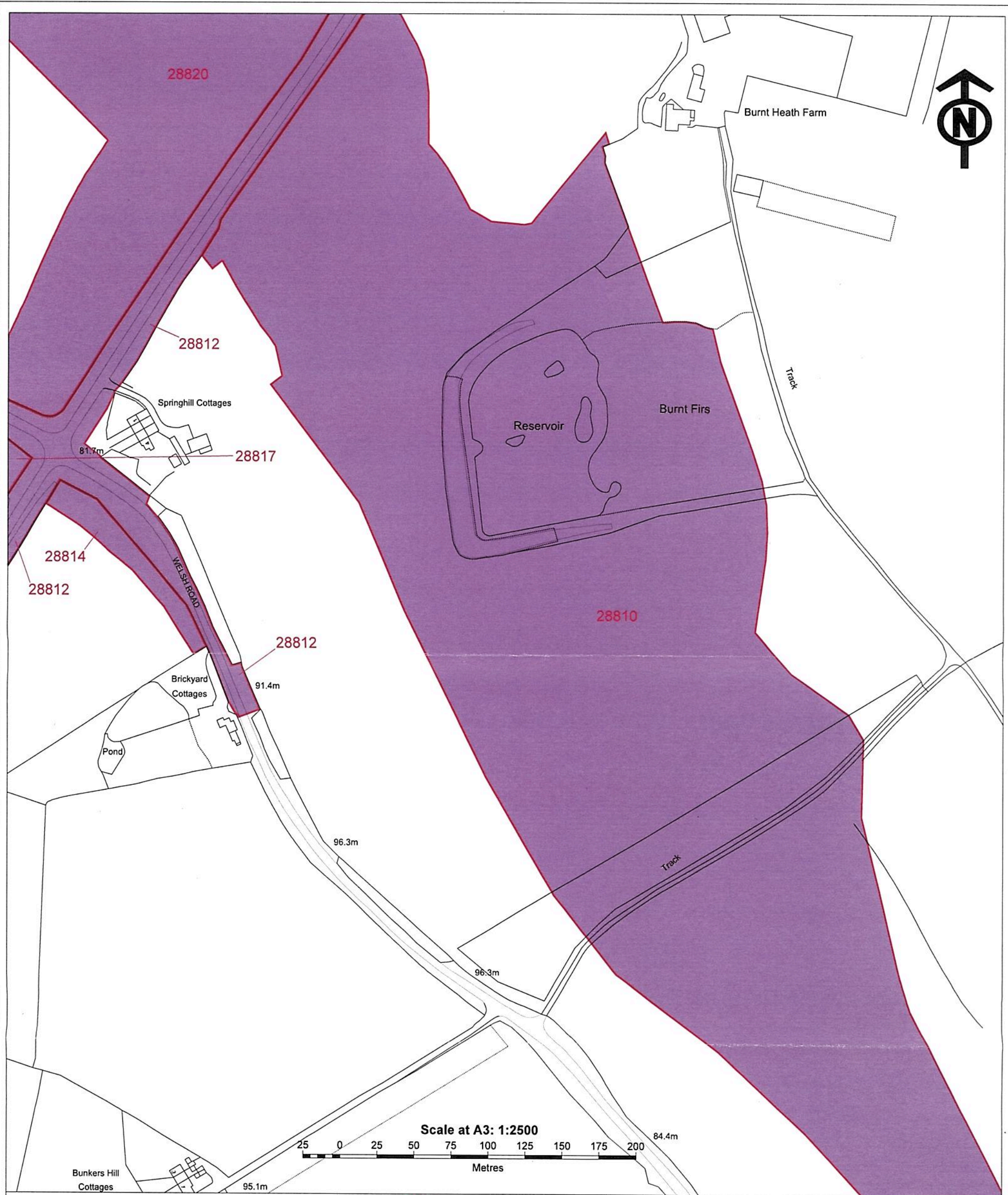

The CORPORATE SEAL of the
SECRETARY OF STATE
hereunto affixed to this deed
is authenticated by

Authorised by the Secretary of State for Transport

Dated 15 August 2019



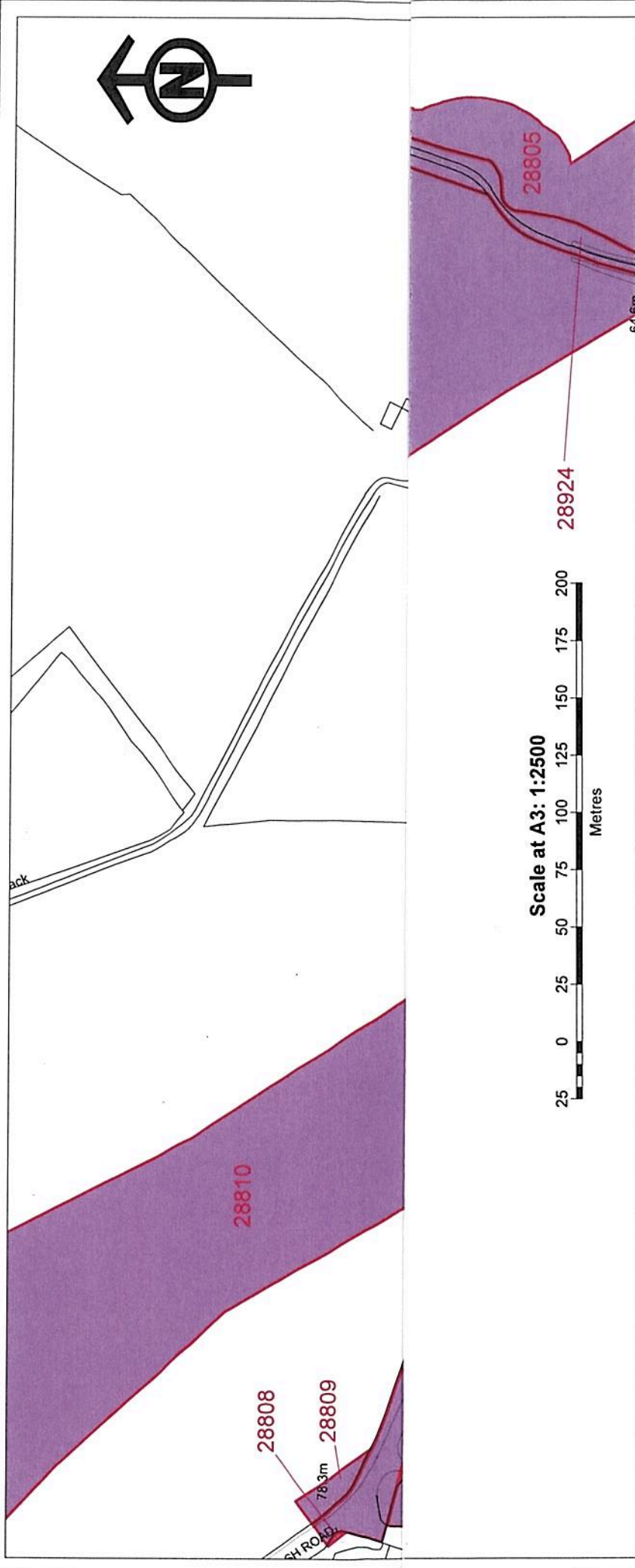

The CORPORATE SEAL of the
SECRETARY OF STATE
hereunto affixed to this deed
is authenticated by

Authorised by the Secretary of State for Transport

Dated 15 August 2019



© Crown copyright and database right 2018. Ordnance Survey Licence Number 100040190.
© Crown copyright material is reproduced with the permission of Land Registry under
delegated authority from the Controller of HMSO and © Crown Copyright Ordnance Survey

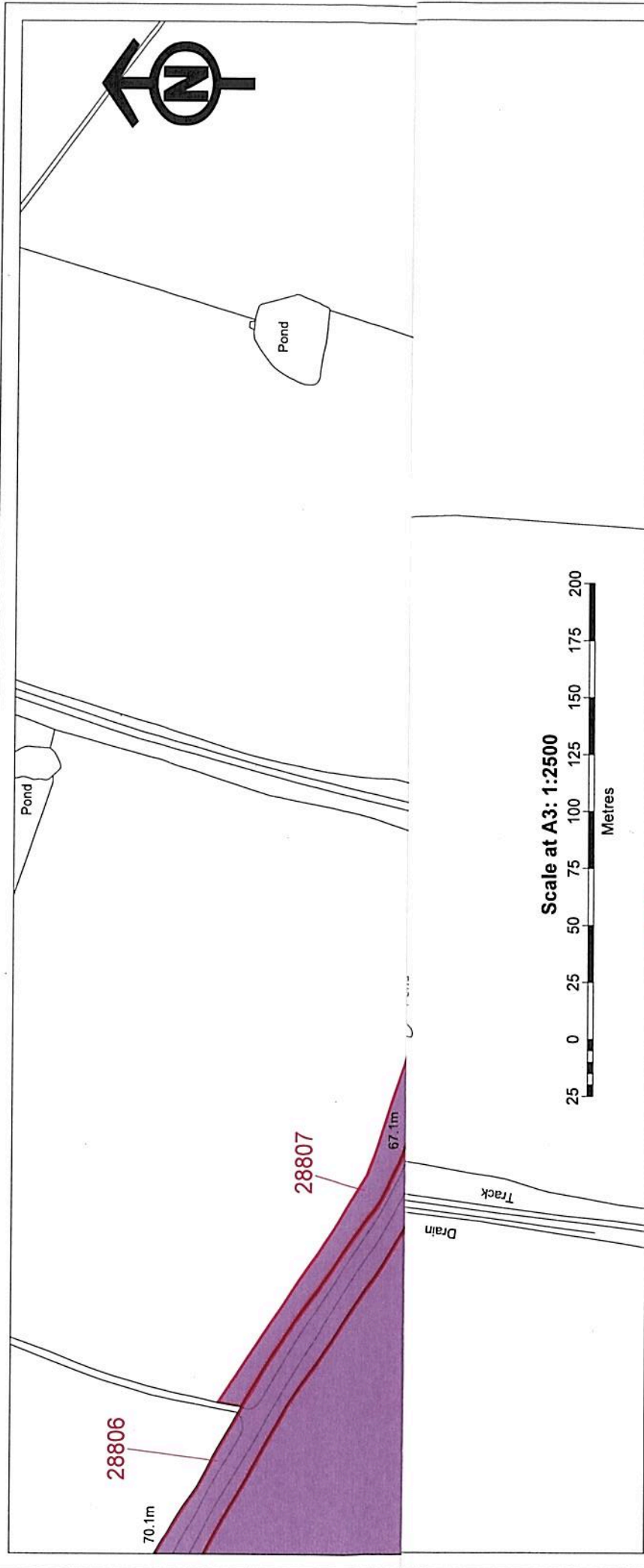

The CORPORATE SEAL of the
SECRETARY OF STATE
hereunto affixed to this deed
is authenticated by



[Handwritten signature]

.....
Authorised by the Secretary of State for Transport

Dated 15 August 2019

