

**HIGH SPEED RAIL (LONDON – WEST MIDLANDS) ACT 2017**

**HIGH SPEED RAIL (LONDON – WEST MIDLANDS) GENERAL VESTING DECLARATION No. 449**

This **GENERAL VESTING DECLARATION** is executed on 11 NOVEMBER 2020  
by the Secretary of State for Transport ("the Authority").

**WHEREAS:**

- (1) On 23 February 2017 the High Speed Rail (London – West Midlands) Act 2017 ("the High Speed Rail Act") received Royal Assent authorising the Authority to acquire the land specified in the Schedule hereto.
- (2) Section 4(1) of the High Speed Rail Act authorises the Authority to acquire compulsorily so much of the land within the limits of the High Speed Rail Act as may be required for Phase One purposes<sup>1</sup>.
- (3) Section 4(4) of the High Speed Rail Act provides that the Compulsory Purchase (Vesting Declarations) Act 1981 ("the 1981 Act") applies as if the High Speed Rail Act were a compulsory purchase order and paragraph 3<sup>2</sup> of Schedule 6 to the High Speed Rail Act provides that the 1981 Act shall have effect subject to the modifications specified in that paragraph.
- (4) Notice pursuant to section 3A<sup>3</sup> of the 1981 Act was first published on 26 October 2020. That notice included the particulars specified in section 3A(3) of the 1981 Act.

**NOW THIS DEED WITNESSETH** that, in exercise of the powers conferred on it by section 4 of the 1981 Act, the Authority hereby declares:-

1. The land described in the Schedule hereto (being part of the land authorised to be acquired by the High Speed Rail Act) and more particularly delineated and shown coloured pink on the plan annexed hereto, together with the right to enter upon and take possession of the land, shall vest in the Authority as from the end of the period of 3 months from the date on which the service of notices required by section 6<sup>4</sup> of the 1981 Act is completed.

For the purposes of Section 2(2) of the 1981 Act, the specified period in relation to the land comprised in this declaration is one year and one day.

---

1 Phase One Purposes has meaning given by section 67 of the High Speed Rail Act

2 Paragraph 3 as substituted by section 11 of, and paragraph 6 of Schedule 14 to, the High Speed Rail Act.

3 Section 3A of the 1981 Act as inserted by paragraph 3(a) of Schedule 6 to the High Speed Rail Act as substituted by section 11 of, and paragraphs 6 and 7 of Schedule 14 to, that Act.

4 Section 6 as modified by paragraph 3(c) of Schedule 6 to the High Speed Rail Act, as substituted by section 11 of, and paragraph 6 of Schedule 14 to, that Act

## SCHEDULE

District of Lichfield

(1) Plot No	(2) Plot Description
29611	All interests in 3,201.65 square metres, or thereabouts, of public road and verges (Shaw Lane) excluding all interests held by Secretary of State for Transport
29612	All interests in 547.62 square metres, or thereabouts, of scrubland and wooded area (Shaw Lane) excluding all interests held by Secretary of State for Transport
29613	All interests in 46,435.8 square metres, or thereabouts, of agricultural land, track, scrubland, ponds and wooded area (Shaw Lane)
29615	All interests in 517.51 square metres, or thereabouts, of agricultural land (Tuppenhurst Lane)
29616	All interests in 18,909.23 square metres, or thereabouts, of agricultural land (Ashton Hayes Farm) (Tuppenhurst Lane)
29617	All interests in 4,038.22 square metres, or thereabouts, of garden, building, accessway and agricultural land (Ashton Hayes Farm) (Tuppenhurst Lane)
29618	All interests in 323.25 square metres, or thereabouts, of agricultural land (Ashton Hayes Farm) and public footpath (Kings Bromley 6) (Tuppenhurst Lane)
29619	All interests in 16,081.51 square metres, or thereabouts, of agricultural land (Ashton Hayes Farm), watercourse, wooded area and public footpath (Kings Bromley 6) (Tuppenhurst Lane)
29642	All interests in 24,145.71 square metres, or thereabouts, of agricultural land, wooded area, watercourse and public footpath (Kings Bromley 6) (Tuppenhurst Lane)
50346	All interests in 76.76 square metres, or thereabouts, of agricultural land (Shaw Lane)
50347	All interests in 754.19 square metres, or thereabouts, of public road verge (Shaw Lane)
50350	All interests in 19.58 square metres, or thereabouts, of bridge carrying public road over railway, works and land (West Coast Main Line) (Shaw Lane)
51761	All interests in 1,739.32 square metres, or thereabouts, of agricultural land (Tuppenhurst Lane)

**IN WITNESS WHEREOF** the Secretary of State for Transport has hereunto set its corporate seal on the day in the year first written above.

The **CORPORATE SEAL** of the SECRETARY OF STATE FOR TRANSPORT hereunto affixed to this deed is authenticated by



Authorised Signatory

Dated: 11 NOVEMBER 2020

SEAL REF  
DFT GP / 0336





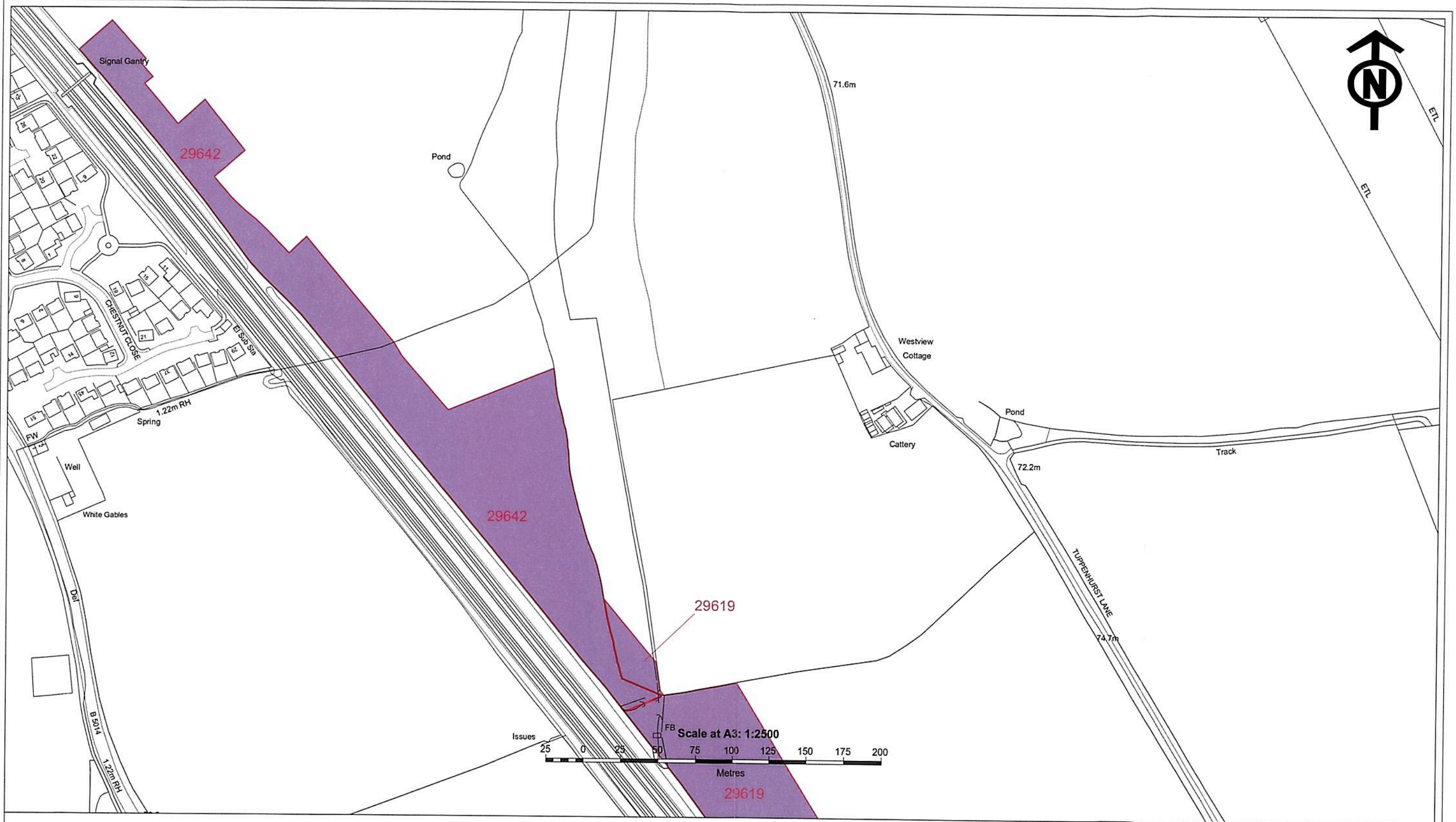

The CORPORATE SEAL of the  
SECRETARY OF STATE  
hereunto affixed to this deed  
is authenticated by  
  
.....  
Authorised by the Secretary of State for Transport  
Dated 11 NOVEMBER 2020



0336



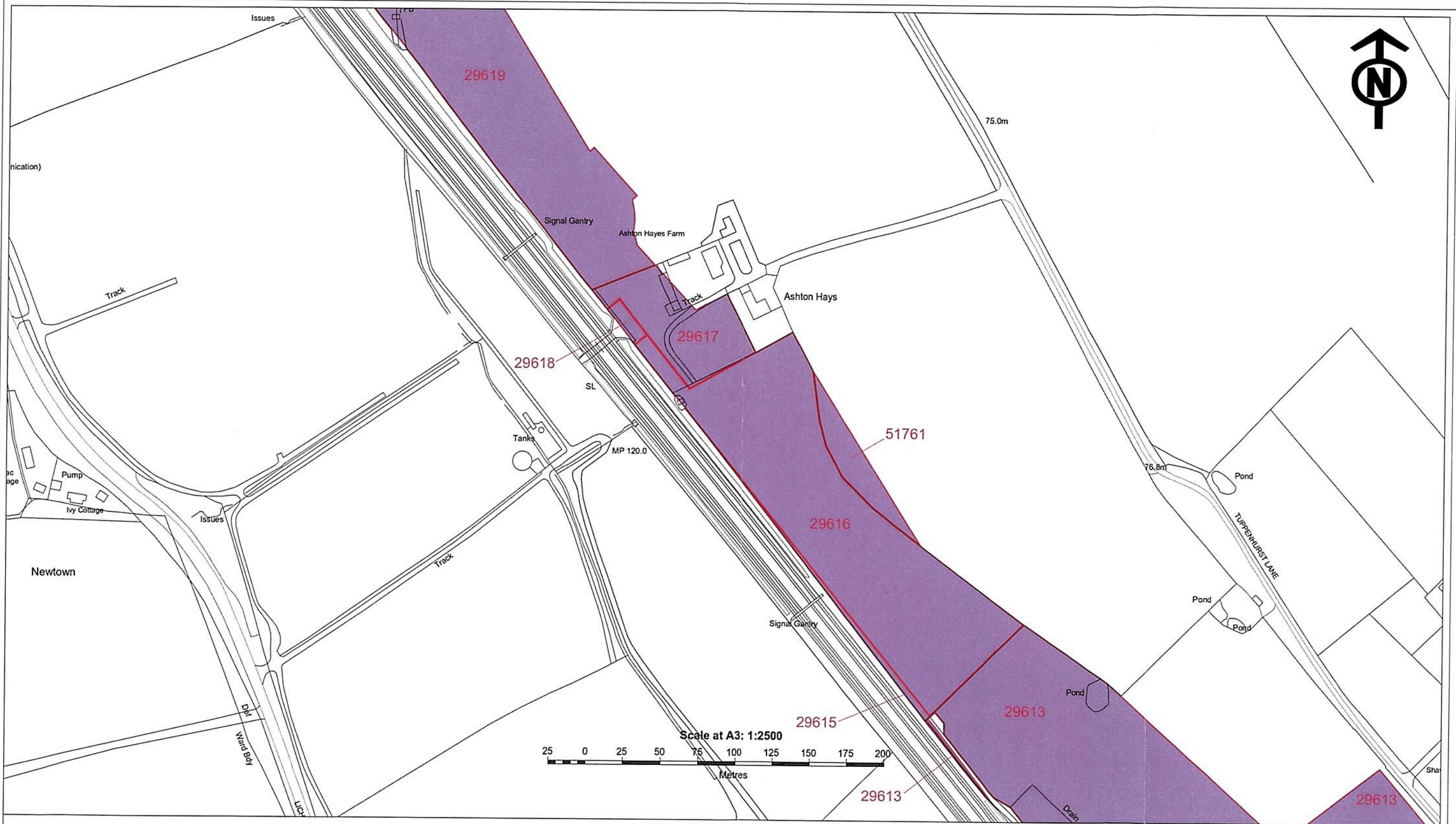

The CORPORATE SEAL of the  
SECRETARY OF STATE  
hereunto affixed to this deed  
is authenticated by

Authorised by the Secretary of State for Transport

Dated 11 NOVEMBER 2020







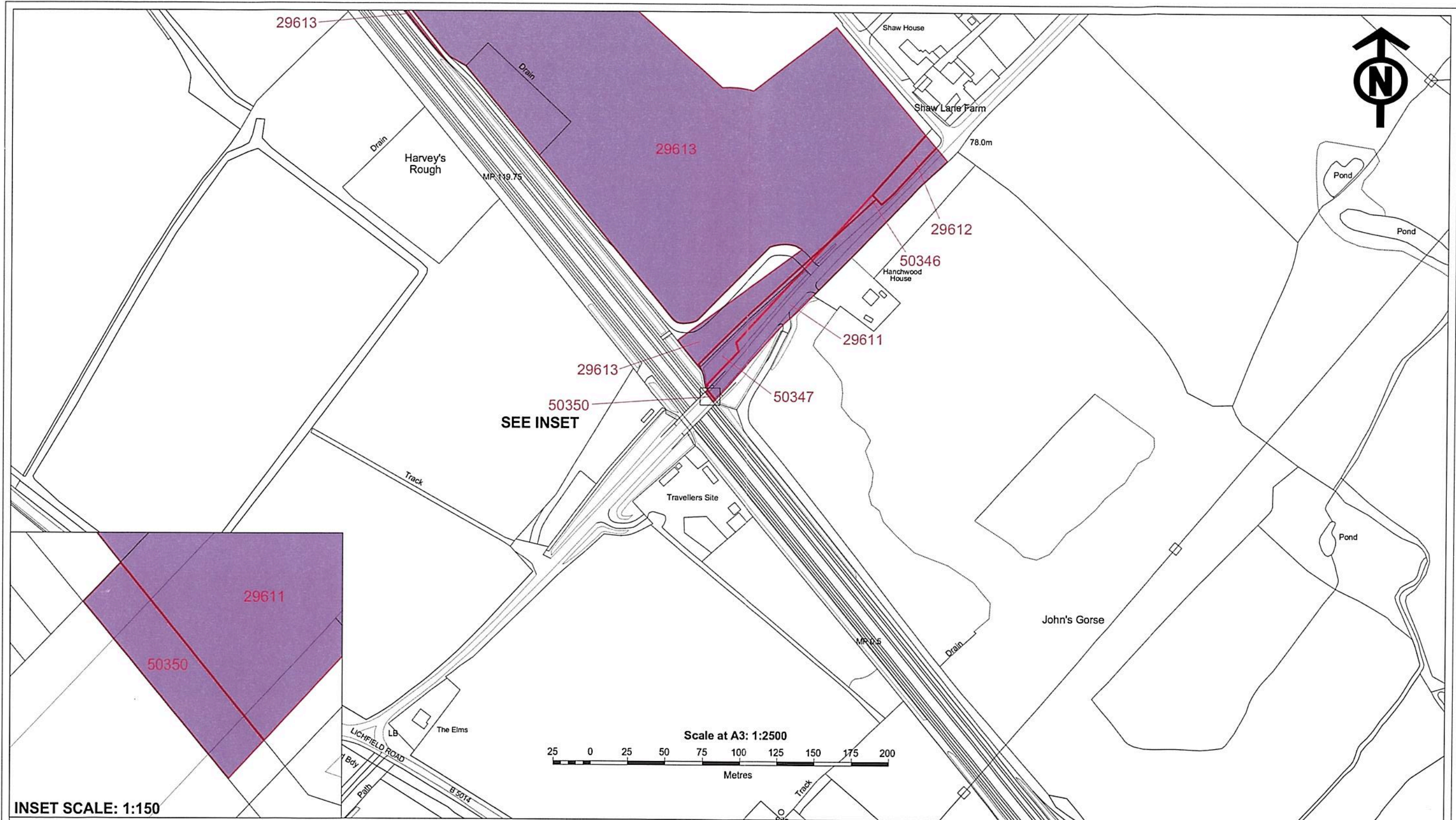

**INSET SCALE: 1:150**

The CORPORATE SEAL of the  
SECRETARY OF STATE  
hereunto affixed to this deed  
is authenticated by

*[Signature]*  
.....  
Authorised by the Secretary of State for Transport

Dated 11 NOVEMBER 2020



0336

