

## HIGH SPEED RAIL (LONDON – WEST MIDLANDS) ACT 2017

### HIGH SPEED RAIL (LONDON – WEST MIDLANDS) GENERAL VESTING DECLARATION No. 362

This **GENERAL VESTING DECLARATION** is executed on *13<sup>th</sup> January 2020* by the Secretary of State for Transport ("the Authority").

#### WHEREAS:

- (1) On 23 February 2017 the High Speed Rail (London – West Midlands) Act 2017 ("the High Speed Rail Act") received Royal Assent authorising the Authority to acquire the land specified in the Schedule hereto.
- (2) Section 4(1) of the High Speed Rail Act authorises the Authority to acquire compulsorily so much of the land within the limits of the High Speed Rail Act as may be required for Phase One purposes<sup>1</sup>.
- (3) Section 4(4) of the High Speed Rail Act provides that the Compulsory Purchase (Vesting Declarations) Act 1981 ("the 1981 Act") applies as if the High Speed Rail Act were a compulsory purchase order and paragraph 3<sup>2</sup> of Schedule 6 to the High Speed Rail Act provides that the 1981 Act shall have effect subject to the modifications specified in that paragraph.
- (4) Notice pursuant to section 3A<sup>3</sup> of the 1981 Act was first published on 29 November 2019. That notice included the particulars specified in section 3A(3) of the 1981 Act.

**NOW THIS DEED WITNESSETH** that, in exercise of the powers conferred on it by section 4 of the 1981 Act, the Authority hereby declares:-

1. The land described in the Schedule hereto (being part of the land authorised to be acquired by the High Speed Rail Act) and more particularly delineated and shown coloured pink on the plan annexed hereto, together with the right to enter upon and take possession of the land, shall vest in the Authority as from the end of the period of 3 months from the date on which the service of notices required by section 6<sup>4</sup> of the 1981 Act is completed.

For the purposes of Section 2(2) of the 1981 Act, the specified period in relation to the land comprised in this declaration is one year and one day.

---

1 Phase One Purposes has meaning given by section 67 of the High Speed Rail Act

2 Paragraph 3 as substituted by section 11 of, and paragraph 6 of Schedule 14 to, the High Speed Rail Act.

3 Section 3A of the 1981 Act as inserted by paragraph 3(a) of Schedule 6 to the High Speed Rail Act as substituted by section 11 of, and paragraphs 6 and 7 of Schedule 14 to, that Act.

4 Section 6 as modified by paragraph 3(c) of Schedule 6 to the High Speed Rail Act; as substituted by section 11 of, and paragraph 6 of Schedule 14 to, that Act

## SCHEDULE

District of Lichfield

<b>(1) Plot No</b>	<b>(2) Plot Description</b>
50148	All interests in 41,215.05 square metres, or thereabouts, of agricultural land, access track and public footpath (King`s Bromley 0.392), woodland (Black Slough), pylons and overhead electricity cables (Wood End Lane)
50149	All interests in 23,090.01 square metres, or thereabouts, of agricultural land, access track, drain and woodland (Ravenshaw Wood), pylon and overhead electricity cables (Wood End Lane)
50150	All interests in 2,259.06 square metres, or thereabouts, of agricultural land and access track (Wood End Lane)
50151	All interests in 4,868.6 square metres, or thereabouts, of public roads and verges (Watery Lane and Wood End Lane)
50152	All interests in 1,173.8 square metres, or thereabouts, of agricultural land and access track (Wood End Lane)
50153	All interests in 34.56 square metres, or thereabouts, of agricultural land (Wood End Lane)
50154	All interests in 1,126.55 square metres, or thereabouts, of public road and verges (Wood End Lane)
50777	All interests in 12,534.54 square metres, or thereabouts, of agricultural land, access track, pylon and overhead electricity cables (Wood End Lane)

**IN WITNESS WHEREOF** the Secretary of State for Transport has hereunto set its corporate seal on the day in the year first written above.

The **CORPORATE SEAL** of the SECRETARY OF STATE FOR TRANSPORT hereunto affixed to this deed is authenticated by

SEAL REF NO  
DfT/ 9519



A handwritten signature in blue ink, consisting of several loops and a long horizontal stroke at the end.

Authorised Signatory

Dated : 13<sup>th</sup> January 2020 .



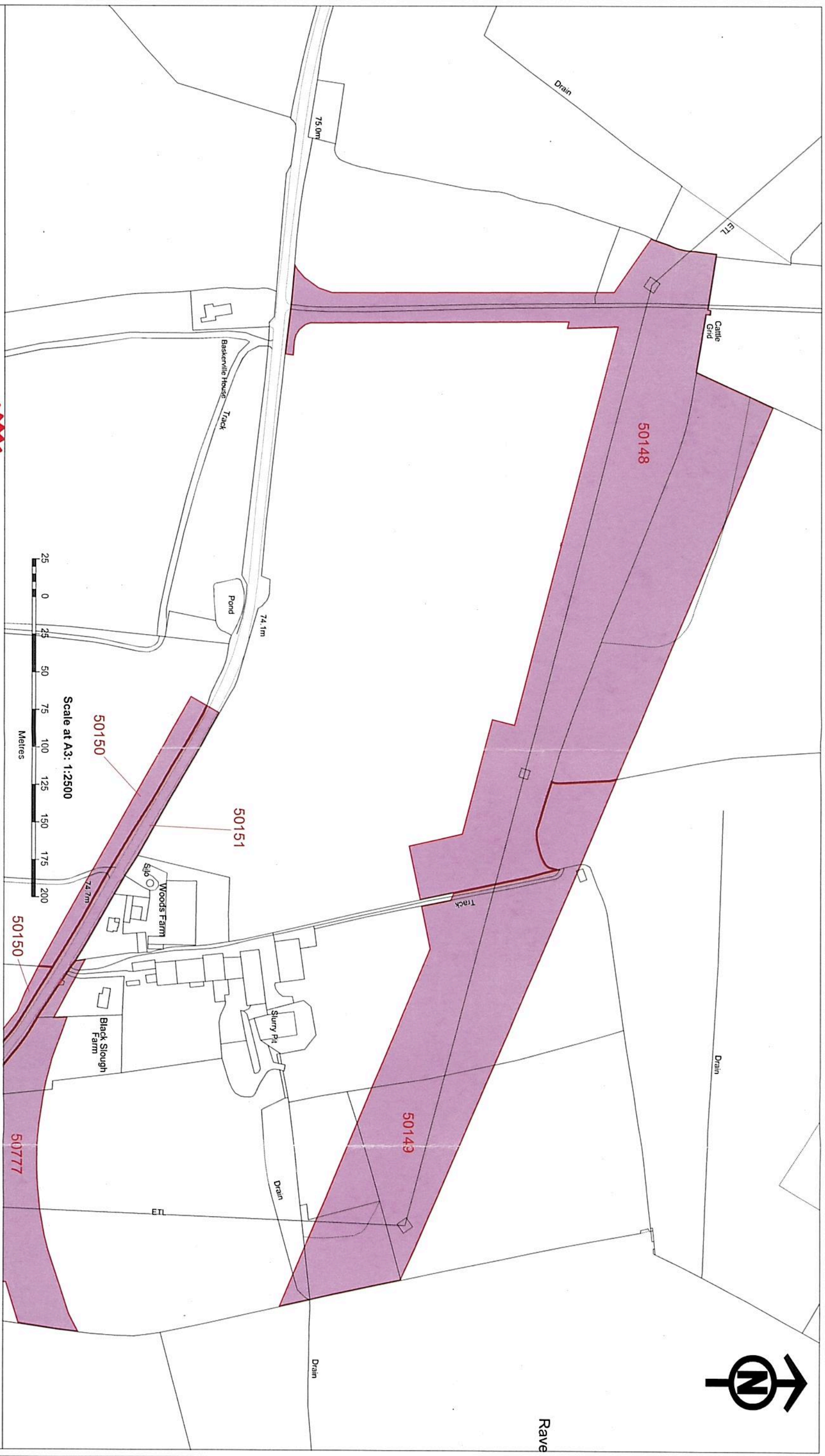

The CORPORATE SEAL of the  
SECRETARY OF STATE  
hereunto affixed to this deed  
is authenticated by

Authorised by the Secretary of State for Transport

Dated 13<sup>th</sup> January 2020



9519



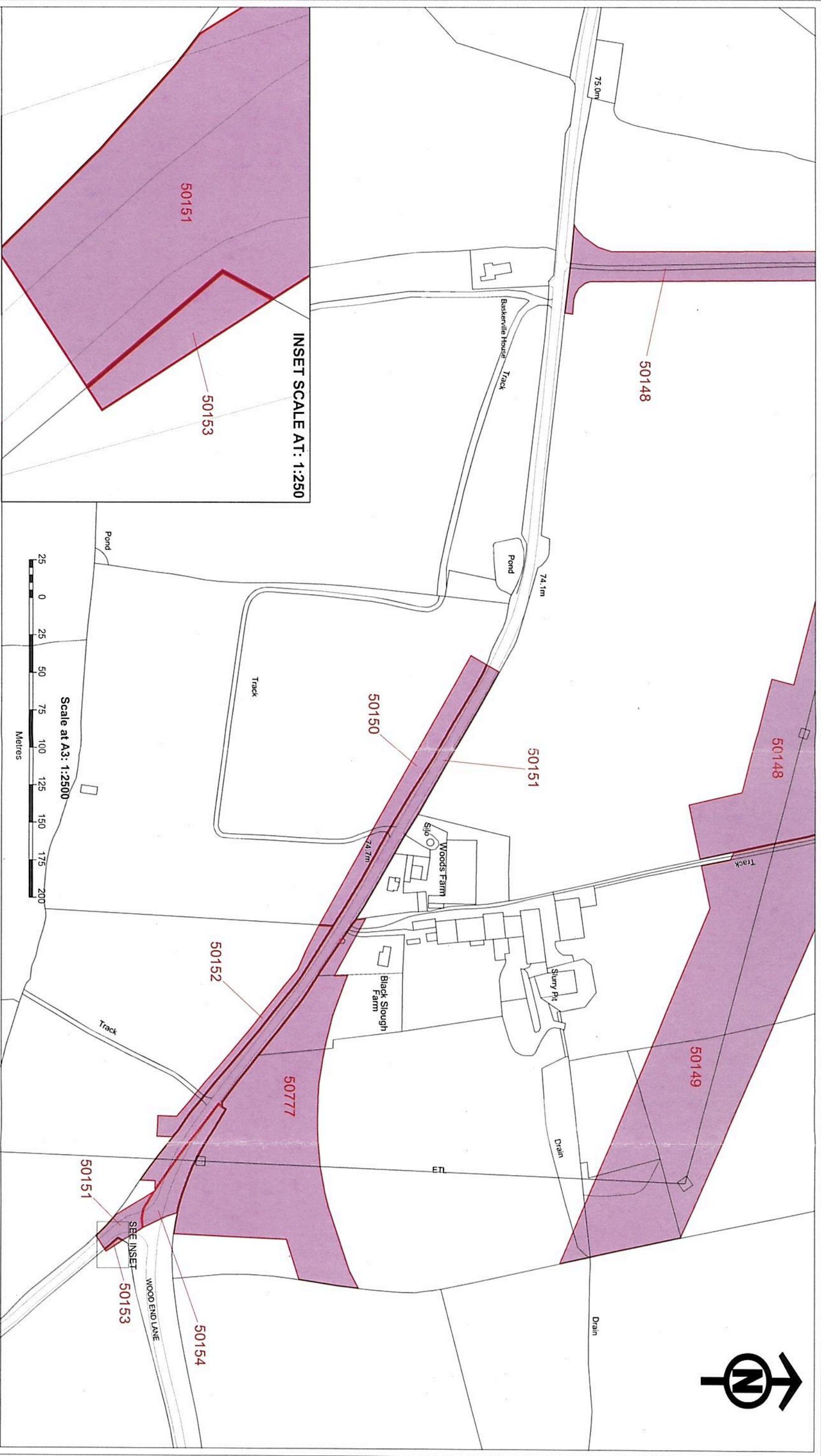

The CORPORATE SEAL of the  
SECRETARY OF STATE  
hereunto affixed to this deed  
is authenticated by

Authorised by the Secretary of State for Transport

Dated 13th January 2020



9519

© Crown copyright and database right 2018. Ordnance Survey, Licence Number: 100019760  
Reproduced by permission of the Controller of Her Majesty's Stationery Office  
© Crown Copyright 2018. Ordnance Survey

