

HIGH SPEED RAIL (LONDON – WEST MIDLANDS) ACT 2017

HIGH SPEED RAIL (LONDON – WEST MIDLANDS) GENERAL VESTING DECLARATION No. 337

This **GENERAL VESTING DECLARATION** is executed on *16th January 2020* by the Secretary of State for Transport ("the Authority").

WHEREAS:

- (1) On 23 February 2017 the High Speed Rail (London – West Midlands) Act 2017 ("the High Speed Rail Act") received Royal Assent authorising the Authority to acquire the land specified in the Schedule hereto.
- (2) Section 4(1) of the High Speed Rail Act authorises the Authority to acquire compulsorily so much of the land within the limits of the High Speed Rail Act as may be required for Phase One purposes¹.
- (3) Section 4(4) of the High Speed Rail Act provides that the Compulsory Purchase (Vesting Declarations) Act 1981 ("the 1981 Act") applies as if the High Speed Rail Act were a compulsory purchase order and paragraph 3² of Schedule 6 to the High Speed Rail Act provides that the 1981 Act shall have effect subject to the modifications specified in that paragraph.
- (4) Notice pursuant to section 3A³ of the 1981 Act was first published on 02 December 2019. That notice included the particulars specified in section 3A(3) of the 1981 Act.

NOW THIS DEED WITNESSETH that, in exercise of the powers conferred on it by section 4 of the 1981 Act, the Authority hereby declares:-

1. The land described in the Schedule hereto (being part of the land authorised to be acquired by the High Speed Rail Act) and more particularly delineated and shown coloured pink on the plan annexed hereto, together with the right to enter upon and take possession of the land, shall vest in the Authority as from the end of the period of 3 months from the date on which the service of notices required by section 6⁴ of the 1981 Act is completed.

For the purposes of Section 2(2) of the 1981 Act, the specified period in relation to the land comprised in this declaration is one year and one day.

1 Phase One Purposes has meaning given by section 67 of the High Speed Rail Act

2 Paragraph 3 as substituted by section 11 of, and paragraph 6 of Schedule 14 to, the High Speed Rail Act.

3 Section 3A of the 1981 Act as inserted by paragraph 3(a) of Schedule 6 to the High Speed Rail Act as substituted by section 11 of, and paragraphs 6 and 7 of Schedule 14 to, that Act.

4 Section 6 as modified by paragraph 3(c) of Schedule 6 to the High Speed Rail Act, as substituted by section 11 of, and paragraph 6 of Schedule 14 to, that Act

SCHEDULE

District of Lichfield

(1) Plot No	(2) Plot Description
27734	All interests in 12,396.26 square metres, or thereabouts, of agricultural land (Rookery Lane)
27736	All interests in 136,884.95 square metres, or thereabouts, of agricultural land and public footpaths (Hints 13 and Hints 14) (Rookery Lane)
27740	All interests in 9,644.34 square metres, or thereabouts, of agricultural land and public footpath (Hints 13) (Rookery Lane)
27741	All interests in 2,217.06 square metres, or thereabouts, of public road and verges (Rookery Lane)
27742	All interests in 62,990.68 square metres, or thereabouts, of agricultural land and track (Rookery Lane)
27743	All interests in 68,682.41 square metres, or thereabouts, of agricultural land, woodland (Job`s Hill) and public footpath (Hints 11) (Rookery Lane)
27744	All interests in 48,251.79 square metres, or thereabouts, of agricultural land (Rookery Lane)
27745	All interests in 296.99 square metres, or thereabouts, of stream (Black Brook) (Watling Street)
27746	All interests in 179.66 square metres, or thereabouts, of half width of stream (Black Brook) (Watling Street)
29278	All interests in 20,893.1 square metres, or thereabouts, of woodland (Rookery) (Rookery Lane)
29279	All interests in 13,634.26 square metres, or thereabouts, of agricultural land (Rookery Lane)
29280	All interests in 669.05 square metres, or thereabouts, of private road, verges and public bridleway (Hints 12) (Rookery Lane)
29281	All interests in 119.34 square metres, or thereabouts, of woodland (Rookery) (Rookery Lane)
29283	All interests in 156.67 square metres, or thereabouts, of agricultural land (Rookery Lane)
29284	All interests in 57.03 square metres, or thereabouts, of wooded area and adopted footway (Rookery Lane)
29285	All interests in 331.81 square metres, or thereabouts, of wooded area (Rookery Lane)
50612	All interests in 605.37 square metres, or thereabouts, of public road and verges (Rookery Lane)
50614	All interests in 1,362.84 square metres, or thereabouts, of public road, verges and track (Rookery Lane)

IN WITNESS WHEREOF the Secretary of State for Transport has hereunto set its corporate seal on the day in the year first written above.

The **CORPORATE SEAL** of the SECRETARY OF STATE FOR TRANSPORT hereunto affixed to this deed is authenticated by



Authorised Signatory

Dated: *16th January 2020*

SEAL REF NO
DfT/ 9527



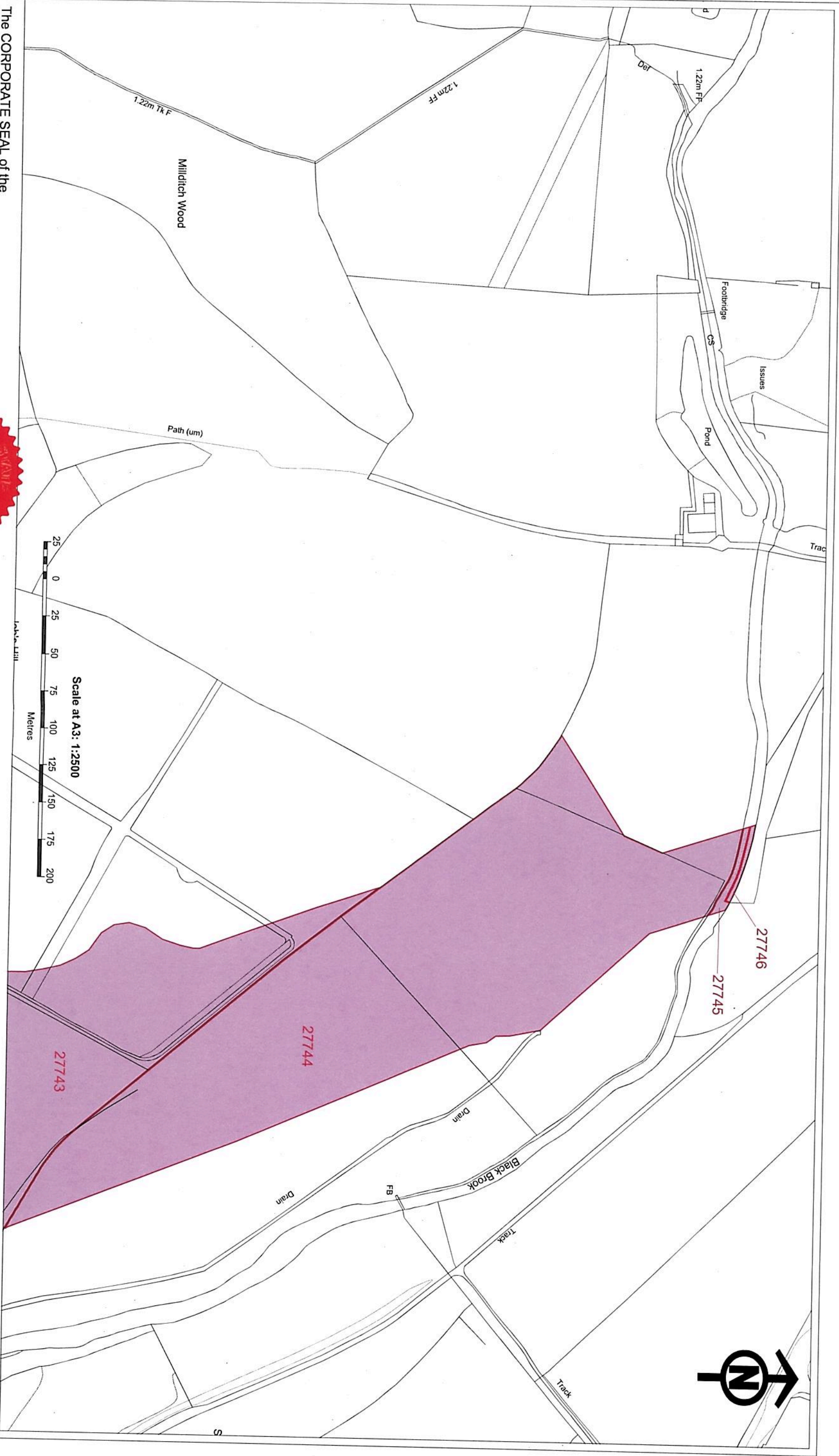

The CORPORATE SEAL of the
SECRETARY OF STATE
hereunto affixed to this deed
is authenticated by

Authorised by the Secretary of State for Transport

Dated 16th January 2012



9527

© Crown copyright and database right 2012. Ordnance Survey. Licence Number: 100019190
This document is reproduced with the permission of Land Registry under
compulsory authority from the Controller of HMSO and the Ordnance Survey

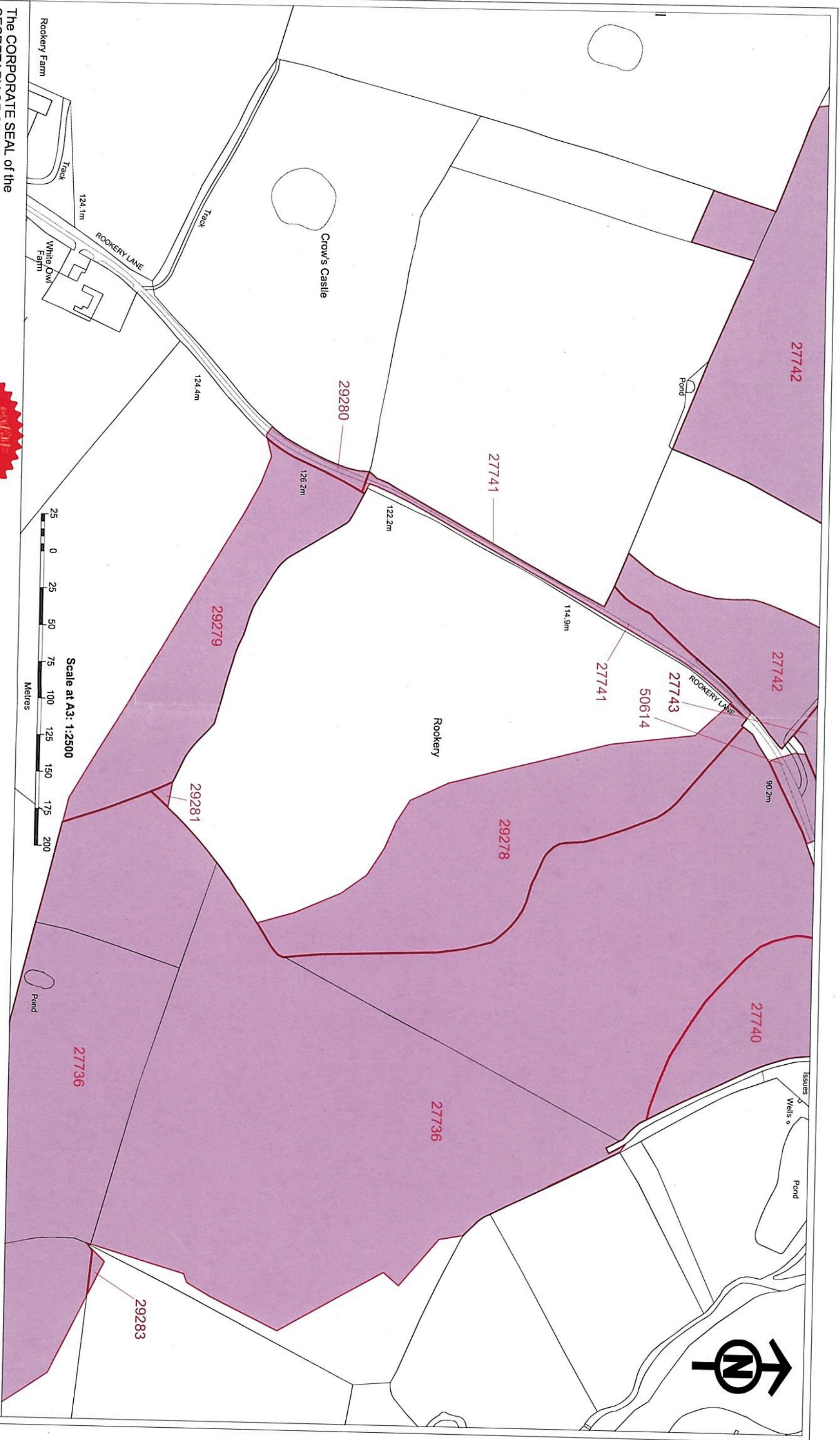

The CORPORATE SEAL of the
 SECRETARY OF STATE
 hereunto affixed to this deed
 is authenticated by

[Handwritten signature]

Authorised by the Secretary of State for Transport
 Dated 16th January 2020



9827

© Crown copyright and database right 2018. Ordnance Survey 100041502
 © Crown copyright material is reproduced with the permission of HM Land Registry and the Controller of HMSO and © Crown Copyright Database Survey

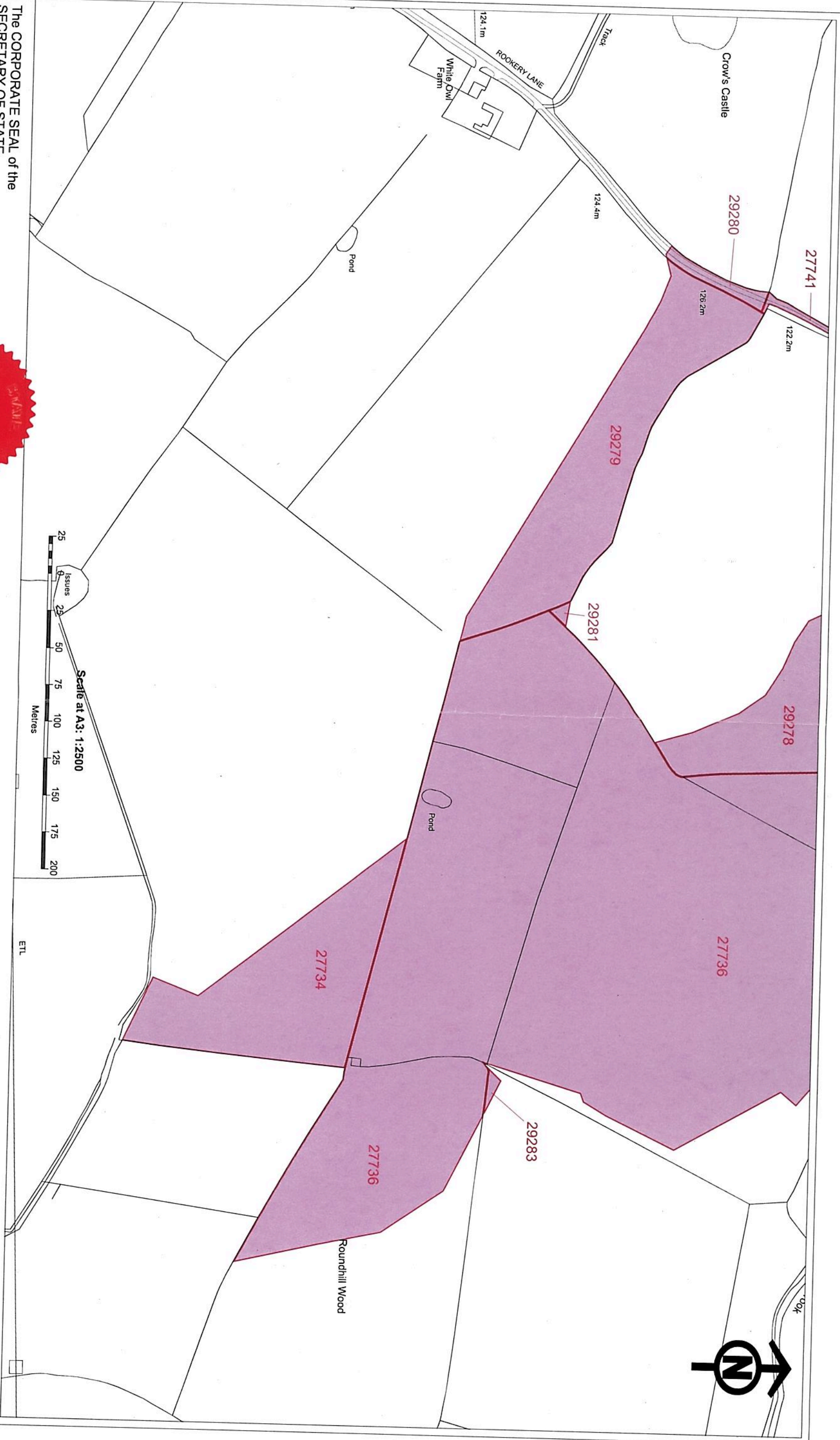

The CORPORATE SEAL of the
SECRETARY OF STATE
hereunto affixed to this deed
is authenticated by

[Signature]

Authorised by the Secretary of State for Transport

Dated 16th January 2020.



© Crown copyright and database right 2018. Ordnance Survey is the copyright owner of the data. All rights reserved. This information is reproduced with the permission of Land Registry under the provisions of the Commons Act 2006 and the Commons Act 2012.

