

HIGH SPEED RAIL (LONDON – WEST MIDLANDS) ACT 2017

HIGH SPEED RAIL (LONDON – WEST MIDLANDS) GENERAL VESTING DECLARATION No. 154

This **GENERAL VESTING DECLARATION** is executed on 2nd May 2019
by the Secretary of State for Transport ("the Authority").

WHEREAS:

- (1) On 23 February 2017 the High Speed Rail (London – West Midlands) Act 2017 ("the High Speed Rail Act") received Royal Assent authorising the Authority to acquire the land specified in the Schedule hereto.
- (2) Section 4(1) of the High Speed Rail Act authorises the Authority to acquire compulsorily so much of the land within the limits of the High Speed Rail Act as may be required for Phase One purposes¹.
- (3) Section 4(4) of the High Speed Rail Act provides that the Compulsory Purchase (Vesting Declarations) Act 1981 ("the 1981 Act") applies as if the High Speed Rail Act were a compulsory purchase order and paragraph 3² of Schedule 6 to the High Speed Rail Act provides that the 1981 Act shall have effect subject to the modifications specified in that paragraph.
- (4) Notice pursuant to section 3A³ of the 1981 Act was first published on 10 April 2019. That notice included the particulars specified in section 3A(3) of the 1981 Act.

NOW THIS DEED WITNESSETH that, in exercise of the powers conferred on it by section 4 of the 1981 Act, the Authority hereby declares:-

1. The land described in the Schedule hereto (being part of the land authorised to be acquired by the High Speed Rail Act) and more particularly delineated and shown coloured pink on the plan annexed hereto, together with the right to enter upon and take possession of the land, shall vest in the Authority as from the end of the period of 3 months from the date on which the service of notices required by section 6⁴ of the 1981 Act is completed.

For the purposes of Section 2(2) of the 1981 Act, the specified period in relation to the land comprised in this declaration is one year and one day.

1 Phase One Purposes has meaning given by section 67 of the High Speed Rail Act

2 Paragraph 3 as substituted by section 11 of, and paragraph 6 of Schedule 14 to, the High Speed Rail Act.

3 Section 3A of the 1981 Act as inserted by paragraph 3(a) of Schedule 6 to the High Speed Rail Act as substituted by section 11 of, and paragraphs 6 and 7 of Schedule 14 to, that Act.

4 Section 6 as modified by paragraph 3(c) of Schedule 6 to the High Speed Rail Act, as substituted by section 11 of, and paragraph 6 of Schedule 14 to, that Act

SCHEDULE

District of South Northamptonshire

(1) Plot No	(2) Plot Description
46459	All interests in 1237.3 square metres, or thereabouts, of public road and verges (Culworth Road)
46461	All interests in 46763.1 square metres, or thereabouts, of agricultural land, hedgerows, woodland and public footpath (AE28) (Beeches Farm)
46468	All interests in 477.2 square metres, or thereabouts, of access track and public footpaths (AE12 and AE20) (Beeches Farm)
46471	All interests in 8948.9 square metres, or thereabouts, of agricultural land, hedgerow, access track and public footpaths (AE12 and AE21) (Beeches Farm)
46495	All interests in 126371.1 square metres, or thereabouts, of agricultural land, woodland, pond, dismantled railway (Stratford-upon-Avon and Midland Junction), hedgerows and public footpath (AA8) (Manor Farm)
46504	All interests in 95.8 square metres, or thereabouts, of river, bed and banks thereof (Highfurlong Brook)
46507	All interests in 34976.9 square metres, or thereabouts, of agricultural land, woodland, hedgerows and public footpath (AC2) (Old House Farm)
48519	All interests in 18835.6 square metres, or thereabouts, of agricultural land (Old House Farm)
48620	All interests in 2161.3 square metres, or thereabouts, of agricultural land, woodland and public footpath (AE12) (Beeches Farm)

IN WITNESS WHEREOF the Secretary of State for Transport has hereunto set its corporate seal on the day in the year first written above.

The **CORPORATE SEAL** of the SECRETARY OF STATE FOR TRANSPORT hereunto affixed to this deed is authenticated by



.....

Authorised Signatory

Dated: 2nd May 2019

SEAL REF No. DF19538

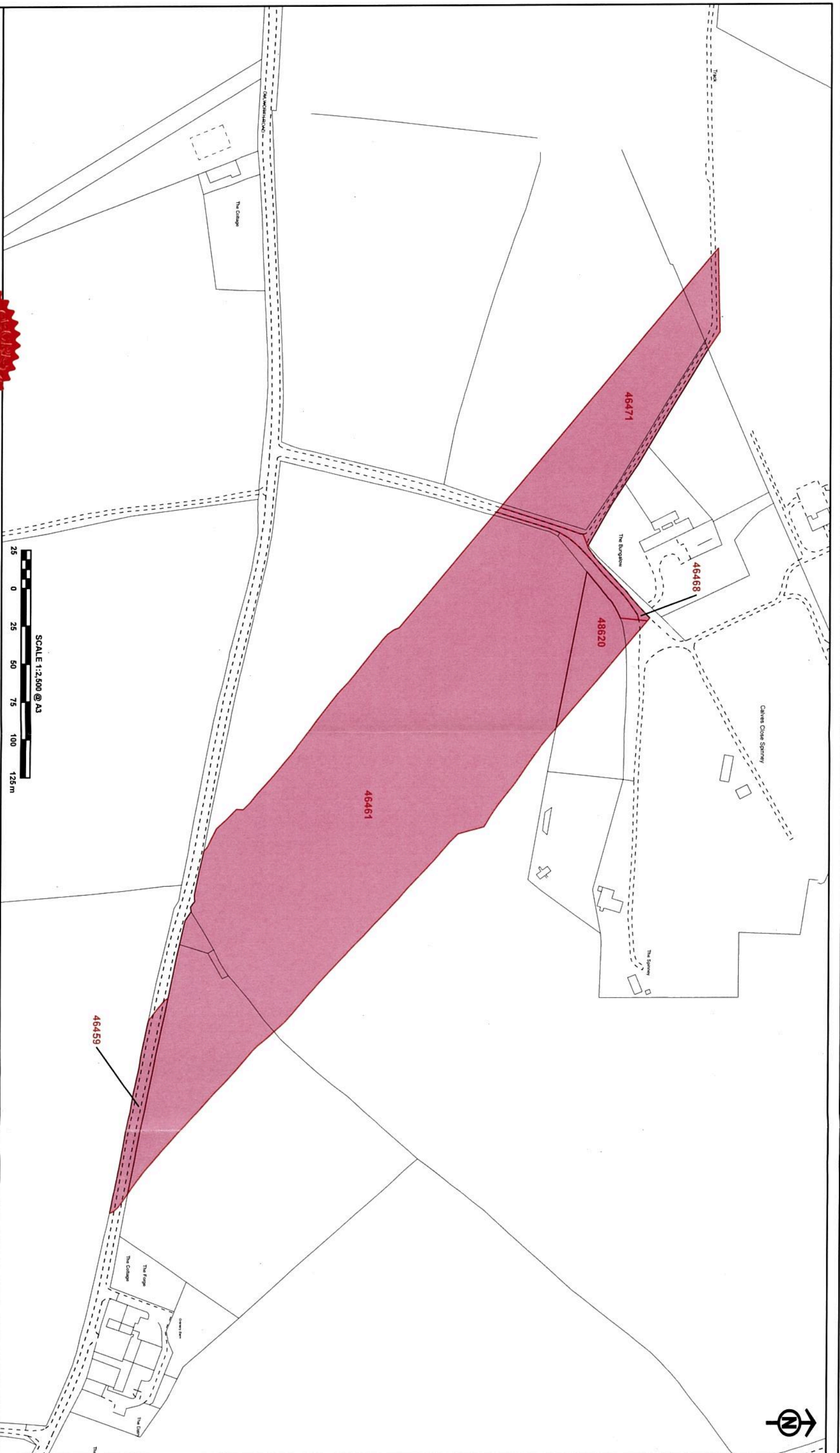



SCALE 1:2,500 @ A3
25 0 25 50 75 100 125m

The CORPORATE SEAL of the
SECRETARY OF STATE
hereunto affixed to this deed
is authenticated by

Authorised by the Secretary of State for Transport

Dated 2nd May 2019

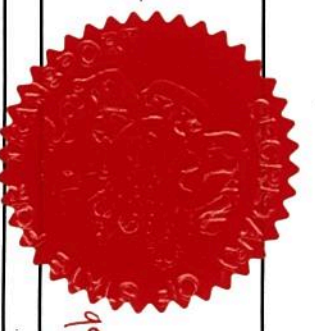

4938

© Crown copyright and database rights 2018 Ordnance Survey Licence Number 10004176
© Crown copyright material is reproduced with the permission of Land Registry under
licence from the Controller of HMSO and © Crown Copyright Ordnance Survey

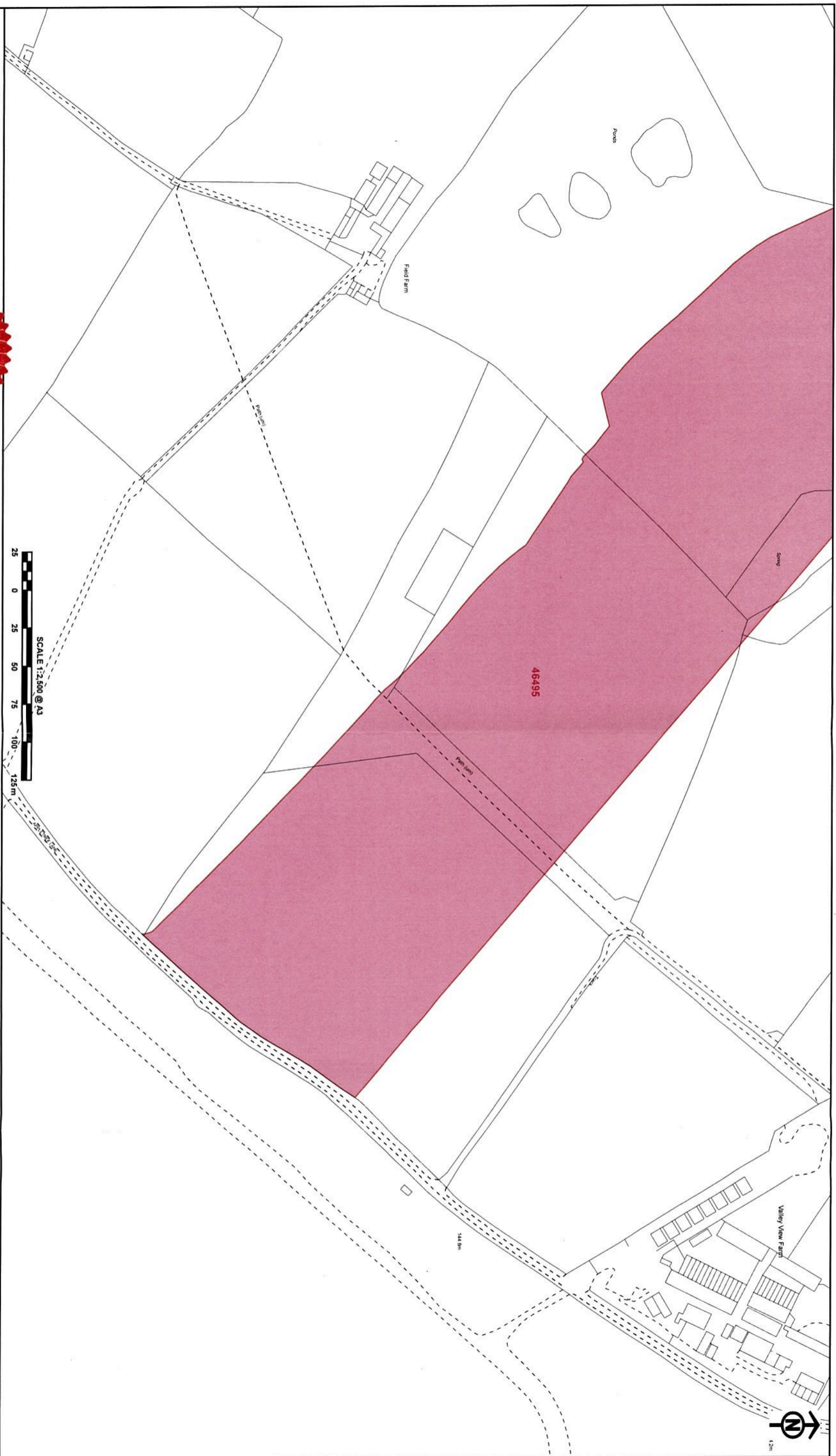

The CORPORATE SEAL of the
SECRETARY OF STATE
hereunto affixed to this deed
is authenticated by

Authorised by the Secretary of State for Transport

Dated 2nd May 2019

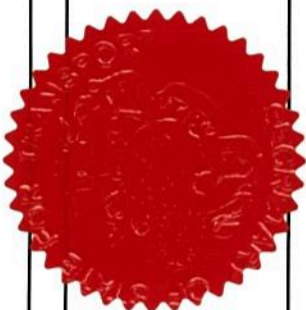

15358



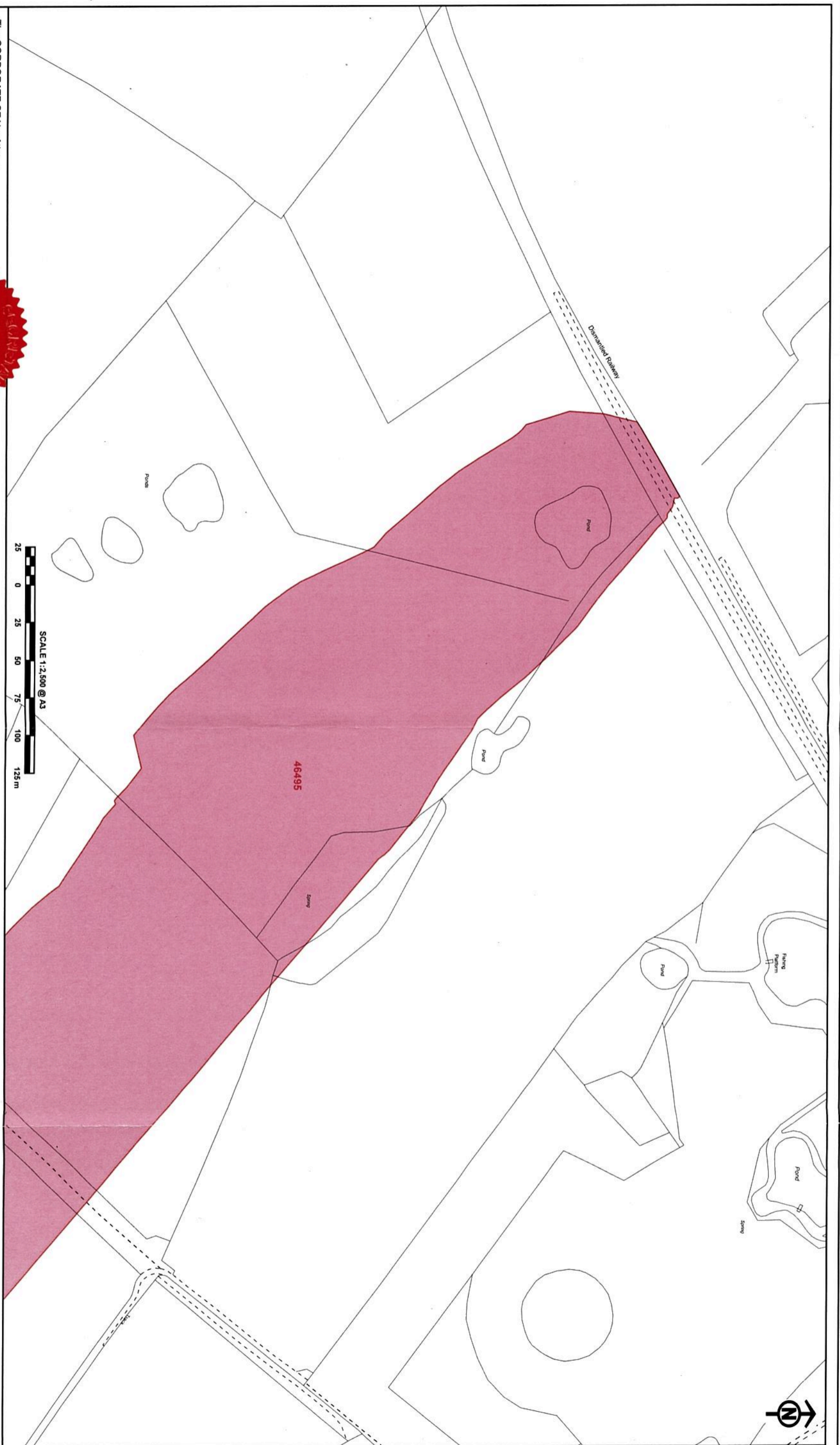

The CORPORATE SEAL of the
SECRETARY OF STATE
hereunto affixed to this order
is authenticated by

[Signature]

Authorised by the Secretary of State for Transport

Dated 2nd May 2019

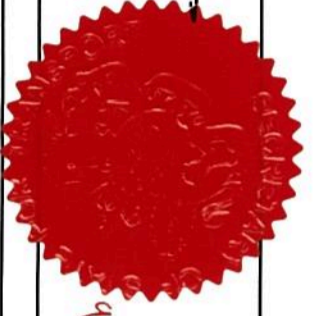

4938

© Crown copyright and database rights 2011 Ordnance Survey. Licence Number: 100049196
© Crown copyright material is reproduced with the permission of Land Registry under
imagery supplied from the Controller of HMSO and © Crown Copyright Ordnance Survey

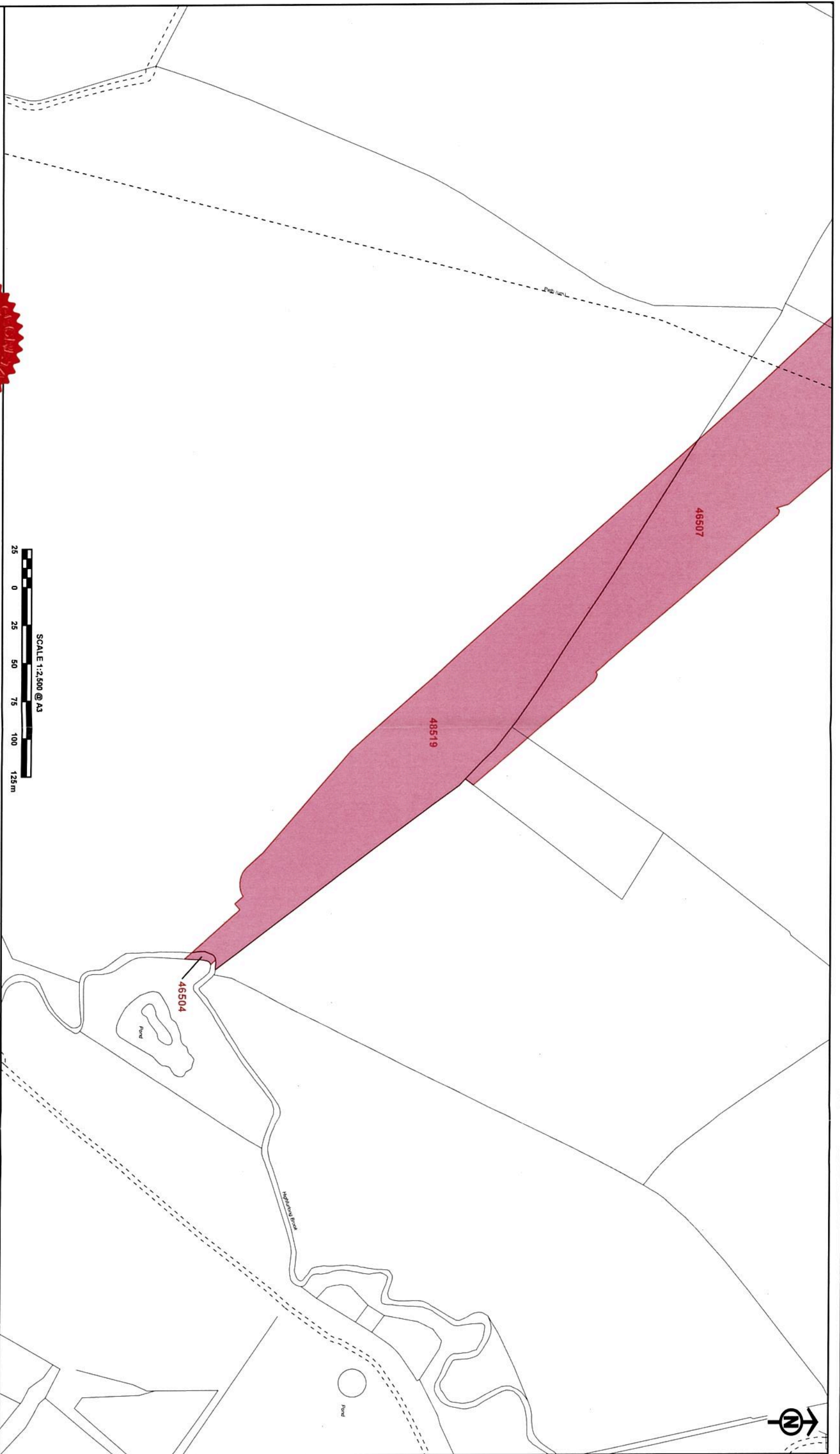

The CORPORATE SEAL of the
SECRETARY OF STATE
hereunto affixed to this Declaration
is authentic.

Authorised by the Secretary of State for Transport

Dated 2nd May 2019.

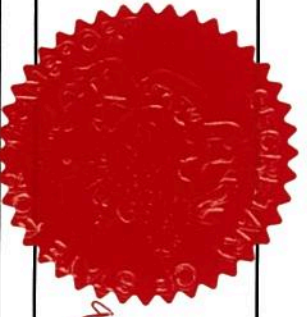

45358

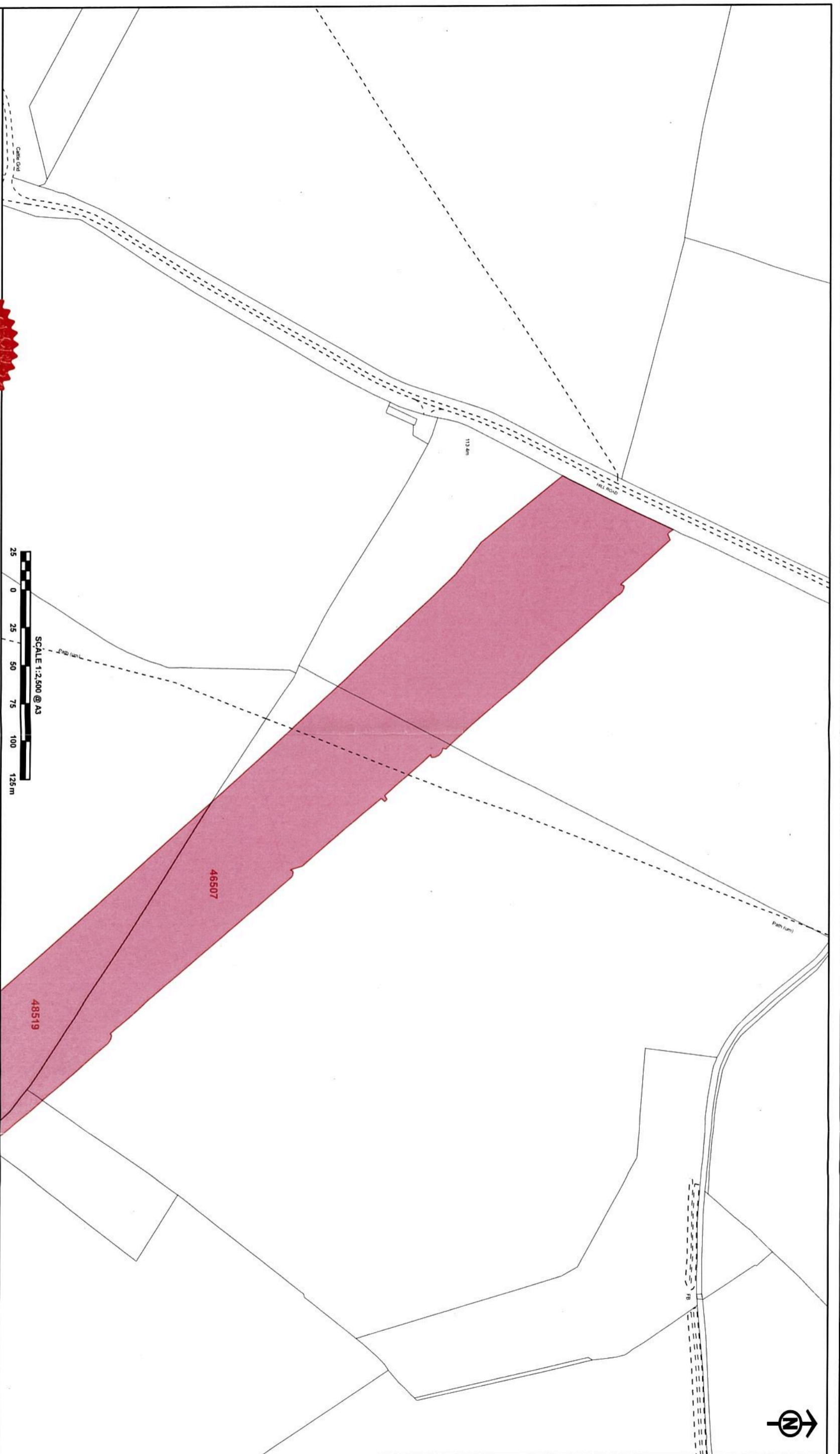

The CORPORATE SEAL of the
SECRETARY OF STATE
hereunto affixed to this deed
is authentic.

[Signature]
Authorised by the Secretary of State for Transport

Dated 2nd May 2019.

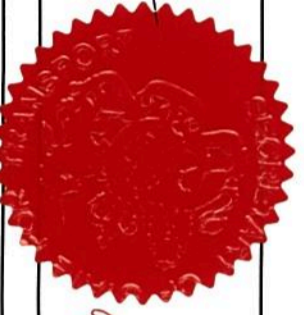

4538