

HIGH SPEED RAIL (LONDON – WEST MIDLANDS) ACT 2017

HIGH SPEED RAIL (LONDON – WEST MIDLANDS) GENERAL VESTING DECLARATION No. 441

This **GENERAL VESTING DECLARATION** is executed on
by the Secretary of State for Transport ("the Authority").

5th October 2020

WHEREAS:

- (1) On 23 February 2017 the High Speed Rail (London – West Midlands) Act 2017 ("the High Speed Rail Act") received Royal Assent authorising the Authority to acquire the land specified in the Schedule hereto.
- (2) Section 4(1) of the High Speed Rail Act authorises the Authority to acquire compulsorily so much of the land within the limits of the High Speed Rail Act as may be required for Phase One purposes¹.
- (3) Section 4(4) of the High Speed Rail Act provides that the Compulsory Purchase (Vesting Declarations) Act 1981 ("the 1981 Act") applies as if the High Speed Rail Act were a compulsory purchase order and paragraph 3² of Schedule 6 to the High Speed Rail Act provides that the 1981 Act shall have effect subject to the modifications specified in that paragraph.
- (4) Notice pursuant to section 3A³ of the 1981 Act was first published on 16 September 2020. That notice included the particulars specified in section 3A(3) of the 1981 Act.

NOW THIS DEED WITNESSETH that, in exercise of the powers conferred on it by section 4 of the 1981 Act, the Authority hereby declares:-

1. The land described in the Schedule hereto (being part of the land authorised to be acquired by the High Speed Rail Act) and more particularly delineated and shown coloured pink on the plan annexed hereto, together with the right to enter upon and take possession of the land and to win and work the mines and minerals comprised therein⁴, shall vest in the Authority as from the end of the period of 3 months from the date on which the service of notices required by section 6⁵ of the 1981 Act is completed.

For the purposes of Section 2(2) of the 1981 Act, the specified period in relation to the land comprised in this declaration is one year and one day.

¹ Phase One Purposes has meaning given by section 67 of the High Speed Rail Act.

² Paragraph 3 as substituted by section 11 of, and paragraph 6 of Schedule 14 to, the High Speed Rail Act.

³ Section 3A of the 1981 Act as inserted by paragraph 3(a) of Schedule 6 to the High Speed Rail Act as substituted by section 11 of, and paragraphs 6 and 7 of Schedule 14 to, that Act.

⁴ Paragraph 4(2) of Schedule 6 to the High Speed Rail Act applies Parts 2 and 3 of Schedule 2 to the Acquisition of Land Act 1981 (exception of minerals from compulsory purchase and regulation of working of mines or minerals underlying and authorised undertaking) to land to which Section 4(1) of the High Speed Rail Act applies, as if it were comprised in a compulsory purchase order providing for the incorporation with that Order of those Parts of that Schedule.

⁵ Section 6 as modified by paragraph 3(c) of Schedule 6 to the High Speed Rail Act, as substituted by section 11 of, and paragraph 6 of Schedule 14 to, that Act.

SCHEDULE

Metropolitan Borough of Solihull

(1) Plot No	(2) Plot Description
52198	All interests in 126,937.93 square metres, or thereabouts, of agricultural land, woodlands (Park Lane Spinney and Marlowes), tracks and public footpaths (M214 and M215) (Kenilworth Road, A452)
52199	All interests in 33,599.57 square metres, or thereabouts, of agricultural land, woodland (Sixteen Acre Wood) and public footpath (M216) (Kenilworth Road, A452)
52200	All interests in 23,603.53 square metres, or thereabouts, of woodland (Sixteen Acre Wood) (Kenilworth Road, A452)
52201	All interests in 697.9 square metres, or thereabouts, of agricultural land and wooded area (Kenilworth Road, A452)
52202	All interests in 498.1 square metres, or thereabouts, of private access road, verges and public footpath (M216) (Kenilworth Road, A452)
52203	All interests in 47.89 square metres, or thereabouts, of garden (Marsh Cottage) (Kenilworth Road, A452) excluding any interest held by the Secretary of State for Transport
52204	All interests in 65,821.5 square metres, or thereabouts, of agricultural land, stream (Bayley`s Brook) and public footpath (M217) (Kenilworth Road, A452)
52205	All interests in 35,884.43 square metres, or thereabouts, of agricultural land and stream (Bayley's Brook) (Kenilworth Road, A452)
52206	All interests in 2,670.15 square metres, or thereabouts, of private road, verges and public bridleway (M218) (Kenilworth Road, A452)
52207	All interests in 26.47 square metres, or thereabouts, of agricultural land (Marsh Lane)
52208	All interests in 250.82 square metres, or thereabouts, of agricultural land (Kenilworth Road, A452)
52209	All interests in 1,512.48 square metres, or thereabouts, of agricultural land (Marsh Lane Nature Reserve) (Kenilworth Road, A452)
52210	All interests in 110,379.63 square metres, or thereabouts, of agricultural land, tracks and watercourse (Kenilworth Road, A452)
52211	All interests in 4,745.11 square metres, or thereabouts, of agricultural land and watercourse (Kenilworth Road, A452)
52212	All interests in 21.53 square metres, or thereabouts, of wooded area (Kenilworth Road, A452)
52213	All interests in 11,865.89 square metres, or thereabouts, of agricultural land and stream (Horn Brook) (Kenilworth Road, A452)
52214	All interests in 8,849.38 square metres, or thereabouts, of agricultural land, wooded area and stream (Horn Brook) (Kenilworth Road, A452)
52215	All interests in 98,826.14 square metres, or thereabouts, of public roads, verges, lay-bys, footway, subway, wooded area and streams partly in culverts (Bayley's Brook and Horn Brook) (Marsh Lane and Kenilworth Road, A452) excluding any interests held by the Secretary of State for Transport

IN WITNESS WHEREOF the Secretary of State for Transport has hereunto set its corporate seal on the day in the year first written above.

The **CORPORATE SEAL** of the SECRETARY OF STATE FOR TRANSPORT hereunto affixed to this deed is authenticated by



.....

Authorised Signatory

Dated : 5th October 2020

SEAL REF
DfT GP / 0294

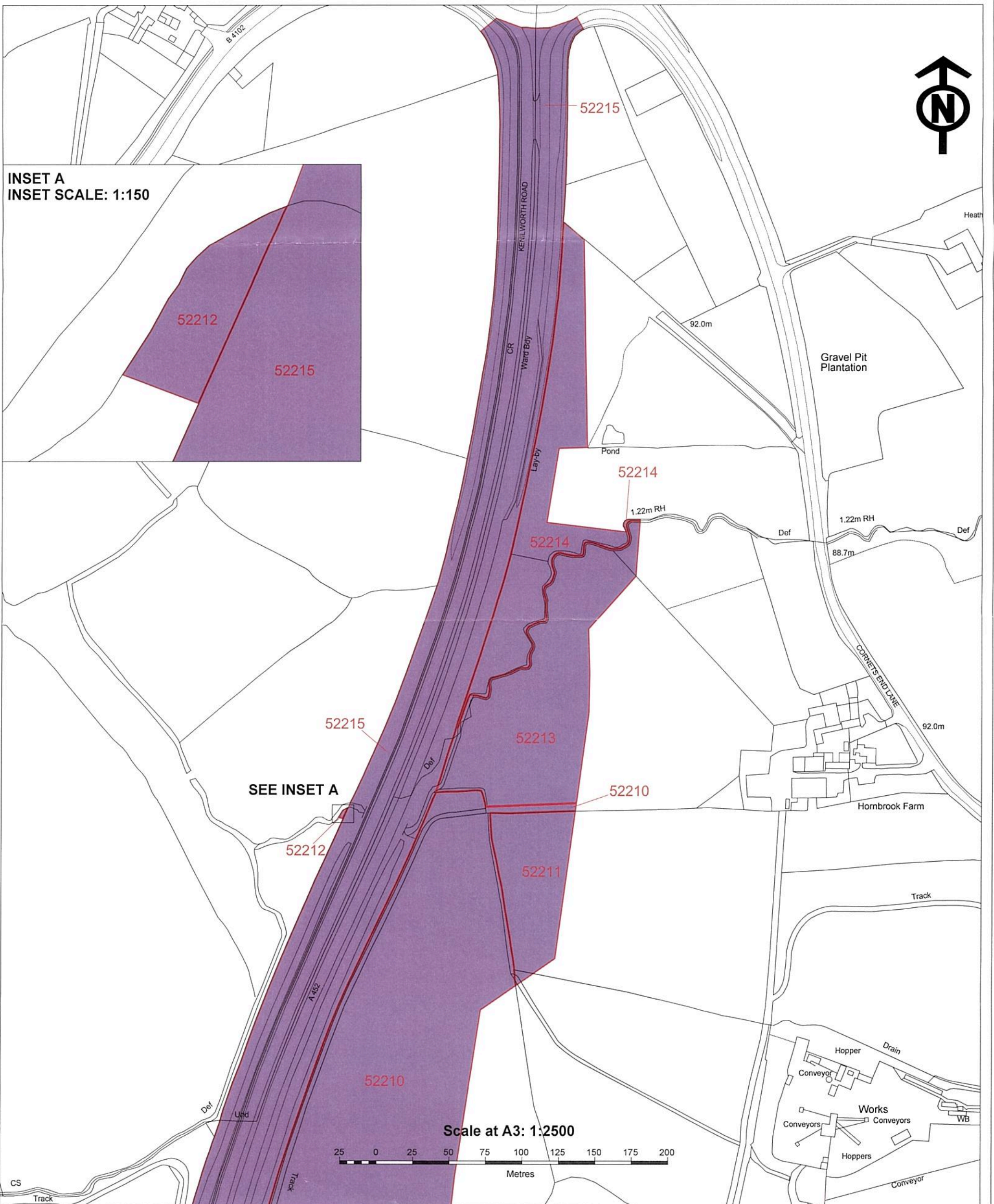



INSET A
INSET SCALE: 1:150



SEE INSET A

The CORPORATE SEAL of the
SECRETARY OF STATE
hereunto affixed to this deed
is authenticated by

Authorised by the Secretary of State for Transport

Dated 5th October 2020



0294

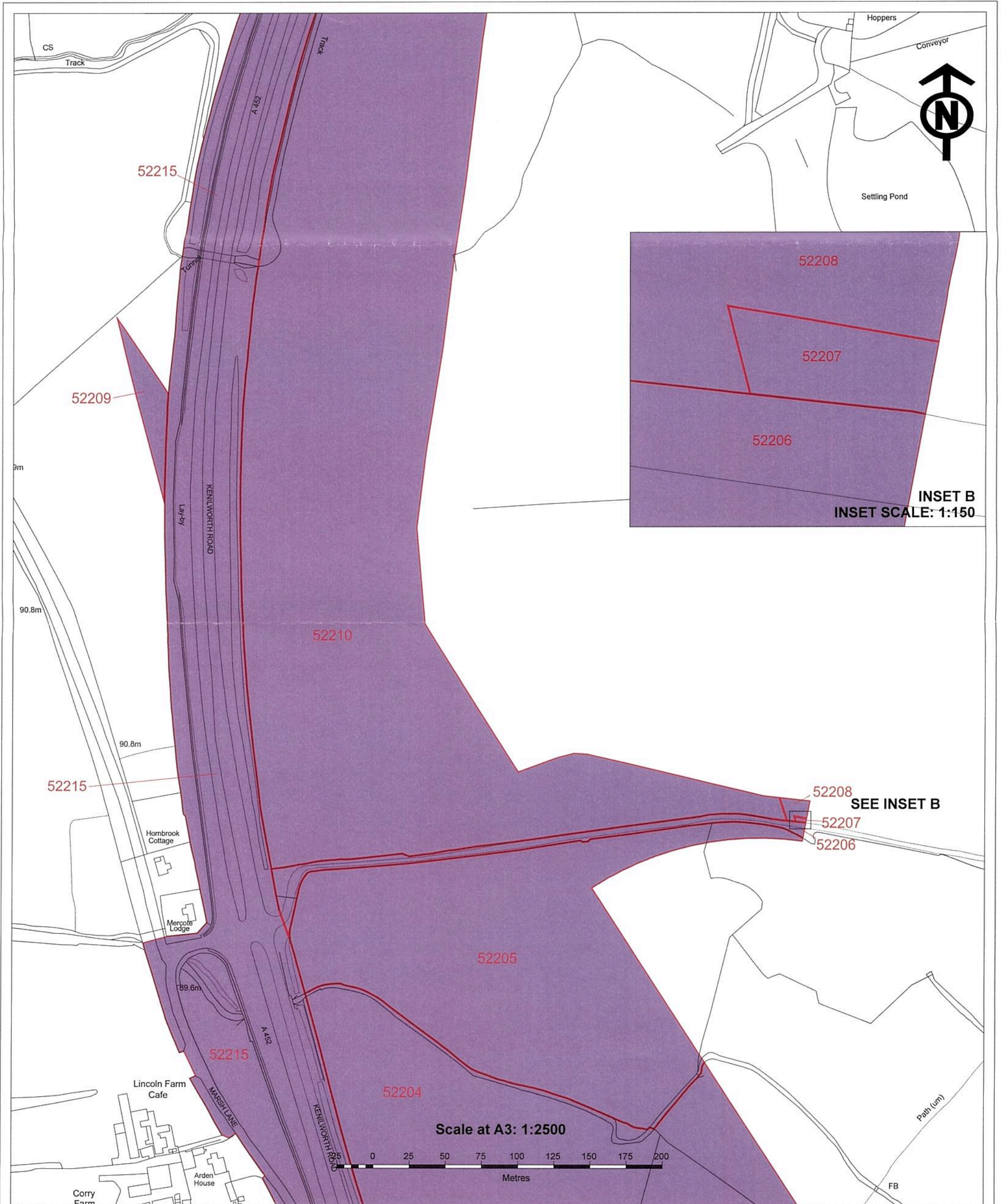

The CORPORATE SEAL of the
SECRETARY OF STATE
hereunto affixed to this deed
is authenticated by

[Signature]
.....
Authorised by the Secretary of State for Transport

Dated 5th October 2020

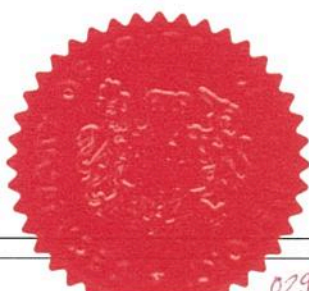

0294



The CORPORATE SEAL of the
SECRETARY OF STATE
hereunto affixed to this deed
is authenticated by

[Signature]

Authorised by the Secretary of State for Transport

Dated 5th October 2020





The CORPORATE SEAL of the
SECRETARY OF STATE
hereunto affixed to this deed
is authenticated by

Authorised by the Secretary of State for Transport

Dated 5th October 2020



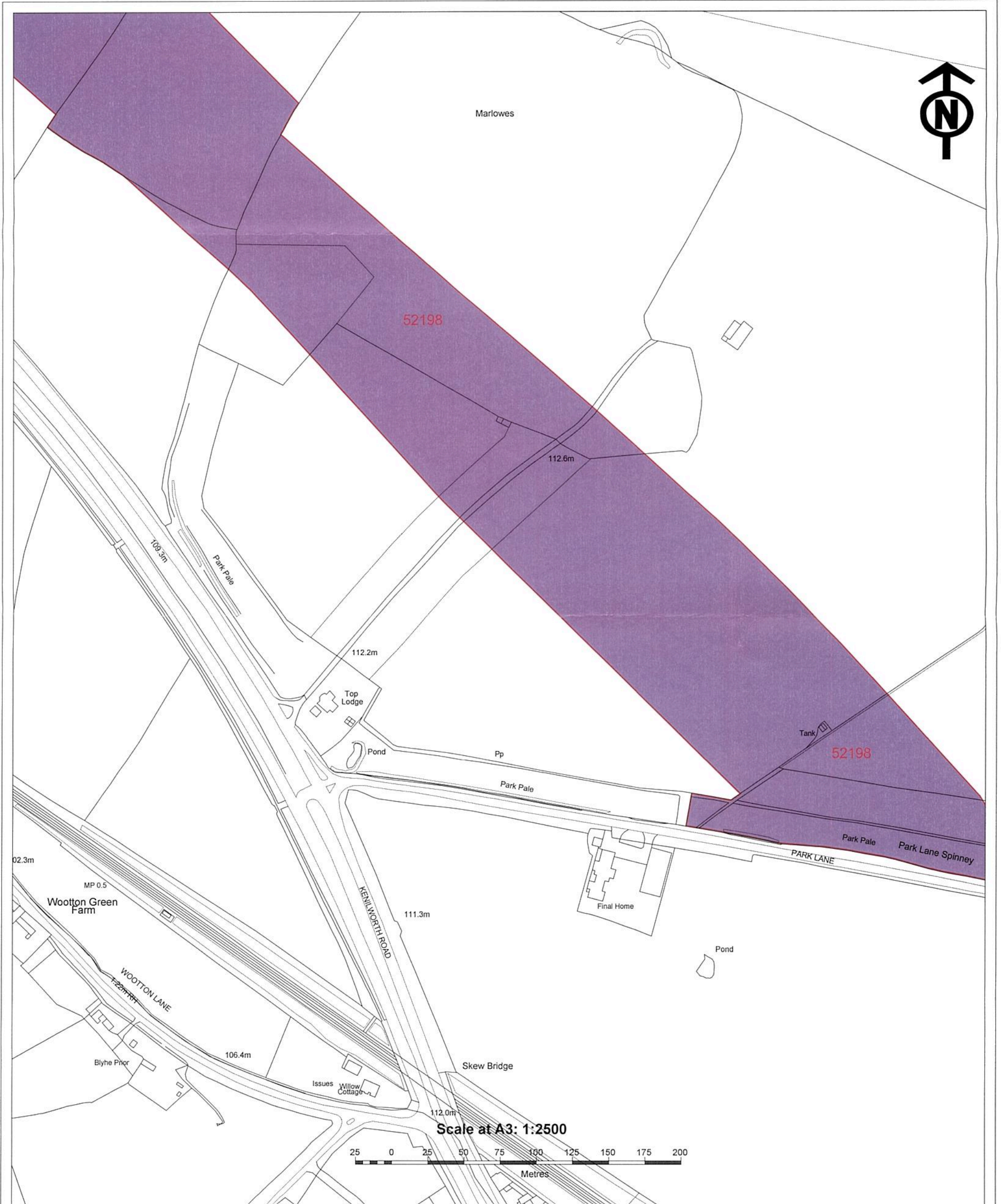

The CORPORATE SEAL of the
SECRETARY OF STATE
hereunto affixed to this deed
is authenticated by

.....
Authorised by the Secretary of State for Transport

Dated 5th October 2020





Registered in England. Registration Number 06791686.
Registered office: 2 Snowhill, Queensway, Birmingham, B4 6GA.

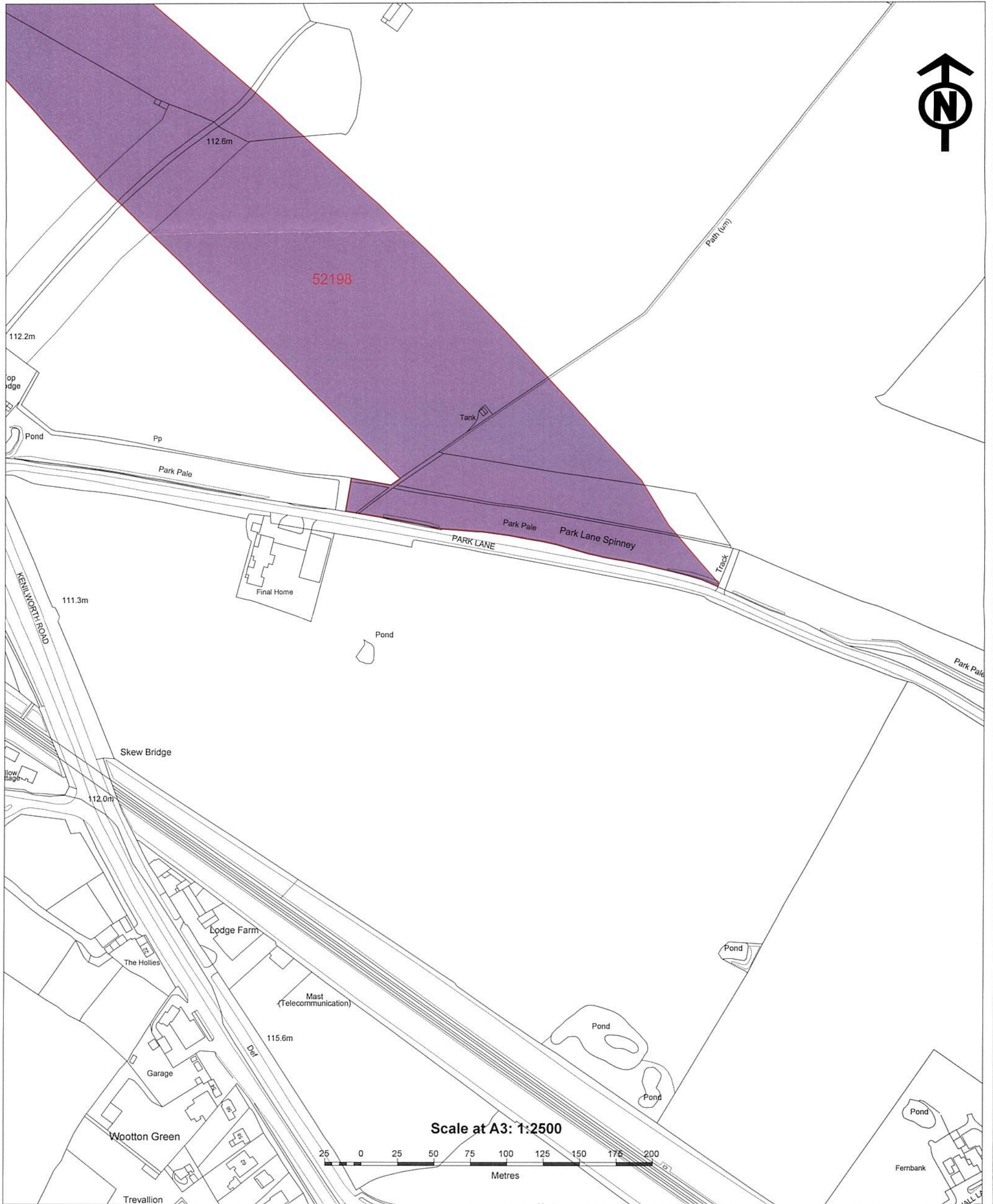

The CORPORATE SEAL of the
SECRETARY OF STATE
hereunto affixed to this deed
is authenticated by

.....
Authorised by the Secretary of State for Transport

Dated 5th October 2020



