

HIGH SPEED RAIL (LONDON – WEST MIDLANDS) ACT 2017

HIGH SPEED RAIL (LONDON – WEST MIDLANDS) GENERAL VESTING DECLARATION No. 297

This **GENERAL VESTING DECLARATION** is executed on 19th November 2019 by the Secretary of State for Transport ("the Authority").

WHEREAS:

- (1) On 23 February 2017 the High Speed Rail (London – West Midlands) Act 2017 ("the High Speed Rail Act") received Royal Assent authorising the Authority to acquire the land specified in the Schedule hereto.
- (2) Section 4(1) of the High Speed Rail Act authorises the Authority to acquire compulsorily so much of the land within the limits of the High Speed Rail Act as may be required for Phase One purposes¹.
- (3) Section 4(4) of the High Speed Rail Act provides that the Compulsory Purchase (Vesting Declarations) Act 1981 ("the 1981 Act") applies as if the High Speed Rail Act were a compulsory purchase order and paragraph 3² of Schedule 6 to the High Speed Rail Act provides that the 1981 Act shall have effect subject to the modifications specified in that paragraph.
- (4) Notice pursuant to section 3A³ of the 1981 Act was first published on 17 October 2019. That notice included the particulars specified in section 3A(3) of the 1981 Act.

NOW THIS DEED WITNESSETH that, in exercise of the powers conferred on it by section 4 of the 1981 Act, the Authority hereby declares:-

1. The land described in the Schedule hereto (being part of the land authorised to be acquired by the High Speed Rail Act) and more particularly delineated and shown coloured pink on the plan annexed hereto, together with the right to enter upon and take possession of the land, shall vest in the Authority as from the end of the period of 3 months from the date on which the service of notices required by section 6⁴ of the 1981 Act is completed.

For the purposes of Section 2(2) of the 1981 Act, the specified period in relation to the land comprised in this declaration is one year and one day.

1 Phase One Purposes has meaning given by section 67 of the High Speed Rail Act

2 Paragraph 3 as substituted by section 11 of, and paragraph 6 of Schedule 14 to, the High Speed Rail Act.

3 Section 3A of the 1981 Act as inserted by paragraph 3(a) of Schedule 6 to the High Speed Rail Act as substituted by section 11 of, and paragraphs 6 and 7 of Schedule 14 to, that Act.

4 Section 6 as modified by paragraph 3(c) of Schedule 6 to the High Speed Rail Act, as substituted by section 11 of, and paragraph 6 of Schedule 14 to, that Act

SCHEDULE

London Borough of Hillingdon

(1) Plot No	(2) Plot Description
40998	All interests in 10486.0 square metres, or thereabouts, of lake (Hillingdon Outdoor Activities Centre)
46920	All interests in 466.5 square metres, or thereabouts, of public road and verge (Moorhall Road)
46951	All interests in 13786.5 square metres, or thereabouts, of lake, woodland, pond and access track (Savay Lake)
47407	All interests in 2788.8 square metres, or thereabouts, of grassland, woodland, outbuildings, hardstanding and access track (Hillingdon Outdoor Activities Centre)
47414	All interests in 77.4 square metres, or thereabouts, of hardstanding (Dews Farm Pumping Station)
47415	All interests in 200.8 square metres, or thereabouts, of access track and verge (Hillingdon Outdoor Activities Centre)
48973	All interests in 0.8 square metres, or thereabouts, of woodland (Blackford Pumping Station)
48974	All interests in 431.1 square metres, or thereabouts, of agricultural land (Blackford Pumping Station)
49368	All interests in 842.4 square metres, or thereabouts, of woodland, access track, public footpaths (Colne Valley Trail and London Loop) and permissive bridleway (Denham Quarries) (Hillingdon Outdoor Activities Centre)
49933	All interests in 849.2 square metres, or thereabouts, of woodland, access track and lake (Blackford Pumping Station)
61195	All interests in 11.5 square metres, or thereabouts, of hardstanding (Hillingdon Outdoor Activities Centre)
61201	All interests in 791.2 square metres, or thereabouts, of lake (Hillingdon Outdoor Activities Centre)
61202	All interests in 235.0 square metres, or thereabouts, of lake (Hillingdon Outdoor Activities Centre)
61435	All interests in 4163.2 square metres, or thereabouts, of agricultural land, woodland, access track and public footpath (U34) (Hillingdon Outdoor Activities Centre)

IN WITNESS WHEREOF the Secretary of State for Transport has hereunto set its corporate seal on the day in the year first written above.

The **CORPORATE SEAL** of the SECRETARY OF STATE FOR TRANSPORT hereunto affixed to this deed is authenticated by

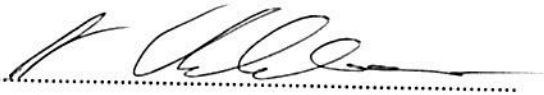

.....

Authorised Signatory

Dated: 19th November 2019

SEAL REF NO
DFT/ 9403

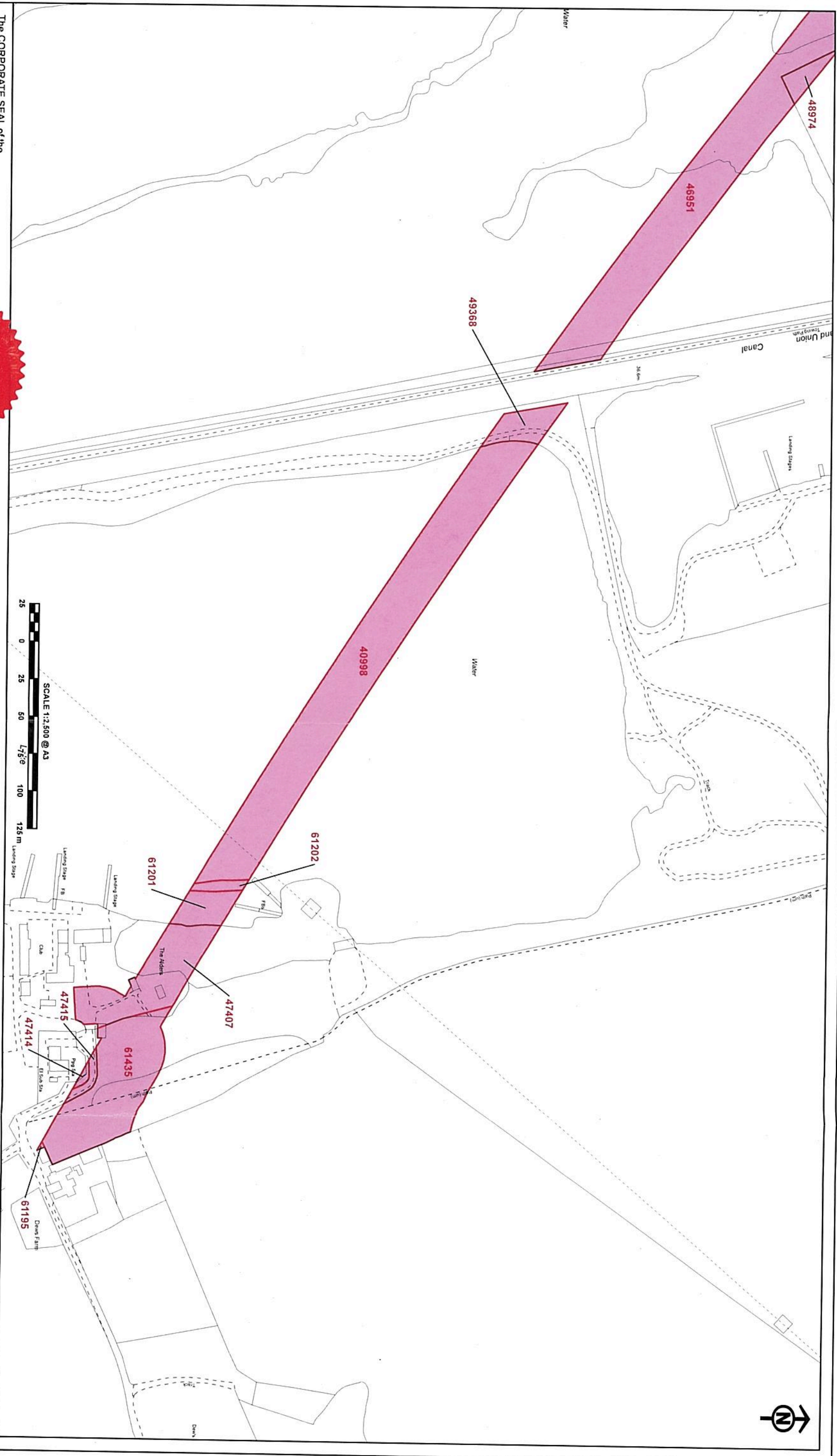



The CORPORATE SEAL of the
SECRETARY OF STATE
hereunto affixed to this deed
is authenticated by

Authorised by the Secretary of State for Transport

Dated 19th November 2019

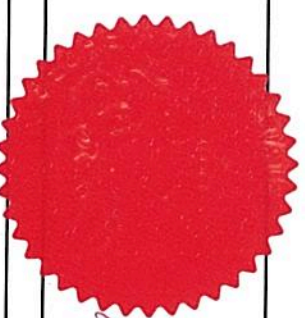

9403

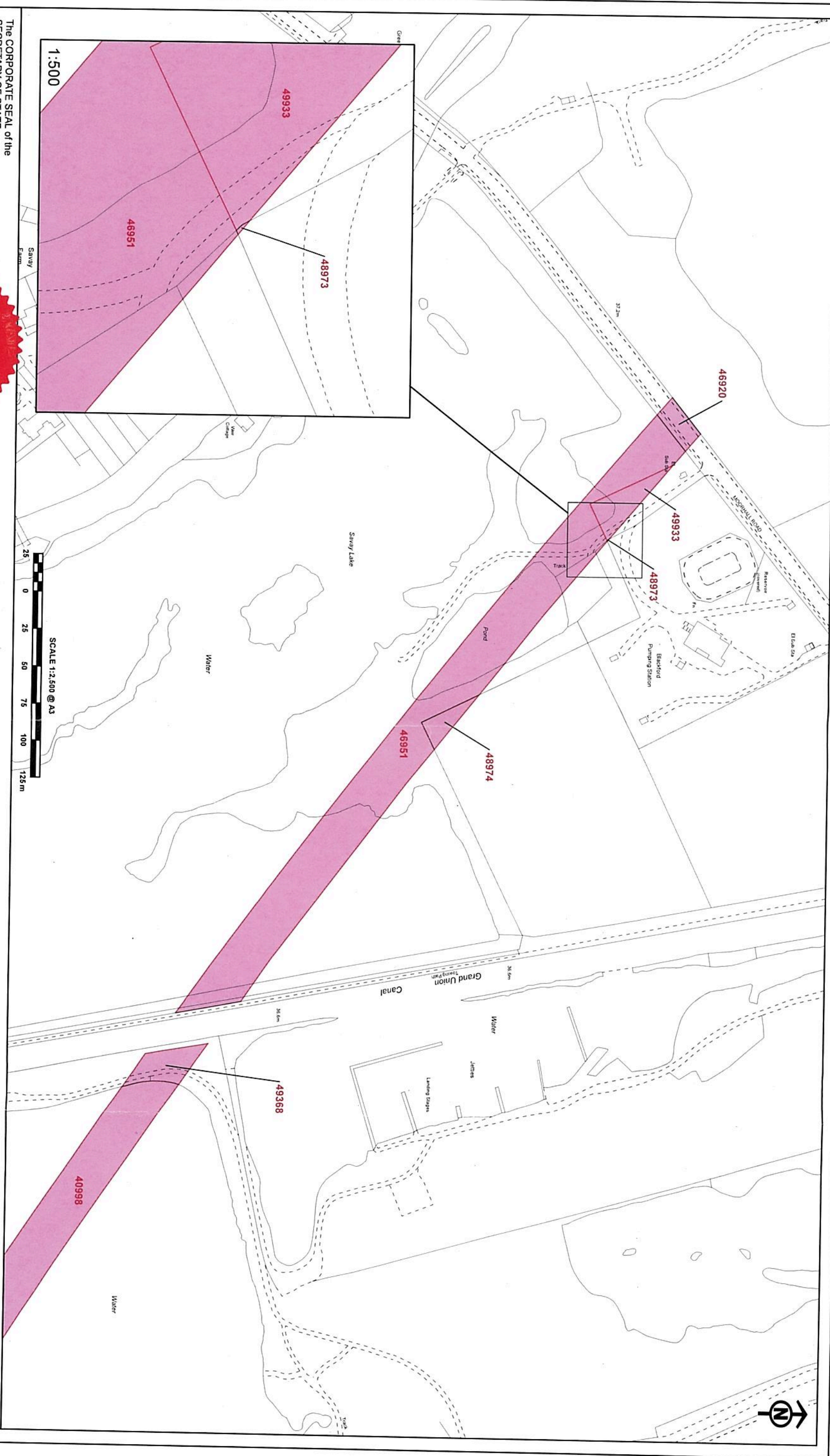

The CORPORATE SEAL of the
SECRETARY OF STATE
hereunto affixed to this deed
is authenticated by

Authorised by the Secretary of State for Transport

Dated 19th November 2019



9403

