

HIGH SPEED RAIL (LONDON – WEST MIDLANDS) ACT 2017

HIGH SPEED RAIL (LONDON – WEST MIDLANDS) GENERAL VESTING DECLARATION No. 573

This **GENERAL VESTING DECLARATION** is executed on
by the Secretary of State for Transport ("the Authority").

30th September 2021

WHEREAS:

- (1) On 23 February 2017 the High Speed Rail (London – West Midlands) Act 2017 ("the High Speed Rail Act") received Royal Assent authorising the Authority to acquire the land specified in the Schedule hereto.
- (2) Section 4(1) of the High Speed Rail Act authorises the Authority to acquire compulsorily so much of the land within the limits of the High Speed Rail Act as may be required for Phase One purposes¹.
- (3) Section 4(4) of the High Speed Rail Act provides that the Compulsory Purchase (Vesting Declarations) Act 1981 ("the 1981 Act") applies as if the High Speed Rail Act were a compulsory purchase order and paragraph 3² of Schedule 6 to the High Speed Rail Act provides that the 1981 Act shall have effect subject to the modifications specified in that paragraph.
- (4) Notice pursuant to section 3A³ of the 1981 Act was first published on 25 August 2021. That notice included the particulars specified in section 3A(3) of the 1981 Act.

NOW THIS DEED WITNESSETH that, in exercise of the powers conferred on it by section 4 of the 1981 Act, the Authority hereby declares:-

1. The land described in the Schedule hereto (being part of the land authorised to be acquired by the High Speed Rail Act) and more particularly delineated and shown coloured pink on the plan annexed hereto, together with the right to enter upon and take possession of the land, shall vest in the Authority as from the end of the period of 3 months from the date on which the service of notices required by section 6⁴ of the 1981 Act is completed.

For the purposes of Section 2(2) of the 1981 Act, the specified period in relation to the land comprised in this declaration is one year and one day.

1 Phase One Purposes has meaning given by section 67 of the High Speed Rail Act

2 Paragraph 3 as substituted by section 11 of, and paragraph 6 of Schedule 14 to, the High Speed Rail Act.

3 Section 3A of the 1981 Act as inserted by paragraph 3(a) of Schedule 6 to the High Speed Rail Act as substituted by section 11 of, and paragraphs 6 and 7 of Schedule 14 to, that Act.

4 Section 6 as modified by paragraph 3(c) of Schedule 6 to the High Speed Rail Act, as substituted by section 11 of, and paragraph 6 of Schedule 14 to, that Act

SCHEDULE

Buckinghamshire

(1) Plot No.	(2) Description
61636	All interests in 4040.4 square metres, or thereabouts, of construction site, pylon and overhead electricity cables (Old Shire Lane)
64818	All interests in 19752.2 square metres, or thereabouts, of agricultural land and woodland (Little Halings)
64828	All interests in 106382.8 square metres, or thereabouts, of agricultural land (Denham Park Farm)
64890	All interests in 44.0 square metres, or thereabouts, of construction site and public bridleway (CSP/44/1) (Chalfont Lane)
64891	All interests in 36.8 square metres, or thereabouts, of grassland (Chalfont Lane)
64904	All interests in 190.2 square metres, or thereabouts, of verge (Shire Lane)
64905	All interests in 220.2 square metres, or thereabouts, of public road and verges (Shire Lane)
69843	All interests in 265.7 square metres, or thereabouts, of verge and grassland (Shire Lane)
69844	All interests in 8.1 square metres, or thereabouts, of woodland and verge (North Orbital Road)
69846	All interests in 127.2 square metres, or thereabouts, of access road (Shire Lane)
69868	All interests in 51.2 square metres, or thereabouts, of woodland and verge (North Orbital Road)
71194	All interests in 28.6 square metres, or thereabouts, of construction site and public bridleway (CSP/44/1) (Chalfont Lane)

District of Three Rivers

(1) Plot No.	(2) Description
63423	All interests in 26.5 square metres, or thereabouts, of verge (Chalfont Lane)
64528	All interests in 32.8 square metres, or thereabouts, of access track (Chalfont Lane)
64529	All interests in 9.9 square metres, or thereabouts, of verge (Chalfont Lane)
64858	All interests in 3013.1 square metres, or thereabouts, of agricultural land (Home Farm)
64872	All interests in 3983.8 square metres, or thereabouts, of agricultural land and public bridleway (Rickmansworth 004) (Home Farm)
64885	All interests in 29484.6 square metres, or thereabouts, of agricultural land, hedgerow and verge (Chalfont Lane)
64889	All interests in 3263.2 square metres, or thereabouts, of agricultural land (Chalfont Lane)

IN WITNESS WHEREOF the Secretary of State for Transport has hereunto set its corporate seal on the day in the year first written above.

The **CORPORATE SEAL** of the SECRETARY OF STATE FOR TRANSPORT hereunto affixed to this deed is authenticated by

.....

Authorised Signatory

Dated : 30th September 2021

SEAL REF
DfT GP / 0690



64907	All interests in 41012.6 square metres, or thereabouts, of agricultural land, hedgerow, pylon and overhead electricity cables and public footpath (Rickmansworth 005) (Chalfont Lane)
64909	All interests in 22708.3 square metres, or thereabouts, of verge, agricultural land, drain and public footpath (Rickmansworth 005A) (Hornhill Road)
69845	All interests in 12228.5 square metres, or thereabouts, of construction site, verge, access splay and pylon and overhead electricity cables (Chalfont Lane)
69847	All interests in 515.7 square metres, or thereabouts, of verge (Shire Lane)
69848	All interests in 801.1 square metres, or thereabouts, of access road (Shire Lane)
69849	All interests in 4463.6 square metres, or thereabouts, of access road, access splays and public footpath (Rickmansworth 005A) (Link Road)
69850	All interests in 15988.6 square metres, or thereabouts, of verge, agricultural land and public footpath (Rickmansworth 005A) (Link Road)
69869	All interests in 2204.9 square metres, or thereabouts, of access road (Chalfont Lane)
70426	All interests in 25.7 square metres, or thereabouts, of verge (Chalfont Lane)
70427	All interests in 1231.8 square metres, or thereabouts, of construction site (Chalfont Lane)



The CORPORATE SEAL of the
SECRETARY OF STATE
hereunto affixed to this deed
is authenticated by

Authorised by the Secretary of State for Transport
Dated 30th September 2021



0690

© Crown copyright and database right 2021 Ordnance Survey Licence Number: 100049130
Designed and printed from the Corporation of HMJD and G. Crown Copyright. Ordnance Survey
is a registered trademark of the Ordnance Survey Corporation.

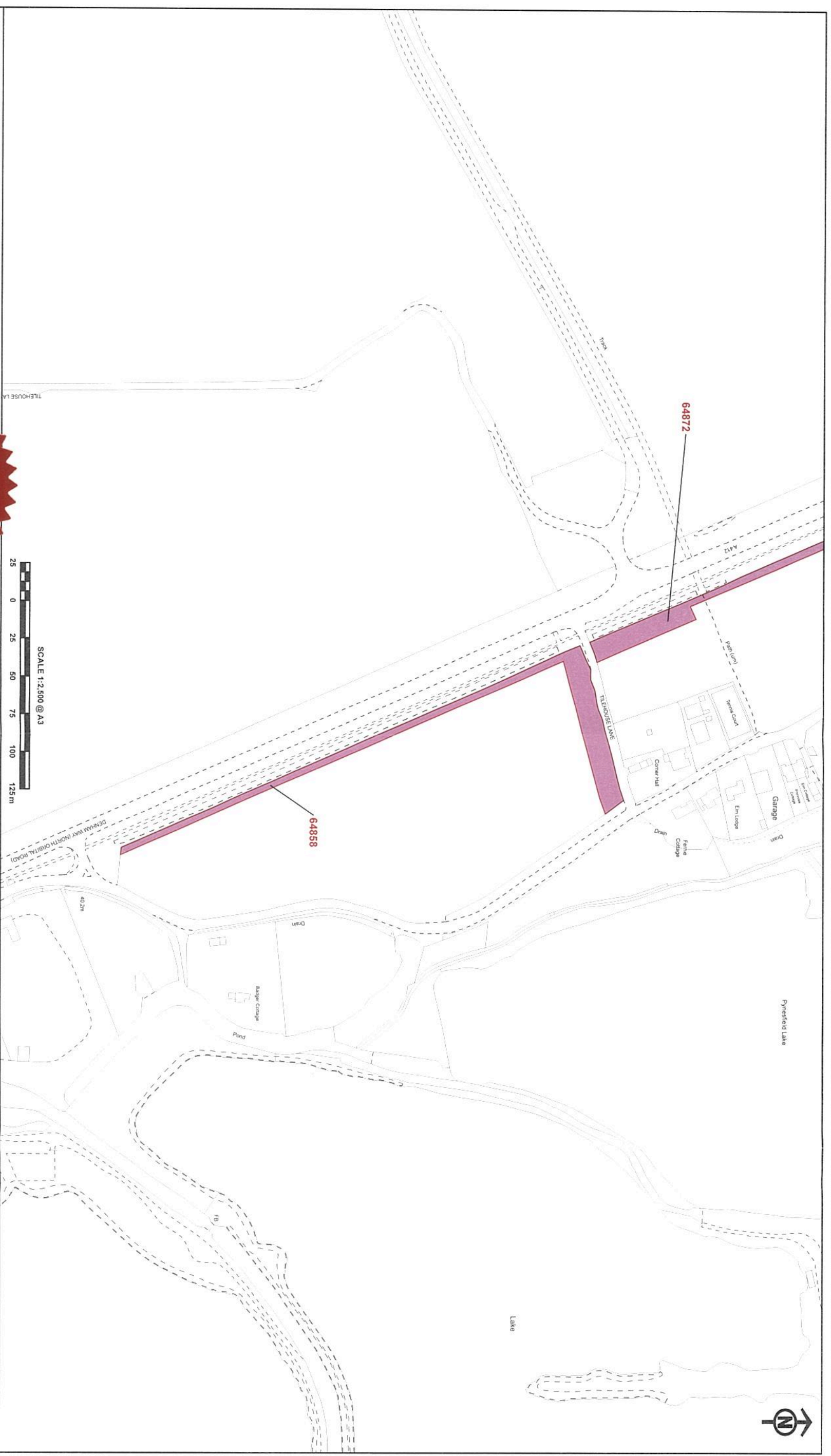

The CORPORATE SEAL of the
SECRETARY OF STATE
hereunto affixed to this deed
is authenticated by

.....
Authorised by the Secretary of State for Transport

Dated 30th September 2021



0640

© Crown copyright and database rights 2021 Ordnance Survey Licence Number: 100019190
Information derived from the Ordnance Survey of Great Britain and other Crown Copyright/Ordnance Survey data



The CORPORATE SEAL of the
SECRETARY OF STATE
hereunto affixed to this deed
is authenticated by

[Signature]

Authorised by the Secretary of State for Transport
Dated 30th September 2021



0690



The CORPORATE SEAL of the
 SECRETARY OF STATE
 hereunto affixed to this deed
 is authenticated by

[Signature]

Authorised by the Secretary of State for Transport
 Dated 30th September 2011



06910

