

HIGH SPEED RAIL (LONDON – WEST MIDLANDS) ACT 2017

HIGH SPEED RAIL (LONDON – WEST MIDLANDS) GENERAL VESTING DECLARATION No. 562

This **GENERAL VESTING DECLARATION** is executed on
by the Secretary of State for Transport (“the Authority”).

22 SEPTEMBER 2021

WHEREAS:

- (1) On 23 February 2017 the High Speed Rail (London – West Midlands) Act 2017 (“the High Speed Rail Act”) received Royal Assent authorising the Authority to acquire the land specified in the Schedule hereto.
- (2) Section 4(1) of the High Speed Rail Act authorises the Authority to acquire compulsorily so much of the land within the limits of the High Speed Rail Act as may be required for Phase One purposes¹.
- (3) Section 4(4) of the High Speed Rail Act provides that the Compulsory Purchase (Vesting Declarations) Act 1981 (“the 1981 Act”) applies as if the High Speed Rail Act were a compulsory purchase order and paragraph 3² of Schedule 6 to the High Speed Rail Act provides that the 1981 Act shall have effect subject to the modifications specified in that paragraph.
- (4) Notice pursuant to section 3A³ of the 1981 Act was first published on 23 August 2021. That notice included the particulars specified in section 3A(3) of the 1981 Act.

NOW THIS DEED WITNESSETH that, in exercise of the powers conferred on it by section 4 of the 1981 Act, the Authority hereby declares:-

1. The land described in the Schedule hereto (being part of the land authorised to be acquired by the High Speed Rail Act) and more particularly delineated and shown coloured pink on the plan annexed hereto, together with the right to enter upon and take possession of the land, shall vest in the Authority as from the end of the period of 3 months from the date on which the service of notices required by section 6⁴ of the 1981 Act is completed.

For the purposes of Section 2(2) of the 1981 Act, the specified period in relation to the land comprised in this declaration is one year and one day.

1 Phase One Purposes has meaning given by section 67 of the High Speed Rail Act

2 Paragraph 3 as substituted by section 11 of, and paragraph 6 of Schedule 14 to, the High Speed Rail Act.

3 Section 3A of the 1981 Act as inserted by paragraph 3(a) of Schedule 6 to the High Speed Rail Act as substituted by section 11 of, and paragraphs 6 and 7 of Schedule 14 to, that Act.

4 Section 6 as modified by paragraph 3(c) of Schedule 6 to the High Speed Rail Act, as substituted by section 11 of, and paragraph 6 of Schedule 14 to, that Act

SCHEDULE

Buckinghamshire

(1) Plot No.	(2) Description
64964	All interests in 6.1 square metres, or thereabouts, of access splay (Bottom House Farm Lane)
64965	All interests in 26.2 square metres, or thereabouts, of access splay (Bottom House Farm Lane)
64967	All interests in 1227.9 square metres, or thereabouts, of agricultural land and access track (Upper Bottom House Farm)
64972	All interests in 7592.2 square metres, or thereabouts, of agricultural land and access track (Bottom House Farm Lane)
64974	All interests in 7607.1 square metres, or thereabouts, of public road, verges, access splays and public footpaths (AMS/18/3 and CSG/28/4) (Bottom House Farm Lane)
64978	All interests in 1613.9 square metres, or thereabouts, of agricultural land, hardstanding and access track carrying public footpath (CSG/30/1) (Bottom House Farm Lane)
64979	All interests in 4.4 square metres, or thereabouts, of access splay (Bottom House Farm Lane)
64981	All interests in 1404.8 square metres, or thereabouts, of agricultural land and outbuilding (Bottom House Farm Lane)
64982	All interests in 100.8 square metres, or thereabouts, of river, bed and banks thereof (River Misbourne)
64983	All interests in 51.7 square metres, or thereabouts, of public road and verge (Bottom House Farm Lane) over river, bed and banks thereof (River Misbourne)
64986	All interests in 2895.8 square metres, or thereabouts, of agricultural land (Briardale, Bottom House Farm Lane)
64987	All interests in 993.1 square metres, or thereabouts, of public road and verge (Bottom House Farm Lane)
64988	All interests in 327.5 square metres, or thereabouts, of woodland and verge (Bottom House Farm Lane)
64989	All interests in 1453.6 square metres, or thereabouts, of public road, verges, woodland and footway (Amersham Road)
69498	All interests in 24.3 square metres, or thereabouts, of access track (Upper Bottom House Farm)
69499	All interests in 329.2 square metres, or thereabouts, of garden (Upper Bottom House Farm)
69500	All interests in 362.9 square metres, or thereabouts, of verge and access track (Upper Bottom House Farm)
69501	All interests in 332.3 square metres, or thereabouts, of hardstanding and verge (Upper Bottom House Farm)
69502	All interests in 547.6 square metres, or thereabouts, of hardstanding, access track and woodland (Upper Bottom House Farm)
69503	All interests in 963.2 square metres, or thereabouts, of grassland, hedgerow, verge and public footpath (CSG/28/4) (Upper Bottom House Farm)
69504	All interests in 828.3 square metres, or thereabouts, of access track (Upper Bottom House Farm)
69505	All interests in 1484.3 square metres, or thereabouts, of agricultural land

IN WITNESS WHEREOF the Secretary of State for Transport has hereunto set its corporate seal on the day in the year first written above.

The **CORPORATE SEAL** of the SECRETARY OF STATE FOR TRANSPORT hereunto affixed to this deed is authenticated by

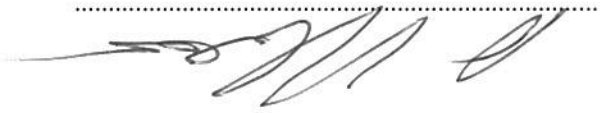

Authorised Signatory

Dated : 22 SEPTEMBER 2021



SEAL REF
DTT GP / 654

69796	All interests in 3668.9 square metres, or thereabouts, of agricultural land (Upper Bottom House Farm)
69921	All interests in 77.6 square metres, or thereabouts, of agricultural land (Upper Bottom House Farm)
69922	All interests in 2358.8 square metres, or thereabouts, of access track and agricultural land (Upper Bottom House Farm)
69926	All interests in 3137.8 square metres, or thereabouts, of access track and agricultural land (Bottom House Farm Lane)
69927	All interests in 837.4 square metres, or thereabouts, of agricultural land and access track (Upper Bottom House Farm)
70675	All interests in 230.6 square metres, or thereabouts, of grassland (Bottom House Farm Lane)
70776	All interests in 543.7 square metres, or thereabouts, of hedgerow, verge, drain and agricultural land (Bottom House Farm Lane)
70777	All interests in 36.2 square metres, or thereabouts, of river, bed and banks thereof (River Misbourne) (Bottom House Farm Lane)

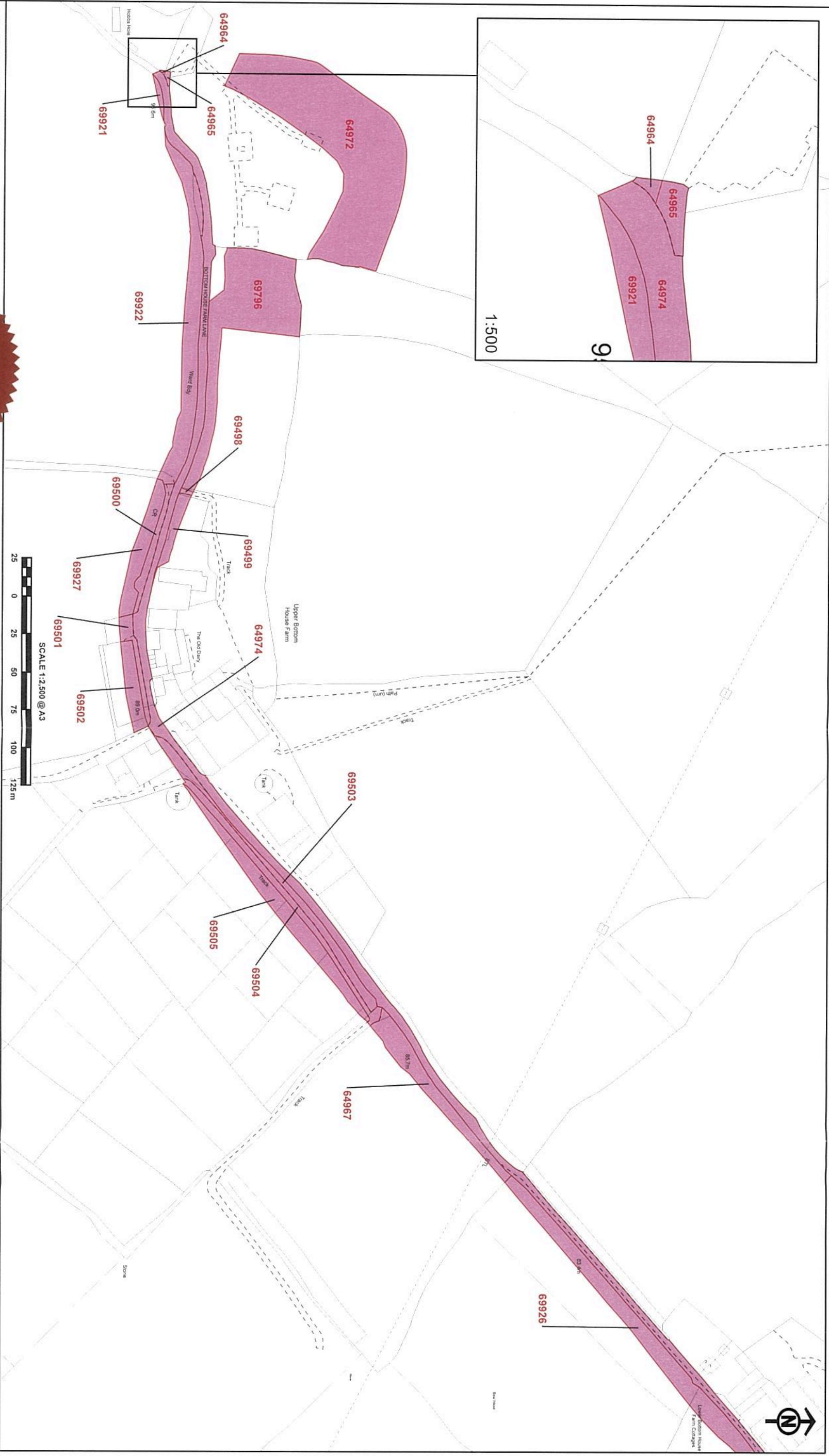
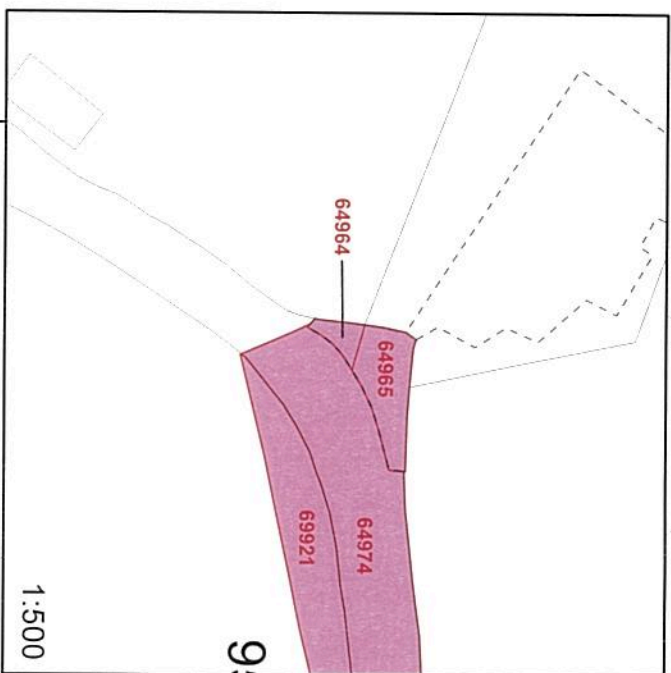

The CORPORATE SEAL of the
SECRETARY OF STATE
hereunto affixed to this deed
is authenticated by

Authorised by the Secretary of State for Transport

Dated 22 SEPTEMBER 2021



0654

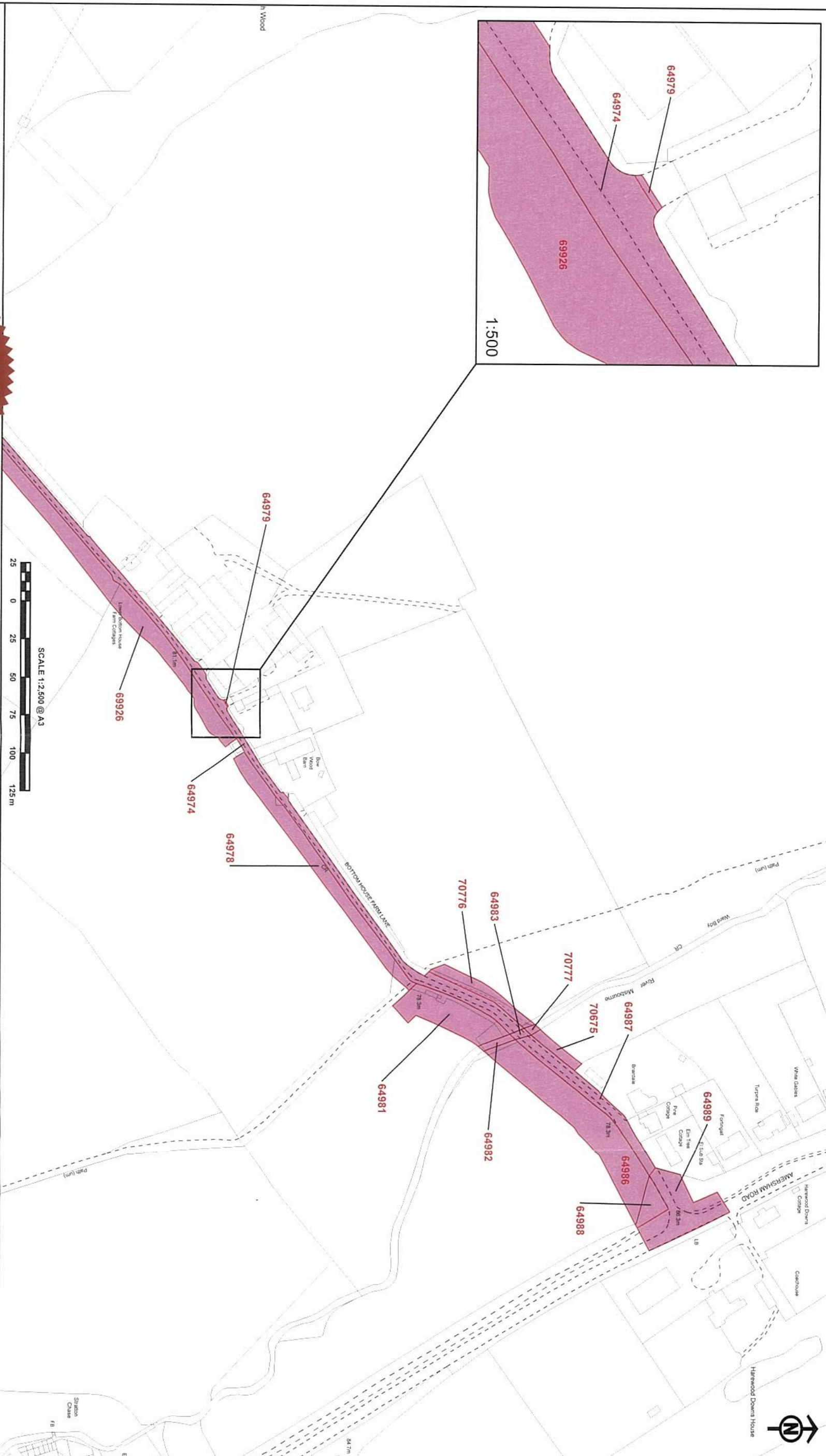
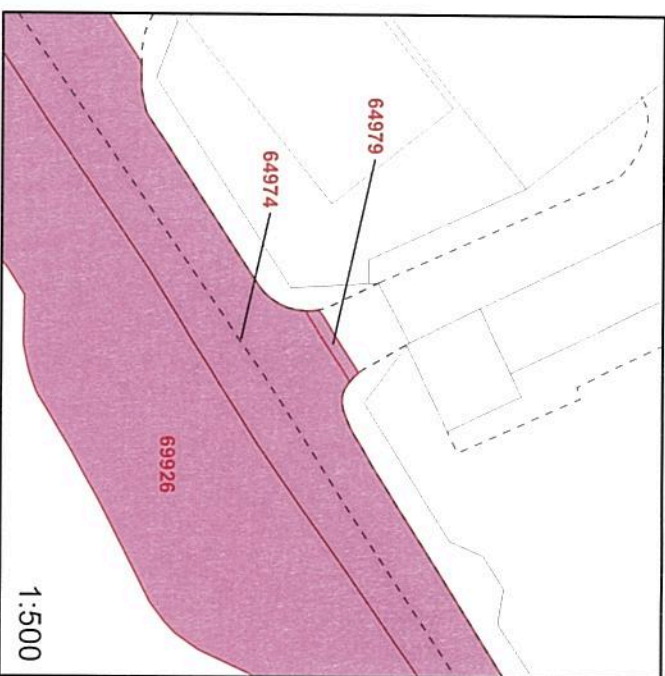

The CORPORATE SEAL of the
SECRETARY OF STATE
hereunto affixed to this deed
is authenticated by

[Signature]

Authorised by the Secretary of State for Transport

Dated 22 SEPTEMBER 2021



6654

