

HIGH SPEED RAIL (LONDON – WEST MIDLANDS) ACT 2017

HIGH SPEED RAIL (LONDON – WEST MIDLANDS) GENERAL VESTING DECLARATION No. 466

This **GENERAL VESTING DECLARATION** is executed on
by the Secretary of State for Transport ("the Authority").

23rd December 2020

WHEREAS:

- (1) On 23 February 2017 the High Speed Rail (London – West Midlands) Act 2017 ("the High Speed Rail Act") received Royal Assent authorising the Authority to acquire the land specified in the Schedule hereto.
- (2) Section 4(1) of the High Speed Rail Act authorises the Authority to acquire compulsorily so much of the land within the limits of the High Speed Rail Act as may be required for Phase One purposes¹.
- (3) Section 8 of the High Speed Rail Act provides that the power under section 4(1) in relation to land may be exercised in relation to the subsoil or under-surface of the land only.
- (4) Section 4(4) of the High Speed Rail Act provides that the Compulsory Purchase (Vesting Declarations) Act 1981 ("the 1981 Act") applies as if the High Speed Rail Act were a compulsory purchase order and paragraph 3² of Schedule 6 to the High Speed Rail Act provides that the 1981 Act shall have effect subject to the modifications specified in that paragraph.
- (5) Notice pursuant to section 3A³ of the 1981 Act was first published on 11 December 2020. That notice included the particulars specified in section 3A(3) of the 1981 Act.

NOW THIS DEED WITNESSETH that, in exercise of the powers conferred on it by section 4 of the 1981 Act, the Authority hereby declares:-

1. The land described in the Schedule hereto (being part of the land authorised to be acquired by the High Speed Rail Act) and more particularly delineated and shown coloured yellow on the plan annexed hereto, together with the right to enter upon and take possession of the land, shall vest in the Authority as from the end of the period of 3 months from the date on which the service of notices required by section 6⁴ of the 1981 Act is completed.
2. For the purposes of Section 2(2) of the 1981 Act, the specified period in relation to the land comprised in this declaration is one year and one day.

1 Phase One Purposes has meaning given by section 67 of the High Speed Rail Act

2 Paragraph 3 as substituted by section 11 of, and paragraph 6 of Schedule 14 to, the High Speed Rail Act.

3 Section 3A of the 1981 Act as inserted by paragraph 3(a) of Schedule 6 to the High Speed Rail Act as substituted by section 11 of, and paragraphs 6 and 7 of Schedule 14 to, that Act.

4 Section 6 as modified by paragraph 3(c) of Schedule 6 to the High Speed Rail Act, as substituted by section 11 of, and paragraph 6 of Schedule 14 to, that Act

SCHEDULE

Buckinghamshire

| (1) Plot No. | (2) Description |
|--------------|--|
| 64332 | All that stratum of subsoil that lies beneath 472.4 square metres, or thereabouts, of grassland, embankment and construction site (Shire Lane) the upper extremity of which is 71.8 metres above Ordnance Survey Datum and the lower extremity of which is 51.8 metres above Ordnance Survey Datum. |
| 64334 | All that stratum of subsoil that lies beneath 37.3 square metres, or thereabouts, of construction site (Shire Lane) the upper extremity of which is 71.7 metres above Ordnance Survey Datum and the lower extremity of which is 51.8 metres above Ordnance Survey Datum. |
| 64335 | All that stratum of subsoil that lies beneath 3620.1 square metres, or thereabouts, of motorway, verges, embankment, woodland and gantry (M25) the upper extremity of which is 67.5 metres above Ordnance Survey Datum and the lower extremity of which is 51.3 metres above Ordnance Survey Datum. |
| 64338 | All that stratum of subsoil that lies beneath 560.1 square metres, or thereabouts, of hedgerow, public road, access splays and verge (Shire Lane) the upper extremity of which is 71.2 metres above Ordnance Survey Datum and the lower extremity of which is 50.7 metres above Ordnance Survey Datum. |

IN WITNESS WHEREOF the Secretary of State for Transport has hereunto set its corporate seal on the day in the year first written above.

The **CORPORATE SEAL** of the SECRETARY OF STATE FOR TRANSPORT hereunto affixed to this deed is authenticated by



.....

Authorised Signatory

Dated : 23rd December 2020

SEAL REF
DIT GP / 0378

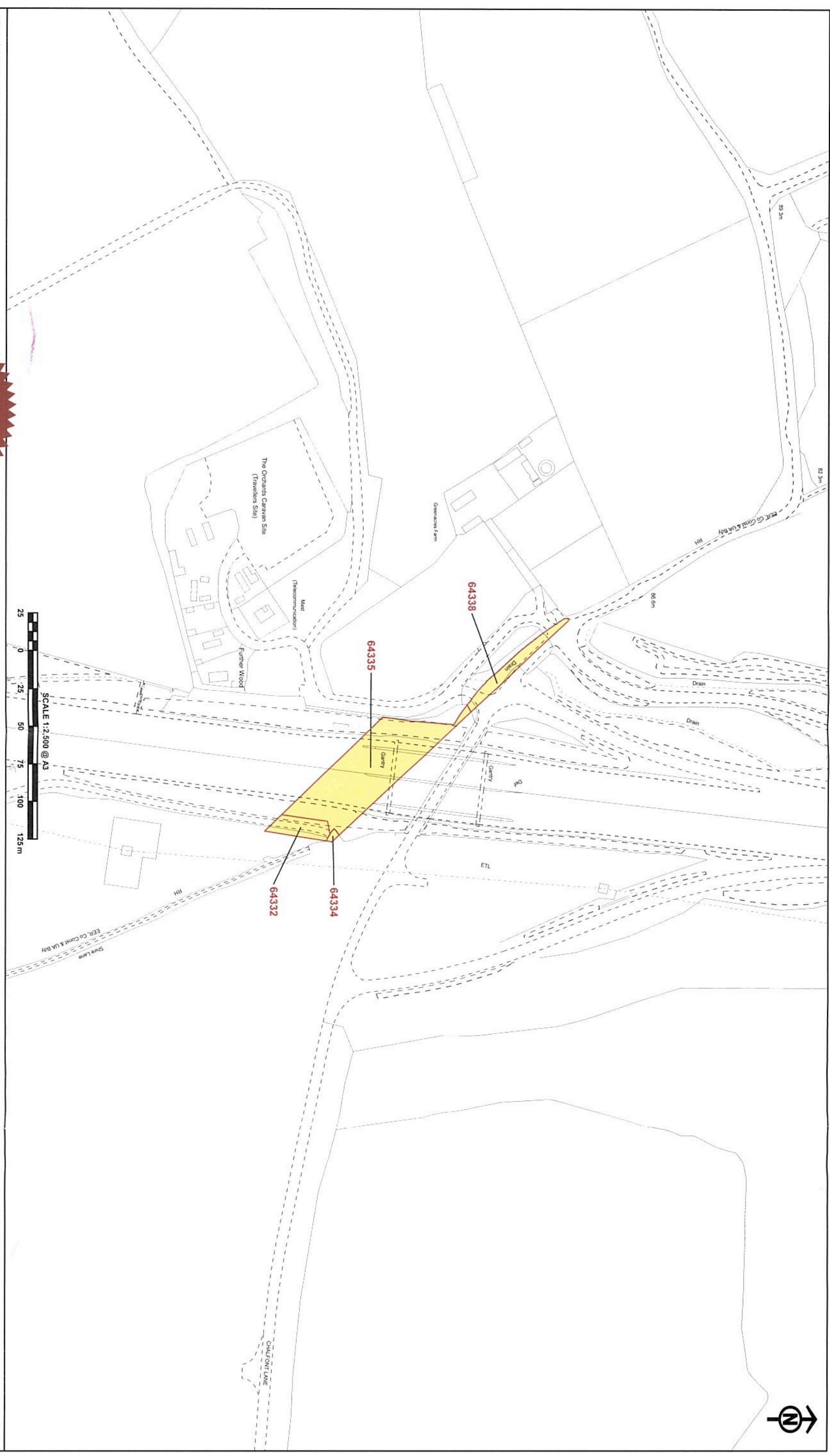



The CORPORATE SEAL of the
SECRETARY OF STATE
hereunto affixed to this deed
is authenticated by

Authorised by the Secretary of State for Transport

Dated 23rd December 2020



0378

© Crown copyright and database right 2020 Ordnance Survey, Licence Number 10004186
Reproduced with permission from the Controller of MAJG and © Crown Copyright Ordnance Survey

