

HIGH SPEED RAIL (LONDON – WEST MIDLANDS) ACT 2017

HIGH SPEED RAIL (LONDON – WEST MIDLANDS) GENERAL VESTING DECLARATION No. 374

This **GENERAL VESTING DECLARATION** is executed on 21st February 2020 by the Secretary of State for Transport ("the Authority").

WHEREAS:

- (1) On 23 February 2017 the High Speed Rail (London – West Midlands) Act 2017 ("the High Speed Rail Act") received Royal Assent authorising the Authority to acquire the land specified in the Schedule hereto.
- (2) Section 4(1) of the High Speed Rail Act authorises the Authority to acquire compulsorily so much of the land within the limits of the High Speed Rail Act as may be required for Phase One purposes¹.
- (3) Section 4(4) of the High Speed Rail Act provides that the Compulsory Purchase (Vesting Declarations) Act 1981 ("the 1981 Act") applies as if the High Speed Rail Act were a compulsory purchase order and paragraph 3² of Schedule 6 to the High Speed Rail Act provides that the 1981 Act shall have effect subject to the modifications specified in that paragraph.
- (4) Notice pursuant to section 3A³ of the 1981 Act was first published on 23 January 2020. That notice included the particulars specified in section 3A(3) of the 1981 Act.

NOW THIS DEED WITNESSETH that, in exercise of the powers conferred on it by section 4 of the 1981 Act, the Authority hereby declares:-

1. The land described in the Schedule hereto (being part of the land authorised to be acquired by the High Speed Rail Act) and more particularly delineated and shown coloured pink on the plan annexed hereto, together with the right to enter upon and take possession of the land, shall vest in the Authority as from the end of the period of 3 months from the date on which the service of notices required by section 6⁴ of the 1981 Act is completed.

For the purposes of Section 2(2) of the 1981 Act, the specified period in relation to the land comprised in this declaration is one year and one day.

1 Phase One Purposes has meaning given by section 67 of the High Speed Rail Act

2 Paragraph 3 as substituted by section 11 of, and paragraph 6 of Schedule 14 to, the High Speed Rail Act.

3 Section 3A of the 1981 Act as inserted by paragraph 3(a) of Schedule 6 to the High Speed Rail Act as substituted by section 11 of, and paragraphs 6 and 7 of Schedule 14 to, that Act.

4 Section 6 as modified by paragraph 3(c) of Schedule 6 to the High Speed Rail Act, as substituted by section 11 of, and paragraph 6 of Schedule 14 to, that Act

SCHEDULE

District of Aylesbury Vale

(1) Plot No	(2) Plot Description
62829	All interests in 84974.8 square metres, or thereabouts, of agricultural land, woodland and public footpaths (BHA/2/1 and BHA/3/1) (Barton Grounds Farm)
62830	All interests in 25401.3 square metres, or thereabouts, of agricultural land, drain and public footpath (BHA/2/2) (Barton Grounds Farm)
62831	All interests in 548.7 square metres, or thereabouts, of woodland and embankment (Great Central Railway)
62832	All interests in 4976.6 square metres, or thereabouts, of woodland, drain and embankment carrying dismantled railway (Great Central Railway)

IN WITNESS WHEREOF the Secretary of State for Transport has hereunto set its corporate seal on the day in the year first written above.

The **CORPORATE SEAL** of the SECRETARY OF STATE FOR TRANSPORT hereunto affixed to this deed is authenticated by

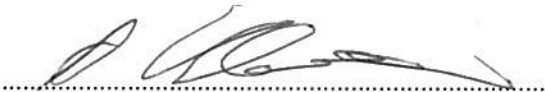

A handwritten signature in black ink, consisting of several loops and a long horizontal stroke, positioned above a dotted line.

Authorised Signatory

Dated : 21st February 2020

SEAL REF NO
DfT/ 9597



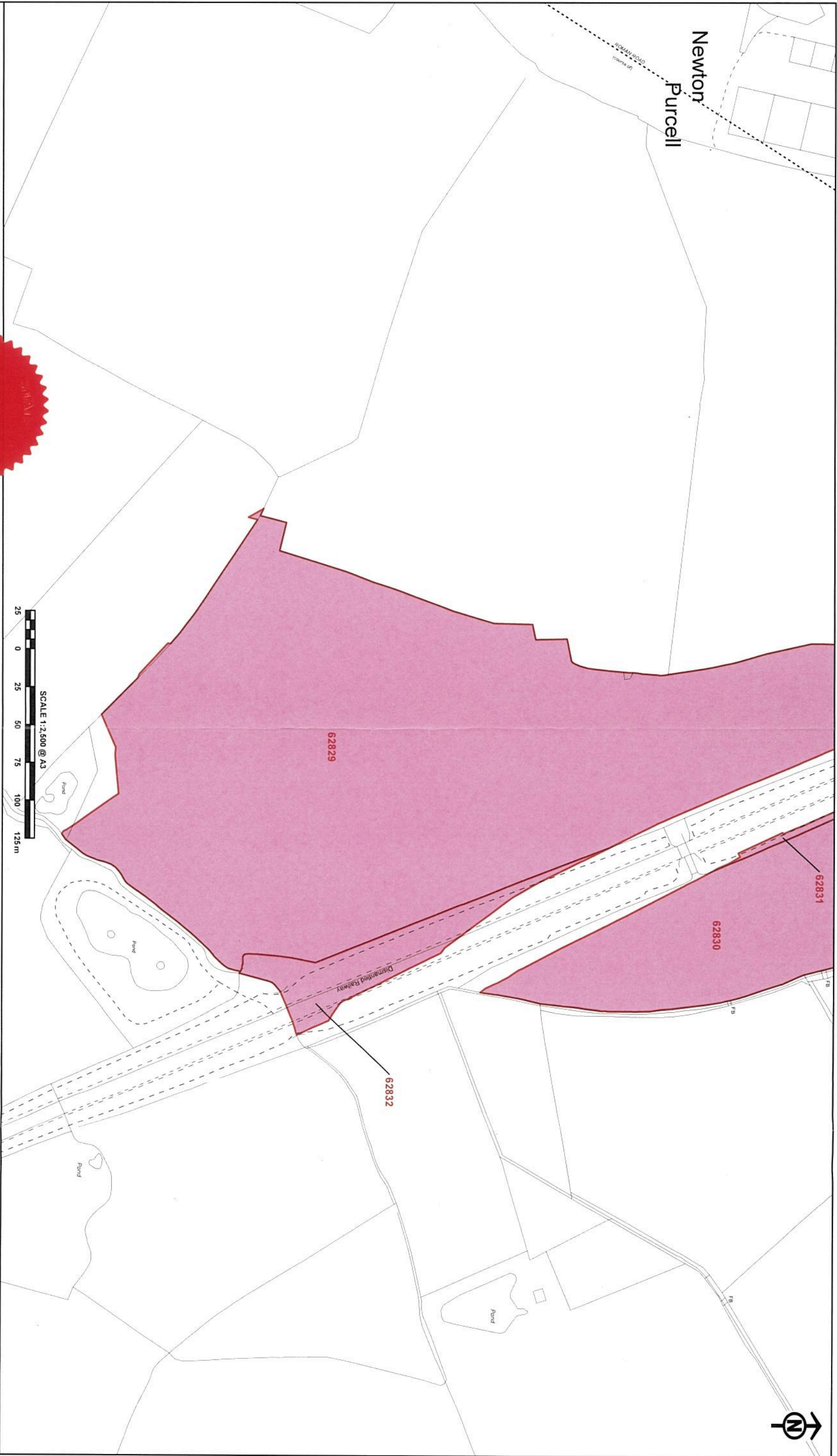

Newton
Purcell

SCALE 1:2,500 @ A3
25 0 25 50 75 100 125 m

The CORPORATE SEAL of the
SECRETARY OF STATE
hereunto affixed to this deed
is authenticated by

Authorised by The Secretary of State for Transport

Dated 21st February 2020

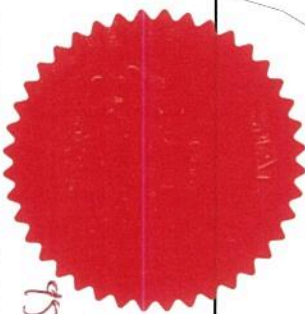

9597

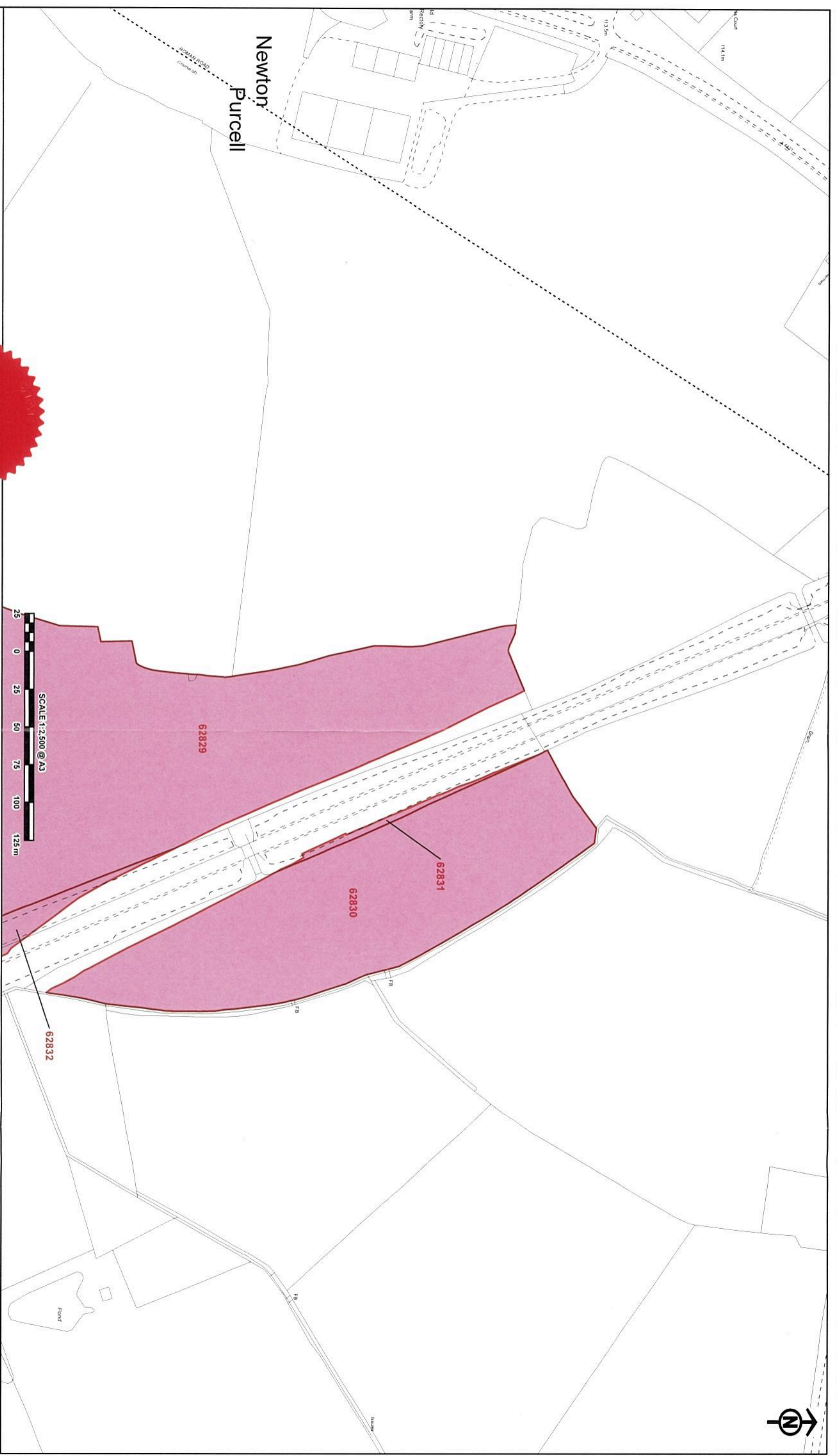

The CORPORATE SEAL of the
SECRETARY OF STATE
hereunto affixed to this deed
is authenticated by

Authorised by the Secretary of State for Transport

Dated 21st February 2020



9597

© Crown copyright and database right, 2018 Ordnance Survey Licence Number: 100041918.
Reproduced with the permission of the Controller of Her Majesty's Stationery Office and the Controller of Copyright.

