

HIGH SPEED RAIL (LONDON – WEST MIDLANDS) ACT 2017

HIGH SPEED RAIL (LONDON – WEST MIDLANDS) GENERAL VESTING DECLARATION No. 189

This **GENERAL VESTING DECLARATION** is executed on 18th June 2019
by the Secretary of State for Transport ("the Authority").

WHEREAS:

- (1) On 23 February 2017 the High Speed Rail (London – West Midlands) Act 2017 ("the High Speed Rail Act") received Royal Assent authorising the Authority to acquire the land specified in the Schedule hereto.
- (2) Section 4(1) of the High Speed Rail Act authorises the Authority to acquire compulsorily so much of the land within the limits of the High Speed Rail Act as may be required for Phase One purposes¹.
- (3) Section 4(4) of the High Speed Rail Act provides that the Compulsory Purchase (Vesting Declarations) Act 1981 ("the 1981 Act") applies as if the High Speed Rail Act were a compulsory purchase order and paragraph 3² of Schedule 6 to the High Speed Rail Act provides that the 1981 Act shall have effect subject to the modifications specified in that paragraph.
- (4) Notice pursuant to section 3A³ of the 1981 Act was first published on 30 May 2019. That notice included the particulars specified in section 3A(3) of the 1981 Act.

NOW THIS DEED WITNESSETH that, in exercise of the powers conferred on it by section 4 of the 1981 Act, the Authority hereby declares:-

1. The land described in the Schedule hereto (being part of the land authorised to be acquired by the High Speed Rail Act) and more particularly delineated and shown coloured pink on the plan annexed hereto, together with the right to enter upon and take possession of the land, shall vest in the Authority as from the end of the period of 3 months from the date on which the service of notices required by section 6⁴ of the 1981 Act is completed.

For the purposes of Section 2(2) of the 1981 Act, the specified period in relation to the land comprised in this declaration is one year and one day.

1 Phase One Purposes has meaning given by section 67 of the High Speed Rail Act

2 Paragraph 3 as substituted by section 11 of, and paragraph 6 of Schedule 14 to, the High Speed Rail Act.

3 Section 3A of the 1981 Act as inserted by paragraph 3(a) of Schedule 6 to the High Speed Rail Act as substituted by section 11 of, and paragraphs 6 and 7 of Schedule 14 to, that Act.

4 Section 6 as modified by paragraph 3(c) of Schedule 6 to the High Speed Rail Act, as substituted by section 11 of, and paragraph 6 of Schedule 14 to, that Act

SCHEDULE

District of Cherwell

(1) Plot No	(2) Plot Description
46101	All interests in 2717.6 square metres, or thereabouts, of agricultural land and woodland (Chetwode Manor Farm)
46103	All interests in 62.9 square metres, or thereabouts, of woodland (Chetwode Manor Farm)
46105	All interests in 13120.1 square metres, or thereabouts, of dismantled railway (Great Central), woodland and drain (The Shelswell Inn)
46108	All interests in 702.7 square metres, or thereabouts, of grassland (The Shelswell Inn)
46109	All interests in 94.2 square metres, or thereabouts, of public road and verges (A4421)
46110	All interests in 425.5 square metres, or thereabouts, of dismantled railway (Great Central) (Newton Purcell)
46112	All interests in 68.0 square metres, or thereabouts, of woodland (Newton Purcell)
46113	All interests in 62.8 square metres, or thereabouts, of bridge carrying dismantled railway (Great Central) over public road (A4421)
46114	All interests in 76.1 square metres, or thereabouts, of public road and verges (A4421)
46115	All interests in 485.4 square metres, or thereabouts, of dismantled railway (Great Central) and woodland (Newton Purcell)
46116	All interests in 69.0 square metres, or thereabouts, of bridge carrying dismantled railway (Great Central) over public road (A4421)
46120	All interests in 12456.2 square metres, or thereabouts, of disused railway (Great Central), embankment and pond (Newton Purcell)
46121	All interests in 149.7 square metres, or thereabouts, of public road and verges (A4421)
49277	All interests in 5112.1 square metres, or thereabouts, of agricultural land, hedgerows and woodland (Chetwode Manor Farm)

IN WITNESS WHEREOF the Secretary of State for Transport has hereunto set its corporate seal on the day in the year first written above.

The **CORPORATE SEAL** of the SECRETARY OF STATE FOR TRANSPORT hereunto affixed to this deed is authenticated by

.....

Authorised Signatory

Dated: 18th June 2019

SEAL REF No. DFT/19646



SEAL REF NO.

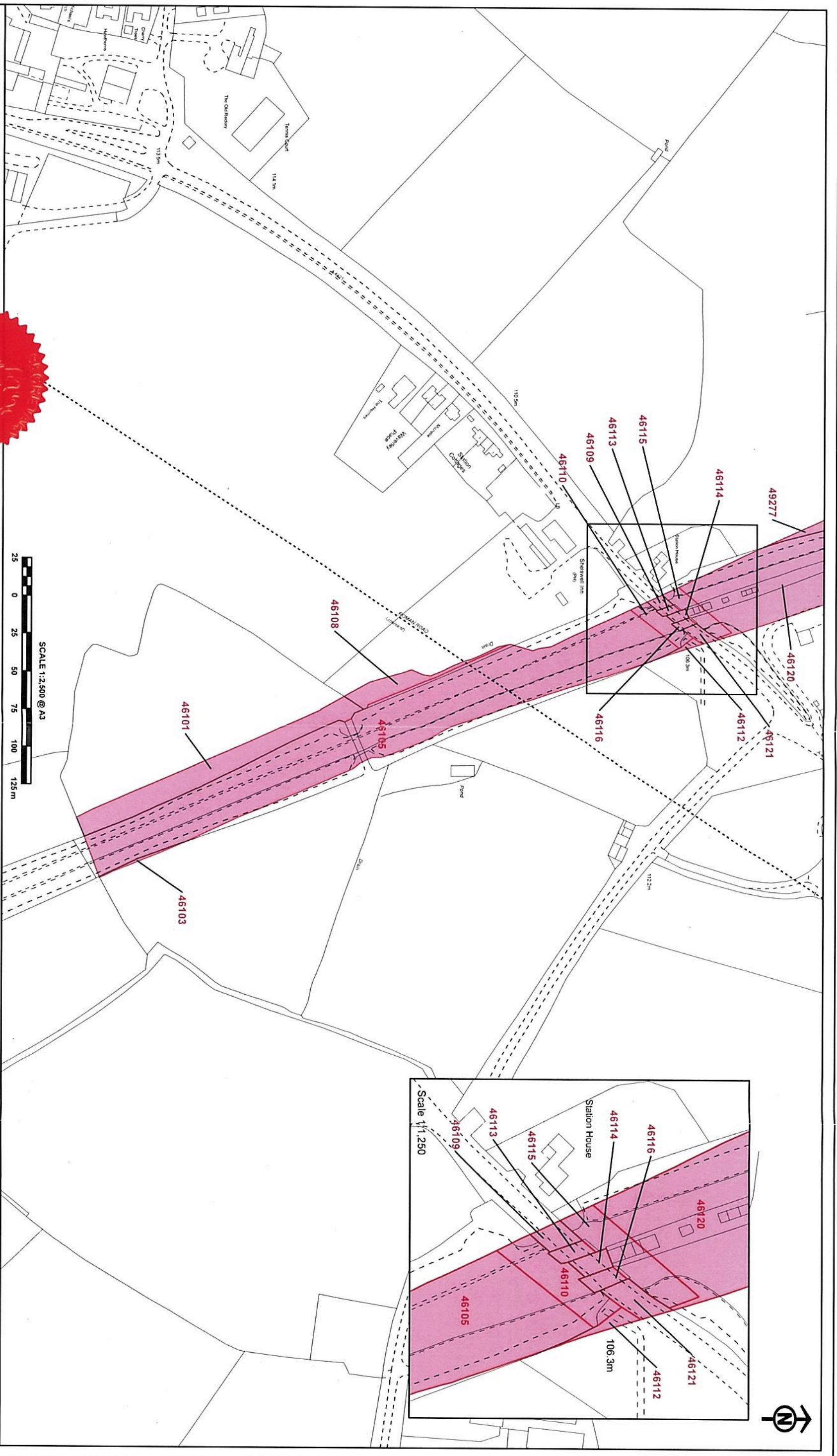

The CORPORATE SEAL of the
 SECRETARY OF STATE
 hereunto affixed to this deed
 is authenticated by

Authorised by the Secretary of State for Transport
 Dated 18th June 2019

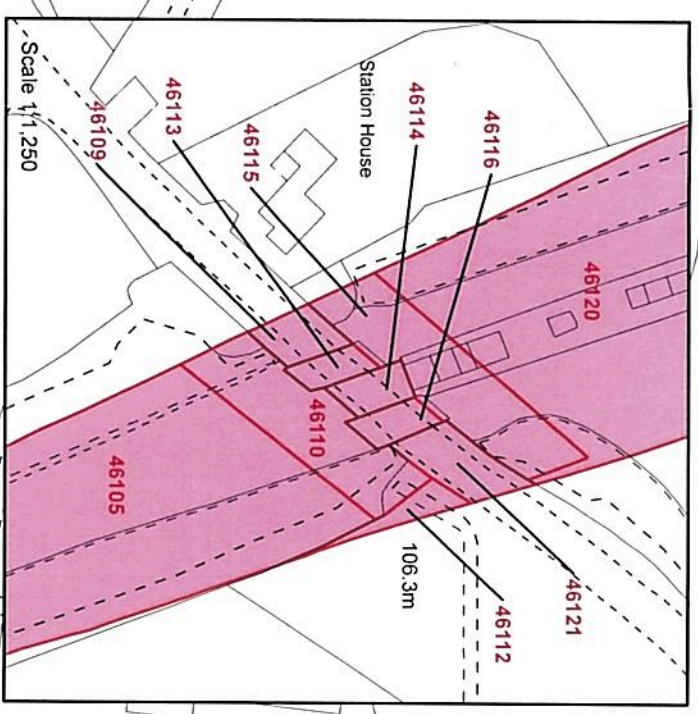
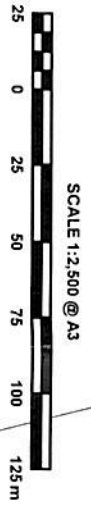
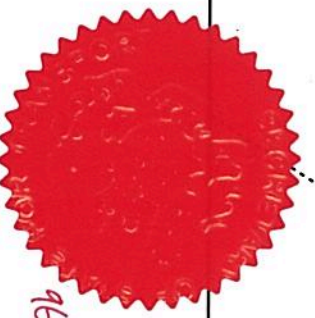

© Crown copyright and database right 2018. Ordnance Survey. Licence Number: 100049186
 © Crown copyright material is reproduced with the permission of Land Registry under
 license from the Controller of HMSO and the Crown Copyright Database Service

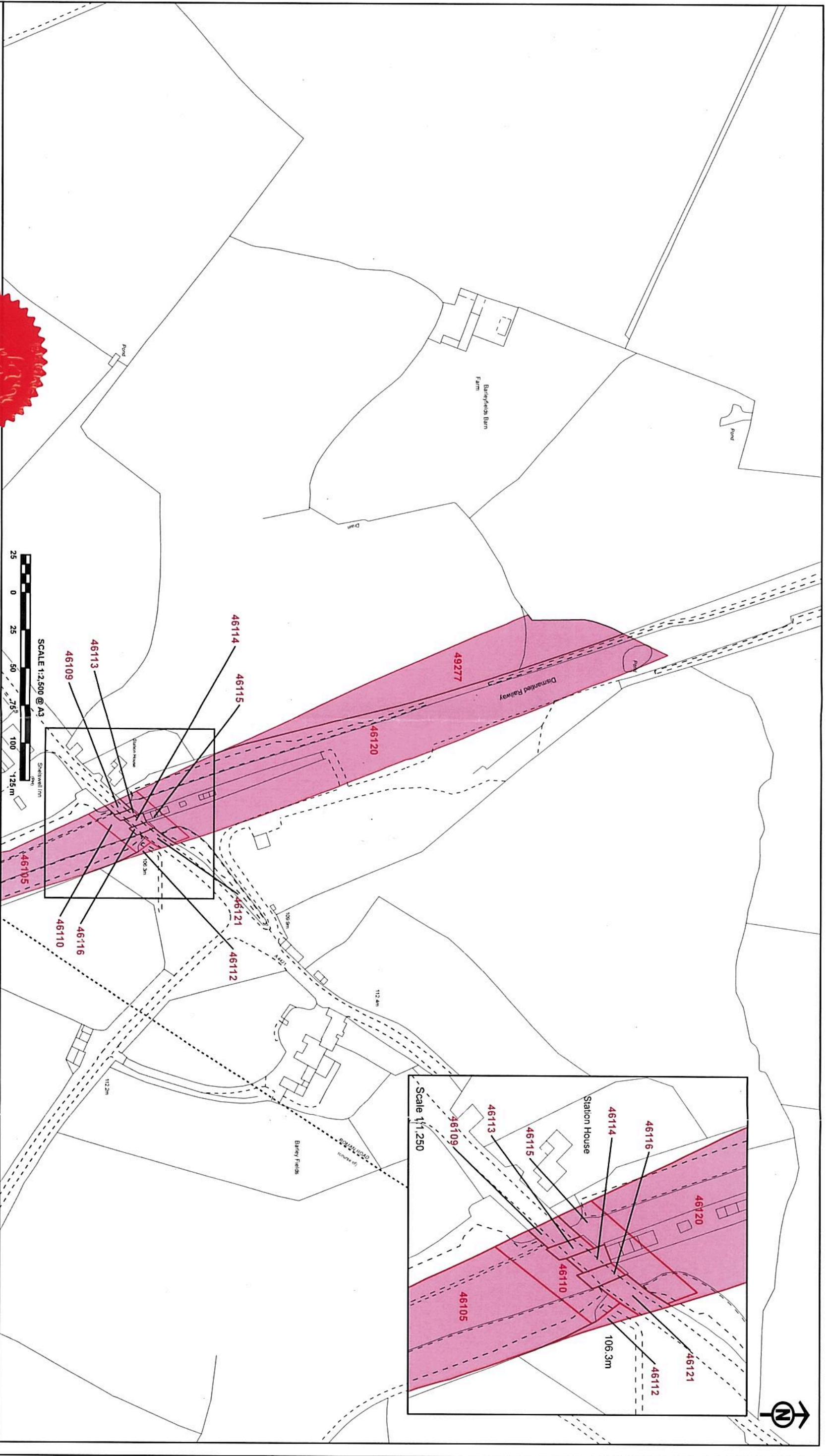

The CORPORATE SEAL of the
SECRETARY OF STATE
hereunto affixed to this deed
is authenticated by

[Signature]

Authorised by the Secretary of State for Transport
Dated 18th June 2019



946

