

## HIGH SPEED RAIL (LONDON – WEST MIDLANDS) ACT 2017

### HIGH SPEED RAIL (LONDON – WEST MIDLANDS) GENERAL VESTING DECLARATION No. 116

This **GENERAL VESTING DECLARATION** is executed on 4<sup>th</sup> DECEMBER 2018  
by the Secretary of State for Transport (“the Authority”).

#### WHEREAS:

- (1) On 23 February 2017 the High Speed Rail (London – West Midlands) Act 2017 (“the High Speed Rail Act”) received Royal Assent authorising the Authority to acquire the land specified in the Schedule hereto.
- (2) Section 4(1) of the High Speed Rail Act authorises the Authority to acquire compulsorily so much of the land within the limits of the High Speed Rail Act as may be required for Phase One purposes<sup>1</sup>.
- (3) Section 4(4) of the High Speed Rail Act provides that the Compulsory Purchase (Vesting Declarations) Act 1981 (“the 1981 Act”) applies as if the High Speed Rail Act were a compulsory purchase order and paragraph 3<sup>2</sup> of Schedule 6 to the High Speed Rail Act provides that the 1981 Act shall have effect subject to the modifications specified in that paragraph.
- (4) Notice pursuant to section 3A<sup>3</sup> of the 1981 Act was first published on 22 October 2018. That notice included the particulars specified in section 3A(3) of the 1981 Act.

**NOW THIS DEED WITNESSETH** that, in exercise of the powers conferred on it by section 4 of the 1981 Act, the Authority hereby declares:-

1. The land described in the Schedule hereto (being part of the land authorised to be acquired by the High Speed Rail Act) and more particularly delineated and shown coloured pink on the plan annexed hereto, together with the right to enter upon and take possession of the land, shall vest in the Authority as from the end of the period of 3 months from the date on which the service of notices required by section 6<sup>4</sup> of the 1981 Act is completed.

For the purposes of Section 2(2) of the 1981 Act, the specified period in relation to the land comprised in this declaration is one year and one day.

---

1 Phase One Purposes has meaning given by section 67 of the High Speed Rail Act

2 Paragraph 3 as substituted by section 11 of, and paragraph 6 of Schedule 14 to, the High Speed Rail Act.

3 Section 3A of the 1981 Act as inserted by paragraph 3(a) of Schedule 6 to the High Speed Rail Act as substituted by section 11 of, and paragraphs 6 and 7 of Schedule 14 to, that Act.

4 Section 6 as modified by paragraph 3(c) of Schedule 6 to the High Speed Rail Act, as substituted by section 11 of, and paragraph 6 of Schedule 14 to, that Act

## SCHEDULE

District of Aylesbury Vale

(1) Plot No.	(2) Description
16131	All interests in 37630.7 square metres, or thereabouts, of agricultural land (Shepherds Furze Farm)
42927	All interests in 118588.4 square metres, or thereabouts, of agricultural land, access track, hedgerows and drains (Shepherds Furze Farm)
42929	All interests in 15055.2 square metres, or thereabouts, of agricultural land, hedgerows, hardstanding, woodland and drain (Shepherds Furze Farm). To the extent that Schedule 15 Paragraph 2 of the High Speed Rail (London-West Midlands) Act 2017 would otherwise apply, the Secretary of State directs under Paragraph 3 of Schedule 15 that Schedule 15 Paragraph 2 does not apply to any private rights held by Western Power Distribution (East Midlands) plc.
43034	All interests in 55068.7 square metres, or thereabouts, of agricultural land and drain (Shepherds Furze Farm). To the extent that Schedule 15 Paragraph 2 of the High Speed Rail (London-West Midlands) Act 2017 would otherwise apply, the Secretary of State directs under Paragraph 3 of Schedule 15 that Schedule 15 Paragraph 2 does not apply to any private rights held by Western Power Distribution (East Midlands) plc.
43685	All interests in 299.2 square metres, or thereabouts, of access track (Shepherds Furze Farm). To the extent that Schedule 15 Paragraph 2 of the High Speed Rail (London-West Midlands) Act 2017 would otherwise apply, the Secretary of State directs under Paragraph 3 of Schedule 15 that Schedule 15 Paragraph 2 does not apply to any private rights held by Western Power Distribution (East Midlands) plc.
46870	All interests in 2420.6 square metres, or thereabouts, of buildings, hardstanding, access tracks, agricultural land, hedgerows and copse (Shepherds Furze Farm)

**IN WITNESS WHEREOF** the Secretary of State for Transport has hereunto set its corporate seal on the day in the year first written above.

The **CORPORATE SEAL** of the SECRETARY OF STATE FOR TRANSPORT hereunto affixed to this deed is authenticated by

  
.....

Authorised Signatory

Dated : 4<sup>th</sup> DECEMBER 2018

SEAL REF NO. DFT/9321











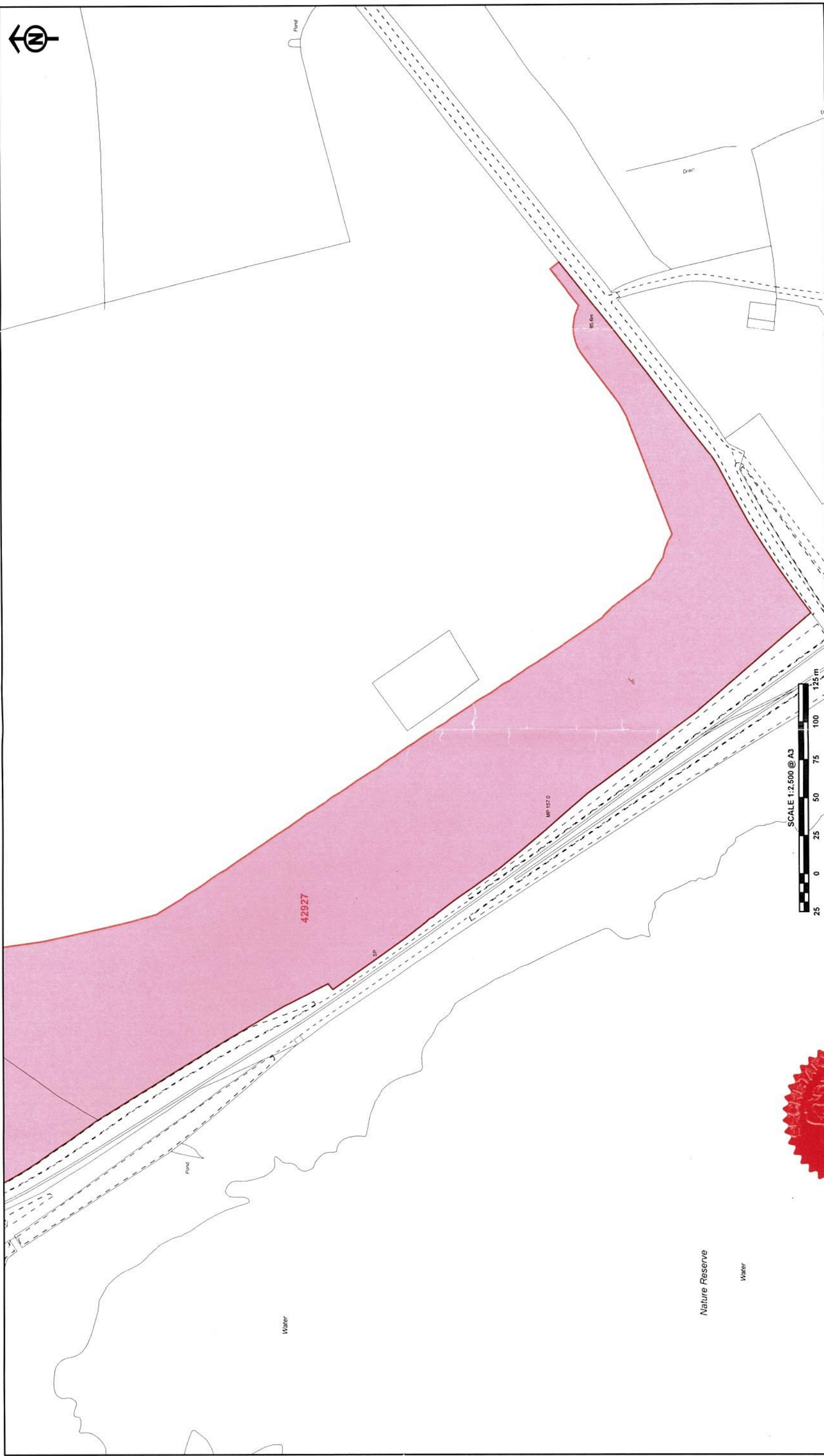

9321

The CORPORATE SEAL of the  
SECRETARY OF STATE  
hereunto affixed to this deed  
is authenticated by

*[Signature]*

Authorised by the Secretary of State for Transport

Dated 4<sup>th</sup> DECEMBER 2016