

Jerrings Hall Farm
 Tanworth Lane
 Solihull
 B90 4DX
 Redline: 1.68 Ha / 4.16 ac

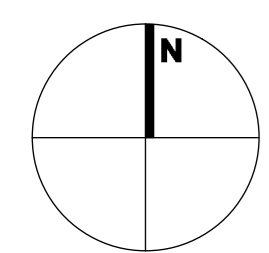

A 01/06/2020 PDR Visibility splays included within Redline
 Rev: Date: Dr/Ch: Description:

<p>Client: The Island Project</p> <p>Project: Jerrings Hall Farm</p>	<p>Scale: 1:1250 @ A4</p> <p>Date: Aug 2018</p> <p>Drawn: PDR</p> <p>Checked:</p> <p><small>Copyright. Check all dimensions on site. Do not scale drawing. This drawing is only to be used on the site for which designed.</small></p>	<p>18.1831.LOC01</p> <p>Drawing: Site Location Plan</p> <p>26 Martingate Corsham Wiltshire SN13 0HL</p> <p>Tel. 01249 701333 Fax. 01249 701444 mail@cms-group.co</p>	<p>A</p> <p>CMS Architects</p>
--	--	--	---



276400N

276400E

Jerrings Hall Farm
Tanworth Lane
Solihull
B90 4DX
Redline: 1.61 Ha / 3.99 ac

Survey Key:-

- | | | | |
|------|--------------------------|-----|-------------------------|
| BO | Bollard | LB | Letter Box |
| BB | Belisha Beacon | LP | Lamp Post |
| BT | BT Cover | MC | Metal Drainage Channel |
| CB | Telephone Control Box | MH | Manhole Cover (round) |
| CH | Coal Hole | MP | Marker Post |
| CO | Unidentified Cover | RWP | Rain Water Pipe |
| Conc | Concrete | SV | Water Stop Valve |
| EP | Electricity Pole | SW | Storm Water Drain Cover |
| FH | Fire Hydrant | TCB | Telephone Call Box |
| FT | Face Profile Target | TL | Traffic Light |
| FW | Foul Water Drain Cover | TP | Telegraph Pole |
| GU | Drainage Gully Cover | TV | Cable TV Cover |
| GV | Gas Valve | WM | Water Meter Cover |
| Gas | Gas Cover | | |
| IC | Inspection Chamber Cover | | |

Some of these symbols may not appear on this drawing

- STN 157.08
- TP 154.87
- WL 154.87
- 2101/10
- 154.87
- 154.87

- Survey Control Station
- Trial Pit
- Borehole
- Water Level (with date measured)
- Spot Level
- Tree (spread to scale)

Linetypes

- Fenceline
- Electricity Transmission Line
- Hedge
- Rock Face
- Embankment Slope
- Contour Lines
- Gas Pipeline
- Water Pipeline

Building Internals - Specific Codes

- Cell +154.87
- F-Ce +154.87
- +154.87
- USB +154.87
- Structural Ceiling Level
- False / Suspended Ceiling Level
- Floor Level
- Underside of Beam / Openings Level

Survey is tied to Ordnance Survey grid and level by GPS Smartnet

Contours where shown are at 0.25m intervals and highlighted at 1m intervals

276350N

276350E

276300N

276300E

276250N

276250E

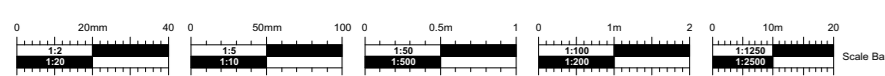

TENDER

No. Date

ORCH Revision Notes

Project File
Jerrings Hall Farm
Project Client
The Island Project
Suitability
D2 SUITABLE FOR TENDER

Sheet Scale
1:250 @ A0
Date
2020/03/03
Drawn By
PCR
Reviewed By
EC

Sheet No.
1831-CMS- SP -00-DR-A-0001
Sheet Title
Existing Site Plan



Copyright. Check all dimensions on site. Do not scale this drawing. This drawing is only to be used for the site for which designed.

24 Moorfields, Coventry, CV3 3DF, UK. Web: www.cms-group.co.uk 02460 731033

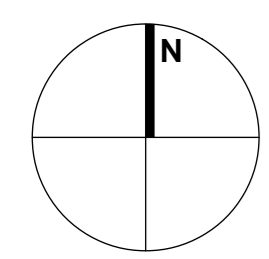

270400N

276400N

Jerrings Hall Farm
Tanworth Lane
Sohiall
B90 4DX
Redline: 1.61 Ha / 3.99 ac

Survey Key:-

- | | | | |
|------|--------------------------|-----|-------------------------|
| BO | Bollard | LB | Letter Box |
| BB | Belisha Beacon | LP | Lamp Post |
| BT | BT Cover | MC | Metal Drainage Channel |
| CB | Telephone Control Box | MH | Manhole Cover (round) |
| CH | Coal Hole | MP | Marker Post |
| CO | Unidentified Cover | RWP | Rain Water Pipe |
| Conc | Concrete | SV | Water Stop Valve |
| EP | Electricity Pole | SW | Storm Water Drain Cover |
| FH | Fire Hydrant | TCB | Telephone Call Box |
| FT | Face Profile Target | TL | Traffic Light |
| FW | Foul Water Drain Cover | TP | Telegraph Pole |
| GU | Drainage Gully Cover | TV | Cable TV Cover |
| GV | Gas Valve | WM | Water Meter Cover |
| IC | Inspection Chamber Cover | | |

Some of these symbols may not appear on this drawing

- STN 157.08
- TP 154.87
- SH 154.87
- WL 154.87
- 2101/10
- 154.87
- 154.87

- Survey Control Station
- Trial Pit
- Borehole
- Water Level (with date measured)
- Spot Level
- Tree (spread to scale)

Linetypes

- Fenceline
- Electricity Transmission Line
- Hedge
- Rock Face
- Embankment Slope
- Contour Lines
- Gas Pipeline
- Water Pipeline
- New Storm Water Drainage
- New Foul Water Drainage

Building Internals - Specific Codes

- Cell +154.87
- F-Ce +154.87
- +154.87
- USB +154.87
- Structural Ceiling Level
- Fault / Suspended Ceiling Level
- Floor Level
- Underside of Beam / Openings Level

Survey is tied to Ordnance Survey grid and level by GPS Smartnet
Contours where shown are at 0.25m intervals and highlighted at 1m intervals
For details of external lighting refer to Lighting Drawing.

270300N

276300N

270300N

276300N

270200N

276200N

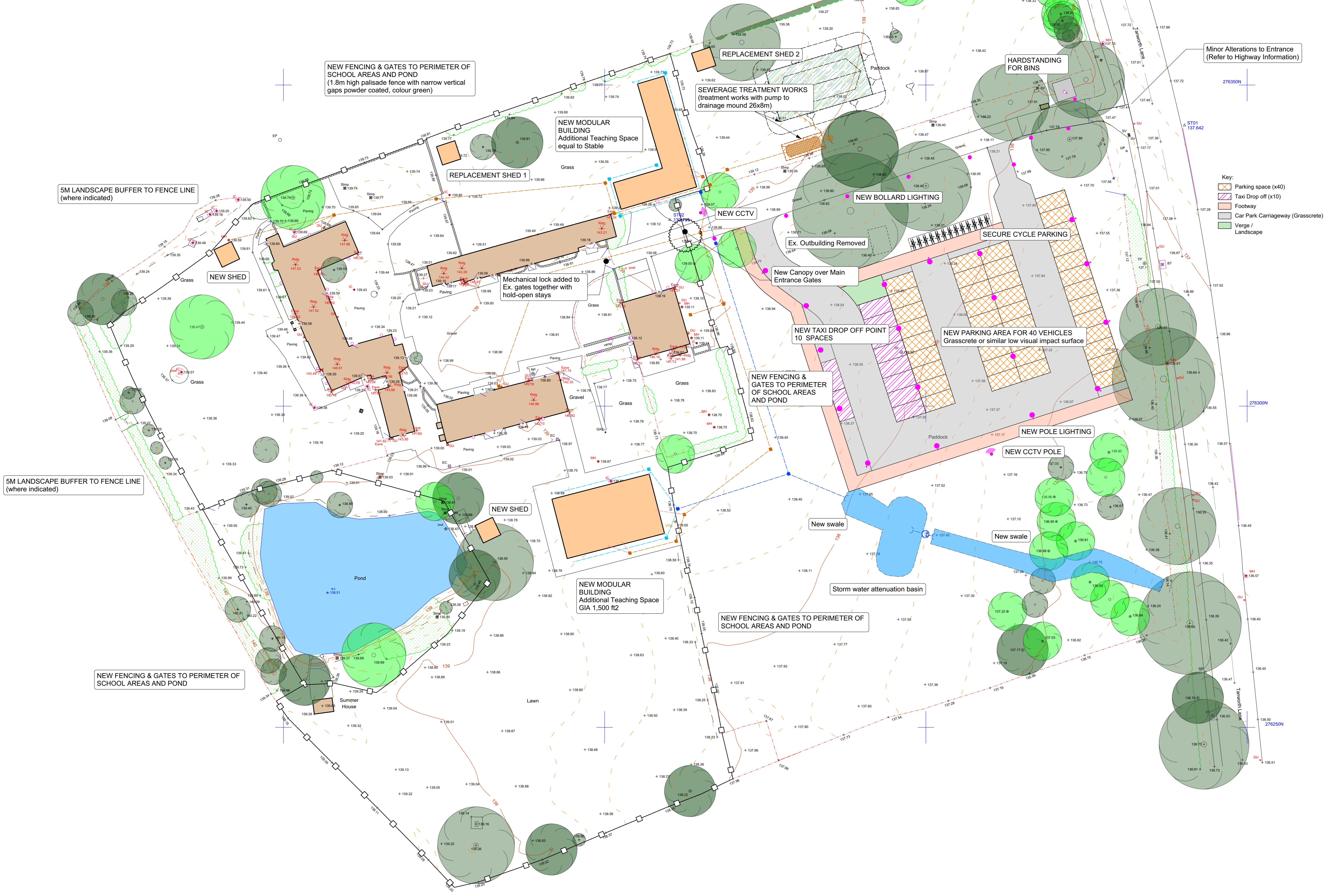

- Key:
- Parking space (x40)
 - Taxi Drop off (x10)
 - Footway
 - Car Park Carriageway (Grasscrete)
 - Verge / Landscape

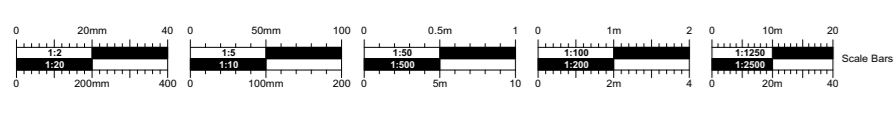

TENDER

No.	Date	DESCR	Revision Notes
A	13/05/2020	PDR	Drainage Proposals update, adjustment of perimeter fence line.
B	02/09/2020	PDR	Lighting and cycle parking added

Project Name
Jerrings Hall Farm
Project Client
The Island Project
Suitability
100% Proposed
S4 SUITABLE FOR STAGE APPROVAL

Sheet Scale
1:250 @ A0
Date
20/02/2023
Drawn By
PDR
Reviewed By
EC

Sheet No.
1831-CMS-SP-00-DR-A-0002
Sheet Title
Proposed Site Plan



Copyright. Check all dimensions on site. Do not scale this drawing. This drawing is only to be used on the site for which it was prepared.