

# SAMARA GAME RESERVE

**NOTE:**  
 1. NO INTERNAL FENCES  
 2. SIZES OF EXISTING AND PROPOSED PORTIONS SUBJECT TO FINAL SURVEY  
 3. ALIGNMENT OF ROADS TO BE DETERMINED ON SITE  
 4. ALIGNMENT OF PROPOSED SUBDIVISIONAL LINES ARE SUBJECT TO FINAL SURVEY.

PORTION	POSSIBLE BUILDING SITES & GPS COORDINATES	SIZE	COMM. SUB.	SPEKBOOM 10-20%	SPEKBOOM 30-50%
1	RED VALLEY	S32 16 30.6 E24 50 03.8	833Ha	57Ha	52Ha
2	BOREHOLE RIDGE	S32 17 00.7 E24 49 25.5			
3	SPITSKOP	S32 17 29.0 E24 49 31.0			
4	OLIVE GROVE	S32 16 19.7 E24 51 04.1	833Ha	18Ha	54Ha
5	GOEDHOOP	S32 16 48.2 E24 50 42.2			
6	NTN HOUSE	S32 17 52.5 E24 49 59.8	833Ha		173Ha
7	GUM TREE	S32 18 33.9 E24 49 56.2			
8	ROOIBERG 2	S32 18 31.3 E24 51 42.3	833Ha		103Ha
9	ROOIBERG 1	S32 18 46.9 E24 51 10.3			
10	SNOWY SPOT	S32 18 51.7 E24 50 37.9			
11	MOUNTAIN RETREAT	S32 19 34.8 E24 48 02.2	828Ha	5Ha	157Ha
12	MOUNTAIN RETREAT JUNCTION	S32 19 50.6 E24 50 36.3	833Ha	29Ha	365Ha
13	NTN GATE BOWL	S32 20 28.7 E24 51 05.7			
14	BOESMANSKLOOF	S32 21 31.2 E24 49 08.1	833Ha		157Ha
15	BOESMANSHOEK 2	S32 21 40.5 E24 49 57.7	833Ha	60Ha	599Ha
16	BOESMANSHOEK 1	S32 22 35.2 E24 50 19.4			
17	RIVERINE SITE	S32 21 54.8 E24 51 38.8	825.8Ha	111Ha	294Ha
18	THE MANOR	S32 23 30.4 E24 51 26.0		7.2Ha	
19&20	KAROO LODGE	S32 21 13.7 E24 51 40.0	817Ha	16Ha	197Ha
21	ACACIA DAM	S32 22 20.5 E24 52 18.6			
22	KONDOA 2	S32 21 24.6 E24 55 33.3	833Ha		191Ha
23	KONDOA	S32 22 19.8 E24 56 12.3			
24	ALTERNATIVE SITE	S32 22 49.8 E24 55 42.2	833Ha		185Ha
25	WINDMILL KILL	S32 24 26.3 E24 56 09.6	853Ha	211Ha	288Ha
26	EASTERN BOUDBARY	S32 25 42.3 E24 56 45.4	860Ha	58Ha	19Ha
27	KLIPFONTEIN RIDGE 3	S32 29 07.8 E24 54 55.5	833Ha		17Ha
28	KLIPFONTEIN RIDGE 1	S32 29 29.7 E24 55 15.4	887Ha		173Ha
29	KLIPFONTEIN RIDGE 2	S32 29 47.8 E24 55 22.4	867Ha		78Ha
30	KLIPFONTEIN 4	S32 28 45.9 E24 54 31.5	851Ha		52Ha
31	IMPALA RIDGE	S32 24 21.8 E24 53 20.9			
33	R R DEAD END	S32 23 49.4 E24 53 36.1	833Ha	6Ha	572Ha
34	R R RESERVOIR	S32 23 55.9 E24 53 26.8			
32	BOUWERSHOEK	S32 24 13.2 E24 55 34.2	897Ha		306Ha
55	NEW SITE	S32 28 45.9 E24 54 31.5	869Ha		44Ha
35	WOLVKLOOF SOUTH	S32 22 43.3 E24 53 36.8	825.5Ha		235Ha
36	MODELMANNETJIE	S32 22 53.1 E24 52 40.9			
38	TRACKER ACADEMY			7.5Ha	
39	STUDENT VOLUNTEER				
40	AASVOELBERG POINT	S32 23 12.2 E24 50 00.0	828Ha	160Ha	136Ha
41	RIVERBEND - NEW LODGE	S32 24 06.9 E24 51 02.0		5Ha	
42	AASVOELBERG CLIFF	S32 23 28.3 E24 48 35.3	833Ha	159Ha	234Ha
43	PLATEAU VIEW	S32 23 14.5 E24 47 52.7	833Ha	476Ha	84Ha
44	FONTEINPLAAS	S32 25 03.9 E24 45 51.5	833Ha	306Ha	10Ha
45	GREEN TREES	S32 25 57.1 E24 44 52.6	799.4Ha	33.6Ha	101Ha
46&47	RESERVE MANAGEMENT				106Ha
49	LOSKOP PLATEAU RESEARCH CENTRE	S32 42 31.9 E24 43 43.4	833Ha	10Ha	300Ha
50	LOSKOP WINDMILL	S32 23 52.3 E24 42 33.5	833Ha		419Ha
51	DUGMORE	S32 22 46.1 E24 44 30.2	833Ha		137Ha
52	WINDMILL NEST N	S32 22 56.9 E24 44 11.8	833Ha		215Ha
53	CABBAGE TREE	S32 22 47.5 E24 46 07.0	833Ha	225Ha	423Ha
54	SECRET WELL	S32 22 39.6 E24 47 41.7	833Ha		221Ha
<b>TOTAL SAMARA GAME RESERVE</b>		<b>26 894Ha</b>	<b>26 809.7Ha</b>	<b>84.3Ha</b>	<b>3 166Ha</b>

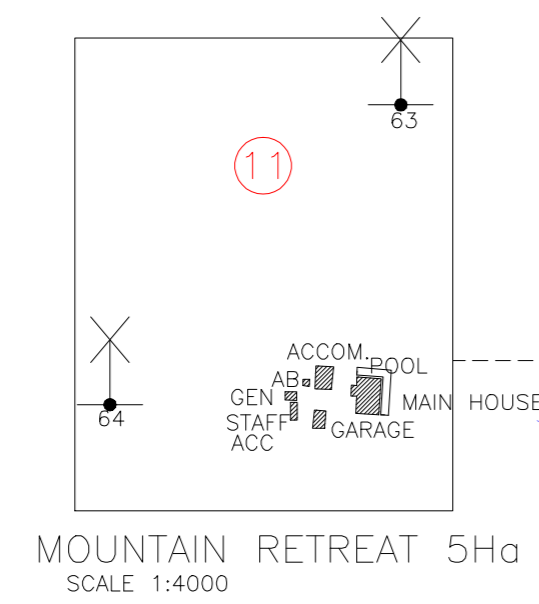
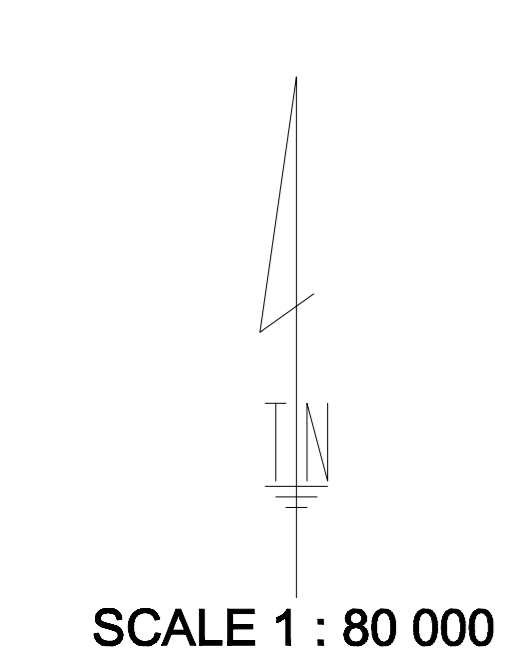

- LEGEND**
- ① SUBDIVISION LINE (No Fences)
  - POSSIBLE BUILDING SITES
  - EXISTING FACILITIES
  - △/△△ PROPOSED PORTIONS RANGING FROM 811Ha TO 948Ha INDICATED BY LINE (NO FENCES)
  - ⊕ BOREHOLES
  - EXISTING ROADS
  - RIVERS, STREAMS & DAMS

*andré van der walt* en assosiate and associates  
**PROFESSIONELE LANDMETER**  
**PROFESSIONAL LAND SURVEYOR**  
 P.O.BOX 72650  
 LYNNWOOD RIDGE  
 0040  
 E-Mail : itio1754@mweb.co.za  
 TEL : 083 279 0155  
 FAX : 086 670 9149

**Derick Peacock Associates**  
**RESORT AND LEISURE PLANNERS**  
**TOWN AND REGIONAL PLANNERS**  
 P.O.BOX 11352  
 SILVER LAKES  
 0054  
 E-Mail : dposso@telkomsa.net  
 TEL : 012 809 2124

PLAN NUMBER	AMMENDMENTS	DATE
SAMARA	FIRST ISSUE	NOVEMBER 2010
SAMARA2	MARKETING PLAN	JANUARY 2011
SAMARA3	MARKETING PLAN(ADMIN BOUNDARY & LAYOUT)	MARCH 2011
SAMARA4	AMMEND BOUNDARIES	APRIL 2011
SAMARA5	FENCE ADDED	10 APRIL 2011
SAMARA6	EXCLUSION AREAS	13 APRIL 2011
SAMARA7	VEGETATION AREAS	24 APRIL 2011