

- Sanderson Associates (Consulting Engineers) Ltd ("the consultant"), has not checked or verified, and shall have no liability whatsoever for any inaccuracies which may be attributable to any data, reports, base plan(s) and drawings provided by the client, or purchased by the consultant on the client's behalf, that may have been utilised within this drawing.
- The consultant shall not be liable for the use by any person of any document for any purpose other than that for which the same were provided by the consultant.
- No liability whatsoever is accepted by the consultant for any error or omissions.
- The consultant accepts no liability for any vehicle specification errors within the vehicle track software used and / or its vehicle libraries.
- The locations of utilities apparatus, if shown, is reproduced from plans supplied to the consultant, although care has been taken when duplicating this information. These locations are approximate only and no guarantee can be given for their accuracy. It is the client's or its appointed agent/contractors responsibility to verify the exact locations on site by hand dug trial holes or other appropriate means prior to mechanical excavation.
- Service connections are not shown but their presence should be anticipated.
- Reference to any third party equipment shown on this drawing was only relevant at the time the drawing was prepared.
- It is the client's responsibility to ensure that any equipment ordered meets the design.

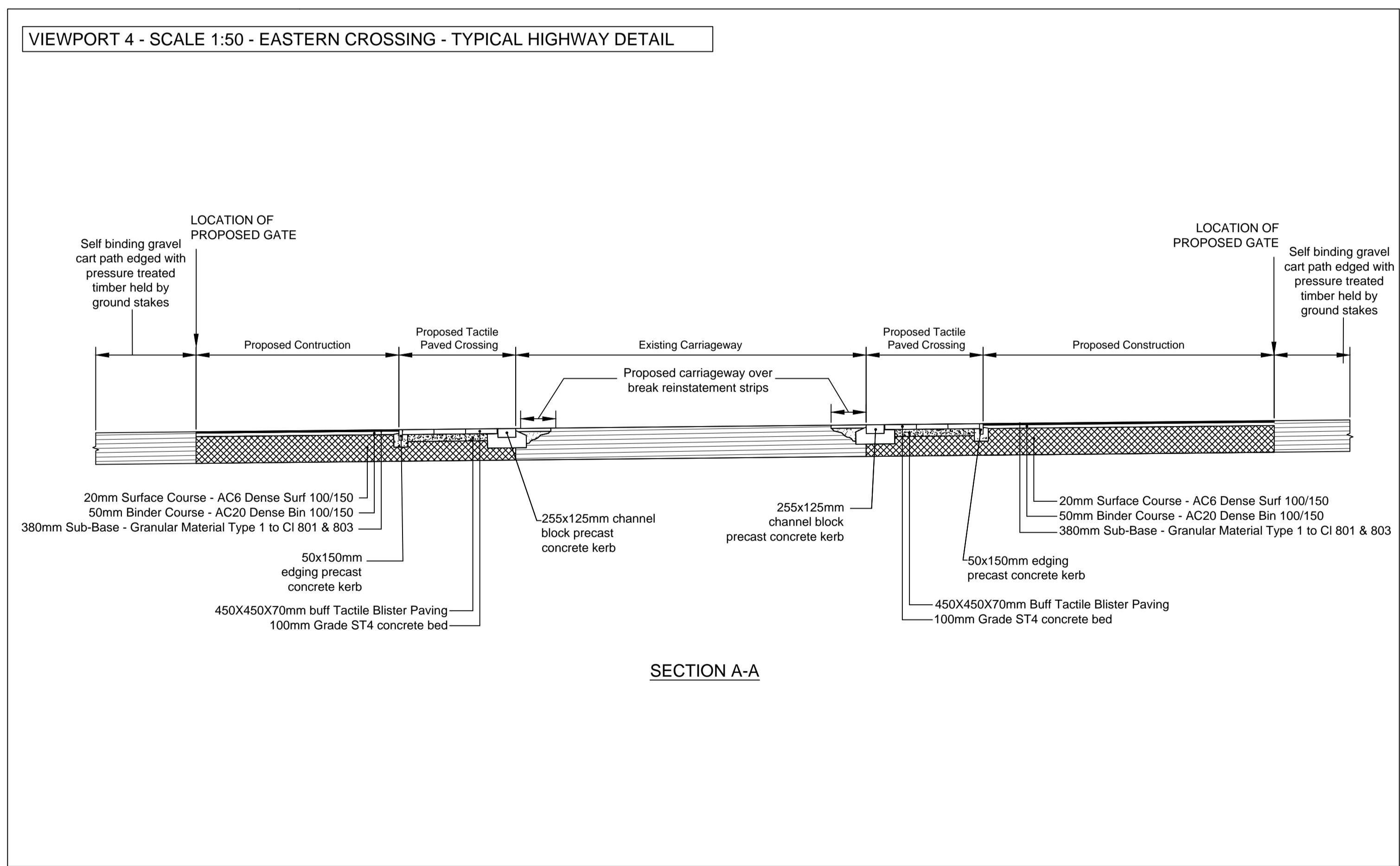
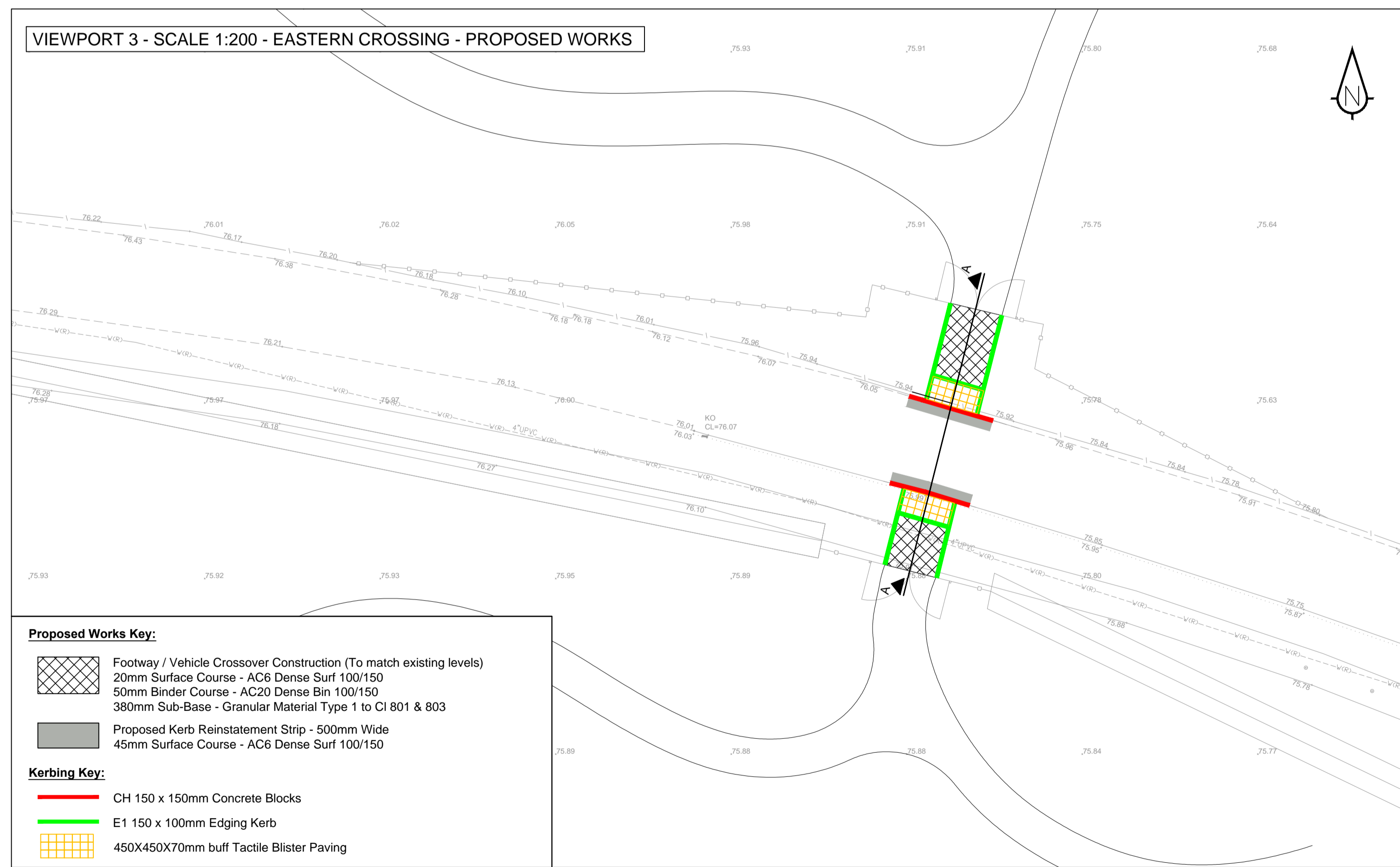

<p>sanderson[®] associates (consulting engineers) Ltd Highways Traffic Transportation Water T 01924 844080 mail@sandersonassociates.co.uk F 01924 844081 www.sandersonassociates.co.uk</p>	Client	Project Title	Drawing Title				Scale	AS SHOWN	Drawn By	NJB			
	KINGSTON HILL GOLF CLUB LIMITED	INGESTRE PARK GOLF CLUB	PEDESTRIAN CROSSING DETAILS EASTERN ACCESS	A	Location of Western access updated	NJB	25.01.21	PJM	Checked By	PJM			
				Rev	Amendment	Drawn	Date	Checked	Date	23.12.20	Approved By	PJM	
											Drawing Number	11756-100-002	Rev

**PRELIMINARY
DRAWING**