

**Heavy Standard Trees**

- Transplanted Mature Tree
- Acer campestre
- Alnus glutinosa
- Alnus incana
- Araucaria araucana
- Betula pendula
- Castanea sativa
- Cedrus atlantica
- Cedrus deodara
- Cedrus libani
- Corylus avellana
- Crataegus monogyna
- Fagus sylvatica
- Juglans regia
- Pinus sylvestris
- Pinus wallichiana
- Prunus avium
- Prunus spinosa
- Quercus petraea
- Quercus robur
- Salix alba
- Salix babingtonia
- Sequoia sempervirens
- Sorbus aucuparia
- Tilia x euchlora
- Tilia x europaea
- Tilia platyphyllos

**Woodland (Whips only)**

- Acer campestre
- Alnus cordata
- Alnus glutinosa
- Betula nigra
- Alnus incana
- Betula nigra
- Betula pendula
- Carpinus betulus
- Castanea sativa
- Cornus sanguinea
- Corylus avellana
- Crataegus monogyna
- Euonymus europaeus
- Fagus sylvatica
- Ilex aquifolium
- Juglans regia
- Prunus avium
- Prunus spinosa
- Quercus petraea
- Quercus robur
- Rosa canina
- Sorbus aucuparia
- Taxodium distichum
- Tilia cordata
- Tilia x euchlora
- Tilia x europaea
- Tilia platyphyllos
- Viburnum opulus

**Wetland Trees (Whips only)**

- Alnus cordata
- Alnus glutinosa
- Betula nigra
- Populus tremula 'Erecta'
- Salix alba
- Salix sepulcralis 'Chrysocoma'
- Taxodium distichum

**Legend**

- Protected Gas Main
- Post & Wire Fence
- Pair 8ft Timber Gates
- Boundary Fence (by HS2)
- Retained Trees
- New Whips
- Long Rough / Grassland Habitat
- Mown Rough
- Semi Rough
- Fairways
- Green
- Tree
- Hedges:
  - Corylus avellana
  - Crataegus monogyna
  - Ilex aquifolium
  - Prunus spinosa
  - Rosa canina
  - Sambucus nigra
  - Viburnum opulus
- Removed Trees / Hedges
- 3.5m Wide Maintenance Bridge
- 2.2m Wide Pedestrian Bridge
- Bunker
- Retained Hedge

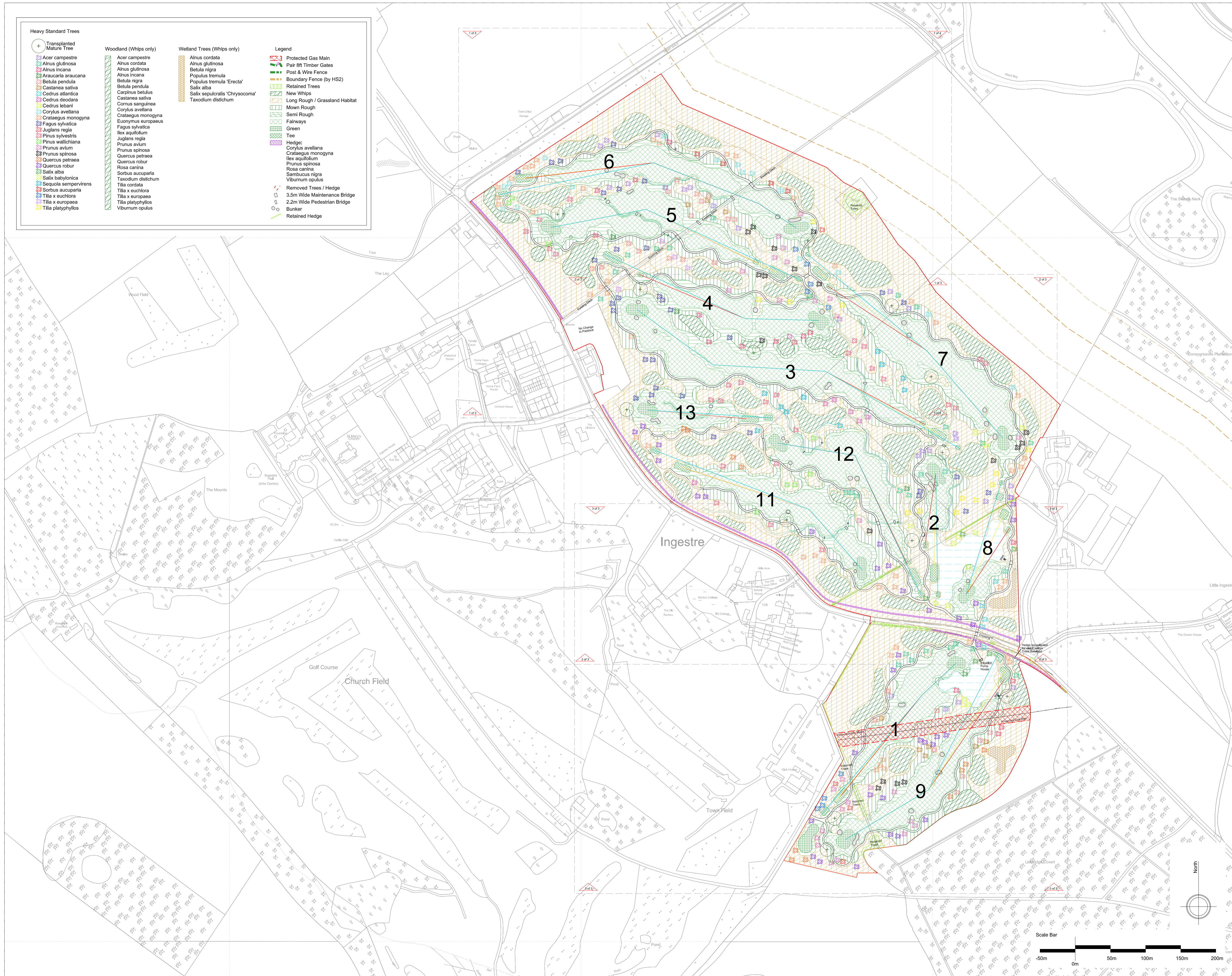

**GENERAL NOTES**

- 
- 
- 
- 
- 

**REVISIONS**

REV	DATE	DESCRIPTION	REV BY	CHK BY
D	25/05/2021	HS2 Feedback	SS	JH
C	10/02/2021	Signals replaced with Ebbes Water Soldier removed.	SS	JH
B	15/12/2020	Whip area adjacent to existing hole # 4 shored, (previously missed on masterplan although shown on tree planting plan)	SS	JH
A	15/12/2020	Tree density reduced to 2m spacing following ecologists advice. Tree protection and seed mixes amended.	SS	JH

**KEY PLAN**

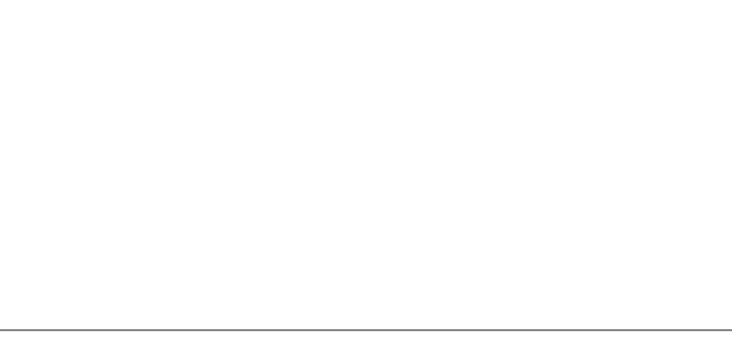

**CONSULTANT**



**LEAD CONSULTANT**

**CLIENT**



**ISSUED FOR**

Planning Direction

**PROJECT**

Ingestre Park Golf Club

**DRAWING TITLE**

Proposed Routing Plan

Drawn	JH	Checked	AC	Approved	RH
Date	20/11/2020	Sheet Size	A1	Scale	1:2500 @A1
Drawing No.	G982 NC 707 PROPOSED ROUTING PLAN			Rev.	D

CAD File No.	G982 NC 707 PROPOSED ROUTING PLAN	Consultant Project No.	
--------------	-----------------------------------	------------------------	--

This drawing, the designs and details shown are the copyright of International Design Group and shall not be copied or reproduced in any form without their written consent.



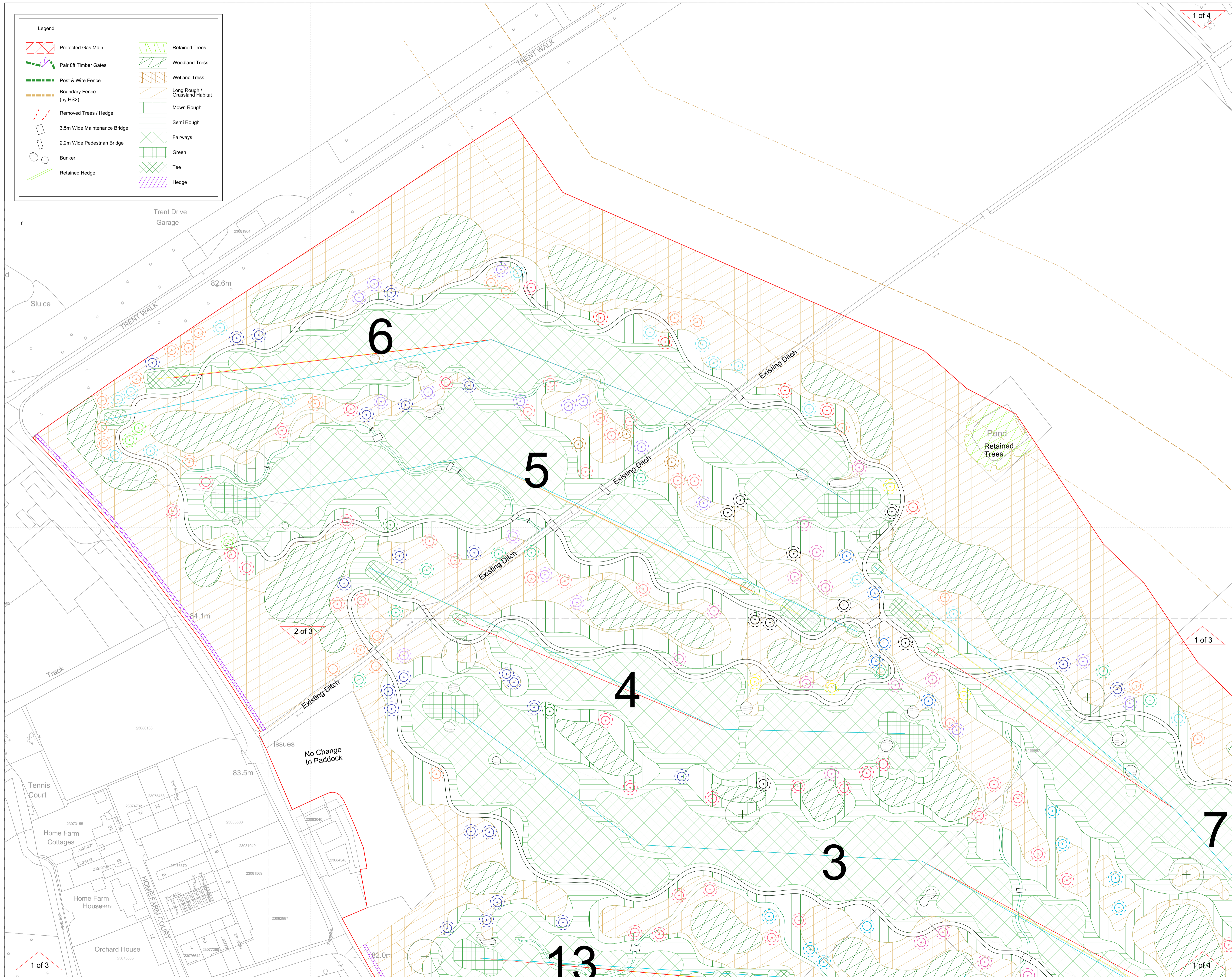

GENERAL NOTES

- 01.
- 02.
- 03.
- 04.
- 05.

REVISIONS

REV	DATE	DESCRIPTION	REV BY	CHK BY
D	25.05.2021	HS2 Feedback	SS	JH
C	10/02/2021	Signalls replaced with Ebbw Water Soldier removed	SS	JH
B	18/12/2020	Who area adjacent to existing hole # 4 added, (previously missed on masterplan although shown on tree planting plan)	SS	JH
A	15/12/2020	Tree density reduced to 2m spacing following ecologists advice. Tree protection and seed mixes amended.	SS	JH

KEY PLAN

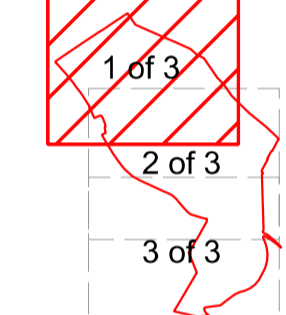

CONSULTANT



LEAD CONSULTANT

CLIENT



ISSUED FOR

Planning Direction

PROJECT

Ingestre Park Golf Club

DRAWING TITLE

Routing Plan 1 of 3

Drawn	JH	Checked	AC	Approved	RH
Date	20/11/2020	Sheet Size	A1	Scale	1:1000 @A1
Drawing No.	G982 NC 707-1 PROPOSED ROUTING PLAN 1 OF 3			Rev.	D

CAD File No. G982 NC 707-1 PROPOSED ROUTING PLAN 1 OF 3  
 Consultant Project No. G982 NC 707-1 PROPOSED ROUTING PLAN 1 OF 3  
 This drawing, the designs and details shown are the copyright of International Design Group and shall not be copied or reproduced in any form without their written consent.  
 © INTERNATIONAL DESIGN GROUP



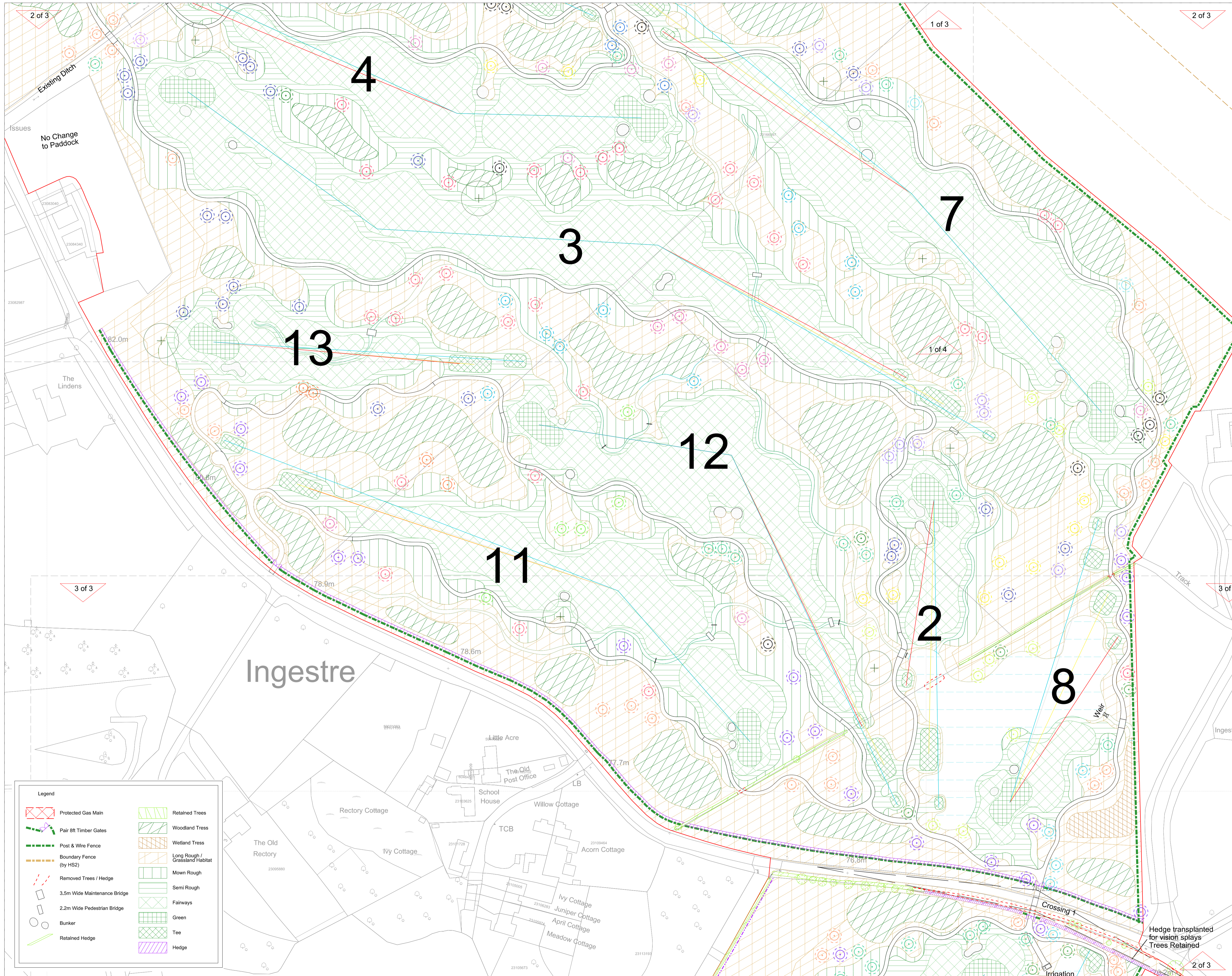

GENERAL NOTES

- 01.
- 02.
- 03.
- 04.
- 05.

REVISIONS

REV	DATE	DESCRIPTION	REV BY	CHK BY
D	25.05.2021	HS2 Feedback	SS	JH
C	10/02/2021	Stalls replaced with Elder. Water Solder removed.	SS	JH
B	18/12/2020	Who area adjacent to existing hole # 4 added. (previously missed on masterplan although shown on tree planting plan)	SS	JH
A	15/12/2020	Tree density reduced to 2m spacing following ecologists advice. Tree protection and seed mixes amended.	SS	JH

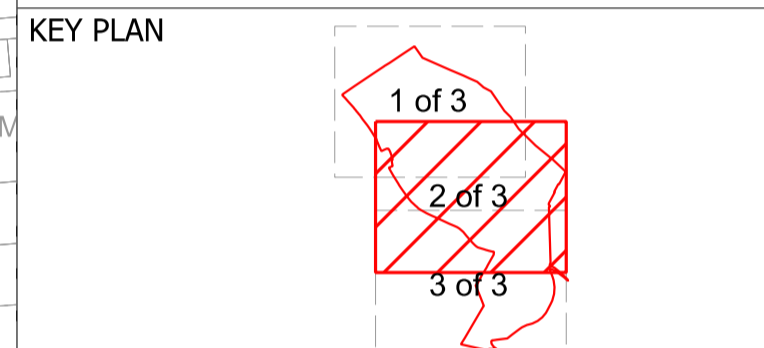

3 of 3 LEAD CONSULTANT

CLIENT

ISSUED FOR

Planning Direction

PROJECT

Ingestre Park Golf Club

DRAWING TITLE

Routing Plan 2 of 3

Drawn	JH	Checked	AC	Approved	RH
Date	20/11/2020	Sheet Size	A1	Scale	1:1000 @A1
Drawing No.	G982 NC 707-2 PROPOSED ROUTING PLAN 2 OF 3			Rev.	D
CAD File No.	G982 NC 707-2 PROPOSED ROUTING PLAN 2 OF 3			Consultant Project No.	G982 NC 707-2 PROPOSED ROUTING PLAN 2 OF 3

This drawing, the designs and details shown are the copyright of International Design Group and shall not be copied or reproduced in any form without their written consent.

© INTERNATIONAL DESIGN GROUP



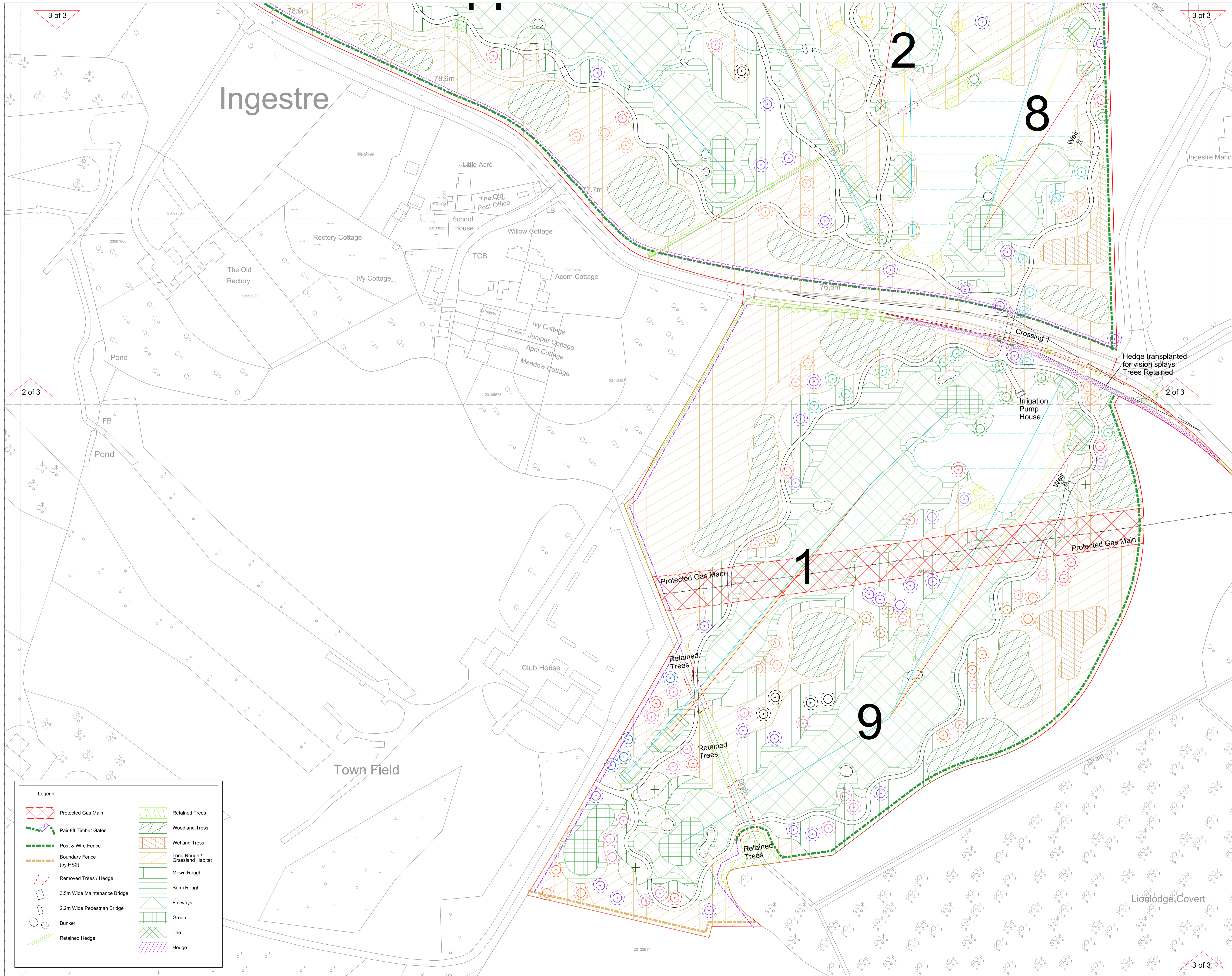

**Legend**

	Protected Gas Main		Retained Trees
	Pair 8ft Timber Gates		Woodland Tress
	Post & Wire Fence		Wetland Tress
	Boundary Fence (by HS2)		Long Rough / Grassland Habitat
	Removed Trees / Hedge		Mown Rough
	3.5m Wide Maintenance Bridge		Semi Rough
	2.2m Wide Pedestrian Bridge		Fairways
	Bunker		Green
	Retained Hedge		Tee
			Hedge

**GENERAL NOTES**

- 01.
- 02.
- 03.
- 04.
- 05.

**REVISIONS**

REV	DATE	DESCRIPTION	REV BY	CHK BY
D	25/05/2021	HS2 Feedback	SS	JH
C	10/02/2021	Signalls replaced with Elber. Water Solder removed.	SS	JH
B	15/12/2020	Who area adjacent to existing hole # 4 shown. (previously missed on masterplan although shown on tree planting plan)	SS	JH
A	15/12/2020	Tree density reduced to 2m spacing following ecologists advice. Tree protection and seed mixes amended.	SS	JH

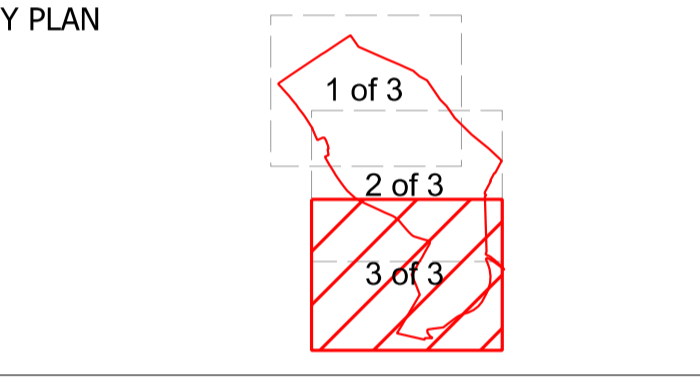

**LEAD CONSULTANT**

**CLIENT**

**ISSUED FOR**

Planning Direction

**PROJECT**

Ingestre Park Golf Club

**DRAWING TITLE**

Routing Plan 3 of 3

Drawn	JH	Checked	AC	Approved	RH
Date	20/11/2020	Sheet Size	A1	Scale	1:1000 @A1
Drawing No.	G982 NC 707-3 PROPOSED ROUTING PLAN 3 OF 3			Rev.	D

**CAD File No.**  
G982 NC 707-3 PROPOSED ROUTING PLAN 3 OF 3

**Consultant Project No.**  
G982 NC 707-3 PROPOSED ROUTING PLAN 3 OF 3

This drawing, the designs and details shown are the copyright of International Design Group and shall not be copied or reproduced in any form without their written consent.

© INTERNATIONAL DESIGN GROUP