

Notes
 1. Refer to drawing nos
 2PT10-ARP-CV-DPP-000-011009 &
 2PT10-ARP-CV-DPP-000-011010
 for HS2 Phase 2a Main Line Plan and Profile.

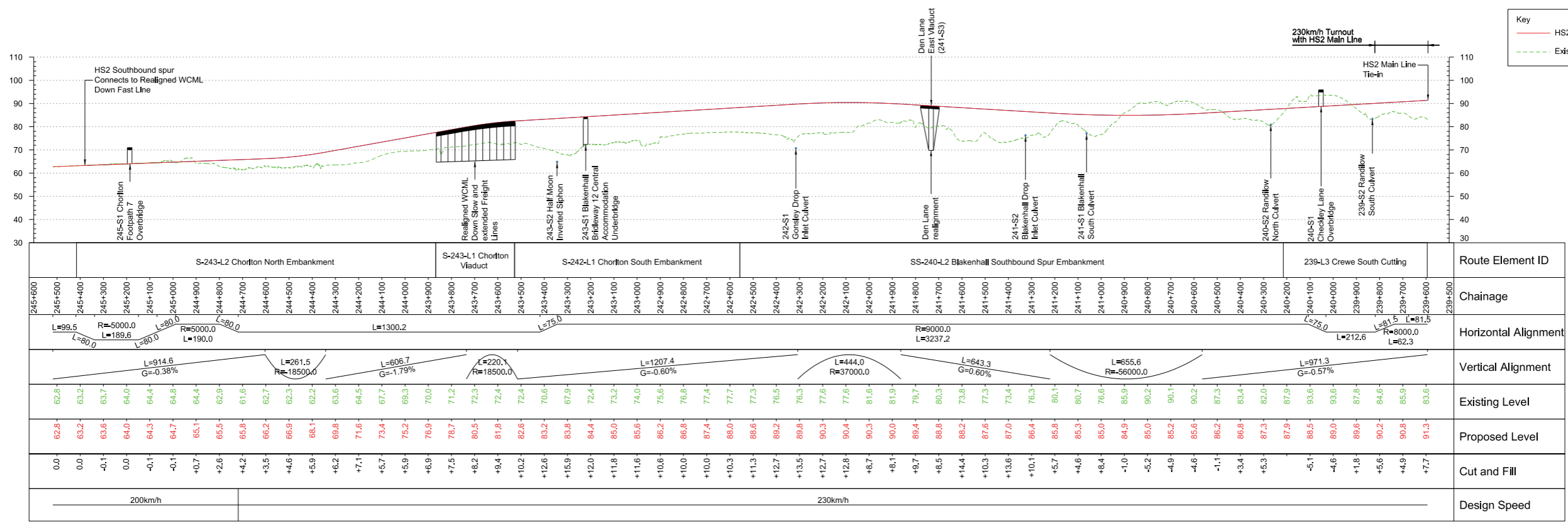

HS2 Spur (Southbound)

Profile
 Scale H:1:10,000 V:1:1000 @ A1

Fit for Acceptance

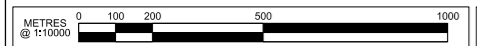

| Rev | Description | Drawn | Checked | Con App | HS2 App | Scale with caution as distortion can occur. |
|-----|---|-------|---------|---------|---------|--|
| P02 | Final Preliminary Design Approved for publication | DM1 | IMD | DE | | HS2 accepts no responsibility for any circumstances which arise from the reproduction of this document after alteration, amendment or abbreviation or if it is issued in part or issued incompletely in any way. |
| P01 | Final Preliminary Design | CW | IMD | DE | | © Crown Copyright and database right 2019. All rights reserved. Ordnance Survey Licence number 100049190 |

Legends/Notes:

- Depot, station, headhouse or portal building
- Tunnel portal
- Electricity substation
- Land drainage area
- Ecological mitigation pond
- Balancing pond
- Replacement floodplain storage
- Woodland habitat creation
- Wetland habitat creation
- Grassland habitat creation
- Ecological mitigation planting (scrub / woodland)
- Grassed areas
- Local placement of surplus excavated material
- Public realm/Replacement community facility
- Hedgerow habitat creation
- Main utility works
- Engineering earthworks
- Landscape earthworks
- Rail alignment formation
- Returned to suitable development use
- County boundary
- Borough / District boundary
- Community Area boundary
- Watercourse diversion
- Existing watercourse
- Ditches - new
- Existing Woodland
- Existing Buildings
- Existing Inland Water
- Existing Contours
- HS2 Access road
- Noise fence barrier
- HS2 Mainline Rail alignment
- Chainage (e.g. 10+000)
- Existing public right of way (PRoW)
- New, diverted or realigned PRoW
- Stopped-up PRoW
- Tunnels external extent
- Modified Network Rail alignment
- HS2 Spur Rail alignment
- Chainage (e.g. 10+000)

HS2

Registered in England
 Registration No. 05791686
 Registered office:
 2 Snow Hill, Queensway,
 Birmingham, B4 6GA

Creator/Originator
Ove Arup & Partners International Ltd

| Zone | Route Wide | Project/Contract |
|---------------|--|---|
| Design Stage | Hybrid Bill - Final Preliminary Design FPD | C861 Hybrid Bill Final Preliminary Design (FPD) |
| Drawing Title | HS2 Southbound Spur | Discipline/Function Civil |
| Sheet | Sheet 15 | Drawn DM1 |
| | | Checked IMD |
| | | Approved DE |
| | | Date 09/04/2020 |
| | | Scale AS SHOWN |
| | | Size A1 |
| | | Drawing No. 2PT10-ARP-CV-DPP-000-011015 |
| | | Rev. P02 |