

Plan
Scale 1:10,000 @ A1

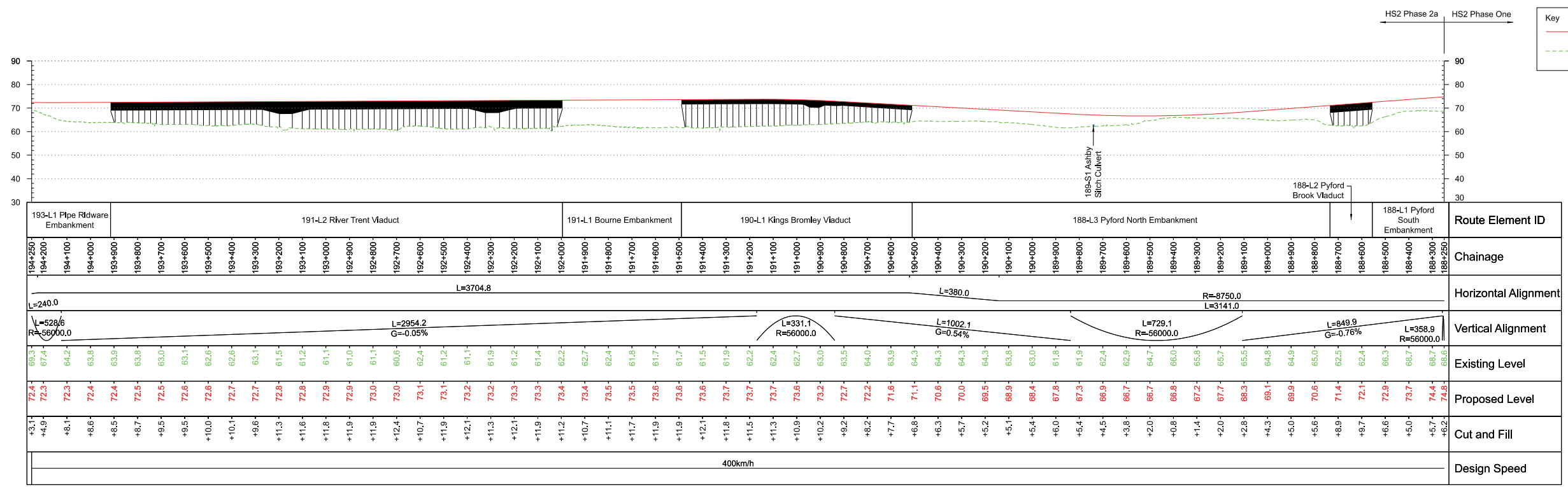

Profile
Scale H:1:10,000 V:1:1000 @ A1

Fit for Acceptance

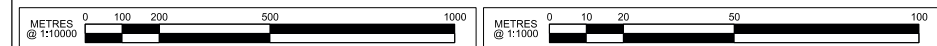

Rev	Description	Drawn	Checked	Con App	HS2 App
P02	Final Preliminary Design Approved for publication	DM1	IMD	DE	15/04/2020
P01	Final Preliminary Design	CW	IMD	DE	09/04/2020

HS2 accepts no responsibility for any circumstances which arise from the reproduction of this document after alteration, amendment or abbreviation or if it is issued in part or issued incompletely in any way.

© Crown Copyright and database right 2019. All rights reserved. Ordnance Survey Licence number 100049190

© Crown Copyright material is reproduced with the permission of Land Registry under delegated authority from the Controller of HMSO. This material was last updated on 2019 and may not be copied, distributed, sold or published without the formal permission of Land Registry. Only an official copy of a title plan or register obtained from the Land Registry may be used for legal or other official purposes.

Legends/Notes:

- Depot, station, headhouse or portal building
- Tunnel portal
- Electricity substation
- Land drainage area
- Ecological mitigation pond
- Balancing pond
- Replacement floodplain storage
- Woodland habitat creation
- Wetland habitat creation
- Grassland habitat creation
- Ecological mitigation planting (scrub / woodland)
- Grassed areas
- Local placement of surplus excavated material
- Public realm/Replacement community facility
- Hedgerow habitat creation
- Main utility works
- Engineering earthworks
- Landscape earthworks
- Rail alignment formation
- Returned to suitable development use
- County boundary
- Borough / District boundary
- Community Area boundary
- Watercourse diversion
- Existing watercourse
- Ditches - new
- Existing Woodland
- Existing Buildings
- Existing Inland Water
- Existing Contours
- HS2 Access road
- Noise fence barrier
- HS2 Mainline Rail alignment
- Chainage (e.g. 10+000)
- Existing public right of way (PRoW)
- Existing diverted or realigned PRoW
- Stopped-up PRoW
- Tunnels external extent

Registered in England
Registration No. 06791686
Registered office:
2 Snow Hill, Queensway,
Birmingham, B4 6GA

Creator/Originator
Ove Arup & Partners International Ltd

Zone	Route Wide	Project/Contract
Design Stage	Hybrid Bill - Final Preliminary Design FPD	C861 Hybrid Bill Final Preliminary Design (FPD)
Drawing Title	Main Line Sheet 1 Chainage 188+250 to 194+250	Discipline/Function Civil
Drawn	DM1	Checked IMD
Date	09/04/2020	Approved DE
Drawing No.	2PT10-ARP-CV-DPP-000-011001	Scale AS SHOWN
Rev.	P02	Size A1

Case 1 - Accepted