

From: [REDACTED]
To: [REDACTED]
Subject: 42668 - Boundary co-ordinates for parcel ref 710. Pegging out and installing a fence
Date: 30 September 2020 16:14:49
Attachments: [42668_001.pdf](#)
[42668_Boundary_CAD.dwg](#)
[42668_Boundary_CAD.dwg.xml](#)
[42668_coordinates.xlsx](#)

Hi [REDACTED]

I have received your 2 job requests 34066 & 42668. Looking at the description and the location, I believe they both refer to the same location. But please let me know if I have misinterpreted this.

Please find attached the plan which contains the co-ordinates for the boundary of parcel 710 (EX704142) with Mount Lodge in Basildon.

I have also attached an Excel spreadsheet with the co-ordinates and the CAD export in case these are required.

Many thanks

[REDACTED]

From: [REDACTED]
To: [REDACTED]
Subject: FW: 42668 - Boundary co-ordinates for parcel ref 710. Pegging out and installing a fence
Date: 05 October 2020 12:44:00
Attachments: [image001.png](#)
[image002.png](#)
[42668_001.pdf](#)
[42668_004.pdf](#)
[42668_003.pdf](#)
[42668_002.pdf](#)

Importance: High

Hi [REDACTED]
Please see plans.
[REDACTED]

[REDACTED]

Homes
England

[REDACTED]
[REDACTED] [homesengland.gov.uk](https://www.homesengland.gov.uk)
One Friargate, Coventry, CV1 2GN

#MakingHomesHappen
We're the government's housing accelerator. We have the appetite, influence, expertise and resources to drive positive market change. [Find out more and help make this happen](#)



OFFICIAL SENSITIVE - COMMERCIAL

[REDACTED]

From: [REDACTED]
Sent: 07 October 2020 07:55
To: [REDACTED]
Subject: PO for Basildon
Attachments: PO-HE01013.pdf

Good Morning [REDACTED]

Please find attached the PO for the veg clearance at the site adjacent to Mount Lodge and the site meeting on the 6th October 2020.

Many thanks,
[REDACTED]

[REDACTED]



[REDACTED]
[REDACTED]
[REDACTED] [homesengland.gov.uk](https://www.homesengland.gov.uk)

One Friargate, Coventry, CV1 2GN

#MakingHomesHappen

We're the government's housing accelerator. We have the appetite, influence, expertise and resources to drive positive market change. [Find out more and help make this happen.](#)



OFFICIAL

[REDACTED]

From: [REDACTED]
Sent: 08 June 2020 10:47
To: [REDACTED]
Subject: Fencing quote GLS

Morning [REDACTED]
Please can you provide a quote for the fencing works adjacent to [REDACTED] in Basildon.
I am lining the surveyor and yourselves for a start date on the 6th July. Please confirm that you will be able to meet this.
Kind regards,

[REDACTED]
[REDACTED]



[REDACTED]
[REDACTED]
[REDACTED] [@homesengland.gov.uk](mailto:[REDACTED]@homesengland.gov.uk)

One Friargate, Coventry, CV1 2GN

#MakingHomesHappen

We're the government's housing accelerator. We have the appetite, influence, expertise and resources to drive positive market change. [Find out more and help make this happen.](#)



OFFICIAL

[REDACTED]

From: [REDACTED]
Sent: 08 June 2020 15:46
To: [REDACTED]@slpsolutions.co.uk
Subject: RE: Gardiners Lane fencing

Hi [REDACTED]
[REDACTED] gate onto site which has a small ditch to cross, but [REDACTED] planting a row of conifers behind the fence and hedge. I will try and find a picture.
Kind regards,
[REDACTED]

[REDACTED]



[REDACTED]
[REDACTED]
[REDACTED]@homesengland.gov.uk

One Friargate, Coventry, CV1 2GN

#MakingHomesHappen

We're the government's housing accelerator. We have the appetite, influence, expertise and resources to drive positive market change. [Find out more and help make this happen.](#)



OFFICIAL

From: [REDACTED]@slpsolutions.co.uk <[REDACTED]@slpsolutions.co.uk>
Sent: 08 June 2020 15:16
To: [REDACTED]@homesengland.gov.uk>
Subject: Gardiners Lane fencing

Hi [REDACTED]

Assuming adequate access is available for small machinery we can provide and install standard post and three rail fencing as per supplied plans and presumably the exact line will be marked out for us for the sum of [REDACTED]^{reg. 12(6)} per metre giving total cost of [REDACTED]^{reg. 12(6)(e)}.
As previously discussed I would like to include an additional half a day for 2 men for interruptions and minor changes etc at [REDACTED]^{reg. 12(6)(e)}

Kind Regards

[REDACTED]

[REDACTED]

[REDACTED]@slpsolutions.co.uk

Visit our website: www.slpsolutions.co.uk
Company Registration Number: 09949835
Vat Registration Number: 237 4409 06

WARNING

This e-mail and any attachments may contain information which is confidential or privileged and is intended for the sole use of the named recipient. If you are not the intended recipient, be aware that

any disclosures, copying, distribution or use of the contents is prohibited.
If you have received this e-mail in error, please notify our offices by
telephone immediately

[REDACTED]

From: [REDACTED]
Sent: 15 September 2020 08:28
To: [REDACTED]
Subject: Gardiners close/ Mount lodge purchase order
Attachments: PO-HE00803.pdf

Good Morning [REDACTED]

Please find attached the Purchase order for the fencing works to the boundary at Gardiners Close/ Mount Lodge.

Works to start on the 5th October 2020.

Kind regards,

[REDACTED]

[REDACTED]



[REDACTED]

[REDACTED]

[REDACTED] [@homesengland.gov.uk](mailto:[REDACTED]@homesengland.gov.uk)

One Friargate, Coventry, CV1 2GN

#MakingHomesHappen

We're the government's housing accelerator. We have the appetite, influence, expertise and resources to drive positive market change. [Find out more and help make this happen.](#)



OFFICIAL

[REDACTED]

From: [REDACTED]
Sent: 18 October 2020 18:42
To: [REDACTED]
Subject: Incident form
Attachments: accident incident report form SHE 1.pdf

Hi [REDACTED]

Please can I ask you to fill in the form as best you can in light of the site incident on Friday.

Any questions please don't hesitate to call me.

Many thanks,

[REDACTED]

[REDACTED]



[REDACTED]

[REDACTED]

[REDACTED] [@homesengland.gov.uk](mailto:[REDACTED]@homesengland.gov.uk)

One Friargate, Coventry, CV1 2GN

#MakingHomesHappen

We're the government's housing accelerator. We have the appetite, influence, expertise and resources to drive positive market change. [Find out more and help make this happen.](#)



OFFICIAL

[REDACTED]

From: [REDACTED]
Sent: 19 October 2020 08:09
To: [REDACTED]
Subject: Friday

Hi [REDACTED]
Please can you send me the record of what happened on Friday with yourself and the fencing as soon as possible. Please can you also confirm all wasted costs as we need to include those in a letter we are sending out.
Many thanks,

[REDACTED]

[REDACTED]



[REDACTED]
[REDACTED]

[REDACTED] [@homesengland.gov.uk](mailto:[REDACTED]@homesengland.gov.uk)

One Friargate, Coventry, CV1 2GN

#MakingHomesHappen

We're the government's housing accelerator. We have the appetite, influence, expertise and resources to drive positive market change. [Find out more and help make this happen.](#)



OFFICIAL

[REDACTED]

From: [REDACTED]
Sent: 26 May 2020 09:46
To: [REDACTED]
Subject: Post and rail quote, Basildon
Attachments: 005 Basildon Lane Boundary .pdf

Hello [REDACTED]

Please can I have a quote for 220 m of Post and three rail fencing for [REDACTED] in Baidon.
Standard post and three rail fencing specification to be used.

Many thanks,
[REDACTED]

[REDACTED]



[REDACTED]
[REDACTED]
[REDACTED] [@homesengland.gov.uk](mailto:[REDACTED]@homesengland.gov.uk)

One Friargate, Coventry, CV1 2GN

#MakingHomesHappen

We're the government's housing accelerator. We have the appetite, influence, expertise and resources to drive positive market change. [Find out more and help make this happen.](#)



OFFICIAL

ACCIDENT/INCIDENT REPORT FORM – SHE1

APPENDIX 1 – ACCIDENT / INCIDENT REPORT FORM SHE1

PART A – TO BE COMPLETED BY THE PERSON MAKING THE REPORT

1. Details of the person reporting the incident

Forename:	Click here to enter text.	Surname:	Click here to enter text.
Telephone:	Click here to enter text.	Email:	Click here to enter text.
Employer:	Click here to enter text.	Job Title:	Click here to enter text.

2. Details about the incident

Incident Date & Time:	Click here to enter a date. Time: Click here to enter text. AM <input type="checkbox"/> PM <input type="checkbox"/>		
Address where incident occurred:	Click here to enter text		
Postcode:	Click here to enter text.		
Exact Location of Occurrence :	Click here to enter text		
Witness Name:	Click here to enter text.	Witness Contact No:	Click here to enter text.
Describe precisely what happened:			
Click here to enter text.			

3. What kind of incident are you reporting?

An injury or an illness?	Yes <input type="checkbox"/> No <input type="checkbox"/> (Complete Sections 4 to 7)
A reportable dangerous occurrence?	Yes <input type="checkbox"/> No <input type="checkbox"/> Don't Know <input type="checkbox"/> (Complete Section 8)
Damage to property or vehicles?	Yes <input type="checkbox"/> No <input type="checkbox"/> (Complete Section 9)
A near miss?	Yes <input type="checkbox"/> No <input type="checkbox"/> (Complete Section 10)
An Environmental Incident?	Yes <input type="checkbox"/> No <input type="checkbox"/> (Complete Section 11)

4. Reporting an injury or illness.

Did the injury or illness result in a fatality?	Yes <input type="checkbox"/> No <input type="checkbox"/>
If an employee, did the injury result in a specified injury? e.g. fracture, amputation:	Yes <input type="checkbox"/> No <input type="checkbox"/> N/A <input type="checkbox"/>
If an employee, did the accident cause the person to be away from work or unable to do their normal job for more than 7 days? (Including weekends and holidays but not including the day of the accident):	Yes <input type="checkbox"/> No <input type="checkbox"/> N/A <input type="checkbox"/>
If an employee, did the employee remain in hospital for 24 hours or more? :	Yes <input type="checkbox"/> No <input type="checkbox"/> N/A <input type="checkbox"/>
If a member of the public, were they taken directly to hospital from the scene of the accident? :	Yes <input type="checkbox"/> No <input type="checkbox"/> N/A <input type="checkbox"/>
If work related illness or disease has it been diagnosed by a medical practitioner?	Yes <input type="checkbox"/> No <input type="checkbox"/> N/A <input type="checkbox"/>
IF YOU HAVE ANSWERED YES TO ANY OF THE ABOVE, THE INCIDENT IS REPORTABLE UNDER RIDDOR AND YOU	

ACCIDENT/INCIDENT REPORT FORM – SHE1

MUST CONTACT A MEMBER OF THE HEALTH AND SAFETY TEAM AS SOON AS POSSIBLE ON 01234 242519 / 01234 242578.

5. Details about the person involved or injured

Forename:	Click here to enter text.	Surname:	Click here to enter text.
Telephone:	Click here to enter text.	Email:	Click here to enter text.
Home Address:	Click here to enter text.	Post Code:	Click here to enter text.
Age:	Click here to enter text.	Gender:	Choose an item.
Status:	Choose an item.	Job Title:	Click here to enter text.
Base:	Choose an item.	Division / Region:	Choose an item.
Team:	Click here to enter text.		

6. Details about the injury

Injury Type:	Choose an item.	Part of body affected:	Click here to enter text.
Materials used in First Aid treatment:	Click here to enter text.		
If an employee, was the person absent from work as a result of the incident?	Yes <input type="checkbox"/> No <input type="checkbox"/> Don't Know <input type="checkbox"/>		
Date absent:	From: Click here to enter a date. To: Click here to enter a date.		

7. Details about the illness

Has the illness or disease been formal diagnosed by medical practitioner?	Yes <input type="checkbox"/> No <input type="checkbox"/>
If yes, please state date of diagnosis:	Click here to enter a date.
Is the illness work related? :	Yes <input type="checkbox"/> No <input type="checkbox"/>
What is the illness?	Click here to enter text.

8. Details about the dangerous occurrence

What is the dangerous occurrence you are reporting? :	Click here to enter text.
If in doubt, please contact a member of the H&S team in the first instance.	

9. Details about the property damage (including road traffic accidents)

Owner of Damaged Property (HCA or Other):	Click here to enter text.
Classification of damage:	Choose an item.

10. Details about a near miss

Hazard Classification:	Choose an item.
How serious / reoccurrence:	Choose an item.

11. Report an environmental incident

Environmental Topic:	Choose an item.	Receptor:	Choose an item.
----------------------	-----------------	-----------	-----------------

ACCIDENT/INCIDENT REPORT FORM – SHE1

Nature of Incident:	Choose an item.	Primary Cause:	Choose an item.
Grid reference / GPS fix? (if known)	Click here to enter text.	eB Reference (if known)	Click here to enter text.

PART B – TO BE COMPLETED BY THE RESPONSIBLE HOMES ENGLAND MANAGER

12. Findings and conclusions drawn from accident investigation carried out by the responsible line manager.

Apparent and underlying causes:	Click here to enter text.		
Immediate Action taken:	Click here to enter text.		
Further Action taken to Prevent Recurrence:	Click here to enter text.		
Who Will Take Action:	Click here to enter text.	By What Date:	Click here to enter a date.
Name:	Click here to enter text.	Position:	Click here to enter text.

PART C – TO BE COMPLETED BY THE HOMES ENGLAND SAFETY, HEALTH AND ENVIRONMENTAL TEAM

13. Regulator notification

Has the incident been reported to a regulator e.g. HSE, Environment Agency?	Yes <input type="checkbox"/> No <input type="checkbox"/>		
If yes, please provide name of regulator:	Choose an item.		
Date contacted:	Click here to enter a date.	If other, please state:	Click here to enter text.
Name of contact:	Click here to enter text.	Position:	Click here to enter text.
Regulator's Office / Base:	Click here to enter text.	Telephone /Ext	Click here to enter text.
Incident Reference No:	Click here to enter text.		

14. Homes England officers who have been notified of this event

Head of Human Resources:	Yes <input type="checkbox"/> No <input type="checkbox"/>
Fleet and Insurance Manager:	Yes <input type="checkbox"/> No <input type="checkbox"/>
Communications	Yes <input type="checkbox"/> No <input type="checkbox"/>
Internal Audit:	Yes <input type="checkbox"/> No <input type="checkbox"/>

15. Comments/involvement/action taken by the Homes England Safety, Health and Environmental team.

Click here to enter text.			
Name:	Click here to enter text.	Date:	Click here to enter a date.

THIS REPORT IS TO BE FORWARDED TO THE HOMES ENGLAND SAFETY, HEALTH AND ENVIRONMENT TEAM BY EMAIL HEALTHANDSAFETY@HOMESENGLAND.GOV.UK WITHIN 3 WORKING DAYS OF THE INCIDENT OCCURRING.



Homes
England

Purchase Order

SLP VEGETATION SOLUTIONS LTD
10 DILLIWOOD FIELDS
ROCHESTER
KENT
ME3 8EY

Order Number: HE00803
Date: 14-SEP-20
Account No: S0112
Vat Reg: 941 6200 50

INVOICE TO:-

INVOICES@HOMESENGLAND.GOV.UK
HOMES ENGLAND
ST GEORGE'S HOUSE
KINGSWAY
TEAM VALLEY, GATESHEAD
NE11 0NA

PLEASE SUPPLY:-	NET AMOUNT
Mount Lodge and Gardiners Close Boundary fencing - to supply and install three rail fencing as per supplied plans and marking out the lines provided by the land surveyor	<div style="text-align: right;">reg. 12(5)(e)</div>
ORDER TOTAL £	<div style="text-align: right;">reg. 12(5)(e)</div>

Requested by	Authorised by
<div style="background-color: black; width: 100px; height: 20px; display: inline-block;"></div> @homesengland.gov.uk	<div style="background-color: black; width: 100px; height: 20px; display: inline-block;"></div>



Homes
England

Purchase Order

SLP VEGETATION SOLUTIONS LTD
10 DILLIWOOD FIELDS
ROCHESTER
KENT
ME3 8EY

Order Number: HE01013
Date: 06-OCT-20
Account No: S0112
Vat Reg: 941 6200 50

INVOICE TO:-

INVOICES@HOMES ENGLAND.GOV.UK
HOMES ENGLAND
ST GEORGE'S HOUSE
KINGSWAY
TEAM VALLEY, GATESHEAD
NE11 0NA

PLEASE SUPPLY:-	NET AMOUNT
Basildon - Winter works, vegetation clearance	reg. 12(5)(e)
	ORDER TOTAL £ reg. 12(5)(e)

Requested by	Authorised by
[Redacted]@homesengland.gov.uk	[Redacted]

POINT	X Co-ord	Y Co-ord
1	571827.42	190324.65
2	571829.52	190314.88
3	571831.3	190305.04
4	571832.05	190300.1
5	571832.78	190292.62

POINT	X Co-ord	Y Co-ord
6	571833.05	190288.89
7	571833.07	190274.19
8	571832.06	190265.2
9	571830.95	190255.27
10	571829.84	190245.33

POINT	X Co-ord	Y Co-ord
11	571829.25	190240.1
12	571829.12	190235.36
13	571828.75	190225.37
14	571828.29	190215.38
15	571827.93	190205.39

POINT	X Co-ord	Y Co-ord
16	571827.44	190195.4
17	571826.83	190185.42
18	571826.65	190175.42
19	571826.61	190165.42
20	571826.65	190158.07



Title
 Boundary of EX704142 with Mount Lodge
 Basildon

TMS Ref -	Parcel Ref 710	Date 30/09/2020	Scale 1:750	Size A3
Plan Ref 42668_001				

Information shown is correct to the best of Homes England's knowledge at date of issue. This map is reproduced from Ordnance Survey material with the permission of Ordnance Survey on behalf of the Controller of Her Majesty's Stationary Office. © Crown Copyright and database rights 2020. Homes England OS 100024383. Unauthorised reproduction infringes Crown copyright and may lead to prosecution or civil proceedings.



Title
 Homes England Title EX704142 v
 Mount Lodge Title EX354657
 Gardiners Close
 Basildon



Homes
 England

Making Homes Happen

TMS Ref
 -

Parcel Ref
 710

Plan Ref
 42668_002

Date
 01/10/2020

Scale
 1:750

Size
 A3

Information shown is correct to the best of Homes England's knowledge at date of issue.
 This map is reproduced from Ordnance Survey material with the permission of Ordnance Survey on
 behalf of the Controller of Her Majesty's Stationary Office. © Crown Copyright and database rights 2020.
 Homes England GD 100024393
 Unauthorised reproduction infringes Crown copyright and may lead to prosecution or civil proceedings.

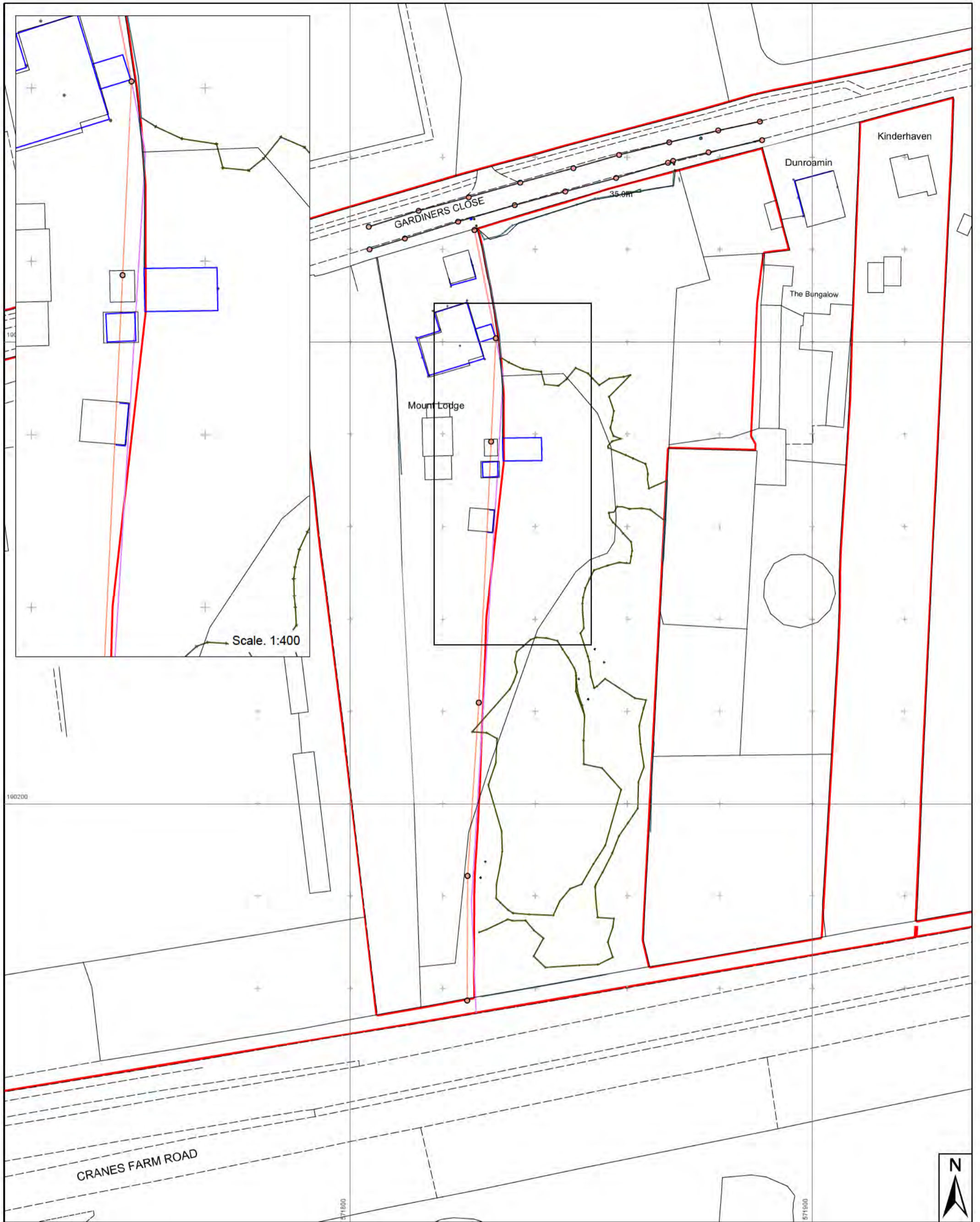

Title
 Homes England ownership (red line) v
 Topographic Survey
 Gardiners Close
 Basildon



Making Homes Happen

TMS Ref -	Parcel Ref 710	Date 01/10/2020	Scale 1:750	Size A3
Plan Ref 42668_003				

Information shown is correct to the best of Homes England's knowledge at date of issue.
 This map is reproduced from Ordnance Survey material with the permission of Ordnance Survey on
 behalf of the Controller of Her Majesty's Stationary Office. © Crown Copyright and database rights 2020.
 Homes England GD 100024383
 Unauthorised reproduction infringes Crown copyright and may lead to prosecution or civil proceedings.

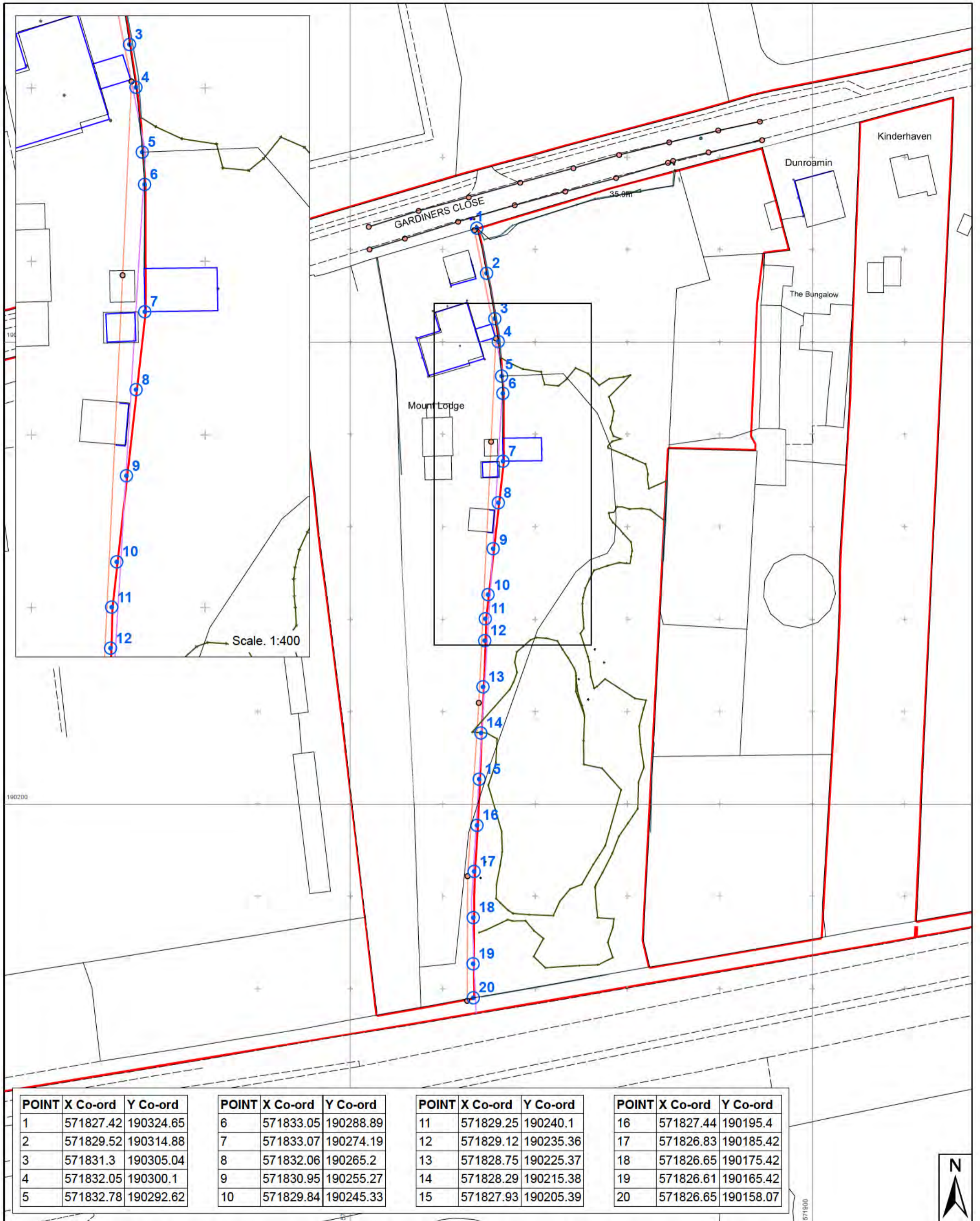

POINT	X Co-ord	Y Co-ord
1	571827.42	190324.65
2	571829.52	190314.88
3	571831.3	190305.04
4	571832.05	190300.1
5	571832.78	190292.62

POINT	X Co-ord	Y Co-ord
6	571833.05	190288.89
7	571833.07	190274.19
8	571832.06	190265.2
9	571830.95	190255.27
10	571829.84	190245.33

POINT	X Co-ord	Y Co-ord
11	571829.25	190240.1
12	571829.12	190235.36
13	571828.75	190225.37
14	571828.29	190215.38
15	571827.93	190205.39

POINT	X Co-ord	Y Co-ord
16	571827.44	190195.4
17	571826.83	190185.42
18	571826.65	190175.42
19	571826.61	190165.42
20	571826.65	190158.07

Title
Homes England ownership (red line) v
Topographic Survey
Gardiners Close
Basildon



Making Homes Happen

TMS Ref

Plan Ref
42668_003

Parcel Ref
710

Date
01/10/2020

Scale
1:750

Size
A3

Information shown is correct to the best of Homes England's knowledge at date of issue.
This map is reproduced from Ordnance Survey material with the permission of Ordnance Survey on behalf of the Controller of Her Majesty's Stationary Office. © Crown Copyright and database rights 2020.
Homes England ID 100024383
Unauthorised reproduction infringes Crown copyright and may lead to prosecution or civil proceedings.

X Co-ord	Y Co-ord	POINT
571827.4	190324.7	1
571829.5	190314.9	2
571831.3	190305	3
571832.1	190300.1	4
571832.8	190292.6	5
571833.1	190288.9	6
571833.1	190274.2	7
571832.1	190265.2	8
571831	190255.3	9
571829.8	190245.3	10
571829.3	190240.1	11
571829.1	190235.4	12
571828.8	190225.4	13
571828.3	190215.4	14
571827.9	190205.4	15
571827.4	190195.4	16
571826.8	190185.4	17
571826.7	190175.4	18
571826.6	190165.4	19
571826.7	190158.1	20

Date 6/10/2020

Pegs up to Stables

Fence line from corner post
up to post 7 corner of
existing old stable.

marking out our boundary
↳ want to be amicable.

pegging the boundary out all to what
they think.
top range + scale of
the map that we used.

The
Growth Ring For
Time To Carve And
The Memory To Imprint
On Mind

materials on site

Map = Provide a them
with a map

Want it in writing ~~that~~
17

then they will put
things in the
other side of
~~the~~
Hawthorns.
↳



Date: _____

it is only temporary:

Now ~~the~~ mansland
then the have
a Com flab/dowissio
about noman stand.

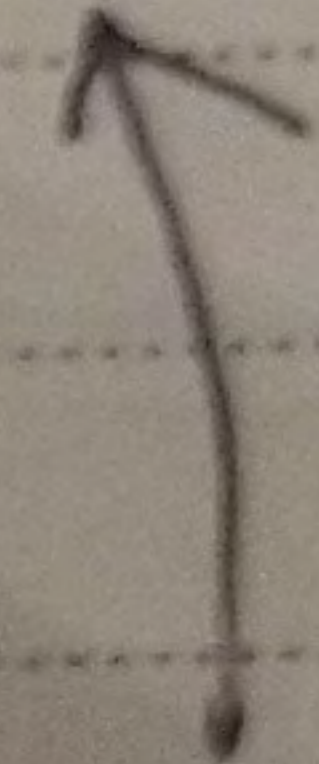

The
Growth Ring For
Time To Carve, And
The Memory To Imprint
On Mind

Agree we put our
fence up. It is only
temporary..

The put theirs up.

Boundaries new houses
wrong.



They will get a
surveyor.

Date _____
It is well out
according to [redacted]

Caravan point 15.
they will clear the
scrub around-u.

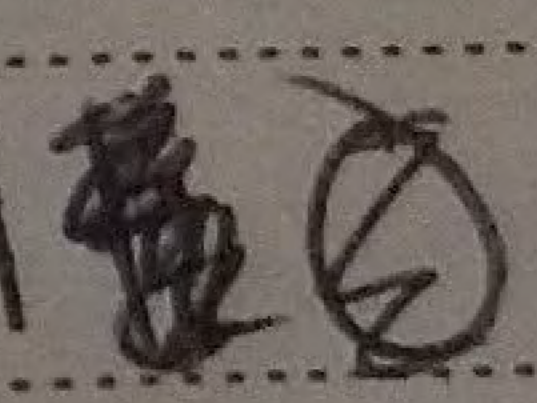
Gap between Peg 1  and ~~1~~ 2.

Gap boundary between
fence and fence + concrete

The
Growth Ring For
Time To Carve, And
The Memory To Imprint
On Mind

Temporary fence

1-6 and end of post.

then end of stable, to peg 11
Gap to peg 12 the peg to
20..

Thurs day or Fri day



SLP Costs

Date: 6/10/2020

Temporary fencing (mat + lab) eg 25 (e)

Meeting today = reg. 12(5)(e)

Winters works veg clearance (tree) eg 2(5)(e)

Veg clearance for surveyor reg. 12(5)(e)

Veg clearance site access from gate eg 2(5)(e)

Veg clearance along fence line (cannon) eg 2(5)(e)

clearance of debris eg 2(5)(e)

temporary fence line
↳ permanent one
after dispute
playing on words,

obstructive

Homes eng land
members of staff on site
to take mus of contractor

Baliffs.

Their marked boundary they are claiming
are staying in trespass. A members of Homes
England needs to argue with
them.

M O C D

measured out there
boundary,

O R N

He doesn't have to
prove it, as he
has pegged it out.

28 days for surveyor
they are going to
use. S