

DO NOT SCALE

100
0 10
Millimetres

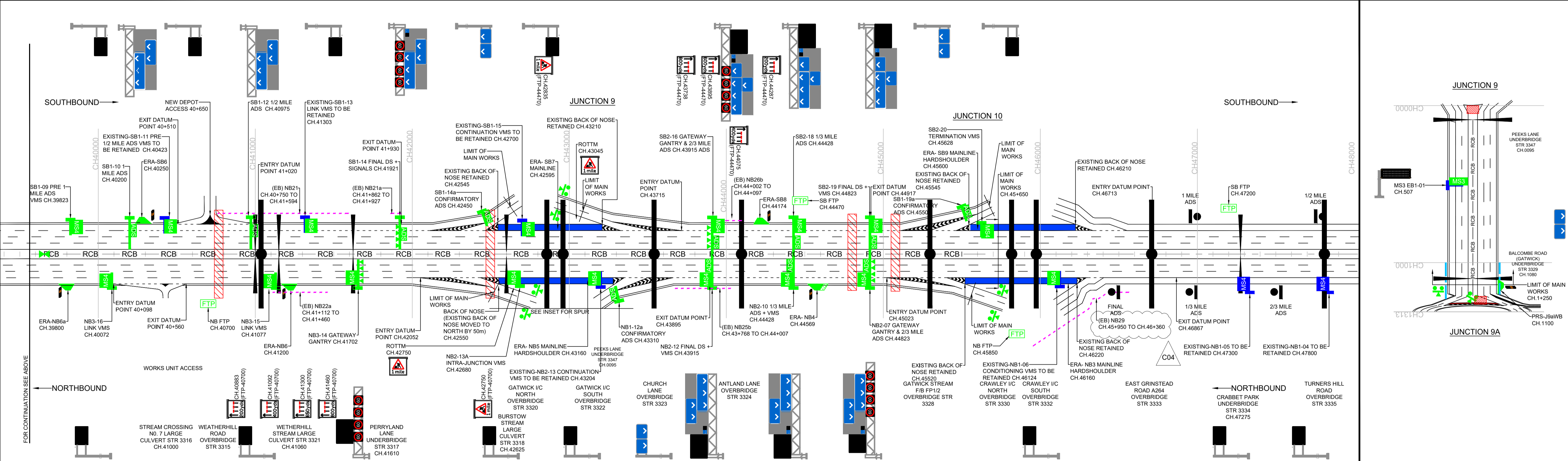
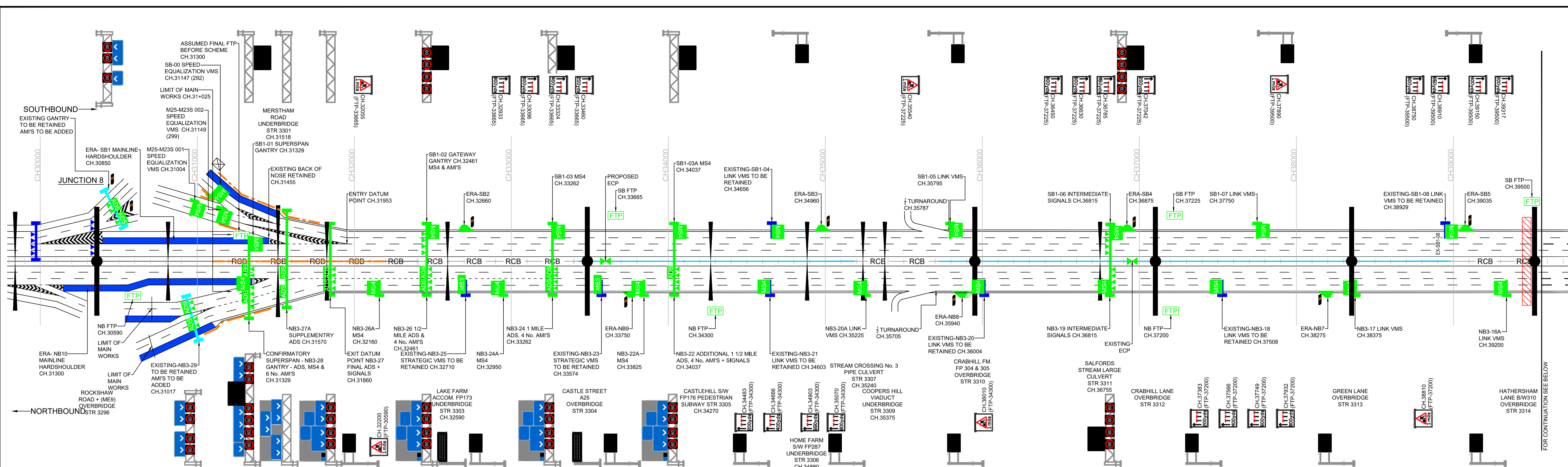

LEGEND

- GANTRY
- MS2
- MS3
- MS4
- ADS (GANTRY MOUNTED)
- AMI
- HARDSHOULDER
- ENTRY SLIP SIGNAL
- OVERBRIDGE
- UNDERBRIDGE
- DESIGN CONSTRAINT
- PROPOSED RETAINING SOLUTION
- CROSS CARRIAGEWAY DUCT
- EXISTING LIGHTING COLUMNS TO BE REPLACED
- EXISTING LIGHTING COLUMNS TO BE RETAINED
- EXISTING NOISE BARRIER
- PROPOSED NOISE BARRIER
- PROPOSED CONCRETE BARRIER
- EXISTING CONCRETE BARRIER TO BE REPLACED WITH RCB
- PROPOSED ERA
- PROPOSED ERA WITH MAINTENANCE HARDSTANDING
- TRANSMISSION STATION
- PROPOSED ERT
- PROPOSED ECP
- RETAINED ECP
- EXISTING ADS (POST MOUNTED)
- POLICE OBSERVATION PLATFORM

COLOUR KEY

- Cyan = Existing Upgraded
- Blue = Existing Retained
- Green = Proposed

SAFETY, HEALTH AND ENVIRONMENTAL INFORMATION

The significant residual risks detailed on this drawing are linked to the referencing system within the Design Hazard Log (HA549337-JAVJ-PGN-SG_MULTI-HS-C-0001). Each risk is given a unique number followed by a letter that corresponds to one of the six stages affected.

Significant Residual Risks
NONE

S - Survey
C - Construction
M - Maintenance
O - Operation
U - Road User
D - Demolition

Rev.	Date	Description	By	Chkd	Rev'd
C01	06/02/18	ISSUED FOR CONSTRUCTION (DF5)	NKRP	HN	JL
C02	05/07/18	IFC (DF5S APPROVED)	TK	HN	AM
C03	29/10/18	IFC (V.3 MS4S REFLECTED + MINOR UPDATES)	TK	AM	HN
C04	13/11/19	IFC (NB29 SHOWN)	PM	SM	AM

Drawing Status: **FOR CONSTRUCTION**

Subsidiary: **A**

Project Title: **M23 J8 - 10 SMART MOTORWAY**

Drawing Title: **SCHEME OVERVIEW PROPOSED SCHEMATIC LAYOUT**

JACOBS ATKINS

Working on behalf of **highways england**

Scale	Original Size	Designed / Drawn	Checked	Reviewed	Approved
NTS	A1	PM	SM	AM	AM
Date	Date	Date	Date	Date	Date
13/11/19	13/11/19	13/11/19	13/11/19	13/11/19	13/11/19

Project: **HA549337 - JAVJ - HGN - SG_XX - DR - C - 0005**

Volume: **C04**