

# AREA NORTH EWC

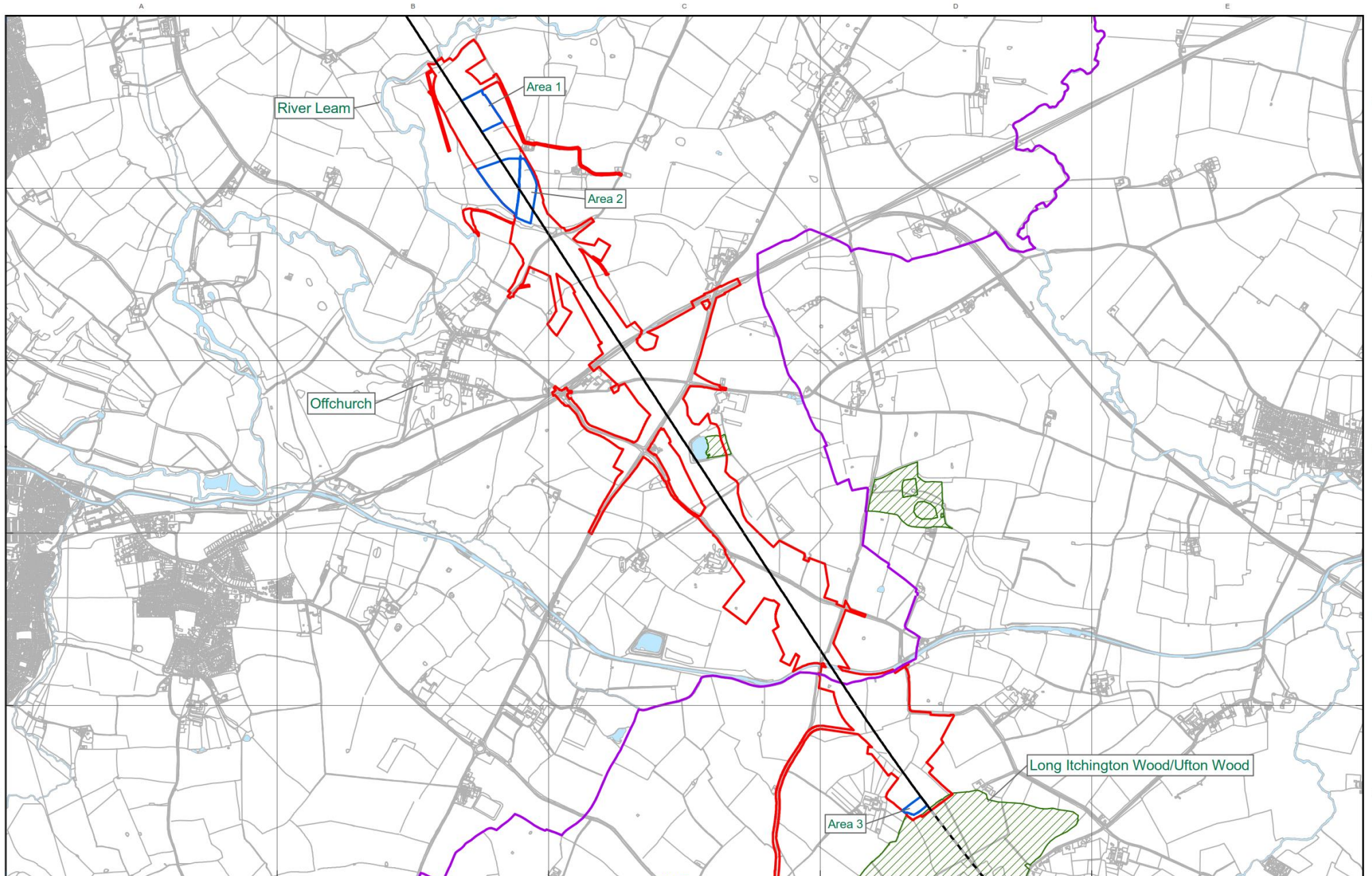

# MITIGATION

# FOSSE WAY



- Legend**
- Route in tunnel
  - Route on surface
  - Land potentially required during construction
  - District/Borough boundary
  - Watercourse
  - Water Body
  - Ancient Woodland
  - Mitigation Area

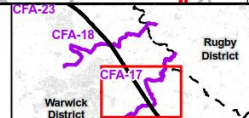

Map Number: Figure 1  
 Map Name: Fosse Way, Offchurch / River Leam Location Plan

**HS2** HSE Ltd accept no responsibility for any circumstances, which arise from the reproduction of this map after alteration, amendment or abbreviation or if it is issued in part or issued incomplete in any way.

Registered in England. Registration number 06791686.  
 Registered office: 2 Snow Hill, Queensway, Birmingham, B4 6QA

Scale at A3: 1:20,000



# AREA 1



## Key

- Excavated slot
- Natural Feature
- Furrow
- Land Drain

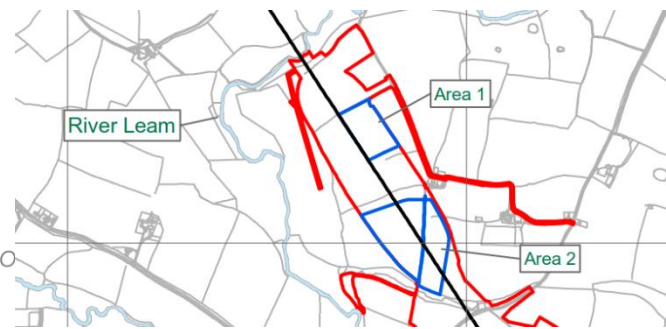



# FOSSE WAY AREA 2

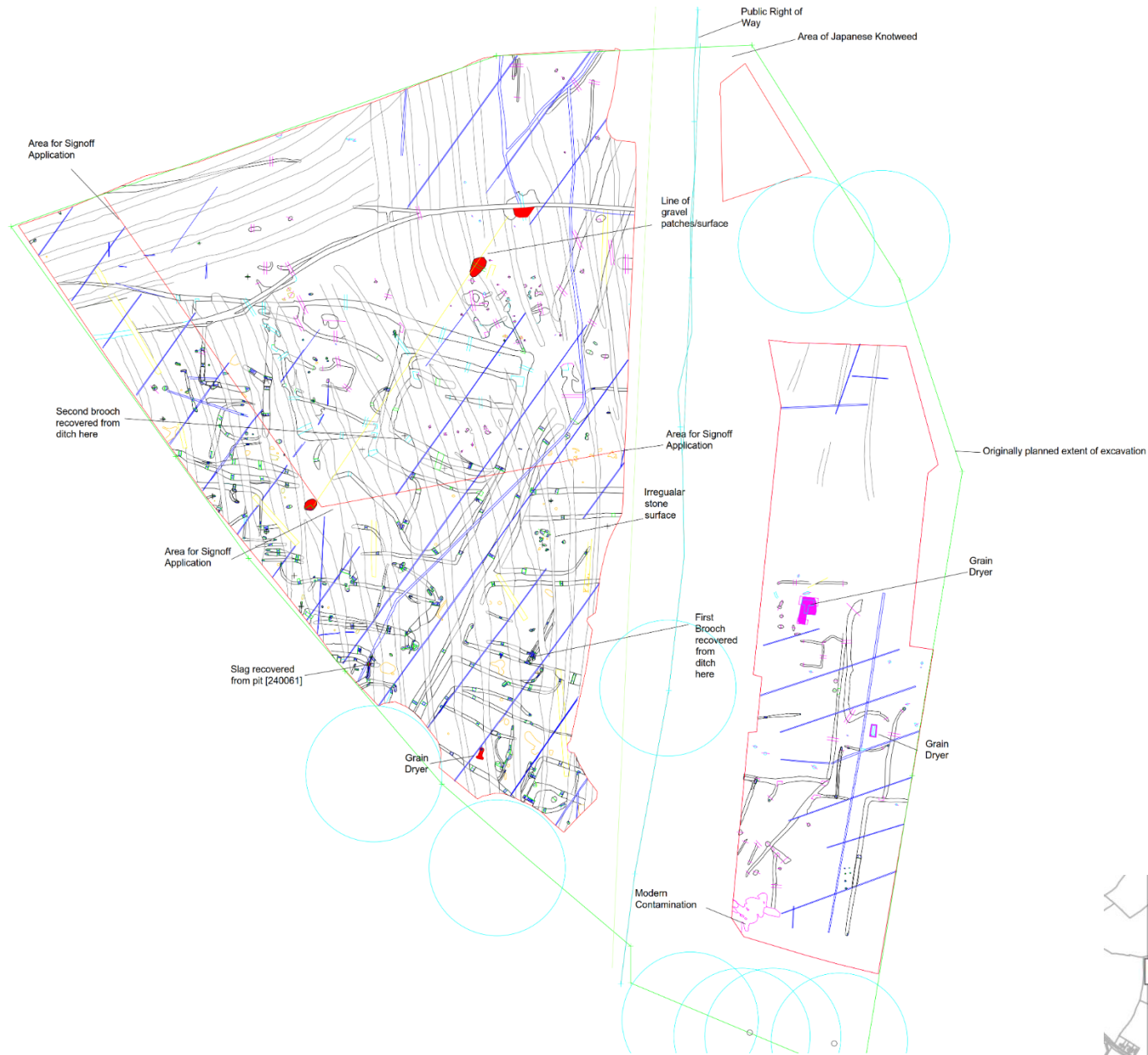

## AREA 2

### KEY

- = Archaeological Feature
- = Excavated slot
- = currently being excavated
- = Slot to be excavated
- = Natural Feature
- = LOE
- = Eval Trench
- = Land Drain
- = Furrow
- = Badger buffer

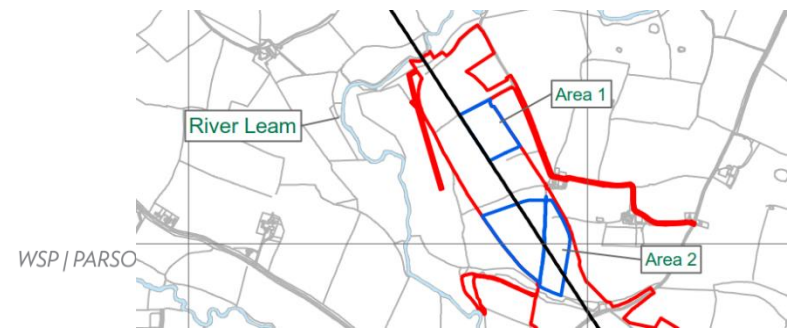



# COLESHILL

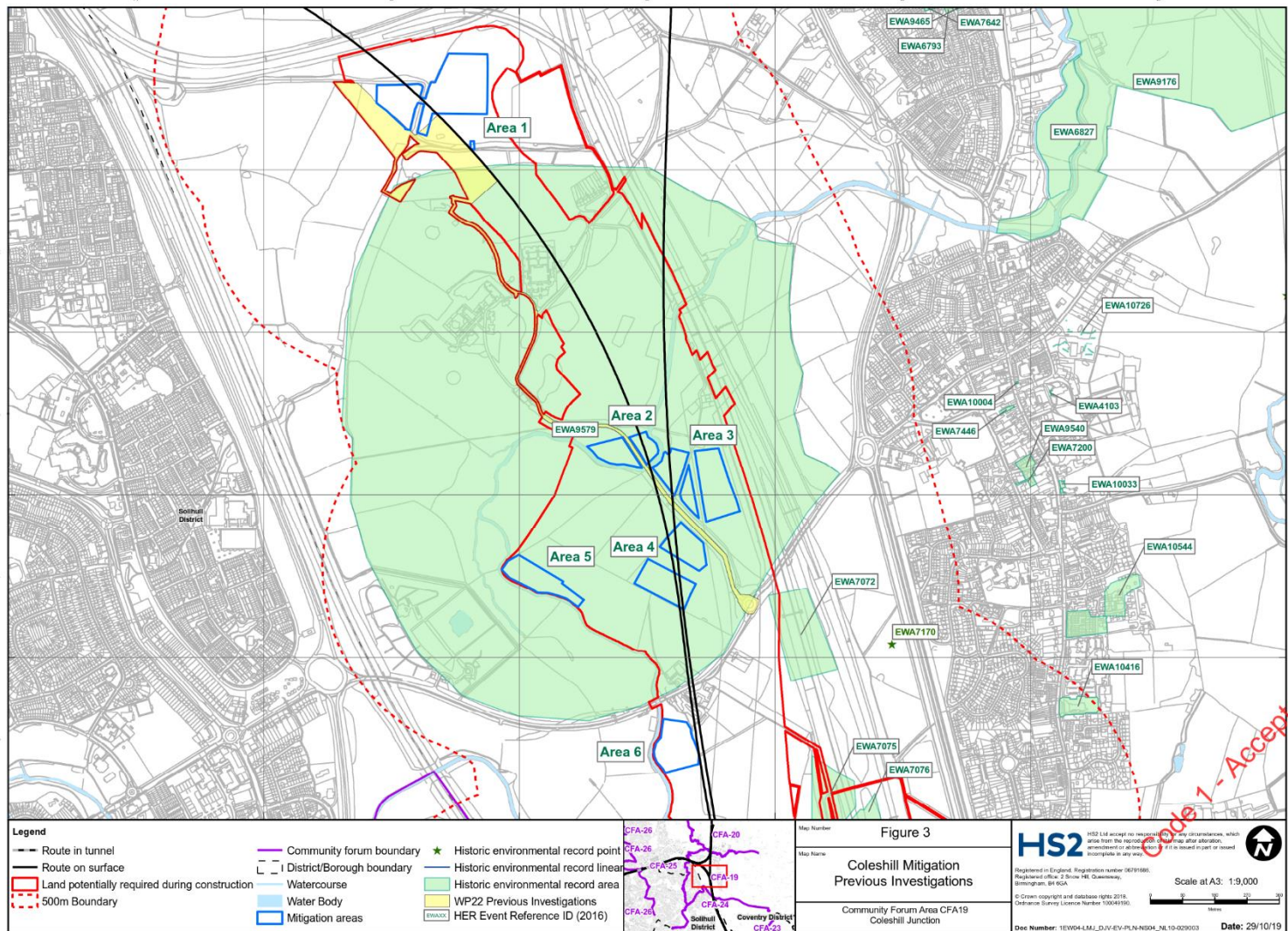







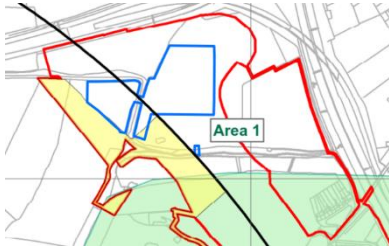

# COLESHILL MOATED SITE

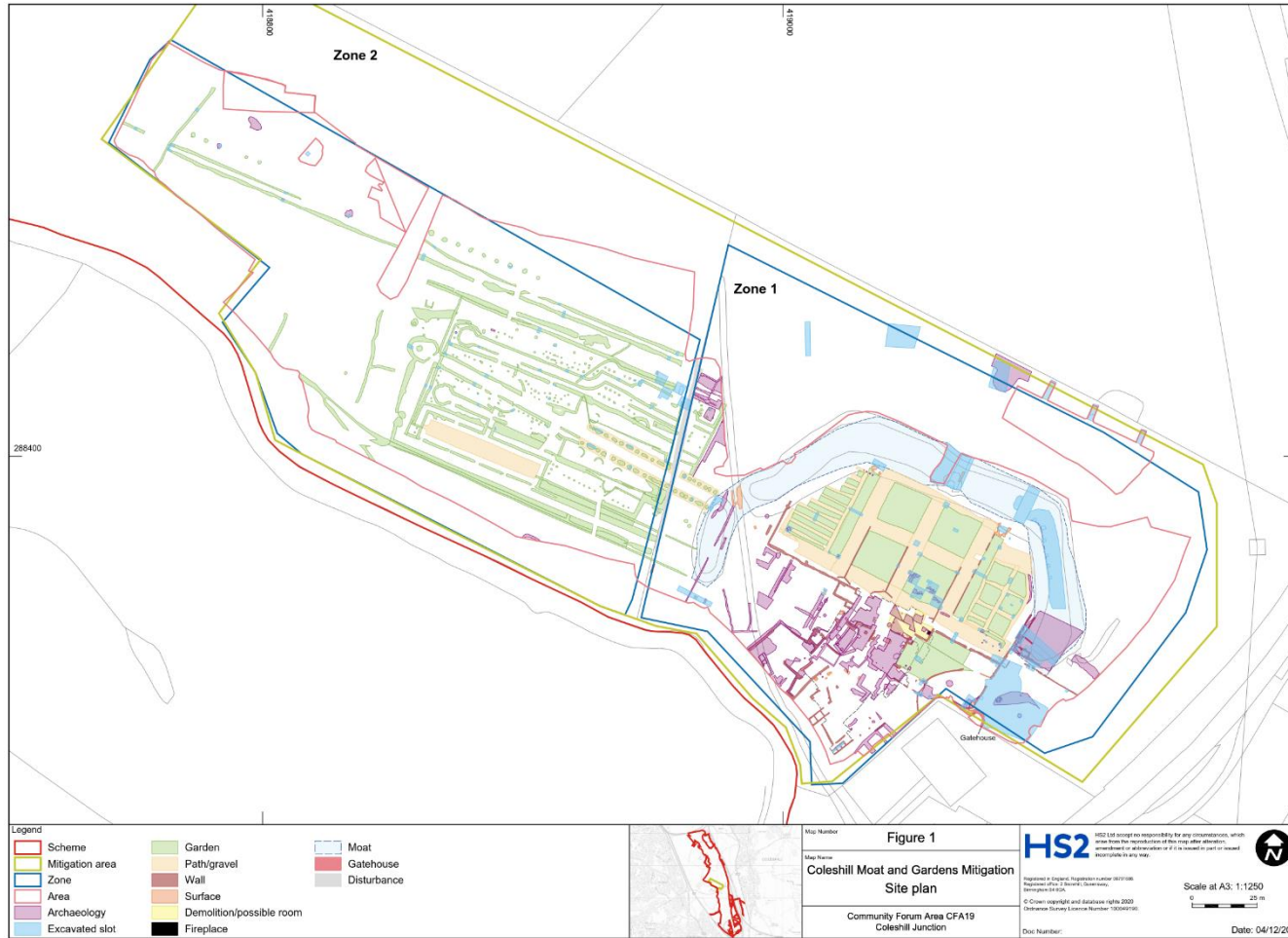



# CURZON ROUNDHOUSE

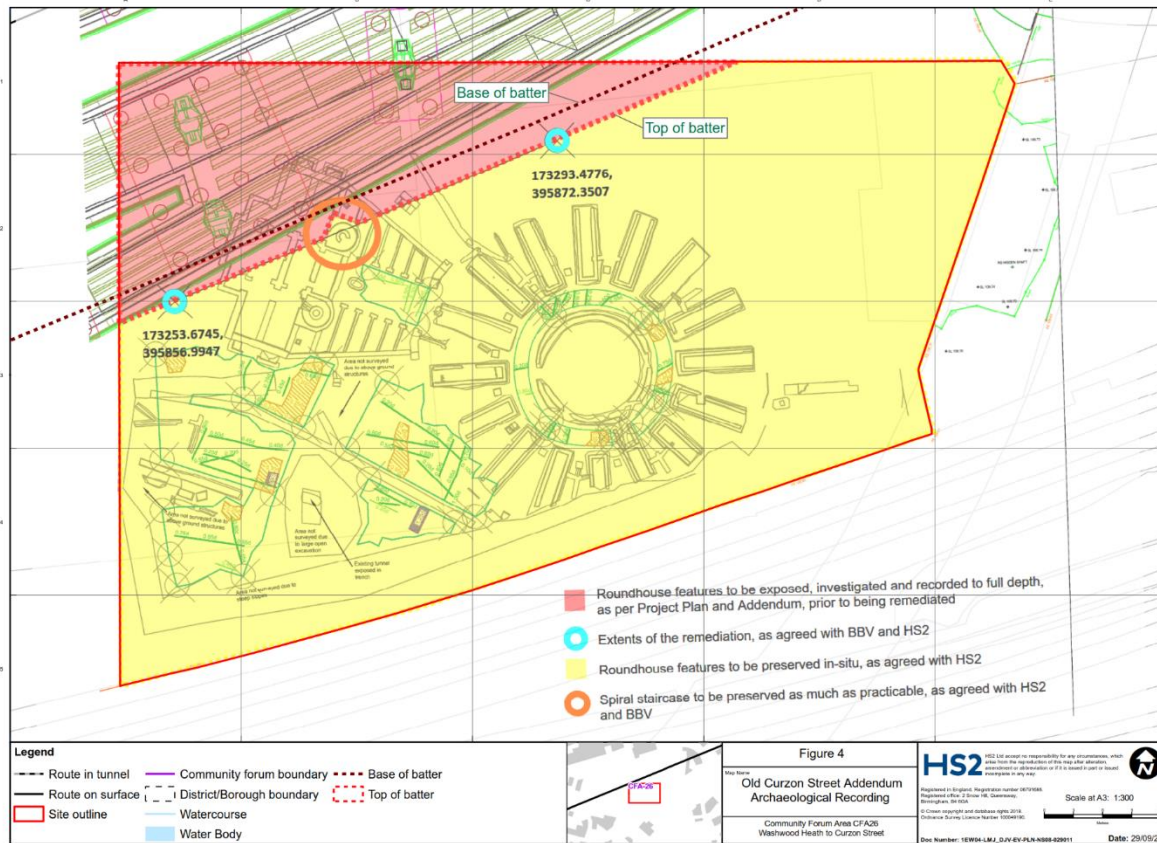

# CURZON ROUNDHOUSE

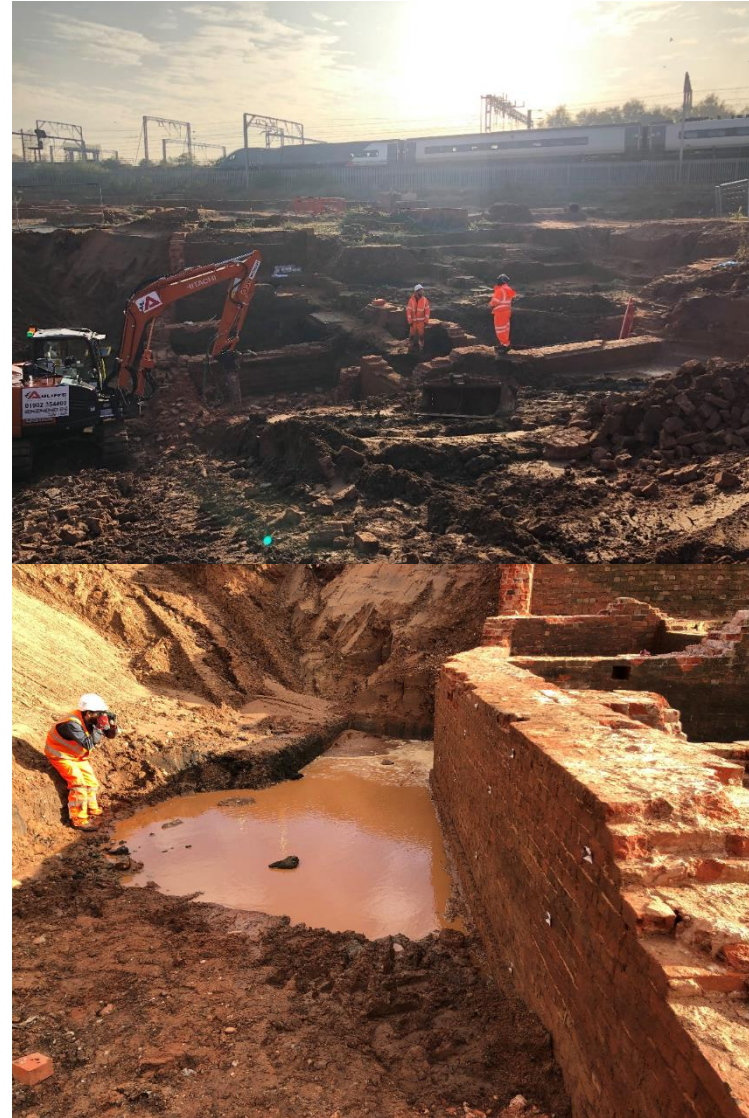
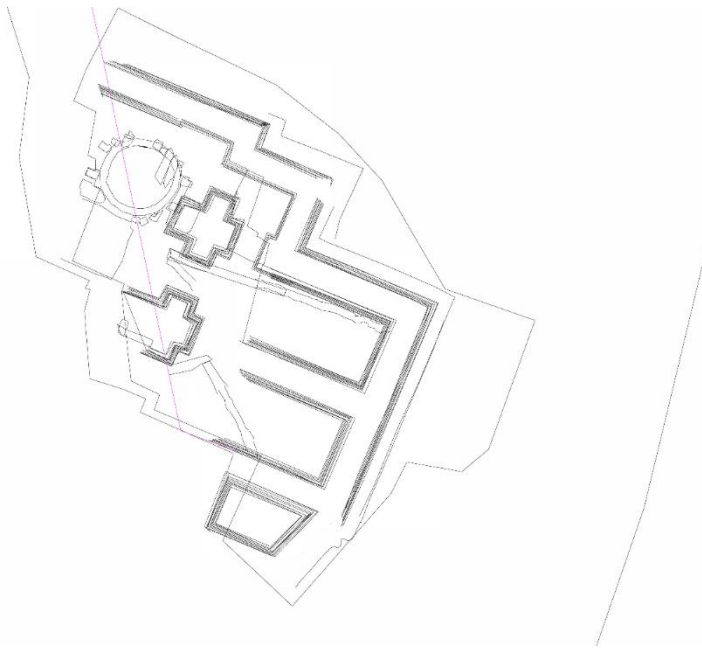





# ONLINE ENGAGEMENT

## HERITAGE OPEN DAYS



Thank you so much for a fantastic, fascinating talk. ...Wish we could see more in depth talks on this subject. Please thank everyone involved!

I attended 4 webinars over Heritage week and enjoyed them all, in particular, Death & Burial in Ancient Britain. Your speaker was wonderfully clear and easy to listen to and the artefacts were very well presented.

- ❖ Successful Archaeology Conference held in October as part of Heritage Open Days



WSP | PARSONS BRINCKERHOFF + RAMBOLL

# ONLINE ENGAGEMENT

## HS2 ARCHAEOLOGY IN FOCUS



Well done  
guys! Stuart  
was really  
great



- ❖ Continued engagement on sites Curzon Street, Fosse Way, Park Street and good feedback on Coleshill
- ❖ Webinars, virtual classrooms, storymaps, podcasts and films



# EXHIBITIONS – ONLINE AND IRL

