

Air Quality and Dust Monitoring Monthly Report – **November** 2020 **Buckinghamshire** Council



Department for Transport

High Speed Two (HS2) Limited has been tasked by the Department for Transport (DfT) with managing the delivery of a new national high speed rail network. It is a non-departmental public body wholly owned by the DfT.

High Speed Two (HS2) Limited,
Two Snowhill
Snow Hill Queensway
Birmingham B4 6GA

Telephone: 08081 434 434

General email enquiries: HS2enquiries@hs2.org.uk

Website: www.gov.uk/hs2

A report prepared by EWCs and MWCCs on behalf of HS2 Ltd.

High Speed Two (HS2) Limited has actively considered the needs of blind and partially sighted people in accessing this document. The text will be made available in full on the HS2 website. The text may be freely downloaded and translated by individuals or organisations for conversion into other accessible formats. If you have other needs in this regard please contact High Speed Two (HS2) Limited.

© High Speed Two (HS2) Limited, 2020, except where otherwise stated.

Copyright in the typographical arrangement rests with High Speed Two (HS2) Limited.

This information is licensed under the Open Government Licence v2.0. To view this licence, visit www.nationalarchives.gov.uk/doc/open-government-licence/version/2 **OGI** or write to the Information Policy Team, The National Archives, Kew, London TW9 4DU, or e-mail: psi@nationalarchives.gsi.gov.uk. Where we have identified any third-party copyright information you will need to obtain permission from the copyright holders concerned.



Printed in Great Britain on paper containing at least 75% recycled fibre.

Monthly Summary

- 1.1.1 This Summary Report is published in fulfilment of commitments detailed in the High Speed Rail (London-West Midlands) Environmental Minimum Requirements, Annex 1: Code of Construction Practice, for the nominated undertaker to present the results of dust monitoring undertaken in the Buckinghamshire Council (BC) area during November 2020.
- 1.1.2 Figures 1 to 4 in Appendix A presents the current worksites together with the dust monitoring locations for November 2020.
- 1.1.3 This summary should be read in conjunction with the overview monitoring report available from www.gov.uk/government/collections/monitoring-the-environmental-effects-of-hs2, which highlights: the applicable standards and guidance, as well as the air quality and dust monitoring methodologies to be implemented by nominated undertakers throughout construction.
- 1.1.4 The current phase of works that commenced within BC during January 2020 and is expected to be completed by the end of May 2021. The current worksites at Colne Valley Viaduct (CVV) LTP1, Chalfont St Peter Vent Shaft, Amersham Vent Shaft and Lower Bottom House Farm Lane are presented in Appendix A, Figures 1 to 4. Activities for each worksite within November 2020 included:

Colne Valley Viaduct (CVV) LTP1:

- Affinity Water Access Site: construction of access road including earthworks, drainage and road & hardstanding;
- Affinity Water Access Site: gas crossing;
- Affinity Water Access Site - Strengthen of DWSC Way: earthworks; and
- Alternative Access to DWSC: laying of track matt, temporary fencing and signage.

Chalfont St Peter Vent Shaft:

- Grout injection (pre-treatment grouting);
- D-wall works: D-wall excavation, rebar and concreting; and
- Operation of all auxiliary plant.

Amersham Vent Shaft:

- Site installations;
- Construct new footpath;
- Installation of site offices;
- Construct internal site roads & car park;
- Car park finishes, utilities and drainage; and
- Constructing waling beam along sheet pile wall.

Lower Bottom House Farm Lane:

- Earthworks including excavation, stockpiling, and material movement;
- Construction works, including new road haul road, topsoil strip, cut/fill placing and compaction, utility diversions, installations of ducting and drainage, lay CBGM, installation of 1 no. temporary bridge, road signage and landscaping; and
- Track out activities with up to 10 – 50 HGV (>3.5 t) trips anticipated in any one day.

- 1.1.5 Eight (8) dust monitors are installed around the worksites, where demolition, earthworks, construction and trackout activities are underway. Two (2) are located at the CVV LTP1 compound, two (2) are located at the Chalfont St Peter worksite, two (2) are located at the Amersham worksite and other two (2) are located at Lower Bottom House Farm Lane site. Dust Risk Assessments for each worksite returned a medium dust risk rating (for works currently active on site).
- 1.1.6 Dust monitoring locations and results are presented in Appendix B, Table 1, together with a line chart of monthly data from each dust monitor presented in Figures 5 to 11. All continuous dust monitoring is undertaken using indicative monitors. Despite being Environment Agency (MCERTS) certified, indicative monitors carry a higher level of uncertainty than reference monitors, and therefore cannot be strictly compared with Air Quality Standards for human health and the environment. The purpose of the monitoring undertaken is to ensure the effectiveness of the on-site mitigation.
- 1.1.7 The trigger level for PM₁₀ concentrations of 190 µg/m³, over a 1-hour period, in accordance with the updated guidance document '*Guidance on Monitoring in the Vicinity of Demolition and Construction Sites – (October 2018)*' has been applied.
- 1.1.8 There was one (1) dust trigger alert recorded during the monitoring period (November 2020). However, following investigations it was noted that these exceedances were not related to HS2 site activities, but rather the prevailing weather conditions (heavy fog experienced). Exceedances are presented in Appendix B, Table 2. All other results were in line with expected ranges.
- 1.1.9 Data capture for various monitors was below 90% for the month of November 2020. Missing data was due to the loss of continuous site power to the monitoring location, or due to the loss of solar and leisure battery power, caused by a lack of sunlight. Site power was restored, and monitoring resumed at the respective locations, with an alternative power source being explored to resolve the intermittent solar power supply issues.
- 1.1.10 CSP-AQMP2 was removed from its location without authorisation. A new unit is due to be installed following review of the security at the monitoring location.
- 1.1.11 There were no (0) complaints received, relating to dust or air quality, during the reporting period (November 2020).

Appendix A – Monitoring Locations

Figure 1: Worksite and Monitoring locations during November 2020 – CVV LTP1



Figure 2: Worksite and Monitoring locations during November 2020 – Chalfont St Peter Vent Shaft Site

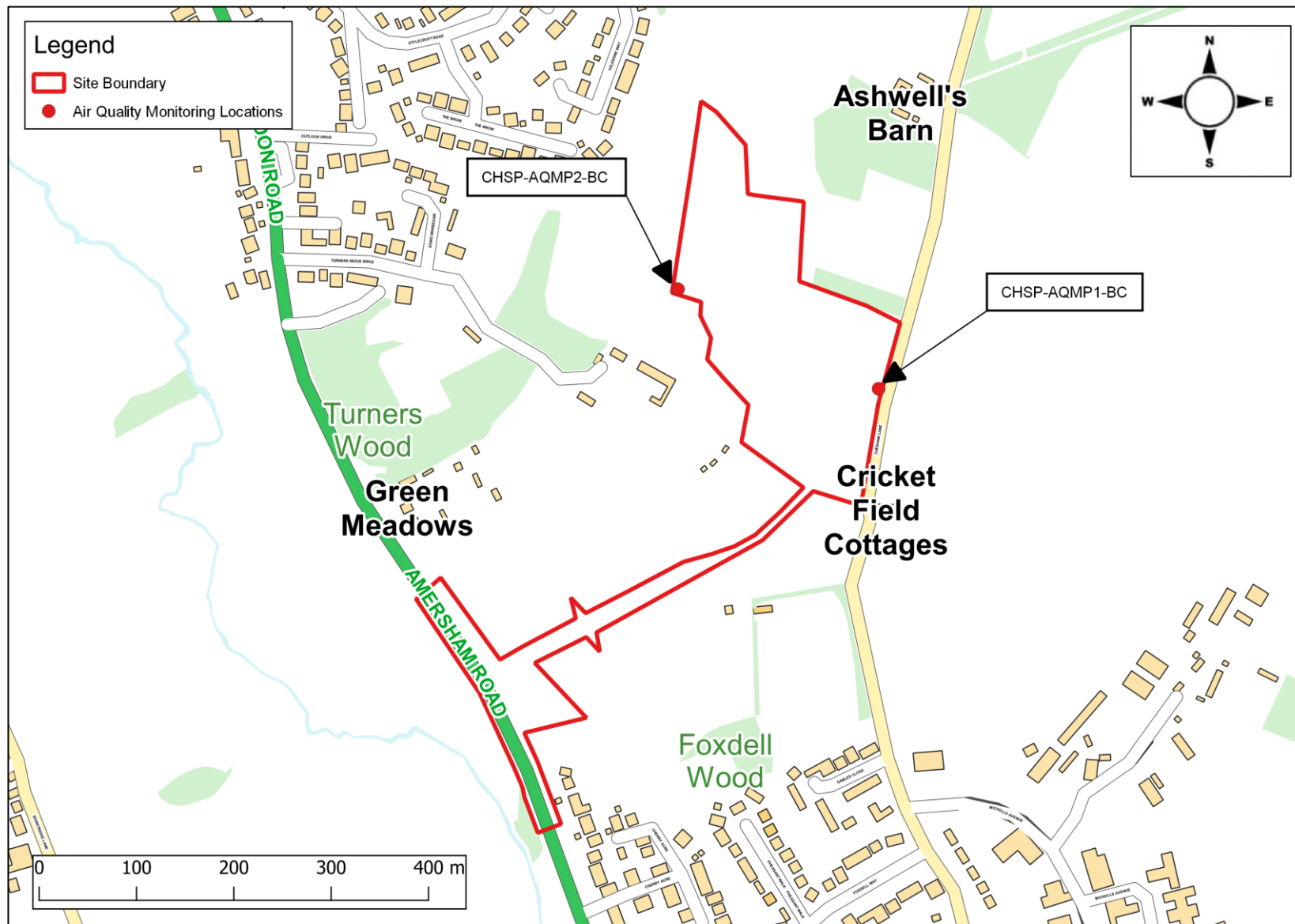

Figure 3: Worksite and Monitoring locations during November 2020 – Amersham Vent Shaft Site

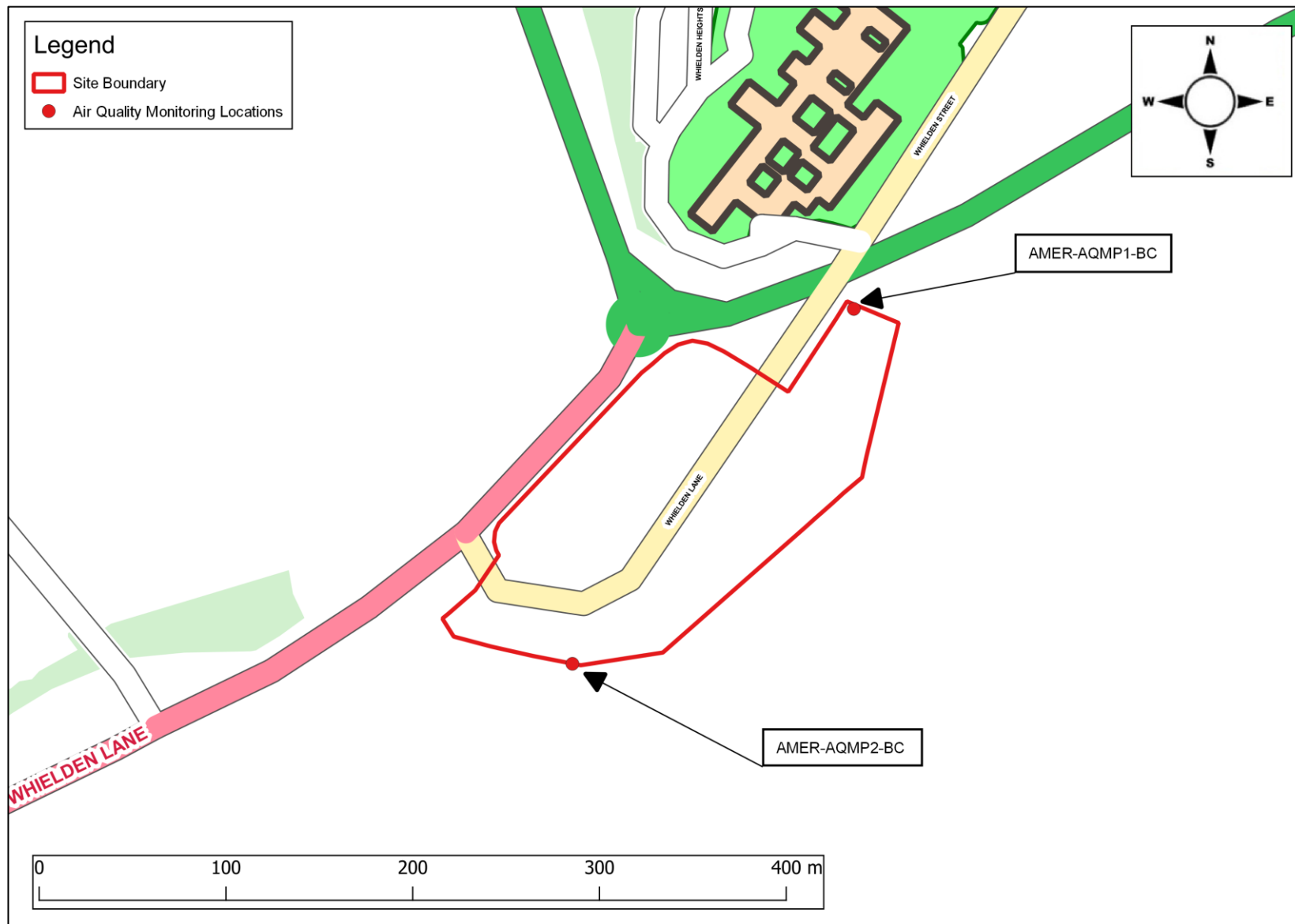

Figure 4: Worksite and Monitoring locations during November 2020 – Lower Bottom House Farm Lane



Appendix B – Dust Monitoring Results

Table 1: Dust monitoring locations and November 2020 Results

Monitoring site ID	Coordinates (X,Y)	Location description	Dust risk rating for site	Monitoring site active during period	Change to site since previous period report	Mean 1-hour PM ₁₀ concentration (µg/m ³)	Minimum 1-hour PM ₁₀ concentration (µg/m ³)	Maximum 1-hour PM ₁₀ concentration (µg/m ³)	Number of 1-hour periods exceeding trigger level of 190 µg/m ³	Data capture (%)
CHSP-AQMP1-BC	500114, 193104	On the eastern boundary of the site with Chesham Lane	M	Yes	Yes	12.8	2.2	72.6	0	92
CHSP-AQMP2-BC	499903, 193181	On the western boundary of the site	M	Yes	Yes	-	-	-	-	0
LTP1-AQMP1-BC	503602, 189832	On the north boundary of LTP1	M	Yes	Yes	11.2	1.8	142.7	0	91
LTP1-AQMP2-BC	503654, 189795	On the south boundary of LTP1	M	Yes	Yes	14.0	2.0	442.8	1	99
AMER-AQMP1-BC	495440, 196733	On the north-eastern boundary of Amersham	M	Yes	Yes	13.9	6.1	22.6	0	5
AMER-AQMP2-BC	495280, 196532	On the south-western boundary of Amersham	M	Yes	Yes	10.6	2.1	26.2	0	20
3252Dust2	498390, 195434	On the boundary with Elm Tree Cottage, Bottom House Farm Lane	M	Yes	No	9.7	1.1	33.8	0	99
3252Dust3	498100, 195145	On the site boundary opposite Lower Bottom House Farm	M	Yes	No	9.1	1.0	40.0	0	85

Table 2: Summary of exceedances during period (November 2020) overleaf

Monitoring Site ID	Period of trigger alert & Concentration recorded	Investigation	Outcomes / Resolution / Remedial measures implemented
LTP1-AQMP2_BC	<u>27/11/2020</u> 01:01 - 02:00: 442.8 µg/m ³	<p>At the time of the trigger alerts, no works were being undertaken on the site.</p> <p>It is therefore believed that these alerts are linked to the heated inlet mechanism rather than any site activities. It has been confirmed that the heated inlet is working, however erroneously recorded PM10 readings due to the high levels of humidity (i.e. the thick fog experienced).</p>	Heated inlet functionality continuing to be monitored.

Figure 5: Continuous dust 1-hour mean indicative PM₁₀ concentration for CHSP-AQMP1-BC for November 2020

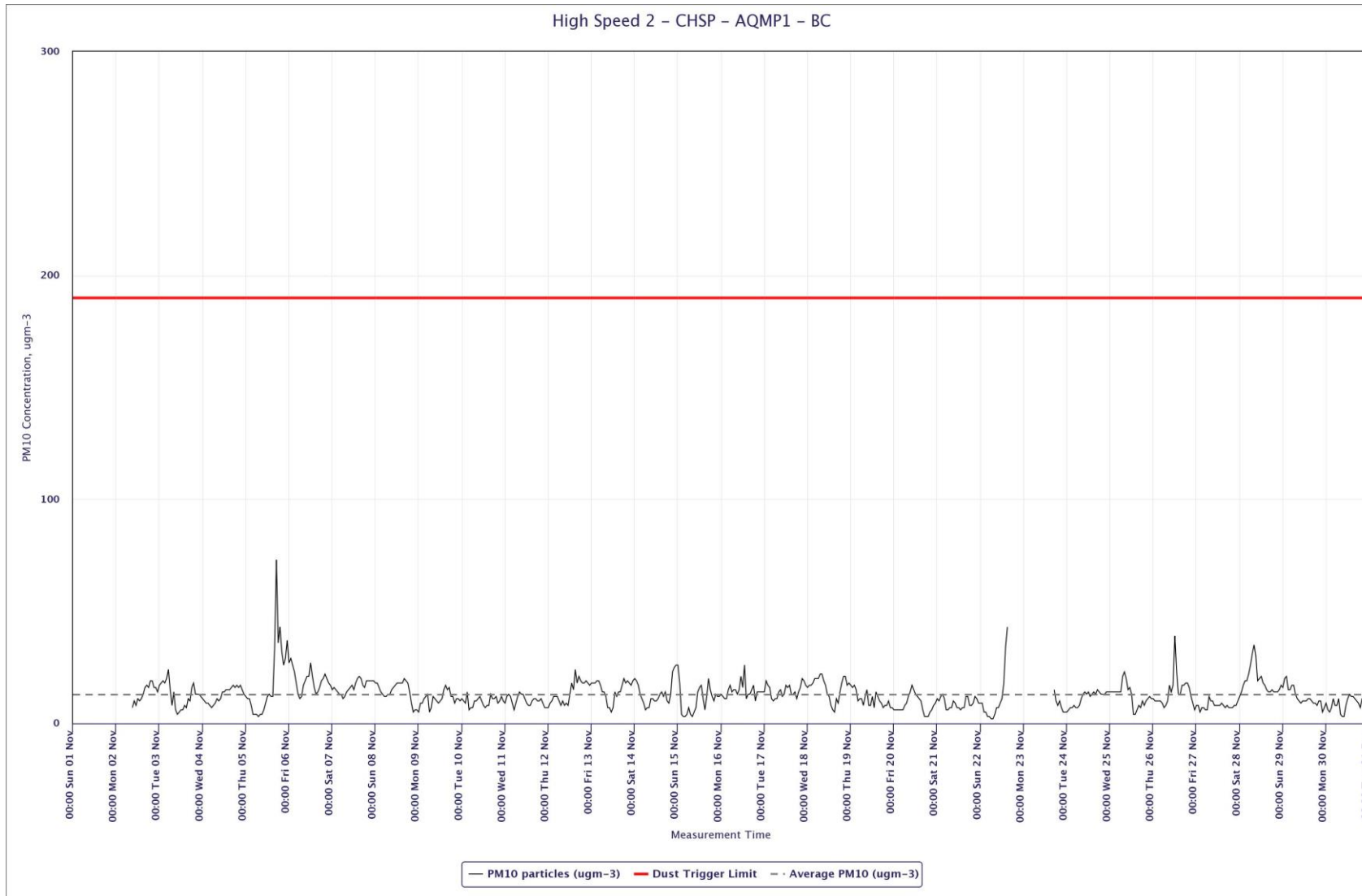

Figure 6: Continuous dust 1-hour mean indicative PM₁₀ concentration for LTP1-AQMP1-BC for November 2020

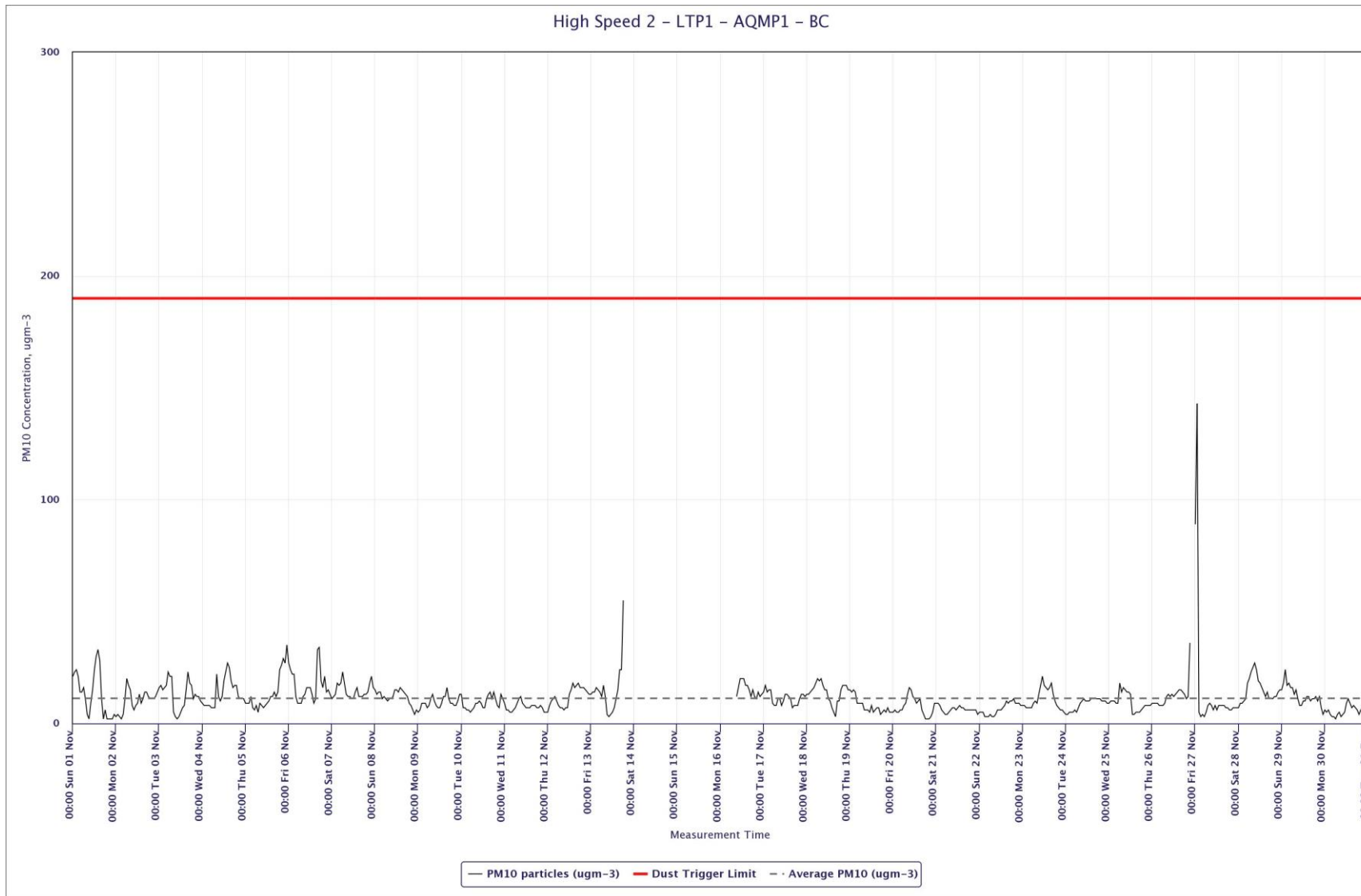

Figure 7: Continuous dust 1-hour mean indicative PM₁₀ concentration for LTP1-AQMP2-BC for November 2020

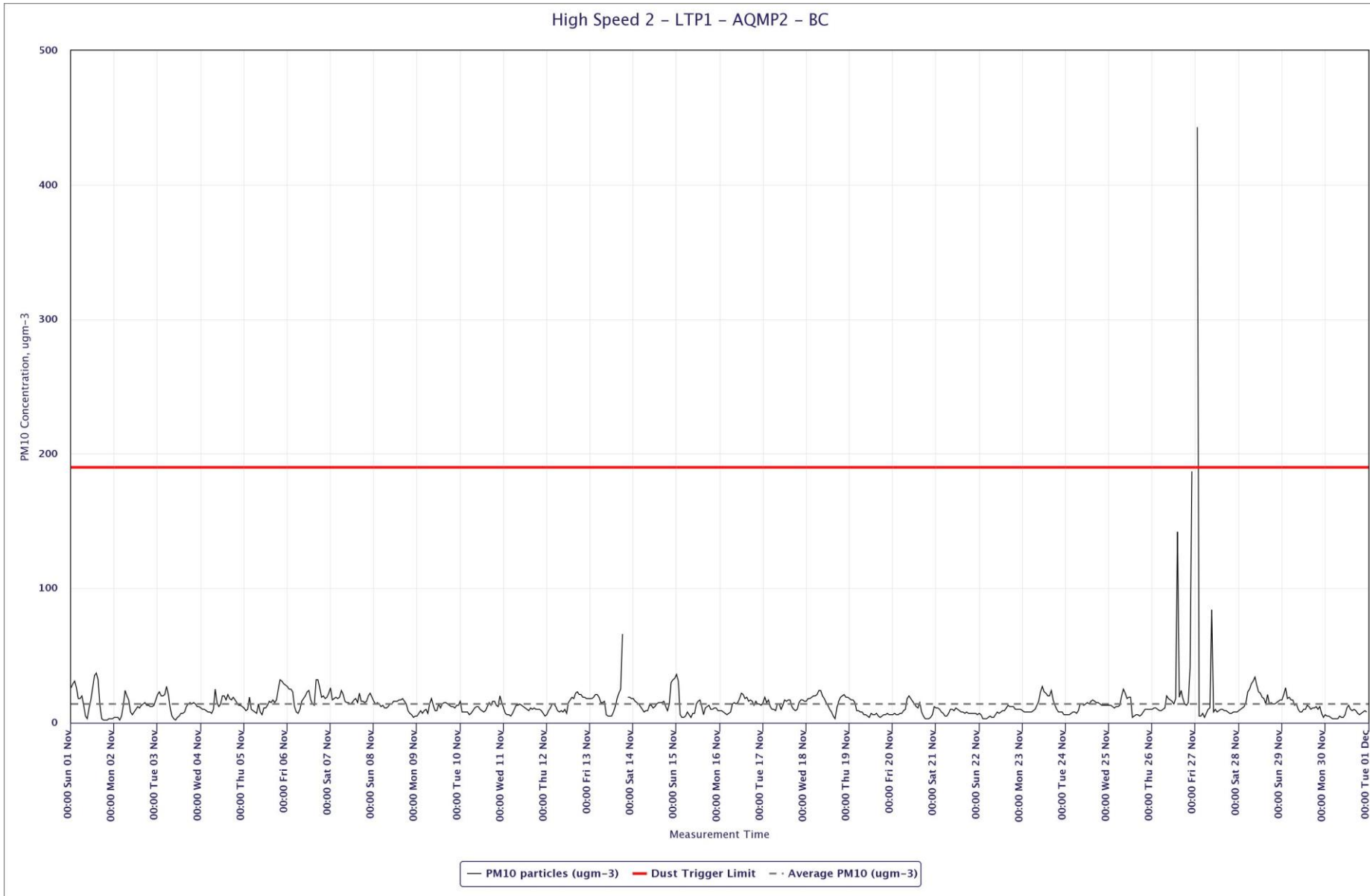

Figure 8: Continuous dust 1-hour mean indicative PM₁₀ concentration for AMER-AQMP1-BC for November 2020

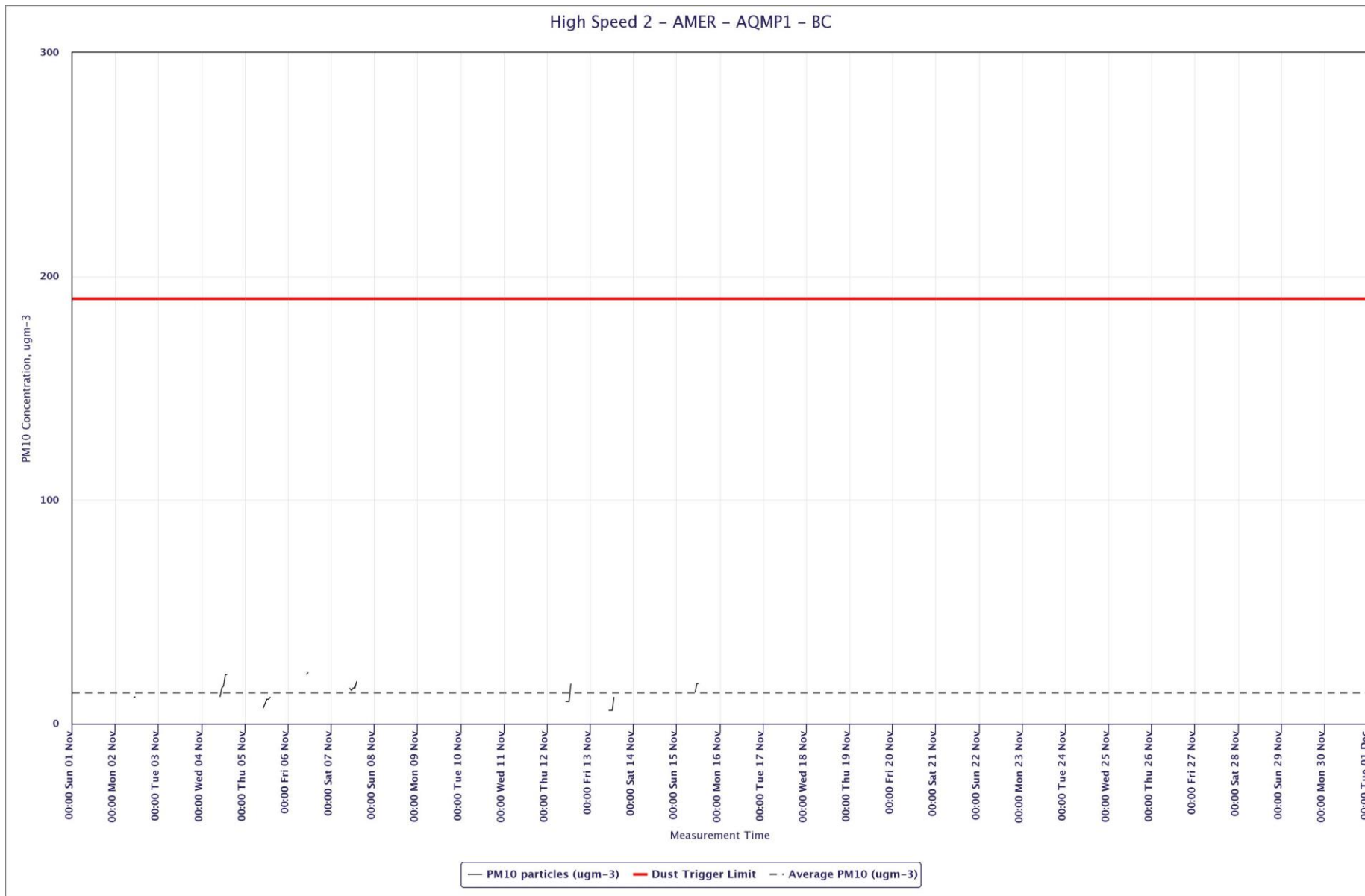

Figure 9: Continuous dust 1-hour mean indicative PM₁₀ concentration for AMER-AQMP2-BC for November 2020

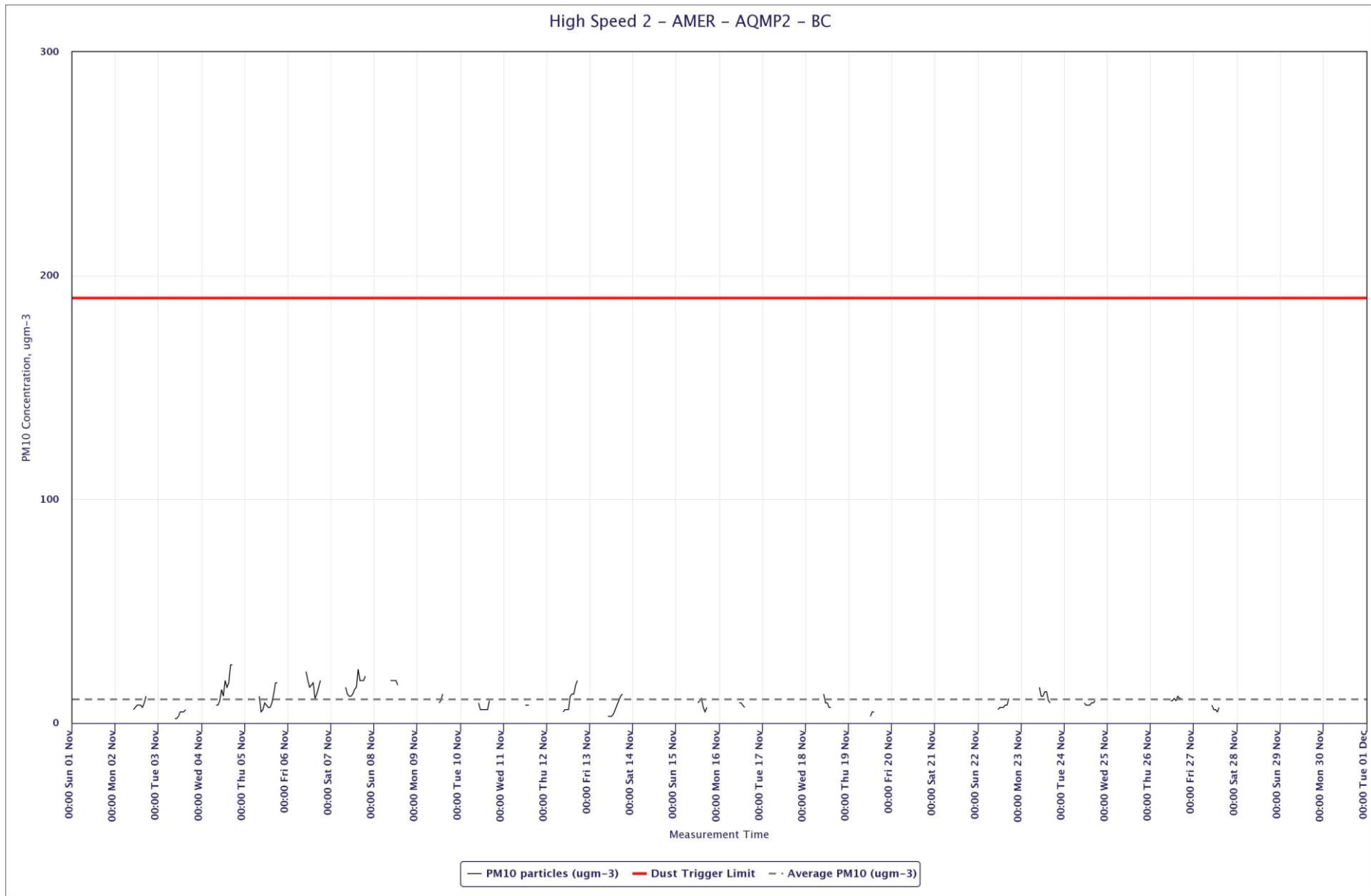

Figure 10: Continuous dust 1-hour mean indicative PM₁₀ concentration for 3252Dust2 – Elm Tree Cottage for November 2020

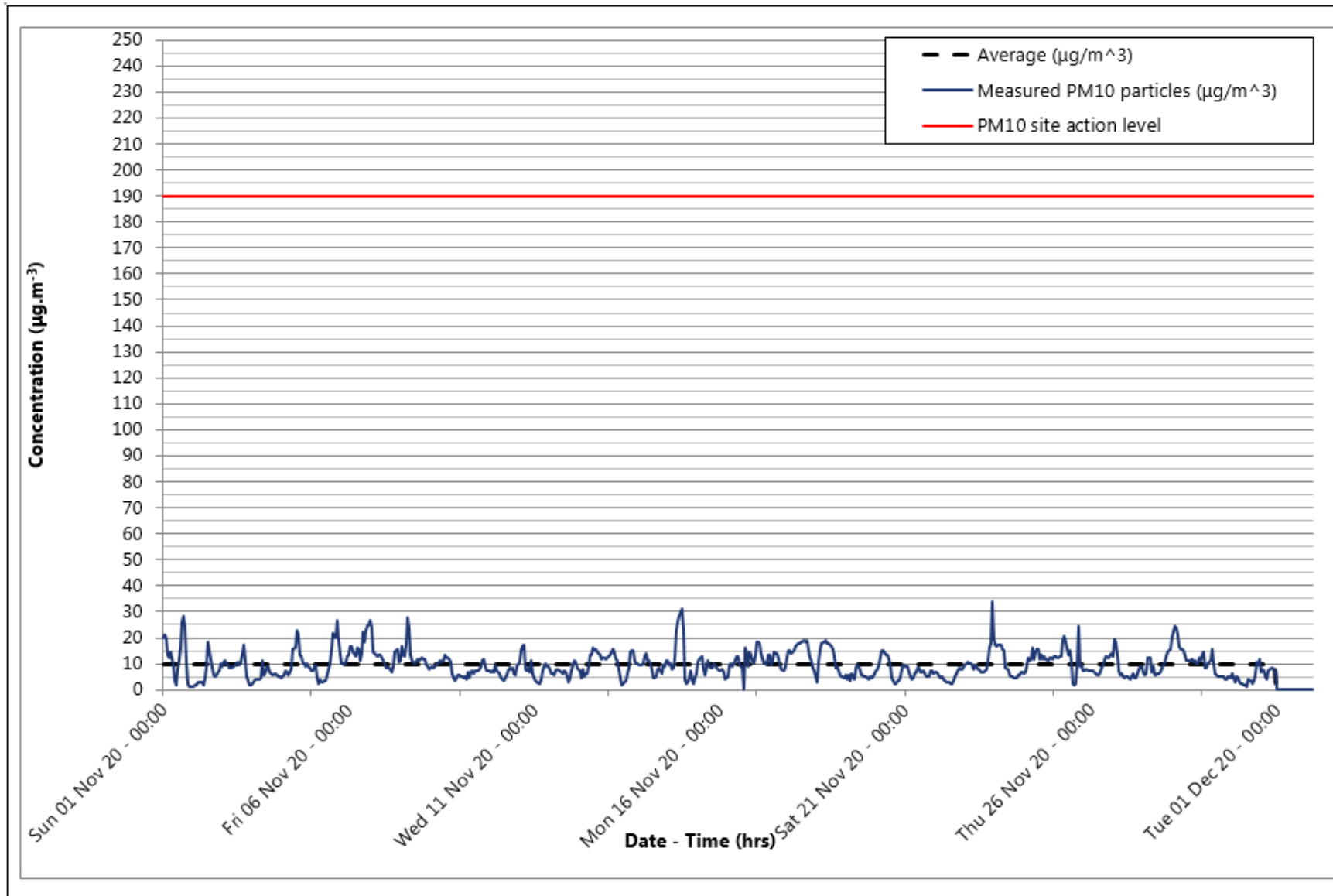

Figure 11: Continuous dust 1-hour mean indicative PM₁₀ concentration for 3252Dust3 – Lower Bottom House Farm for November 2020

