

HS2 PHASE 1 NORTH ENABLING WORKS CONTRACT (EWC)

HERITAGE SUB-GROUP:
JUNE 2020

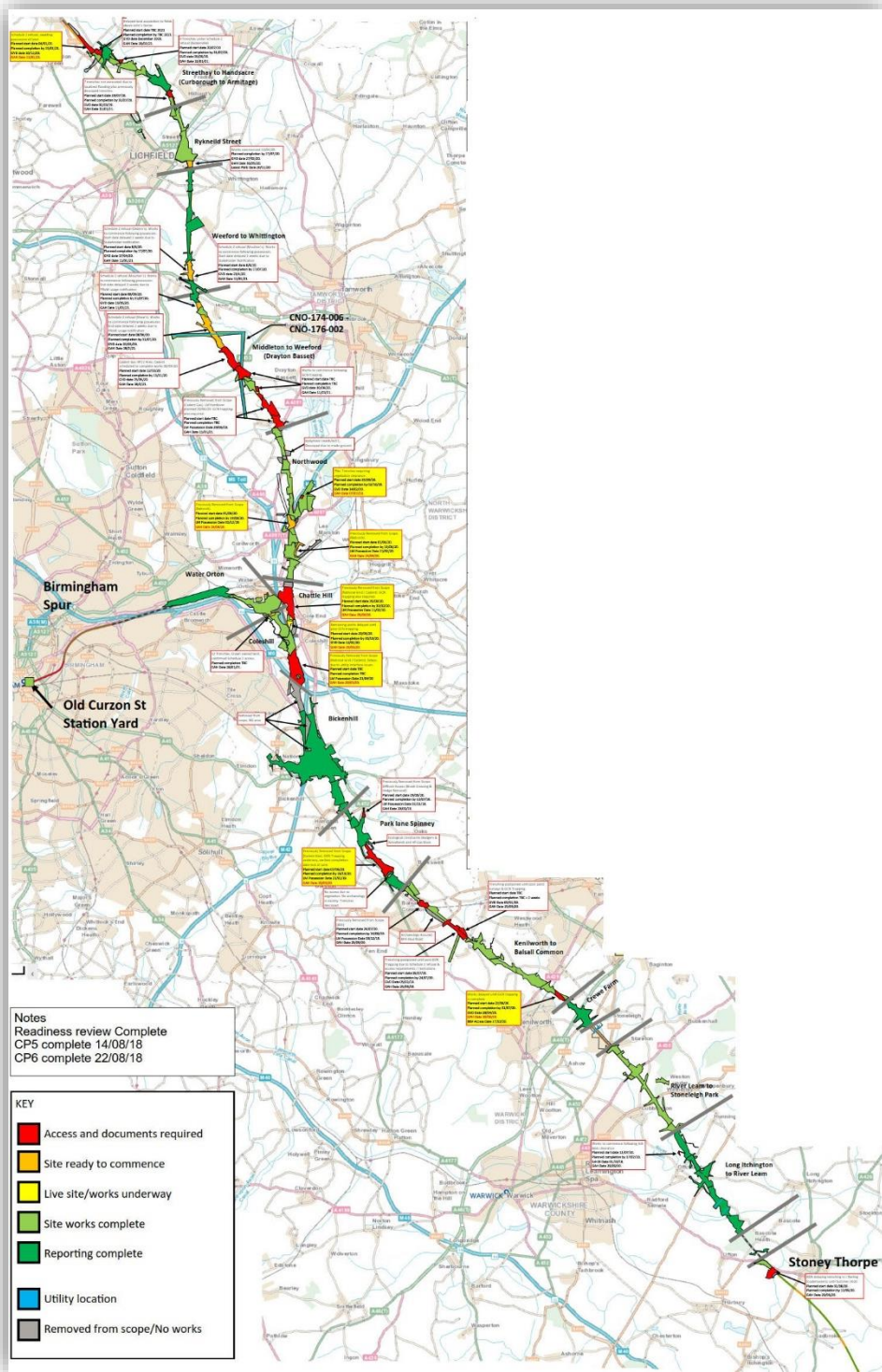

Trenching Progress June 2020

Trenching Progress:

Trenching c.70% complete

Other Work Progress

- Desk-Based studies mainly complete, inclusive of Historic Settlement Landscape DDBA, LiDAR reappraisal, Railway and Industry DDBA.
- Geophysical survey complete.
- Geoarchaeological study ongoing.
- Table 1 and 2 buildings ongoing

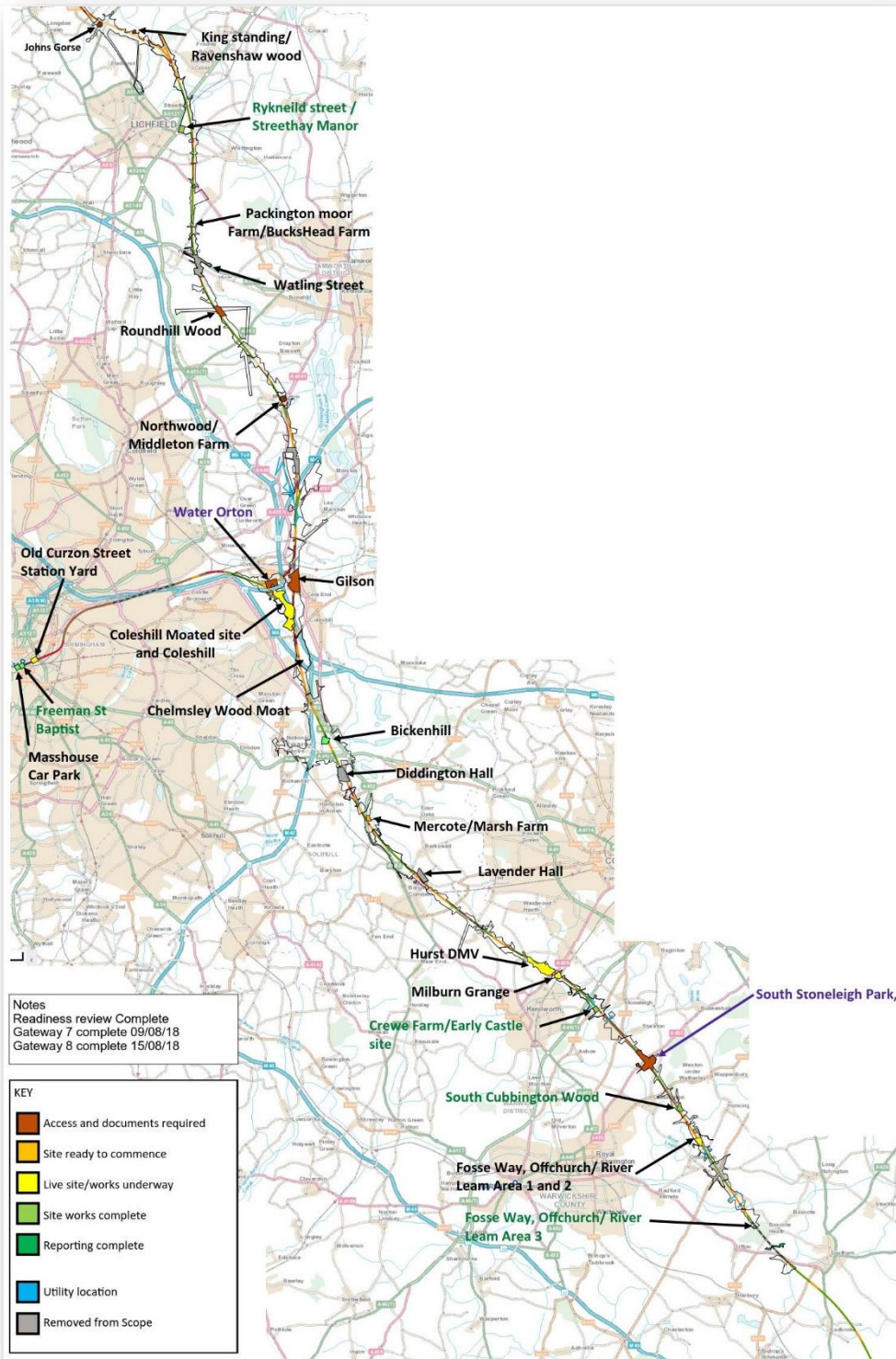

Mitigation Ongoing and Complete

- Bickenhill
- Crewe Farm
- Coleshill
- Curzon Street
- Fosse Way, Offchurch, River Leam
- Freeman Street
- Handsacre
- Rykneild Street
- Mass House
- Mercote / Marsh Farm
- Milburn Grange
- Park Street Burial Ground
- South Cubbington Wood
- Streethay
- Water Orton

Mitigation To Commence

- Coleshill Manor
- Kings Standing
- Packington Moor
- Northwood
- South Stoneleigh

MITIGATION: CREWE FARM

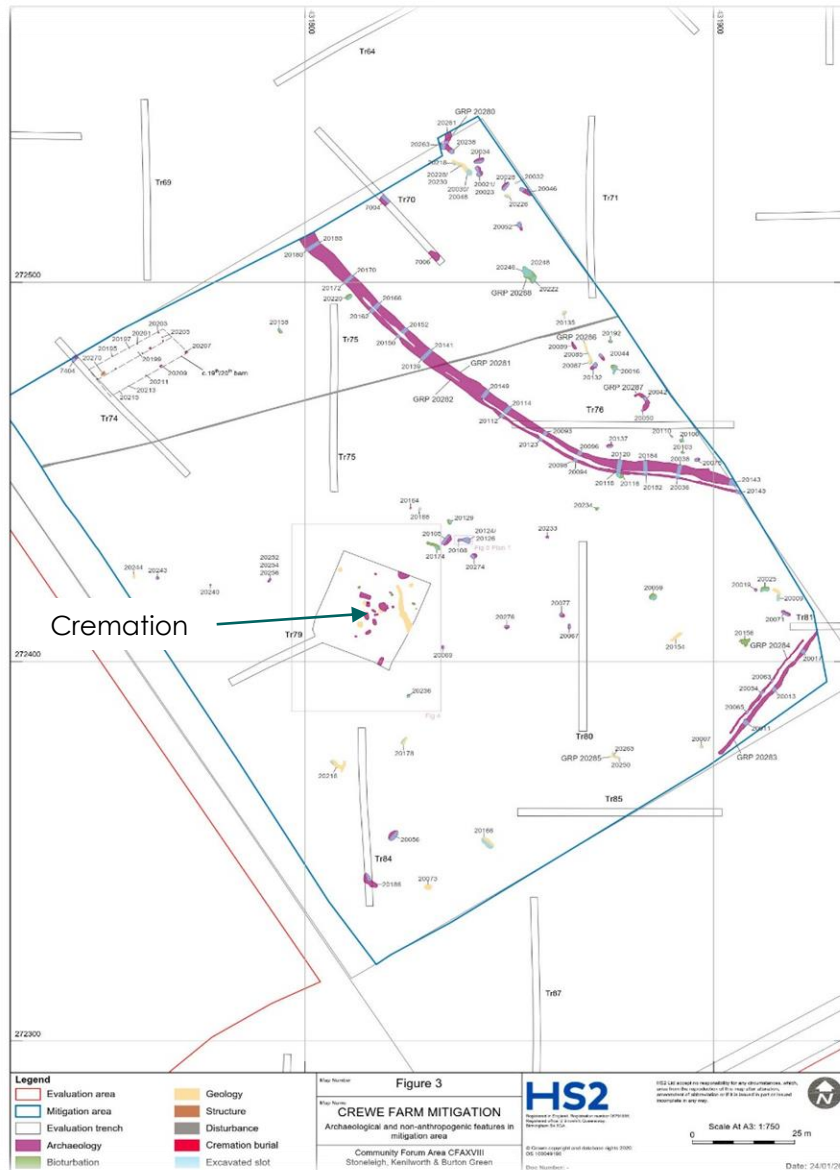

- Mitigation Complete
 - Metal detecting.
 - Test pitting.
 - Archaeological Recording.
- Early Anglo-Saxon urned cremation and other funerary features identified during evaluation trenching.
- Small assemblage of worked flint recovered from ploughsoil and as residual material in later features.
- Five sherds of residual Bronze Age – Iron Age pottery recovered from two pits and one ditch
- No additional Anglo-Saxon funerary activity identified.
- One Medieval pit.
- Parish boundary ditch examined. Shallow fill contained residual Roman, Post Medieval and Modern pot sherds.

MITIGATION: COLESHILL

Coleshill Mitigation Areas

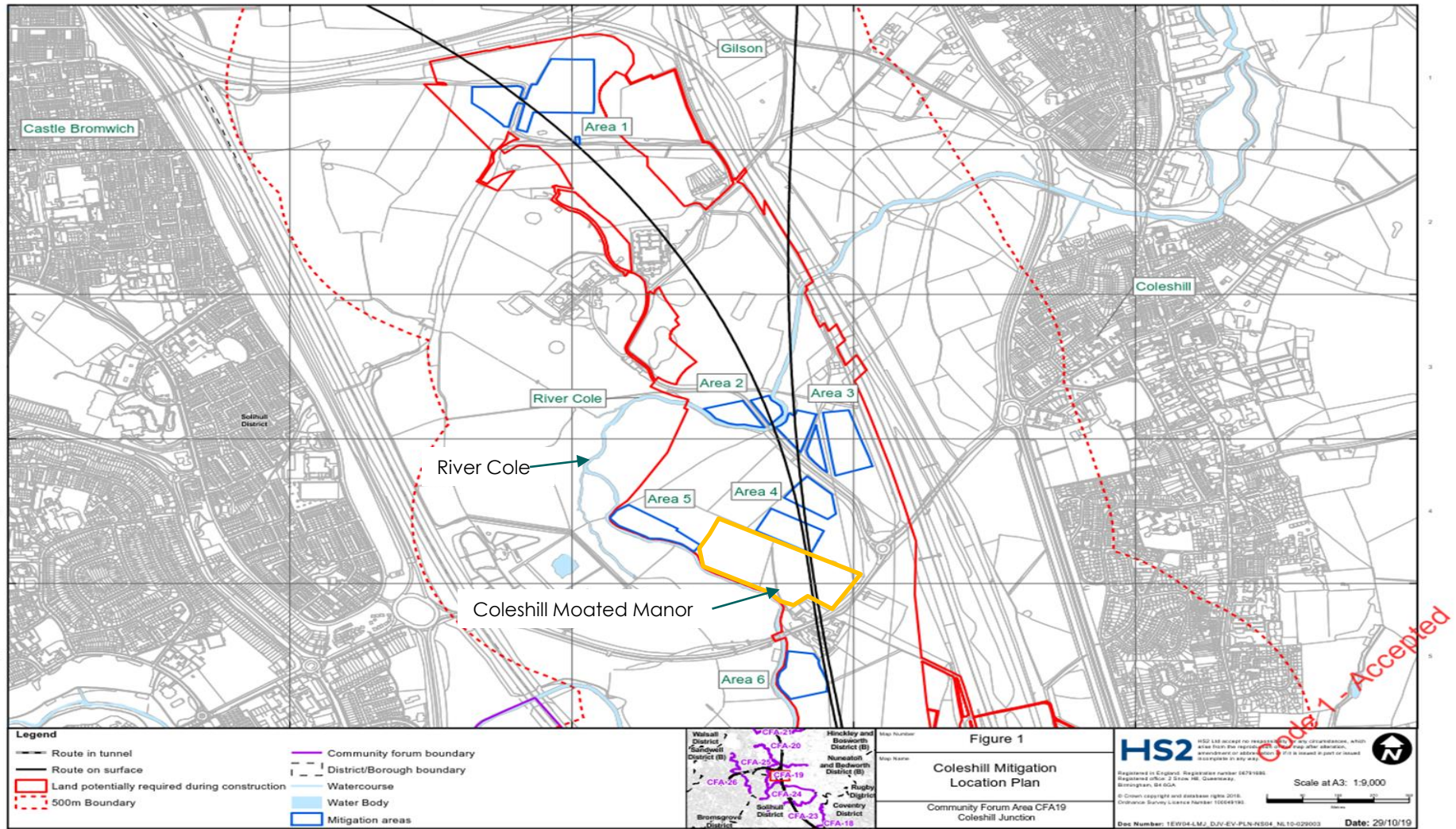

MITIGATION: COLESHILL

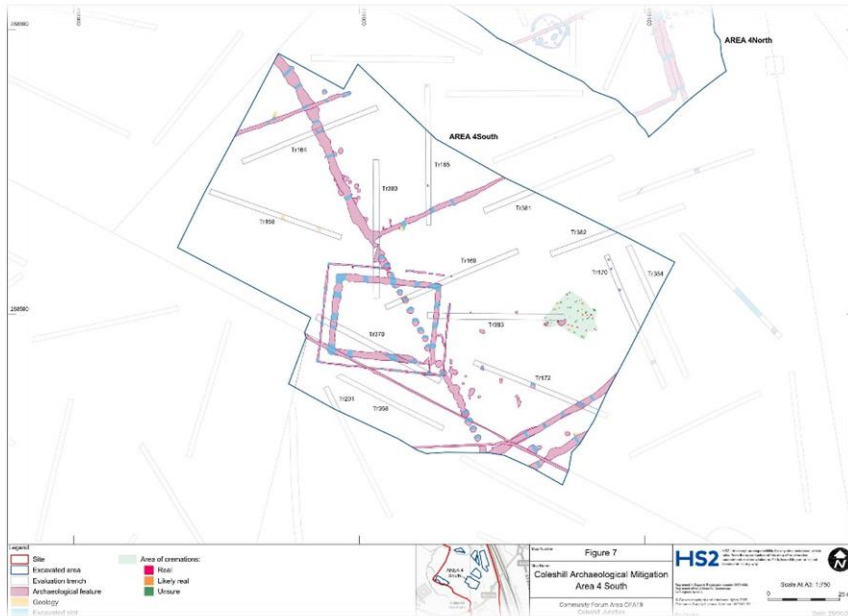

- Mitigation Ongoing
 - Metal Detecting.
 - Archaeological Recording.
- Roman Brooch and coin, a late medieval coin, post med and modern finds, from metal detecting.
- Two burnt mounds; one adjacent to the east and one adjacent to the north bank of the River Cole.
- Two palaeochannels. One more expected.
- Three pit alignments. Two more are expected.
- Iron Age roundhouses (x2).
- Cremation cemetery, c.10 – 20 total. Potentially Iron Age.
- Iron Age/Romano-British enclosure and field system ditches. Two of the ditches follow and truncate earlier pit alignments.
- Small rectangular enclosure overlooks the River Cole cuts one of the pit alignments.

MITIGATION: COLESHILL MANOR

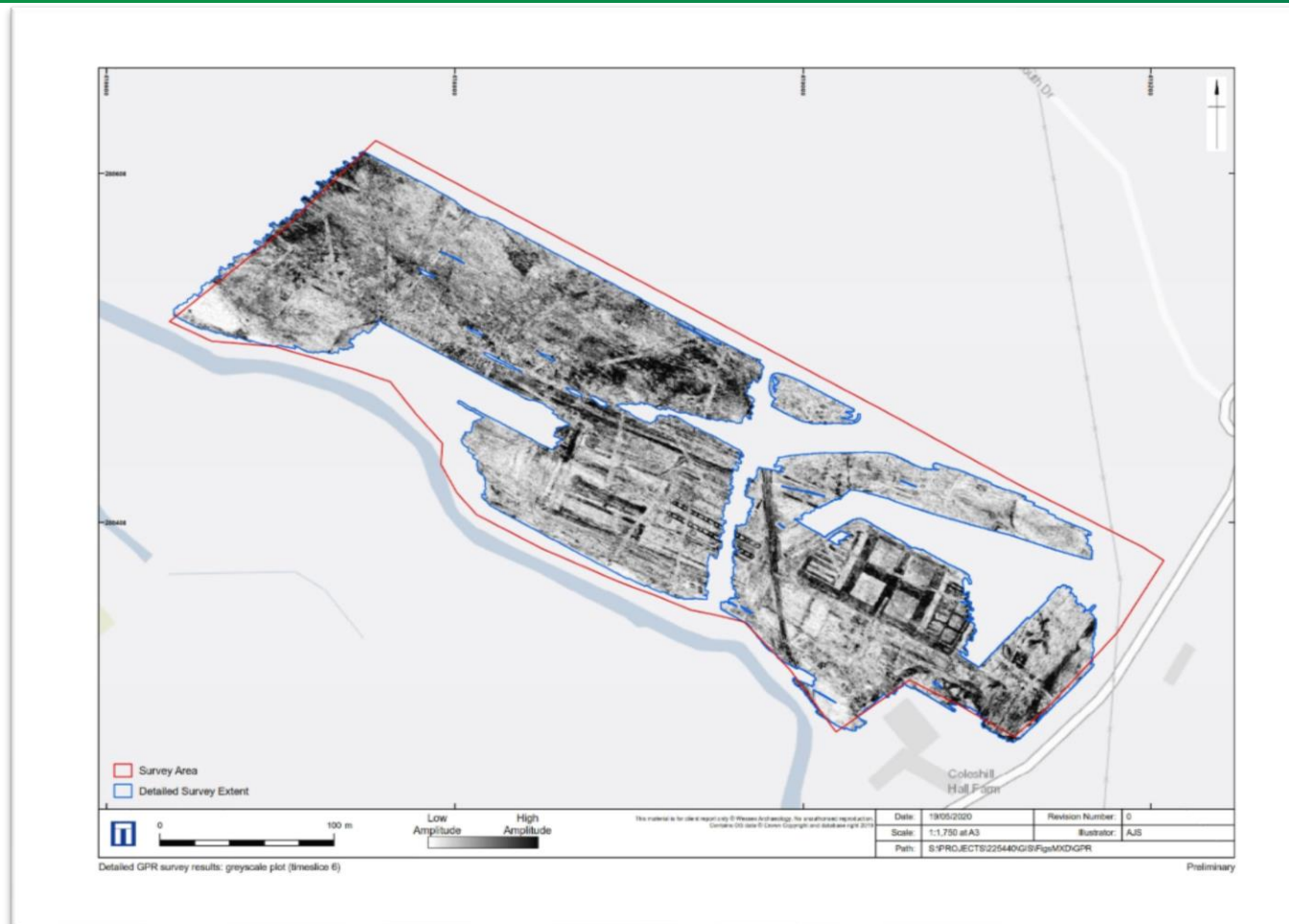

Coleshill Manor
GPR time slice

- Mitigation programmed to commence end July 2020
 - Metal Detecting.
 - Topographic Survey
 - Archaeological Recording
- Late Medieval and Post Medieval Moated Manor and Gardens.

MITIGATION: COLESHILL MANOR



Coleshill Manor
GPR time slice

- Mitigation programmed to commence end July 2020
 - Metal Detecting.
 - Topographic Survey
 - Archaeological Recording
- Late Medieval and Post Medieval Moated Manor and Gardens.

MITIGATION: COLESHILL MANOR

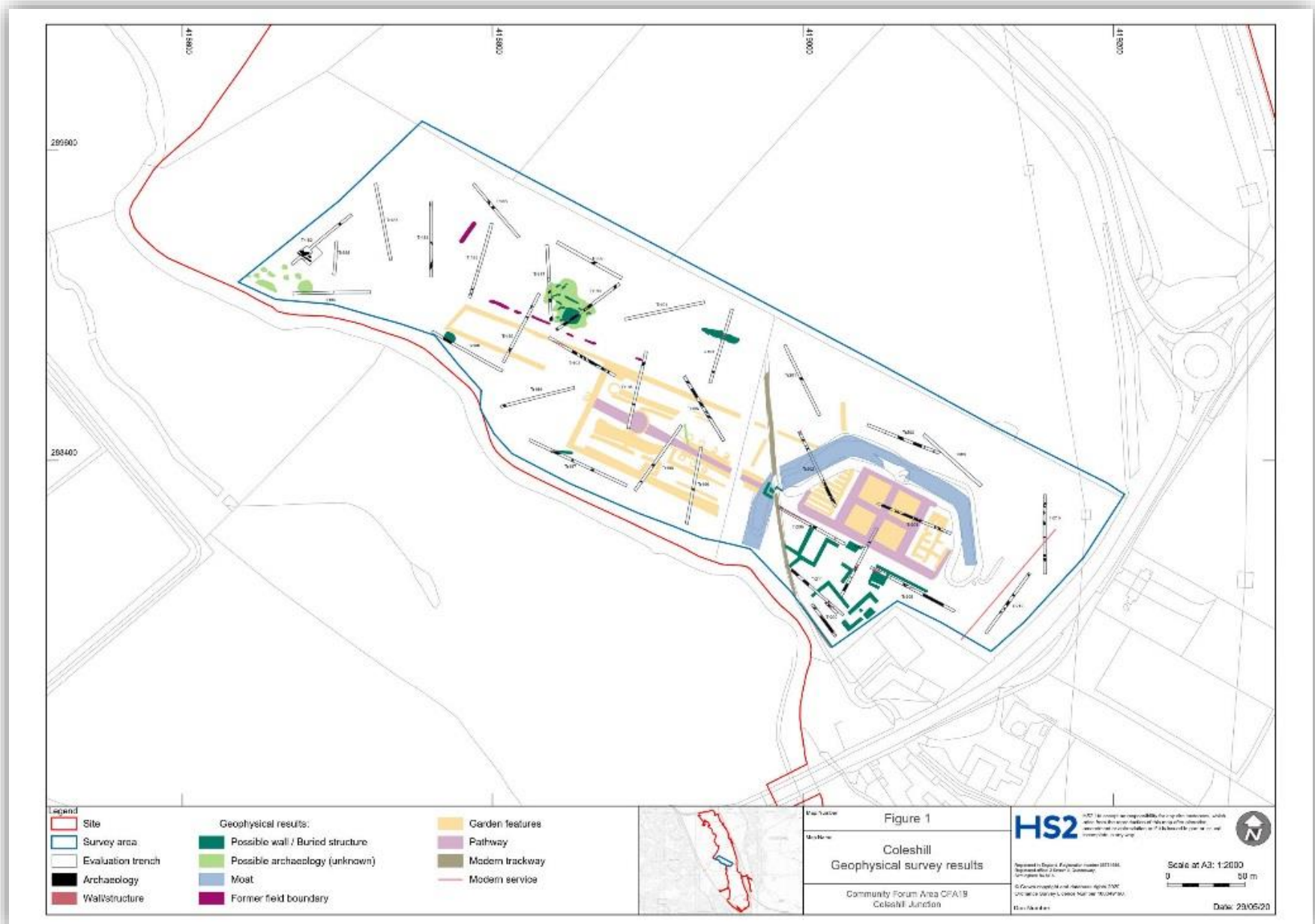

GPR Interpretation and trench results

MITIGATION: CURZON STREET



- Mitigation Ongoing
 - Construction Integrated Recording (CIR) of Grand Junction Railway (GJR) Terminus.
 - Archaeological Recording of London to Birmingham Railway (LBR) Roundhouse.
 - Construction Integrated Recording of Palaeolandscape during ground remediation.
- Palaeolandscape has low potential, thin peat layer is degraded and truncated. Surrounding fluvial sands and gravels also truncated during construction of stations.
- Extensive survival of elements of the GJR recorded during CIR.
- Good survival of remains of the LBR roundhouse. Concrete wall of turntable, base of radial inspection pits and associated drainage, foundation of roundhouse and attached office building identified.

MITIGATION: MERCOTE / MARSH FARM

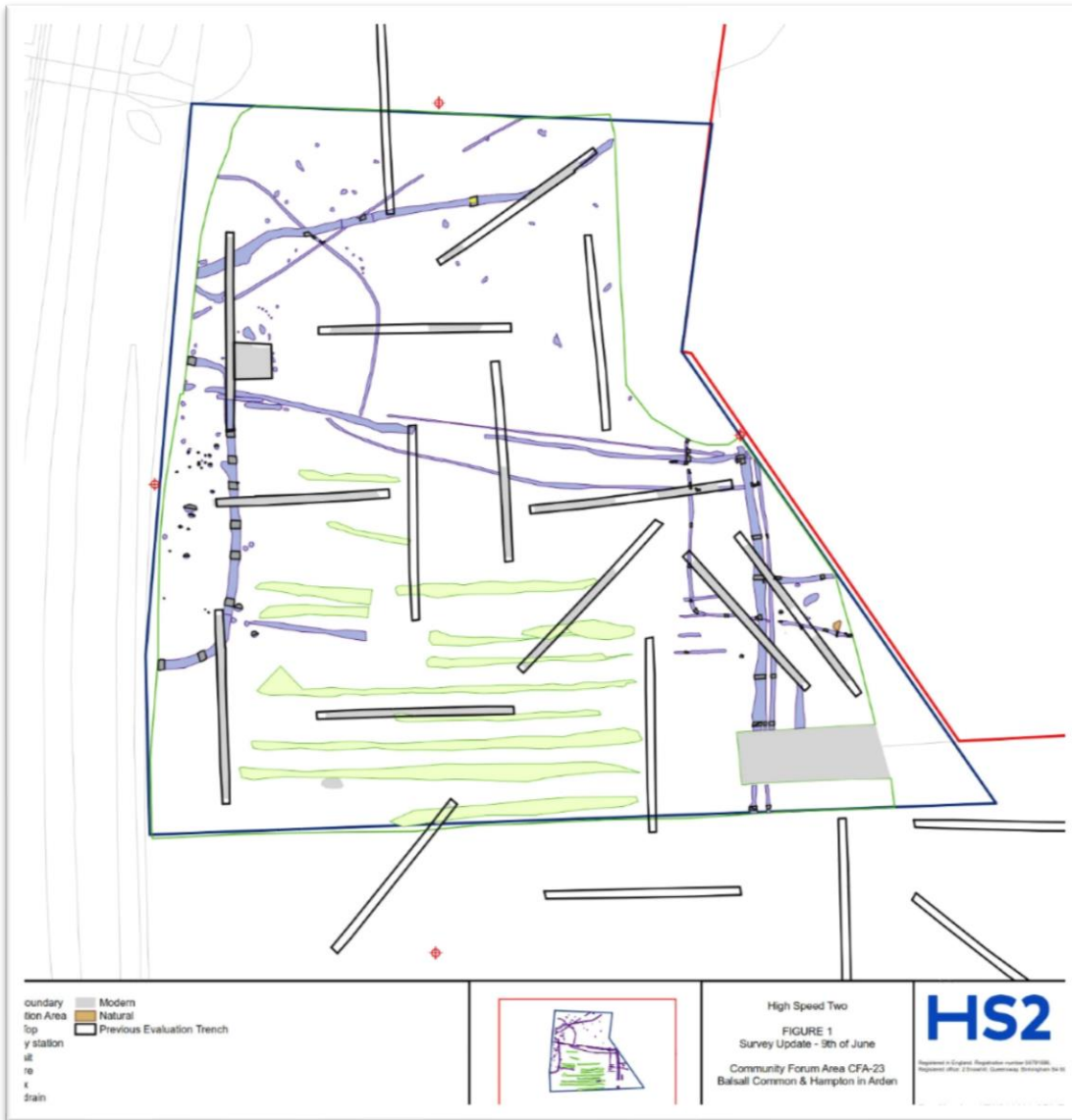

- Mitigation Ongoing.
 - Archaeological Recording
- Middle Iron Age enclosure ditch, pits and post holes at the west.
- Potential Romano-British field system at the east.
- Possible evidence for systematic tree clearance at the north, not yet investigated.
- Approximately north south and east-west aligned post medieval field system ditches and east-west aligned furrows

MILBURN GRANGE



- Mitigation Ongoing
 - Metal Detecting
 - Test Pitting
 - Archaeological Recording
- Approximately 500 worked flints recovered from ploughsoil during test pitting, with concentrations noted at two areas. Diagnostic component is largely Mesolithic.
- Approximately 140 residual worked flint artefacts recovered from excavated enclosure ditches. One Roman brooch and pot sherd is the only other dating evidence retrieved as yet.
- Strip of remainder of the mitigation area will commence shortly and this is where the evaluation suggests presence of structural features contemporary with the enclosures.

MITIGATION: RYKNIELD STREET

- Mitigation Complete
 - Test pitting
 - Archaeological Recording
- Very small assemblage of worked flint, prehistoric, Roman and medieval pot sherds recovered during test pitting.
- Three areas of dispersed pits. Dated pits were concentrated at the north and south, they contained worked flint and Bronze Age pot sherds.
- A single cremation located c.20m north of the curvilinear ditch had been interred in an inverted collared urn.
- At the north three unurned cremations. One interred with an accessory vessel of middle Bronze Age date.
- At the south Bronze Age pottery and thirteen pieces of worked flint recovered from a linear. A single sherd of Roman pottery from the northern terminal of a curving ditch cutting the linear.

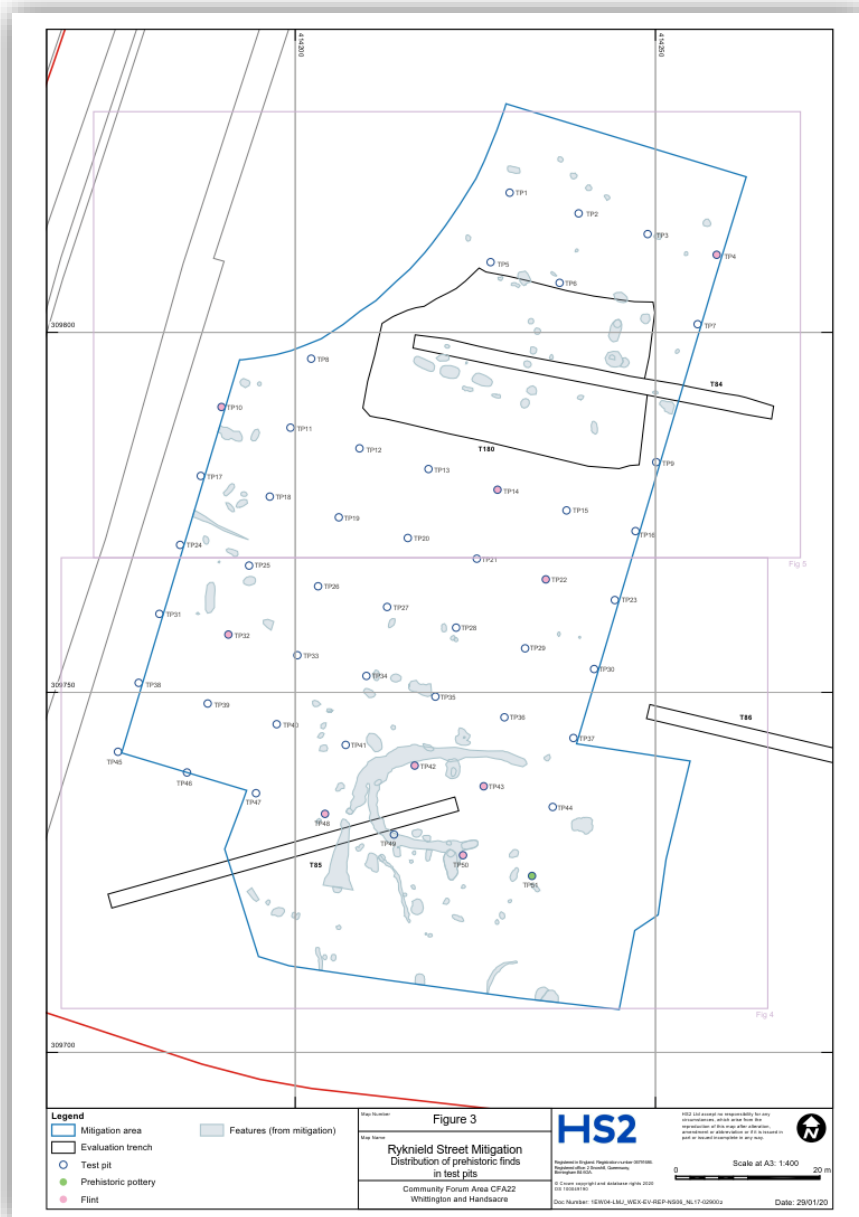

SOUTH CUBBINGTON WOOD

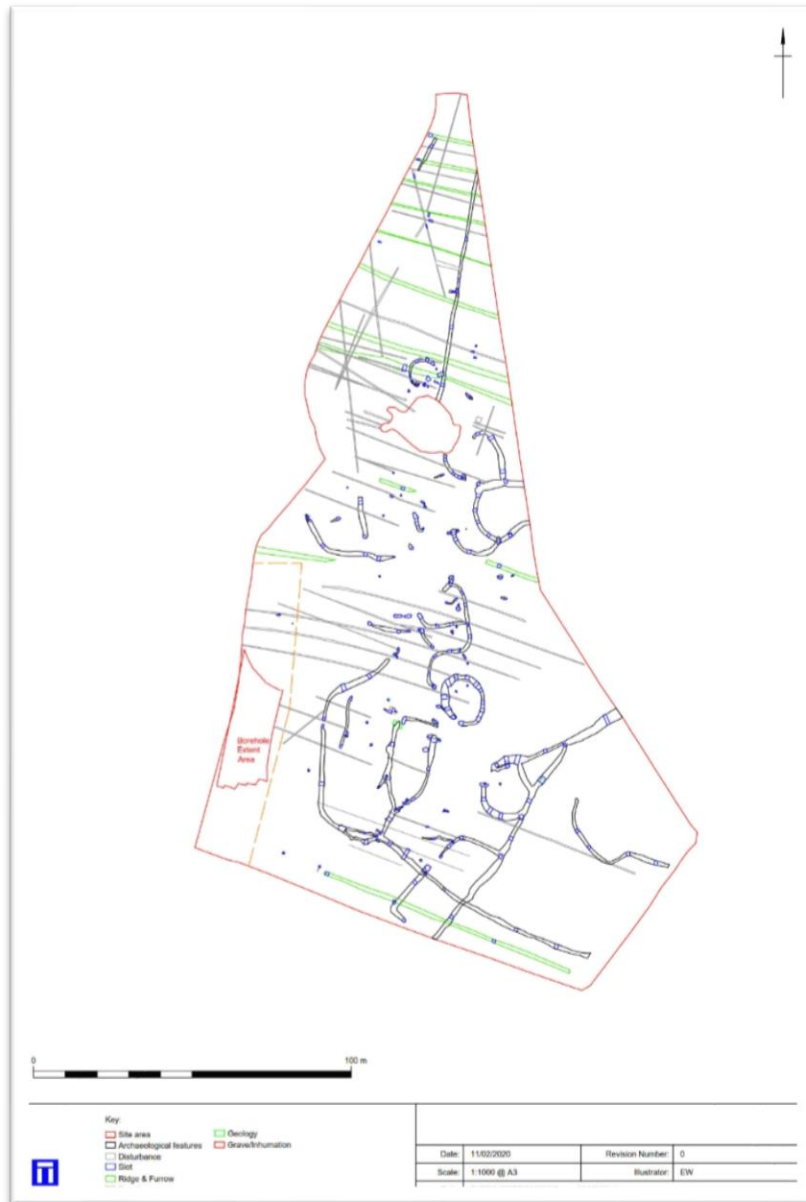

- Mitigation Complete
 - Archaeological Recording
- Late Iron Age / Early Romano-British rural settlement.
- One roundhouse at north, two potential roundhouses at the south.
- Rectilinear and curvilinear agricultural enclosures.
- Iron Age pot sherds, a copper alloy ear scoop, an iron spear head, a saddle quern and a fragment of human femur recovered.
- Animal bone and environmental samples are being assessed and results written up.

PARK STREET

BIRMINGHAM'S LARGEST BURIAL GROUND

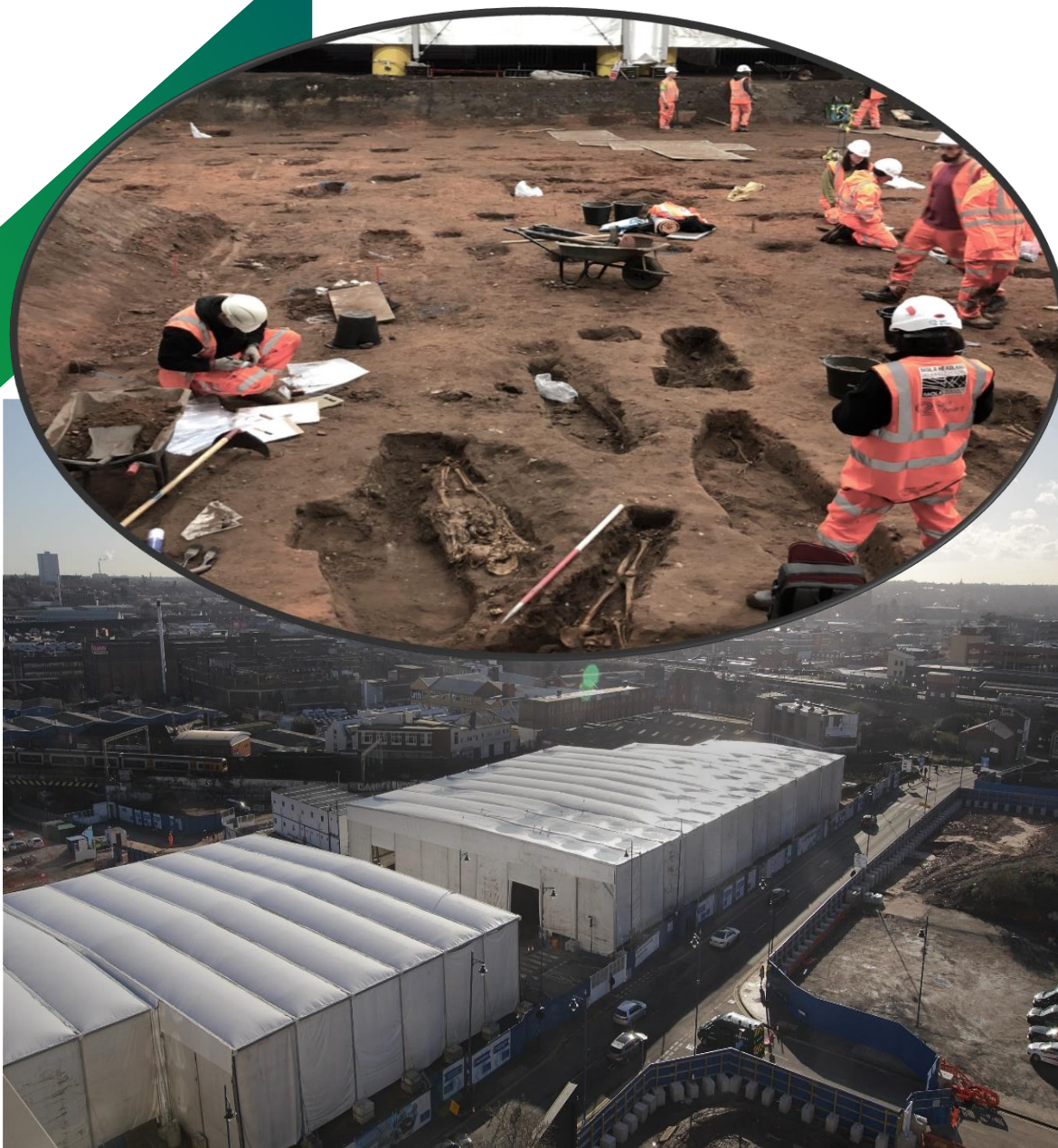

- ❖ Excavation and fieldwork report complete
- ❖ Over 10,000 individuals excavated with dignity, care and respect - in accordance with HS2's legal Undertakings with the Church of England
- ❖ Finished to program and under budget
- ❖ Success achieved by a collaborative team DJV, LM and MHI, monitoring, managing and delivering scope of this complex project
- ❖ Initial stages of reburial successfully designed, negotiated and delivered

PARK STREET

POST EXCAVATION & HERDS

Proposals to meet research objectives on topics including:

- ❖ Health and disease – within and between cemeteries, comparison of disease prevalence with contemporary assemblages and documentary evidence
- ❖ Medical advances in anatomy stemming from the discovery of dissection – details of autopsy, medical teaching, burial ground management and socio-economic status
- ❖ Mobility – origin and lifestyle (holistic approach: historical, documentary, biographical, skeletal)
- ❖ Cemetery management – layout, phasing (orderly to less-so!)
- ❖ Aim to share information through digital curation



GEOARCHAEOLOGY

- Programme of works near-complete
- Test Pits for Palaeolithic archaeology
- Boreholes to capture Pleistocene deposits
- Next steps - Ecofact assessment and updated Deposit modelling



A1-2 – Fosse Way (south of Leam) 4 Terraces



A2-3 Chattle Hill - Glaciofluvial outwash gravels overlying, clayey sand and fluvial sands and gravels (Tame terrace 2) overlying weathered mudstone.

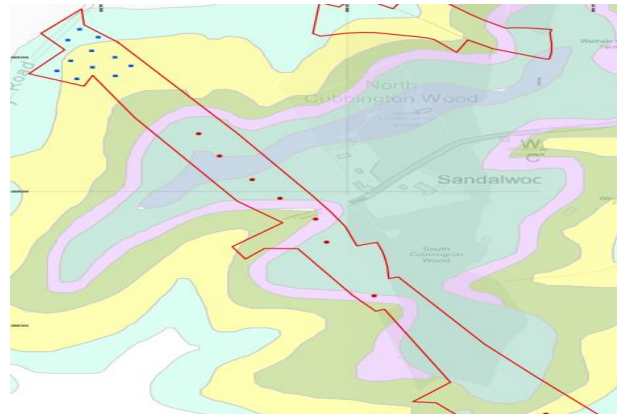

A1-3 Cubbington – good sample recovery from Baginton Sands and Gravels



A2-2 Coleshill – mitigation Area 2 early Holocene channel reactivated in the Bronze Age. Burnt mound material – within channel fill

GEOARCHAEOLOGY

CURZON STATION YARD A2-GCZ41



- Organic silt discovered where modelled
- Fairly disturbed - degraded, compressed and truncated by post-medieval drains and made ground.

- No artefacts were recovered – unlike to the south
- A single monolith was taken and associated bulk samples in the less disturbed south of the trench

- Pollen, plant macrofossils and insect assessment is recommended, focussing on preservation
- Radiocarbon chronology could be established through dating on microfossils

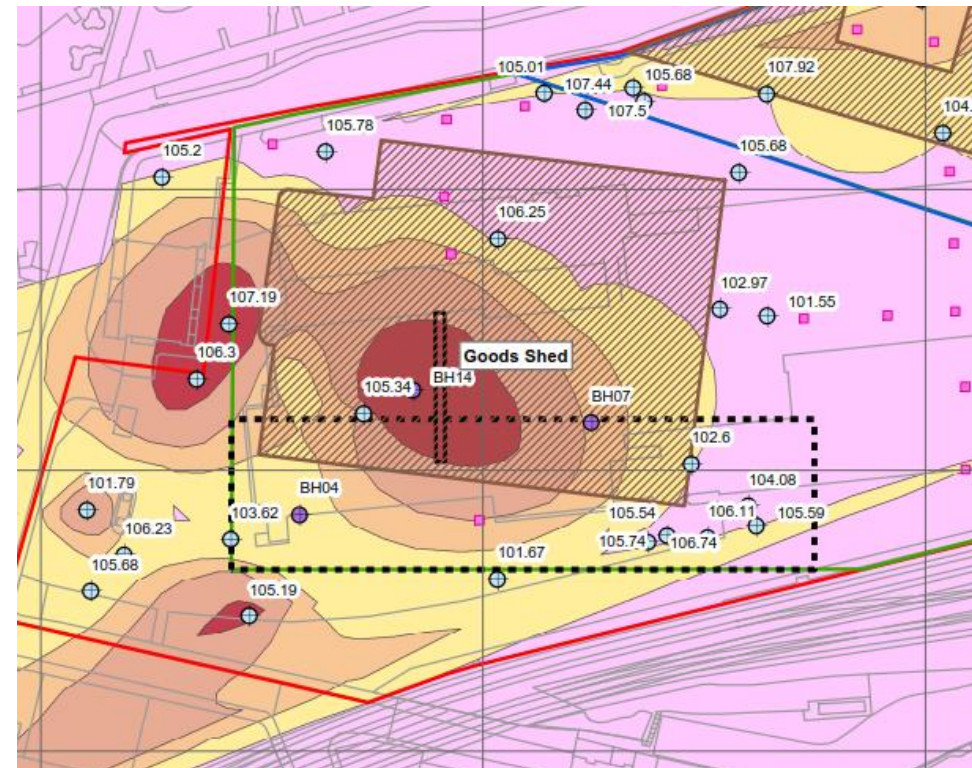

COMMUNITY ENGAGEMENT - HERDS

CURRENT ARCHAEOLOGY

- ❖ The 'world's oldest' round house at Curzon Station yard made it on to the cover of Current Archaeology this month
- ❖ www.hs2.org.uk/building-hs2/archaeology/curzon-street-station-archaeology
- ❖ HS2 video on the roundhouse



ONLINE ENGAGEMENT

WEBINARS AND OTHER ACTIVITIES

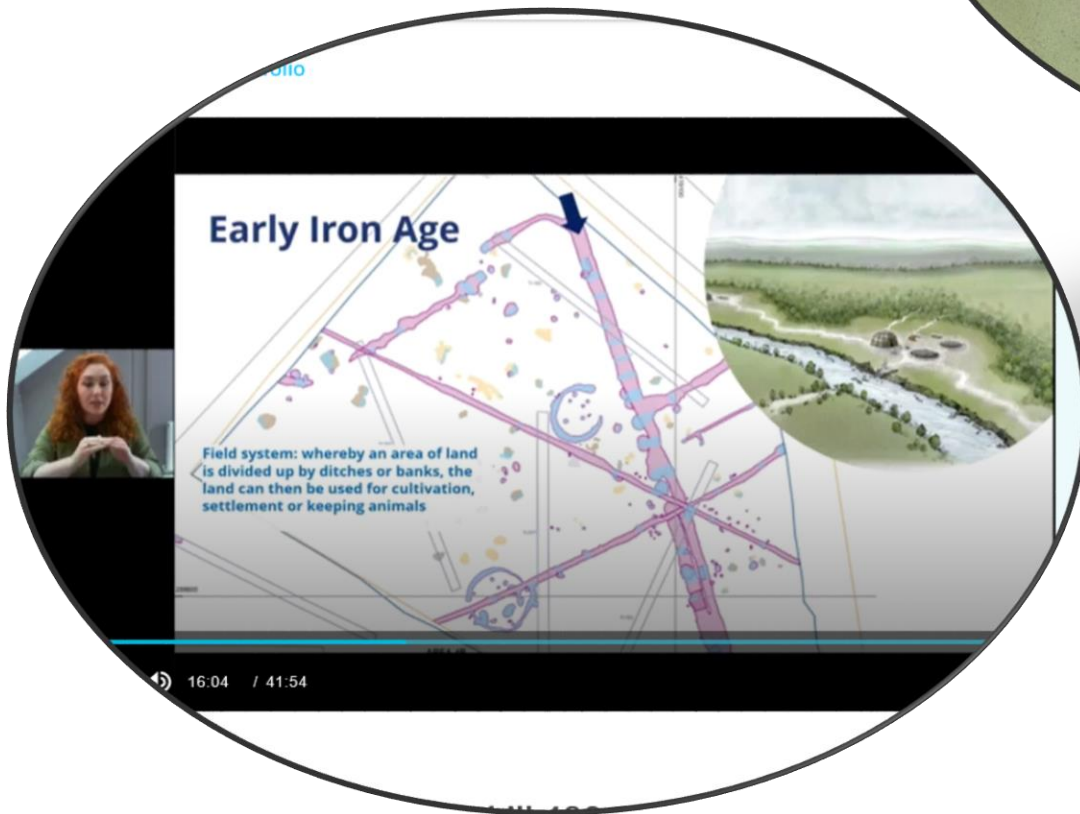
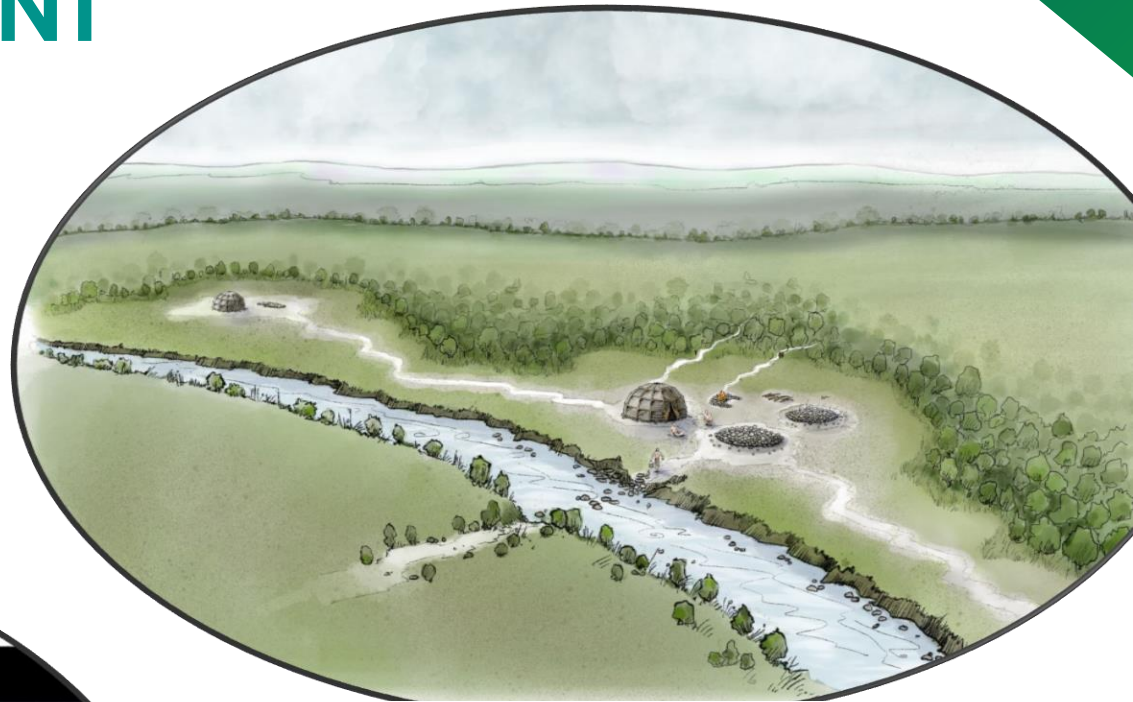

- ❖ WP29 Community Engagement - digital
- ❖ Webinars showcasing the archaeology of Area North – Coleshill, Kenilworth to Balsall Common and Curzon Street
- ❖ Live links, virtual object handling, UAV footage, fly-throughs
- ❖ Lectures and talks
- ❖ Early Railways Conference
- ❖ Online Exhibition – creative visualisations

ONLINE ENGAGEMENT

WEBINARS AND OTHER ACTIVITIES

