

HIGH SPEED RAIL (LONDON – WEST MIDLANDS) ACT 2017

HIGH SPEED RAIL (LONDON – WEST MIDLANDS) GENERAL VESTING DECLARATION No. 438

This **GENERAL VESTING DECLARATION** is executed on
by the Secretary of State for Transport (“the Authority”).

9th October 2020

WHEREAS:

- (1) On 23 February 2017 the High Speed Rail (London – West Midlands) Act 2017 (“the High Speed Rail Act”) received Royal Assent authorising the Authority to acquire the land specified in the Schedule hereto.
- (2) Section 4(1) of the High Speed Rail Act authorises the Authority to acquire compulsorily so much of the land within the limits of the High Speed Rail Act as may be required for Phase One purposes¹.
- (3) Section 4(4) of the High Speed Rail Act provides that the Compulsory Purchase (Vesting Declarations) Act 1981 (“the 1981 Act”) applies as if the High Speed Rail Act were a compulsory purchase order and paragraph 3² of Schedule 6 to the High Speed Rail Act provides that the 1981 Act shall have effect subject to the modifications specified in that paragraph.
- (4) Notice pursuant to section 3A³ of the 1981 Act was first published on 18 September 2020. That notice included the particulars specified in section 3A(3) of the 1981 Act.

NOW THIS DEED WITNESSETH that, in exercise of the powers conferred on it by section 4 of the 1981 Act, the Authority hereby declares:-

1. The land described in the Schedule hereto (being part of the land authorised to be acquired by the High Speed Rail Act) and more particularly delineated and shown coloured pink on the plan annexed hereto, together with the right to enter upon and take possession of the land, shall vest in the Authority as from the end of the period of 3 months from the date on which the service of notices required by section 6⁴ of the 1981 Act is completed.

For the purposes of Section 2(2) of the 1981 Act, the specified period in relation to the land comprised in this declaration is one year and one day.

1 Phase One Purposes has meaning given by section 67 of the High Speed Rail Act

2 Paragraph 3 as substituted by section 11 of, and paragraph 6 of Schedule 14 to, the High Speed Rail Act.

3 Section 3A of the 1981 Act as inserted by paragraph 3(a) of Schedule 6 to the High Speed Rail Act as substituted by section 11 of, and paragraphs 6 and 7 of Schedule 14 to, that Act.

4 Section 6 as modified by paragraph 3(c) of Schedule 6 to the High Speed Rail Act, as substituted by section 11 of, and paragraph 6 of Schedule 14 to, that Act

SCHEDULE

District of South Northamptonshire

(1) Plot No	(2) Plot Description
63467	All interests in 78816.8 square metres, or thereabouts, of agricultural land and public footpath (AX6) (Radstone House Farm)
63559	All interests in 9562.8 square metres, or thereabouts, of agricultural land and verge (Radstone House Farm)
63560	All interests in 66997.6 square metres, or thereabouts, of agricultural land, public footpaths (AX7 and AX15), hedgerows, drain, woodland and access track (Radstone House Farm)
63561	All interests in 243.8 square metres, or thereabouts, of woodland, grassland and watercourse (Radstone Road)
63562	All interests in 98273.2 square metres, or thereabouts, of agricultural land, access track, hedgerows, drain and public footpath (AX5) and public bridleways (AX18 and AX19) (Radstone House Farm)
63563	All interests in 243622.0 square metres, or thereabouts, of agricultural land, hedgerows, access track, drain and public footpath (AX5) and public bridleways (AX1, AX18 and AX19) (Radstone House Farm)
63569	All interests in 45953.4 square metres, or thereabouts, of agricultural land, hedgerows, drain, public footpaths (AX7 and AX15) and public bridleway (AX14) (Radstone House Farm)
63570	All interests in 29072.9 square metres, or thereabouts, of agricultural land, grassland, woodland and public bridleway (AX1) (Radstone House Farm)
64002	All interests in 9414.0 square metres, or thereabouts, of agricultural land, woodland (Halse Copse), hedgerows, public footpath (AN22) (Halse Grange Farm)
64004	All interests in 5474.3 square metres, or thereabouts, of agricultural land, woodland (Halse Copse), hedgerows, public footpath (AN22) and public bridleway (AN37) (Halse Grange Farm)
64046	All interests in 212.3 square metres, or thereabouts, of agricultural land and public bridleway (AX14) (Radstone House Farm)
64047	All interests in 14305.3 square metres, or thereabouts, of dismantled railway (Great Central Railway), footbridge carrying public bridleway (AX14) and agricultural land (Radstone House Farm)
64048	All interests in 26860.1 square metres, or thereabouts, of agricultural land, hedgerow and public bridleways (AX14 and AX16) (Radstone House Farm)
64049	All interests in 5778.3 square metres, or thereabouts, of dismantled railway (Great Central Railway) (Radstone House Farm)
64050	All interests in 21138.3 square metres, or thereabouts, of agricultural land and public bridleway (AX16) (Radstone House Farm)

IN WITNESS WHEREOF the Secretary of State for Transport has hereunto set its corporate seal on the day in the year first written above.

The **CORPORATE SEAL** of the SECRETARY OF STATE FOR TRANSPORT hereunto affixed to this deed is authenticated by



.....

Authorised Signatory

Dated: 9th October 2020

SEAL REF
DfT GP / 0300

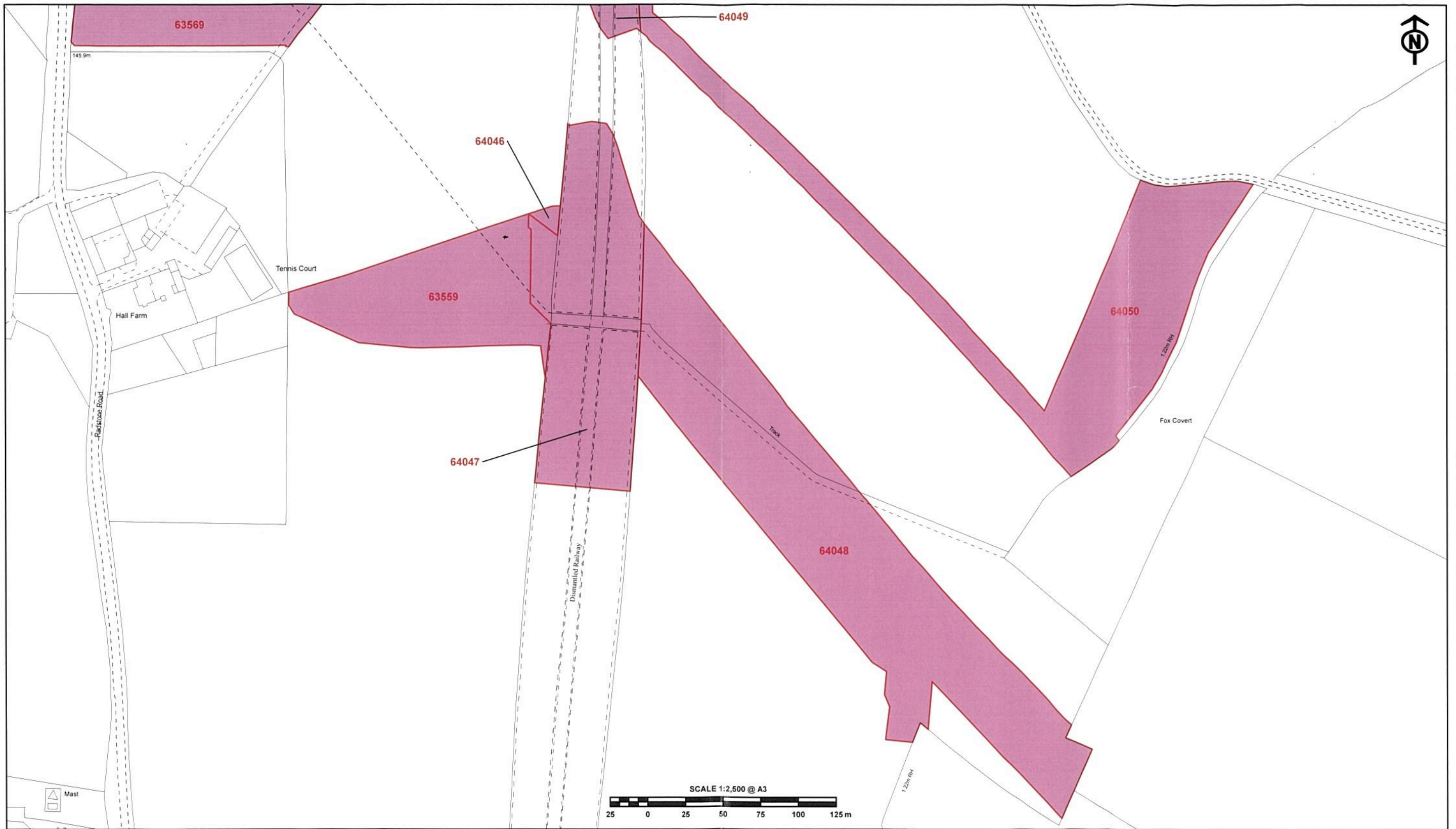



The CORPORATE SEAL of the
SECRETARY OF STATE
hereunto affixed to this deed
is authenticated by

Authorised by the Secretary of State for Transport

Dated 9th October 2020

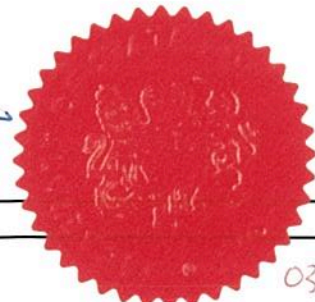

0300



The CORPORATE SEAL of the
SECRETARY OF STATE
hereunto affixed to this deed
is authenticated by

Authorised by the Secretary of State for Transport

Dated 9th October 2020



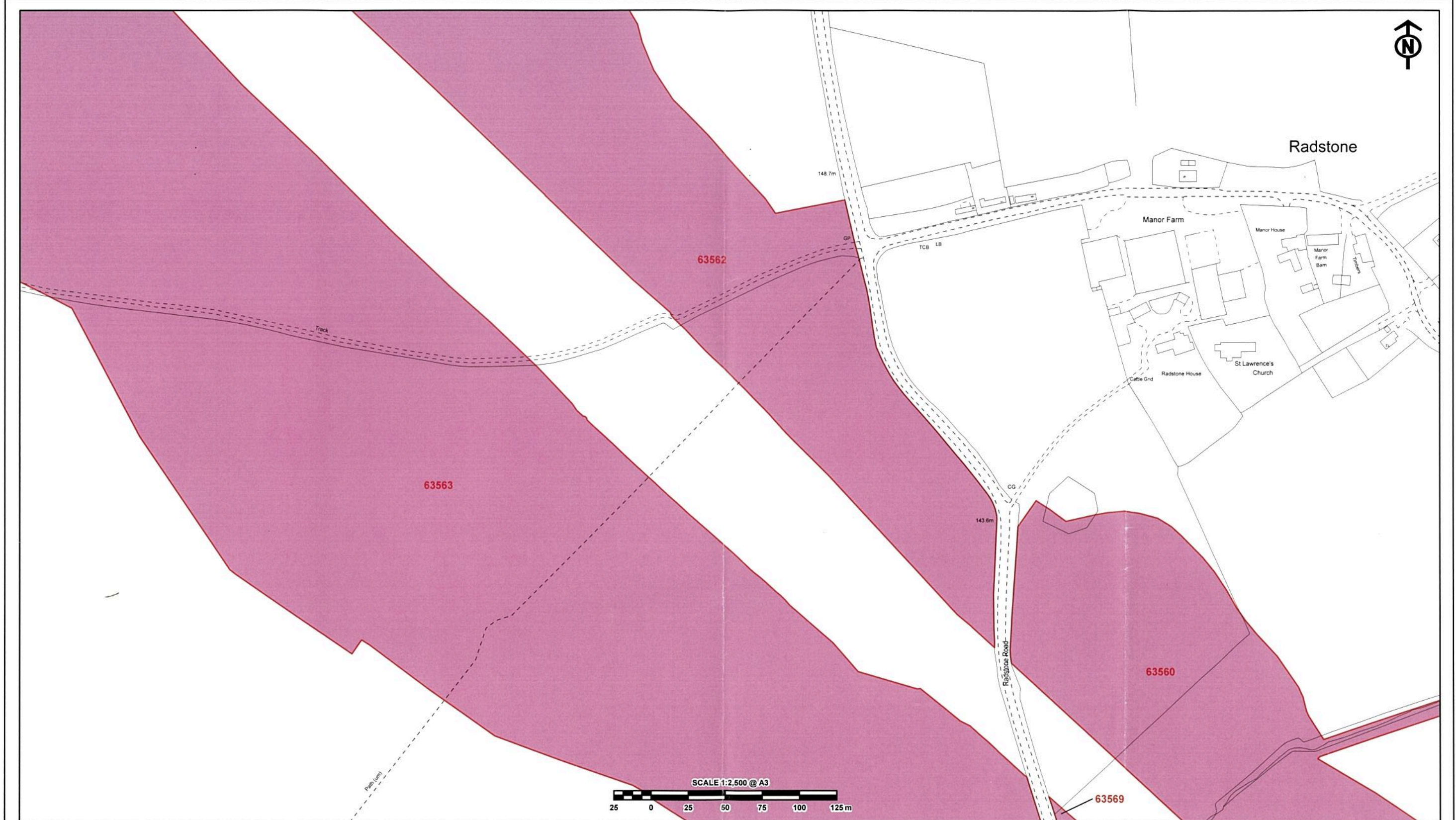

The CORPORATE SEAL of the
SECRETARY OF STATE
hereunto affixed to this deed
is authenticated by

[Signature]
Authorised by the Secretary of State for Transport

Dated 9th October 2020



0300

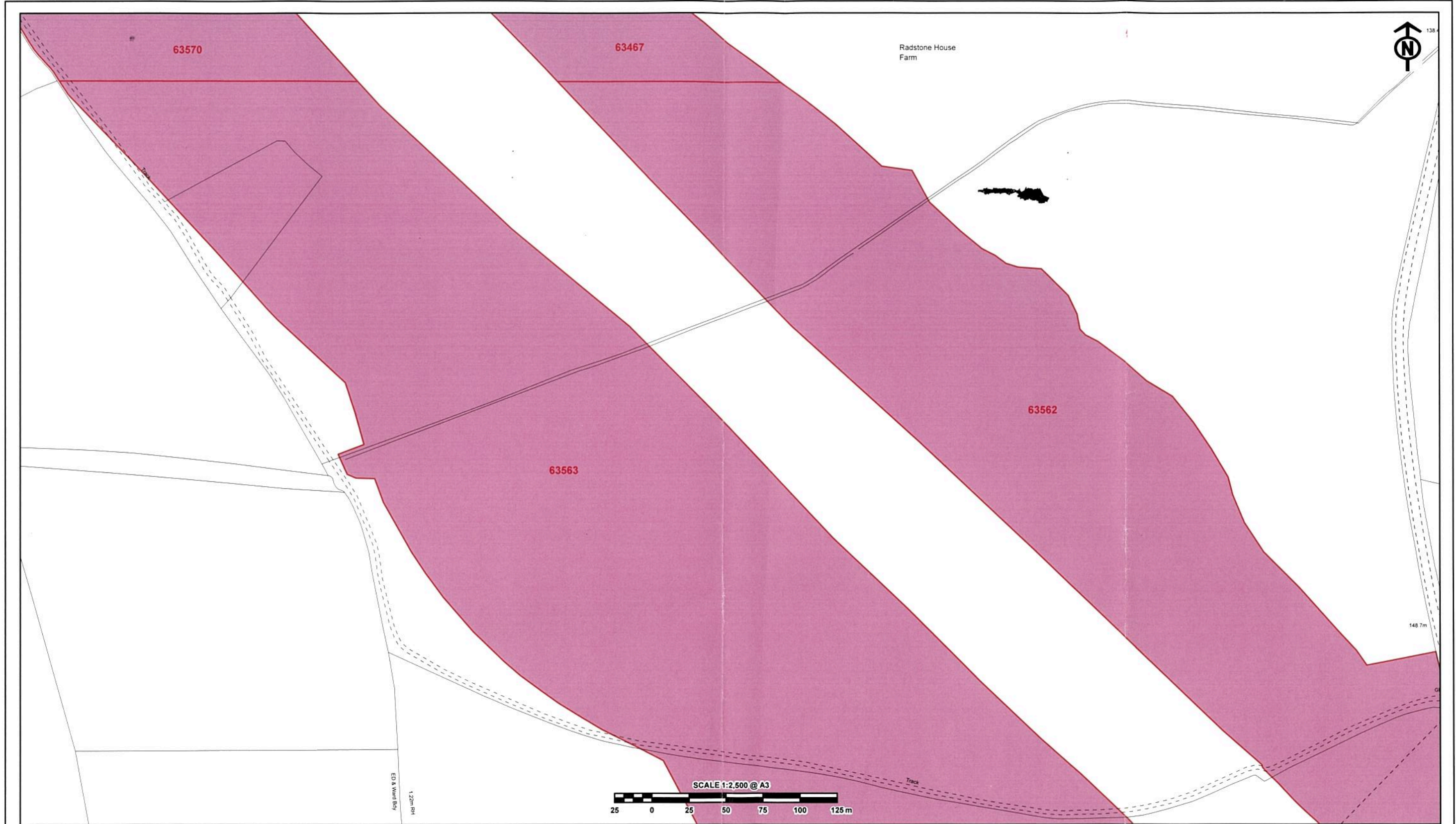

The CORPORATE SEAL of the
SECRETARY OF STATE
hereunto affixed to this deed
is authenticated by

Authorised by the Secretary of State for Transport

Dated 9th October 2020





The CORPORATE SEAL of the
SECRETARY OF STATE
hereunto affixed to this deed
is authenticated by

Authorised by the Secretary of State for Transport

Dated 9th October 2020



0300

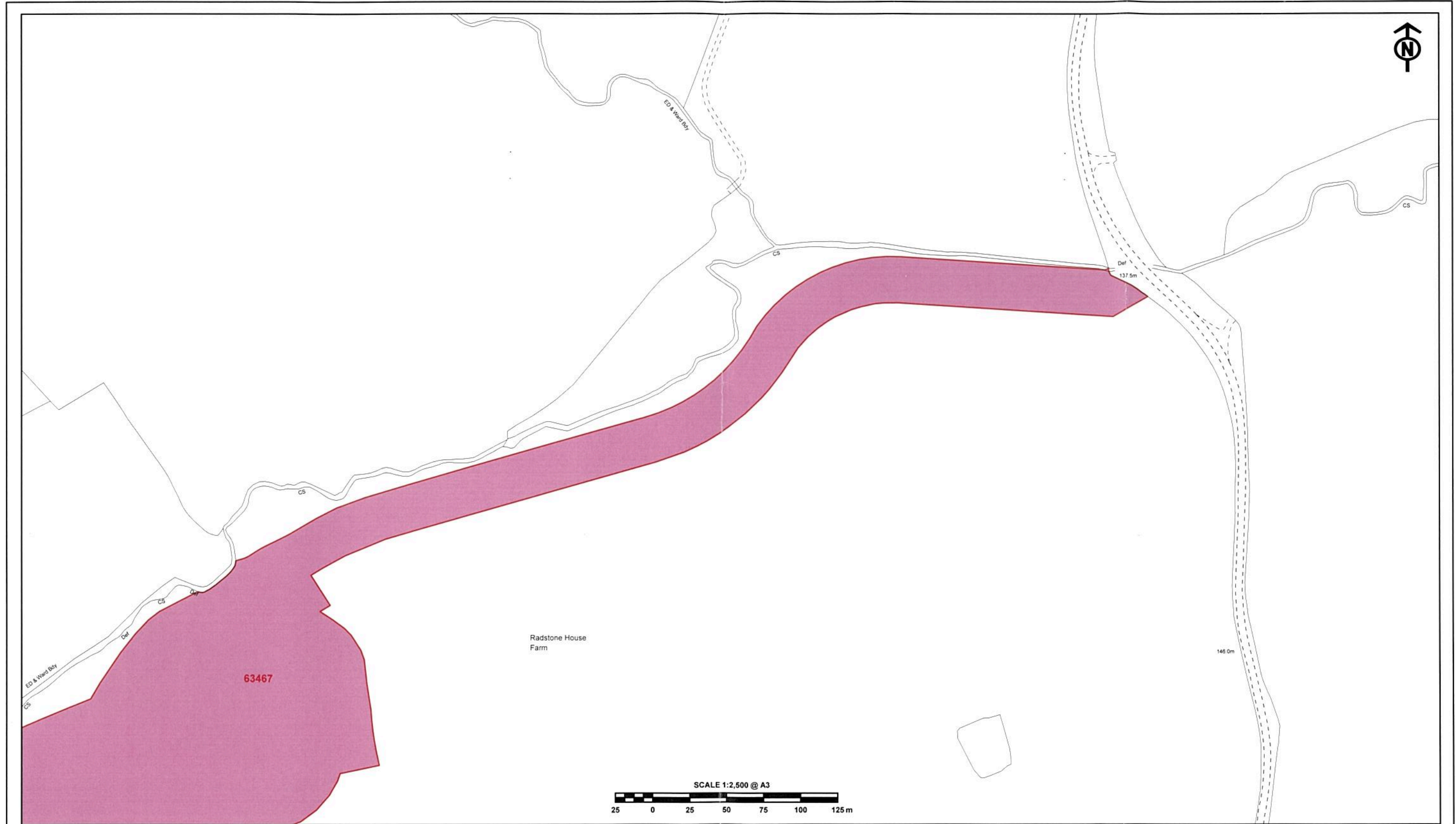

The CORPORATE SEAL of the
SECRETARY OF STATE
hereunto affixed to this deed
is authenticated by

[Signature]
Authorised by the Secretary of State for Transport

Dated 9th October 2020



