

Air Quality and Dust Monitoring Monthly Report – June 2020

South Northamptonshire District Council



Department for Transport

High Speed Two (HS2) Limited has been tasked by the Department for Transport (DfT) with managing the delivery of a new national high speed rail network. It is a non-departmental public body wholly owned by the DfT.

High Speed Two (HS2) Limited,
Two Snowhill
Snow Hill Queensway
Birmingham B4 6GA

Telephone: 08081 434 434

General email enquiries: HS2enquiries@hs2.org.uk

Website: www.gov.uk/hs2

A report prepared by Fusion on behalf of HS2 Ltd.

High Speed Two (HS2) Limited has actively considered the needs of blind and partially sighted people in accessing this document. The text will be made available in full on the HS2 website. The text may be freely downloaded and translated by individuals or organisations for conversion into other accessible formats. If you have other needs in this regard please contact High Speed Two (HS2) Limited.

© High Speed Two (HS2) Limited, 2020, except where otherwise stated.

Copyright in the typographical arrangement rests with High Speed Two (HS2) Limited.

This information is licensed under the Open Government Licence v2.0. To view this licence, visit www.nationalarchives.gov.uk/doc/open-government-licence/version/2 **OGI** or write to the Information Policy Team, The National Archives, Kew, London TW9 4DU, or e-mail: psi@nationalarchives.gsi.gov.uk. Where we have identified any third-party copyright information you will need to obtain permission from the copyright holders concerned.



Printed in Great Britain on paper containing at least 75% recycled fibre.

Monthly Summary

- 1.1.1 This Summary Report is published in fulfilment of commitments detailed in the High Speed Rail (London-West Midlands) Environmental Minimum Requirements, Annex 1: Code of Construction Practice, for the nominated undertaker to present the results of dust monitoring undertaken in South Northamptonshire District Council (SNDC) during June 2020.
- 1.1.2 Figure 1 in Appendix A indicates the current worksites together with the dust monitoring location in June 2020.
- 1.1.3 This summary should be read in conjunction with the overview monitoring report monthly available from www.gov.uk/government/collections/monitoring-the-environmental-effects-of-hs2, which highlights: the applicable standards and guidance, as well as the air quality and dust monitoring methodologies to be implemented by nominated undertakers throughout construction.
- 1.1.4 The current phase of works commenced within SNDC during October 2019 and are expected to be completed later in 2020. The current works form part of Chipping Warden road-widening item of the DC3A Work Package and, as presented in Appendix A, Figure 1, include:
- WPD ducting and cabling works;
 - Gas diversion trial holes;
 - Road box: Verge fill, v ditch excavation and topsoil dressing;
 - Appletree Road Drainage and carriageway construction;
 - Pond 2 excavation, bunds and topsoiling; and
 - Main line: Verge fill, earthworks and topsoil dressing. V ditches and headwalls.
- 1.1.5 One (1) dust monitor is installed around the worksites, where earthworks, construction and trackout activities are underway. These worksites returned a medium dust risk rating (for works currently active on site).
- 1.1.6 Dust monitoring location and results for June 2020 are presented in Appendix B, Table 1, together with a line chart of monthly data from this dust monitor presented in Figure 2. All continuous dust monitoring is undertaken using indicative monitors. Despite being Environment Agency (MCERTS) certified, indicative monitors carry a higher level of uncertainty than reference monitors, and therefore cannot be strictly compared with Air Quality Standards for human health and the environment. The purpose of the monitoring undertaken is to ensure the effectiveness of the on-site mitigation.
- 1.1.7 The trigger level for PM₁₀ concentrations of 190 µg/m³, over a 1-hour period, in accordance with the updated guidance document 'Guidance on Monitoring in the Vicinity of Demolition and Construction Sites – October 2018' has been applied.

- 1.1.8 Data capture for dust monitor AQ001 was below 90% for the month of June 2020 due to an airflow error occurred on 01/06/20 and five unexpected power outages. As a result, the monitor was offline and no data was recorded between the 01/06/20 and 09/06/20, when the monitor was replaced. Further data losses due to the power outages occurred between 10/06/2020 14:00 – 11/06/2020 06:00, 14/06/2020 12:00 – 15/06/2020 06:00, 19/06/2020 08:00 – 20/06/2020 06:00, 23/06/2020 22:00 – 24/06/2020 06:00 and also between 27/06/2020 18:00 – 28/06/2020 06:00. To solve these outages, the batteries were replaced and the monitoring was resumed.
- 1.1.9 There were no (0) dust trigger alerts recorded during the monitoring period (June 2020).
- 1.1.10 There were no (0) complaints, relating to dust or air quality, received during this reporting period (June 2020).

Appendix A – Worksites and Monitoring Locations

Figure 1: Worksites and Monitoring location during June 2020 within South Northamptonshire District Council

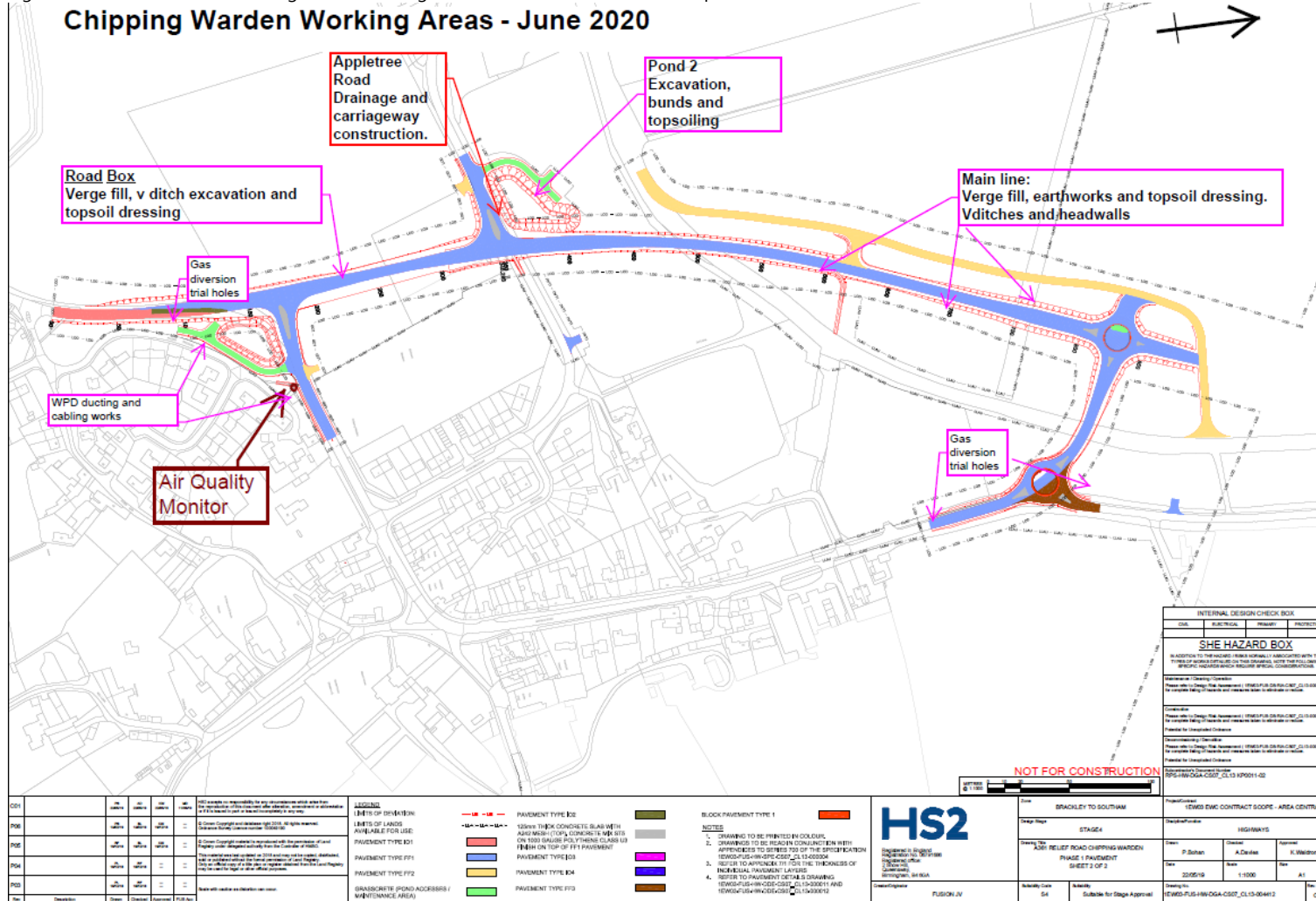

Appendix B – Dust Monitoring Results

Table 1: Dust monitoring locations and Results (1st June 2020 – 30th June 2020)

Monitoring site ID	Coordinates (X,Y)	Location description	Dust risk rating for site	Monitoring site active during period	Change to site since previous period report	Mean 1-hour PM ₁₀ concentration (µg/m ³)	Minimum 1-hour PM ₁₀ concentration (µg/m ³)	Maximum 1-hour PM ₁₀ concentration (µg/m ³)	Number of 1-hour periods exceeding trigger level of 190 µg/m ³	Data capture (%)
AQ001	449728, 248774	Secured to a lamppost by a footpath connecting Banbury Road to Allens Orchard	M	Yes	No	7.2	0.6	26.0	0	61

Figure 2: Construction dust 1-hour mean indicative PM₁₀ concentration for dust monitor AQ001

