

Air Quality and Dust Monitoring Monthly Report – June 2020

Birmingham City Council



Department for Transport

High Speed Two (HS2) Limited has been tasked by the Department for Transport (DfT) with managing the delivery of a new national high speed rail network. It is a non-departmental public body wholly owned by the DfT.

High Speed Two (HS2) Limited,
Two Snowhill
Snow Hill Queensway
Birmingham B4 6GA

Telephone: 08081 434 434

General email enquiries: HS2enquiries@hs2.org.uk

Website: www.gov.uk/hs2

A report prepared by LM on behalf of HS2 Ltd.

High Speed Two (HS2) Limited has actively considered the needs of blind and partially sighted people in accessing this document. The text will be made available in full on the HS2 website. The text may be freely downloaded and translated by individuals or organisations for conversion into other accessible formats. If you have other needs in this regard please contact High Speed Two (HS2) Limited.

© High Speed Two (HS2) Limited, 2020, except where otherwise stated.

Copyright in the typographical arrangement rests with High Speed Two (HS2) Limited.

This information is licensed under the Open Government Licence v2.0. To view this licence, visit www.nationalarchives.gov.uk/doc/open-government-licence/version/2 **OGI** or write to the Information Policy Team, The National Archives, Kew, London TW9 4DU, or e-mail: psi@nationalarchives.gsi.gov.uk. Where we have identified any third-party copyright information you will need to obtain permission from the copyright holders concerned.



Printed in Great Britain on paper containing at least 75% recycled fibre.

Monthly Summary

- 1.1.1 This Summary Report is published in fulfilment of commitments detailed in the High-Speed Rail (London-West Midlands) Environmental Minimum Requirements, Annex 1: Code of Construction Practice, for the nominated undertaker to present the results of dust monitoring undertaken within Birmingham City Council (BCC) during June 2020.
- 1.1.2 Figure 1 in Appendix A indicates the BCC worksite together with dust monitoring locations for June 2020.
- 1.1.3 This summary should be read in conjunction with the overview monitoring report monthly available from www.gov.uk/government/collections/monitoring-the-environmental-effects-of-hs2, which highlights: the applicable standards and guidance, as well as the air quality and dust monitoring methodologies to be implemented by nominated undertakers throughout construction.
- 1.1.4 The current phase of works commenced within BCC during July 2018 and is expected to be completed by the end of 2021. Two (2) dust monitors (Aeroqual Dust Sentry Monitors) are installed for the current phase of work, of which, one (1) is installed outside the Birmingham Museum Trust (BMT) site whilst the other one (1) is installed inside the building (artefact storage area). The demolition works along Erskine Street and Inkerman Street, Birmingham mobilised on the 04/05/2020, and demolition works commenced on the 11/05/2020. Demolition works were completed on the 12/06/2020 and the site was demobilised.
- 1.1.5 An additional two (2) dust monitors (Aeroqual Dust Sentry Monitors) are installed for the current phase of work at Curzon Street Station. The remediation works are currently underway at this site and continued through the month of June 2020.
- 1.1.6 Dust monitoring locations and results for June 2020 are presented in Appendix B, Table 1 together with line charts for June 2020 from each dust monitor presented in Figures 2 to 5. All continuous dust monitoring is undertaken using indicative monitors. Despite being Environment Agency (MCERTS) certified, indicative monitors carry a higher level of uncertainty than reference monitors, and therefore cannot be strictly compared with Air Quality Standards for human health and the environment. The purpose of the monitoring undertaken is to ensure the effectiveness of the on-site mitigation.
- 1.1.7 The trigger level for PM₁₀ concentrations of 190 µg/m³, over a 1-hour period, in accordance with the updated guidance document '*Guidance on Monitoring in the Vicinity of Demolition and Construction Sites – (October 2018)*' has been applied.
- 1.1.8 There were no (0) dust trigger alerts recorded during the monitoring period (June 2020).

1.1.9 Data capture for monitor #530 was below 90% for the month of June 2020. This was due to power supply issues at this monitor and as a result of the recent road closure at Park Street, and the associated disconnection of power. Works to resolve this issue are currently underway and it is expected that power supply will be resume during July 2020.

1.1.10 There were no (0) complaints related to dust or air quality received during the reporting period (June 2020).

Appendix A – Worksite and Dust Monitoring Locations

Figure 1: Birmingham City Council Worksites and monitoring locations during June 2020.

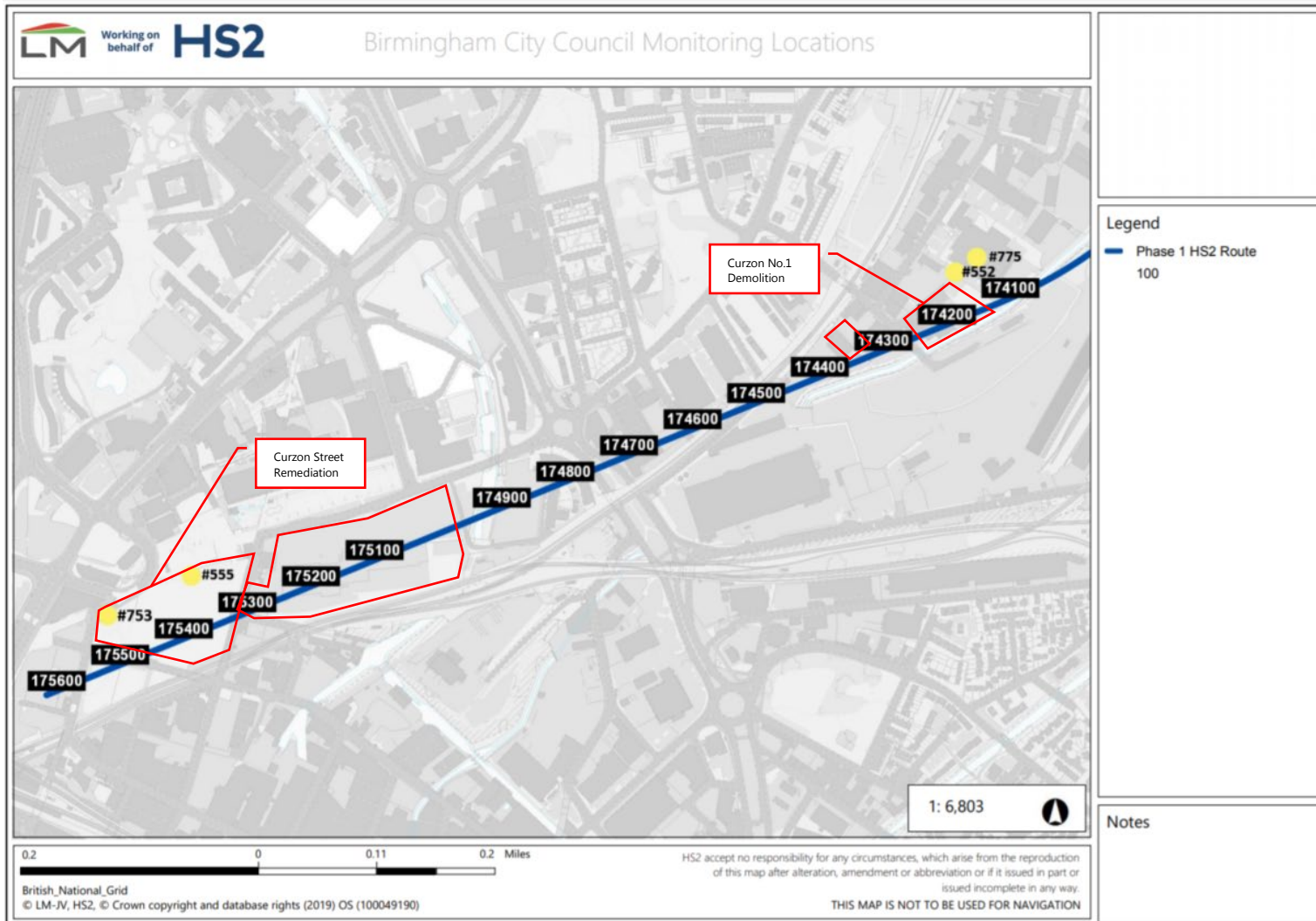

Appendix B – Dust Monitoring Results

Table 1: Dust monitoring locations and June 2020 Results

Monitoring site ID	Coordinates (X,Y)	Location description	Dust risk rating for site	Monitoring site active during period	Change to site since previous period report	Mean 1-hour PM ₁₀ concentration (µg/m ³)	Minimum 1-hour PM ₁₀ concentration (µg/m ³)	Maximum 1-hour PM ₁₀ concentration (µg/m ³)	Number of 1-hour periods exceeding trigger level of 190 µg/m ³	Data capture rate (%)
Dust #552 (old #82)	408811, 287485	Monitor outside the building	High	N/A	N/A	10.7	0	40.7	0	100
Dust #775 (old #85)	408841, 287529	Monitor secured inside the building	High	N/A	N/A	8.3	6.9	11.8	0	100
Dust #530 (old #555)	407702, 287079	Curzon Street Station HS2 Site	High	N/A	N/A	4.8	0	8	0	35
Dust #753	407619, 287006	Curzon Street Station HS2 Site	High	N/A	N/A	4.2	0	37.7	0	100

Figure 2: Construction dust hourly mean indicative PM₁₀ concentration for Dust #552 (June 2020)

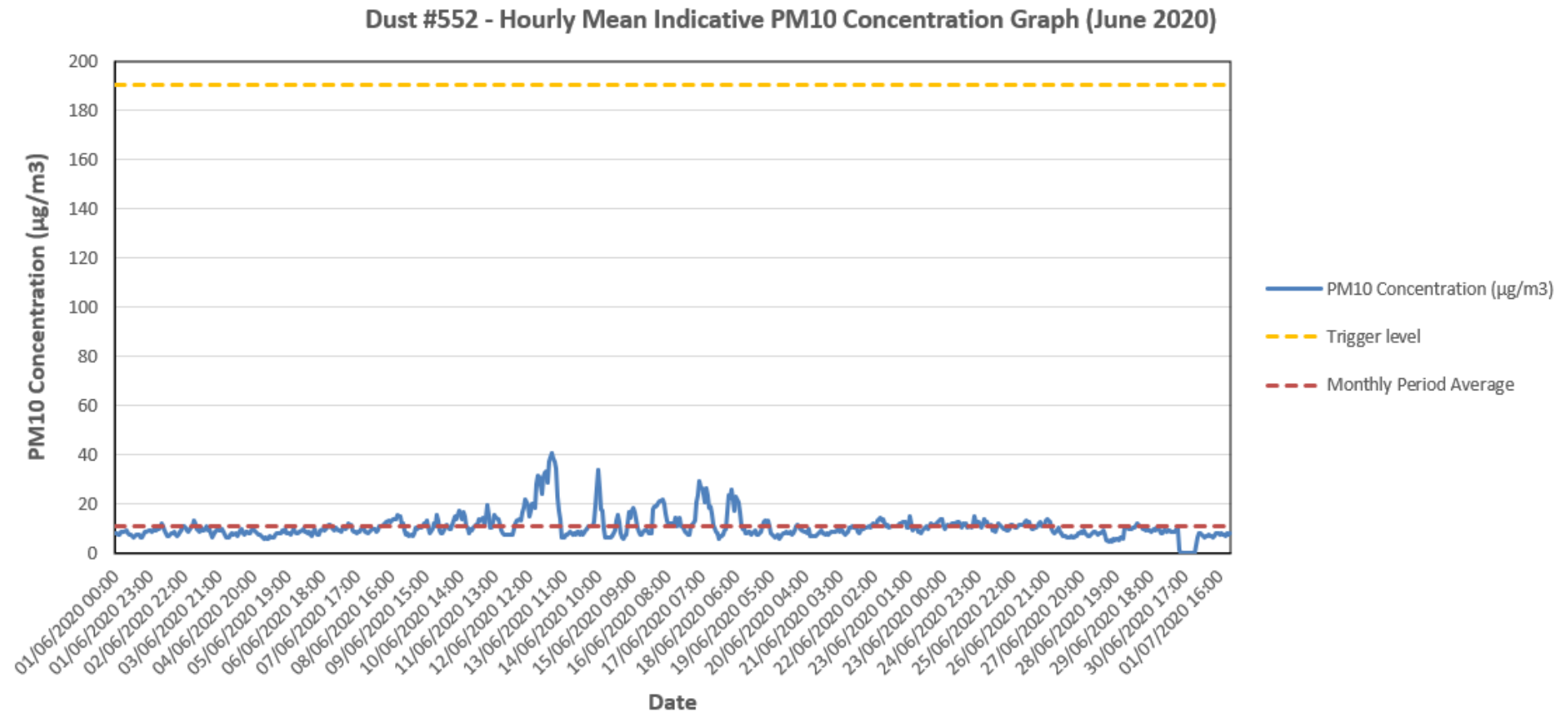

Figure 3: Construction dust hourly mean indicative PM₁₀ concentration for Dust #775 (June 2020)

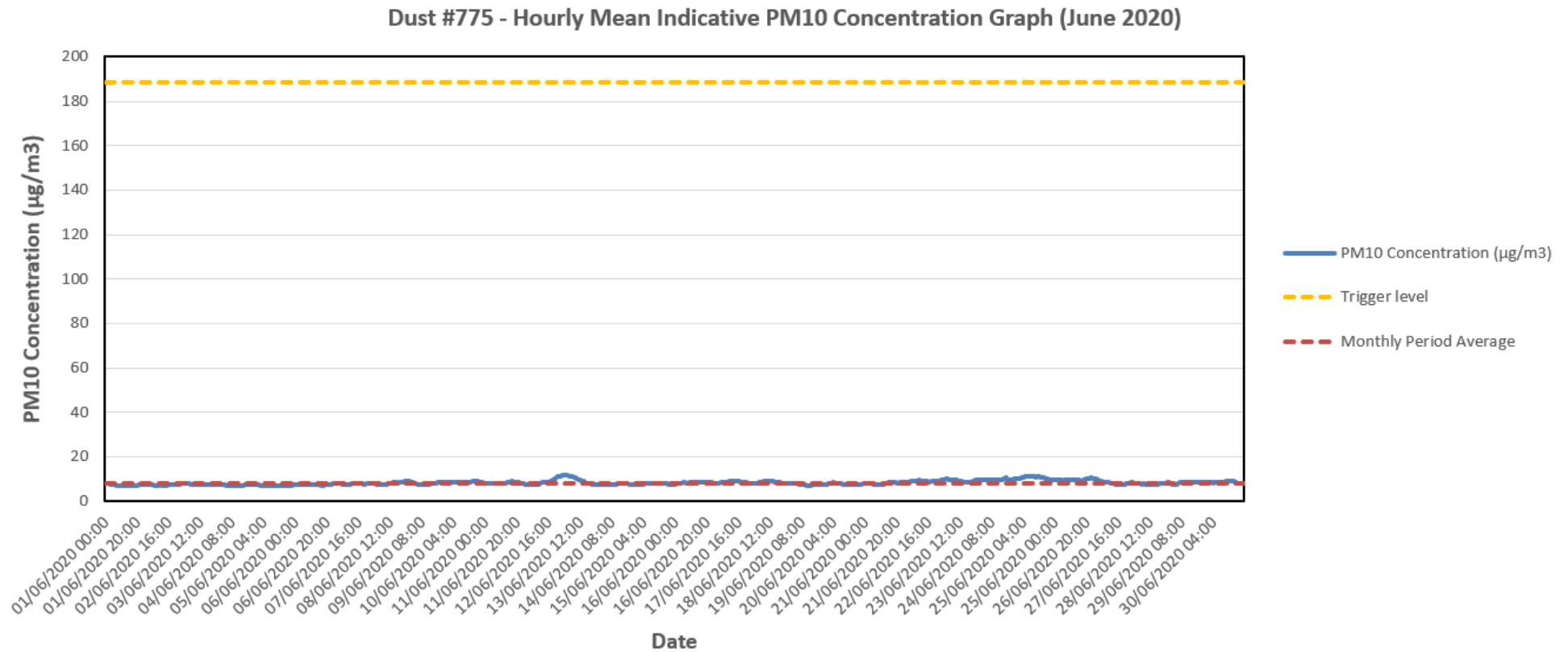

Figure 4: Construction dust hourly mean indicative PM₁₀ concentration for Dust #530 (old #555) (June 2020)

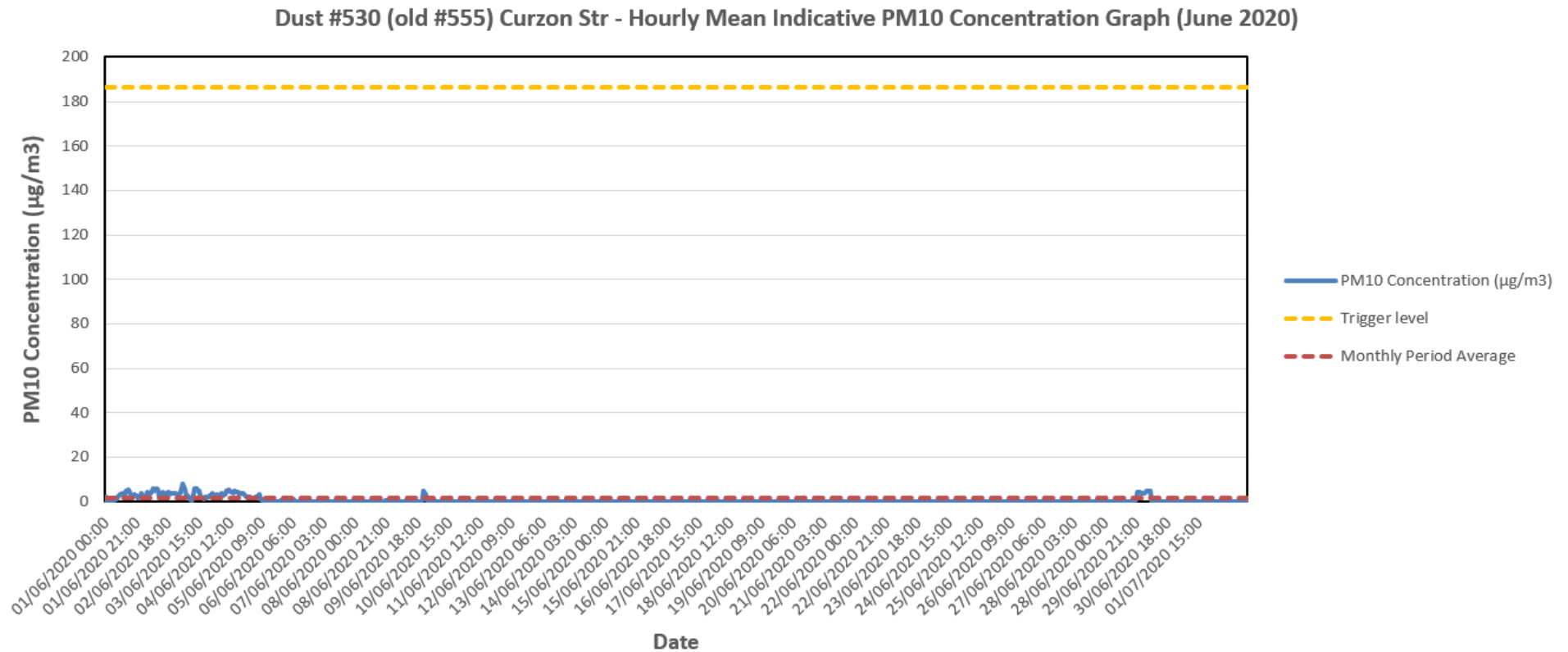

Figure 5: Construction dust hourly mean indicative PM₁₀ concentration for Dust #753 (June 2020)

