

Permit with introductory note

The Environmental Permitting (England & Wales) Regulations 2016

Geminor UK Limited

Geminor UK
St Mark's Street
Hull
HU8 7EB

Permit number

EPR/GP3303PN

Geminor UK

Permit number EPR/GP3303PN

Introductory note

This introductory note does not form a part of the permit

The main features of the permit are as follows.

The facility will primarily be accepting dry mixed municipal waste to produce Refuse Derived Fuel (RDF) for onward transfer to the nearby Energy from Waste Facility (EA Ref: EPR/NP3837NV) for incineration

The listed activity for the RDF plant is:

Section 5.4, Part A (1) (a) (ii) – Disposal of non-hazardous waste with a capacity exceeding 50 tonnes per day (or 100 tonnes per day if the only waste treatment activity is anaerobic digestion) involving physico-chemical treatment and pre-treatment of waste for incineration or co-incineration.

There is an associated activated (DAA):

- Temporary storage of non-hazardous waste.

The site will also operate a Waste Material Recycling Facility (MRF) for household, construction and industrial waste destined for recovery at other sites.

The main activities will comprise the storage and physical treatment of waste by sorting, separation, screening shredding and baling (and wrapping) for further recovery or disposal. All operations take place inside a building

The facility has impermeable surfacing throughout the site, enclosed by kerbing surrounding the entire site. All runoff collected within this fully contained area will drain to a central point in the yard, where via underground pipework, it will flow to an interceptor, before transferring to a surface water flow control box (to regulate the release of surface water to sewer). Any clean down water from the waste reception building, will be contained and will not enter the surface water drainage system in the yard area. A penstock isolation valve will be installed at the release point to sewer, which will be closed by site operatives if required.

The facility has a maximum waste throughput capacity of 199,800 tonnes non-hazardous per year. There are no point source emissions to air or land from the facility.

The site is situated approximately 1.5 km north east of Hull city centre within a predominately commercial area. The site is bounded by St Mark Street to the south which links into the A1165 to the west. The National Grid Reference (NGR) for the Site is TA 10546 29719.

There are a number of sensitive ecological receptors close to the installation, with two Special Areas of Conservation (SAC), one Special Protection Area (SPA) and a RAMSAR sites within 10km, and one Site of Special Scientific Interest (SSSI) within 2km.

The status log of the permit sets out the permitting history, including any changes to the permit reference number.

Status log of the permit		
Description	Date	Comments
Application EPR/GP3303PN/A001	Duly made 12/12/2019	Application for Material Recycling Facility.
Additional information received	06/05/2020	Amended Fire Prevention Plan Version 2.
Additional information received	11/06/2020	Amended site plan
Permit determined EPR/GP3303PN (PAS Billing ref. GP3303PN).	15/06/20	Permit issued

End of introductory note

Permit

The Environmental Permitting (England and Wales) Regulations 2016

Permit number

EPR/GP3303PN

The Environment Agency hereby authorises, under regulation 13 of the Environmental Permitting (England and Wales) Regulations 2016

Geminor UK Limited ("the operator"),

whose registered office is

**David Singh , Med IC3 Keele University Science Park
Keele
Newcastle
Staffordshire
ST5 5NP**

Company registration number 08155115

to operate an installation at

**Geminor UK
St Mark's Street
Hull
HU8 7EB**

to the extent authorised by and subject to the conditions of this permit.

Name	Date
Anne Lloyd	15/06/2020

Authorised on behalf of the Environment Agency

Conditions

1 Management

1.1 General management

- 1.1.1 The operator shall manage and operate the activities:
- (a) in accordance with a written management system that identifies and minimises risks of pollution, including those arising from operations, maintenance, accidents, incidents, non-conformances, closure and those drawn to the attention of the operator as a result of complaints; and
 - (b) using sufficient competent persons and resources.
- 1.1.2 Records demonstrating compliance with condition 1.1.1 shall be maintained.
- 1.1.3 Any person having duties that are or may be affected by the matters set out in this permit shall have convenient access to a copy of it kept at or near the place where those duties are carried out.
- 1.1.4 The operator shall comply with the requirements of an approved competence scheme.

1.2 Energy efficiency

- 1.2.1 For the following activities referenced in schedule 1, table S1.1 (AR1 and AR2) The operator shall:
- (a) take appropriate measures to ensure that energy is used efficiently in the activities;
 - (b) review and record at least every four years whether there are suitable opportunities to improve the energy efficiency of the activities; and
 - (c) take any further appropriate measures identified by a review.

1.3 Efficient use of raw materials

- 1.3.1 For the following activities referenced in schedule 1, table S1.1 (AR1 and AR2) The operator shall:
- (a) take appropriate measures to ensure that raw materials and water are used efficiently in the activities;
 - (b) maintain records of raw materials and water used in the activities;
 - (c) review and record at least every four years whether there are suitable alternative materials that could reduce environmental impact or opportunities to improve the efficiency of raw material and water use; and
 - (d) take any further appropriate measures identified by a review.

1.4 Avoidance, recovery and disposal of wastes produced by the activities

- 1.4.1 The operator shall take appropriate measures to ensure that:
- (a) the waste hierarchy referred to in Article 4 of the Waste Framework Directive is applied to the generation of waste by the activities; and
 - (b) any waste generated by the activities is treated in accordance with the waste hierarchy referred to in Article 4 of the Waste Framework Directive; and
 - (c) where disposal is necessary, this is undertaken in a manner which minimises its impact on the environment.

- 1.4.2 The operator shall review and record at least every four years whether changes to those measures should be made and take any further appropriate measures identified by a review.

2 Operations

2.1 Permitted activities

- 2.1.1 The operator is only authorised to carry out the activities specified in schedule 1 table S1.1 (the “activities”).
- 2.1.2 For the following activities referenced in schedule 1, table S1.1. Waste authorised by this permit shall be clearly distinguished from any other waste on the site.

2.2 The site

- 2.2.1 The activities shall not extend beyond the site, being the land shown edged in green on the site plan at schedule 7 to this permit.

2.3 Operating techniques

- 2.3.1 The activities shall, subject to the conditions of this permit, be operated using the techniques and in the manner described in the documentation specified in schedule 1, table S1.2, unless otherwise agreed in writing by the Environment Agency.
- 2.3.2 If notified by the Environment Agency that the activities are giving rise to pollution, the operator shall submit to the Environment Agency for approval within the period specified, a revision of any plan or other documentation (“plan”) specified in schedule 1, table S1.2 or otherwise required under this permit which identifies and minimises the risks of pollution relevant to that plan , and shall implement the approved revised plan in place of the original from the date of approval, unless otherwise agreed in writing by the Environment Agency.
- 2.3.3 Any raw materials or fuels listed in schedule 2 table S2.1 shall conform to the specifications set out in that table.
- 2.3.4 Waste shall only be accepted if:
- (a) it is of a type and quantity listed in schedule 2 table S2.2 and
 - (b) it conforms to the description in the documentation supplied by the producer and holder.
- 2.3.5 The operator shall ensure that where waste produced by the activities is sent to a relevant waste operation, that operation is provided with the following information, prior to the receipt of the waste:
- (a) the nature of the process producing the waste;
 - (b) the composition of the waste;
 - (c) the handling requirements of the waste;
 - (d) the hazardous property associated with the waste, if applicable; and
 - (e) the waste code of the waste.
- 2.3.6 The operator shall ensure that where waste produced by the activities is sent to a landfill site, it meets the waste acceptance criteria for that landfill.

3 Emissions and monitoring

3.1 Emissions to water, air or land

- 3.1.1 There shall be no point source emissions to water, air or land except from the sources and emission points listed in schedule 3 table S3.1.
- 3.1.2 The limits given in schedule 3 shall not be exceeded.

3.2 Emissions of substances not controlled by emission limits

- 3.2.1 Emissions of substances not controlled by emission limits (excluding odour) shall not cause pollution. The operator shall not be taken to have breached this condition if appropriate measures, including, but not limited to, those specified in any approved emissions management plan, have been taken to prevent or where that is not practicable, to minimise, those emissions.
- 3.2.2 The operator shall:
- (a) if notified by the Environment Agency that the activities are giving rise to pollution, submit to the Environment Agency for approval within the period specified, an emissions management plan which identifies and minimises the risks of pollution from emissions of substances not controlled by emission limits;
 - (b) implement the approved emissions management plan, from the date of approval, unless otherwise agreed in writing by the Environment Agency.

3.3 Odour

- 3.3.1 Emissions from the activities shall be free from odour at levels likely to cause pollution outside the site, as perceived by an authorised officer of the Environment Agency, unless the operator has used appropriate measures, including, but not limited to, those specified in any approved odour management plan, to prevent or where that is not practicable to minimise the odour.

3.4 Noise and vibration

- 3.4.1 Emissions from the activities shall be free from noise and vibration at levels likely to cause pollution outside the site, as perceived by an authorised officer of the Environment Agency, unless the operator has used appropriate measures, including, but not limited to, those specified in any approved noise and vibration management plan to prevent or where that is not practicable to minimise the noise and vibration.

3.5 Monitoring

- 3.5.1 The operator shall, unless otherwise agreed in writing by the Environment Agency, undertake the monitoring specified in the following tables in schedule 3 to this permit:
- (a) point source emissions specified in tables S3.1,
- 3.5.2 The operator shall maintain records of all monitoring required by this permit including records of the taking and analysis of samples, instrument measurements (periodic and continual), calibrations, examinations, tests and surveys and any assessment or evaluation made on the basis of such data.
- 3.5.3 Permanent means of access shall be provided to enable sampling/monitoring to be carried out in relation to the emission points specified in schedule 3 tables S3.1, unless otherwise agreed in writing by the Environment Agency.

3.6 Pests

3.6.1 The activities shall not give rise to the presence of pests which are likely to cause pollution, hazard or annoyance outside the boundary of the site. The operator shall not be taken to have breached this condition if appropriate measures, including, but not limited to, those specified in any approved pests management plan, have been taken to prevent or where that is not practicable, to minimise the presence of pests on the site.

3.6.2 The operator shall:

- (a) if notified by the Environment Agency, submit to the Environment Agency for approval within the period specified, a pests management plan which identifies and minimises risks of pollution from pests;
- (b) implement the pests management plan, from the date of approval, unless otherwise agreed in writing by the Environment Agency.

3.7 Fire prevention

3.7.1 The operator shall take all appropriate measures to prevent fires on site and minimise the risk of pollution from them including, but not limited to, those specified in any approved fire prevention plan.

4 Information

4.1 Records

4.1.1 All records required to be made by this permit shall:

- (a) be legible;
- (b) be made as soon as reasonably practicable;
- (c) if amended, be amended in such a way that the original and any subsequent amendments remain legible, or are capable of retrieval; and
- (d) be retained, unless otherwise agreed in writing by the Environment Agency, for at least 6 years from the date when the records were made, or in the case of the following records until permit surrender:
 - (i) off-site environmental effects; and
 - (ii) matters which affect the condition of the land and groundwater.

4.1.2 The operator shall keep on site all records, plans and the management system required to be maintained by this permit, unless otherwise agreed in writing by the Environment Agency.

4.2 Reporting

4.2.1 The operator shall send all reports and notifications required by the permit to the Environment Agency using the contact details supplied in writing by the Environment Agency.

4.2.2 For the following activities referenced in schedule 1, table S1.1 (AR1 to AR3) A report or reports on the performance of the activities over the previous year shall be submitted to the Environment Agency by 31 January (or other date agreed in writing by the Environment Agency) each year. The report(s) shall include as a minimum:

- (a) a review of the results of the monitoring and assessment carried out in accordance with the permit including an interpretive review of that data;

- (b) the annual production /treatment data set out in schedule 4 table S4.2; and
- (c) the performance parameters set out in schedule 4 table S4.3 using the forms specified in table S4.4 of that schedule.

4.2.3 Within 28 days of the end of the reporting period the operator shall, unless otherwise agreed in writing by the Environment Agency, submit reports of the monitoring and assessment carried out in accordance with the conditions of this permit, as follows:

- (a) in respect of the parameters and emission points specified in schedule 4 table S4.1;
- (b) for the reporting periods specified in schedule 4 table S4.1 and using the forms specified in schedule 4 table S4.4 ; and
- (c) giving the information from such results and assessments as may be required by the forms specified in those tables.

4.2.4 The operator shall, unless notice under this condition has been served within the preceding four years, submit to the Environment Agency, within six months of receipt of a written notice, a report assessing whether there are other appropriate measures that could be taken to prevent, or where that is not practicable, to minimise pollution.

4.2.5 Within 1 month of the end of each quarter, the operator shall submit to the Environment Agency using the form made available for the purpose, the information specified on the form relating to the site and the waste accepted and removed from it during the previous quarter.

4.3 Notifications

4.3.1 In the event:

- (a) that the operation of the activities gives rise to an incident or accident which significantly affects or may significantly affect the environment, the operator must immediately—
 - (i) inform the Environment Agency,
 - (ii) take the measures necessary to limit the environmental consequences of such an incident or accident, and
 - (iii) take the measures necessary to prevent further possible incidents or accidents;
- (b) of a breach of any permit condition the operator must immediately—
 - (i) inform the Environment Agency, and
 - (ii) take the measures necessary to ensure that compliance is restored within the shortest possible time;
- (c) of a breach of permit condition which poses an immediate danger to human health or threatens to cause an immediate significant adverse effect on the environment, the operator must immediately suspend the operation of the activities or the relevant part of it until compliance with the permit conditions has been restored.

4.3.2 Any information provided under condition 4.3.1 (a)(i), or 4.3.1 (b)(i) where the information relates to the breach of a limit specified in the permit,] shall be confirmed by sending the information listed in schedule 5 to this permit within the time period specified in that schedule.

4.3.3 The Environment Agency shall be notified within 14 days of the occurrence of the following matters, except where such disclosure is prohibited by Stock Exchange rules:

Where the operator is a registered company:

- (a) any change in the operator's trading name, registered name or registered office address; and
- (b) any steps taken with a view to the operator going into administration, entering into a company voluntary arrangement or being wound up.

Where the operator is a corporate body other than a registered company:

- (a) any change in the operator's name or address; and
- (b) any steps taken with a view to the dissolution of the operator.

In any other case:

- (a) the death of any of the named operators (where the operator consists of more than one named individual);
- (b) any change in the operator's name(s) or address(es); and
- (c) any steps taken with a view to the operator, or any one of them, going into bankruptcy, entering into a composition or arrangement with creditors, or, in the case of them being in a partnership, dissolving the partnership.

4.3.4 Where the operator proposes to make a change in the nature or functioning, or an extension of the activities, which may have consequences for the environment and the change is not otherwise the subject of an application for approval under the Regulations or this permit:

- (a) the Environment Agency shall be notified at least 14 days before making the change; and
- (b) the notification shall contain a description of the proposed change in operation.

4.3.5 The Environment Agency shall be given at least 14 days notice before implementation of any part of the site closure plan.

4.4 Interpretation

4.4.1 In this permit the expressions listed in schedule 6 shall have the meaning given in that schedule.

4.4.2 In this permit references to reports and notifications mean written reports and notifications, except where reference is made to notification being made "immediately" or "without delay" in which case it may be provided by telephone.

Schedule 1 – Operations

Table S1.1 activities			
Activity reference	Activity listed in Schedule 1 of the EP Regulations	Description of specified activity and WFD Annex I and II operations	Limits of specified activity and waste types
AR1	S5.4 Part A(1)(a) (ii)	D9 Physical / physico-chemical treatment of waste prior to any other disposal operation. D14: Repackaging prior to submission to any of the operations numbered D1 to D12. D15: Storage pending any of the operations numbered D 1 to D 14 (excluding temporary storage, pending collection, on the site where the waste is produced.	Pre-treatment of waste to produce Refused Derived Fuel (RDF). Treatment operations shall be limited to physical and mechanical treatment consisting of sorting, screening, shredding and separating baling and wrapping, Non-hazardous waste types as specified in Schedule 2 table S2.2.
Directly Associated Activity			
AR2	Storage of non-hazardous waste prior to treatment	D14: Repackaging prior to submission to any of the operations numbered D1 to D12. D15: Storage pending any of the operations numbered D 1 to D 14 (excluding temporary storage, pending collection, on the site where the waste is produced.	Storage shall be on an impermeable surface with sealed draining
Activity reference	Description of activities for waste operations	Limits of activities	
AR3	R13: Storage of waste pending any of the operations numbered R1 to R12 (excluding temporary storage, pending collection, on the site where it is produced) R3: Recycling/reclamation of organic substances which are not used as solvents R4: Recycling/reclamation of metals and metal compounds R5: Recycling/reclamation of other inorganic compounds	Treatment and storage of non-hazardous waste - operations shall be limited to: Physical treatment including sorting, separating, screening, baling and shredding and for the purpose of recovery. Treatment shall be carried out in an enclosed building and on an impermeable surface with sealed drainage system. Waste types as specified in Table 2.2	

Table S1.2 Operating techniques		
Description	Parts	Date Received
Application	Sections 1.2, 1.4, 1.6 and 1.8 of the application document(s) provided in response to section 3a – technical standards , Part B3 of the application form	Duly Made 12/12/2019
Application	Best Available Operating Techniques document	12/12/2019
Application	Odour management plan reference 419.08768.00001 August 2019	12/12/2019
Application	Noise and vibration management plan	12/12/2019
Application	Pest Management Plan Reference 419.09678.00001 version 1	12/12/2019
Additional Information	Fire Prevention Plan Revised- version 2	06/05/2020

Schedule 2 – Waste types, raw materials and fuels

Table S2.1 Raw materials and fuels	
Raw materials and fuel description	Specification
-	-

Table S2.2 Permitted waste types and quantities for the RDF Facility and the Materials Recycling Facility	
Maximum quantity	150,000 tonnes per year
Waste code	Description
19	Wastes from waste management facilities, off-site waste water treatment plants and the preparation of water intended for human consumption and water for industrial use
19 12	wastes from the mechanical treatment of waste (for example sorting, crushing, compacting, pelletising) not otherwise specified
19 12 07	wood other than that mentioned in 19 12 06
19 12 10	combustible waste (refuse derived fuel)
19 12 12	other wastes (including mixtures of materials) from mechanical treatment of wastes other than those mentioned in 19 12 11
20	Municipal wastes (household waste and similar commercial, industrial and institutional wastes) including separately collected fractions
20 01	separately collected fractions (except 15 01)
20 01 01	paper and cardboard
20 01 02	glass
20 01 38	wood other than that mentioned in 20 01 37
20 01 39	plastics
20 01 40	metals
20 02	garden and park wastes (including cemetery waste)
20 02 01	biodegradable waste
20 02 02	soil and stones
20 02 03	other non-biodegradable wastes
20 03	other municipal wastes
20 03 01	mixed municipal waste
20 03 03	street-cleaning residues
20 03 07	bulky waste

Schedule 3 – Emissions and monitoring

Emission point ref. & location	Source	Parameter	Limit (incl. Unit)	Reference period	Monitoring frequency	Monitoring standard or method
Surface water flow control box to sewage Treatment Works shown on site plan in schedule 7	Uncontaminated surface water from roofs and gutters	None	None	-	-	-

Schedule 4 – Reporting

Parameters, for which reports shall be made, in accordance with conditions of this permit, are listed below.

Parameter	Units
Non-hazardous waste treated for RDF production	tonnes
RDF Produced	tonnes

Parameter	Frequency of assessment	Units
Water usage	Annually	tonnes
Energy usage	Annually	MWh

Media/parameter	Reporting format	Date of form
Water usage	Form water usage 1 or other form as agreed in writing by the Environment Agency	DD/MM/YY
Energy usage	Form energy 1 or other form as agreed in writing by the Environment Agency	DD/MM/YY
Waste returns	E-Waste Return Form or other form as agreed in writing by the Environment Agency	
Other performance indicators	Form performance 1 or other form as agreed in writing by the Environment Agency	DD/MM/YY

Schedule 5 – Notification

These pages outline the information that the operator must provide.

Units of measurement used in information supplied under Part A and B requirements shall be appropriate to the circumstances of the emission. Where appropriate, a comparison should be made of actual emissions and authorised emission limits.

If any information is considered commercially confidential, it should be separated from non-confidential information, supplied on a separate sheet and accompanied by an application for commercial confidentiality under the provisions of the EP Regulations.

Part A

Permit Number	
Name of operator	
Location of Facility	
Time and date of the detection	

(a) Notification requirements for any malfunction, breakdown or failure of equipment or techniques, accident, or emission of a substance not controlled by an emission limit which has caused, is causing or may cause significant pollution	
To be notified within 24 hours of detection	
Date and time of the event	
Reference or description of the location of the event	
Description of where any release into the environment took place	
Substances(s) potentially released	
Best estimate of the quantity or rate of release of substances	
Measures taken, or intended to be taken, to stop any emission	
Description of the failure or accident.	

(b) Notification requirements for the breach of a limit	
To be notified within 24 hours of detection unless otherwise specified below	
Emission point reference/ source	
Parameter(s)	
Limit	
Measured value and uncertainty	
Date and time of monitoring	

(b) Notification requirements for the breach of a limit	
To be notified within 24 hours of detection unless otherwise specified below	
Measures taken, or intended to be taken, to stop the emission	

Time periods for notification following detection of a breach of a limit	
Parameter	Notification period

(c) Notification requirements for the detection of any significant adverse environmental effect	
To be notified within 24 hours of detection	
Description of where the effect on the environment was detected	
Substances(s) detected	
Concentrations of substances detected	
Date of monitoring/sampling	

Part B – to be submitted as soon as practicable

Any more accurate information on the matters for notification under Part A.	
Measures taken, or intended to be taken, to prevent a recurrence of the incident	
Measures taken, or intended to be taken, to rectify, limit or prevent any pollution of the environment which has been or may be caused by the emission	
The dates of any unauthorised emissions from the facility in the preceding 24 months.	

Name*	
Post	
Signature	
Date	

* authorised to sign on behalf of the operator

Schedule 6 – Interpretation

“accident” means an accident that may result in pollution.

“application” means the application for this permit, together with any additional information supplied by the operator as part of the application and any response to a notice served under Schedule 5 to the EP Regulations.

“authorised officer” means any person authorised by the Environment Agency under section 108(1) of The Environment Act 1995 to exercise, in accordance with the terms of any such authorisation, any power specified in section 108(4) of that Act.

“building” means a construction that has the objective of providing sheltering cover and minimising emissions of noise, particulate matter, odour and litter.

“disposal”. Means any of the operations provided for in Annex I to Directive 2008/98/EC of the European Parliament and of the Council on waste.

“emissions to land” includes emissions to groundwater.

“EP Regulations” means The Environmental Permitting (England and Wales) Regulations SI 2016 No.1154 and words and expressions used in this permit which are also used in the Regulations have the same meanings as in those Regulations.

“emissions of substances not controlled by emission limits” means emissions of substances to air, water or land from the activities, either from the emission points specified in schedule 3 or from other localised or diffuse sources, which are not controlled by an emission limit.

“groundwater” means all water, which is below the surface of the ground in the saturation zone and in direct contact with the ground or subsoil.

“Hazardous property” has the meaning in Annex III of the Waste Framework Directive.

“Hazardous waste” has the meaning given in the Hazardous Waste (England and Wales) Regulations 2005 (as amended).

“Industrial Emissions Directive” means DIRECTIVE 2010/75/EU OF THE EUROPEAN PARLIAMENT AND OF THE COUNCIL of 24 November 2010 on industrial emissions

“List of Wastes” means the list of wastes established by Commission Decision 2000/532/EC replacing Decision 94/3/EC establishing a list of wastes pursuant to Article 1(a) of Council Directive 75/442/EEC on waste and Council Decision 94/904/EC establishing a list of hazardous waste pursuant to Article 1(4) of Council Directive 91/689/EEC on hazardous waste, as amended from time to time.

Pests” means Birds, Vermin and Insects.

“quarter” means a calendar year quarter commencing on 1 January, 1 April, 1 July or 1 October.

“recovery” means any of the operations provided for in Annex II to Directive 2008/98/EC of the European Parliament and of the Council on waste.

“Waste code” means the six digit code referable to a type of waste in accordance with the List of Wastes and in relation to hazardous waste, includes the asterisk.

“Waste Framework Directive” or “WFD” means Waste Framework Directive 2008/98/EC of the European Parliament and of the Council on waste

Where a minimum limit is set for any emission parameter, for example pH, reference to exceeding the limit shall mean that the parameter shall not be less than that limit.

Unless otherwise stated, any references in this permit to concentrations of substances in emissions into air means:

- in relation to emissions from combustion processes, the concentration in dry air at a temperature of 273K, at a pressure of 101.3 kPa and with an oxygen content of 3% dry for liquid and gaseous fuels 6% dry for solid fuels; and/or
- in relation to emissions from non-combustion sources, the concentration at a temperature of 273K and at a pressure of 101.3 kPa, with no correction for water vapour content.

“year” means calendar year ending 31 December.:

‘hazardous substance’ means a substance classified as hazardous as a consequence of fulfilling the criteria laid down in parts 2 to 5 of Annex I to Regulation (EC) No 1272/2008

‘heavy metal’ means any compound of antimony, arsenic, cadmium, chromium (VI), copper, lead, mercury, nickel, selenium, tellurium, thallium and tin, as well as these materials in metallic form, as far as these are classified as hazardous substances

‘PCBs’ means

- polychlorinated biphenyls
- polychlorinated terphenyls
- monomethyl-tetrachlorodiphenyl methane, Monomethyl-dichloro-diphenyl methane, Monomethyldibromo-diphenyl methane
- any mixture containing any of the above mentioned substances in a total of more than 0,005 %by weight

‘transition metals’ means any of the following metals: any compound of scandium, vanadium, manganese, cobalt, copper, yttrium, niobium, hafnium, tungsten, titanium, chromium, iron, nickel, zinc, zirconium, molybdenum and tantalum, as well as these materials in metallic form, as far as these are classified as hazardous substances

‘stabilisation’ means processes which change the hazardousness of the constituents in the waste and transform hazardous waste into non-hazardous waste

‘solidification’ means processes which only change the physical state of the waste by using additives without changing the chemical properties of the waste

‘partly stabilised wastes’ means wastes containing, after the stabilisation process, hazardous constituents which have not been changed completely into non-hazardous constituents and could be released into the environment in the short, middle or long term

Schedule 7 – Site plan

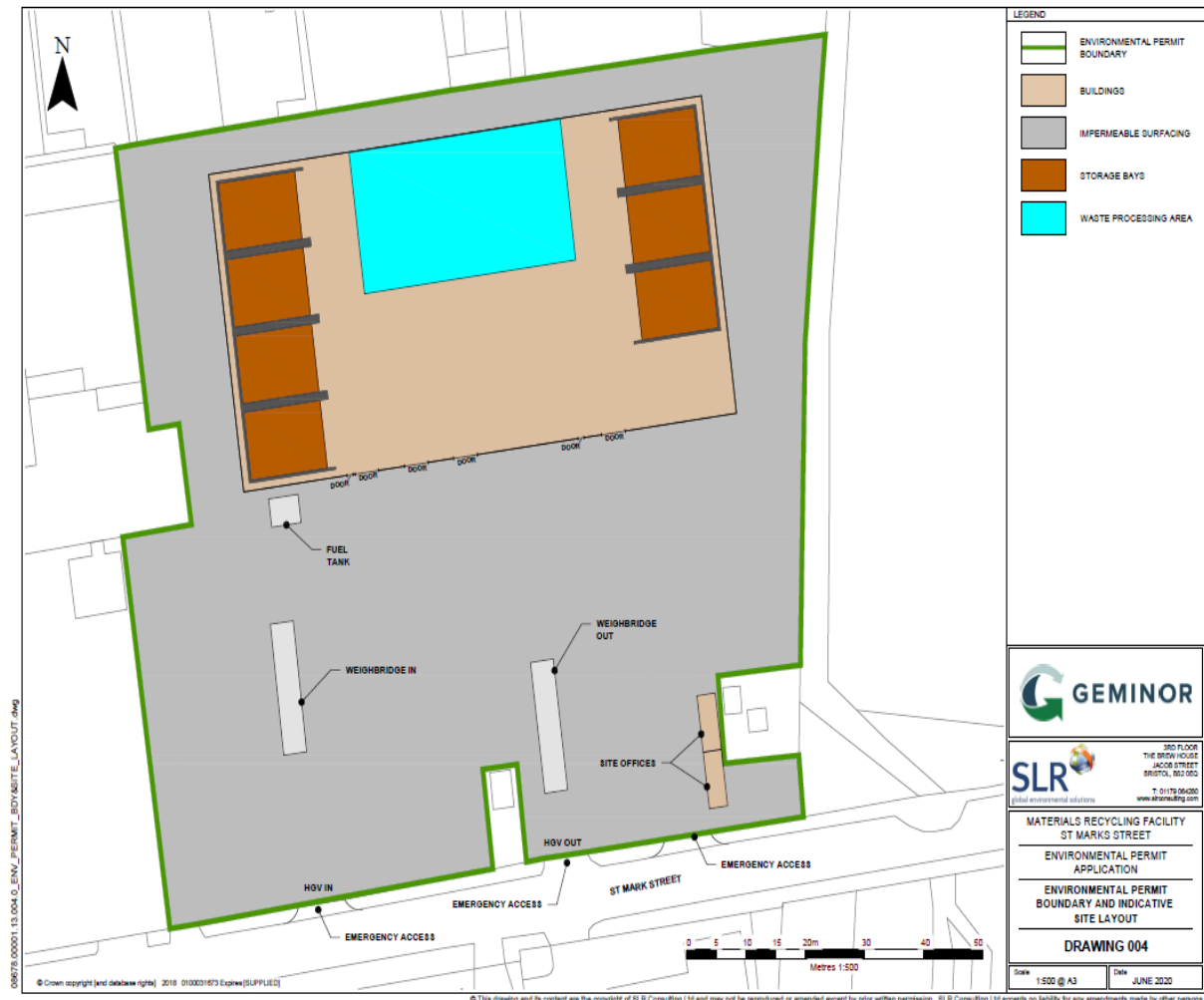

END OF PERMIT