

Drawing No.
T 112

© CROWN COPYRIGHT

- NOTES: 1. The grid does not form part of any sign to which the symbol is applied.
2. Dimensions are given in grid divisions (normally equal to 1/4 x-height).

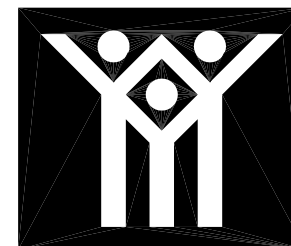
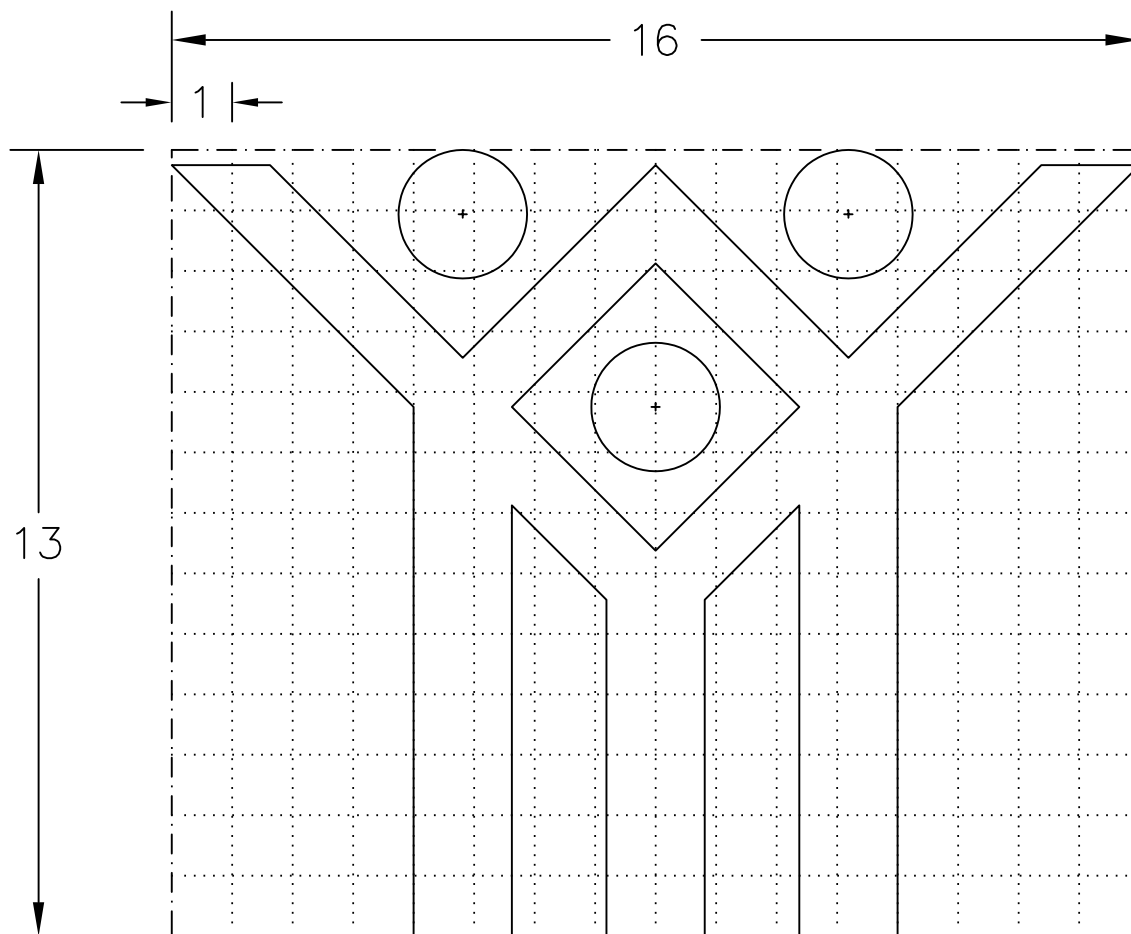

T112

Before using this drawing, confirm that it has not been superseded.

Department for
Transport

Title: Tourist Attraction
Symbol
COUNTRY PARK

Issue: Date:
A: 1.7.94
B: 17.7.03
C:

Drawn by: S.P.
Approved by: R.M.

Dimensions:
SEE
NOTE 2

Drawing No.
T 112