



# Notice of variation and consolidation with introductory note

## The Environmental Permitting (England & Wales) Regulations 2016

---

Moy Park Limited

Monksthorpe Poultry Farm & Ladywath Poultry Farm  
Monksthorpe  
Spilsby  
Lincolnshire  
PE23 5PP

### **Variation application number**

EPR/ZP3133FJ/V004

### **Permit number**

EPR/ZP3133FJ

# Monksthorpe Poultry Farm & Ladywath Poultry Farm

## Permit number EPR/ZP3133FJ

### Introductory note

#### **This introductory note does not form a part of the notice.**

Under the Environmental Permitting (England & Wales) Regulations 2016 (schedule 5, part 1, paragraph 19) a variation may comprise a consolidated permit reflecting the variations and a notice specifying the variations included in that consolidated permit.

Schedule 1 of the notice specifies the conditions that have been varied and schedule 2 comprises a consolidated permit which reflects the variations being made. All the conditions of the permit have been varied and are subject to the right of appeal.

#### This variation authorises the following changes.

- The addition of one two-tiered broiler house (known as House 4) at the Ladywath site. The new shed will be located within the existing installation boundary.
- The addition of 64,000 broiler chickens to be reared within shed 4 increasing the total capacity of the two farms to 609,000.
- The addition of one biomass boiler at Ladywath will be installed to heat the new House 4.
- There will be no change to the Monksthorpe site.

We have reviewed the new housing introduced with this permit variation for this installation against the BAT conclusions as defined in Intensive Farming BAT conclusion document dated 20/02/17. The permit conditions and schedules ensure the compliance of the new housing with this BAT conclusions document

#### The rest of the installation is unchanged and continues to be operated as follows.

Monksthorpe and Ladywath Farms are located approximately 500m apart and approximately 1km to the north east of the village of Great Steeping at TF 44449 65607 and TF 44378 65114 respectively.

The landscape in the area is comprised of open farmland, with isolated parcels of woodland, dwellings and farmsteads. Properties in the area include the village of Great Steeping, which has a small caravan site.

**Monksthorpe Farm** comprises 8 single storey houses with a capacity for 355,000 broilers. All houses have high speed ridge mounted extraction fans with side inlets. Fan outflows are not obstructed by caps, which aids dispersion. All houses at Monksthorpe are heated by biomass boilers, with gas as a backup. Dirty and wash out waters are directed to underground storage tanks..

**Ladywath Farm** at present includes 3 modern two tiered broiler houses (1, 2 & 3), having a ridge height of 8m and have a revised capacity for 254,000 broiler places. The additional broiler house 4 will also be ventilated by uncapped high speed side mounted fans and chimneys, which provide cross flow ventilation to both tiers, at a release height of 8.3m with an efflux velocity of 12m/s. The buildings have guttering for removal of roof water and there is either concreted or tarmac areas to the front of each house.

Ladywath, heat exchangers do not have their own vent and discharge via the chimney outlet. Consequently they have not been included as a separate emission point to air. The heating coils for the heat exchangers are to be heated via biomass boilers. No condensate is generated from the heat exchangers as the air entering the house is not recirculated into the unit.

Litter is not stored at the either farm. It is collected at the end of each crop and taken to a power station to produce energy. Records are kept of the quantities and the date of the transfer. The empty houses are then washed and disinfected ready for the next crop. Dirty / wash out waters are disposed via an approved third party and records kept, neither are spread to operator controlled land.

Uncontaminated roof and surface waters, from Monksthorpe farm, are directed to an attenuation pond to the south of the site, while that from Ladywath goes to an attenuation pond to the north of the Ladywath site.

The production cycle will be varied according to the requirements of customers but chicks will be brought onto the site from a hatchery at one day old and grown to finished weight. According to current customer requirements, birds are likely to be grown up to a maximum of 42 days of age (~ 2.2kg live-weight) with a proportion of the flock (possibly up to 50%) being 'thinned' at around 33 - 34 days (~ 1.7kg live-weight). The average turnaround time for house cleaning etc. is expected to be 5 - 8 days, and so there will be approximately 7 - 8 production cycles per year.

At the start of the cycle, litter will be delivered and spread on the floor to a depth of around 2cm. All houses will be pre-warmed to 31 - 33°C. As the birds grow, the house temperature is gradually reduced and ventilation increased until the heating is turned off. Ventilation rates are automatically controlled to ensure an optimal environment. A stand-by generator is in place on each site for use in the event of power failure.

All house include pan feeders and low-spillage / drip free nipple drinkers. These, together with good environmental control in the houses and limits on stocking density help to maintain good litter condition and hence reduce ammonia and odours. Water use in each house is monitored daily. The buildings incorporate double-glazed windows with shutters in the side walls allowing maximum use to be made of natural daylight. Natural light will be supplemented by the use of low energy, high frequency, dimmable fluorescent tube lighting systems.

Feed is delivered to the farms from a UFAS accredited mill and is stored on-site in enclosed silos, two silos per house. Each one will be protected from vehicle damage by being set back from the front of the house. Phase feeding principles are utilised with up to four diet regimes used over the birds growth cycle. The feed protein content is reduced to match nutritional needs as the birds get older.

Mortalities are regularly removed from all houses and their number recorded. The carcasses are held temporarily within sealed, covered, vermin-proof bins prior to collection for disposal in compliance with the Animal By-Products Regulations.

The schedules specify the changes made to the permit.

The status log of a permit sets out the permitting history, including any changes to the permit reference number.

<b>Status log of the permit</b>		
<b>Description</b>	<b>Date</b>	<b>Comments</b>
Application received EPR/ZP3133FJ/A001	Duly made 06/09/11	Application for poultry intensive farming permit
Additional information received	09/11/11	Confirmation of the fate of heat exchanger condensate
Additional information received	27/01/12	Detailed site layout plans received
Additional information received	05/03/12	Odour management plan resubmitted
Permit determined EPR/ZP3133FJ	06/03/12	Original permit issued to Moy Park Limited
Application EPR/ZP3133FJ/V002 (variation)	Duly made 17/06/13	Application to add eight biomass boilers to broiler sheds. Conditions added and amended to include the requirements of IED.
Variation determined EPR/ZP3133FJ/V002	05/07/13	Varied permit issued to Moy Park Limited
Application received EPR/ZP3133FJ/V003 (variation)	Duly made 09/01/14	Application to add six biomass boilers to broiler sheds and to amend the ventilation proposals for the sheds.
Additional information received	20/02/14	Email providing evidence to demonstrate that a fan speed of 12m/s is achievable.
Additional information received	11/03/14	Updated odour modelling report to account for a change in the location of the fan outlets.

<b>Status log of the permit</b>		
<b>Description</b>	<b>Date</b>	<b>Comments</b>
Variation determined EPR/ZP3133FJ/V003	18/03/14	Varied permit issued to Moy Park Limited
Application received EPR/ZP3133FJ/V004	Duly made 20/12/18	Application to add 64,000 broiler, an additional house (7/8), one additional biomass boiler and consolidated / update to modern conditions..
Additional information received	01/11/18	Confirmation of revised number of biomass boilers and proposed specification. Also revised bioaerosol / dust risk assessment.
Additional information received	20/12/18	Confirmation of ammonia emissions reduction plan for Ladywath Poultry Farm.
Additional information received	20/03/19	Revised Site Condition Report.
Additional information received	07/03/19	Revised drainage plan for House 4
Additional information received	10/06/19	Revised Noise Management Plan
Variation determined EPR/ZP3133FJ/V004 (Billing reference: VP3139JH)	16/07/19	Varied and consolidated permit issued in modern condition format to Moy Park Limited

End of introductory note

# Notice of variation and consolidation

## The Environmental Permitting (England and Wales) Regulations 2016

The Environment Agency in exercise of its powers under regulation 20 of the Environmental Permitting (England and Wales) Regulations 2016 varies and consolidates

### Permit number

**EPR/ZP3133FJ**

### Issued to

**Moy Park Limited** (“the operator”)

whose registered office is

**The Food Park  
39 Seago Industrial Estate  
Craigavon  
BT63 5QE**

company registration number **NI004842**

to operate an installation at

**Monksthorpe Poultry Farm & Ladywath Poultry Farm  
Monksthorpe  
Spilsby  
Lincolnshire  
PE23 5PP**

to the extent set out in the schedules.

The notice shall take effect from 16/07/2019

Name	Date
<b>David Griffiths</b>	<b>16/07/2019</b>

Authorised on behalf of the Environment Agency

## **Schedule 1**

All conditions have been varied by the consolidated permit EPR/ZP3133FJ as a result of the application made by the operator.

## **Schedule 2 – consolidated permit**

Consolidated permit issued as a separate document.

# Permit

## The Environmental Permitting (England and Wales) Regulations 2016

### Permit number

**EPR/ZP3133FJ**

This is the consolidated permit referred to in the variation and consolidation notice for application EPR/ZP3133FJ/V004 authorising,

**Moy Park Limited** (“the operator”),

whose registered office is

**The Food Park**

**39 Seagoe Industrial Estate**

**Craigavon**

**BT63 5QE**

company registration number **NI004842**

to operate an installation at

**Monksthorpe Poultry Farm & Ladywath Poultry Farm**

**Monksthorpe**

**Spilsby**

**Lincolnshire**

**PE23 5PP**

to the extent authorised by and subject to the conditions of this permit.

Name	Date
<b>David Griffiths</b>	<b>16/07/2019</b>

Authorised on behalf of the Environment Agency

# Conditions

## 1 Management

### 1.1 General management

- 1.1.1 The operator shall manage and operate the activities:
- (a) in accordance with a written management system that identifies and minimises risks of pollution, so far as is reasonably practicable, including those risks arising from operations, maintenance, accidents, incidents, non-conformances, closure and those drawn to the attention of the operator as a result of complaints; and
  - (b) using sufficient competent persons and resources.
- 1.1.2 Records demonstrating compliance with condition 1.1.1 shall be maintained.
- 1.1.3 Any person having duties that are or may be affected by the matters set out in this permit shall have convenient access to a copy of the permit.

### 1.2 Energy efficiency

- 1.2.1 The operator shall:
- (a) take appropriate measures to ensure that energy is used efficiently in the activities;
  - (b) maintain records of fuel and energy consumption used in the activities;

### 1.3 Efficient use of raw materials

- 1.3.1 The operator shall:
- (a) take appropriate measures to ensure that raw materials and water are used efficiently in the activities; and
  - (b) maintain records of raw materials and water used in the activities;

### 1.4 Avoidance, recovery and disposal of wastes produced by the activities

- 1.4.1 The operator shall take appropriate measures to ensure that the waste hierarchy referred to in Article 4 of the Waste Framework Directive is applied to the generation of waste by the activities and that:
- (a) any waste generated by the activities is treated in accordance with the waste hierarchy referred to in Article 4 of the Waste Framework Directive; and
  - (b) where disposal is necessary, this is undertaken in a manner which minimises its impact on the environment.

## 2 Operations

### 2.1 Permitted activities

- 2.1.1 The only activities authorised by the permit are the activities specified in schedule 1 table S1.1 (the "activities").



## **2.2 The site**

2.2.1 The activities shall not extend beyond the site, being the land shown edged in green on the site plan at schedule 7 to this permit.

## **2.3 Operating techniques**

2.3.1 The activities shall, subject to the conditions of this permit, be operated using the techniques and in the manner described in the documentation specified in schedule 1, table S1.2, unless otherwise agreed in writing by the Environment Agency.

2.3.2 If notified by the Environment Agency that the activities are giving rise to pollution, the operator shall submit to the Environment Agency for approval within the period specified, a revision of any plan or other documentation ("plan") specified in schedule 1, table S1.2 or otherwise required under this permit which identifies and minimises the risks of pollution relevant to that plan, and shall implement the approved revised plan in place of the original from the date of approval, unless otherwise agreed in writing by the Environment Agency.

2.3.3 The operator shall maintain and implement a system to record the number of animal places and animal movements.

2.3.4 The operator shall ensure that a diet formulation and nutritional strategy is used to reduce the total nitrogen and total phosphorous excreted.

2.3.5 The operator shall take appropriate measures in disposal or recovery of solid manure or slurry to prevent, or where this is not practicable, to minimise pollution.

2.3.6 Any raw materials or fuels listed in schedule 2 table S2.1 shall conform to the specifications set out in that table.

2.3.7 The operator shall ensure that where waste produced by the activities is sent to a relevant waste operation, that operation is provided with the following information, prior to the receipt of the waste:

- (a) the nature of the process producing the waste;
- (b) the composition of the waste;
- (c) the handling requirements of the waste;
- (d) the hazardous property associated with the waste, if applicable; and
- (e) the waste code of the waste.

## **3 Emissions and monitoring**

### **3.1 Emissions to water, air or land**

3.1.1 There shall be no point source emissions to water, air or land except from the sources and emission points specified in tables S3.1 and S3.2.

3.1.2 The limits given in schedule 3 shall not be exceeded.

3.1.3 Periodic monitoring shall be carried out at least once every 5 years for groundwater and 10 years for soil, unless such monitoring is based on a systematic appraisal of the risk of contamination.

### **3.2 Emissions of substances not controlled by emission limits**

3.2.1 Emissions of substances not controlled by emission limits shall not cause pollution. The operator shall not be taken to have breached this condition if appropriate measures, including, but not limited to, those specified in any approved emissions management plan, have been taken to prevent or where that is not practicable, to minimise, those emissions.

3.2.2 The operator shall:

- (a) if notified by the Environment Agency that the activities are giving rise to pollution, submit to the Environment Agency for approval within the period specified, an emissions management plan which identifies and minimises the risks of pollution from emissions of substances not controlled by emission limits; and
- (b) implement the approved emissions management plan, from the date of approval, unless otherwise agreed in writing by the Environment Agency.

3.2.3 All liquids in containers, whose emission to water or land could cause pollution, shall be provided with secondary containment, unless the operator has used other appropriate measures to prevent or where that is not practicable, to minimise, leakage and spillage from the primary container.

### **3.3 Odour**

3.3.1 Emissions from the activities shall be free from odour at levels likely to cause pollution outside the site, as perceived by an authorised officer of the Environment Agency, unless the operator has used appropriate measures, including, but not limited to, those specified in any approved odour management plan, to prevent or where that is not practicable to minimise the odour.

### **3.4 Noise and vibration**

3.4.1 Emissions from the activities shall be free from noise and vibration at levels likely to cause pollution outside the site, as perceived by an authorised officer of the Environment Agency, unless the operator has used appropriate measures, including, but not limited to, those specified in any approved noise and vibration management plan to prevent or where that is not practicable to minimise the noise and vibration.

### **3.5 Monitoring**

3.5.1 The operator shall, unless otherwise agreed in writing by the Environment Agency, undertake the monitoring specified in the following tables in schedule 3 to this permit:

- (a) point source emissions specified in tables S3.1 and S3.2; and
- (b) process monitoring specified in table S3.3.

3.5.2 The operator shall maintain records of all monitoring required by this permit including records of the taking and analysis of samples, instrument measurements (periodic and continual), calibrations, examinations, tests and surveys and any assessment or evaluation made on the basis of such data.

### **3.6 Pests**

3.6.1 The activities shall not give rise to the presence of pests which are likely to cause pollution, hazard or annoyance outside the boundary of the site. The operator shall not be taken to have breached this condition if appropriate measures, including, but not limited to, those specified in any approved pests management plan, have been taken to prevent or where that is not practicable, to minimise the presence of pests on the site.

3.6.2 The operator shall:

- (a) if notified by the Environment Agency, submit to the Environment Agency for approval within the period specified, a pests management plan which identifies and minimises risks of pollution, hazard or annoyance from pests; and
- (b) implement the pests management plan, from the date of approval, unless otherwise agreed in writing by the Environment Agency.

## 4 Information

### 4.1 Records

4.1.1 All records required to be made by schedules 3, 4 and 5 to this permit shall:

- (a) be legible;
- (b) be made as soon as reasonably practicable;
- (c) if amended, be amended in such a way that the original and any subsequent amendments remain legible, or are capable of retrieval; and
- (d) be retained, unless otherwise agreed in writing by the Environment Agency, for at least 6 years from the date when the records were made, or in the case of the following records until permit surrender:
  - (i) off-site environmental effects; and
  - (ii) matters which affect the condition of the land and groundwater.

4.1.2 The operator shall maintain convenient access, in either electronic or hard copy, to the records, plans and management system required to be maintained by this permit.

### 4.2 Reporting

4.2.1 The operator shall send all reports and notifications required by the permit to the Environment Agency using the contact details supplied in writing by the Environment Agency.

4.2.2 For the following activities referenced in schedule 1, table S1.1 a report or reports on the performance of the activities over the previous year shall be submitted to the Environment Agency by 31 January (or other date agreed in writing by the Environment Agency) each year. The report(s) shall include as a minimum:

- (a) a review of the results of the monitoring and assessment carried out in accordance with the permit including an interpretive review of that data.

4.2.3 Within 28 days of the end of the reporting period the operator shall, unless otherwise agreed in writing by the Environment Agency, submit reports of the monitoring and assessment carried out in accordance with the conditions of this permit, as follows:

- (a) in respect of the parameters and emission points specified in schedule 4 table S4.1;
- (b) for the reporting periods specified in schedule 4 table S4.1 and using the forms specified in schedule 4 table S4.1 and
- (c) giving the information from such results and assessments as may be required by the forms specified in those tables.

4.2.4 The operator shall, unless notice under this condition has been served within the preceding four years, submit to the Environment Agency, within six months of receipt of a written notice, a report assessing whether there are other appropriate measures that could be taken to prevent, or where that is not practicable, to minimise pollution.

### 4.3 Notifications

4.3.1 In the event:

- (a) that the operation of the activities gives rise to an incident or accident which significantly affects or may significantly affect the environment, the operator must immediately :—
  - (i) inform the Environment Agency,
  - (ii) take the measures necessary to limit the environmental consequences of such an incident or accident, and

- (iii) take the measures necessary to prevent further possible incidents or accidents; and
  - (b) of a breach of any permit condition the operator must immediately :—
    - (i) inform the Environment Agency, and
    - (ii) take the measures necessary to ensure that compliance is restored within the shortest possible time;
  - (c) of a breach of permit condition which poses an immediate danger to human health or threatens to cause an immediate significant adverse effect on the environment, the operator must immediately suspend the operation of the activities or the relevant part of it until compliance with the permit conditions has been restored.
- 4.3.2 Any information provided under condition 4.3.1 (a)(i) or 4.3.1 (b)(i) shall be confirmed by sending the information listed in schedule 5 to this permit within the time period specified in that schedule.
- 4.3.3 Where the Environment Agency has requested in writing that it shall be notified when the operator is to undertake monitoring and/or spot sampling, the operator shall inform the Environment Agency when the relevant monitoring and/or spot sampling is to take place. The operator shall provide this information to the Environment Agency at least 14 days before the date the monitoring is to be undertaken.
- 4.3.4 The Environment Agency shall be notified within 14 days of the occurrence of the following matters, except where such disclosure is prohibited by Stock Exchange rules:
- Where the operator is a registered company:
- (a) any change in the operator's trading name, registered name or registered office address; and
  - (b) any steps taken with a view to the operator going into administration, entering into a company voluntary arrangement or being wound up.
- Where the operator is a corporate body other than a registered company:
- (c) any change in the operator's name or address; and
  - (d) any steps taken with a view to the dissolution of the operator.
- In any other case:
- (e) the death of any of the named operators (where the operator consists of more than one named individual);
  - (f) any change in the operator's name(s) or address(es); and
  - (g) any steps taken with a view to the operator, or any one of them, going into bankruptcy, entering into a composition or arrangement with creditors, or, in the case of them being in a partnership, dissolving the partnership.
- 4.3.5 Where the operator proposes to make a change in the nature or functioning, or an extension of the activities, which may have consequences for the environment and the change is not otherwise the subject of an application for approval under the Regulations or this permit:
- (a) the Environment Agency shall be notified at least 14 days before making the change; and
  - (b) the notification shall contain a description of the proposed change in operation.
- 4.3.6 The Environment Agency shall be given at least 14 days' notice before implementation of any part of the site closure plan.

## 4.4 Interpretation

- 4.4.1 In this permit the expressions listed in schedule 6 shall have the meaning given in that schedule.
- 4.4.2 In this permit references to reports and notifications mean written reports and notifications, except where reference is made to notification being made "immediately", in which case it may be provided by telephone.

# Schedule 1 – Operations

<b>Table S1.1 Activities</b>		
<b>Activity listed in Schedule 1 of the EP Regulations</b>	<b>Description of specified activity</b>	<b>Limits of specified activity</b>
Section 6.9 A(1)(a)(i) Rearing of poultry intensively in an installation with more than 40,000 places	The rearing of poultry in a facility with a capacity for 609,000 broiler places comprising of 355,000 at Monksthorpe Farm and 254,000 at Ladywath Farm.	From receipt of birds, raw materials and fuels onto the site to removal of birds and associated wastes from site.
<b>Directly Associated Activity</b>	<b>Description of specified activity</b>	<b>Limits of specified activity</b>
Biomass boilers	Operation of Biomass Boilers with an aggregated thermal rate input not exceeding: Monksthorpe Farm -1.592MWth & Ladywath Farm – 1.875MWth For site heating requirements, burning biomass fuel not comprising waste or animal carcasses.	From receipt of raw materials and fuels, to release of combustion products to air and associated wastes removed from site.

<b>Table S1.2 Operating techniques</b>		
<b>Description</b>	<b>Parts</b>	<b>Date Received</b>
Application EPR/ZP3133FJ/A001	Responses to Part B3 section 3 of the application form and referenced supporting documentation.	15/07/11
Application EPR/ZP3133FJ/A001	Odour management plan reference Appendix 9 and Noise Management Plan reference Appendix 10 in response to Part B3 section 3b, Table 3b – General Requirements of the application form.	15/07/11
Additional Information received	Response confirming that heat exchanger condensate is piped to dirty water storage tanks.	09/11/11
Additional Information received	Response to Request for Information confirming site drainage and water emission points. Drawings RAMONKSServ/ Low/7 (Monksthorpe) and R&ALADY-IPPC Plan (Ladywath) supplied. Also confirming that heat exchangers will now not be fitted.	27/01/12
Additional Information received	Odour Management Plan resubmitted.	05/03/12
Application EPR/ZP3133FJ/V002	The responses to Part C3 section 3 of the application form and referenced supporting documentation.	07/05/13
Application EPR/ZP3133FJ/V003	The responses to Part C3 section 3 of the application form and referenced supporting documentation.	28/11/13
Additional Information received	Email providing evidence to demonstrate that a fan speed of 12m/s is achievable.	20/02/14
Additional Information received	Updated odour modelling report to account for a change in the location of the fan outlets.	11/03/14
Application EPR/ZP3133FJ/V004	Responses to Part C3.5 of the application form and referenced supporting documentation and plans.	20/12/18

<b>Table S1.2 Operating techniques</b>		
<b>Description</b>	<b>Parts</b>	<b>Date Received</b>
Application EPR/ZP3133FJ/V004	Odour management plan reference 'AG8 Odour Management Plan' and Noise Management Plan reference 'AG9 Noise Management Plan'.	20/12/18
Additional Information received	Response to request for Information confirming ammonia reduction plan for Ladywath Farm.	20/12/18
Additional Information received	Response to request for Information confirming new biomass boiler at Ladywath Farm criteria, thermal inputs and number of.	01/11/18
Additional Information received	Response to request for Information confirming revised drainage plan for House 4	07/03/19
Additional Information received	Response to request for Information confirming revised site plan of the Ladywath site.	20/03/19
Additional Information received	Response to request for Information confirming revised Noise Management Plan.	10/06/19

## Schedule 2 – Waste types, raw materials and fuels

<b>Table S2.1 Raw materials and fuels</b>	
<b>Raw materials and fuel description</b>	<b>Specification</b>
Fuel for biomass boiler units	Biomass chips or pellets comprising virgin timber, straw, miscanthus.

## Schedule 3 – Emissions and monitoring

Table S3.1 Point source emissions to air – emission limits and monitoring requirements						
Emission point ref. & location	Source	Parameter	Limit (including unit)	Reference period	Monitoring frequency	Monitoring standard or method
<b>Monksthorpe farm</b>						
High velocity roof fan outlets on poultry house 1 to 8 as shown on the site plan number RAMONKS-Serv/Low/7 within application EPR/ZP3133FJ/A001	Poultry houses 1 to 8	Exit velocity	No less than 12m/s	---	---	---
Vent from oil tank as shown on the site plan number RAMONKS-Serv/Low/7 within application EPR/ZP3133FJ/A001	Diesel Tank	---	---	---	---	---
Exhaust from standby generator as shown on the site plan number RAMONKS-Serv/Low/7 within application EPR/ZP3133FJ/A001	Standby generator	---	---	---	---	---
Emissions from 8 Biomass Boilers as shown on the site plan number MONKS OA-BUILD LO 2 within application EPR/ZP3133FJ/V002	8 Biomass Boilers aggregated to 1.592MW	---	---	---	---	---
<b>Ladywath Farm</b>						
Uncapped high speed chimney fan extraction outlets, exiting at ridge height, as shown on the site plan ref 'Lady-Dr-SR/R4' received as part of RFI response dated 20/03/19 as part of application EPR/ZP3133FJ/V004	Poultry houses 1 to 4	Exit velocity	No less than 12m/s	---	---	---
Exhaust from standby generator as shown on the site plan ref 'Lady-Dr-SR/R4' received as part of RFI response dated 20/03/19 as part of application EPR/ZP3133FJ/V004	Standby generator	---	---	---	---	---
Vent from oil tank as shown on the site plan	Diesel Tank	---	---	---	---	---



<b>Table S3.1 Point source emissions to air – emission limits and monitoring requirements</b>						
<b>Emission point ref. &amp; location</b>	<b>Source</b>	<b>Parameter</b>	<b>Limit (including unit)</b>	<b>Reference period</b>	<b>Monitoring frequency</b>	<b>Monitoring standard or method</b>
ref 'Lady-Dr-SR/R4' received as part of RFI response dated 20/03/19 as part of application EPR/ZP3133FJ/V004						
Emissions from 7 Biomass Boilers as shown on the site plan ref 'Lady-Dr-SR/R4' received as part of RFI response dated 20/03/19 as part of application EPR/ZP3133FJ/V004	7 Biomass Boilers total aggregated to 1.875MW	---	---	---	---	---

<b>Table S3.2 Point Source emissions to water (other than sewer) and land – emission limits and monitoring requirements</b>						
<b>Emission point ref. &amp; location</b>	<b>Source</b>	<b>Parameter</b>	<b>Limit (incl. unit)</b>	<b>Reference Period</b>	<b>Monitoring frequency</b>	<b>Monitoring standard or method</b>
<b>Monksthorpe Farm</b>						
Surface water discharge at grid reference 544447,365379 and as shown on the site plan number RAMONKSServ/ Low/7. Emission to Ladywath Brook, a tributary of the River Steeping.	Uncontaminated Roof and surface waters to attenuation pond (excluding poultry house wash out periods)	---	---	---	---	---
Surface water discharge at grid reference 544329,365489 and as shown on the site plan number RAMONKSServ/ Low/7. Emission to Ladywath Brook, a tributary of the River Steeping.	Uncontaminated Roof and surface waters to attenuation pond (excluding poultry house wash out periods)	---	---	---	---	---
<b>Ladywath Farm</b>						
Surface water discharge at grid reference 544440,365157 and as shown on the site plan number 'RA-LADY-4HSE DRAINAGE PLAN'.	Uncontaminated Roof and surface waters to attenuation pond (excluding poultry house wash out periods)	---	---	---	---	---

**Table S3.2 Point Source emissions to water (other than sewer) and land – emission limits and monitoring requirements**

Emission point ref. & location	Source	Parameter	Limit (incl. unit)	Reference Period	Monitoring frequency	Monitoring standard or method
emission to Ladywath Brook, a tributary of the River Steeping.	wash out periods)					

**Table S3.3 Process monitoring requirements**

Emission point reference or source or description of point of measurement	Parameter	Limit (incl. Unit)	Monitoring frequency (1)	Monitoring standard or method
<b>Monksthorpe Farm</b>				
Broilers in houses 1 to 8	kg N excreted/animal place/year	<b>From 21/02/2021</b> 0.6 kg N/animal place/year	Annually	Estimation by using manure analysis for total nitrogen content
	kg P <sub>2</sub> O <sub>5</sub> excreted/animal place/year	<b>From 21/02/2021</b> 0.25 kg P <sub>2</sub> O <sub>5</sub> animal place/year	Annually	Estimation by using manure analysis for total phosphorus content
Broilers in houses 1 to 8	kg NH <sub>3</sub> /animal place/year	<b>From 21/02/2021</b> 0.08 kg NH <sub>3</sub> /animal place/year	Annually	Estimation using emission factors
Broilers in houses 1 to 8	Dust	n/a	Annually	Estimation using emission factors
<b>Ladywath Farm</b>				
Broilers in houses 1 to 3	kg N excreted/animal place/year	<b>From 21/02/2021</b> 0.6 kg N/animal place/year	Annually	Estimation by using manure analysis for total nitrogen content
	kg P <sub>2</sub> O <sub>5</sub> excreted/animal place/year	<b>From 21/02/2021</b> 0.25 kg P <sub>2</sub> O <sub>5</sub> animal place/year	Annually	Estimation by using manure analysis for total phosphorus content
Broilers in house 4	kg N excreted/animal place/year	0.6 kg N/animal place/year	Annually	Estimation by using manure analysis for total nitrogen content
	kg P <sub>2</sub> O <sub>5</sub> excreted/animal place/year	0.25 kg P <sub>2</sub> O <sub>5</sub> /animal place/year	Annually	Estimation by using manure analysis for total phosphorus content
Broilers in houses 1 to 3	kg NH <sub>3</sub> /animal place/year	<b>From 21/02/2021</b> 0.08 kg NH <sub>3</sub> /animal place/year	Annually	Estimation using emission factors
Broilers in house 4	kg NH <sub>3</sub> /animal place/year	0.08 kg NH <sub>3</sub> /animal place/year	Annually	Estimation using emission factors
Broilers in houses 1 to 4	Dust	n/a	Annually	Estimation using emission factors

**Notes** (1) For all existing housing permitted before 21/02/17 the monitoring is a requirement from 21/02/21.

# Schedule 4 – Reporting

<b>Table S4.1 Reporting of monitoring data</b>			
<b>Parameter</b>	<b>Emission or monitoring point/reference</b>	<b>Reporting period</b>	<b>Period begins</b>
Process monitoring Parameters as required by condition 3.5.1	---	Every 12 months	1 January

<b>Table S4.2 Reporting forms</b>		
<b>Media/parameter</b>	<b>Reporting format</b>	<b>Date of form</b>
kg NH <sub>3</sub> /animal place/year	Form Process Monitoring 1 or other form as agreed in writing by the Environment Agency	16/07/2019
kg N excreted/animal place/year & kg P <sub>2</sub> O <sub>5</sub> excreted/animal place/year		
Dust atmospheric mass emission		

# Schedule 5 – Notification

These pages outline the information that the operator must provide.

Units of measurement used in information supplied under Part A and B requirements shall be appropriate to the circumstances of the emission. Where appropriate, a comparison should be made of actual emissions and authorised emission limits.

If any information is considered commercially confidential, it should be separated from non-confidential information, supplied on a separate sheet and accompanied by an application for commercial confidentiality under the provisions of the EP Regulations.

## Part A

Permit number	
Name of operator	
Location of facility	
Time and date of the detection	

**(a) Notification requirements for any malfunction, breakdown or failure of equipment or techniques, accident, or emission of a substance not controlled by an emission limit which has caused, is causing or may cause significant pollution**

**To be notified within 24 hours of detection**

Date and time of the event	
Reference or description of the location of the event	
Description of where any release into the environment took place	
Substances(s) potentially released	
Best estimate of the quantity or rate of release of substances	
Measures taken, or intended to be taken, to stop any emission	
Description of the failure or accident.	

**(b) Notification requirements for the breach of a limit**

**To be notified within 24 hours of detection**

Emission point reference/ source	
Parameter(s)	
Limit	
Measured value and uncertainty	
Date and time of monitoring	
Measures taken, or intended to be taken, to stop the emission	

Time periods for notification following detection of a breach of a limit	
Parameter	Notification period

(c) Notification requirements for the detection of any significant adverse environmental effect	
To be notified within 24 hours of detection	
Description of where the effect on the environment was detected	
Substances(s) detected	
Concentrations of substances detected	
Date of monitoring/sampling	

## Part B – to be submitted as soon as practicable

Any more accurate information on the matters for notification under Part A.	
Measures taken, or intended to be taken, to prevent a recurrence of the incident	
Measures taken, or intended to be taken, to rectify, limit or prevent any pollution of the environment which has been or may be caused by the emission	
The dates of any unauthorised emissions from the facility in the preceding 24 months.	
Name*	
Post	
Signature	
Date	

\* authorised to sign on behalf of the operator

## Schedule 6 – Interpretation

“accident” means an accident that may result in pollution.

“application” means the application for this permit, together with any additional information supplied by the operator as part of the application and any response to a notice served under Schedule 5 to the EP Regulations.

“authorised officer” means any person authorised by the Environment Agency under section 108(1) of The Environment Act 1995 to exercise, in accordance with the terms of any such authorisation, any power specified in section 108(4) of that Act.

“building” means a construction that has the objective of providing sheltering cover and minimising emissions of noise, particulate matter, odour and litter.

“emissions to land” includes emissions to groundwater.

“emissions of substances not controlled by emission limits” means emissions of substances to air, water or land from the activities, either from the emission points specified in schedule 3 or from other localised or diffuse sources, which are not controlled by an emission limit.

“EP Regulations” means The Environmental Permitting (England and Wales) Regulations SI 2016 No.1154 and words and expressions used in this permit which are also used in the Regulations have the same meanings as in those Regulations.

“groundwater” means all water, which is below the surface of the ground in the saturation zone and in direct contact with the ground or subsoil.

“Hazardous property” has the meaning in Annex III of the Waste Framework Directive.

“Industrial Emissions Directive” means DIRECTIVE 2010/75/EU OF THE EUROPEAN PARLIAMENT AND OF THE COUNCIL of 24 November 2010 on industrial emissions.

“List of Wastes” means the list of wastes established by Commission Decision 2000/532/EC replacing Decision 94/3/EC establishing a list of wastes pursuant to Article 1(a) of Council Directive 75/442/EEC on waste and Council Decision 94/904/EC establishing a list of hazardous waste pursuant to Article 1(4) of Council Directive 91/689/EEC on hazardous waste, as amended from time to time.

“Manure and slurry” have the following meaning:

- Manures may be either slurries or solid manures.
- Slurries consist of excreta produced by livestock whilst in a yard or building mixed with rainwater and wash water and, in some cases, waste bedding and feed. Slurries can be pumped or discharged by gravity.
- Slurry includes duck effluent, seepage from manure and wash water.
- Solid manures include farmyard manure (FYM) and comprise material from straw-based housing systems, excreta with lots of straw/sawdust/woodchips in it, or solids from mechanical separators.
- Most poultry systems produce solid manure (litter).
- Solid manure can generally be stacked.

“virgin timber” means timber from

- Whole trees and the woody parts of trees including branches and bark derived from forestry works, woodland management, tree surgery and other similar operations (it does not include clippings or trimmings that consist primarily of foliage);
- Virgin wood processing (e.g. wood offcuts, shavings or sawdust from sawmills) or timber product manufacture dealing in virgin timber.
- If virgin timber is mixed with waste timber or any other waste, the mixed load is classed as waste.

“pests” means Birds, Vermin and Insects.

“Waste code” means the six digit code referable to a type of waste in accordance with the List of Wastes and in relation to hazardous waste, includes the asterisk.

“Waste Framework Directive” or “WFD” means Waste Framework Directive 2008/98/EC of the European Parliament and of the Council on waste.

“year” means calendar year ending 31 December.

# Schedule 7 – Site plan

Site plan - showing installation boundary as referred to in condition 2.2.1.

### Monksthorpe Farm Installation Boundary Plan

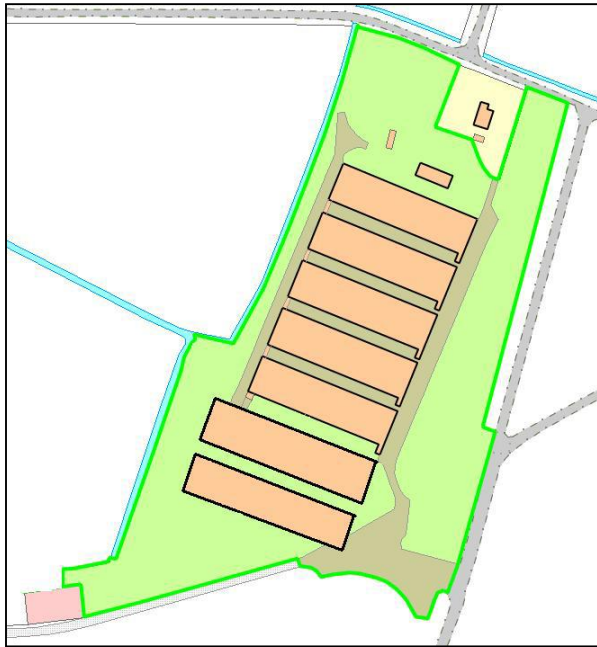

©Crown Copyright. All rights reserved. Environment Agency, 100024198, 2019.”

### Ladywath Farm Installation Boundary Plan

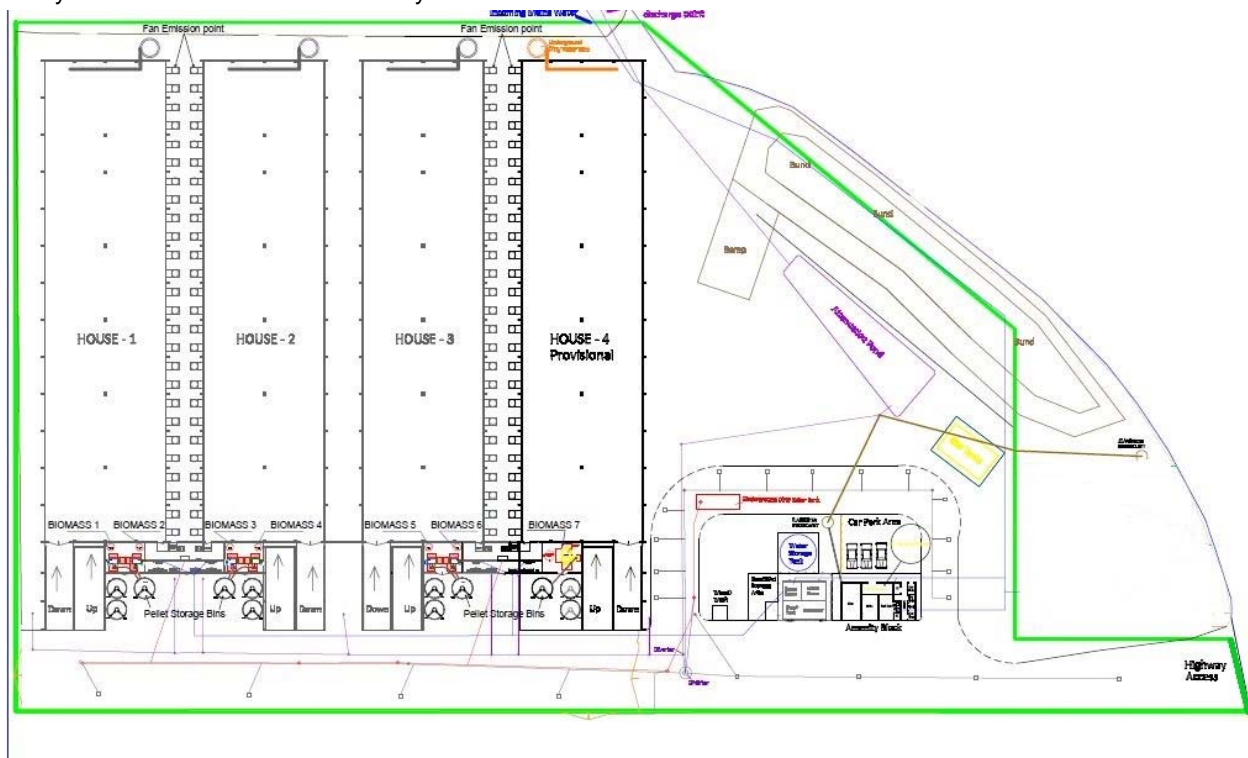

©Crown Copyright. All rights reserved. Environment Agency, 100024198, 2019.”

END OF PERMIT

Permit number  
EPR/ZP3133FJ