

Notice of variation and consolidation with introductory note

The Environmental Permitting (England & Wales) Regulations 2016

West London Composting Limited

West London Composting Limited

High View Farm

Newyears Green Lane

Harefield

Middlesex

UB9 6LX

Variation application number

EPR/UP3893EC/V007

Permit number

EPR/UP3893EC

West London Composting Limited

Permit number EPR/UP3893EC

Introductory note

This introductory note does not form a part of the notice

Under the Environmental Permitting (England & Wales) Regulations 2016 (schedule 5, part 1, paragraph 19) a variation may comprise a consolidated permit reflecting the variations and a notice specifying the variations included in that consolidated permit.

Schedule 1 of the notice specifies the conditions that have been varied and schedule 2 comprises a consolidated permit which reflects the variations being made. All the conditions of the permit have been varied and are subject to the right of appeal.

The Installation is located west of Ruislip, approximately 5 km from the M25 at National Grid Reference TQ 0719888015. Access to the site is via Newyears Green Lane.

The operator has applied for a substantial variation to the existing permit to:

- treat municipal solid waste (MSW) fines and other biodegradable wastes in a sanitisation and stabilisation process using in-vessel composting (IVC) vessels to produce a waste compost-like output (CLO) which will be dispatched off-site for recovery.
- treat biodegradable materials which are not subject to Animal By-Products (ABP) Regulations in open windrows located at the northern side of the site to produce a PAS 100 compost product.
- relocate the waste transfer activity, which is operated in the reception building, to another separate part of the reception building, thus allowing the reception building to be split into 3 separated areas so that incoming untreated MSW fines and other wastes do not come into contact with either the waste located in the waste transfer station or the sanitised and stabilised waste CLO.

The following operations are currently undertaken on site:

- Processing of biodegradable materials, which include wastes subject to the ABP Regulations, into a PAS 100 compost product. The materials are shredded and mixed prior to transfer to the sanitisation and stabilisation stages of the composting process, which is undertaken in IVC vessels located on the southern side of the site. The final maturation phase is undertaken in the open, on a maturation pad located on the northern side of the site.
- Operation of a waste transfer station activity in designated bays at the back of the reception building, accepting food waste collections for temporary storage prior to removal for onward processing at a third party site.

As a result of this variation, the site will now operate as follows:

The site comprises of two separate areas:

- an area to the south of the facility where the IVC (sanitisation and stabilisation) takes place in the IVC vessels and a small waste transfer station operation is undertaken in the central area of the reception building; and
- a large concrete pad to the north designated for open-windrow composting.

The Installation will continue to be operated under the current activities (Table S1.1A) within the land shown on the site plan at schedule 7A until the pre-operational conditions in Table S1.4 have been completed and approved by the Environment Agency. On approval, the Installation will be operated under the proposed activities (Table S1.1B) within the land shown on the site plan at schedule 7B.

This variation authorises the following:

- a) In-vessel composting, on the southern side of the site, of municipal solid waste (MSW) fines which will be blended with source segregated kerbside, civic amenity and commercial food and green wastes to balance the carbon to nitrogen ratio for optimal conditions in the reception area of the reception building and then moved into the vessels for sanitisation and subsequent stabilisation. After stabilisation, the treated CLO will be moved into the separated dispatch area of the reception building pending removal from site to an appropriately licenced facility which can take the CLO for use in landfill restoration. The MSW fines which will be accepted onto the site will be sourced from a materials recovery facility (MRF). Annual throughput from this process shall not exceed 50,000 tonnes.
- b) Operation of a waste transfer station in a relocated and separated central section of the reception building located on the southern section of the site. The waste transfer station will accept food waste, green waste and commingled food and green waste for transfer only, with waste being both off-loaded and re-loaded within the central separated area of the reception building. The throughput of the waste transfer station remains unchanged at 20,000 tonnes.
- c) Open windrows composting, on the northern side of the site, of biodegradable wastes to produce a PAS 100 QP certified compost. Materials to be processed through this treatment process shall not include catering and animal wastes listed in the Animal By-Products Regulations (ABPR). This operation will take place on the concrete pad north of the Installation, with an annual throughput not exceeding 50,000 tonnes. The concrete pad shall no longer accept any output from the IVC process.
- d) Increase in the total site annual throughput from 95,000 tonnes to 120,000 tonnes.

The acceptance and pre-treatment of municipal solid waste fines will be enclosed and maintained under negative pressure in a building with a ventilation extraction system.

All wastes on site will be stored and treated on an impermeable surface with sealed drainage system.

Odorous emissions from the MSW fines reception area, transfer building, fines storage building and the IVC tunnels will be channelled through an abatement system comprising a wet scrubber and two biofilter units for treatment prior to release to atmosphere.

Leachate from the IVC treatment process is collected in a network of tanks that provide a total storage capacity of 576 m³. Leachate generated will only be recirculated within the IVC process. Upon the leachate storage tanks reaching 90% capacity, a specialist contractor will be notified, and the tanks will be emptied within 48 hours.

Leachate from the open windrow composting process will be collected by a dedicated sump and channelled to two leachate tanks, situated to the north of the maturation pad, and with a combined storage capacity of 980 m³. Leachate from the open windrow composting process will not be recirculated. Upon the leachate tanks reaching 80% capacity, a specialist contractor will be notified, and the tanks will be emptied within 48 hours.

The bioaerosols monitoring frequency given in Table S3.4 may be reduced to twice a year if agreed to in writing by the Environment Agency.

The status log of the permit sets out the permitting history, including any changes to the permit reference number.

Status log of the permit		
Description	Date	Comments
Licence Issued EAWML 80785	25/09/07	Licence issued to West London Composting Limited.
Variation determined EPR/UP3893EC/V002	08/07/10	Variation to include new waste codes.

Status log of the permit		
Description	Date	Comments
Variation determined EPR/UP3893EC/V003	29/03/11	Environment Agency initiated variation to add bioaerosols monitoring requirements to the permit.
Variation determined EPR/UP3893EC/V004	14/05/14	Variation to increase annual throughput from 50,000 to 75,000 tonnes and to add new waste codes.
Application EPR/UP3893EC/V005 (variation and consolidation)	Duly made 12/09/14	Application to vary and update the permit to modern conditions.
Variation determined EPR/UP3893EC	09/10/15	Varied and consolidated permit issued in modern condition format.
Application EPR/UP3893EC/V006 (variation and consolidation)	Duly made 07/03/16	Application to add a waste transfer station and to consolidate the permit. Including the additional information received on 19/02/16, 26/02/16 and 07/03/16 (application forms, OPRA spreadsheet and waste codes).
Additional information received	12/04/16	Updated Management System, Odour Management Plan, Drainage and Leachate Management Plan, Accident Management Plan and H1 Risk Assessment.
	05/05/16	Reception hall plan and clarification on the quarantine area, hazardous wastes, the area receiving leachate and leachate transfer.
Variation determined EPR/UP3893EC/V006	09/06/16	Varied and consolidated permit issued.
Application EPR/UP3893EC/V007 (variation and consolidation)	Duly made 26/01/18	Application to treat municipal solid waste fines through the existing in-vessel system and a separate open windrow composting process.
Additional information received	25/01/18	Response to request for information providing further information on the type of biofilters proposed for this variation and all sensitive receptors within 250 metres of the composting operation.
	26/01/18	Information on waste acceptance procedures on site and the treatment procedure for municipal solid waste fines.
Schedule 5 Notice response received	20/04/18	Responses to questions 1 to 32 of information notice #1 dated 15/03/18.
Schedule 5 Notice response received	22/06/18	Responses to questions 1 to 9 of information notice #2 dated 11/05/18.
	24/08/18	Jacobs Framework Assessment data and associated report.
Schedule 5 Notice response received.	04/10/18	Response to questions 1 to 8 of information notice #3 dated 20/09/18.
Schedule 5 Notice response received.	12/02/19	Response to all parts, except questions 4 and 5 of information notice #4 dated 14/01/19.
	02/04/19	Noise Impact Assessment (NIA)
Additional information received	25/04/19	Updated versions of the following management plans:

Status log of the permit		
Description	Date	Comments
		<ul style="list-style-type: none"> • Fire Prevention Plan • Odour Management Plan • Accident Management Plan Best Available Techniques (BAT) Assessment Report.
Additional information received	21/05/19	Amended South Site Drainage Plan
Variation determined EPR/UP3893EC/V007 (Billing ref: DP3239JA / 403434).	28/06/19	Varied and consolidated permit issued.

End of introductory note

Notice of variation and consolidation

The Environmental Permitting (England and Wales) Regulations 2016

The Environment Agency in exercise of its powers under regulation 20 of the Environmental Permitting (England and Wales) Regulations 2016 varies and consolidates

Permit number

EPR/UP3893EC

Issued to

West London Composting Limited ("the operator")

whose registered office is

39 The Metro Centre

Tolpits Lane

Watford

Hertfordshire

WD18 9SB

company registration number 04014874

to operate a regulated facility at

West London Composting Limited

High View Farm

Newyears Green Lane

Harefield

Middlesex

UB9 6LX

to the extent set out in the schedules.

The notice shall take effect from 28/06/2019.

Name	Date
Claire Roberts	28/06/2019

Authorised on behalf of the Environment Agency

Schedule 1

All conditions have been varied by the consolidated permit as a result of the application made by the operator.

Schedule 2 – consolidated permit

Consolidated permit issued as a separate document.

Permit

The Environmental Permitting (England and Wales) Regulations 2016

Permit number

EPR/UP3893EC

This is the consolidated permit referred to in the variation and consolidation notice for application EPR/UP3893EC/V007 authorising,

West London Composting Limited ("the operator"),

whose registered office is

39 The Metro Centre

Tolpits Lane

Watford

Hertfordshire

WD18 9SB

company registration number 04014874

to operate an installation at

West London Composting Limited

High View Farm

Newyears Green Lane

Harefield

Middlesex

UB9 6LX

to the extent authorised by and subject to the conditions of this permit.

Name	Date
Claire Roberts	28/06/2019

Authorised on behalf of the Environment Agency

Conditions

1 Management

1.1 General management

- 1.1.1 The operator shall manage and operate the activities:
- (a) in accordance with a written management system that identifies and minimises risks of pollution, including those arising from operations, maintenance, accidents, incidents, non-conformances, closure and those drawn to the attention of the operator as a result of complaints; and
 - (b) using sufficient competent persons and resources.
- 1.1.2 Records demonstrating compliance with condition 1.1.1 shall be maintained.
- 1.1.3 Any person having duties that are or may be affected by the matters set out in this permit shall have convenient access to a copy of it kept at or near the place where those duties are carried out.
- 1.1.4 The operator shall comply with the requirements of an approved competence scheme.

1.2 Energy efficiency

- 1.2.1 For the following activities referenced in schedule 1, table S1.1A AR1 to AR7 and table S1.1B AR1 to AR9, the operator shall:
- (a) take appropriate measures to ensure that energy is used efficiently in the activities;
 - (b) review and record at least every four years whether there are suitable opportunities to improve the energy efficiency of the activities; and
 - (c) take any further appropriate measures identified by a review.

1.3 Efficient use of raw materials

- 1.3.1 For the following activities referenced in schedule 1, table S1.1A AR1 to AR7 and table S1.1B AR1 to AR9, the operator shall:
- (a) take appropriate measures to ensure that raw materials and water are used efficiently in the activities;
 - (b) maintain records of raw materials and water used in the activities;
 - (c) review and record at least every four years whether there are suitable alternative materials that could reduce environmental impact or opportunities to improve the efficiency of raw material and water use; and
 - (d) take any further appropriate measures identified by a review.

1.4 Avoidance, recovery and disposal of wastes produced by the activities

- 1.4.1 The operator shall take appropriate measures to ensure that:
- (a) the waste hierarchy referred to in Article 4 of the Waste Framework Directive is applied to the generation of waste by the activities; and
 - (b) any waste generated by the activities is treated in accordance with the waste hierarchy referred to in Article 4 of the Waste Framework Directive; and

- (c) where disposal is necessary, this is undertaken in a manner which minimises its impact on the environment.

- 1.4.2 The operator shall review and record at least every four years whether changes to those measures should be made and take any further appropriate measures identified by a review.

2 Operations

2.1 Permitted activities

- 2.1.1 The operator is only authorised to carry out the activities in schedule 1 table S1.1A (the current activities) until such time as the activities in schedule 1 table S1.1B (the proposed activities) are commenced from which date the operator is only authorised to carry out the table S1.1B activities.
- 2.1.2 For the following activities referenced in schedule 1, table S1.1A AR1 to AR7 and table S1.1B AR1 to AR9, waste authorised by this permit shall be clearly distinguished from any other waste on the site.

2.2 The site

- 2.2.1 The activities in schedule 1 table S1.1A (the current activities) shall not extend beyond the site, being the land shown edged in red on the site plan at schedule 7A to this permit until such time as the activities in schedule 1 table S1.1B (the proposed activities) are commenced from which date the activities shall not extend beyond the site, being the land shown edged in green on the site plan at schedule 7B to this permit.

2.3 Operating techniques

- 2.3.1 The activities shall, subject to the conditions of this permit, be operated using the techniques and in the manner described in the documentation specified in schedule 1, table S1.2, unless otherwise agreed in writing by the Environment Agency.
- 2.3.2 If notified by the Environment Agency that the activities are giving rise to pollution, the operator shall submit to the Environment Agency for approval within the period specified, a revision of any plan or other documentation ("plan") specified in schedule 1, table S1.2 or otherwise required under this permit which identifies and minimises the risks of pollution relevant to that plan, and shall implement the approved revised plan in place of the original from the date of approval, unless otherwise agreed in writing by the Environment Agency.
- 2.3.3 Any raw materials or fuels listed in schedule 2 table S2.1 shall conform to the specifications set out in that table.
- 2.3.4 Waste shall only be accepted if:
 - (a) it is of a type and quantity listed in schedule 2 tables S2.2, S2.3, S2.4 and S2.5; and
 - (b) it conforms to the description in the documentation supplied by the producer and holder.
- 2.3.5 The operator shall ensure that where waste produced by the activities is sent to a relevant waste operation, that operation is provided with the following information, prior to the receipt of the waste:
 - (a) the nature of the process producing the waste;
 - (b) the composition of the waste;
 - (c) the handling requirements of the waste;
 - (d) the hazardous property associated with the waste, if applicable; and
 - (e) the waste code of the waste.

- 2.3.6 The operator shall ensure that where waste produced by the activities is sent to a landfill site, it meets the waste acceptance criteria for that landfill.

2.4 Improvement programme

- 2.4.1 The operator shall complete the improvements specified in schedule 1 table S1.3 by the date specified in that table unless otherwise agreed in writing by the Environment Agency.
- 2.4.2 Except in the case of an improvement which consists only of a submission to the Environment Agency, the operator shall notify the Environment Agency within 14 days of completion of each improvement.

2.5 Pre-operational conditions

- 2.5.1 The operations specified in schedule 1 table S1.4 shall not commence until the measures specified in that table have been completed.

3 Emissions and monitoring

3.1 Emissions to water, air or land

- 3.1.1 There shall be no point source emissions to water, air or land except from the sources and emission points listed in schedule 3 tables S3.1 and S3.2.
- 3.1.2 The limits given in schedule 3 shall not be exceeded.
- 3.1.3 For the following activities referenced in schedule 1, table S1.1A AR1 to AR7 and table S1.1B AR1 to AR9, periodic monitoring shall be carried out at least once every 5 years for groundwater and 10 years for soil, unless such monitoring is based on a systematic appraisal of the risk of contamination.

3.2 Emissions of substances not controlled by emission limits

- 3.2.1 Emissions of substances not controlled by emission limits (excluding odour) shall not cause pollution. The operator shall not be taken to have breached this condition if appropriate measures, including, but not limited to, those specified in any approved emissions management plan, have been taken to prevent or where that is not practicable, to minimise, those emissions.
- 3.2.2 The operator shall:
- (a) if notified by the Environment Agency that the activities are giving rise to pollution, submit to the Environment Agency for approval within the period specified, an emissions management plan which identifies and minimises the risks of pollution from emissions of substances not controlled by emission limits;
 - (b) implement the approved emissions management plan, from the date of approval, unless otherwise agreed in writing by the Environment Agency.
- 3.2.3 All liquids in containers, whose emission to water or land could cause pollution, shall be provided with secondary containment, unless the operator has used other appropriate measures to prevent or where that is not practicable, to minimise, leakage and spillage from the primary container.

3.3 Odour

- 3.3.1 Emissions from the activities shall be free from odour at levels likely to cause pollution outside the site, as perceived by an authorised officer of the Environment Agency, unless the operator has used appropriate measures, including, but not limited to, those specified in any approved odour management plan, to prevent or where that is not practicable to minimise the odour.

3.4 Noise and vibration

- 3.4.1 Emissions from the activities shall be free from noise and vibration at levels likely to cause pollution outside the site, as perceived by an authorised officer of the Environment Agency, unless the operator has used appropriate measures, including, but not limited to, those specified in any approved noise and vibration management plan to prevent or where that is not practicable to minimise the noise and vibration.
- 3.4.2 The operator shall:
- (a) if notified by the Environment Agency that the activities are giving rise to pollution outside the site due to noise and vibration, submit to the Environment Agency for approval within the period specified, a noise and vibration management plan which identifies and minimises the risks of pollution from noise and vibration;
 - (b) implement the approved noise and vibration management plan, from the date of approval, unless otherwise agreed in writing by the Environment Agency.

3.5 Bioaerosols

- 3.5.1 The operator shall take all appropriate measures, to prevent or where that is not practicable to minimise the release of bioaerosols. Emissions of bioaerosols from the operational activities shall not exceed the emission threshold limits specified in table S3.4.
- 3.5.2 The operator shall, where the emission threshold limits are exceeded:
- (a) notify the Environment Agency and investigate and take remedial action;
 - (b) submit to the Environment Agency for approval within the period specified, a bioaerosols management plan which identifies and minimises the risks of pollution from bioaerosols; and
 - (c) implement the bioaerosols management plan from the date of approval and revise the plan periodically, unless otherwise agreed in writing by the Environment Agency.

3.6 Pests

- 3.6.1 The activities shall not give rise to the presence of pests which are likely to cause pollution, hazard or annoyance outside the boundary of the site. The operator shall not be taken to have breached this condition if appropriate measures, including, but not limited to, those specified in any approved pests management plan, have been taken to prevent or where that is not practicable, to minimise the presence of pests on the site.
- 3.6.2 The operator shall:
- (a) if notified by the Environment Agency, submit to the Environment Agency for approval within the period specified, a pests management plan which identifies and minimises risks of pollution from pests;
 - (b) implement the pests management plan, from the date of approval, unless otherwise agreed in writing by the Environment Agency.

3.7 Fire prevention

- 3.7.1 The operator shall take all appropriate measures to prevent fires on site and minimise the risk of pollution from them including, but not limited to, those specified in any approved fire prevention plan.

3.8 Monitoring

- 3.8.1 The operator shall, unless otherwise agreed in writing by the Environment Agency, undertake the monitoring specified in the following tables in schedule 3 to this permit:

- (a) point source emissions specified in tables S3.1 and S3.2;
 - (b) process monitoring specified in table S3.3; and
 - (c) bioaerosols monitoring specified in table S3.4.
- 3.8.2 The operator shall maintain records of all monitoring required by this permit including records of the taking and analysis of samples, instrument measurements (periodic and continual), calibrations, examinations, tests and surveys and any assessment or evaluation made on the basis of such data.
- 3.8.3 Monitoring equipment, techniques, personnel and organisations employed for the emissions monitoring programme and the environmental or other monitoring specified in condition 3.8.1 shall have either MCERTS certification or MCERTS accreditation (as appropriate), where available, unless otherwise agreed in writing by the Environment Agency.
- 3.8.4 Permanent means of access shall be provided to enable sampling/monitoring to be carried out in relation to the emission points specified in schedule 3 tables S3.1 and S3.2 unless otherwise agreed in writing by the Environment Agency.

4 Information

4.1 Records

- 4.1.1 All records required to be made by this permit shall:
 - (a) be legible;
 - (b) be made as soon as reasonably practicable;
 - (c) if amended, be amended in such a way that the original and any subsequent amendments remain legible, or are capable of retrieval; and
 - (d) be retained, unless otherwise agreed in writing by the Environment Agency, for at least 6 years from the date when the records were made, or in the case of the following records until permit surrender:
 - (i) off-site environmental effects; and
 - (ii) matters which affect the condition of the land and groundwater.
- 4.1.2 The operator shall keep on site all records, plans and the management system required to be maintained by this permit, unless otherwise agreed in writing by the Environment Agency.

4.2 Reporting

- 4.2.1 The operator shall send all reports and notifications required by the permit to the Environment Agency using the contact details supplied in writing by the Environment Agency.
- 4.2.2 For the following activities referenced in schedule 1, table S1.1A AR1 to AR7 and table S1.1B A1 to AR9, a report or reports on the performance of the activities over the previous year shall be submitted to the Environment Agency by 31 January (or other date agreed in writing by the Environment Agency) each year. The report(s) shall include as a minimum:
 - (a) a review of the results of the monitoring and assessment carried out in accordance with the permit including an interpretive review of that data;
 - (b) the annual production/treatment data set out in schedule 4 table S4.2; and
 - (c) the performance parameters set out in schedule 4 table S4.3 using the forms specified in table S4.4 of that schedule.

- 4.2.3 Within 28 days of the end of the reporting period the operator shall, unless otherwise agreed in writing by the Environment Agency, submit reports of the monitoring and assessment carried out in accordance with the conditions of this permit, as follows:
- (a) in respect of the parameters and emission points specified in schedule 4 table S4.1;
 - (b) for the reporting periods specified in schedule 4 table S4.1 and using the forms specified in schedule 4 table S4.4; and
 - (c) giving the information from such results and assessments as may be required by the forms specified in those tables.
- 4.2.4 The operator shall, unless notice under this condition has been served within the preceding four years, submit to the Environment Agency, within six months of receipt of a written notice, a report assessing whether there are other appropriate measures that could be taken to prevent, or where that is not practicable, to minimise pollution.
- 4.2.5 Within 1 month of the end of each quarter, the operator shall submit to the Environment Agency using the form made available for the purpose, the information specified on the form relating to the site and the waste accepted and removed from it during the previous quarter.
- 4.2.6 The operator shall submit to the Environment Agency a bi-annual report of the efficiency of the biofilters in the first year of compost operations. This shall include but not be limited to, the assessment of the efficiency to reduce odours, the summary of maintenance and any re-commissioning planned or conducted, assessment of back pressure, venting and cracking. Thereafter the operator shall submit the report within one month of the end of each year, unless otherwise agreed in writing by the Environment Agency.

4.3 Notifications

- 4.3.1 For the following activities referenced in schedule 1, table S1.1A AR1 to AR7 and table S1.1B AR1 to AR9, in the event:
- (a) that the operation of the activities gives rise to an incident or accident which significantly affects or may significantly affect the environment, the operator must immediately—
 - (i) inform the Environment Agency,
 - (ii) take the measures necessary to limit the environmental consequences of such an incident or accident, and
 - (iii) take the measures necessary to prevent further possible incidents or accidents;
 - (b) of a breach of any permit condition the operator must immediately—
 - (i) inform the Environment Agency, and
 - (ii) take the measures necessary to ensure that compliance is restored within the shortest possible time;
 - (c) of a breach of permit condition which poses an immediate danger to human health or threatens to cause an immediate significant adverse effect on the environment, the operator must immediately suspend the operation of the activities or the relevant part of it until compliance with the permit conditions has been restored.
- 4.3.2 Any information provided under condition 4.3.1 (a)(i), or 4.3.1 (b)(i) where the information relates to the breach of a limit specified in the permit, shall be confirmed by sending the information listed in schedule 5 to this permit within the time period specified in that schedule.
- 4.3.3 For the following activities referenced in schedule 1, table S1.1A AR8 and table S1.1B AR10, the Environment Agency shall be notified without delay following the detection of:

- (a) any malfunction, breakdown or failure of equipment or techniques, accident, or emission of a substance not controlled by an emission limit which has caused, is causing or may cause significant pollution;
 - (b) the breach of a limit specified in the permit; or
 - (c) any significant adverse environmental effects.
- 4.3.4 Any information provided under condition 4.3.3 shall be confirmed by sending the information listed in schedule 5 to this permit within the time period specified in that schedule.
- 4.3.5 Where the Environment Agency has requested in writing that it shall be notified when the operator is to undertake monitoring and/or spot sampling, the operator shall inform the Environment Agency when the relevant monitoring and/or spot sampling is to take place. The operator shall provide this information to the Environment Agency at least 14 days before the date the monitoring is to be undertaken.
- 4.3.6 The Environment Agency shall be notified within 14 days of the occurrence of the following matters, except where such disclosure is prohibited by Stock Exchange rules:
- Where the operator is a registered company:
- (a) any change in the operator's trading name, registered name or registered office address; and
 - (b) any steps taken with a view to the operator going into administration, entering into a company voluntary arrangement or being wound up.
- Where the operator is a corporate body other than a registered company:
- (a) any change in the operator's name or address; and
 - (b) any steps taken with a view to the dissolution of the operator.
- In any other case:
- (a) the death of any of the named operators (where the operator consists of more than one named individual);
 - (b) any change in the operator's name(s) or address(es); and
 - (c) any steps taken with a view to the operator, or any one of them, going into bankruptcy, entering into a composition or arrangement with creditors, or, in the case of them being in a partnership, dissolving the partnership.
- 4.3.7 Where the operator proposes to make a change in the nature or functioning, or an extension of the activities, which may have consequences for the environment and the change is not otherwise the subject of an application for approval under the Regulations or this permit:
- (a) the Environment Agency shall be notified at least 14 days before making the change; and
 - (b) the notification shall contain a description of the proposed change in operation.
- 4.3.8 The Environment Agency shall be given at least 14 days notice before implementation of any part of the site closure plan.

4.4 Interpretation

- 4.4.1 In this permit the expressions listed in schedule 6 shall have the meaning given in that schedule.
- 4.4.2 For the following activities referenced in schedule 1, table S1.1A AR1 to AR7 and table S1.1B AR1 to AR9, in this permit references to reports and notifications mean written reports and notifications, except where reference is made to notification being made "immediately", in which case it may be provided by telephone.
- 4.4.3 For the following activities referenced in schedule 1, table S1.1A AR8 and table S1.1B AR10, in this permit references to reports and notifications mean written reports and notifications, except where

reference is made to notification being made “without delay”, in which case it may be provided by telephone.

Schedule 1 – Operations

Table S1.1A Current Activities			
Activity reference	Activity listed in Schedule 1 of the EP Regulations	Description of specified activity and WFD Annex I and II operations	Limits of specified activity and waste types
AR1	S5.4 A(1) (b) (i) Recovery or a mix of recovery and disposal of non hazardous waste with a capacity exceeding 75 tonnes per day involving biological treatment	R3: Recycling/reclamation of organic substances which are not used as solvents	<p>From receipt of permitted waste through to composting and recovery of by-products.</p> <p>Composting of waste under aerobic conditions in closed composting reactors or in closed vessels/buildings fitted with appropriate odour abatement.</p> <p>Maturation of waste in windrows located within the area as shown on the site plan in Schedule 7A.</p> <p>Waste types suitable for acceptance are limited to those specified in Table S2.2.</p>
Directly Associated Activity			
AR2	Storage of waste pending recovery or disposal	R13: Storage of waste pending the R3 operation (excluding temporary storage, pending collection, on the site where it is produced)	<p>From the receipt of waste to despatch for composting or despatch off site for recovery and/or disposal.</p> <p>Storage of waste in an enclosed building fitted with appropriate odour abatement and on an impermeable surface with sealed drainage.</p> <p>Waste types suitable for acceptance are limited to those specified in Table S2.2.</p>
AR3	Physical treatment for the purposes of recycling	R3: Recycling/reclamation of organic substances which are not used as solvents	<p>From the receipt of waste to despatch for composting or despatch off site for recovery.</p> <p>Pre-treatment of waste prior to composting in an enclosed building and on an impermeable surface</p>

Table S1.1A Current Activities			
Activity reference	Activity listed in Schedule 1 of the EP Regulations	Description of specified activity and WFD Annex I and II operations	Limits of specified activity and waste types
			<p>including shredding and screening.</p> <p>Post-treatment of processed compost on a maturation pad with an impermeable surface including screening to remove contraries.</p> <p>Waste types suitable for acceptance are limited to those specified in Table S2.2.</p>
AR4	Raw material storage	Storage of raw materials	From the receipt of raw materials to despatch for use within the facility.
AR5	Compost storage	Storage of processed compost on an open maturation pad with an impermeable surface	From the receipt of processed compost produced at the facility to despatch for use off-site.
AR6	Process water collection and storage.	Collection and storage of dirty surface water and compost liquor/leachate in 4 storage tanks. Maturation pad runoff water drains to a leachate lagoon.	From the receipt of compost leachate produced at the facility to despatch for treatment at the facility or despatch off site for recovery or disposal.
AR7	Surface water collection and storage.	Collection and storage of uncontaminated roof and site surface water is managed separately to that which lands on process areas. It is collected through the roof drainage system and directed to the rain water recycling facility. There are three holding tanks for rainwater which is captured and used as washdown waters for processing areas. Excess water is directed through an underground drainage pipe connecting to the surface water drainage system.	From the collection of uncontaminated roof and site surface water from non-operational areas only to re-use within the facility or discharge offsite.
Activity reference	Description of activities for waste operations		Limits of activities
AR8	R13: Storage of waste pending any of the operations numbered R1 to R12 (excluding temporary storage, pending collection, on the site where it is produced).		<p>Storage of waste prior to transfer off-site for the purpose of recovery.</p> <p>Waste types as specified in Table S2.5.</p>

Table S1.1A Current Activities			
Activity reference	Activity listed in Schedule 1 of the EP Regulations	Description of specified activity and WFD Annex I and II operations	Limits of specified activity and waste types
			<p>Storage limited to a maximum of 30 tonnes at any one time in the area outlined in green on the site plan in Schedule 7A and labelled as 'waste transfer facility'.</p> <p>Wastes shall be stored for no longer than 24 hours.</p>

Table S1.1B Proposed Activities			
Activity reference	Activity listed in Schedule 1 of the EP Regulations	Description of specified activity and WFD Annex I and II operations	Limits of specified activity and waste types
AR1	S5.4 A (1) (b) (i) Recovery or a mix of recovery and disposal of non-hazardous waste with a capacity exceeding 75 tonnes per day involving biological treatment.	<p>Open windrow composting (North side of facility)</p> <p>R3: Recycling/reclamation of organic substances which are not used as solvents</p>	<p>From receipt of waste through to composting and recovery of by-products.</p> <p>Composting of waste under aerobic conditions in open systems such as outdoor turned windrows or aerated static piles on impermeable surface with sealed drainage system.</p> <p>Waste types suitable for acceptance are limited to those specified in Table S2.3.</p>
AR2	S5.4 A (1) (b) (i) Recovery or a mix of recovery and disposal of non-hazardous waste with a capacity exceeding 75 tonnes per day involving biological treatment.	<p>In-vessel composting of municipal solid waste (MSW) fines and other biodegradable wastes (South side of facility)</p> <p>R3: Recycling/reclamation of organic substances which are not used as solvents</p>	<p>From receipt of waste through to sanitisation and stabilisation of mixed MSW fines and other biodegradable wastes to despatch of resultant compost-like output (CLO) waste off-site.</p> <p>Sanitisation and stabilisation of waste under aerobic conditions in closed composting reactors or in closed vessels/buildings fitted with appropriate odour abatement.</p> <p>Waste types suitable for acceptance are limited to those specified in Table S2.4.</p>
	Directly Associated Activity		
AR3	Storage of waste pending recovery	R13: Storage of waste pending the R3 operation (excluding temporary storage, pending collection,	Undertaken in relation to AR1 – Open windrow composting process on the North side of the facility:-

Table S1.1B Proposed Activities			
Activity reference	Activity listed in Schedule 1 of the EP Regulations	Description of specified activity and WFD Annex I and II operations	Limits of specified activity and waste types
		on the site where it is produced)	<p>From the receipt of waste to despatch for composting or despatch off-site for recovery.</p> <p>Storage of waste on an impermeable surface with sealed drainage.</p> <p>Waste types suitable for acceptance are limited to those specified in Table S2.3.</p> <p>Waste shall not be stored for more than 48 hours prior to treatment.</p> <p>Undertaken in relation to AR2 – In-vessel composting of MSW fines on the South side of the facility:-</p> <p>From the receipt of waste to despatch for composting or despatch off site for recovery.</p> <p>Storage of waste in an enclosed building fitted with appropriate odour abatement and on an impermeable surface with sealed drainage.</p> <p>Waste types suitable for acceptance are limited to those specified in Table S2.4.</p> <p>Waste shall not be stored for more than 48 hours prior to treatment.</p>
AR4	Physical treatment for the purposes of recycling	R3: Recycling/reclamation of organic substances which are not used as solvents	<p>Undertaken in relation to AR1 – Open windrow composting process on the North side of the facility:-</p> <p>From the receipt of waste to despatch for composting or despatch off site for recovery.</p> <p>Pre-treatment of waste prior to composting on an impermeable surface including shredding.</p>

Table S1.1B Proposed Activities			
Activity reference	Activity listed in Schedule 1 of the EP Regulations	Description of specified activity and WFD Annex I and II operations	Limits of specified activity and waste types
			<p>Post-treatment of processed compost on an impermeable surface including screening to remove contraries.</p> <p>Waste types suitable for acceptance are limited to those specified in Table S2.3.</p> <p>Undertaken in relation to AR2 – In-vessel composting of MSW fines on the South side of the facility:-</p> <p>From the receipt of waste to despatch for composting or despatch off site for recovery.</p> <p>Pre-treatment of waste prior to composting on an impermeable surface including shredding.</p> <p>Post-treatment of processed sanitised and stabilised CLO waste on an impermeable surface including screening to remove contraries.</p> <p>Pre-treatment of waste prior to composting and post-treatment of processed sanitised and stabilised CLO waste shall be undertaken within the reception area for MSW fines in the Reception Building on the South side of the facility.</p> <p>Waste types suitable for acceptance are limited to those specified in Table S2.4.</p>
AR5	Raw material storage	Storage of raw materials including lubrication oil, scrubber liquid (water), antifreeze, diesel.	<p>Undertaken in relation to Activity AR1 and AR2:-</p> <p>From the receipt of raw materials to despatch for use within the facility.</p>
AR6	Storage of processed materials – uncertified compost (Non-PAS 100 compliant) and CLO waste	R13: Storage of waste pending any of the operations numbered R1 to R12 (excluding temporary storage, pending collection, on the site where it is produced)	<p>Undertaken in relation to AR1 – Open windrow composting process on the North side of the facility:-</p> <p>From the receipt of processed uncertified compost (Non-PAS 100 compliant) produced at the</p>

Table S1.1B Proposed Activities			
Activity reference	Activity listed in Schedule 1 of the EP Regulations	Description of specified activity and WFD Annex I and II operations	Limits of specified activity and waste types
			<p>facility to despatch off-site for recovery.</p> <p>Storage of processed uncertified compost on an impermeable surface.</p> <p>Undertaken in relation to AR2 – In-vessel composting of MSW fines on the South side of the facility:-</p> <p>From the receipt of processed post sanitised and stabilised CLO waste into Area 3 of the reception building to despatch off-site for recovery.</p> <p>Storage of processed post sanitised and stabilised CLO waste on an impermeable surface.</p> <p>Storage of processed post sanitised and stabilised CLO waste on site shall be no longer than 3 months.</p>
AR7	Process water collection and storage	Collection and storage of leachate from treatment of waste.	<p>Undertaken in relation to AR1 – Open windrow composting process on the North side of the facility:-</p> <p>From the receipt of compost leachate produced at the open windrow composting process to despatch off-site for recovery or disposal.</p> <p>Undertaken in relation to AR2 – In-vessel composting of MSW fines on the South side of the facility:-</p> <p>From the receipt of leachate produced at the in-vessel composting process to despatch off-site for recovery or disposal.</p>
AR8	Surface water collection and storage	Collection and storage of uncontaminated roof and site surface water.	Undertaken in relation to AR1 – Open windrow composting process on the North side of the facility:-

Table S1.1B Proposed Activities			
Activity reference	Activity listed in Schedule 1 of the EP Regulations	Description of specified activity and WFD Annex I and II operations	Limits of specified activity and waste types
			<p>From the collection of uncontaminated roof and site surface water from non-operational areas of the open windrow process to storage in 2 tanks and re-use within the facility or despatch off-site.</p> <p>Undertaken in relation to AR2 – In-vessel composting of MSW fines on the South side of the facility:-</p> <p>From the collection of uncontaminated roof and site surface water from non-operational areas of the in-vessel composting process to storage in 3 tanks and re-use within the South side of the site in the in-vessel composting side of the regulated facility or despatch off-site.</p>
AR9	Air treatment	Collection and treatment of air from the buildings or plant using abatement system – wet scrubber and two open biofilters prior to release to atmosphere.	<p>Undertaken in relation to AR2 – In-vessel composting of MSW fines on the South side of the facility:-</p> <p>From the collection of air from the reception building and in-vessels units to treatment in a wet scrubber and two open bed biofilters and release of treated air to atmosphere.</p>
Activity reference	Description of activities for waste operations		Limits of activities
AR10	<p>Waste Transfer Station</p> <p>R13: Storage of waste pending any of the operations numbered R1 to R12 (excluding temporary storage, pending collection, on the site where it is produced)</p>		<p>Storage of waste in the Waste Transfer Area on the South side of the facility prior to transfer off-site for the purpose of recovery:-</p> <p>From the receipt of waste at the facility to storage in the Waste Transfer Area in the reception building in separated Area 2 and despatch off-site.</p> <p>Waste types as specified in Table 2.5.</p> <p>Storage limited to a maximum of 30 tonnes at any one time. Waste shall be stored in this area for no longer than 24 hours.</p> <p>Collection of air from the Waste Transfer Area in the reception building to treatment in a wet</p>

Table S1.1B Proposed Activities			
Activity reference	Activity listed in Schedule 1 of the EP Regulations	Description of specified activity and WFD Annex I and II operations	Limits of specified activity and waste types
			scrubber and two open bed biofilters prior to release of treated air to atmosphere.

Table S1.2 Operating techniques		
Description	Parts	Date Received
Application	The operating techniques contained within the operator's original permit application documentation and any additional documentation addressing operating techniques contained in any subsequent variation application documentation, where applicable.	25/09/2007
Environment Agency Request	Odour Management Plan (March 2013, version 2)	12/05/2014
Application	Document 'WLC01' - Fugitive Emissions Management Plan. Document 'WLC013' - Noise and Vibration Management Plan.	10/12/2015
	Section 3a – technical standards, Part B4 of the application form. Document 'WLC15' - Site Plan.	19/02/2016
Response to Schedule 5 Notice dated 16/03/16	Response to questions 16 to 23 providing appropriate risk management measures in an updated H1 Risk Assessment. Document 'WLC02' - Management System for the waste transfer facility. Document 'WLC12' - Drainage and Leachate Management Plan. Document 'WLC03' - Odour Management Plan for the waste transfer facility. Document 'WLC06' - Accident Management Plan.	12/04/2016
Response to requests for further information dated 27/04/16 and 28/04/16	Responses to questions regarding site plans, the quarantine area, hazardous wastes, the area receiving leachate and leachate transfer.	05/05/2016
Application	Responses to questions 3d and 4 of Application Form C2.	23/10/2017
Response to Schedule 5 Notice dated 11/05/2018	WLC08 - Drainage Management Plan Issue 03 WLC_006 - North Site drainage plan	22/06/2018
	OPO2 Version 3: Waste Acceptance Procedure, excluding Annex A and B Jacobs Framework Assessment Report	24/08/2018
Response to Schedule 5	WLC05 – Site Capacity Assessment Issue 2 OP06 – Clean Down Procedure Issue 01	04/10/2018

Notice dated 20/09/2018	Response to question 7 of Third Schedule 5 Notice Accompanying Document.	
Additional information received	OP07 – Fines Management Plan Issue 2	26/10/2018
Response to Schedule 5 Notice dated 14/01/2019	WLC_004c - North Site Location and Layout Plan WLC_003c – South Site Location and Layout Plan WLC_007 Site Location Plan Operating techniques described in the responses to the Notice: Response 3 (odour management on site), Response 4 (site recording of waste movement) Response 9 (waste recording and tracking) Response 11 (mixing of MSW fines) Response 12 (destination of bulking material)	12/02/2019
Additional Information Received	WLC13 Fire Prevention Plan Issue 05 WLC03 Accident Management Plan Issue 4 WLC07 Odour Management Plan Issue 9 WLC10 BAT Assessment Issue 5	25/04/2019
Additional Information Received	WLC_005b – South Site Drainage Plan Amended	21/05/2019

Table S1.3 Improvement programme requirements		
Reference	Requirement	Date
IC1	Following the completion of PO1, an updated Odour Management Plan shall be written and approved by the Environment Agency.	3 months from commissioning the MSW fines in-vessel abatement unit
IC2	The operator shall submit revised written procedures for approval to meet all the relevant BAT requirements for Management Systems as detailed in Environment Agency's draft guidance <i>How to comply with your environmental permit. Additional technical guidance for: composting and aerobic treatment sector (LIT 8705 Report version 1.0 and Sector Guidance Note IPPC S5.06 – Guidance for the Treatment of Hazardous and Non-Hazardous Waste</i> . The procedures must cover all activities in table S1.1B AR1 to AR10, and must contain dates for implementation of individual measures.	27/09/2019
IC3	Following the completion of PO1 and PO2, the operator shall carry out a review of the AR9 odour abatement systems listed in table S1.1B in order to determine whether the systems have been effective in minimising odorous emissions. The operator shall submit a written report to the Environment Agency following this review for written approval.	6 months from completion of commissioning the MSW fines in-vessel

Table S1.3 Improvement programme requirements		
Reference	Requirement	Date
	<p>This report shall include the following:</p> <ul style="list-style-type: none"> • A minimum of 2 months of daily odour monitoring results at the site boundary • For each odour abatement system, at least three inlet and outlet monitoring results for all odorous compounds shall be taken during full operation using MCERTS methods and in line with M2 monitoring guidance. • For each odour abatement system, based on inlet and outlet monitoring, calculations of the percentage treatment efficiency for each odorous component of the gas stream shall be provided and compared to the percentage treatment efficiencies stated in application EPR/UP3893EC/V007. • Process monitoring results including temperature, moisture, conductivity, air flow and pH shall be provided and compared to process monitoring figures stated in application EPR/UP3893EC/V007. • Recommendations for improvement <p>In the event:</p> <ul style="list-style-type: none"> • odour is detected at the boundary of the site; or • inlet and outlet monitoring and/or process monitoring does not indicate effective BAT treatment of odour in line with the efficiency and process monitoring figures stated in application EPR/UP3893EC/V007; or • improvements are identified <p>The report shall include timescales for implementation of improvements to the abatement system for agreement with the Environment Agency. The operator shall implement the improvements in line with the timescales agreed with the Environment Agency.</p>	abatement unit.
IC4	<p>The operator shall undertake a review of the drainage management systems on site, and submit a report to the Environment Agency, detailing the findings of the review. The report must include but not be limited to:</p> <ul style="list-style-type: none"> • A detailed description of how drainage is managed at the facility. • A description of site drainage streams, how these streams are categorised (contaminated and uncontaminated) and justification as to why they have been classified as such. • The location of all emissions points to land or water and sources of the various streams. • Details of any interceptors or screens on site and the streams they serve. • A description of the routing of all the Installation's drains and subsurface pipework including any interconnection and link between the drains and pipework. <p>The report must be supported by updated site drainage plans (north and south) showing the location of the surface water drainage, foul sewer</p>	27/12/2019

Table S1.3 Improvement programme requirements		
Reference	Requirement	Date
	drainage and process water drainage. The site drainage plans must be accurately drawn to scale, labelled and dated. The plans must clearly show all drainage structures and directions of drainage flow in line with information presented in the report.	

Table S1.4 Pre-operational measures	
Reference	Pre-operational measures
1	<p>Prior to the acceptance and processing of municipal solid waste (MSW) fines (Activity reference AR2, Table S1.1B), the operator shall submit to the Environment Agency, a written report on the odour abatement systems proposed to serve the:</p> <ul style="list-style-type: none"> • sanitisation and stabilisation of MSW fines processed in each in-vessel composting unit and • reception building areas where: <ul style="list-style-type: none"> ○ MSW are unloaded, accepted and pre-treated prior to loading into the in-vessel composting units, and ○ the sanitised and stabilised compost-like output produced from the sanitised and stabilised MSW are stored prior to removal off site, and ○ the waste transfer station is operated in the reception building. <p>The report shall comprise a detailed description of each odour abatement system, the operational design parameters, the monitoring of process parameters and a demonstration of how the system will effectively abate odorous emissions from the proposed in-vessel composting process, storage of MSW fines and waste transfer station.</p> <p>The report must include but not be limited to:</p> <ul style="list-style-type: none"> • Expected content of odorous emissions from the treatment and storage process, pre and post each abatement treatment stage. • Details (with evidence) of why each systems' design will allow effective treatment of all odorous components contained within the emissions. • Details (with evidence) of the optimum process operational parameters for the different abatement systems and why this will ensure effective treatment of all odorous components within the emissions. • Expected odour emissions concentrations to be released from the abatement systems' stack, and emission points. • How the abatement systems will be maintained to remain effective. • The process monitoring regime to be used to demonstrate that the operation remains at an optimum. • Contingency measures in place to bring the process back under control in the event of abatement failure. <p>Where the operator proposes an odour abatement design or process parameter not supported by the Environment Agency's draft guidance <i>How to comply with your environmental permit. Additional technical guidance for: composting and aerobic treatment sector (LIT 8705 Report version 1.0)</i>, the operator shall justify this deviation with a Best Available Techniques demonstration supported by scientific evidence.</p>

Table S1.4 Pre-operational measures	
Reference	Pre-operational measures
	<p>If it is shown that the proposed odour abatement design or parameter will not result in considerable abatement or reduction of the odorous emissions from the treatment process, the operator shall carry out further investigation and propose to the Environment Agency for written approval, further mitigation in the form of additional abatement or change of design or process operational parameters supported by a Best Available Techniques demonstration and scientific evidence, to ensure that the proposed treatment process shall not result in odour pollution at sensitive receptors off-site.</p> <p>This condition will be considered complete when the final report and any identified improvement have been approved by the Environment Agency.</p>
2	<p>At least 8 weeks (or any other date as agreed with the Environment Agency) prior to the commencement of commissioning of all odour abatement units, the operator shall provide a written commissioning plan (including timescales for completion) for approval by the Environment Agency.</p> <p>The commissioning plan shall include:</p> <ul style="list-style-type: none"> • the expected emissions to the environment during the different stages of commissioning, • the expected durations of commissioning activities and • the measures to be taken to protect the environment and report to the Environment Agency in the event that actual emissions exceed expected emissions. • Emissions testing, to MCERTS standard for both sampling and testing and personnel, a demonstration of the effectiveness of each abatement system which will include parallel pre and post abatement testing of emissions, and will include testing and measurement of odour, NH₃, H₂S and speciation of VOCs from each odour abatement unit in accordance with technical guidance note M2 standards. • Smoke testing of the air extraction system in the reception building and each in-vessel composting unit to demonstrate effectiveness of air extraction systems. <p>Commissioning shall be carried out in accordance with the commissioning plan as approved by the Environment Agency.</p> <p>As part of commissioning, the operator shall, on an agreed upon date, with the Regulatory Officer in attendance, demonstrate through a smoke test that the reception building, odour abatement and all associated pipes and vessels are fit for purpose and will prevent the release of odour emissions to the atmosphere.</p> <p>Municipal solid waste fines shall not be accepted at the installation unless the Environment Agency has given prior written permission under this condition.</p>
3	<p>At least 8 weeks (or any other date as agreed with the Environment Agency) prior to the commencement of the open windrow composting activity (Activity reference AR1, Table S1.1B), the operator shall ensure that a review of the design, method of construction and integrity of the proposed north site secondary containment is carried out by a qualified civil or structural engineer. The review shall compare the constructed secondary containment against the standards set out in <i>How to comply with your environmental permit. Additional technical guidance for: composting and aerobic treatment sector (LIT 8705 Report version 1.0)</i> and CIRIA C736 – Containment</p>

Table S1.4 Pre-operational measures	
Reference	Pre-operational measures
	<p>Systems for the Prevention of Pollution – secondary, tertiary and other measures for industrial and commercial premises or other relevant industry standard.</p> <p>The review shall include:</p> <ul style="list-style-type: none"> • physical condition of the secondary containment • the suitability for containment when subjected to the dynamic and static loads caused by catastrophic tank failure; • any work required to ensure compliance with the standards set out in CIRIA C736 or other relevant industry standard; and • a preventative maintenance and inspection regime <p>A written report of the review shall be submitted to the Environment Agency for approval detailing the review's findings and recommendations. Remedial action shall be taken to ensure that the secondary containment meets the standards set out in the guidance documents and implement the maintenance and inspection regime.</p> <p>The new open windrow composting activity shall not commence at the facility unless the Environment Agency has given prior written permission under this condition.</p>
4	<p>Prior to the commencement of processing of municipal solid wastes fines and the open windrow operations (Activity reference AR1 and AR2, Table S1.1B), the operator shall submit a report to the Environment Agency for approval detailing the design specifications and construction details of the acoustic barrier proposed within the Noise Impact Assessment Report number P19-065-R01v3 submitted to the Environment Agency on 02/04/2019.</p> <p>The report must be written by an experienced and suitably qualified person in accordance with the procedures given in BS4142:2014 and must also demonstrate that the barrier will adhere to the recommendations specified in the Noise Impact Assessment Report P19-065-R01v3 and our Horizontal Guidance for Noise Part 2 – Noise Assessment and Control, section 3.2.2.2: Sound attenuation by barriers.</p> <p>The report must also contain information to demonstrate that the barrier provides the 11 dB attenuation predicted in the noise impact assessment report P19-065-R01v3.</p>
5	<p>At least 8 weeks (or any other date as agreed with the Environment Agency) prior to the commencement of processing of municipal solid wastes fines (Activity reference AR2, Table S1.1B), the operator shall ensure that the existing areas used for the acceptance, pre-treatment, storage and treatment (including the in-vessel units) of wastes have been cleaned down and all existing waste and non-waste (PAS 100) output removed.</p> <p>The new processing of municipal solid wastes fines activity shall not commence at the facility unless the Environment Agency has given prior written permission under this condition.</p>

Schedule 2 – Waste types, raw materials and fuels

Table S2.1 Raw materials and fuels	
Raw materials and fuel description	Specification
--	--

Table S2.2 Permitted waste types and quantities for composting in closed systems (Activity reference AR1, Table S1.1A) – Current Activity	
Maximum quantity	Annual throughput shall not exceed 75,000 tonnes.
Exclusions	Wastes having any of the following characteristics shall not be accepted: <ul style="list-style-type: none"> - consisting solely or mainly of dusts (except sawdust), powders, or loose fibres - wastes containing treated wood, wood-preserving agents or other biocides, persistent organic pollutants, Japanese Knotweed - hazardous wastes
Waste code	Description
02	Wastes from agriculture, horticulture, aquaculture, forestry, hunting and fishing, food preparation and processing
02 01	wastes from agriculture, horticulture, aquaculture, forestry, hunting and fishing
02 01 02	animal-tissue waste
02 01 03	plant-tissue waste
02 01 06	animal faeces, urine and manure including spoiled straw
02 01 07	wastes from forestry comprising wood and plant tissue
02 02	wastes from the preparation and processing of meat, fish and other foods of animal origin
02 02 02	Animal tissue waste (excluding animal blood)
02 02 03	Shells from shellfish processing (where all the flesh has been removed)
02 02 99	Horse manure, farmyard manure and bedding
02 03	wastes from fruit, vegetables, cereals, edible oils, cocoa, coffee, tea and tobacco preparation and processing; conserve production; yeast and yeast extract production, molasses preparation and fermentation
02 03 04	Biodegradable materials unsuitable for consumption or processing (other than those containing dangerous substances)
02 05	wastes from the dairy products industry
02 05 01	Biodegradable materials unsuitable for consumption or processing (other than those containing dangerous substances)
02 06	wastes from the baking and confectionery industry
02 06 01	Biodegradable materials unsuitable for consumption or processing (other than those containing dangerous substances)
02 07	wastes from the production of alcoholic and non-alcoholic beverages (except coffee, tea and cocoa)
02 07 01	wastes from washing, cleaning and mechanical reduction of raw materials
02 07 02	wastes from spirits distillation
02 07 04	materials unsuitable for consumption or processing

Table S2.2 Permitted waste types and quantities for composting in closed systems (Activity reference AR1, Table S1.1A) – Current Activity	
Maximum quantity	Annual throughput shall not exceed 75,000 tonnes.
Exclusions	Wastes having any of the following characteristics shall not be accepted: <ul style="list-style-type: none"> - consisting solely or mainly of dusts (except sawdust), powders, or loose fibres - wastes containing treated wood, wood-preserving agents or other biocides, persistent organic pollutants, Japanese Knotweed - hazardous wastes
Waste code	Description
02 07 99	Wastes not otherwise specified (malt husks, hops, spent grains, sludge from the production process, yeast and yeast-like residues, biodegradable material only)
03	Wastes from wood processing and the production of panels and furniture, pulp, paper and cardboard
03 01	wastes from wood processing and the production of panels and furniture, pulp, paper and cardboard
03 01 01	waste bark and cork
03 01 05	sawdust, shavings, cuttings, wood, particle board and veneer other than those mentioned in 03 01 04 only
03 03	wastes from pulp, paper and cardboard production and processing
03 03 01	waste bark and wood
03 03 10	fibre rejects not containing hazardous substances
04	Wastes from the leather, fur and textile industries
04 01	wastes from the leather and fur industry
04 01 01	fleshings and lime split wastes <i>Restriction: fleshings may also be described as leather shavings. Allowed only if hides and skins, or parts of them, originating from animals that did not show clinical signs of any disease communicable through that product to humans or animals</i>
04 02	wastes from the textile industry
04 02 10	organic matter from natural products (<i>for example grease, wax, biodegradable material only</i>)
15	Waste packaging, absorbents, wiping cloths, filter materials and protective clothing not otherwise specified
15 01	packaging (including separately collected municipal packaging waste)
15 01 01	paper and cardboard packaging <i>Restriction: not permitted if any non-biodegradable coating or preserving substance is present</i>
15 01 02	plastic packaging (biodegradable only)
15 01 03	wooden packaging untreated
15 01 05	composite packaging (<i>biodegradable organic packaging only</i>)
15 01 09	textile packaging <i>Restriction: allowed only if entirely natural fibres</i>
17	Construction and demolition wastes (including excavated soil from contaminated sites)
17 02	wood, glass and plastic
17 02 01	Wood (<i>Untreated</i>)

Table S2.2 Permitted waste types and quantities for composting in closed systems (Activity reference AR1, Table S1.1A) – Current Activity	
Maximum quantity	Annual throughput shall not exceed 75,000 tonnes.
Exclusions	Wastes having any of the following characteristics shall not be accepted: <ul style="list-style-type: none"> - consisting solely or mainly of dusts (except sawdust), powders, or loose fibres - wastes containing treated wood, wood-preserving agents or other biocides, persistent organic pollutants, Japanese Knotweed - hazardous wastes
Waste code	Description
17 05	soil (including excavated soil from contaminated sites), stones and dredging spoil
17 05 06	Dewatered dredging spoil and plant tissue waste from inland waters, not containing Japanese Knotweed and not containing dangerous substances
19	Wastes from waste management facilities, off-site waste water treatment plants and the preparation of water intended for human consumption and water for industrial use
19 05	wastes from aerobic treatment of solid wastes
19 05 03	off-specification compost (only from a process operated according to PAS 100 and QP requirements or another approved standard)
19 05 99	Wastes not otherwise specified (liquor or leachate from a composting process that accepts only the input wastes allowed by the quality protocol)
19 06	wastes from anaerobic treatment of waste
19 06 03	liquor from anaerobic treatment of municipal waste <i>Restriction: allowed only if derived from input types allowed by the Anaerobic Digestate Quality Protocol and are derived from a facility independently certified as complying with BSI PAS 110</i>
19 06 04	digestate from anaerobic treatment of municipal waste <i>Restriction: allowed only if derived from input types allowed by the Anaerobic Digestate Quality Protocol and are derived from a facility independently certified as complying with BSI PAS 110</i>
19 06 05	liquor from anaerobic treatment of animal and vegetable waste <i>Restriction: allowed only if derived from input types allowed by the Anaerobic Digestate Quality Protocol and are derived from a facility independently certified as complying with BSI PAS 110</i>
19 06 06	digestate from anaerobic treatment of animal and vegetable waste <i>Restriction: allowed only if derived from input types allowed by the Anaerobic Digestate Quality Protocol and are derived from a facility independently certified as complying with BSI PAS 110</i>
20	Municipal wastes (household waste and similar commercial, industrial and institutional wastes) including separately collected fractions
20 01	separately collected fractions (except 15 01)
20 01 01	paper and cardboard <i>Restriction: not allowed if any non-biodegradable coating or preserving substance present</i>
20 01 08	biodegradable kitchen and canteen waste
20 01 25	edible oil and fat
20 01 38	wood other than that mentioned in 20 01 37 <i>Restriction: not allowed if any non-biodegradable coating or preserving substance is present.</i>

Table S2.2 Permitted waste types and quantities for composting in closed systems (Activity reference AR1, Table S1.1A) – Current Activity	
Maximum quantity	Annual throughput shall not exceed 75,000 tonnes.
Exclusions	Wastes having any of the following characteristics shall not be accepted: <ul style="list-style-type: none"> - consisting solely or mainly of dusts (except sawdust), powders, or loose fibres - wastes containing treated wood, wood-preserving agents or other biocides, persistent organic pollutants, Japanese Knotweed - hazardous wastes
Waste code	Description
20 01 39	plastics <i>only if independently certified to BS EN 14995</i>
20 02	garden and park wastes (including cemetery waste)
20 02 01	biodegradable waste comprising wood and plant tissue
20 03	other municipal wastes
20 03 02	Biodegradable waste from markets

Table S2.3 Permitted waste types and quantities for composting in open systems (Activity reference AR1, Table S1.1B) – Proposed Activity	
Maximum quantity	Annual throughput shall not exceed 50,000 tonnes.
Exclusions	Wastes having any of the following characteristics shall not be accepted: <ul style="list-style-type: none"> - consisting solely or mainly of dusts (except sawdust), powders, or loose fibres; - catering waste or other wastes containing animal by-products covered by the Animal By-Products Regulations; - wastes that are in a form which is liquid; - wastes containing treated wood, wood-preserving agents or other biocides, persistent organic pollutants, Japanese Knotweed; - hazardous wastes
Waste code	Description
02	Wastes from agriculture, horticulture, aquaculture, forestry, hunting and fishing, food preparation and processing
02 01	wastes from agriculture, horticulture, aquaculture, forestry, hunting and fishing
02 01 03	plant-tissue waste
02 01 06	animal faeces, urine and manure (including spoiled straw) only
02 01 07	wastes from forestry (biodegradable only)
02 01 99	wastes not otherwise specified (spent mushroom compost and fully biodegradable bedding only)
02 03	wastes from fruit, vegetables, cereals, edible oils, cocoa, coffee, tea and tobacco preparation and processing; conserve production; yeast and yeast extract production, molasses preparation and fermentation
02 03 04	materials unsuitable for consumption or processing (biodegradable only)
02 07	wastes from the production of alcoholic and non-alcoholic beverages (except coffee, tea and cocoa)
02 07 01	wastes from washing, cleaning and mechanical reduction of raw materials (biodegradable only)
02 07 02	wastes from spirits distillation (biodegradable only)

Table S2.3 Permitted waste types and quantities for composting in open systems (Activity reference AR1, Table S1.1B) – Proposed Activity	
Maximum quantity	Annual throughput shall not exceed 50,000 tonnes.
Exclusions	Wastes having any of the following characteristics shall not be accepted: <ul style="list-style-type: none"> - consisting solely or mainly of dusts (except sawdust), powders, or loose fibres; - catering waste or other wastes containing animal by-products covered by the Animal By-Products Regulations; - wastes that are in a form which is liquid; - wastes containing treated wood, wood-preserving agents or other biocides, persistent organic pollutants, Japanese Knotweed; - hazardous wastes
Waste code	Description
02 07 04	materials unsuitable for consumption or processing (biodegradable only)
02 07 99	wastes not otherwise specified (malt husks, malt sprouts, yeast and yeast-like residues only)
03	Wastes from wood processing and the production of panels and furniture, pulp, paper and cardboard
03 01	wastes from wood processing and the production of panels and furniture
03 01 01	waste bark and cork
03 01 05	sawdust, shavings, cuttings, wood and particle board other than those mentioned in 03 01 04 only
03 03	wastes from pulp, paper and cardboard production and processing
03 03 01	waste bark and wood
03 03 10	fibre rejects only
04	Wastes from the leather, fur and textile industries
04 02	wastes from the textile industry
04 02 10	organic matter from natural products (un-dyed and untreated only)
07	Wastes from organic chemical processes
07 02	wastes from the MFSU of plastics, synthetic rubber and man-made fibres
07 02 13	waste plastic (compostable plastics only, unused and uncontaminated excess production only)
15	Waste packaging, absorbents, wiping cloths, filter materials and protective clothing not otherwise specified
15 01	packaging (including separately collected municipal packaging waste)
15 01 01	paper and cardboard packaging (excluding veneers, plastic coatings or laminates)
15 01 02	plastic packaging (compostable plastics only)
15 01 03	wooden packaging
15 01 05	composite packaging (only biodegradable organic packaging)
15 01 09	textile packaging (made entirely from biodegradable fibres only)
17	Construction and demolition wastes (including excavated soil from contaminated sites)
17 02	wood, glass and plastic
17 02 01	wood
17 05	soil (including excavated soil from contaminated sites), stones and dredging spoil

Table S2.3 Permitted waste types and quantities for composting in open systems (Activity reference AR1, Table S1.1B) – Proposed Activity	
Maximum quantity	Annual throughput shall not exceed 50,000 tonnes.
Exclusions	Wastes having any of the following characteristics shall not be accepted: <ul style="list-style-type: none"> - consisting solely or mainly of dusts (except sawdust), powders, or loose fibres; - catering waste or other wastes containing animal by-products covered by the Animal By-Products Regulations; - wastes that are in a form which is liquid; - wastes containing treated wood, wood-preserving agents or other biocides, persistent organic pollutants, Japanese Knotweed; - hazardous wastes
Waste code	Description
17 05 06	dredging spoil other than those mentioned in 17 05 05 (from inland waters only)
19	Wastes from waste management facilities, off-site waste water treatment plants and the preparation of water intended for human consumption and water for industrial use
19 02	wastes from physico/chemical treatments of waste (including dechromatation, decyanidation, neutralisation)
19 02 03	premixed wastes composed only of non-hazardous wastes (waste types listed in this table only)
19 05	wastes from aerobic treatment of solid wastes
19 05 03	off-specification compost (from a composting process that accepts waste input types listed in this table only)
19 08	wastes from waste water treatment plants not otherwise specified
19 08 05	sludges from treatment of urban waste water
19 12	wastes from the mechanical treatment of waste (for example sorting, crushing, compacting, pelletising) not otherwise specified
19 12 01	paper and cardboard (excluding veneers or plastic coatings)
19 12 07	wood other than that mentioned in 19 12 06
19 12 12	other wastes (including mixtures of materials) from mechanical treatment of wastes other than those mentioned in 19 12 11 (and only including waste types listed in this table)
20	Municipal wastes (household waste and similar commercial, industrial and institutional wastes) including separately collected fractions
20 01	separately collected fractions (except 15 01)
20 01 01	paper and cardboard (excluding veneers, plastic coatings or laminates)
20 01 38	wood other than that mentioned in 20 01 37
20 01 39	plastics (compostable plastics only)
20 02	garden and park wastes (including cemetery waste)
20 02 01	biodegradable waste (plant matter only)
20 03	other municipal wastes
20 03 02	waste from markets (biodegradable only)

Table S2.4 Permitted waste types and quantities for composting in closed systems (Activity reference AR2, Table S1.1B) – Proposed Activity	
Maximum quantity	Annual throughput shall not exceed 50,000 tonnes.
Exclusions	Wastes having any of the following characteristics shall not be accepted: - consisting solely or mainly of dusts (except sawdust), powders, or loose fibres - wastes containing treated wood, wood-preserving agents or other biocides, persistent organic pollutants, Japanese Knotweed - hazardous wastes
Waste code	Description
02	Wastes from agriculture, horticulture, aquaculture, forestry, hunting and fishing, food preparation and processing
02 01	wastes from agriculture, horticulture, aquaculture, forestry, hunting and fishing
02 01 02	animal-tissue waste
02 01 03	plant-tissue waste
02 01 06	animal faeces, urine and manure (including spoiled straw) only
02 01 07	wastes from forestry (biodegradable only)
02 02	wastes from the preparation and processing of meat, fish and other foods of animal origin
02 02 02	animal tissue waste
02 02 03	materials unsuitable for consumption or processing
02 02 99	horse manure, farmyard manure and bedding
02 03	wastes from fruit, vegetables, cereals, edible oils, cocoa, coffee, tea and tobacco preparation and processing; conserve production; yeast and yeast extract production, molasses preparation and fermentation
02 03 04	materials unsuitable for consumption or processing (biodegradable only)
02 05	wastes from the dairy products industry
02 05 01	materials unsuitable for consumption or processing (biodegradable only)
02 06	wastes from the baking and confectionery industry
02 06 01	materials unsuitable for consumption or processing (biodegradable only)
02 07	wastes from the production of alcoholic and non-alcoholic beverages (except coffee, tea and cocoa)
02 07 01	wastes from washing, cleaning and mechanical reduction of raw materials (biodegradable only)
02 07 02	wastes from spirits distillation (biodegradable only)
02 07 04	materials unsuitable for consumption or processing (biodegradable only)
02 07 99	wastes not otherwise specified (malt husks, hops, spent grains, sludge from the production process, yeast and yeast-like residues only)
03	Wastes from wood processing and the production of panels and furniture, pulp, paper and cardboard
03 01	wastes from wood processing and the production of panels and furniture, pulp, paper and cardboard
03 01 01	waste bark and cork

Table S2.4 Permitted waste types and quantities for composting in closed systems (Activity reference AR2, Table S1.1B) – Proposed Activity	
Maximum quantity	Annual throughput shall not exceed 50,000 tonnes.
Exclusions	Wastes having any of the following characteristics shall not be accepted: - consisting solely or mainly of dusts (except sawdust), powders, or loose fibres - wastes containing treated wood, wood-preserving agents or other biocides, persistent organic pollutants, Japanese Knotweed - hazardous wastes
Waste code	Description
03 01 05	sawdust, shavings, cuttings, wood and particle board other than those mentioned in 03 01 04
03 03	wastes from pulp, paper and cardboard production and processing
03 03 01	waste bark and wood
03 03 10	fibre rejects, fibre-, filler- and coating-sludges from mechanical separation
04	Wastes from the leather, fur and textile industries
04 01	wastes from the leather and fur industry
04 01 01	fleshings and lime split wastes
04 02	wastes from the textile industry
04 02 10	organic matter from natural products (un-dyed and untreated only)
15	Waste packaging, absorbents, wiping cloths, filter materials and protective clothing not otherwise specified
15 01	packaging (including separately collected municipal packaging waste)
15 01 01	paper and cardboard packaging (excluding veneers, plastic coatings or laminates)
15 01 02	plastic packaging (compostable plastics only)
15 01 03	wooden packaging
15 01 05	composite packaging (only biodegradable organic packaging)
15 01 09	textile packaging (made entirely from biodegradable fibres only)
16	Wastes not otherwise specified in the list
16 10	aqueous liquid wastes destined for off-site treatment
16 10 02	liquor/leachate from a composting process that accepts waste input types listed in this table only
17	Construction and demolition wastes (including excavated soil from contaminated sites)
17 02	wood, glass and plastic
17 02 01	wood
17 05	soil (including excavated soil from contaminated sites), stones and dredging spoil
17 05 06	dredging spoil other than those mentioned in 17 05 05 (from inland waters only)
19	Wastes from waste management facilities, off-site waste water treatment plants and the preparation of water intended for human consumption and water for industrial use
19 05	wastes from aerobic treatment of solid wastes
19 05 03	off-specification compost (only from a composting process that accepts waste input types listed in this table)

Table S2.4 Permitted waste types and quantities for composting in closed systems (Activity reference AR2, Table S1.1B) – Proposed Activity	
Maximum quantity	Annual throughput shall not exceed 50,000 tonnes.
Exclusions	Wastes having any of the following characteristics shall not be accepted: <ul style="list-style-type: none"> - consisting solely or mainly of dusts (except sawdust), powders, or loose fibres - wastes containing treated wood, wood-preserving agents or other biocides, persistent organic pollutants, Japanese Knotweed - hazardous wastes
Waste code	Description
19 06	wastes from anaerobic treatment of waste
19 06 03	liquor from anaerobic treatment of municipal waste (derived from source segregated municipal waste only)
19 06 04	digestate from anaerobic treatment of municipal waste (derived from source segregated municipal waste only)
19 06 05	liquor from anaerobic treatment of animal and vegetable waste
19 06 06	digestate from anaerobic treatment of animal and vegetable waste
19 12	wastes from the mechanical treatment of waste (for example sorting, crushing, compacting, pelletising) not otherwise specified
19 12 12	other wastes (including mixtures of materials) from mechanical treatment of wastes other than those mentioned in 19 12 11 (Consisting only of organic fines from Renewi UK Services Limited, Jenkins Lane Waste Management Facility, Barking, Essex, IG11 0AD)
19 12 12	other wastes (including mixtures of materials) from mechanical treatment of wastes other than those mentioned in 19 12 11 (Consisting only of organic fines from Renewi UK Services Limited, Frog Island Waste Management Facility, Creek Way, Rainham, RM13 8EN)
20	Municipal wastes (household waste and similar commercial, industrial and institutional wastes) including separately collected fractions
20 01	separately collected fractions (except 15 01)
20 01 01	paper and cardboard (excluding veneers, plastic coatings or laminates)
20 01 08	biodegradable kitchen and canteen waste
20 01 25	edible oil and fat
20 01 38	wood other than that mentioned in 20 01 37
20 01 39	plastics (compostable plastics only)
20 02	garden and park wastes (including cemetery waste)
20 02 01	biodegradable waste
20 03	other municipal wastes
20 03 02	waste from markets (biodegradable only)

Table S2.5 Permitted waste types and quantities for waste transfer facility (Activity reference AR8, Table S1.1A and Activity reference AR10, Table S1.1B)

Maximum quantity	Annual throughput shall not exceed 20,000 tonnes.
Exclusions	Wastes having any of the following characteristics shall not be accepted: <ul style="list-style-type: none"> - consisting solely or mainly of dusts (except sawdust), powders, or loose fibres - wastes that are in a form which is either sludge or liquid - wastes containing treated wood, wood-preserving agents or other biocides, persistent organic pollutants, Japanese Knotweed - hazardous wastes
Waste code	Description
02	Wastes from agriculture, horticulture, aquaculture, forestry, hunting and fishing, food preparation and processing
02 01	wastes from agriculture, horticulture, aquaculture, forestry, hunting and fishing
02 01 02	animal-tissue waste
02 01 03	plant-tissue waste
02 01 06	animal faeces, urine and manure including spoiled straw
02 02	wastes from the preparation and processing of meat, fish and other foods of animal origin
02 02 02	animal tissue waste (excluding animal blood)
02 02 03	shells from shellfish processing (where all the flesh has been removed)
02 02 99	horse manure, farmyard manure and bedding
02 03	wastes from fruit, vegetables, cereals, edible oils, cocoa, coffee, tea and tobacco preparation and processing; conserve production; yeast and yeast extract production, molasses preparation and fermentation
02 03 04	biodegradable materials unsuitable for consumption or processing (other than those containing dangerous substances)
02 05	wastes from the dairy products industry
02 05 01	biodegradable materials unsuitable for consumption or processing (other than those containing dangerous substances)
02 06	wastes from the baking and confectionery industry
02 06 01	biodegradable materials unsuitable for consumption or processing (other than those containing dangerous substances)
20	Municipal wastes (household waste and similar commercial, industrial and institutional wastes) including separately collected fractions
20 01	separately collected fractions (except 15 01)
20 01 08	biodegradable kitchen and canteen waste
20 01 25	edible oil and fat
20 02	garden and park wastes (including cemetery waste)
20 02 01	biodegradable waste comprising wood and plant tissue
20 03	other municipal wastes
20 03 02	biodegradable waste from markets

Schedule 3 – Emissions and monitoring

Table S3.1 Point source emissions to air – emission limits and monitoring requirements						
Emission point ref. & location	Source	Parameter	Limit (including unit)	Reference period	Monitoring frequency	Monitoring standard or method
Biofilter 1	Outlets from biofilter emitting treated air from enclosed composting vessels, the waste reception, transfer and MSW fines storage buildings channelled via the wet scrubber	No parameter set	No limit set	--	--	--
Biofilter 2	Outlets from biofilter emitting treated air from enclosed composting vessels, the waste reception, transfer and MSW fines storage buildings channelled via the wet scrubber	No parameter set	No limit set	--	--	--

Table S3.2 Point source emissions to water (other than sewer) and land – emission limits and monitoring requirements						
Emission point ref. & location	Source	Parameter	Limit (incl. unit)	Reference Period	Monitoring frequency	Monitoring standard or method
Outlet labelled L1 to offsite dyke as shown on WLC_005b South Site Drainage Plan – Amended, dated 20/06/2018, and submitted in support of application EPR/UP3893EC/V007	Uncontaminated excess rainwater and site surface water from non-operational areas	No parameter set	No limit set	--	--	--

Table S3.3 Process monitoring requirements				
Emission point reference or source or description of point of measurement	Parameter	Monitoring frequency	Monitoring standard or method	Other specifications
Open Windrow Composting (Proposed Activity)				
Internal for each composting batch during sanitisation stage	Temperature	At least daily	Temperature probe	Monitoring equipment shall be available on site and used as required to maintain aerobic conditions and ensure compliance with this permit. Equipment shall be calibrated on a 4 monthly basis or as agreed in writing by the Environment Agency.
	Moisture	None specified	--	
Internal for each composting batch during stabilisation stage	Temperature	At least weekly	Temperature probe	
	Moisture	None specified	--	
<u>In-vessel Composting of MSW fines and other wastes (Current and Proposed Activity)</u>				
Internal for each batch during sanitisation stage	Temperature	At least daily	Temperature probe	Monitoring equipment shall be available on site and used as required to maintain aerobic conditions and ensure compliance with this permit. Equipment shall be calibrated on a 4 monthly basis or as agreed in writing by the Environment Agency.
	Moisture	None specified	--	
Internal for each batch during stabilisation stage	Temperature	At least weekly	Temperature probe	
	Moisture	None specified	--	
Biofilters	Temperature	As required	Temperature probe	Biofilters shall be regularly checked and maintained to ensure appropriate temperature and moisture content.
	Moisture	As required	None specified	
	Thatching/compaction	As required	None specified	
Wet scrubber system	Key parameters to include pH, temperature, conductivity, air flow and differential pressure	In accordance with manufacturer's recommendations	None specified	Wet scrubber system shall be regularly checked and maintained to ensure appropriate temperature and moisture content.
Waste reception, transfer and MSW fines storage buildings; Storage tanks; Maturation area	Odour	Daily and during transfer of wastes from the reception building, IVC tunnels and MSW	Olfactory monitoring	Odour detection at the site boundary

Table S3.3 Process monitoring requirements				
Emission point reference or source or description of point of measurement	Parameter	Monitoring frequency	Monitoring standard or method	Other specifications
		finest storage buildings		
Storage tanks	Integrity checks	Weekly	Visual assessment	--

Table S3.4 Bioaerosols monitoring requirements – ambient monitoring					
Location or description of point of measurement	Parameter	Bioaerosols threshold limits CFU m ⁻³)	Monitoring frequency	Monitoring standard or method	Other specifications
Upwind of the operational area, as described in the Technical Guidance Note M9	Total bacteria	1000 ^{Note 1}	Quarterly for the first year of operation and twice a year thereafter, unless another frequency is agreed in writing by the Environment Agency	In accordance with Technical Guidance Note M9 – Environmental monitoring of bioaerosols at regulated facilities.	As described in the Technical Guidance Note M9, including all the additional data requirements specified therein.
Downwind of the operational area, as described in the Technical Guidance Note M9	Aspergillus Fumigatus	500 ^{Note 1}			
Note 1 – The bioaerosols threshold limits are only applicable at downwind sampling locations.					

Schedule 4 – Reporting

Parameters, for which reports shall be made, in accordance with conditions of this permit, are listed below.

Table S4.1 Reporting of monitoring data			
Parameter	Emission or monitoring point/reference	Reporting period	Period begins
Bioaerosols monitoring Parameters as required by condition 3.8.1	As specified in schedule 3 table S3.4.	Every 3 months or as agreed in writing by the Environment Agency	1 January, 1 April, 1 July, 1 October
Biofilter efficiency Parameters as required by condition 4.2.6	Biofilter 1	Every 12 months	1 January
Biofilter efficiency Parameters as required by condition 4.2.6	Biofilter 2	Every 12 months	1 January

Table S4.2 Annual production/treatment	
Parameter	Units
In-vessel Composting of wastes (Current Activity)	
Processed compost	tonnes
Open Windrow Composting (Proposed Activity)	
Processed compost (PAS 100)	tonnes
Processed compost waste (non-PAS 100)	tonnes
Other waste removed from the site	tonnes
In-vessel Composting of MSW fines and other wastes (Proposed Activity)	
Sanitised and Stabilised Compost-like Output	tonnes
Other waste removed from the site	tonnes

Table S4.3 Performance parameters		
Parameter	Frequency of assessment	Units
Water usage	Annually	tonnes or m ³
Energy usage	Annually	MWh
Total raw material used	Annually	tonnes

Table S4.4 Reporting forms		
Media/parameter	Reporting format	Date of form
Bioaerosols	As specified in the Technical Guidance Note M9 or other form as agreed in writing by the Environment Agency	--
Water usage	Form water usage 1 or other form as agreed in writing by the Environment Agency	28/06/19

Table S4.4 Reporting forms		
Media/parameter	Reporting format	Date of form
Energy usage	Form energy 1 or other form as agreed in writing by the Environment Agency	28/06/19
Other performance indicators	Form performance 1 or other form as agreed in writing by the Environment Agency	28/06/19
Waste Returns	E-waste Returns Form or other form as agreed in writing by the Environment Agency	--

Schedule 5 – Notification

These pages outline the information that the operator must provide.

Units of measurement used in information supplied under Part A and B requirements shall be appropriate to the circumstances of the emission. Where appropriate, a comparison should be made of actual emissions and authorised emission limits.

If any information is considered commercially confidential, it should be separated from non-confidential information, supplied on a separate sheet and accompanied by an application for commercial confidentiality under the provisions of the EP Regulations.

Part A

Permit Number	
Name of operator	
Location of Facility	
Time and date of the detection	

(a) Notification requirements for any malfunction, breakdown or failure of equipment or techniques, accident, or emission of a substance not controlled by an emission limit which has caused, is causing or may cause significant pollution	
To be notified within 24 hours of detection	
Date and time of the event	
Reference or description of the location of the event	
Description of where any release into the environment took place	
Substances(s) potentially released	
Best estimate of the quantity or rate of release of substances	
Measures taken, or intended to be taken, to stop any emission	
Description of the failure or accident.	

(b) Notification requirements for the breach of a limit	
To be notified within 24 hours of detection unless otherwise specified below	
Emission point reference/ source	
Parameter(s)	
Limit	
Measured value and uncertainty	
Date and time of monitoring	

(b) Notification requirements for the breach of a limit	
To be notified within 24 hours of detection unless otherwise specified below	
Measures taken, or intended to be taken, to stop the emission	

Time periods for notification following detection of a breach of a limit	
Parameter	Notification period

(c) Notification requirements for the detection of any significant adverse environmental effect	
To be notified within 24 hours of detection	
Description of where the effect on the environment was detected	
Substances(s) detected	
Concentrations of substances detected	
Date of monitoring/sampling	

Part B – to be submitted as soon as practicable

Any more accurate information on the matters for notification under Part A.	
Measures taken, or intended to be taken, to prevent a recurrence of the incident	
Measures taken, or intended to be taken, to rectify, limit or prevent any pollution of the environment which has been or may be caused by the emission	
The dates of any unauthorised emissions from the facility in the preceding 24 months.	

Name*	
Post	
Signature	
Date	

* authorised to sign on behalf of the operator

Schedule 6 – Interpretation

“accident” means an accident that may result in pollution.

“activities” means either the current activities or the proposed activities as appropriate.

“animal waste” means any waste consisting of animal matter that has not been processed into food for human consumption.

“application” means the application for this permit, together with any additional information supplied by the operator as part of the application and any response to a notice served under Schedule 5 to the EP Regulations.

“authorised officer” means any person authorised by the Environment Agency under section 108(1) of The Environment Act 1995 to exercise, in accordance with the terms of any such authorisation, any power specified in section 108(4) of that Act.

“bioaerosols threshold limits” means the maximum acceptable bioaerosol concentrations at the nearest sensitive receptor, or at an equivalent distance downwind of the biowaste treatment operations, which are attributable to the biowaste treatment operations. The maximum acceptable concentrations are respectively 1000 and 500 CFU m⁻³ for total bacteria and *Aspergillus fumigatus*.

“building” means a construction that has the objective of providing sheltering cover and minimising emissions of noise, particulate matter, odour and litter.

“compost” means solid particulate material that is the result of composting, which has been sanitised and stabilised, and which confers beneficial effects when added to soil, used as a component of growing media or used in another way in conjunction with plants.

“composting” means the biological decomposition of organic materials, under conditions that are predominantly aerobic and that allow the development of thermophilic temperatures as a result of biologically produced heat.

“disposal” means any of the operations provided for in Annex I to Directive 2008/98/EC of the European Parliament and of the Council on waste.

“emissions of substances not controlled by emission limits” means emissions of substances to air, water or land from the activities, either from the emission points specified in schedule 3 or from other localised or diffuse sources, which are not controlled by an emission limit.

“emissions to land” includes emissions to groundwater.

“EP Regulations” means The Environmental Permitting (England and Wales) Regulations SI 2016 No.1154 and words and expressions used in this permit which are also used in the Regulations have the same meanings as in those Regulations.

“groundwater” means all water, which is below the surface of the ground in the saturation zone and in direct contact with the ground or subsoil.

“impermeable surface” means a surface or pavement constructed and maintained to a standard sufficient to prevent the transmission of liquids beyond the pavement surface.

“Industrial Emissions Directive” means DIRECTIVE 2010/75/EU OF THE EUROPEAN PARLIAMENT AND OF THE COUNCIL of 24 November 2010 on industrial emissions.

“MCERTS” means the Environment Agency’s Monitoring Certification Scheme.

“pests” means Birds, Vermin and Insects.

“quarter” means a calendar year quarter commencing on 1 January, 1 April, 1 July or 1 October.

“recovery” means any of the operations provided for in Annex II to Directive 2008/98/EC of the European Parliament and of the Council on waste.

“sanitisation stage” means the actively managed and intensive stage of composting lasting for at least five days, characterised by high oxygen demand and temperatures of over 55 °C, during which biological processes, together with conditions in the composting mass, eradicate human and animal pathogens or reduce them to acceptably low levels.

“sealed drainage system” in relation to an impermeable surface, means a drainage system with impermeable components which does not leak and which will ensure that:

- (a) no liquid will run off the surface otherwise than via the system;
- (b) except where they may be lawfully be discharged to foul sewer, all liquids entering the system are collected in a sealed sump.

“stabilisation stage” means the stage of composting following sanitisation, during which biological conditions in the composting mass, give rise to compost that is nominally stable.

“Waste code” means the six digit code referable to a type of waste in accordance with the List of Wastes (England) Regulations 2005, or List of Wastes (Wales) Regulations 2005, as appropriate, and in relation to hazardous waste, includes the asterisk.

“Waste Framework Directive” or “WFD” means Waste Framework Directive 2008/98/EC of the European Parliament and of the Council on waste.

“year” means calendar year ending 31 December.

Where a minimum limit is set for any emission parameter, for example pH, reference to exceeding the limit shall mean that the parameter shall not be less than that limit.

Unless otherwise stated, any references in this permit to concentrations of substances in emissions into air means:

- in relation to emissions from combustion processes, the concentration in dry air at a temperature of 273K, at a pressure of 101.3 kPa and with an oxygen content of 3% dry for liquid and gaseous fuels, 6% dry for solid fuels; and/or
- in relation to emissions from non-combustion sources, the concentration at a temperature of 273K and at a pressure of 101.3 kPa, with no correction for water vapour content.

Schedule 7A – Site plan (Current Activities)

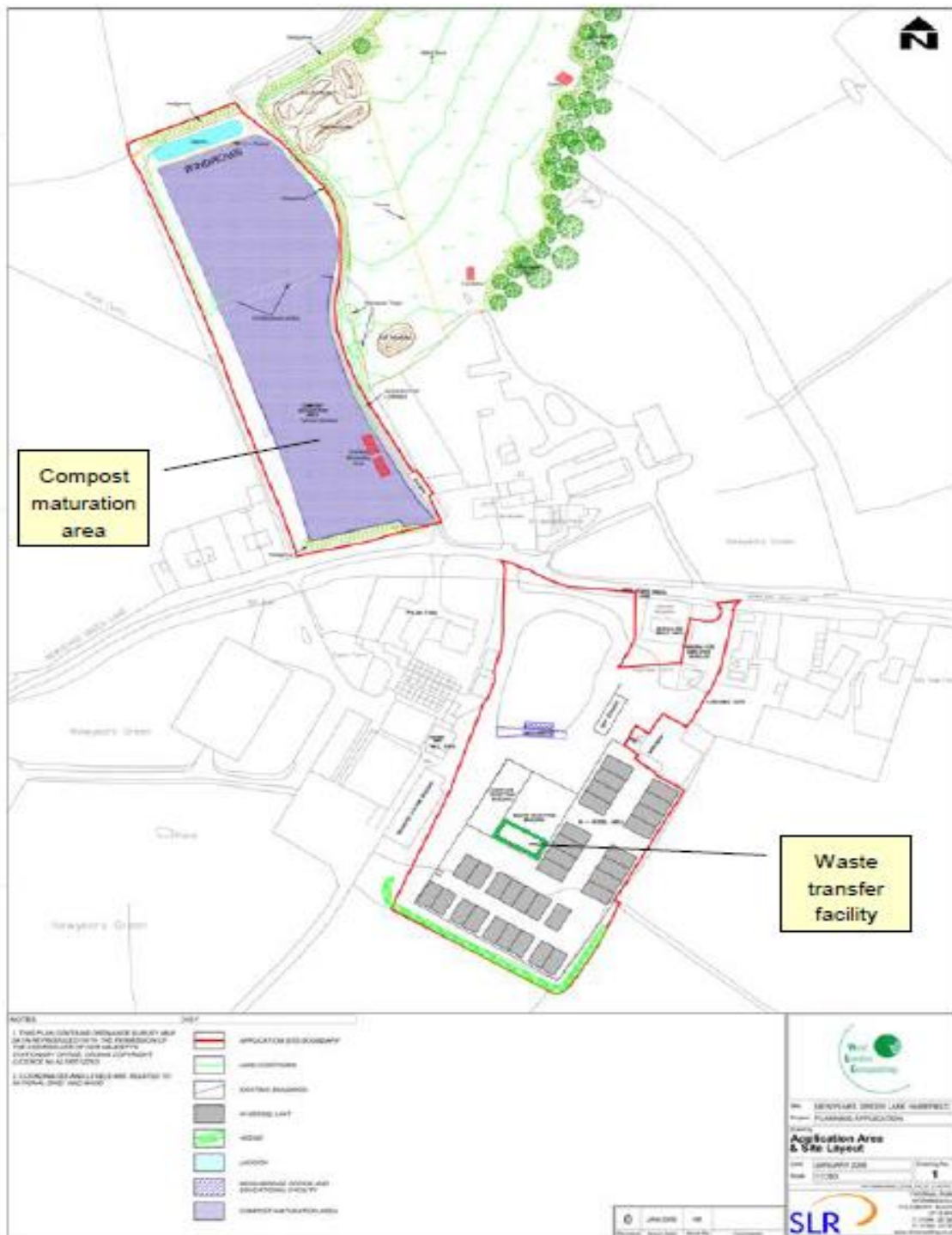

Schedule 7B – Site plan (Proposed Activities)

Site plan – Open windrow composting (North side of facility)

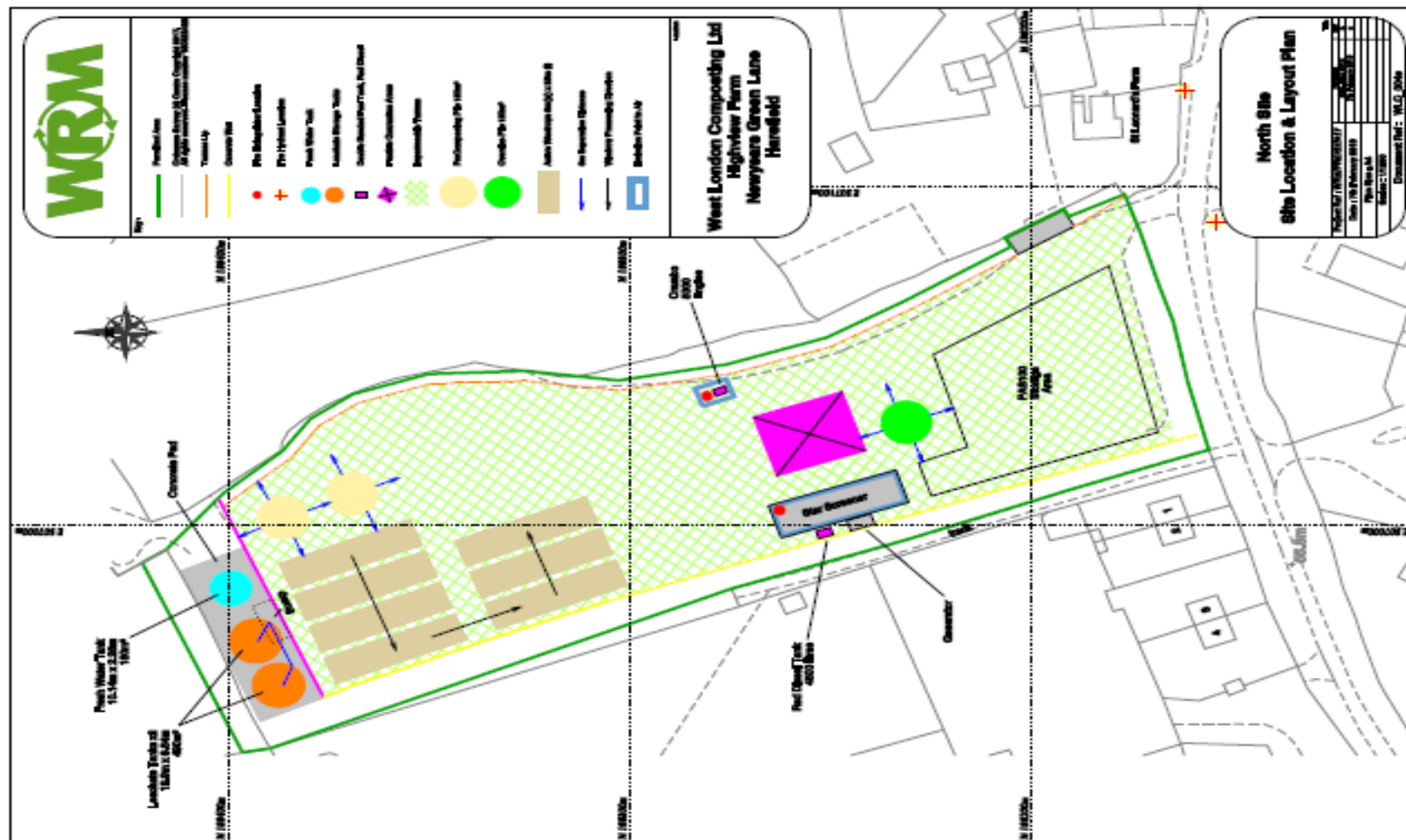

Site plan – In-vessel composting MSW fines & Waste Transfer Station (South side of facility)

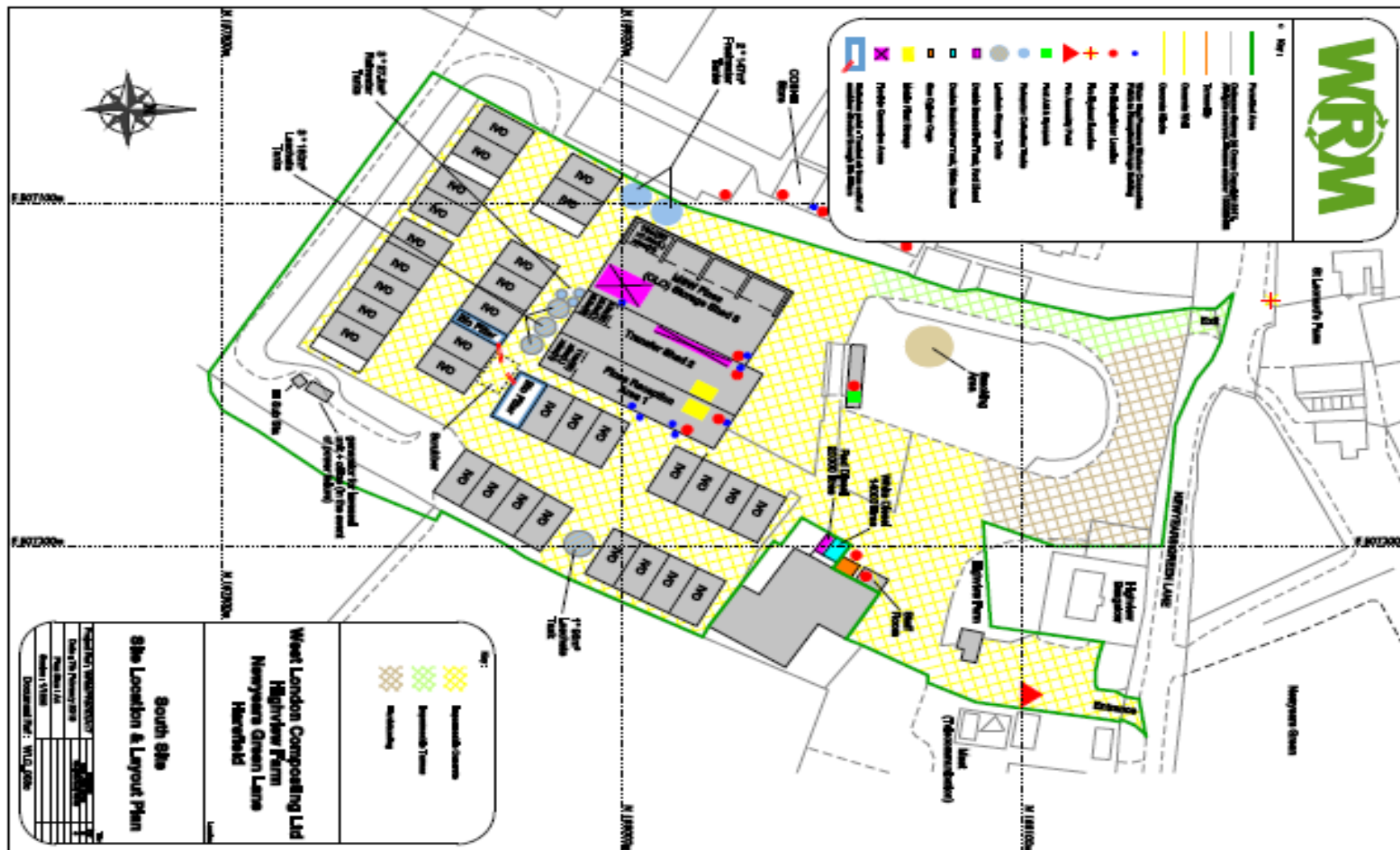

Site plan – North and South side of facility



END OF PERMIT

Permit Number: **EPR/UP3893EC**

Facility: **West London**
 Composting Limited

Operator: **West London**
 Composting Limited

Form Number: **WaterUsage1 / 28/06/19**

Reporting of Water Usage for the year

Water Source	Usage (m³/year)	Specific Usage (m³/unit output)
Mains water		
Site borehole		
River abstraction		
TOTAL WATER USAGE		

Operator's comments:

Signed

Date.....

(authorised to sign as representative of Operator)

Permit Number: EPR/UP3893EC

**Operator: West London
Composting Limited**

**Facility: West London
Composting Limited**

**Form Number:
Energy1 / 28/06/19**

Reporting of Energy Usage for the year

Energy Source	Energy Usage		Specific Usage (MWh/unit output)
	Quantity	Primary Energy (MWh)	
Electricity *	MWh		
Natural Gas	MWh		
Gas Oil	tonnes		
Recovered Fuel Oil	tonnes		
TOTAL	-		

* Conversion factor for delivered electricity to primary energy = 2.4

Operator's comments:

Signed

Date.....

(Authorised to sign as representative of Operator)

Permit Number: EPR/UP3893EC

**Operator: West London
Composting Limited**

**Facility: West London
Composting Limited**

Form Number: Performance1 / 28/06/19

Reporting of other performance indicators for the period DD/MM/YYYY to DD/MM/YYYY

Parameter	Units
Total raw material used	tonnes

Operator's comments:

Signed

Date.....

(Authorised to sign as representative of Operator)