

Plan
Scale 1:5,000 @ A1

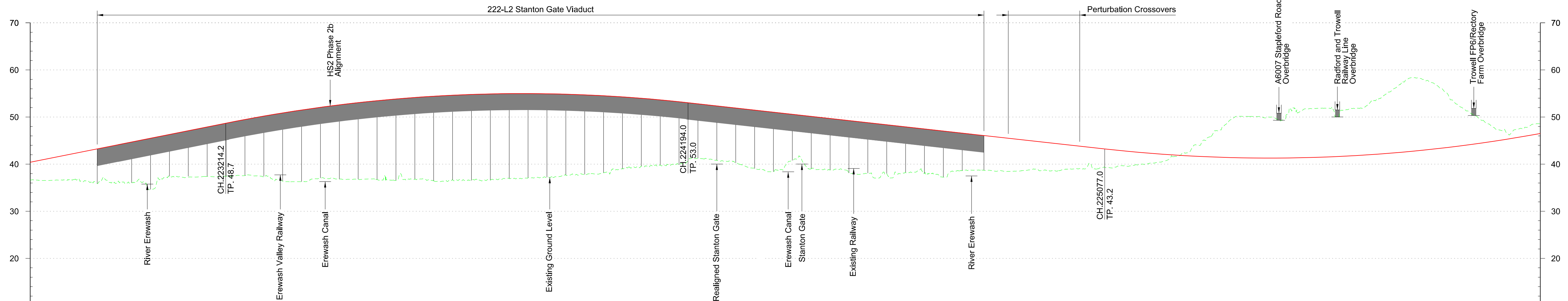

Route Element ID	222-L1 Stapleford Embankment	222 - L2 Stanton Gate Viaduct																224-L1 Trowell Embankment						225-L1 Trowell Cutting																																									
Chainage	222+800	222+850	222+900	222+950	223+000	223+050	223+100	223+150	223+200	223+250	223+300	223+350	223+400	223+450	223+500	223+550	223+600	223+650	223+700	223+750	223+800	223+850	223+900	223+950	224+000	224+050	224+100	224+150	224+200	224+250	224+300	224+350	224+400	224+450	224+500	224+550	224+600	224+650	224+700	224+750	224+800	224+850	224+900	224+950	225+000	225+050	225+100	225+150	225+200	225+250	225+300	225+350	225+400	225+450	225+500	225+550	225+600	225+650	225+700	225+750	225+800	225+850	225+900	225+950	226+000
Horizontal Alignment	R=3000.0 L=1827.3																L=300.0						L=862.1						L=340.0																																				
Vertical Alignment	L=503.9 G=2.000%																L=979.7 R=31500.0																L=883.0 G=-1.111%						L=1137.1 R=31500.0																										
Existing Level	36.7	36.6	36.7	36.4	35.9	34.6	37.3	37.3	37.4	37.5	37.6	36.3	36.9	36.8	36.7	37.5	36.8	36.6	36.6	36.6	36.8	37.1	37.2	37.8	37.9	39.0	39.0	38.8	38.9	39.4	39.9	41.2	40.9	40.1	38.9	39.7	39.0	38.8	38.8	38.7	38.5	38.6	38.8	39.0	39.4	39.4	40.0	40.6	42.4	45.8	49.8	50.1	49.2	51.7	51.8	51.8	51.8	53.5	56.8	58.0	55.3	51.1	47.8	47.4	48.6
Proposed Level	40.4	41.4	42.4	43.4	44.4	45.4	46.4	47.4	48.4	49.4	50.3	51.1	51.9	52.5	53.1	53.6	54.0	54.4	54.7	54.8	54.8	54.6	54.3	53.9	53.5	53.0	52.4	51.9	51.3	50.8	50.2	49.6	49.1	48.5	48.0	47.4	46.9	46.3	45.8	45.2	44.6	44.1	43.5	43.0	42.5	42.1	41.8	41.5	41.4	41.8	42.1	42.5	43.0	43.5	44.1	44.8	45.6	46.5							
Cut and Fill	+3.7	+4.8	+5.7	+7.0	+8.5	+10.8	+9.1	+10.1	+11.0	+11.9	+12.7	+14.8	+15.0	+15.7	+16.4	+16.1	+17.2	+17.8	+18.1	+18.2	+18.2	+17.9	+17.7	+17.0	+16.7	+15.3	+14.5	+13.6	+11.8	+11.5	+11.8	+12.4	+11.1	+11.2	+10.8	+9.6	+7.6	+7.3	+6.6	+5.8	+5.1	+4.1	+3.6	+2.5	+1.5	-0.6	-4.3	-8.4	-8.8	-7.9	-10.3	-10.3	-10.0	-11.4	-14.3	-15.0	-11.8	-7.0	-3.0	-1.8	-2.1				
Design Speed:	250km/h																300km/h																																																



Profile
Scale H 1:5,000 V 1:500 @ A1

Fit for Acceptance

Rev	Description	Drawn	Checked	Con App	HS2 App	Scale with caution as distortion can occur.
P06	Issued for CP2.1	JNO	MEV	AHI	17/04/2019	17/04/2019
P05	Issued for CP2.1	BH	AKO	AHI	16/04/2019	16/04/2019
P04	Issued for CP2	CLE	MEV	DCL	18/07/2018	19/07/2018
P03	Issued for CP2	KT	MEV	AHI	22/06/2018	22/06/2018
P02	Issued for CP1	KB	MEV	AHI	23/11/2017	24/11/2017

Legends/Notes:

- Depot, station, headhouse, shaft or portal building
- Tunnel portal
- Electricity substation
- Ecological mitigation pond
- Balancing pond
- Pumping station
- Replacement floodplain storage area
- Woodland habitat creation
- Wetland habitat creation
- Grassland habitat creation
- Landscape mitigation planting (scrub / woodland)
- Grassed areas
- Local placement
- Public realm
- Engineering earthworks
- Landscape earthworks
- Rail alignment formation
- Returned to suitable development use
- County boundary
- Borough / District boundary
- Major contour
- Community area boundary
- Existing watercourse
- Watercourse diversions
- New Ditches
- Hedge row
- Major utility works
- Noise fence barrier
- Existing public right of way
- New, diverted or realigned public right of way
- Public right of way closure
- Tunnels external extent
- HS2 access road
- Realigned highway
- Rail alignment

HS2

Registered in England
Registration No. 06791686
Registered office:
2 Snow Hill, Queensway,
Birmingham, B4 6GA

Creator/Organiser
Aecom Capita Ineco Joint Venture

Zone	Project/Contract		
L2 Kegworth to Newton & Tibshelf	CDDES Area 2 (CE2)		
Design Stage	Discipline/Function		
Hybrid Bill - Draft Interim Preliminary Design	Civil		
Drawing Title	Drawn	Checked	Approved
H2EL-01 (Down Eastern Leg)	KBA	MEV	AHI
Chainage (e.g. 10+000)	Date	Scale	Size
Sheet 11 of 17	24/06/2017	AS SHOWN	A1
Chainage	Drawing No.	Rev.	
Chainage 222+800 to 226+000	2DE02-ACI-CV-DPP-L002-000011	P06	

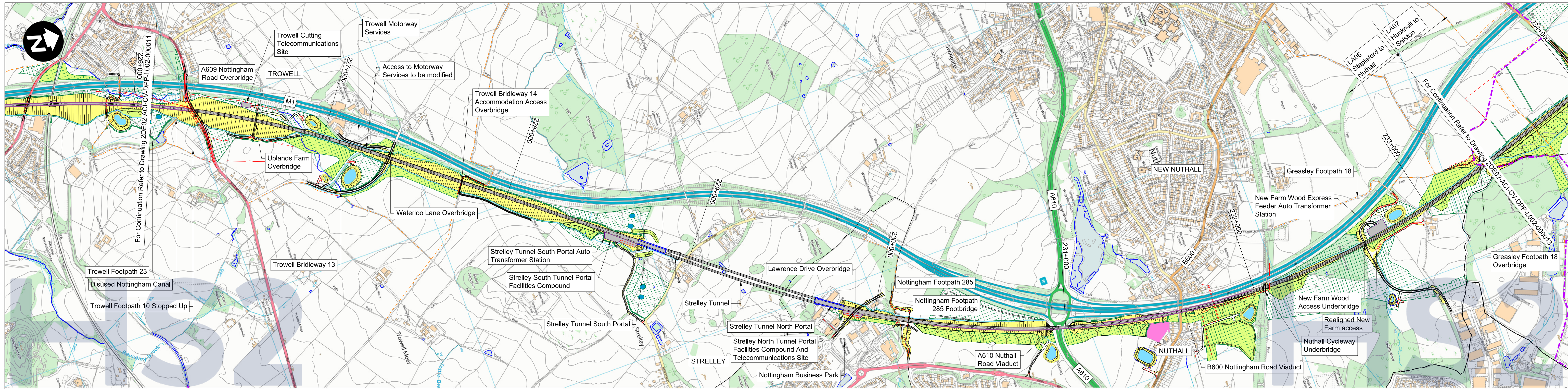

Plan
Scale 1:10,000 @ A1

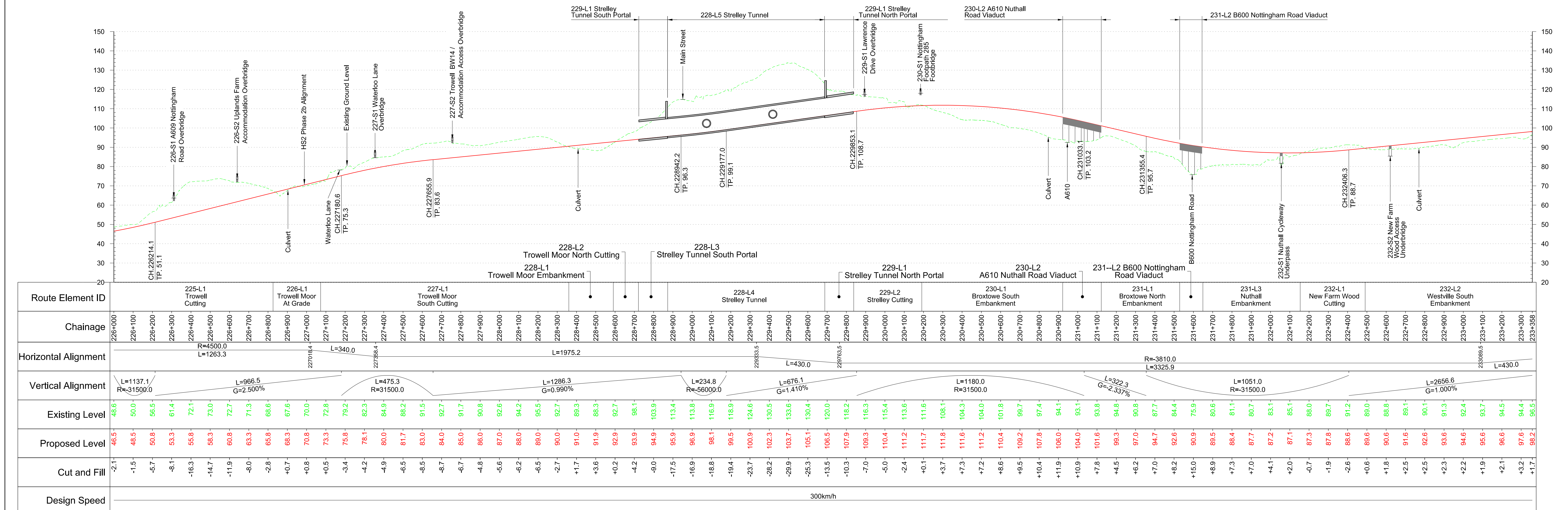

Profile
Scale H1:10,000 V1:1000 @ A1

Fit for Acceptance

Rev	Description	Drawn	Checked	Con App	HS2 App	Scale with caution as distortion can occur.
P06	Issued for CP2.1	JNO	MEV	AHI	17/04/2019	HS2 accepts no responsibility for any circumstances which arise from the reproduction of this document after alteration, amendment or abbreviation or if it is issued in part or issued incompletely in any way.
P05	Issued for CP2.1	BH	AKO	AHI	16/04/2019	© Crown Copyright and database right 2018. All rights reserved. Ordnance Survey Licence number 100049130
P04	Issued for CP2	WJ	MEV	DCL	19/07/2018	© Crown Copyright material is reproduced with the permission of Land Registry under delegated authority from the Controller of HMSO.
P03	Issued for CP2	KT	MEV	AHI	22/06/2018	This material was last updated on 2018 and may not be copied, distributed, sold or published without the formal permission of Land Registry. Only an official copy of a title plan or register obtained from the Land Registry may be used for legal or other official purposes.
P02	Issued for CP1	KB	MEV	AHI	23/11/2017	

Legends/Notes:

- Depot, station, headhouse, shaft or portal building
- Tunnel portal
- Electricity substation
- Ecological mitigation pond
- Balancing pond
- Pumping station
- Replacement floodplain storage area
- Woodland habitat creation
- Wetland habitat creation
- Grassland habitat creation
- Landscape mitigation planting (scrub / woodland)
- Grassed areas
- Local placement
- Public realm
- Engineering earthworks
- Landscape earthworks
- Rail alignment formation
- Returned to suitable development use
- County boundary
- Borough / District boundary
- Major contour
- Community area boundary
- Existing watercourse
- Watercourse diversions
- New Ditches
- Hedge row
- Major utility works
- Noise fence barrier
- Existing public right of way
- New, diverted or realigned public right of way
- Public right of way closure
- Tunnels external extent
- HS2 access road
- Realigned highway
- Rail alignment

HS2

Registered in England
Registration No. 06791686
Registered office:
2 Snow Hill, Queensway,
Birmingham, B4 6GA

Creator/Oriinator
Aecom Capita Ineco Joint Venture

Zone	Project/Contract		
L2 Kegworth to Newton & Tibshelf	CDER Area 2 (CE2)		
Design Stage	Discipline/Function		
Hybrid Bill - Draft Interim Preliminary Design	Civil		
Drawing Title	Drawn	Checked	Approved
H2EL-01 (Down Eastern Leg)	KBA	MEV	AHI
Chainage (e.g. 10+000)	Date	Scale	Size
Chainage 226+000 to 233+358	24/06/2017	AS SHOWN	A1
Drawing No.	Rev.		
2DE02-ACI-CV-DPP-L002-000012	P06		