

Notice of variation and consolidation with introductory note

The Environmental Permitting (England & Wales) Regulations 2016

Newcome-Baker Farms Limited

Whin Close Poultry Farm
Docking Road
Sedgeford
Hunstanton
Norfolk
PE36 5LL

Variation application number

EPR/AP3439DZ/V003

Permit number

EPR/AP3439DZ

Whin Close Poultry Farm

Permit number EPR/AP3439DZ

Introductory note

This introductory note does not form a part of the notice

Under the Environmental Permitting (England & Wales) Regulations 2016 (schedule 5, part 1, paragraph 19) a variation may comprise a consolidated permit reflecting the variations and a notice specifying the variations included in that consolidated permit.

Schedule 1 of the notice specifies the conditions that have been varied and schedule 2 comprises a consolidated permit which reflects the variations being made. All the conditions of the permit have been varied and are subject to the right of appeal.

This variation authorises the following changes:

The addition of four poultry houses, numbered five to eight, as well as an increase in broiler numbers from 168,000 broilers to 360,000 broilers.

The rest of the installation is unchanged and continues to be operated as follows:

Whin Close Poultry Farm is situated approximately 1.5 kilometres east of the village of Sedgeford in Norfolk. The installation is approximately centred on National Grid Reference TF 73051 36280.

The installation is operated by Newcome-Baker Farms Limited and comprises eight poultry houses, numbered one to eight, which operate with a capacity of 360,000 broiler places designed for the rearing of chicken for meat production. Chicks are brought in from the hatchery at a day old and at 35 days a proportion of the birds are removed for slaughter, with the remaining birds reared for approximately 41-42 days, before being transported off site for processing.

All eight poultry houses are ventilated by roof extraction fans with an emission point higher than 5.5 metres above ground level and an efflux speed at or greater than 11 metres per second, and side wall inlets. All houses also have gable end fans, although these are operated infrequently to maintain temperature, typically in the summer months. The houses are warmed by indirect heating in the form of modern thermostatically controlled hot water heaters with the water brought up to the required temperature by a biomass boiler with a backup system fuelled by Liquid Petroleum Gas (LPG).

At the end of the growing period, all birds are removed from the houses and the litter is exported off site and either spread on land owned by the operator or as a contingency, when there are limitations to spreading such as unsuitable weather conditions, transported to power stations for use as fuel. The empty houses are then washed and disinfected ready for the next crop. The wash water is channelled to an underground collection tank and subsequently the contents are exported off site and spread on land owned by the operator. Roof water from the poultry houses and yard surface water (excluding poultry house clean out periods) drain to French drains running along the sides of the houses. These act both as soakaways and also as drainage pathways to a swale, located to the west of the poultry houses, acting as a soakaway at times of heavy rainfall. During clean out operations a diverter valve is used to channel yard surface water to the wash water collection tank for exporting off site.

The land around the site is used primarily for arable farming, although there are some wooded areas and meadows. The land rises gently towards hills to the north-east and falls towards the Heacham River Valley to the south-west. Associated food is stored on the installation in silos adjacent to the poultry houses, positioned away from site traffic. Mortalities are collected daily and stored in a locked and sealed containers on site prior to removal and disposal in accordance with the Animal By-Product Regulations.

There are three Special Areas of Conservation (SACs), three Special Protection Areas (SPAs), and three Ramsar sites within 10km of the installation boundary. In addition there are three Sites of Special Scientific Interest (SSSIs) within 5km of the installation boundary. There are no Local Wildlife Sites (LW) or ancient

woodlands within 2km of the installation. An assessment of the likely impact of the installation has been carried out. All site screen out and no further assessment is necessary.

The schedules specify the changes made to the permit.

The status log of a permit sets out the permitting history, including any changes to the permit reference number.

Status log of the permit		
Description	Date	Comments
Application EPR/AP3439DZ/A001	Duly made 05/08/16	Application for an intensive farming poultry installation permit.
Request for Further Information sent 15/08/16	26/08/16	Further details relating to noise modelling assessment.
Schedule 5 notice issued 06/12/16	22/12/16	Clarification of site drainage, poultry house heating system, clean out procedures, standby generator, carcass disposal, on site dwelling and receipt of Accident Management Plan, Dust Management Plan and revised Site Condition Report.
Schedule 5 notice issued 27/03/17	31/03/17	Confirmation of compliance with the Best Available Techniques (BAT) Conclusion document dated 21/02/17, and receipt of a revised Odour Management Plan.
Permit determined EPR/AP3439DZ (Billing reference: AP3439DZ)	13/07/17	Permit issued to Newcome-Baker Farms Limited.
Application EPR/AP3439DZ/V002	Duly made 24/10/17	Application to add one biomass boiler along with associated fuel storage and to increase the installation boundary.
Variation determined EPR/AP3439DZ	27/11/17	Varied permit issued.
Application EPR/AP3439DZ/V003	Duly made 06/03/18	Application to add four sheds and to increase the number of birds at the installation to 360,000 broilers.
Request for Further Information sent 06/03/2018	06/03/18	Confirmation the new poultry houses will be built in compliance with the Best Available Techniques (BAT) Conclusion document dated 21/02/17.
Schedule 5 notice issued 05/06/2018	14/06/18	Receipt of an updated odour management plan, noise management plan and drainage plan.
Schedule 5 notice issued 20/08/2018	06/09/18	Receipt of a raw materials list, updated emergency plan, as well as confirmation of dust emissions reporting, clarification of drainage details and pest management.
Variation determined EPR/AP3439DZ (Billing reference: YP3438JW)	23/11/18	Varied permit issued

End of introductory note

Notice of variation and consolidation

The Environmental Permitting (England and Wales) Regulations 2016

The Environment Agency in exercise of its powers under regulation 20 of the Environmental Permitting (England and Wales) Regulations 2016 varies

Permit number

EPR/AP3439DZ

Issued to

Newcome-Baker Farms Limited (“the operator”)

whose registered office is

Wethered Manor

Sedgeford

Hunstanton

Norfolk

PE36 5LR

company registration number 00591983

to operate a regulated facility at

Whin Close Poultry Farm

Docking Road

Sedgeford

Hunstanton

Norfolk

PE36 5LL

to the extent set out in the schedules.

The notice shall take effect from 23/11/2018

Name	Date
David Griffiths	23/11/2018

Authorised on behalf of the Environment Agency

Schedule 1

All conditions have been varied by the consolidated permit EPR/AP3439DZ as a result of the application made by the operator.

Schedule 2 – consolidated permit

Consolidated permit issued as a separate document.

Permit

The Environmental Permitting (England and Wales) Regulations 2016

Permit number

EPR/AP3439DZ

This is the consolidated permit referred to in the variation and consolidation notice for application EPR/AP3439DZ/V003 authorising,

Newcome-Baker Farms Limited (“the operator”),

whose registered office is

Wethered Manor

Sedgeford

Hunstanton

Norfolk

PE36 5LR

company registration number 00591983

to operate an installation at

Whin Close Poultry Farm

Docking Road

Sedgeford

Hunstanton

Norfolk

PE36 5LL

to the extent authorised by and subject to the conditions of this permit.

Name	Date
David Griffiths	23/11/2018

Authorised on behalf of the Environment Agency

Conditions

1 Management

1.1 General management

- 1.1.1 The operator shall manage and operate the activities:
- (a) in accordance with a written management system that identifies and minimises risks of pollution, so far as is reasonably practicable, including those risks arising from operations, maintenance, accidents, incidents, non-conformances, closure and those drawn to the attention of the operator as a result of complaints; and
 - (b) using sufficient competent persons and resources.
- 1.1.2 Records demonstrating compliance with condition 1.1.1 shall be maintained.
- 1.1.3 Any person having duties that are or may be affected by the matters set out in this permit shall have convenient access to a copy of the permit.

1.2 Energy efficiency

- 1.2.1 The operator shall:
- (a) take appropriate measures to ensure that energy is used efficiently in the activities; and
 - (b) maintain records of fuel and energy consumption used in the activities.

1.3 Efficient use of raw materials

- 1.3.1 The operator shall:
- (a) take appropriate measures to ensure that raw materials and water are used efficiently in the activities; and
 - (b) maintain records of raw materials and water used in the activities.

1.4 Avoidance, recovery and disposal of wastes produced by the activities

- 1.4.1 The operator shall take appropriate measures to ensure that the waste hierarchy referred to in Article 4 of the Waste Framework Directive is applied to the generation of waste by the activities and that:
- (a) any waste generated by the activities is treated in accordance with the waste hierarchy referred to in Article 4 of the Waste Framework Directive; and
 - (b) where disposal is necessary, this is undertaken in a manner which minimises its impact on the environment.

2 Operations

2.1 Permitted activities

2.1.1 The only activities authorised by the permit is the activities specified in schedule 1, table S1.1 (the “activities”).

2.2 The site

2.2.1 The activities shall not extend beyond the site, being the land shown edged in green on the site plan at schedule 7 to this permit.

2.3 Operating techniques

2.3.1 The activities shall, subject to the conditions of this permit, be operated using the techniques and in the manner described in the documentation specified in schedule 1, table S1.2, unless otherwise agreed in writing by the Environment Agency.

2.3.2 If notified by the Environment Agency that the activities are giving rise to pollution, the operator shall submit to the Environment Agency for approval within the period specified, a revision of any plan or other documentation (“plan”) specified in schedule 1, table S1.2 or otherwise required under this permit which identifies and minimises the risks of pollution relevant to that plan, and shall implement the approved revised plan in place of the original from the date of approval, unless otherwise agreed in writing by the Environment Agency.

2.3.3 The operator shall maintain and implement a system to record the number of animal places and animal movements.

2.3.4 The operator shall ensure that a diet formulation and nutritional strategy is used to reduce the total nitrogen and total phosphorous excreted.

2.3.5 The operator shall take appropriate measures in disposal or recovery of solid manure or slurry to prevent, or where this is not practicable, to minimise pollution.

2.3.6 Any raw materials or fuels listed in schedule 2, table S2.1 shall conform to the specifications set out in that table.

2.3.7 The operator shall ensure that where waste produced by the activities is sent to a relevant waste operation, that operation is provided with the following information, prior to the receipt of the waste:

- (a) the nature of the process producing the waste;
- (b) the composition of the waste;
- (c) the handling requirements of the waste;
- (d) the hazardous property associated with the waste, if applicable; and
- (e) the waste code of the waste.

3 Emissions and monitoring

3.1 Emissions to water, air or land

- 3.1.1 There shall be no point source emissions to water, air or land except from the sources and emission points specified in schedule 3, tables S3.1 and S3.2.
- 3.1.2 The limits given in schedule 3 shall not be exceeded.
- 3.1.3 Periodic monitoring shall be carried out at least once every 5 years for groundwater and 10 years for soil, unless such monitoring is based on a systematic appraisal of the risk of contamination.

3.2 Emissions of substances not controlled by emission limits

- 3.2.1 Emissions of substances not controlled by emission limits shall not cause pollution. The operator shall not be taken to have breached this condition if appropriate measures, including, but not limited to, those specified in any approved emissions management plan, have been taken to prevent or where that is not practicable, to minimise, those emissions.
- 3.2.2 The operator shall:
 - (a) if notified by the Environment Agency that the activities are giving rise to pollution, submit to the Environment Agency for approval within the period specified, an emissions management plan which identifies and minimises the risks of pollution from emissions of substances not controlled by emission limits; and
 - (b) implement the approved emissions management plan, from the date of approval, unless otherwise agreed in writing by the Environment Agency.
- 3.2.3 All liquids in containers, whose emission to water or land could cause pollution, shall be provided with secondary containment, unless the operator has used other appropriate measures to prevent or where that is not practicable, to minimise, leakage and spillage from the primary container.

3.3 Odour

- 3.3.1 Emissions from the activities shall be free from odour at levels likely to cause pollution outside the site, as perceived by an authorised officer of the Environment Agency, unless the operator has used appropriate measures, including, but not limited to, those specified in any approved odour management plan, to prevent or where that is not practicable to minimise the odour.

3.4 Noise and vibration

- 3.4.1 Emissions from the activities shall be free from noise and vibration at levels likely to cause pollution outside the site, as perceived by an authorised officer of the Environment Agency, unless the operator has used appropriate measures, including, but not limited to, those specified in any approved noise and vibration management plan to prevent or where that is not practicable to minimise the noise and vibration.

3.5 Monitoring

- 3.5.1 The operator shall, unless otherwise agreed in writing by the Environment Agency, undertake the monitoring specified in the following tables in schedule 3 to this permit:
 - (a) point source emissions specified in tables S3.1 and S3.2; and
 - (b) process monitoring specified in table S3.3.

- 3.5.2 The operator shall maintain records of all monitoring required by this permit including records of the taking and analysis of samples, instrument measurements (periodic and continual), calibrations, examinations, tests and surveys and any assessment or evaluation made on the basis of such data.
- 3.5.3 Monitoring equipment, techniques, personnel and organisations employed for the emissions monitoring programme and the environmental or other monitoring specified in condition 3.5.1 shall have either MCERTS certification or MCERTS accreditation (as appropriate), where available, unless otherwise agreed in writing by the Environment Agency.

3.6 Pests

- 3.6.1 The activities shall not give rise to the presence of pests which are likely to cause pollution, hazard or annoyance outside the boundary of the site. The operator shall not be taken to have breached this condition if appropriate measures, including, but not limited to, those specified in any approved pests management plan, have been taken to prevent or where that is not practicable, to minimise the presence of pests on the site.
- 3.6.2 The operator shall:
- (a) if notified by the Environment Agency, submit to the Environment Agency for approval within the period specified, a pests management plan which identifies and minimises risks of pollution, hazard or annoyance from pests; and
 - (b) implement the pests management plan, from the date of approval, unless otherwise agreed in writing by the Environment Agency.

4 Information

4.1 Records

4.1.1 All records required to be made by schedules 3, 4 and 5 to this permit shall:

- (a) be legible;
- (b) be made as soon as reasonably practicable;
- (c) if amended, be amended in such a way that the original and any subsequent amendments remain legible, or are capable of retrieval; and
- (d) be retained, unless otherwise agreed in writing by the Environment Agency, for at least 6 years from the date when the records were made, or in the case of the following records until permit surrender:
 - (i) off-site environmental effects; and
 - (ii) matters which affect the condition of the land and groundwater.

4.1.2 The operator shall maintain convenient access, in either electronic or hard copy, to the records, plans and management system required to be maintained by this permit.

4.2 Reporting

4.2.1 The operator shall send all reports and notifications required by the permit to the Environment Agency using the contact details supplied in writing by the Environment Agency.

4.2.2 For the following activities referenced in schedule 1, table S1.1 a report or reports on the performance of the activities over the previous year shall be submitted to the Environment Agency by 31 January (or other date agreed in writing by the Environment Agency) each year. The report(s) shall include as a minimum:

- (a) a review of the results of the monitoring and assessment carried out in accordance with the permit including an interpretive review of that data; and

4.2.3 Within 28 days of the end of the reporting period the operator shall, unless otherwise agreed in writing by the Environment Agency, submit reports of the monitoring and assessment carried out in accordance with the conditions of this permit, as follows:

- (a) in respect of the parameters and emission points specified in schedule 4, table S4.1;
- (b) for the reporting periods specified in schedule 4, table S4.1 and using the forms specified in schedule 4, table S4.2; and
- (c) giving the information from such results and assessments as may be required by the forms specified in those tables.

4.2.4 The operator shall, unless notice under this condition has been served within the preceding four years, submit to the Environment Agency, within six months of receipt of a written notice, a report assessing whether there are other appropriate measures that could be taken to prevent, or where that is not practicable, to minimise pollution.

4.3 Notifications

4.3.1 In the event:

- (a) that the operation of the activities gives rise to an incident or accident which significantly affects or may significantly affect the environment, the operator must immediately:
 - (i) inform the Environment Agency;
 - (ii) take the measures necessary to limit the environmental consequences of such an incident or accident; and
 - (iii) take the measures necessary to prevent further possible incidents or accidents; and
- (b) of a breach of any permit condition the operator must immediately:
 - (i) inform the Environment Agency; and
 - (ii) take the measures necessary to ensure that compliance is restored within the shortest possible time; and
- (c) of a breach of permit condition which poses an immediate danger to human health or threatens to cause an immediate significant adverse effect on the environment, the operator must immediately suspend the operation of the activities or the relevant part of it until compliance with the permit conditions has been restored.

4.3.2 Any information provided under condition 4.3.1 (a)(i), or 4.3.1 (b)(i) where the information relates to the breach of a limit specified in the permit, shall be confirmed by sending the information listed in schedule 5 to this permit within the time period specified in that schedule.

4.3.3 Where the Environment Agency has requested in writing that it shall be notified when the operator is to undertake monitoring and/or spot sampling, the operator shall inform the Environment Agency when the relevant monitoring and/or spot sampling is to take place. The operator shall provide this information to the Environment Agency at least 14 days before the date the monitoring is to be undertaken.

4.3.4 The Environment Agency shall be notified within 14 days of the occurrence of the following matters, except where such disclosure is prohibited by Stock Exchange rules:

Where the operator is a registered company:

- (a) any change in the operator's trading name, registered name or registered office address; and
- (b) any steps taken with a view to the operator going into administration, entering into a company voluntary arrangement or being wound up.

Where the operator is a corporate body other than a registered company:

- (c) any change in the operator's name or address; and
- (d) any steps taken with a view to the dissolution of the operator.

In any other case:

- (e) the death of any of the named operators (where the operator consists of more than one named individual);
- (f) any change in the operator's name(s) or address(es); and
- (g) any steps taken with a view to the operator, or any one of them, going into bankruptcy, entering into a composition or arrangement with creditors, or, in the case of them being in a partnership, dissolving the partnership.

4.3.5 Where the operator proposes to make a change in the nature or functioning, or an extension of the activities, which may have consequences for the environment and the change is not otherwise the subject of an application for approval under the Regulations or this permit:

- (a) the Environment Agency shall be notified at least 14 days before making the change; and
 - (b) the notification shall contain a description of the proposed change in operation.
- 4.3.6 The Environment Agency shall be given at least 14 days' notice before implementation of any part of the site closure plan.
- 4.3.7 Where the operator has entered into a climate change agreement with the Government, the Environment Agency shall be notified within one month of:
- (a) a decision by the Secretary of State not to re-certify the agreement;
 - (b) a decision by either the operator or the Secretary of State to terminate the agreement; and
 - (c) any subsequent decision by the Secretary of State to re-certify such an agreement.

4.4 Interpretation

- 4.4.1 In this permit the expressions listed in schedule 6 shall have the meaning given in that schedule.
- 4.4.2 In this permit references to reports and notifications mean written reports and notifications, except where reference is made to notification being made "immediately", in which case it may be provided by telephone.

Schedule 1 – Operations

Table S1.1 activities		
Activity listed in Schedule 1 of the EP Regulations	Description of specified activity	Limits of specified activity
Section 6.9 A(1)(a)(i) Rearing of poultry intensively in an installation with more than 40,000 places	The rearing of poultry in a facility with a capacity for 360,000 broiler places.	From receipt of birds, raw materials and fuels onto the site to removal of birds and associated wastes from site.
Directly Associated Activity	Description of specified activity	Limits of specified activity
Biomass boiler	Operation of one biomass boiler with a thermal rated input not exceeding 1.047MWth, for site heating requirements, burning biomass fuel not comprising waste or animal carcasses.	From receipt of raw materials and fuels, to release of combustion products to air and associated wastes removed from site.

Table S1.2 Operating techniques		
Description	Parts	Date Received
Application EPR/AP3439DZ/A001	Responses to application form B3.5 and referenced supporting documentation. Responses to Not Duly Made Request for Further Information.	05/08/16
Response to Schedule 5 Notice dated 06/12/16	Response to request for further information clarifying poultry house heating system, clean out procedures, standby generator, carcass disposal, confirmation of no on-site dwelling, receipt of Dust Management Plan and revised Site Condition Report.	22/12/16
Response to Schedule 5 Notice dated 27/03/17	Response to request for further information regarding compliance with the Best Available Techniques (BAT) Conclusion document dated 21/02/17.	28/03/17
Application EPR/AP3439DZ/V002	Responses to Parts C3.5 of the application form and referenced supporting documentation and plans.	24/10/17
Application EPR/AP3439DZ/V003	Responses to Parts C3.5 of the application form and referenced supporting documentation and plans.	21/12/17
Application EPR/AP3439DZ/V003	Responses to Not Duly Made Request for Further Information regarding compliance with the Best Available Techniques (BAT) Conclusion document dated 21/02/17 for poultry houses numbered 5 – 8.	06/03/18
Response to Schedule 5 Notice dated 05/06/2018	Response to request for information supplying an updated odour management plan (reference "Odour management plan") and noise management plan (reference "Noise management plan").	27/06/18
Response to Schedule 5 Notice dated 20/08/18	Response to request for information supplying an updated raw material list and an updated Emergency Management Plan, along with clarification on pest management.	29/08/18

Schedule 2 – Waste types, raw materials and fuels

Table S2.1 Raw materials and fuels	
Raw materials and fuel description	Specification
Fuel for biomass boiler units	Biomass chips or pellets comprising virgin timber, straw, miscanthus; grade A waste wood or a combination of these.

Schedule 3 – Emissions and monitoring

Table S3.1 Point source emissions to air – emission limits and monitoring requirements						
Emission point ref. & location	Source	Parameter	Limit (including unit)	Reference Period	Monitoring frequency	Monitoring standard or method
High velocity roof fan outlets on poultry houses 1 to 8 as shown on the site plan submitted with the application EPR/AP3439DZ/V003	Poultry houses 1 to 8	---	---	---	---	---
Gable end fan outlets on poultry houses 1 to 8 as shown on the site plan submitted with the application EPR/AP3439DZ/V003	Poultry houses 1 to 8	---	---	---	---	---
Exhaust from standby generator as shown on the site plan submitted with the application EPR/AP3439DZ/V003	Standby Generator	---	---	---	---	---
Vent from fuel tank as shown on the site plan submitted with the application EPR/AP3439DZ/V003	Diesel tank	---	---	---	---	---
Emissions from one biomass boiler as shown on the site plan submitted with the application EPR/AP3439DZ/V003	Aggregated 1.047 MWth boiler	---	---	---	---	---

Table S3.2 Point Source emissions to water (other than sewer) and land – emission limits and monitoring requirements						
Emission point ref. & location	Source	Parameter	Limit (incl. unit)	Reference Period	Monitoring frequency	Monitoring standard or method
French drains running along sides of poultry houses 1 – 8 acting as soakaways, as indicated on the site drainage plan submitted with the application EPR/AP3439DZ/V003	Roof water from poultry houses 1 – 8 and yard surface water (excluding poultry house wash out periods)	---	---	---	---	---

Table S3.2 Point Source emissions to water (other than sewer) and land – emission limits and monitoring requirements						
Emission point ref. & location	Source	Parameter	Limit (incl. unit)	Reference Period	Monitoring frequency	Monitoring standard or method
Swale acting as a soakaway located to the west of poultry houses as indicated on the site drainage plan submitted with the application EPR/AP3439DZ/V003	Roof water from poultry houses 1 – 8 and yard surface water (excluding poultry house wash out periods)	---	---	---	---	---

Table S3.3 Process monitoring requirements					
Emission point reference or source or description of point of measurement	Parameter	Limit (incl. Unit)	Monitoring frequency	Monitoring standard or method	Other specifications
Broilers – Houses 1 - 8	kg N excreted/animal place/year	0.6 kg N/animal place/year	Annually	Using a mass balance of nitrogen based on the feed intake, dietary content of crude protein, and animal performance or Estimation by using manure analysis for total nitrogen content	---
	kg P ₂ O ₅ excreted/animal place/year	0.25 kg P ₂ O ₅ animal place/year	Annually	Using a mass balance of phosphorus based on the feed intake, dietary content of crude protein, total phosphorus and animal performance or Estimation by using manure analysis for total phosphorus content	---
Broilers – Houses 1 - 8	kg NH ₃ /animal place/year	0.08 kg NH ₃ /animal place/year	Annually	Estimation using emission factors	House numbers 1 - 8
Broilers – Houses 1 - 8	Dust	n/a	Annually	Estimation using emission factors	House numbers 1 - 8

Schedule 4 – Reporting

Table S4.1 Reporting of monitoring data			
Parameter	Emission or monitoring point/reference	Reporting period	Period begins
Process monitoring Parameters as required by condition 3.5.1	-	Every 12 months	01 January

Table S4.2 Reporting forms		
Media/parameter	Reporting format	Date of form
kg NH ₃ /animal place/year	Form Air 1 or other form as agreed in writing by the Environment Agency	23/11/18
kg N excreted/animal place/year & kg P ₂ O ₅ excreted/animal place/year	Form N&P Excretion 1 or other form as agreed in writing by the Environment Agency	23/11/18
Dust atmospheric mass emission	Form Dust or other form as agreed in writing by the Environment Agency	23/11/18

Schedule 5 – Notification

These pages outline the information that the operator must provide.

Units of measurement used in information supplied under Part A and B requirements shall be appropriate to the circumstances of the emission. Where appropriate, a comparison should be made of actual emissions and authorised emission limits.

If any information is considered commercially confidential, it should be separated from non-confidential information, supplied on a separate sheet and accompanied by an application for commercial confidentiality under the provisions of the EP Regulations.

Part A

Permit Number	
Name of operator	
Location of Facility	
Time and date of the detection	

(a) Notification requirements for any malfunction, breakdown or failure of equipment or techniques, accident, or emission of a substance not controlled by an emission limit which has caused, is causing or may cause significant pollution	
To be notified within 24 hours of detection	
Date and time of the event	
Reference or description of the location of the event	
Description of where any release into the environment took place	
Substances(s) potentially released	
Best estimate of the quantity or rate of release of substances	
Measures taken, or intended to be taken, to stop any emission	
Description of the failure or accident.	

(b) Notification requirements for the breach of a limit	
To be notified within 24 hours of detection	
Emission point reference/ source	
Parameter(s)	
Limit	
Measured value and uncertainty	
Date and time of monitoring	

(b) Notification requirements for the breach of a limit	
To be notified within 24 hours of detection	
Measures taken, or intended to be taken, to stop the emission	

Time periods for notification following detection of a breach of a limit	
Parameter	Notification period

(c) Notification requirements for the detection of any significant adverse environmental effect	
To be notified within 24 hours of detection	
Description of where the effect on the environment was detected	
Substances(s) detected	
Concentrations of substances detected	
Date of monitoring/sampling	

Part B – to be submitted as soon as practicable

Any more accurate information on the matters for notification under Part A.	
Measures taken, or intended to be taken, to prevent a recurrence of the incident	
Measures taken, or intended to be taken, to rectify, limit or prevent any pollution of the environment which has been or may be caused by the emission	
The dates of any unauthorised emissions from the facility in the preceding 24 months.	

Name*	
Post	
Signature	
Date	

* authorised to sign on behalf of the operator

Schedule 6 – Interpretation

“accident” means an accident that may result in pollution.

“application” means the application for this permit, together with any additional information supplied by the operator as part of the application and any response to a notice served under Schedule 5 to the EP Regulations.

“authorised officer” means any person authorised by the Environment Agency under section 108(1) of The Environment Act 1995 to exercise, in accordance with the terms of any such authorisation, any power specified in section 108(4) of that Act.

“building” means a construction that has the objective of providing sheltering cover and minimising emissions of noise, particulate matter, odour and litter.

“emissions to land” includes emissions to groundwater.

“emissions of substances not controlled by emission limits” means emissions of substances to air, water or land from the activities, either from the emission points specified in schedule 3 or from other localised or diffuse sources, which are not controlled by an emission limit.

“EP Regulations” means The Environmental Permitting (England and Wales) Regulations 2016, SI 2016 No.1154 and words and expressions used in this permit which are also used in the EP Regulations have the same meanings as in those regulations.

“groundwater” means all water, which is below the surface of the ground in the saturation zone and in direct contact with the ground or subsoil.

“Hazardous property” has the meaning given in Annex III of the Waste Framework Directive.

“Industrial Emissions Directive” means Directive 2010/75/EU of the European Parliament and of the Council of 24 November 2010 on industrial emissions.

“List of Wastes” means the list of wastes established by Commission Decision 2000/532/EC replacing Decision 94/3/EC establishing a list of wastes pursuant to Article 1(a) of Council Directive 75/442/EEC on waste and Council Decision 94/904/EC establishing a list of hazardous waste pursuant to Article 1(4) of Council Directive 91/689/EEC on hazardous waste, as amended from time to time.

“Manure and slurry” have the following meaning:

- Manures may be either slurries or solid manures.
- Slurries consist of excreta produced by livestock whilst in a yard or building mixed with rainwater and wash water and, in some cases, waste bedding and feed. Slurries can be pumped or discharged by gravity.
- Slurry includes duck effluent, seepage from manure and wash water.
- Solid manures include farmyard manure (FYM) and comprise material from straw-based housing systems, excreta with lots of straw/sawdust/woodchips in it, or solids from mechanical separators.
- Most poultry systems produce solid manure (litter).
- Solid manure can generally be stacked.

“MCERTS” means the Environment Agency’s Monitoring Certification Scheme.

“pests” means Birds, Vermin and Insects.

“Waste code” means the six digit code referable to a type of waste in accordance with the List of Wastes and in relation to hazardous waste, includes the asterisk.

“Waste Framework Directive” or “WFD” means Waste Framework Directive 2008/98/EC of the European Parliament and of the Council of 19 November 2008 on waste.

“year” means calendar year ending 31 December.

Schedule 7 – Site plan

Site Plan

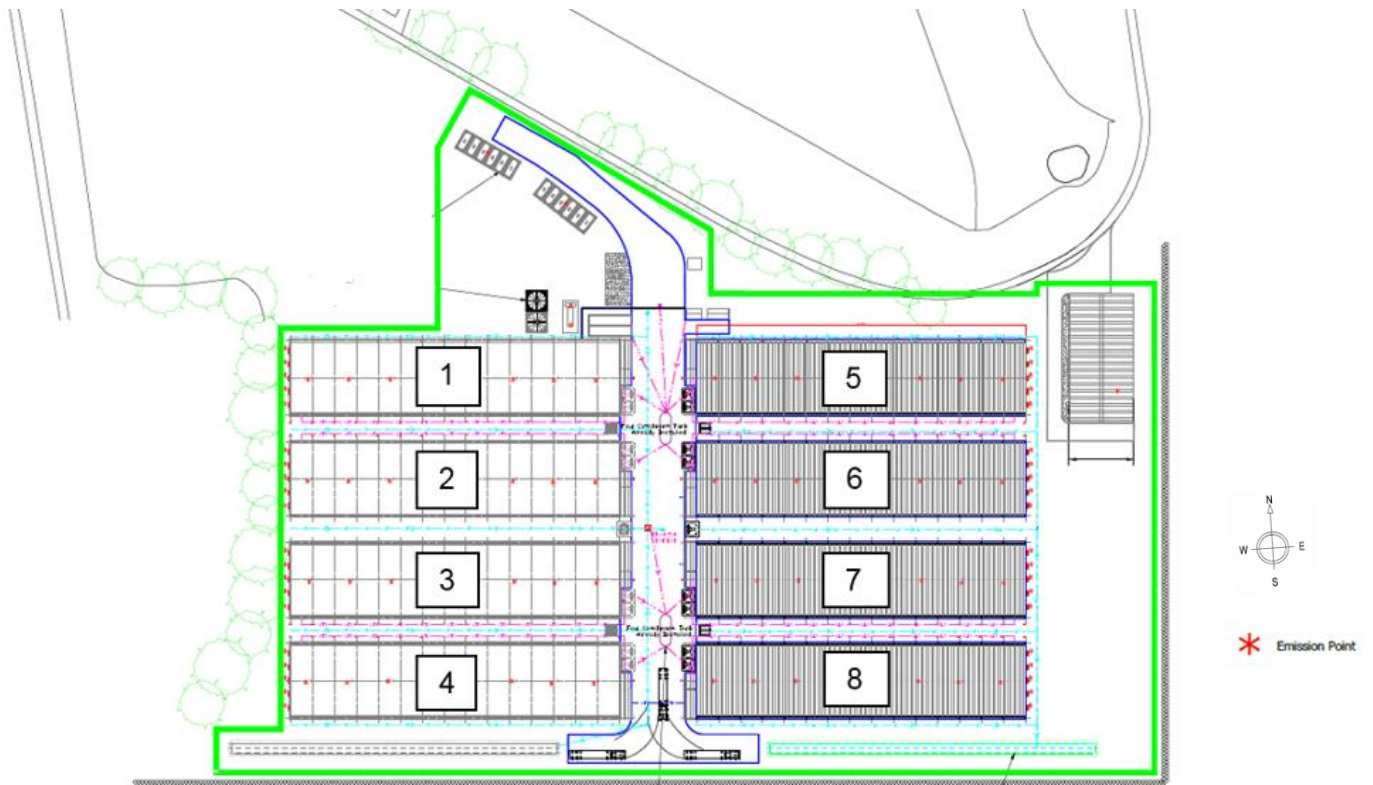

Crown Copyright. All rights reserved. Environment Agency, 100024198, 2018.

END OF PERMIT

Permit Number:

EPR/AP3439DZ

Operator:

Newcome Baker Farms Ltd

Facility

Whin Close Poultry Farm

Form Number:

Process Monitoring 1 23/11/2018

Reporting of other performance indicators for the period DD/MM/YYYY to DD/MM/YYYY

Ammonia emissions

Animal type/housing	Emission Factor utilised in Kg NH ₃ /animal place /year	Total Value for animal type/housing type in kg NH ₃ /year
		Total value for each animal type/housing
Total	-	Aggregate value to provide total installation emissions

Operator's comments:

Nitrogen excretion

Animal type	Emission Factor utilised in Kg N/animal place /year	Total Value for animal type/housing type in kg N excreted/year
		Total value for each animal type
Total	-	Aggregate value to provide total installation emissions

Operator's comments:

Phosphorous excretion

Animal type	Emission Factor utilised in Kg P/animal place /year	Total Value for animal type/housing type in kg P excreted/year
		Total value for each animal type
Total	-	Aggregate value to provide total installation emissions

Operator's comments:

Dust emissions

Animal type	Emission Factor utilised in Kg PM ₁₀ dust/animal place /year	Total Value for animal type/housing type in kg PM ₁₀ dust /year
		Total value for each animal type
Total	-	Aggregate value to provide total installation emissions

Operator's comments:

Signed

Date.....

(Authorised to sign as representative of Operator)