

Continues on Page 50

Electricity Act 1989 and Acquisition of Land Act 1981  
 The FAB Link Limited (Budleigh Salterton to Broadclyst) Compulsory Purchase Order 2016

Confirmed on behalf of the Secretary of State for Business, Energy and Industrial Strategy with modifications excluding any interests of Western Power Distribution (South West) plc in plots 1, 24, 24B, 28, 59, 60, 69, 70 and 73 of this Order.

Gareth Leigh  
 Head of Energy Infrastructure Planning  
 22 March 2018

*Gareth Leigh*

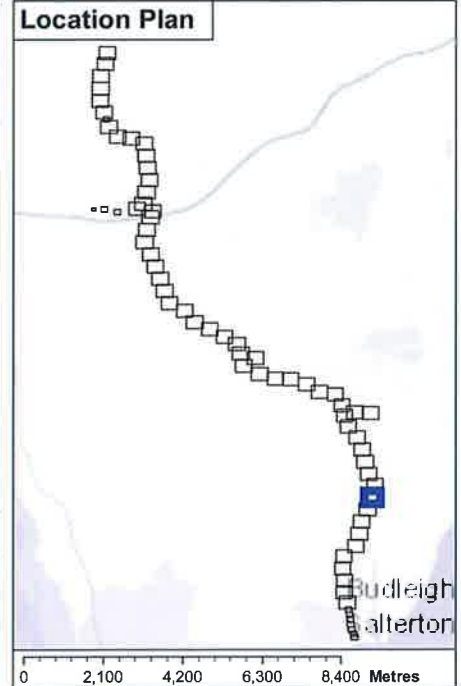

**Key:**

- Order Land
- Compulsory Purchase Order Category**
- Acquisition of Land
- Acquisition of Interconnector Rights
- Acquisition of Interconnector Rights and Access Rights
- Acquisition of Access Rights

Contains OS data © Crown Copyright and database right 2016  
 Coordinate System: British National Grid  
 Projection: Transverse Mercator  
 Datum: OSGB 1936

**Scheme Name:** Budleigh Salterton

**Drawing Name:**  
 Maps referred to in the FAB Link Limited (Budleigh Salterton to Broadclyst) Compulsory Purchase Order 2016

**Dwg:** 2016-11-11-151283-CP-050-0

**Coordinates:** 307,749 85,677

**Issue Date:** 28.11.2016

**First Issue Date:** 31.08.2016

**Sht. No:** 51 of 70    **Size:** A3

**Drn by:** TD    **App By:** HH

**Scale:**  
 1:1,250



The common seal of FAB Link Limited )

was affixed in the presence of: )

*Chris*  
 (Director)

in the presence of: *Chris*

Name of witness: CHRISTOPHER JENNER

Dated this 2nd day of December 2016



Continues on Page 52



The common seal of FAB Link Limited )

was affixed in the presence of: )

*Chris Vint*

(Director)

in the presence of: *Chris Jones*

Name of witness: CHRISTOPHER JONES

Dated this 2nd day of December 2016



Continues on Page 51

Electricity Act 1989 and Acquisition of Land Act 1981  
The FAB Link Limited (Budleigh Salterton to Broadclyst) Compulsory Purchase Order 2016

Confirmed on behalf of the Secretary of State for Business, Energy and Industrial Strategy with modifications excluding any interests of Western Power Distribution (South West) plc in plots 1, 24, 24B, 28, 59, 60, 69, 70 and 73 of this Order.

Gareth Leigh  
Head of Energy Infrastructure Planning  
22 March 2018

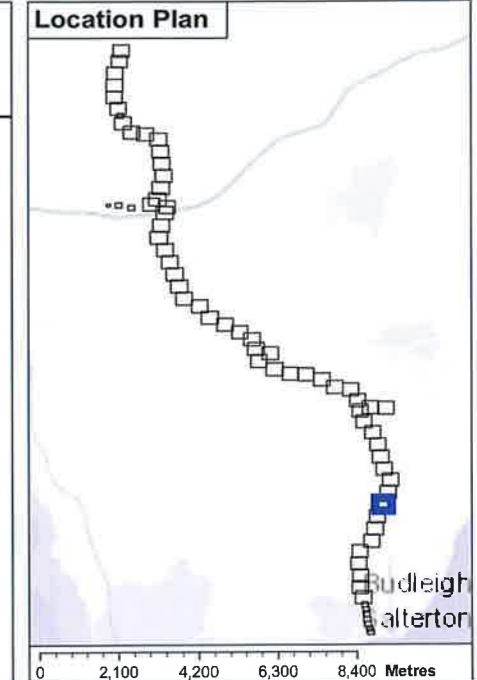

0 2,100 4,200 6,300 8,400 Metres

Key:

- Order Land
- Compulsory Purchase Order Category**
- Acquisition of Land
- Acquisition of Interconnector Rights
- Acquisition of Interconnector Rights and Access Rights
- Acquisition of Access Rights

Contains OS data © Crown Copyright and database right 2016  
Coordinate System: British National Grid  
Projection: Transverse Mercator  
Datum: OSGB 1936

Scheme Name: Budleigh Salterton

Drawing Name:  
Maps referred to in the FAB Link Limited (Budleigh Salterton to Broadclyst) Compulsory Purchase Order 2016

Dwg: 2016-11-11-151283-CP-051-0

Coordinates: 307,621 85,355

Issue Date: 28.11.2016

First Issue Date: 31.08.2016

Sht. No: 52 of 70 Size: A3

Drn by: TD App By: HH

Scale:  
1:1,250



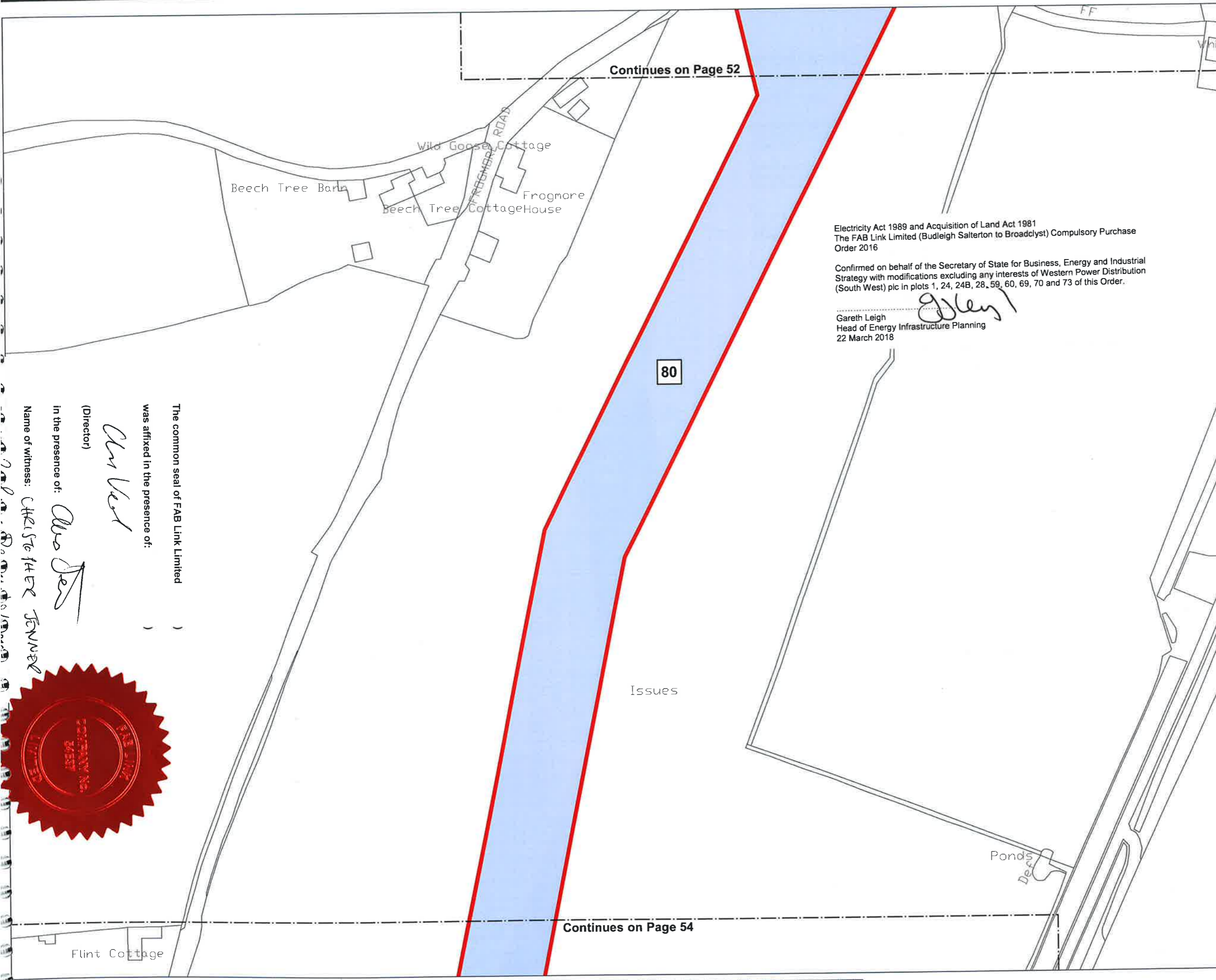

Continues on Page 52

80

Issues

Continues on Page 54

Electricity Act 1989 and Acquisition of Land Act 1981  
 The FAB Link Limited (Budleigh Salterton to Broadclyst) Compulsory Purchase Order 2016

Confirmed on behalf of the Secretary of State for Business, Energy and Industrial Strategy with modifications excluding any interests of Western Power Distribution (South West) plc in plots 1, 24, 24B, 28, 59, 60, 69, 70 and 73 of this Order.

Gareth Leigh  
 Head of Energy Infrastructure Planning  
 22 March 2018

The common seal of FAB Link Limited  
 was affixed in the presence of:  
 (Director)  
 in the presence of:  
 Name of witness: CHRISTOPHER JENNERS

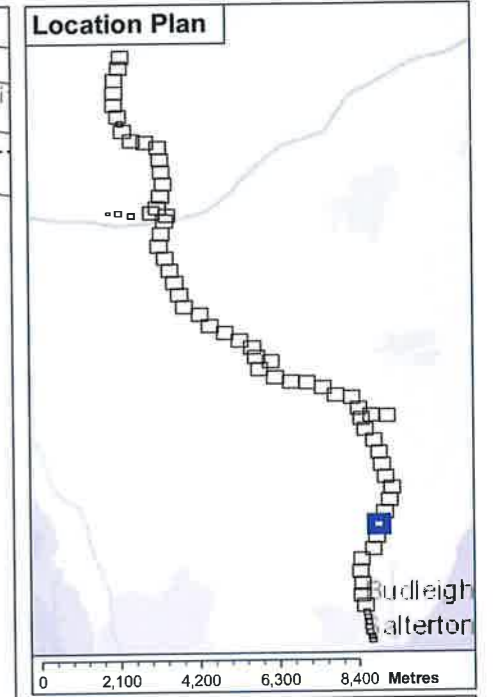

**Key:**

- Order Land
- Compulsory Purchase Order Category**
- Acquisition of Land
- Acquisition of Interconnector Rights
- Acquisition of Interconnector Rights and Access Rights
- Acquisition of Access Rights

Contains OS data © Crown Copyright and database right 2016  
 Coordinate System: British National Grid  
 Projection: Transverse Mercator  
 Datum: OSGB 1936

**Scheme Name:** Budleigh Salterton

**Drawing Name:**  
 Maps referred to in the FAB Link Limited (Budleigh Salterton to Broadclyst) Compulsory Purchase Order 2016

**Dwg:** 2016-11-11-151283-CP-052-0

**Coordinates:** 307,459 85,037

**Issue Date:** 28.11.2016

**First Issue Date:** 31.08.2016

**Sht. No:** 53 of 70 **Size:** A3

**Drn by:** TD **App By:** HH

**Scale:**  
 1:1,250



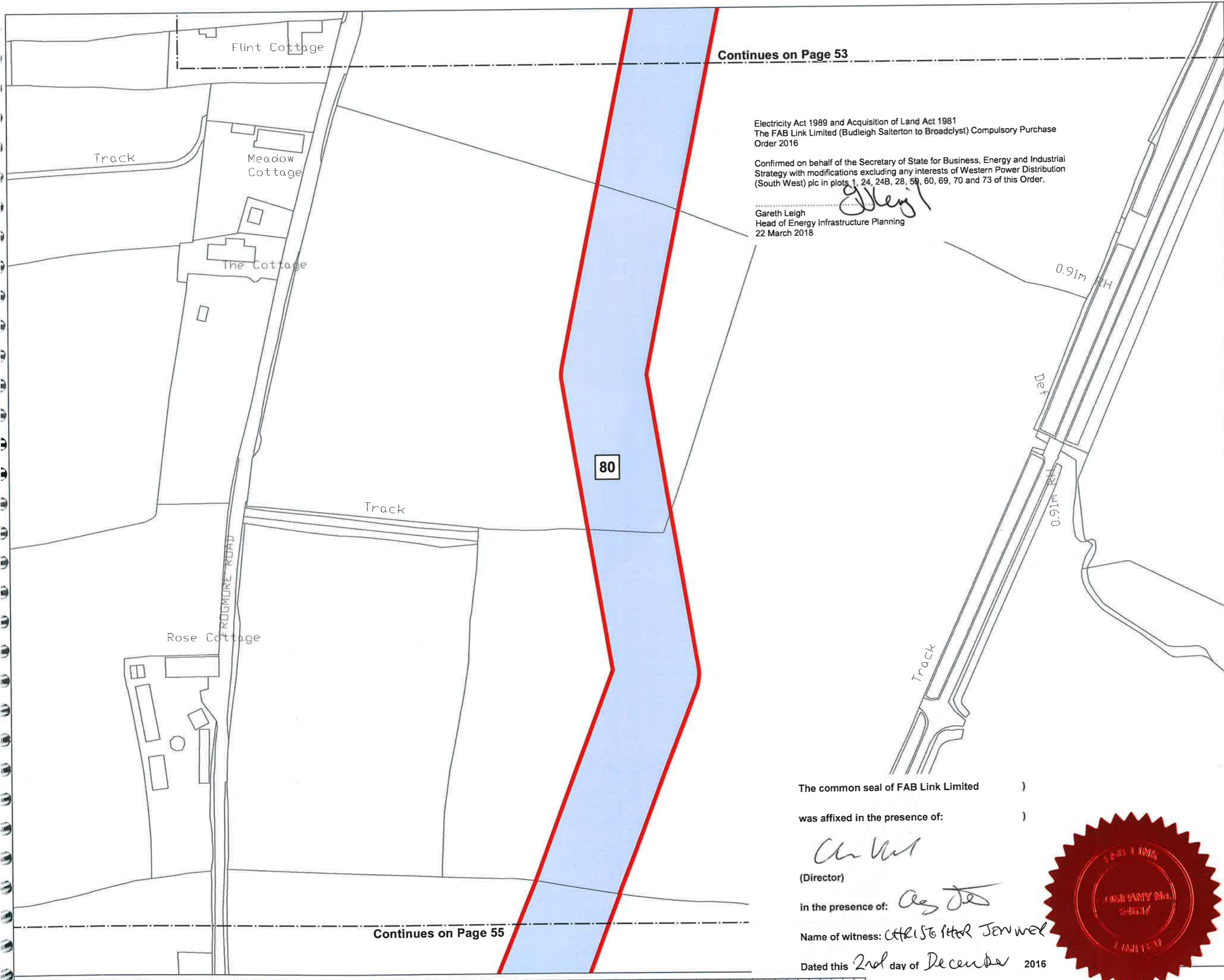

Continues on Page 53

Electricity Act 1989 and Acquisition of Land Act 1981  
 The FAB Link Limited (Budleigh Salterton to Broadclyst) Compulsory Purchase Order 2016  
 Confirmed on behalf of the Secretary of State for Business, Energy and Industrial Strategy with modifications excluding any interests of Western Power Distribution (South West) plc in plots 1, 24, 24B, 28, 59, 60, 69, 70 and 73 of this Order.

Gareth Leigh  
 Head of Energy Infrastructure Planning  
 22 March 2018

80

Continues on Page 55

The common seal of FAB Link Limited )  
 was affixed in the presence of: )

*Chris West*  
 (Director)  
 in the presence of: *Ag J*  
 Name of witness: *CHRISTOPHER JENNER*  
 Dated this *2nd* day of *December* 2016

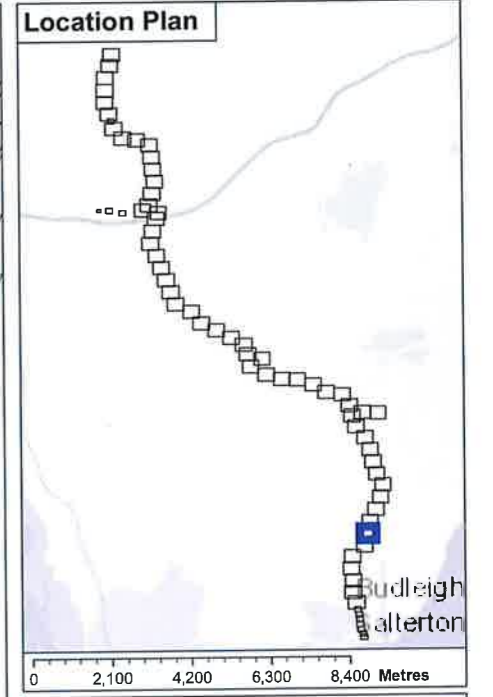
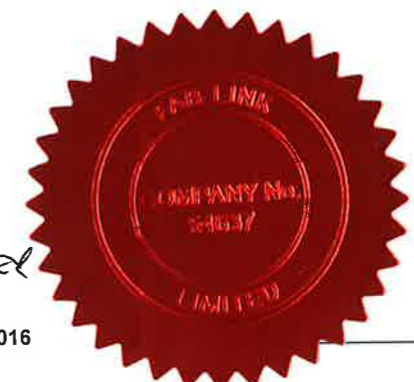

**Key:**

- Order Land
- Compulsory Purchase Order Category**
- Acquisition of Land
- Acquisition of Interconnector Rights
- Acquisition of Interconnector Rights and Access Rights
- Acquisition of Access Rights

Contains OS data © Crown Copyright and database right 2016  
 Coordinate System: British National Grid  
 Projection: Transverse Mercator  
 Datum: OSGB 1936

**Scheme Name:** Budleigh Salterton

**Drawing Name:**  
 Maps referred to in the FAB Link Limited (Budleigh Salterton to Broadclyst) Compulsory Purchase Order 2016

**Dwg:** 2016-11-11-151283-CP-053-0

**Coordinates:** 307,400 84,716

**Issue Date:** 28.11.2016

**First Issue Date:** 31.08.2016

**Sht. No:** 54 of 70 **Size:** A3

**Drn by:** TD **App By:** HH

**Scale:**  
 1:1,250



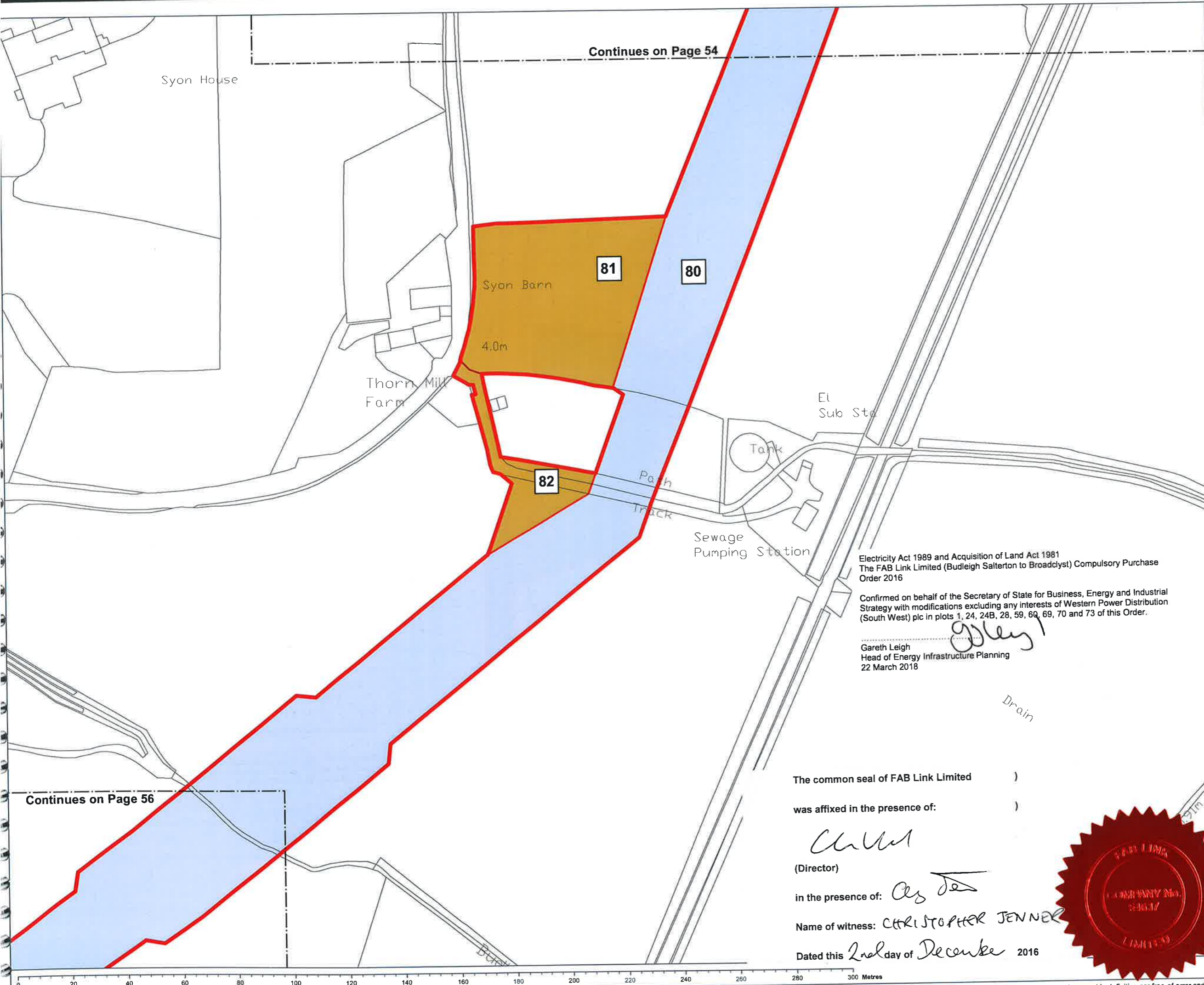

Continues on Page 54

Continues on Page 56

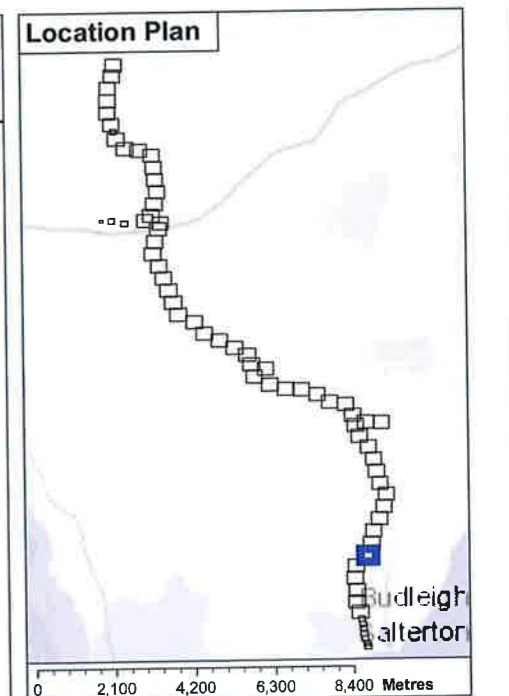

**Key:**

- Order Land
- Compulsory Purchase Order Category**
- Acquisition of Land
- Acquisition of Interconnector Rights
- Acquisition of Interconnector Rights and Access Rights
- Acquisition of Access Rights

Contains OS data © Crown Copyright and database right 2016  
Coordinate System: British National Grid  
Projection: Transverse Mercator  
Datum: OSGB 1936

**Scheme Name:** Budleigh Salterton

**Drawing Name:**  
Maps referred to in the FAB Link Limited (Budleigh Salterton to Broadclyst) Compulsory Purchase Order 2016

**Dwg:** 2016-11-11-151283-CP-054-0

**Coordinates:** 307,311 84,392

**Issue Date:** 28.11.2016

**First Issue Date:** 31.08.2016

**Sht. No:** 55 of 70    **Size:** A3

**Drn by:** TD    **App By:** HH

**Scale:** 1:1,250

Electricity Act 1989 and Acquisition of Land Act 1981  
The FAB Link Limited (Budleigh Salterton to Broadclyst) Compulsory Purchase Order 2016

Confirmed on behalf of the Secretary of State for Business, Energy and Industrial Strategy with modifications excluding any interests of Western Power Distribution (South West) plc in plots 1, 24, 24B, 28, 59, 69, 70 and 73 of this Order.

*Gareth Leigh*  
Gareth Leigh  
Head of Energy Infrastructure Planning  
22 March 2018

The common seal of FAB Link Limited )  
was affixed in the presence of: )

*Chris Jenner*  
(Director)

in the presence of: *Chris Jenner*  
Name of witness: CHRISTOPHER JENNER

Dated this 2nd day of December 2016



0  
1  
2  
3  
4  
5  
6  
7  
8  
9  
10  
11  
12  
13  
14  
15  
16  
17  
18  
19  
20  
21  
22  
23  
24  
25  
26  
27  
28  
29  
30  
31  
32  
33  
34  
35  
36  
37  
38  
39  
40  
41  
42  
43  
44  
45  
46  
47  
48  
49  
50  
51  
52  
53  
54  
55  
56  
57  
58  
59  
60  
61  
62  
63  
64  
65  
66  
67  
68  
69  
70  
71  
72  
73  
74  
75  
76  
77  
78  
79  
80  
81  
82  
83  
84  
85  
86  
87  
88  
89  
90  
91  
92  
93  
94  
95  
96  
97  
98  
99  
100

The common seal of FAB Link Limited  
 was affixed in the presence of:  
 (Director)  
 in the presence of:  
 Name of witness: CERISTIFTER JENNIE



The common seal of FAB Link Limited  
 was affixed in the presence of:  
 (Director)  
 in the presence of:  
 Name of witness: CERISTIFTER JENNIE

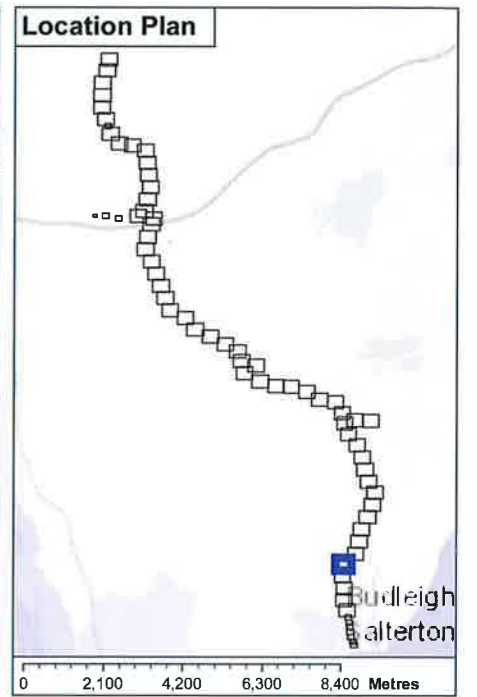
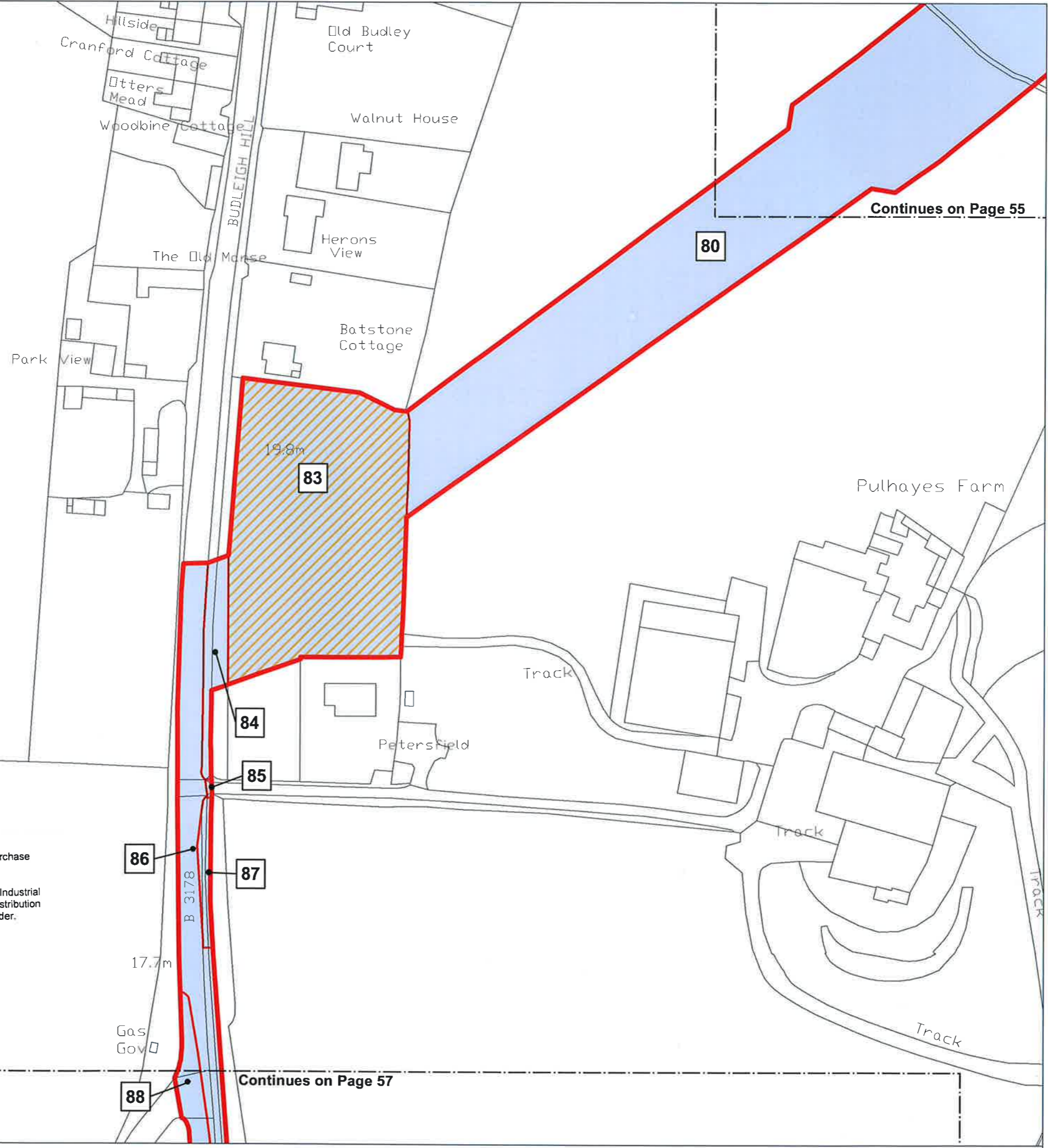

**Key:**

- Order Land
- Compulsory Purchase Order Category**
- Acquisition of Land
- Acquisition of Interconnector Rights
- Acquisition of Interconnector Rights and Access Rights
- Acquisition of Access Rights

Contains OS data © Crown Copyright and database right 2016  
 Coordinate System: British National Grid  
 Projection: Transverse Mercator  
 Datum: OSGB 1936

**Scheme Name:** Budleigh Salterton

**Drawing Name:**  
 Maps referred to in the FAB Link Limited (Budleigh Salterton to Broadclyst) Compulsory Purchase Order 2016

**Dwg:** 2016-11-11-151283-CP-055-0

**Coordinates:** 306,979 84,115

**Issue Date:** 28.11.2016

**First Issue Date:** 31.08.2016

**Sht. No:** 56 of 70 **Size:** A3

**Drn by:** TD **App By:** HH

**Scale:**  
 1:1,250



Electricity Act 1989 and Acquisition of Land Act 1981  
 The FAB Link Limited (Budleigh Salterton to Broadclyst) Compulsory Purchase Order 2016

Confirmed on behalf of the Secretary of State for Business, Energy and Industrial Strategy with modifications excluding any interests of Western Power Distribution (South West) plc in plots 1, 24, 24B, 28, 59, 60, 69, 70 and 73 of this Order.

Gareth Leigh  
 Head of Energy Infrastructure Planning  
 22 March 2018

Continues on Page 57

The common seal of FAB Link Limited )

was affixed in the presence of: )

*Chris West*  
(Director)

in the presence of: *Chris Jen*

Name of witness: CHRISTOPHER JENNEX

Dated this 2nd day of December 2016



Continues on Page 51

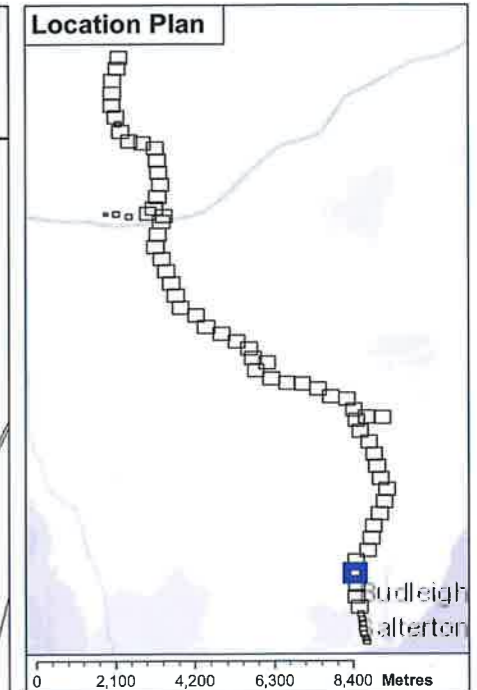

**Key:**

- Order Land
- Compulsory Purchase Order Category**
- Acquisition of Land
- Acquisition of Interconnector Rights
- Acquisition of Interconnector Rights and Access Rights
- Acquisition of Access Rights

Contains OS data © Crown Copyright and database right 2016  
Coordinate System: British National Grid  
Projection: Transverse Mercator  
Datum: OSGB 1936

**Scheme Name:** Budleigh Salterton

**Drawing Name:**  
Maps referred to in the FAB Link Limited (Budleigh Salterton to Broadclyst) Compulsory Purchase Order 2016

**Dwg:** 2016-11-11-151283-CP-056-0

**Coordinates:** 306,955 83,795

**Issue Date:** 28.11.2016

**First Issue Date:** 31.08.2016

**Sht. No:** 57 of 70 **Size:** A3

**Drn by:** TD **App By:** HH

**Scale:** 1:1,250

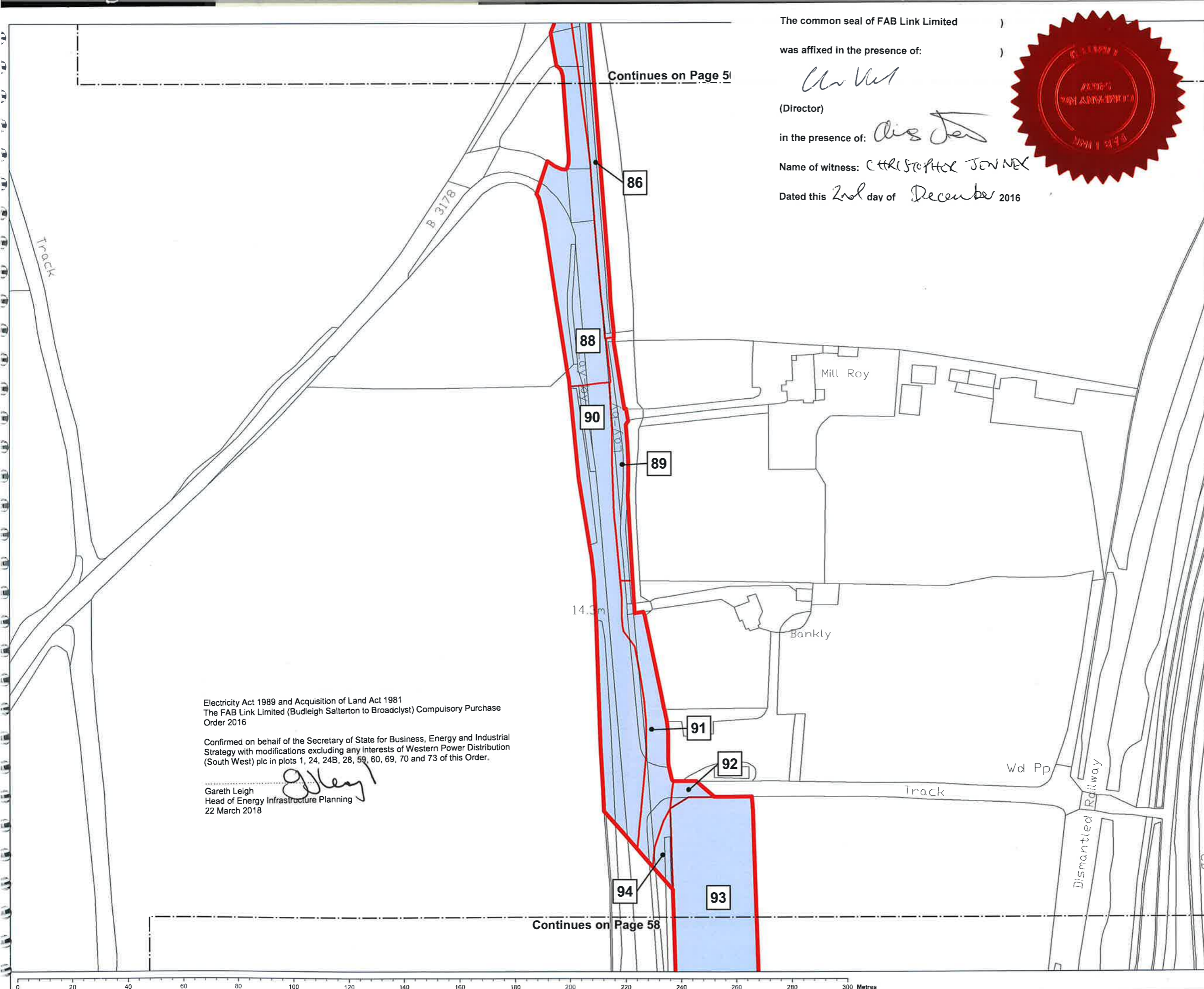

Continues on Page 58

Electricity Act 1989 and Acquisition of Land Act 1981  
The FAB Link Limited (Budleigh Salterton to Broadclyst) Compulsory Purchase Order 2016

Confirmed on behalf of the Secretary of State for Business, Energy and Industrial Strategy with modifications excluding any interests of Western Power Distribution (South West) plc in plots 1, 24, 24B, 28, 59, 60, 69, 70 and 73 of this Order.

*Gareth Leigh*  
Gareth Leigh  
Head of Energy Infrastructure Planning  
22 March 2018

Continues on Page 57

93

Continues on Page 59

Electricity Act 1989 and Acquisition of Land Act 1981  
The FAB Link Limited (Budleigh Salterton to Broadclyst) Compulsory Purchase Order 2016

Confirmed on behalf of the Secretary of State for Business, Energy and Industrial Strategy with modifications excluding any interests of Western Power Distribution (South West) plc in plots 1, 24, 24B, 28, 59, 60, 69, 70 and 73 of this Order.

*Gareth Leigh*  
Gareth Leigh  
Head of Energy Infrastructure Planning  
22 March 2018

The common seal of FAB Link Limited )  
was affixed in the presence of: )  
*Chris West*  
(Director)

in the presence of: *Chris West*  
Name of witness: CHRISTOPHER JENNEX  
Dated this 2nd day of December 2016



**Key:**

- Order Land
- Compulsory Purchase Order Category**
- Acquisition of Land
- Acquisition of Interconnector Rights
- Acquisition of Interconnector Rights and Access Rights
- Acquisition of Access Rights

Contains OS data © Crown Copyright and database right 2016  
Coordinate System: British National Grid  
Projection: Transverse Mercator  
Datum: OSGB 1936

**Scheme Name:** Budleigh Salterton

**Drawing Name:**  
Maps referred to in the FAB Link Limited (Budleigh Salterton to Broadclyst) Compulsory Purchase Order 2016

**Dwg:** 2016-11-11-151283-CP-057-0

**Coordinates:** 307,004 83,473

**Issue Date:** 28.11.2016

**First Issue Date:** 31.08.2016

**Sht. No:** 58 of 70    **Size:** A3

**Drn by:** TD    **App By:** HH

**Scale:**  
1:1,250





The common seal of FAB Link Limited )

was affixed in the presence of: )

*Chris*

(Director)

in the presence of: *As J*

Name of witness: CHRISTOPHER JEWNER

Dated this 2nd day of December 2016



Continues on Page 58

15.5m

Electricity Act 1989 and Acquisition of Land Act 1981  
The FAB Link Limited (Budleigh Salterton to Broadclyst) Compulsory Purchase Order 2016

Confirmed on behalf of the Secretary of State for Business, Energy and Industrial Strategy with modifications excluding any interests of Western Power Distribution (South West) plc in plots 1, 24, 24B, 26, 59, 60, 69, 70 and 73 of this Order.

*Gareth Leigh*  
Gareth Leigh  
Head of Energy Infrastructure Planning  
22 March 2018

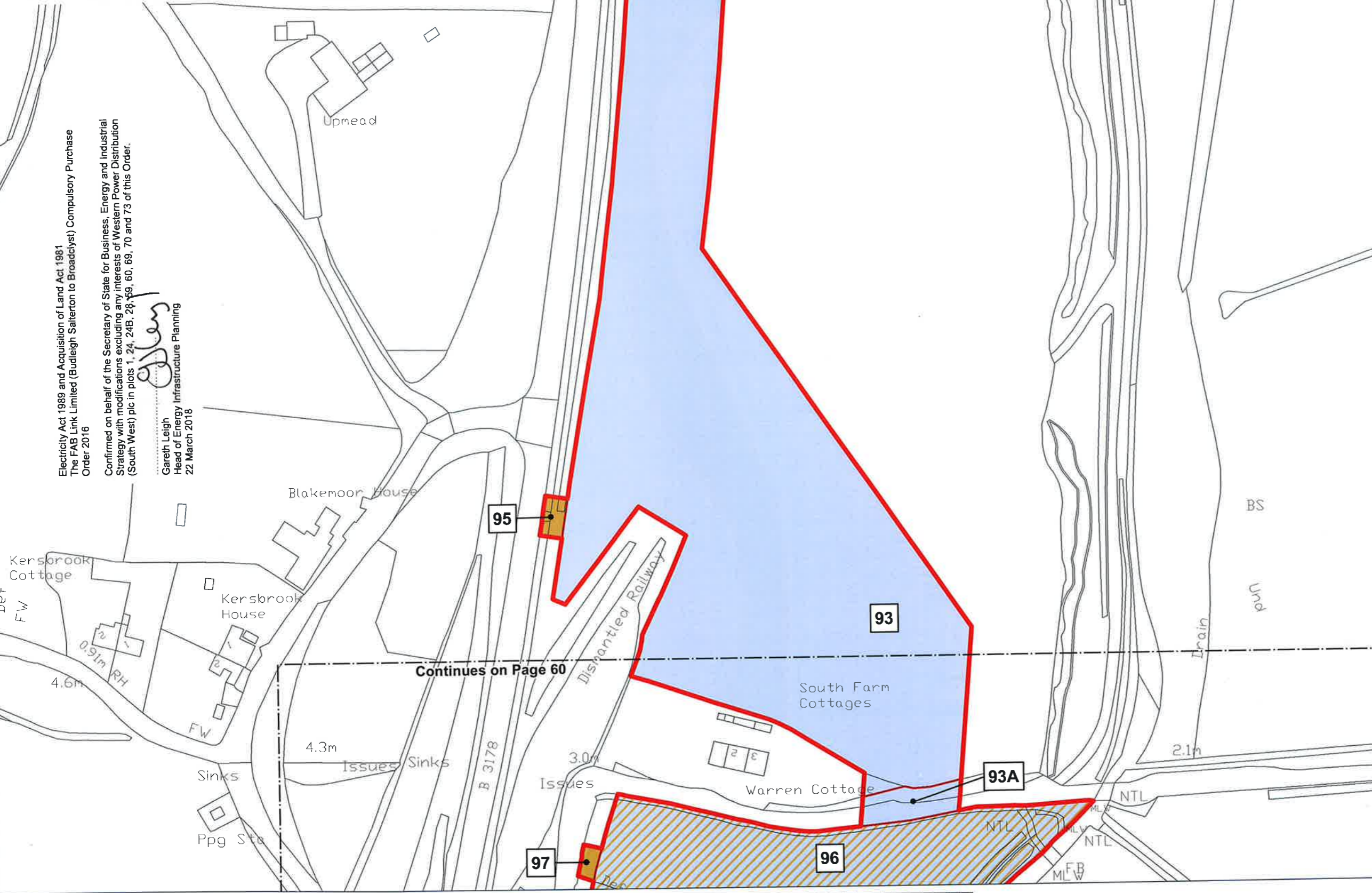

Continues on Page 60

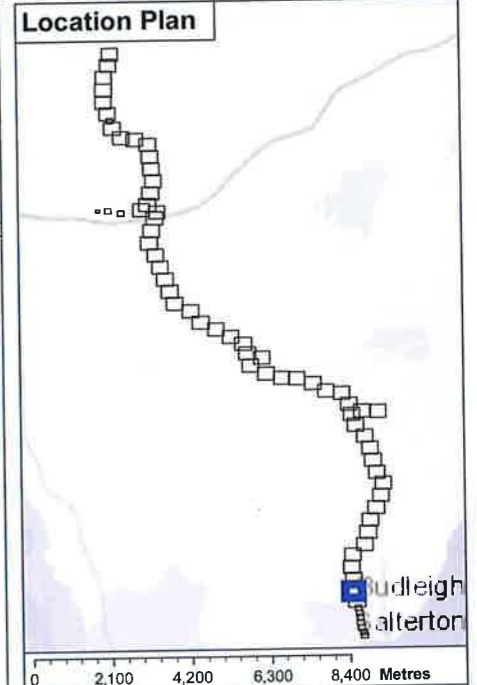

**Key:**

- Order Land
- Compulsory Purchase Order Category**
- Acquisition of Land
- Acquisition of Interconnector Rights
- Acquisition of Interconnector Rights and Access Rights
- Acquisition of Access Rights

Contains OS data © Crown Copyright and database right 2016  
Coordinate System: British National Grid  
Projection: Transverse Mercator  
Datum: OSGB 1936

**Scheme Name:** Budleigh Salterton

**Drawing Name:**  
Maps referred to in the FAB Link Limited (Budleigh Salterton to Broadclyst) Compulsory Purchase Order 2016

**Dwg:** 2016-11-11-151283-CP-058-0

**Coordinates:** 306,991 83,152

**Issue Date:** 28.11.2016

**First Issue Date:** 31.08.2016

**Sht. No:** 59 of 70 **Size:** A3

**Drn by:** TD **App By:** HH

**Scale:**  
1:1,250



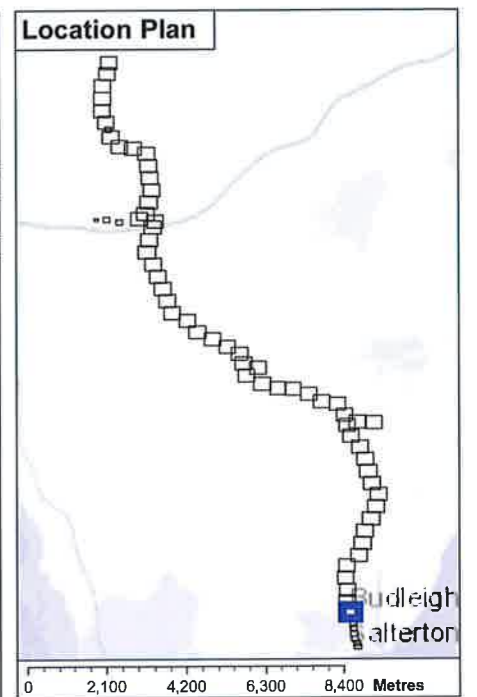
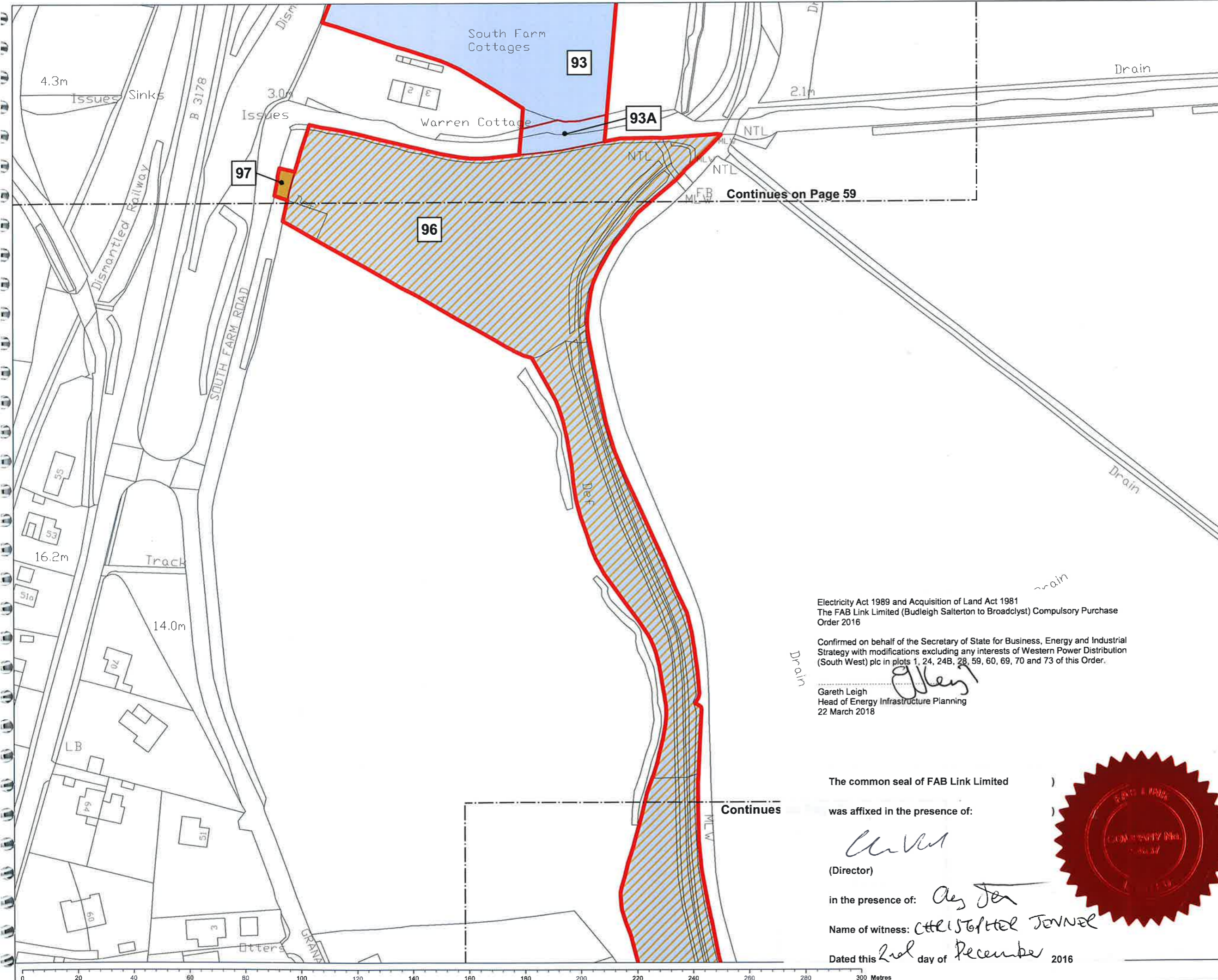

**Key:**

- Order Land
- Compulsory Purchase Order Category**
- Acquisition of Land
- Acquisition of Interconnector Rights
- Acquisition of Interconnector Rights and Access Rights
- Acquisition of Access Rights

Contains OS data © Crown Copyright and database right 2016  
 Coordinate System: British National Grid  
 Projection: Transverse Mercator  
 Datum: OSGB 1936

**Scheme Name:** Budleigh Salterton

**Drawing Name:**  
 Maps referred to in the FAB Link Limited (Budleigh Salterton to Broadclyst) Compulsory Purchase Order 2016

**Dwg:** 2016-11-11-151283-CP-059-0

**Coordinates:** 307,078 82,881

**Issue Date:** 28.11.2016

**First Issue Date:** 31.08.2016

**Sht. No:** 60 of 70 **Size:** A3

**Drn by:** TD **App By:** HH

**Scale:**  
 1:1,250



Electricity Act 1989 and Acquisition of Land Act 1981  
 The FAB Link Limited (Budleigh Salterton to Broadclyst) Compulsory Purchase Order 2016

Confirmed on behalf of the Secretary of State for Business, Energy and Industrial Strategy with modifications excluding any interests of Western Power Distribution (South West) plc in plots 1, 24, 24B, 28, 59, 60, 69, 70 and 73 of this Order.

Gareth Leigh  
 Head of Energy Infrastructure Planning  
 22 March 2018

The common seal of FAB Link Limited )  
 was affixed in the presence of: )

*[Signature]*  
 (Director)

in the presence of: *[Signature]*

Name of witness: CHRISTOPHER JOURNAL

Dated this 2nd day of December 2016



Continues

Continues on Page 59