



Continues on Page 40

Continues on Page 44

Continues on Page 42

The common seal of FAB Link Limited )

was affixed in the presence of: )

(Director)

in the presence of:

Name of witness: CHRISTOPHER JENNERS

Dated this 2nd day of December 2016

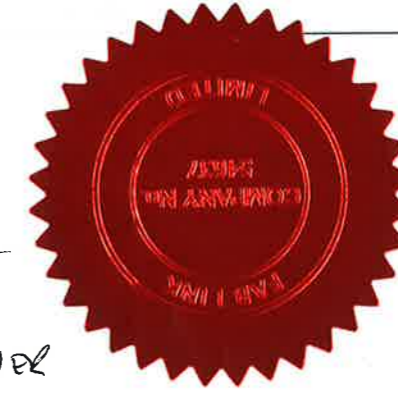

Electricity Act 1989 and Acquisition of Land Act 1981  
The FAB Link Limited (Budleigh Salterton to Broadclyst) Compulsory Purchase Order 2016

Confirmed on behalf of the Secretary of State for Business, Energy and Industrial Strategy with modifications excluding any interests of Western Power Distribution (South West) plc in plots 1, 24, 24B, 28, 59, 60, 69, 70 and 73 of this Order.

Gareth Leigh  
Head of Energy Infrastructure Planning  
22 March 2018

**Location Plan**

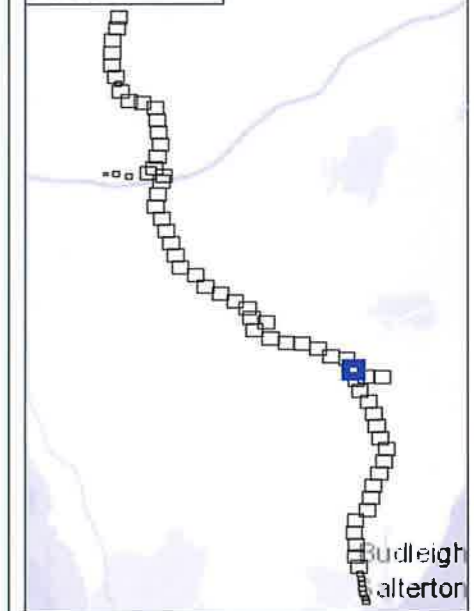

**Key:**

- Order Land
- Compulsory Purchase Order Category**
- Acquisition of Land
- Acquisition of Interconnector Rights
- Acquisition of Interconnector Rights and Access Rights
- Acquisition of Access Rights

Contains OS data © Crown Copyright and database right 2016  
Coordinate System: British National Grid  
Projection: Transverse Mercator  
Datum: OSGB 1936

**Scheme Name:** Budleigh Salterton

**Drawing Name:**  
Maps referred to in the FAB Link Limited (Budleigh Salterton to Broadclyst) Compulsory Purchase Order 2016

**Dwg:** 2016-11-11-151283-CP-040-0

**Coordinates:** 306,935 88,105

**Issue Date:** 28.11.2016

**First Issue Date:** 31.08.2016

**Sht. No:** 41 of 70 **Size:** A3

**Drn by:** TD **App By:** HH

**Scale:**  
1:1,250



The common seal of FAB Link Limited )

was affixed in the presence of: )

*[Signature]*

(Director)

in the presence of: *[Signature]*

Name of witness: CHRISTOPHER JOURNAL

Dated this 2nd day of December 2016

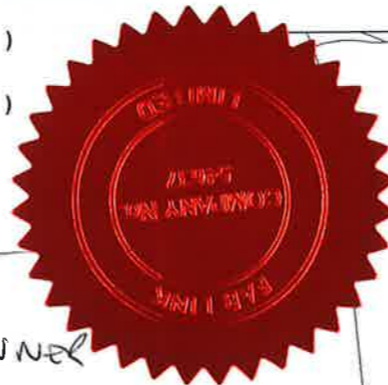

Electricity Act 1989 and Acquisition of Land Act 1981  
The FAB Link Limited (Budleigh Salterton to Broadclyst) Compulsory Purchase Order 2016

Confirmed on behalf of the Secretary of State for Business, Energy and Industrial Strategy with modifications excluding any interests of Western Power Distribution (South West) plc in plots 1, 24, 24B, 28, 59, 60, 69, 70 and 73 of this Order.

Gareth Leigh  
Head of Energy Infrastructure Planning  
22 March 2018

*[Signature]*

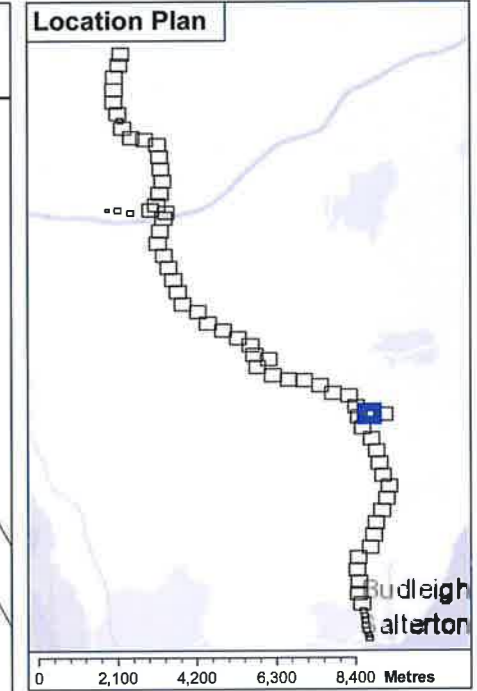

Key:

- Order Land
- Compulsory Purchase Order Category**
- Acquisition of Land
- Acquisition of Interconnector Rights
- Acquisition of Interconnector Rights and Access Rights
- Acquisition of Access Rights

Contains OS data © Crown Copyright and database right 2016  
Coordinate System: British National Grid  
Projection: Transverse Mercator  
Datum: OSGB 1936

Scheme Name: Budleigh Salterton

Drawing Name:  
Maps referred to in the FAB Link Limited (Budleigh Salterton to Broadclyst) Compulsory Purchase Order 2016

Dwg: 2016-11-11-151283-CP-041-0

Coordinates: 307,284 87,922

Issue Date: 28.11.2016

First Issue Date: 31.08.2016

Sht. No: 42 of 70 Size: A3

Drn by: TD App By: HH

Scale: 1:1,250

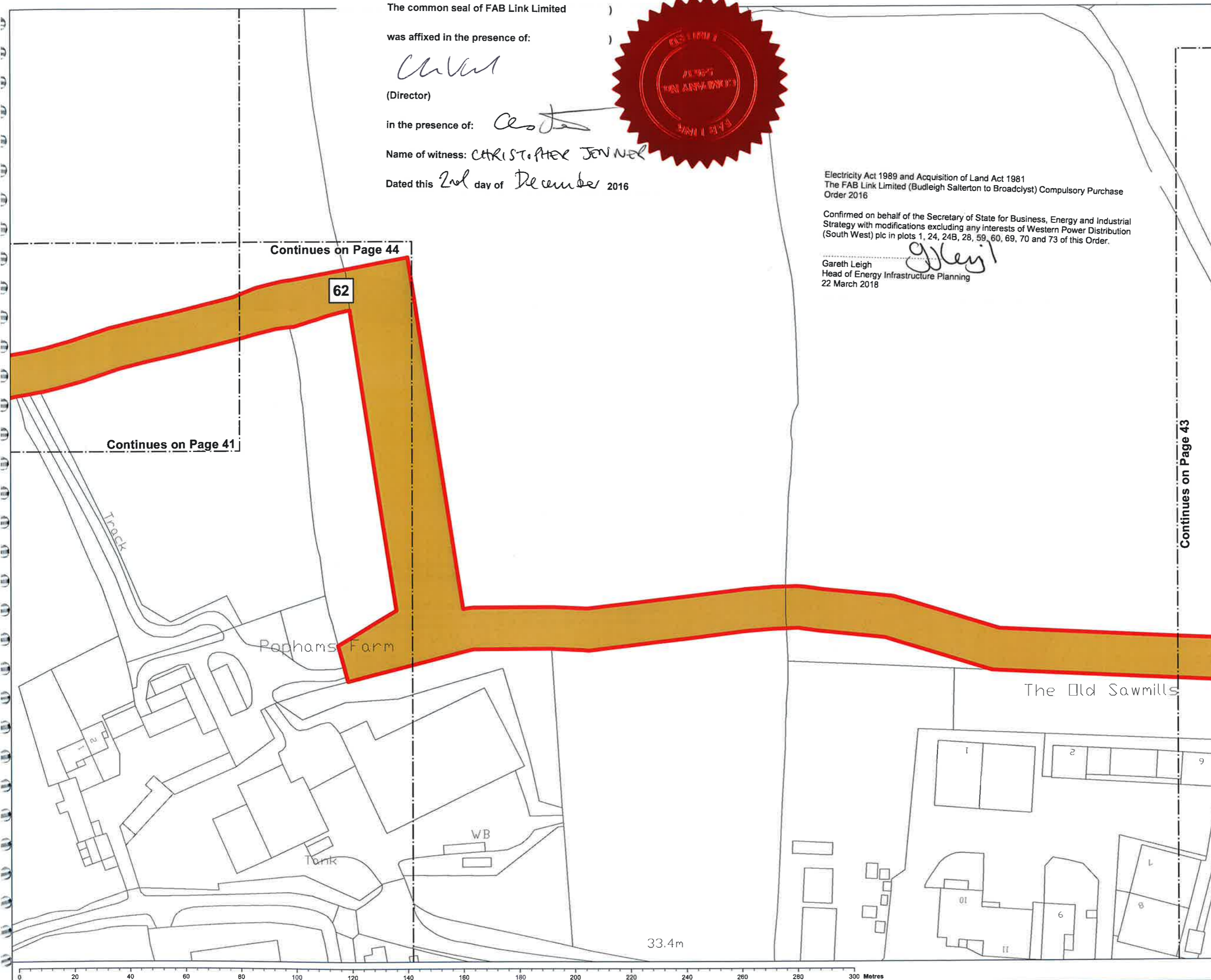

The common seal of FAB Link Limited )

was affixed in the presence of: )

*Chris Vint*

(Director)

in the presence of: *Chris Jones*

Name of witness: CHRISTOPHER JONES

Dated this 2nd day of December 2016

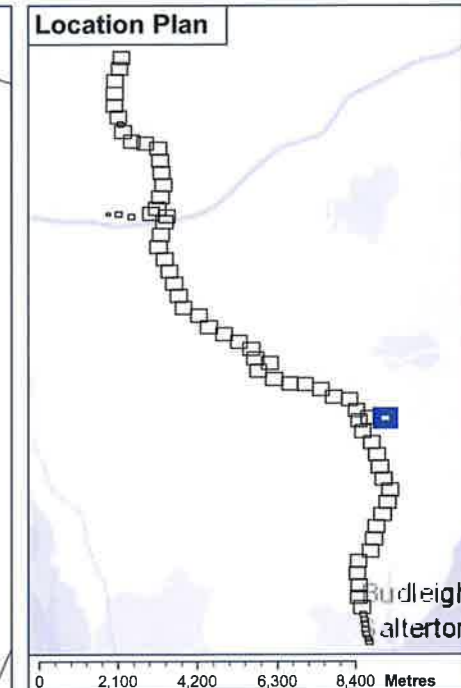

**Key:**

- Order Land
- Compulsory Purchase Order Category**
- Acquisition of Land
- Acquisition of Interconnector Rights
- Acquisition of Interconnector Rights and Access Rights
- Acquisition of Access Rights

Contains OS data © Crown Copyright and database right 2016  
Coordinate System: British National Grid  
Projection: Transverse Mercator  
Datum: OSGB 1936

**Scheme Name:** Budleigh Salterton

**Drawing Name:**  
Maps referred to in the FAB Link Limited (Budleigh Salterton to Broadclyst) Compulsory Purchase Order 2016

**Dwg:** 2016-11-11-151283-CP-042-0

**Coordinates:** 307,702 87,908

**Issue Date:** 28.11.2016

**First Issue Date:** 31.08.2016

**Sht. No:** 43 of 70 **Size:** A3

**Drn by:** TD **App By:** HH

**Scale:**  
1:1,250

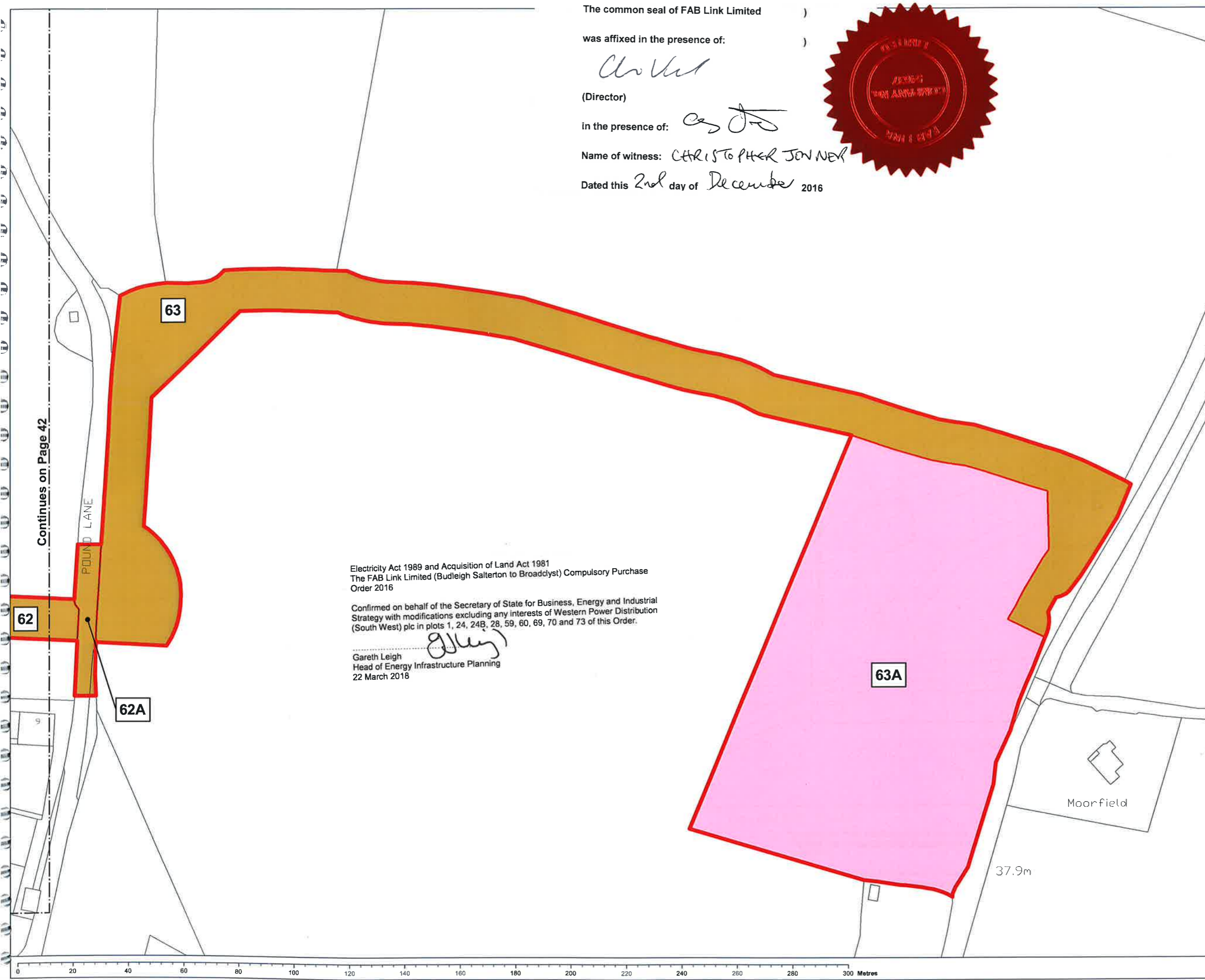

Electricity Act 1989 and Acquisition of Land Act 1981  
The FAB Link Limited (Budleigh Salterton to Broadclyst) Compulsory Purchase Order 2016

Confirmed on behalf of the Secretary of State for Business, Energy and Industrial Strategy with modifications excluding any interests of Western Power Distribution (South West) plc in plots 1, 24, 24B, 28, 59, 60, 69, 70 and 73 of this Order.

*Gareth Leigh*  
Gareth Leigh  
Head of Energy Infrastructure Planning  
22 March 2018

Continues on Page 42

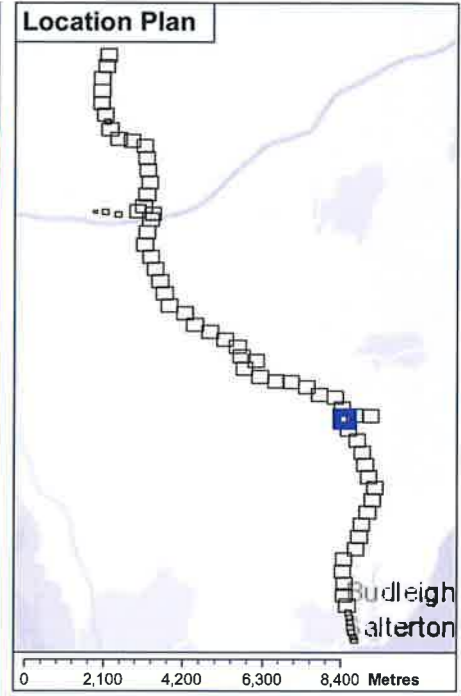
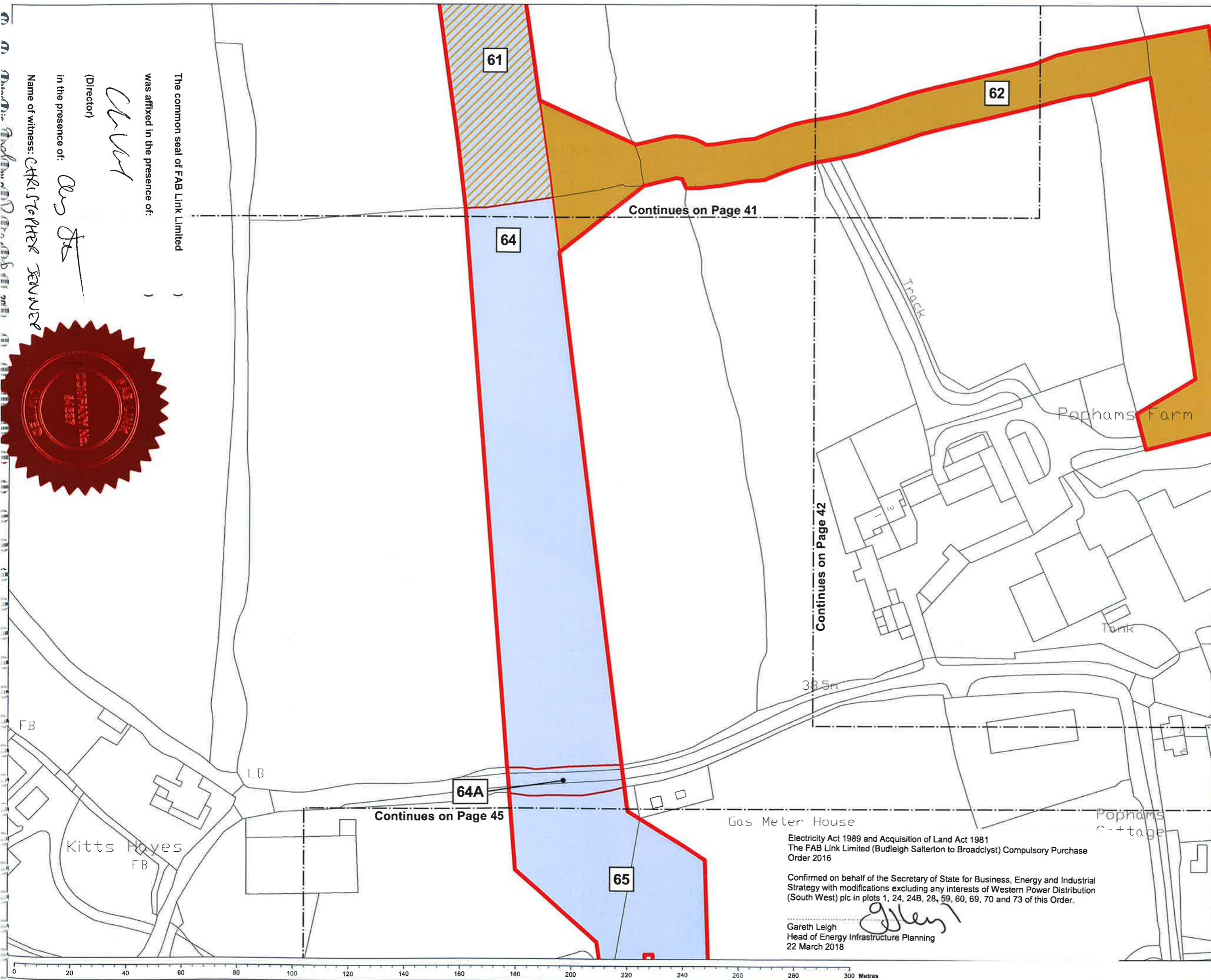

**Key:**

- Order Land
- Compulsory Purchase Order Category**
- Acquisition of Land
- Acquisition of Interconnector Rights
- Acquisition of Interconnector Rights and Access Rights
- Acquisition of Access Rights

Contains OS data © Crown Copyright and database right 2016  
Coordinate System: British National Grid  
Projection: Transverse Mercator  
Datum: OSGB 1936

**Scheme Name:** Budleigh Salterton

**Drawing Name:**  
Maps referred to in the FAB Link Limited (Budleigh Salterton to Broadclyst) Compulsory Purchase Order 2016

**Dwg:** 2016-11-11-151283-CP-043-0

**Coordinates:** 306,997 87,839

**Issue Date:** 28.11.2016

**First Issue Date:** 31.08.2016

**Sht. No:** 44 of 70    **Size:** A3

**Drn by:** TD    **App By:** HH

**Scale:**  
1:1,250



The common seal of FAB Link Limited  
was affixed in the presence of:  
*[Signature]*  
(Director)

in the presence of: *[Signature]*  
Name of witness: CHRISTOPHER JENNINGS



Electricity Act 1989 and Acquisition of Land Act 1981  
The FAB Link Limited (Budleigh Salterton to Broadclyst) Compulsory Purchase Order 2016

Confirmed on behalf of the Secretary of State for Business, Energy and Industrial Strategy with modifications excluding any interests of Western Power Distribution (South West) plc in plots 1, 24, 24B, 28, 59, 60, 69, 70 and 73 of this Order.

*[Signature]*  
Gareth Leigh  
Head of Energy Infrastructure Planning  
22 March 2018

The information contained in this document is confidential and protected by copyright. The use, copying or disclosure to a third party, either wholly or in part, except with the written permission of, and in the manner prescribed by FABLink constitutes an infringement of copyright. Dalcour Maclaren does not warrant that this document is definitive nor free of error and does not accept liability for any loss caused or arising from reliance upon information provided herein. Although our best efforts have been made to ensure the accuracy of these plans, all measurements must be confirmed on site. BASED UPON THE ORDNANCE SURVEY MAP WITH THE SANCTION OF THE CONTROLLER OF H.M. STATIONERY OFFICE. CROWN COPYRIGHT RESERVED.

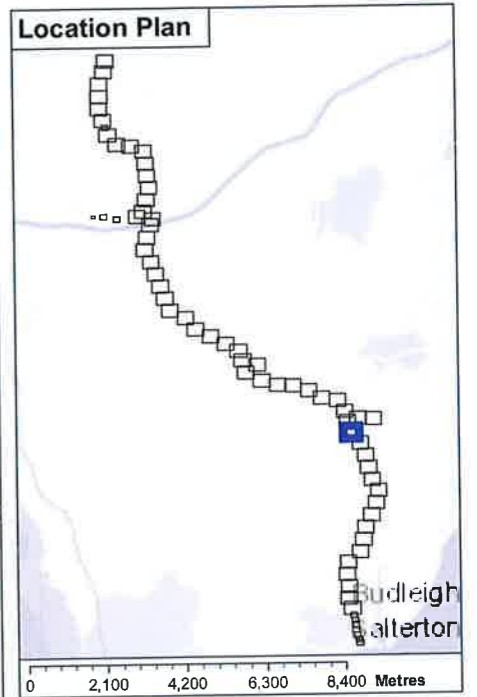
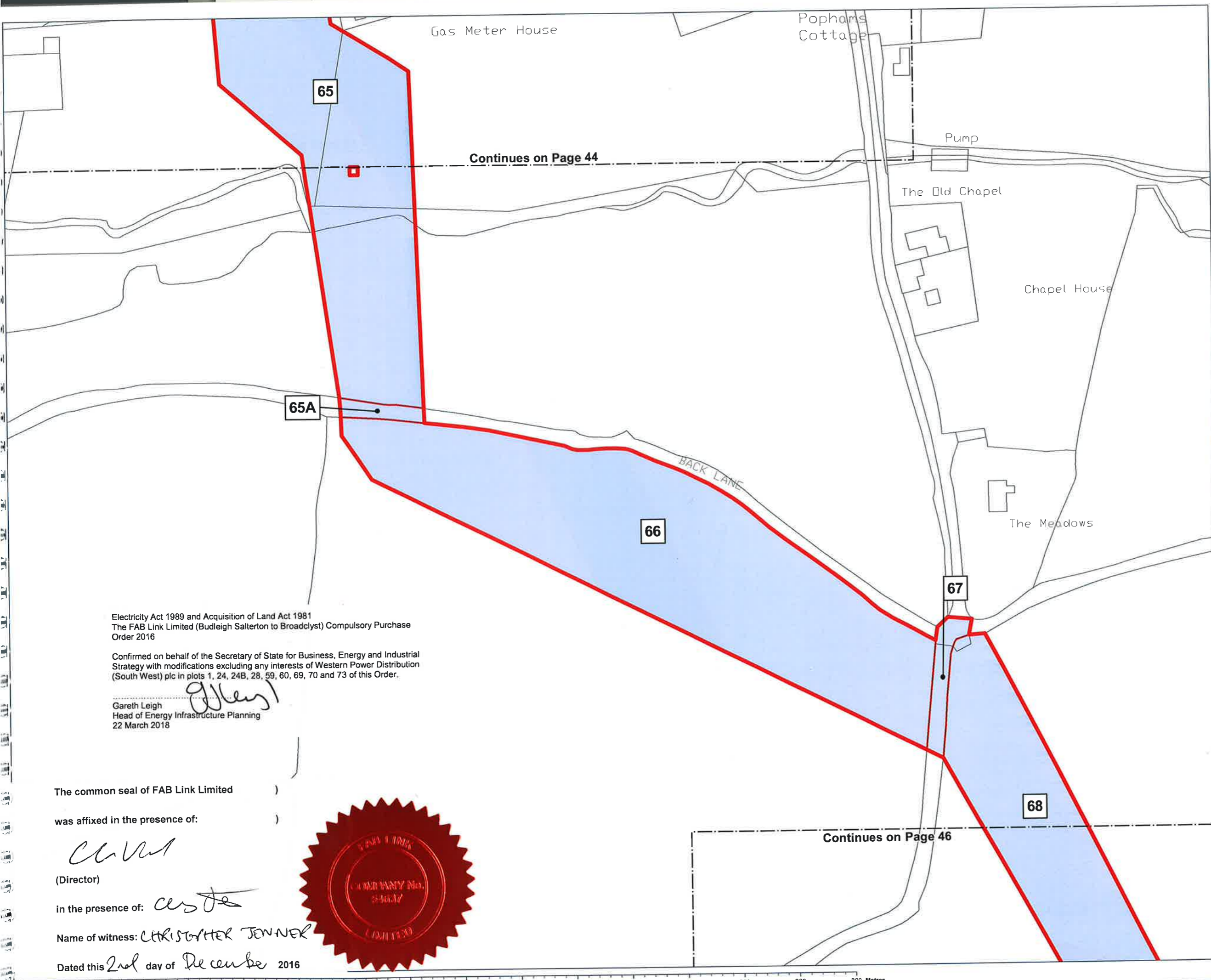

**Key:**

- Order Land
- Compulsory Purchase Order Category**
- Acquisition of Land
- Acquisition of Interconnector Rights
- Acquisition of Interconnector Rights and Access Rights
- Acquisition of Access Rights

Contains OS data © Crown Copyright and database right 2016  
Coordinate System: British National Grid  
Projection: Transverse Mercator  
Datum: OSGB 1936

**Scheme Name:** Budleigh Salterton

**Drawing Name:**  
Maps referred to in the FAB Link Limited (Budleigh Salterton to Broadclyst) Compulsory Purchase Order 2016

**Dwg:** 2016-11-11-151283-CP-044-0

**Coordinates:** 307,101 87,552

**Issue Date:** 28.11.2016

**First Issue Date:** 31.08.2016

**Sht. No:** 45 of 70    **Size:** A3

**Drn by:** TD    **App By:** HH

**Scale:**  
1:1,250



Electricity Act 1989 and Acquisition of Land Act 1981  
The FAB Link Limited (Budleigh Salterton to Broadclyst) Compulsory Purchase Order 2016

Confirmed on behalf of the Secretary of State for Business, Energy and Industrial Strategy with modifications excluding any interests of Western Power Distribution (South West) plc in plots 1, 24, 24B, 28, 59, 60, 69, 70 and 73 of this Order.

Gareth Leigh  
Head of Energy Infrastructure Planning  
22 March 2018

The common seal of FAB Link Limited )

was affixed in the presence of: )

(Director)

in the presence of:

Name of witness: CHRISTOPHER JONNER

Dated this 2nd day of December 2016



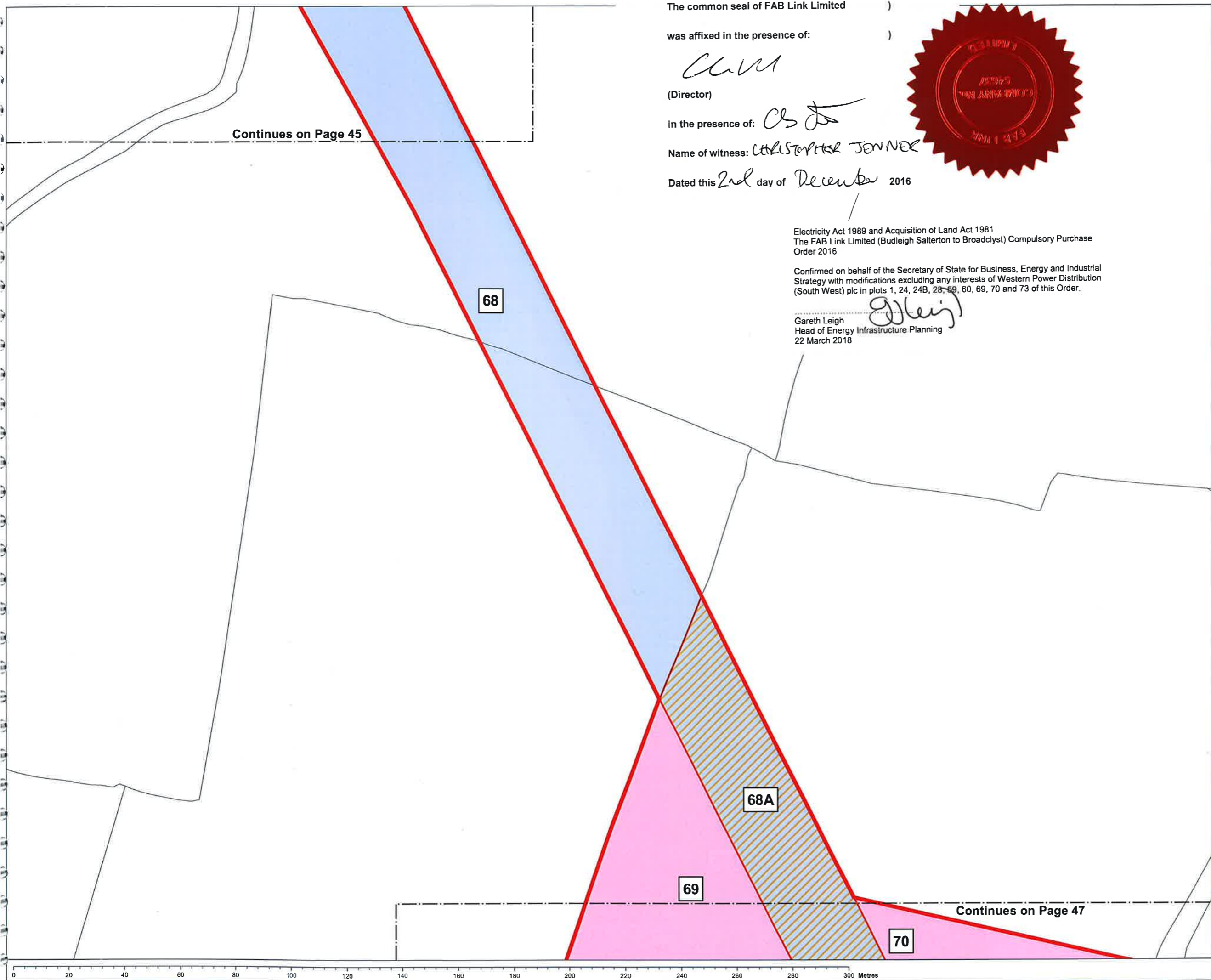

Continues on Page 45

Continues on Page 47

The common seal of FAB Link Limited )  
 was affixed in the presence of: )  
*CLM*  
 (Director)  
 in the presence of: *CS*  
 Name of witness: *CHRISTOPHER JENNER*  
 Dated this *2nd* day of *December* 2016



Electricity Act 1989 and Acquisition of Land Act 1981  
 The FAB Link Limited (Budleigh Salterton to Broadclyst) Compulsory Purchase Order 2016

Confirmed on behalf of the Secretary of State for Business, Energy and Industrial Strategy with modifications excluding any interests of Western Power Distribution (South West) plc in plots 1, 24, 24B, 28, 69, 60, 69, 70 and 73 of this Order.

*G Leigh*  
 Gareth Leigh  
 Head of Energy Infrastructure Planning  
 22 March 2018

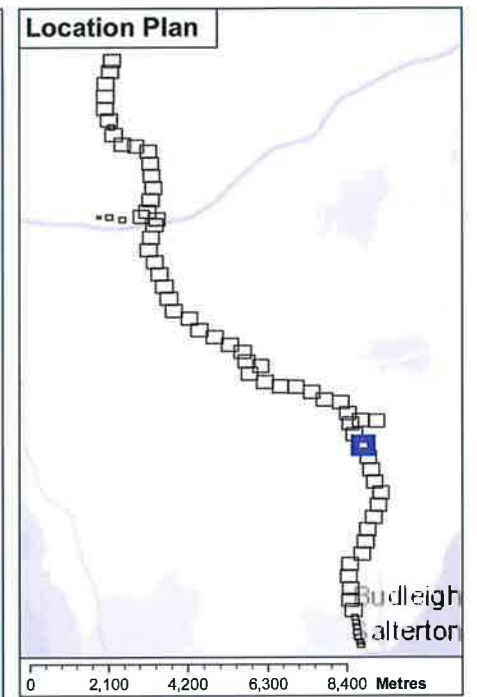

**Key:**

- Order Land
- Compulsory Purchase Order Category**
- Acquisition of Land
- Acquisition of Interconnector Rights
- Acquisition of Interconnector Rights and Access Rights
- Acquisition of Access Rights

Contains OS data © Crown Copyright and database right 2016  
 Coordinate System: British National Grid  
 Projection: Transverse Mercator  
 Datum: OSGB 1936

**Scheme Name:** Budleigh Salterton

**Drawing Name:**  
 Maps referred to in the FAB Link Limited (Budleigh Salterton to Broadclyst) Compulsory Purchase Order 2016

**Dwg:** 2016-11-11-151283-CP-045-0

**Coordinates:** 307,344 87,259

**Issue Date:** 28.11.2016

**First Issue Date:** 31.08.2016

**Sht. No:** 46 of 70 **Size:** A3

**Drn by:** TD **App By:** HH

**Scale:**  
 1:1,250



Continues on Page 46

Location Plan

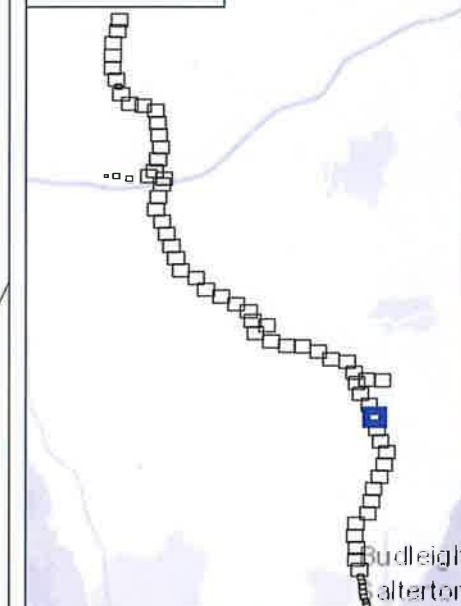

0 2,100 4,200 6,300 8,400 Metres

**Key:**

- Order Land
- Compulsory Purchase Order Category**
- Acquisition of Land
- Acquisition of Interconnector Rights
- Acquisition of Interconnector Rights and Access Rights
- Acquisition of Access Rights

Contains OS data © Crown Copyright and database right 2016  
Coordinate System: British National Grid  
Projection: Transverse Mercator  
Datum: OSGB 1936

**Scheme Name:** Budleigh Salterton

**Drawing Name:**  
Maps referred to in the FAB Link Limited (Budleigh Salterton to Broadclyst) Compulsory Purchase Order 2016

**Dwg:** 2016-11-11-151283-CP-046-0

**Coordinates:** 307,482 86,938

**Issue Date:** 28.11.2016

**First Issue Date:** 31.08.2016

**Sht. No:** 47 of 70 **Size:** A3

**Drn by:** TD **App By:** HH

**Scale:**  
1:1,250

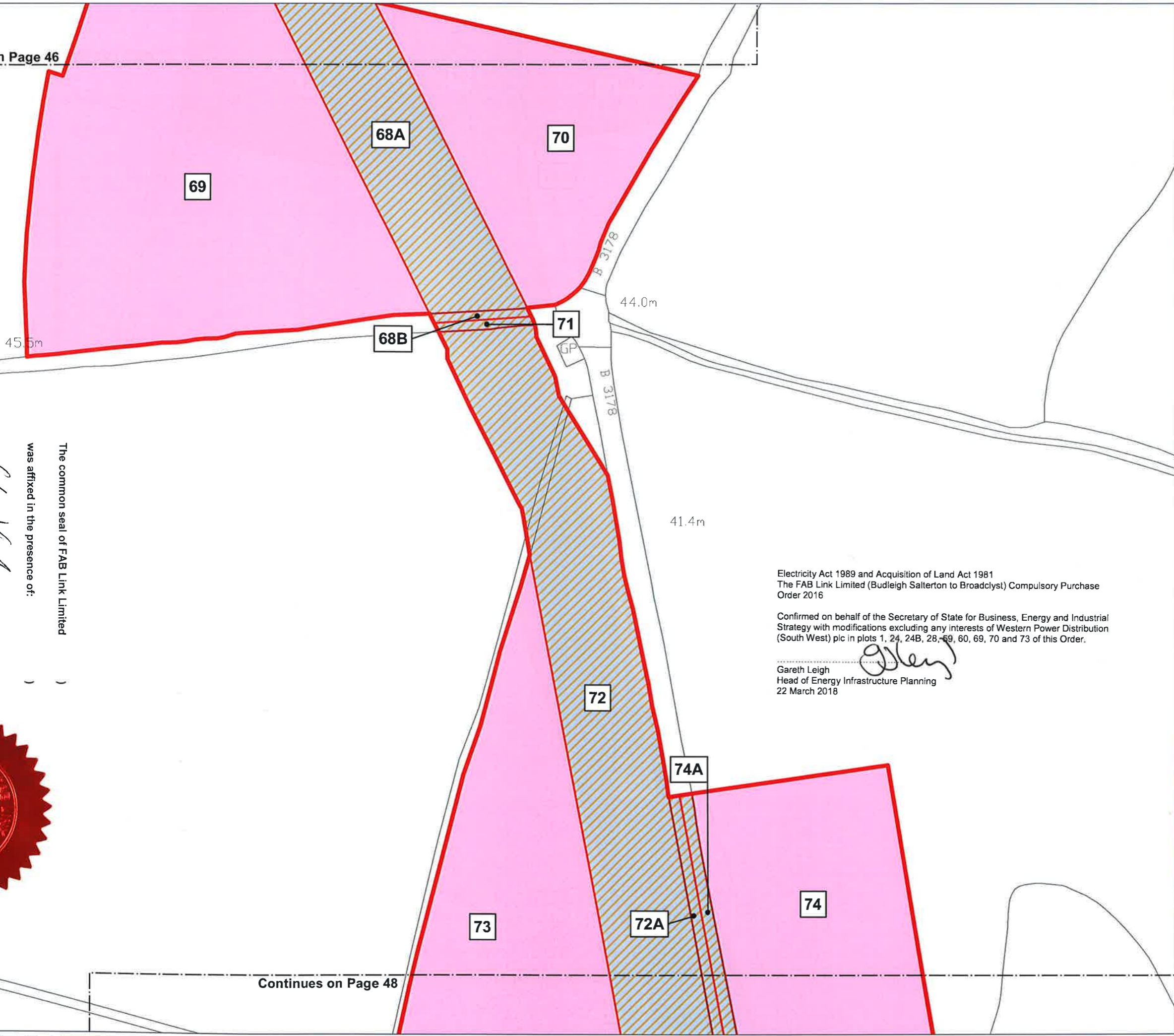

Electricity Act 1989 and Acquisition of Land Act 1981  
The FAB Link Limited (Budleigh Salterton to Broadclyst) Compulsory Purchase Order 2016

Confirmed on behalf of the Secretary of State for Business, Energy and Industrial Strategy with modifications excluding any interests of Western Power Distribution (South West) plc in plots 1, 24, 24B, 28, 59, 60, 69, 70 and 73 of this Order.

Gareth Leigh  
Head of Energy Infrastructure Planning  
22 March 2018

The common seal of FAB Link Limited  
was affixed in the presence of:  
(Director)  
in the presence of:  
Name of witness: CHRISTOPHER JONNOR



Continues on Page 48

Continues on Page 47

The common seal of FAB Link Limited  
 was affixed in the presence of:  
 (Director)  
*[Signature]*  
 in the presence of:  
*[Signature]*  
 Name of witness: CHRISTOPHER JENNER

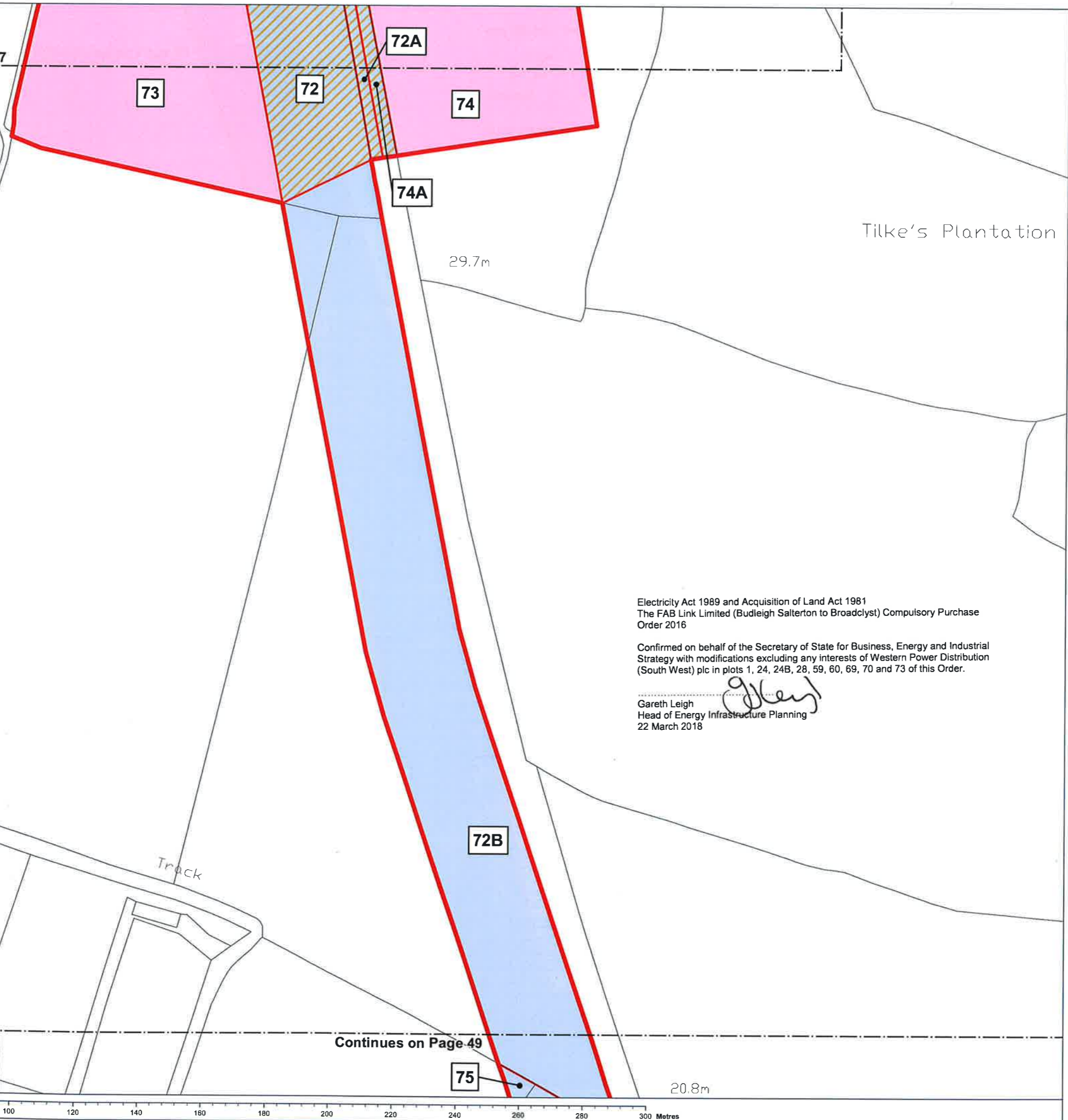

Tilke's Plantation

Electricity Act 1989 and Acquisition of Land Act 1981  
 The FAB Link Limited (Budleigh Salterton to Broadclyst) Compulsory Purchase Order 2016

Confirmed on behalf of the Secretary of State for Business, Energy and Industrial Strategy with modifications excluding any interests of Western Power Distribution (South West) plc in plots 1, 24, 24B, 28, 59, 60, 69, 70 and 73 of this Order.

Gareth Leigh  
 Head of Energy Infrastructure Planning  
 22 March 2018

Continues on Page 49

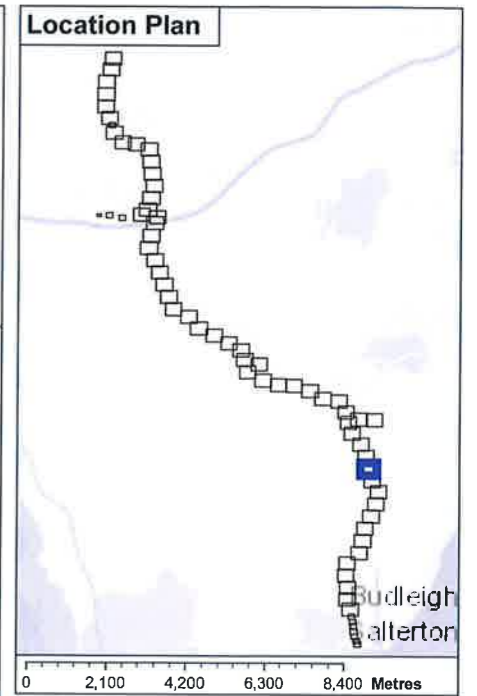

**Key:**

- Order Land
- Compulsory Purchase Order Category**
- Acquisition of Land
- Acquisition of Interconnector Rights
- Acquisition of Interconnector Rights and Access Rights
- Acquisition of Access Rights

Contains OS data © Crown Copyright and database right 2016  
 Coordinate System: British National Grid  
 Projection: Transverse Mercator  
 Datum: OSGB 1936

**Scheme Name:** Budleigh Salterton

**Drawing Name:**  
 Maps referred to in the FAB Link Limited (Budleigh Salterton to Broadclyst) Compulsory Purchase Order 2016

**Dwg:** 2016-11-11-151283-CP-047-0

**Coordinates:** 307,552 86,617

**Issue Date:** 28.11.2016

**First Issue Date:** 31.08.2016

**Sht. No:** 48 of 70 **Size:** A3

**Drn by:** TD **App By:** HH

**Scale:**  
 1:1,250





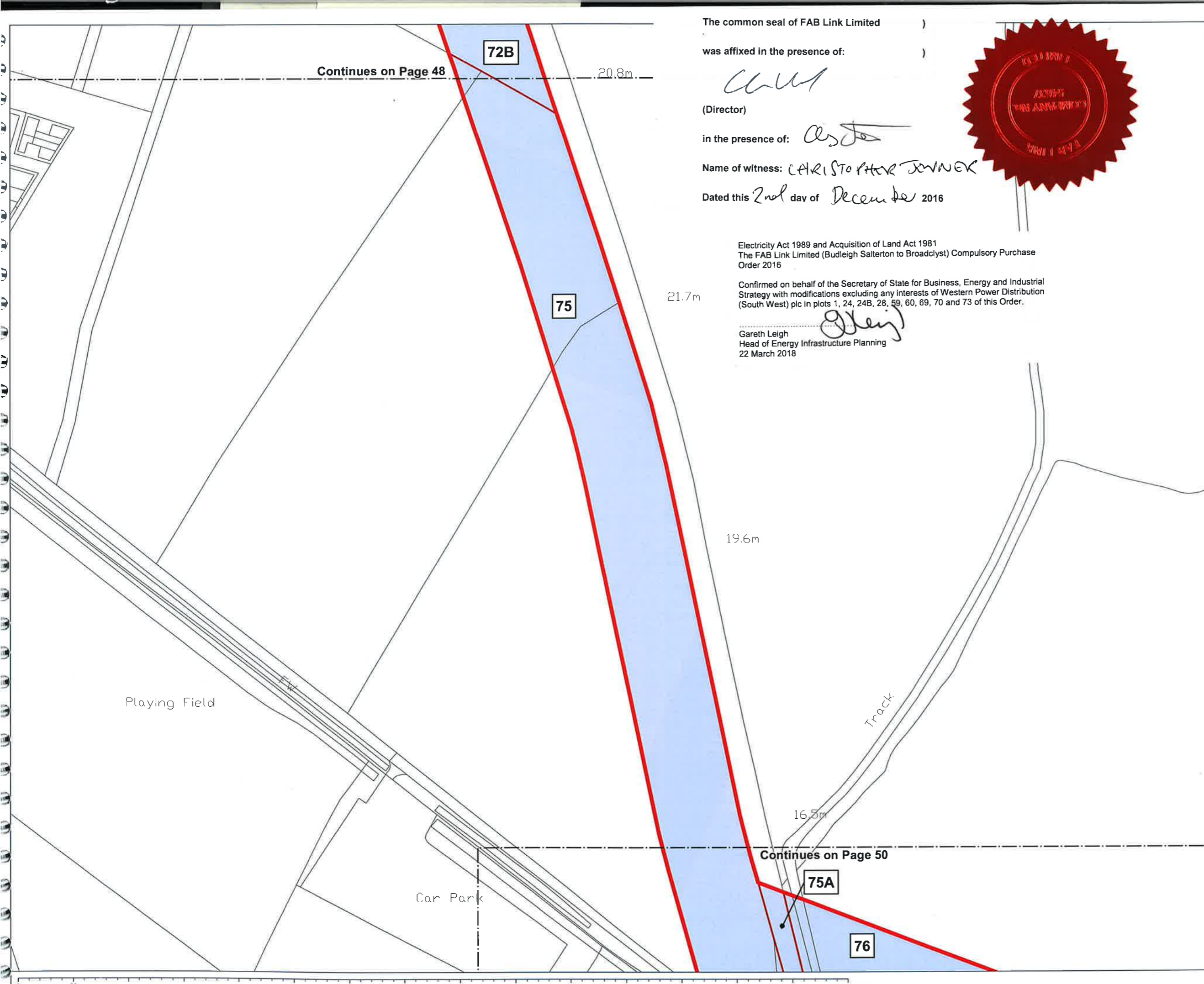

The common seal of FAB Link Limited )  
 was affixed in the presence of: )  
 (Director)  
 in the presence of: *As J*  
 Name of witness: *CARISTOPHER JONNEX*  
 Dated this *2nd* day of *December* 2016



Electricity Act 1989 and Acquisition of Land Act 1981  
 The FAB Link Limited (Budleigh Salterton to Broadclyst) Compulsory Purchase Order 2016

Confirmed on behalf of the Secretary of State for Business, Energy and Industrial Strategy with modifications excluding any interests of Western Power Distribution (South West) plc in plots 1, 24, 24B, 28, 59, 60, 69, 70 and 73 of this Order.

*G Leigh*  
 Gareth Leigh  
 Head of Energy Infrastructure Planning  
 22 March 2018

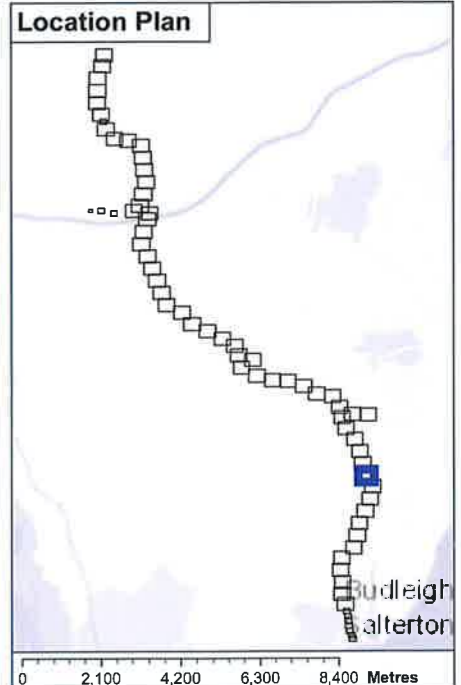

**Key:**

- Order Land
- Compulsory Purchase Order Category**
- Acquisition of Land
- Acquisition of Interconnector Rights
- Acquisition of Interconnector Rights and Access Rights
- Acquisition of Access Rights

Contains OS data © Crown Copyright and database right 2016  
 Coordinate System: British National Grid  
 Projection: Transverse Mercator  
 Datum: OSGB 1936

**Scheme Name:** Budleigh Salterton

**Drawing Name:**  
 Maps referred to in the FAB Link Limited (Budleigh Salterton to Broadclyst) Compulsory Purchase Order 2016

**Dwg:** 2016-11-11-151283-CP-048-0

**Coordinates:** 307,650 86,295

**Issue Date:** 28.11.2016

**First Issue Date:** 31.08.2016

**Sht. No:** 49 of 70 **Size:** A3

**Drn by:** TD **App By:** HH

**Scale:**  
 1:1,250



The common seal of FAB Link Limited )

was affixed in the presence of: )

*Ch. V. H.*

(Director)

in the presence of: *Chris Jen*

Name of witness: *CHRISTOPHER JENNER*

Dated this *2nd* day of *December* 2016



Location Plan



0 2,100 4,200 6,300 8,400 Metres

Key:

- Order Land
- Compulsory Purchase Order Category**
- Acquisition of Land
- Acquisition of Interconnector Rights
- Acquisition of Interconnector Rights and Access Rights
- Acquisition of Access Rights

Contains OS data © Crown Copyright and database right 2016  
Coordinate System: British National Grid  
Projection: Transverse Mercator  
Datum: OSGB 1936

Scheme Name: Budleigh Salterton

Drawing Name:

Maps referred to in the FAB Link Limited (Budleigh Salterton to Broadclyst) Compulsory Purchase Order 2016

Dwg: 2016-11-11-151283-CP-049-0

Coordinates: 307,817 85,998

Issue Date: 28.11.2016

First Issue Date: 31.08.2016

Sht. No: 50 of 70 Size: A3

Drn by: TD App By: HH

Scale:

1:1,250



Continues on Page 49

Electricity Act 1989 and Acquisition of Land Act 1981  
The FAB Link Limited (Budleigh Salterton to Broadclyst) Compulsory Purchase Order 2016

Confirmed on behalf of the Secretary of State for Business, Energy and Industrial Strategy with modifications excluding any interests of Western Power Distribution (South West) plc in plots 1, 24, 24B, 28, 39, 60, 69, 70 and 73 of this Order.

Gareth Leigh  
Head of Energy Infrastructure Planning  
22 March 2018

*Gareth Leigh*

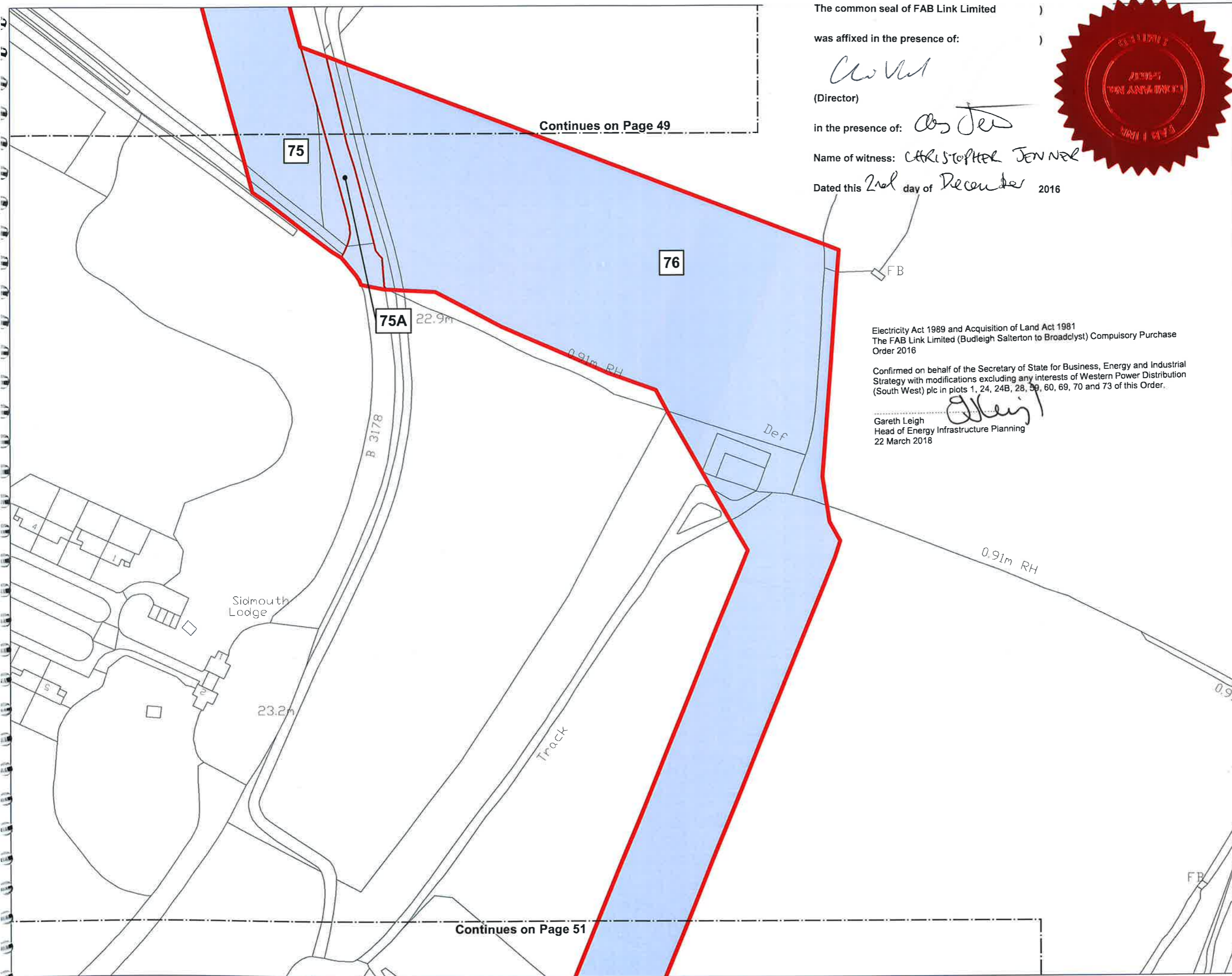

Continues on Page 51

0 20 40 60 80 100 120 140 160 180 200 220 240 260 280 300 Metres