

## Chapter 4:

# Seaford Esplanade to Eastbourne Pier

England Coast Path: Shoreham-by-Sea to Eastbourne - Natural England's Proposals

## Part 4.1: Introduction

<b>Start Point:</b>	<b>Seaford Esplanade</b> (grid reference: 548773 98234)
<b>End Point:</b>	<b>Eastbourne Pier, Eastbourne</b> (grid reference: 561766 98898)
<b>Relevant Maps:</b>	<b>4a to 4o</b>

### Understanding the proposals and accompanying maps:

#### The Trail:

- 4.1.1 Generally follows existing walked routes, including public rights of way, along all of this length.
- 4.1.2 Mainly follows the coastline quite closely and maintains good views of the sea.
- 4.1.3 Traverses the Sussex Heritage Coast between Seaford and Eastbourne, where the South Downs meets the sea, renowned for its iconic chalk cliffs.
- 4.1.4 Follows a route similar to part of the existing South Downs Way National Trail but departs from this in places in order to improve the trail route.
- 4.1.5 Follows a route similar to part of the existing Vanguard Way, a long distance footpath, but departs from this at Exceat, in order to continue along the coast.
- 4.1.6 The South Downs Way generally follows the coast between Exceat and Eastbourne, so for the most part we propose adopting the walked line of this route as the line of the England Coast Path. However, there are places where we have proposed improvements to the existing route line, and furthermore there may be places where the walked line differs slightly from the route originally approved by the Secretary of State, as the path has evolved over time to cope with coastal erosion and other processes. In both situations, as explained at part 6a of the Overview, assuming these proposals are approved we intend to use a separate variation report to the Secretary of State to change the route of the existing national trail to reflect the approved line of the England Coast Path insofar as the two are different.

## Protection of sensitive nature conservation features:

4.1.7 This part of the coast includes the following sites, designated for nature conservation (See map C of the Overview):

- Seaford to Beachy Head Site of Special Scientific Interest (SSSI) designated for its geological and wildlife interest
- Beachy Head West Marine Conservation Zone (MCZ)
- Beachy Head East proposed Marine Conservation Zone (pMCZ)
- Seaford Head Local Nature Reserve (LNR)

We have assessed the potential impacts of our proposals along the proposed route (and over the associated spreading room described below) on the features for which the affected land is designated and on any which are protected in their own right.

4.1.8 With input from specialists we have considered each of the sites involved and the relevant designations and concluded that for this section of the coast our proposals are compatible with the conservation objectives for the sites concerned.

In reaching this conclusion we have also identified the following opportunity to enhance understanding of important habitats:

Location	Risk	Mitigation
West of Seaford Head, map 4a	No risk	No mitigation is necessary, however, we propose to install new interpretation near Seaford Head to raise awareness of important bird life (kittiwakes), prior to the opening of the trail.

See part 6b of the Overview - 'Protection of sensitive nature conservation features' for a description of our overall approach and a summary of our conclusions

## Protection of the Historic Environment:

4.1.9 This part of the coast also includes the following sites, designated for heritage preservation reasons (See map C of the Overview):

- Hillfort and bowl barrow on Seaford Head Scheduled Ancient Monument (SAM).
- Napoleonic Barracks, Cuckmere Haven Scheduled Ancient Monument (SAM).
- Pair of bowl barrows on Bailey's Hill Scheduled Ancient Monument (SAM)
- Camp near Belle Tout Lighthouse, Birling Gap Scheduled Ancient Monument (SAM).
- Wish Tower (Martello Tower) Scheduled Ancient Monument (SAM).

We have assessed the potential impacts of our proposals along the proposed route (and over

the associated spreading room described below) on the features for which the affected land is designated and on any which are protected in their own right.

- 4.1.10 With input from specialists we have considered each of the sites involved and the relevant designations and concluded that for this section of the coast our proposals would not undermine the conservation objectives for the historic environment.

**See part 6c of the Overview - 'Protection of the Historic Environment' for a description of our overall approach and a summary of our conclusions**

#### **Accessibility:**

- 4.1.11 There are few artificial barriers to accessibility on the proposed route, which makes use of existing paths wherever these meet the criteria in the Coastal Access Scheme.

However, there are places where it may not be entirely suitable for people with reduced mobility because:

- The trail would follow uneven and undulating grass or bare soil path along cliff tops;
- The trail would follow a very short section of the shingle foreshore near the Cuckmere Coastguard Cottages;
- There are steps in places where it would be necessary to ascend/descend steeper sections of the South Downs Way;
- There are steps in places where it would be necessary to ascend/descend between the King Edwards Parade and the Middle Parade along Eastbourne seafront.

**See part 6a of the Overview - 'Recreational issues' - for more information.**

#### **Where we have proposed exercising our discretion:**

- 4.1.12 Estuary: This report proposes that the trail should contain sections aligned on the estuary of the river Cuckmere, extending upstream from the open coast.

**See part 5 of the Overview. The trail covered by this chapter includes part of this estuary route.**

- 4.1.13 Landward boundary of the coastal margin: We have used our discretion on some sections of the route to map the landward extent of the coastal margin to an adjacent physical boundary such as a fence line, pavement or track to make the extent of the new access rights clearer. See Table 4.2.1 below.
- 4.1.14 In some places we have used our discretion to propose the inclusion of additional, more extensive landward areas within the coastal margin, to secure or enhance public enjoyment of this part of the coast. The owners of this land are content for us to propose this.

**See also part 3 of the Overview - 'Understanding the proposals and accompanying maps', for an explanation of the default extent of the coastal margin and how we may use our discretion to adjust the margin, either to add land or to provide clarity. See also Annex C of the Overview - 'Excepted land categories'.**

- 4.1.15 Restrictions and/or exclusions: We have proposed to exclude access by direction under the Countryside and Rights of Way Act (2000) in certain places along this section of coast. For details of these directions, see 4.3.22 in the Formal Proposals Section of this chapter and Part 10 of the Overview.
- 4.1.16 Access rights to the spreading room would be subject to the national restrictions on coastal access rights listed in Annex D of the Overview. These restrictions would not apply to public rights of way.
- 4.1.17 These directions will not prevent or affect:
- any existing local use of the land by right, as such use is not covered by coastal access rights;
  - any other use people already make of the land locally by formal agreement with the landowner, or by informal permission or traditional toleration; or
  - use of any registered rights of common or rights at common law or by Royal Charter etc
- 4.1.18 Any such use is not prohibited or limited by these arrangements.
- 4.1.19 The directions we give are intended to avoid any new public rights being created over the salt marsh and mudflat in question in view of the hidden dangers to which new users of the land would be subject to.

**See part 10 of the Overview - 'Restrictions and exclusions' - for details.**

### **Establishment and ongoing management of the trail**

- 4.1.20 Some physical establishment of the trail would be necessary, in accordance with the general approach described in part 7 the Overview.
- 4.1.21 At section SEB-4-S007 on the western side of Cuckmere river (map 4c), the existing path surface will be improved to reduce waterlogging in winter. We envisage this happening before the new access rights come into force.
- 4.1.22 At Birling Gap, the existing wooden backfilled steps towards Belle Tout at section SEB-4-S023 (map 4h) will be improved to make them easier to use. The proposed works include surfacing for the step treads and for the area between the foot of the steps and the car park. We envisage this happening before the new access rights come into force.
- 4.1.23 At Beachy Head, the wooden, backfilled steps which descend to the lower slopes clifftop at section SEB-4-S029 (map 4j) will be improved to make them easier to use. The proposed works include some replacement steps, extra steps and surfacing of the step treads. We envisage this happening before the new access rights come into force.
- 4.1.24 An interpretation panel is proposed to explain the value and interest of kittiwakes nesting at Seaford Head (map 4a).
- 4.1.25 Ongoing management and maintenance would be necessary in accordance with the general approach described in part 8 of the Overview. The overall need for this is likely to be greater than

on some other parts of the stretch, recognising that it will be necessary for the route to roll back from time to time in response to coastal processes, as described below.

**See parts 7 - 'Physical establishment of the trail' and 8 - 'Maintenance of the trail' of the Overview for more information.**

#### **Future Change:**

- 4.1.26 Part of the route of the trail on this length of coast would be able to change without further approval from the Secretary of State in response to coastal erosion or other geomorphological processes, or encroachment by the sea. This would happen in accordance with the criteria and procedures for 'roll back' set out in part 9 of the Overview. See table 4.2.1 below for details of the sections likely to be affected in the foreseeable future.
- 4.1.27 There are also places on the length of coast described in this chapter where, at the time of preparing the report, we foresee the need for changes to the access provisions for particular reasons:
- At Exceat Bridge (map 4d), where East Sussex County Council may replace the current bridge over the River Cuckmere. This is summarised at part 9 of the Overview.

**See parts 6e - 'Coastal processes' and 9 - 'Future changes' of the Overview for more information.**

## Part 4.2: Commentary on Maps

See Part 3 of Overview for guidance on reading and understanding the tables below

### 4.2.1 Section Details – Maps 4a to 4o: Seaford Esplanade to Eastbourne Pier

Notes on table:

Column 2 – an asterisk (\*) against the route section number means see also table 4.2.2: Other options considered.

Column 5 – ‘Yes – normal’ means roll-back approach is likely to follow the current feature (e.g. cliff edge/beach) for the foreseeable future.

Column 5 – ‘Yes – see table 4.2.3’ means refer to that table below about our likely approach to roll-back on this part of the route.

Column 6a – certain coastal land types are included automatically in the coastal margin where they fall landward of the trail if they touch it at some point. These coastal land types are: foreshore, cliff, bank, barrier, dune, beach, flat or section 15 land.

1	2	3	4	5	6a	6b	6c	7
Map(s)	Route section number(s)	Current status of this section	Current surface of this section	Roll-back proposed? (See Part 8 of Overview)	Default coastal land type? (See note 6a above)	Landward boundary of margin (See maps)	Reason for landward boundary discretion	Proposed exclusions or restrictions (see Part 9 of Overview)
4a	SEB-4-S001	Other existing walked route	Gravel	No	No	Landward edge of trail (2m)	Not used	None
	SEB-4-S002	Other existing walked route	Gravel	Yes – Normal	No	Path edge	Clarity and Cohesion	None
4a and 4b	SEB-4-S003	Public footpath	Grass	Yes – Normal	No	Landward edge of trail (2m)	Not used	None
4c	SEB-4-S004	Public footpath	Gravel	Yes – Normal	No	Track edge	Clarity and Cohesion	None
	SEB-4-S005*	Public footpath	Shingle	Yes – Normal	Yes - beach	Landward edge of beach	Not used	None
	SEB-4-S006*	Public footpath	Grass	Yes – Normal	No	Landward edge of trail (2m)	Not used	Margin
	SEB-4-S007*	Public footpath	Bare soil: Compacted	Yes – Normal	No	Fence line	Clarity and Cohesion	Margin
	SEB-4-S008*	Public footpath	Bare soil: Compacted	Yes – Normal	No	Fence line	Clarity and cohesion	Margin
4d	SEB-4-S009*	Public footpath	Bare soil: Compacted	Yes – Normal	No	Fence line	Clarity and Cohesion	Margin
	SEB-4-S010	Public footpath	Bare soil: Compacted	Yes – normal	No	Fence line	Clarity and Cohesion	None
	SEB-4-S011	Other existing walked route	Tarmac	Yes – See table 4.2.3	No	Landward edge of trail (2m)	Not used	None
	SEB-4-S012	Public footway (pavement)	Tarmac	Yes – See table 4.2.3	No	Pavement edge	Clarity and Cohesion	None
	SEB-4-S013	Public footpath	Concrete	Yes – Normal	No	Path edge	Clarity and Cohesion	None
	SEB-4-S014*	Public footpath	Grass	Yes – Normal	No	Landward edge of trail (2m)	Not used	None
	SEB-4-S015*	Public footpath	Stone: Aggregate	Yes – Normal	No	Path edge	Clarity and Cohesion	Margin
4e	SEB-4-S016*	Public footpath	Grass	Yes – Normal	No	Landward edge of trail (2m)	Not used	Margin
4f	SEB-4-S017	Public footpath	Grass	Yes – Normal	No	Landward edge of trail (2m)	Not used	None

1	2	3	4	5	6a	6b	6c	7
Map(s)	Route section number(s)	Current status of this section	Current surface of this section	Roll-back proposed? (See Part 8 of Overview)	Default coastal land type? (See note 6a above)	Landward boundary of margin (See maps)	Reason for landward boundary discretion	Proposed exclusions or restrictions (see Part 9 of Overview)
4f	SEB-4-S018	Public footpath	Grass	Yes – Normal	No	Fence line	Additional landward area	None
4g (and 4n)	SEB-4-S019	Public footpath	Grass	Yes – Normal	No	Various	Additional landward area	None
4h (and 4n)	SEB-4-S020	Public footpath	Grass	Yes – Normal	No	Various	Additional landward area	None
4h	SEB-4-S021	Public footpath	Gravel	Yes – See table 4.2.3	No	Track edge	Clarity and cohesion	None
	SEB-4-S022*	Other existing walked route	Gravel	Yes – See table 4.2.3	No	Various	Clarity and cohesion	None
	SEB-4-S023* to SEB-4 S024	Other existing walked route	Gravel	Yes – Normal	No	Various	Additional landward area	None
	SEB-4 S025 and SEB-4-S026	Public footpath	Grass	Yes – Normal	No	Road edge	Additional landward area	None
4i and 4j (and 4o)	SEB-4-S027 to SEB-3-S028	Public footpath	Grass	Yes – Normal	No	Fence lines	Additional landward area	None
4j and 4k (and 4o)	SEB-4-S029* to SEB-3-S032*	Public footpath	Grass	Yes – Normal	No	Fence lines	Additional landward area	None
4k (and 4o)	SEB-4-S033*	Other existing walked route	Grass	Yes – Normal	No	Road edge	Additional landward area	None
4k (and 4o)	SEB-4-S034*	Public bridleway	Block paving	No	No	Road edge	Additional landward area	None
4l	SEB-4-S035	Public footway (pavement)	Tarmac	No	No	Pavement edge	Clarity and cohesion	None
	SEB-4-S036*	Other existing walked route	Stone: Bedrock	No	No	Path edge	Clarity and cohesion	None
	SEB-4-S037*	Other existing walked route	Block paving	No	No	Wall	Clarity and cohesion	None
	SEB-4-S038*	Other existing walked route	Gravel	No	No	Wall	Clarity and cohesion	None
4m	SEB-4-S039*	Other existing walked route	Tarmac	No	No	Wall	Clarity and cohesion	None
	SEB-4-S040* and SEB-4-S041*	Other existing walked route	Block paving	No	No	Wall	Clarity and cohesion	None
	SEB-4-S042*	Public footway (pavement)	Block paving	No	No	Pavement edge	Clarity and cohesion	None
	SEB-4-S043*	Other existing walked route	Tarmac	No	No	Landward edge of trail (2m)	Not used	None
	SEB-4-S044 to SEB-4-S048	Other existing walked route	Block paving	No	Yes - barrier	Landward edge of barrier (wall)	Not used	None

#### 4.2.2 Other options considered: Maps 4a to 4m: Seaford Esplanade to Eastbourne Pier

Map(s)	Section number(s)	Option(s) considered	Reasons for not proposing this option as the route
4c and 4d	SEB-4-S005 to SEB-4-S009	At the Cuckmere estuary, we also considered following the public footpath along the western side of the river.	<p>We opted for the proposed route because:</p> <ul style="list-style-type: none"> <li>■ the path beside the river is eroding and can become waterlogged in winter;</li> <li>■ the proposed route provides more varied and elevated views over the attractive valley floor landscape, as well as better views towards the sea from higher ground;</li> <li>■ the trail follows the Vanguard Way, a long distance trail between the Coastguard Cottages at Cuckmere Haven and Exceat;</li> <li>■ this proposal is made with the support of the landowner;</li> <li>■ we concluded that overall the proposed route struck the best balance in terms of the criteria described in chapter 4 of the Coastal Access Scheme.</li> </ul>
4d and 4e	SEB-4-S014 to SEB-4-S016	At Cuckmere estuary, we also considered following the surfaced path along the eastern side of the river.	<p>We opted for the proposed route because:</p> <ul style="list-style-type: none"> <li>■ the proposed route provides more varied and elevated views over the attractive valley floor landscape and the classic Cuckmere meanders, as well as better views towards the sea from higher ground;</li> <li>■ The existing valley floor easy access paths are well maintained and would remain available for people to use as part of the spreading room, but would not form part of the designated trail;</li> <li>■ Connecting the valley floor easy access path with the proposed clifftop route to the east would involve a steep climb or a longer inland route from the coast;</li> <li>■ this proposal is made with the support of the landowner;</li> <li>■ we concluded that overall the proposed route struck the best balance in terms of the criteria described in chapter 4 of the Coastal Access Scheme.</li> </ul>
4h	SEB-4-S022 and SEB-4-S023	At Birling Gap, we considered following the existing South Downs Way route across the entrance to the car park and adjacent to the coast road and overflow car parks, where the trail turns seawards towards the clifftop on Belle Tout.	<p>We opted for the proposed route because:</p> <ul style="list-style-type: none"> <li>■ it is closer to the coast and maintains views of the sea;</li> <li>■ The route chosen is already used by the majority of visitors;</li> <li>■ this proposal is made with the support of the landowner;</li> <li>■ this proposal is made with the support of the South Downs Way Officer;</li> <li>■ we concluded that overall the proposed route struck the best balance in terms of the criteria described in chapter 4 of the Coastal Access Scheme.</li> </ul>
4j and 4k	SEB -4-S029 to SEB-4-S034	We considered aligning the trail along the existing South Downs Way, which follows public footpaths landward of Whitebread Hole, between Beachy Head and Dukes Drive, Eastbourne.	<p>We opted for the proposed route because:</p> <ul style="list-style-type: none"> <li>■ it is closer to the sea and maintains views of the sea;</li> <li>■ this proposal is made with the support of the landowner;</li> <li>■ this proposal is made with the support of the South Downs Way Officer;</li> <li>■ we concluded that overall the proposed route struck the best balance in terms of the criteria described in chapter 4 of the Coastal Access Scheme.</li> </ul>



Map(s)	Section number(s)	Option(s) considered	Reasons for not proposing this option as the route
4k	SEB-4-S033	We considered aligning the trail on the existing public footpath along Foyle Way, Holywell, as shown on the map.	We opted for the proposed route because: <ul style="list-style-type: none"> <li>■ it provides far reaching views in both directions, towards Pevensey Levels and Hastings, and west along the escarpment of the South Downs and Beachy Head. These views are not visible from the enclosed Foyle Way;</li> <li>■ Foyle Way would remain available for people to use as part of the spreading room, but would not form part of the designated trail;</li> <li>■ this proposal is made with the support of the landowner and the South Downs Way Officer;</li> <li>■ we concluded that overall the proposed route struck the best balance in terms of the criteria described in chapter 4 of the Coastal Access Scheme.</li> </ul>
4l and 4m	SEB-4-S036 to SEB-4-S043	We considered aligning the trail along the lower promenade between Holywell and the Lifeboat Museum at Eastbourne seafront, as shown on the map.	We opted for the proposed route because: <ul style="list-style-type: none"> <li>■ it provides good, elevated views of the sea and provides a more pleasant, quiet route;</li> <li>■ this proposal is made with the support of the landowner;</li> <li>■ Under our proposals, the lower promenade at Eastbourne between Holywell and the Lifeboat Museum would remain available for people to use as part of the spreading room, but would not form part of the designated trail;</li> <li>■ we concluded that overall the proposed route struck the best balance in terms of the criteria described in chapter 4 of the Coastal Access Scheme.</li> </ul>

#### 4.2.3 Roll-back implementation – more complex situations: Maps 4a to 4m: Seaford Esplanade to Eastbourne Pier

Map(s)	Section number(s)	Feature or site potentially affected	How we will manage roll-back in relation to this feature or site
4d	SEB-4-S011 and SEB-4-S012	Public house, residential properties and A259 coast road, Cuckmere Haven	If it is no longer possible to find a viable route seaward of the public house and residential properties we will choose a route landward of them, following discussions with owners and occupiers. In reaching this judgement we will have full regard to the need to seek a fair balance between the interests of potentially affected owners and occupiers and those of the public.
4h	SEB-4-S021 to SEB-4-S022	Properties at Birling Gap landward of SEB-4-S021	If it is no longer possible to find a viable route seaward of the various properties at Birling Gap, we will choose a new route after detailed discussions with all relevant interests, to pass somewhere on the landward side of them. In reaching this judgement we will have full regard to the need to seek a fair balance between the interests of potentially affected owners and occupiers and those of the public.

## Part 4.3: Chapter 4 - Formal Proposals

- Below are our formal proposals to the Secretary of State for the length of coast shown on maps 4a to 4o.
- They should be read in conjunction with the relevant maps.
- The commentary above explains the practical effect of these proposals.

### Formal Proposals – Seaford Esplanade to Eastbourne Pier

#### Proposed route of the trail

- 4.3.1 In relation to route sections SEB-4-S001 and SEB-4-S034 to SEB-4-S048, the route is to be at the centre of the line shown on maps 4a and 4k to 4m as the proposed route of the trail.
- 4.3.2 In relation to route sections SEB-4-S002 to SEB-4-S033, the route, as initially determined at the time the report was prepared, is to be at the centre of the line shown on maps 4a to 4k as the proposed route of the trail.
- 4.3.3 If at any time any part of a route section listed in the previous paragraph needs, in Natural England's view, to change

- as a result of coastal erosion or other geomorphological processes or encroachment by the sea
- in order to link with other parts of the route that need to roll back in direct response to such changes;

In order for the overall route to remain viable, the new route for the part in question will be determined by Natural England without further reference to the Secretary of State. This will be done in accordance with the criteria and procedures described under the title 'Roll-back' in part 9 of the Overview and section 4.10 of the Coastal Access Scheme. If this happens, the new route will become the approved route for that section for the purposes of the Order which determines where coastal access rights apply.

#### Landward boundary of coastal margin

- 4.3.4 Adjacent to route section SEB-4-S002, the landward boundary of the coastal margin is to coincide with the landward edge of the path shown as the trail on map 4a.
- 4.3.5 Adjacent to route section SEB-4-S004, the landward boundary of the coastal margin is to coincide with the landward edge of the track shown as the trail on map 4c.
- 4.3.6 Adjacent to route sections SEB-4-S007 to SEB-4-S010, the landward boundary of the coastal margin is to coincide with the fence line which, at the time of writing this report, is landward of the public footpath shown as the trail on maps 4c and 4d.
- 4.3.7 Adjacent to route section SEB-4-S012, the landward boundary of the coastal margin is to coincide with the landward edge of the pavement shown as the trail on map 4d.
- 4.3.8 Adjacent to route sections SEB-4-S013 and SEB-4-S015, the landward boundary of the coastal margin is to coincide with the landward edge of the path shown as the trail on map 4d.
- 4.3.9 Adjacent to route sections SEB-4-S018, the landward boundary of the coastal margin is to coincide with fence lines, as indicated by the coastal margin landward of the trail shown on map 4f.

- 4.3.10 Adjacent to route sections SEB-4-S019, the landward boundary of the coastal margin is to coincide with various features, including fence lines and walls, as indicated by the coastal margin landward of the trail shown on map 4g and also on map 4n.
- 4.3.11 Adjacent to route section SEB-4-S020, the landward boundary of the coastal margin is to coincide with various boundaries including fence and hedge lines, as indicated by the coastal margin landward of the trail shown on map 4h and also on map 4n.
- 4.3.12 Adjacent to route section SEB-4-S021, the landward boundary of the coastal margin is to coincide with landward edge of the track shown as the trail on map 4h.
- 4.3.13 Adjacent to route section SEB-4-S022, the landward boundary of the coastal margin is to coincide with the various boundary features of the shared-use walkway around Birling Gap car park, shown as the trail on map 4h.
- 4.3.14 Adjacent to route sections SEB-4-S023 to SEB-4-S024, the landward boundary of the coastal margin is to coincide with various boundary features, as indicated by the coastal margin landward of the trail on map 4h.
- 4.3.15 Adjacent to route sections SEB-4-S025 to SEB-4-S026, the landward boundary of the coastal margin is to coincide with the seaward edge of the road, as indicated by the coastal margin landward of the trail on map 4h.
- 4.3.16 Adjacent to route sections SEB-4-S027 to SEB-4-S032, the landward boundary of the coastal margin is to coincide with fence lines, as indicated by the coastal margin landward of the trail on maps 4i, 4j and 4k and also shown on map 4o.
- 4.3.17 Adjacent to route sections SEB-4-S033 and SEB-4-S034, the landward boundary of the coastal margin is to coincide with the seaward edge of the road, as indicated by the coastal margin landward of the trail on map 4k and also shown on map 4o.
- 4.3.18 Adjacent to route section SEB-4-S035, the landward boundary of the coastal margin is to coincide with landward edge of the pavement shown as the trail on map 4l.
- 4.3.19 Adjacent to route section SEB-4-S036, the landward boundary of the coastal margin is to coincide with landward edge of the path shown as the trail on map 4l.
- 4.3.20 Adjacent to route sections SEB-4-S037 to SEB-4-S041, the landward boundary of the coastal margin is to coincide with the walls which are landward of the trail shown on maps 4l and 4m.
- 4.3.21 Adjacent to route section SEB-4-S042, the landward boundary of the coastal margin is to coincide with the landward edge of the pavement shown as the trail on map 4m.

### **Local restrictions and exclusions**

- 4.3.22 Natural England proposes to exclude access relevant to this length of coast, as follows:
- Access land in the coastal margin covered between route sections SEB-4-S006 and SEB-4-S016 is to be excluded all year-round by direction under Section 25A of the Countryside and Rights of Way Act (2000) as it is mudflat and saltmarsh that is unsuitable for public access. The exclusion does not affect the route itself and will have no legal effect on land where coastal access rights do not apply.

**Please refer to Part 10 of the Overview for further details.**

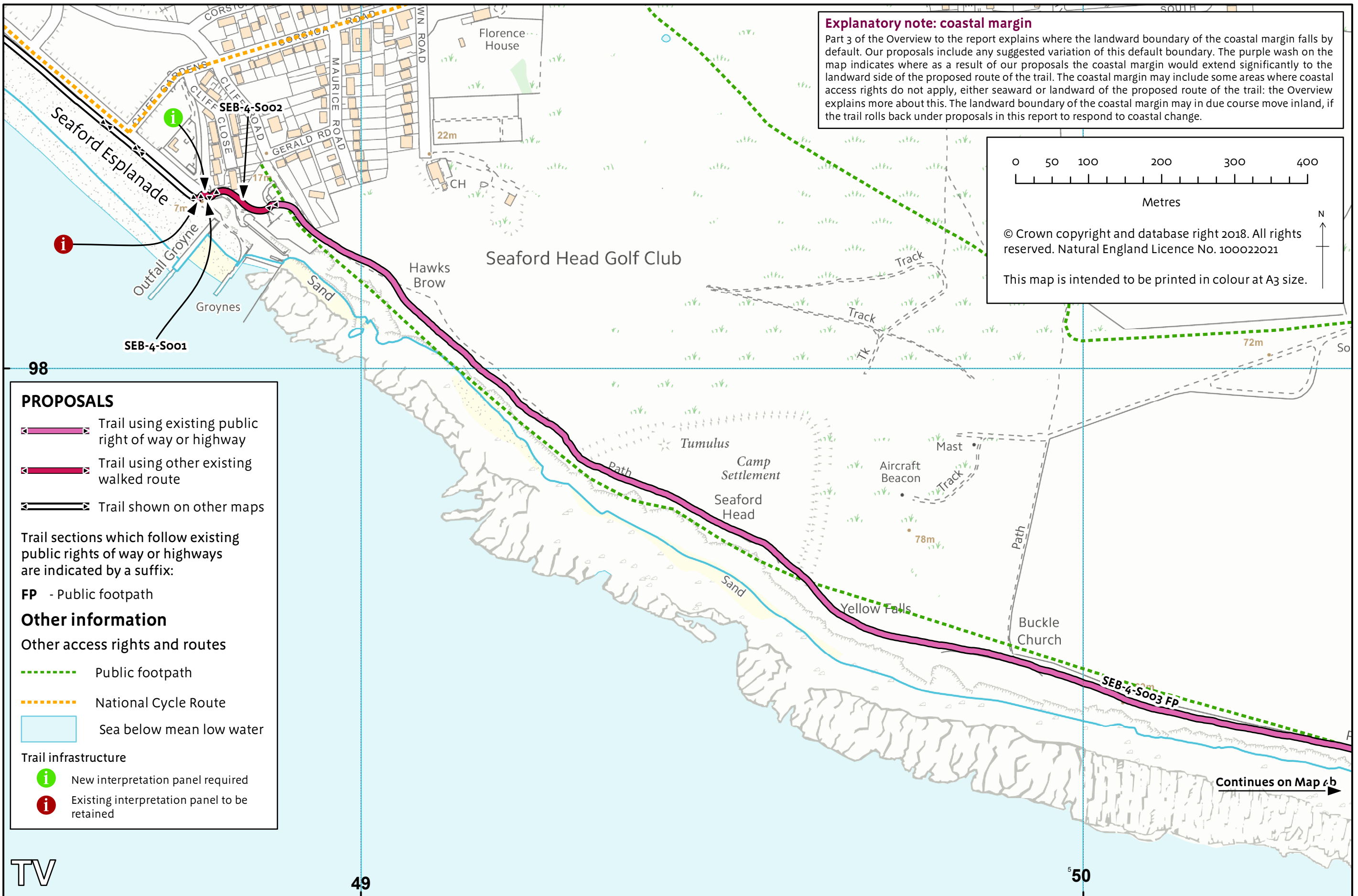

Map 4a: Seaford Esplanade to Seaford Head

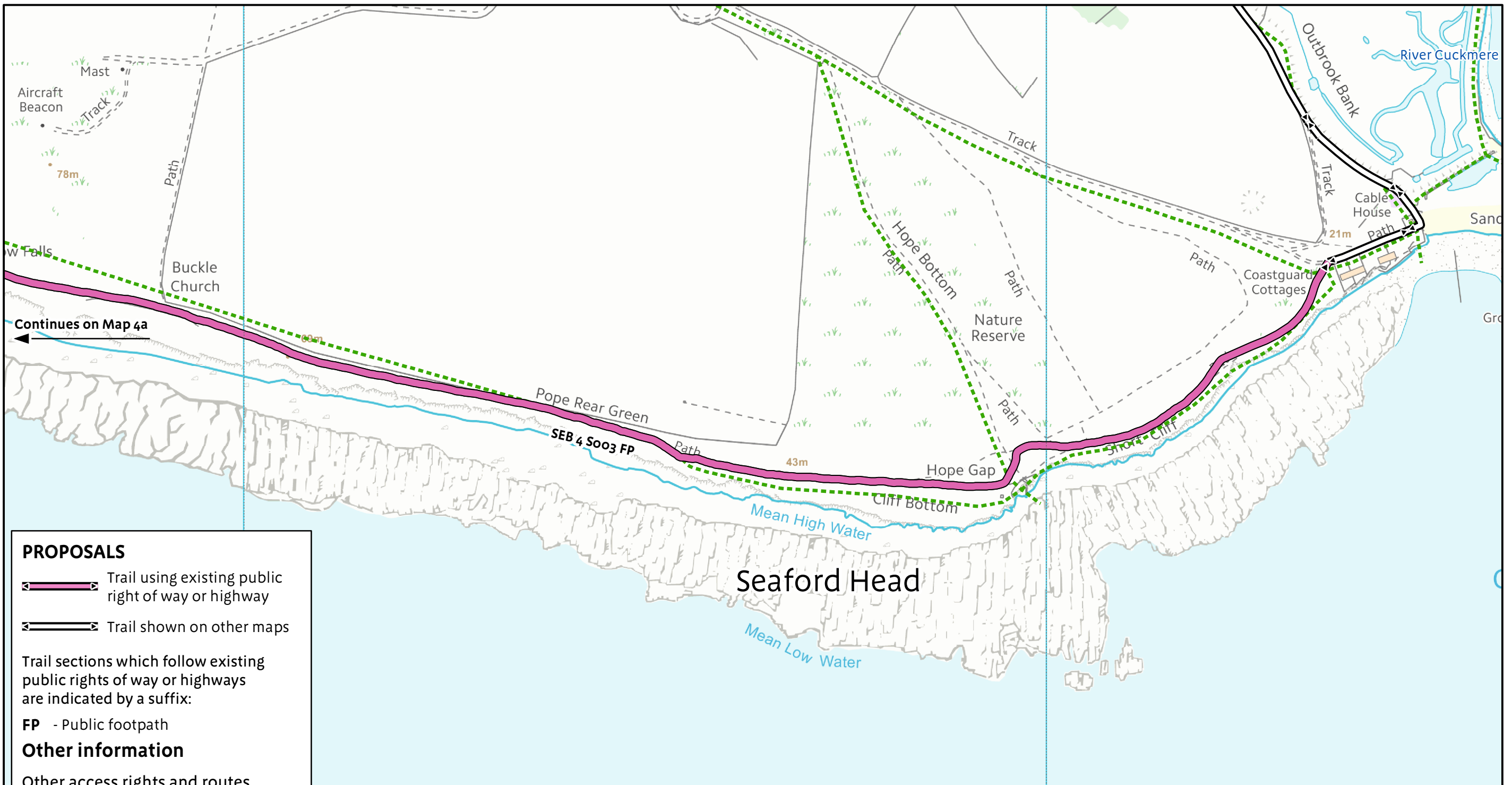

**PROPOSALS**

- Trail using existing public right of way or highway
- Trail shown on other maps

Trail sections which follow existing public rights of way or highways are indicated by a suffix:

**FP** - Public footpath

**Other information**

Other access rights and routes

- Public footpath
- Sea below mean low water

**Explanatory note: coastal margin**

Part 3 of the Overview to the report explains where the landward boundary of the coastal margin falls by default. Our proposals include any suggested variation of this default boundary. The purple wash on the map indicates where as a result of our proposals the coastal margin would extend significantly to the landward side of the proposed route of the trail. The coastal margin may include some areas where coastal access rights do not apply, either seaward or landward of the proposed route of the trail: the Overview explains more about this. The landward boundary of the coastal margin may in due course move inland, if the trail rolls back under proposals in this report to respond to coastal change.

0 50 100 200 300 400

Metres

© Crown copyright and database right 2018. All rights reserved. Natural England Licence No. 100022021

This map is intended to be printed in colour at A3 size.

N

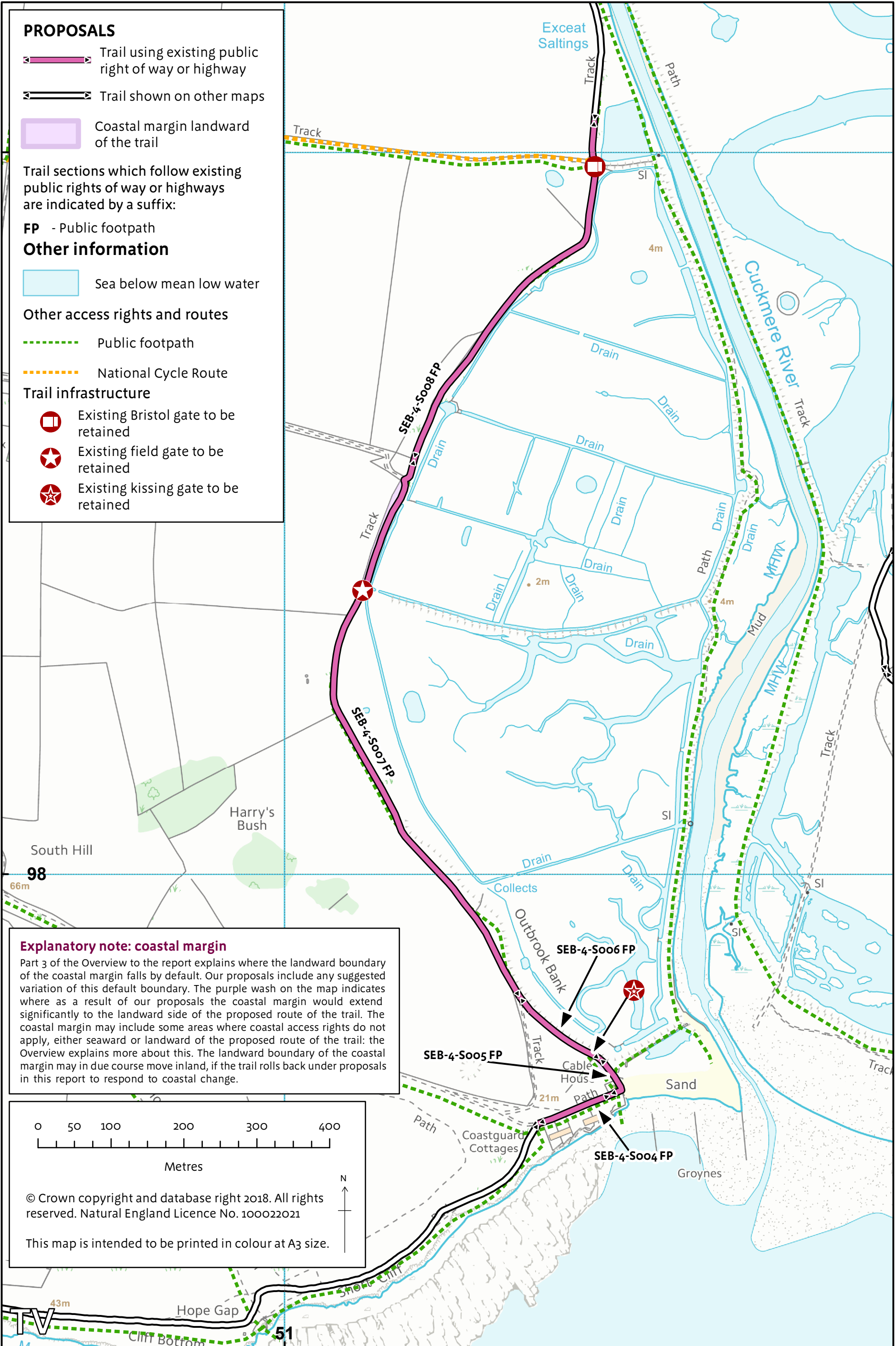

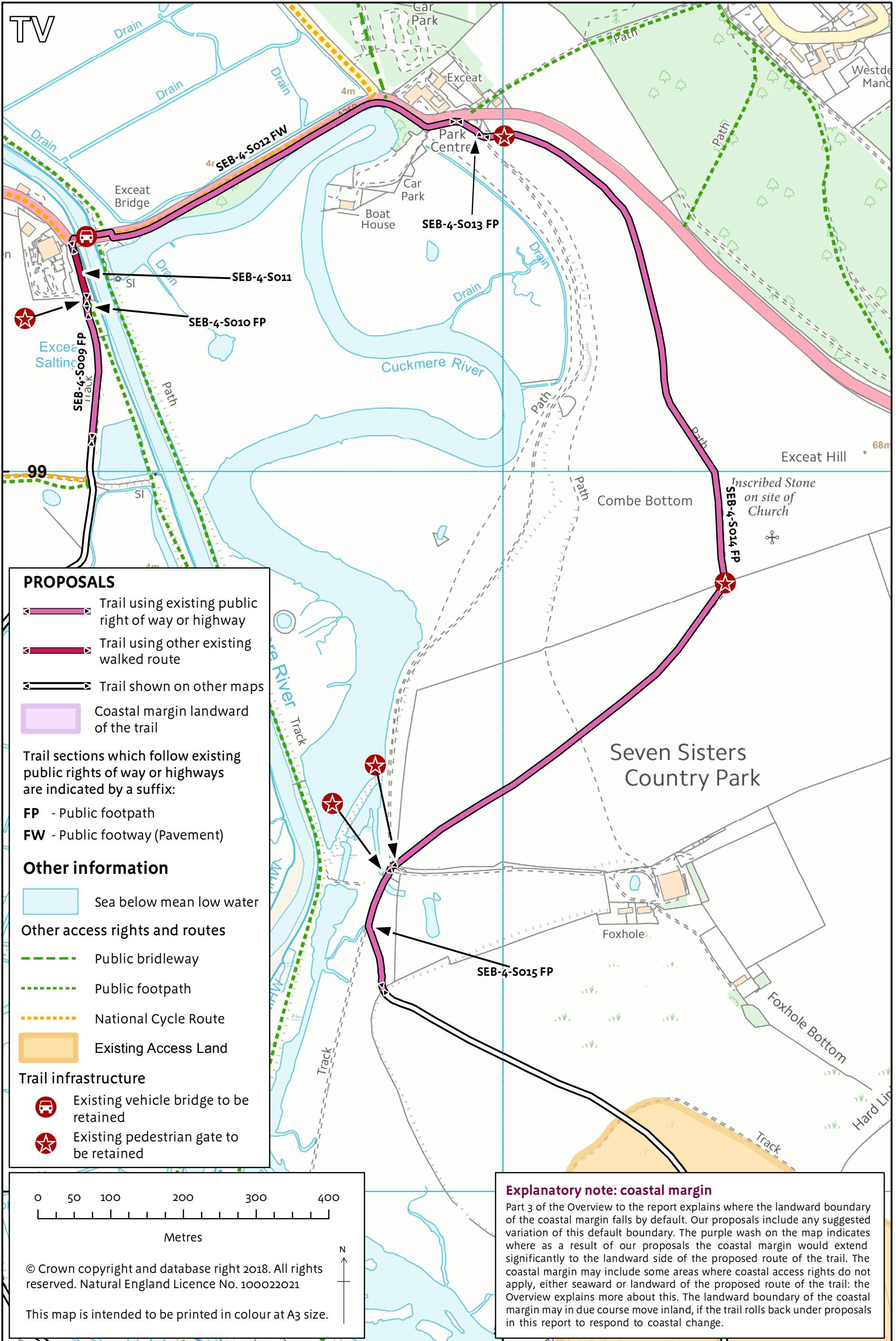

TV

99

**PROPOSALS**

- Trail using existing public right of way or highway
- Trail using other existing walked route
- Trail shown on other maps
- Coastal margin landward of the trail

Trail sections which follow existing public rights of way or highways are indicated by a suffix:

- FP - Public footpath
- FW - Public footway (Pavement)

**Other information**

- Sea below mean low water
- Other access rights and routes
  - Public bridleway
  - Public footpath
  - National Cycle Route
  - Existing Access Land

**Trail infrastructure**

- Existing vehicle bridge to be retained
- Existing pedestrian gate to be retained

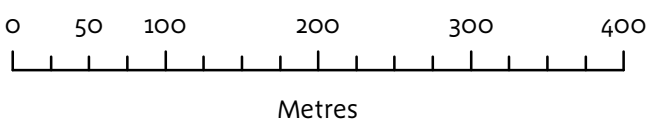

© Crown copyright and database right 2018. All rights reserved. Natural England Licence No. 100022021

This map is intended to be printed in colour at A3 size.

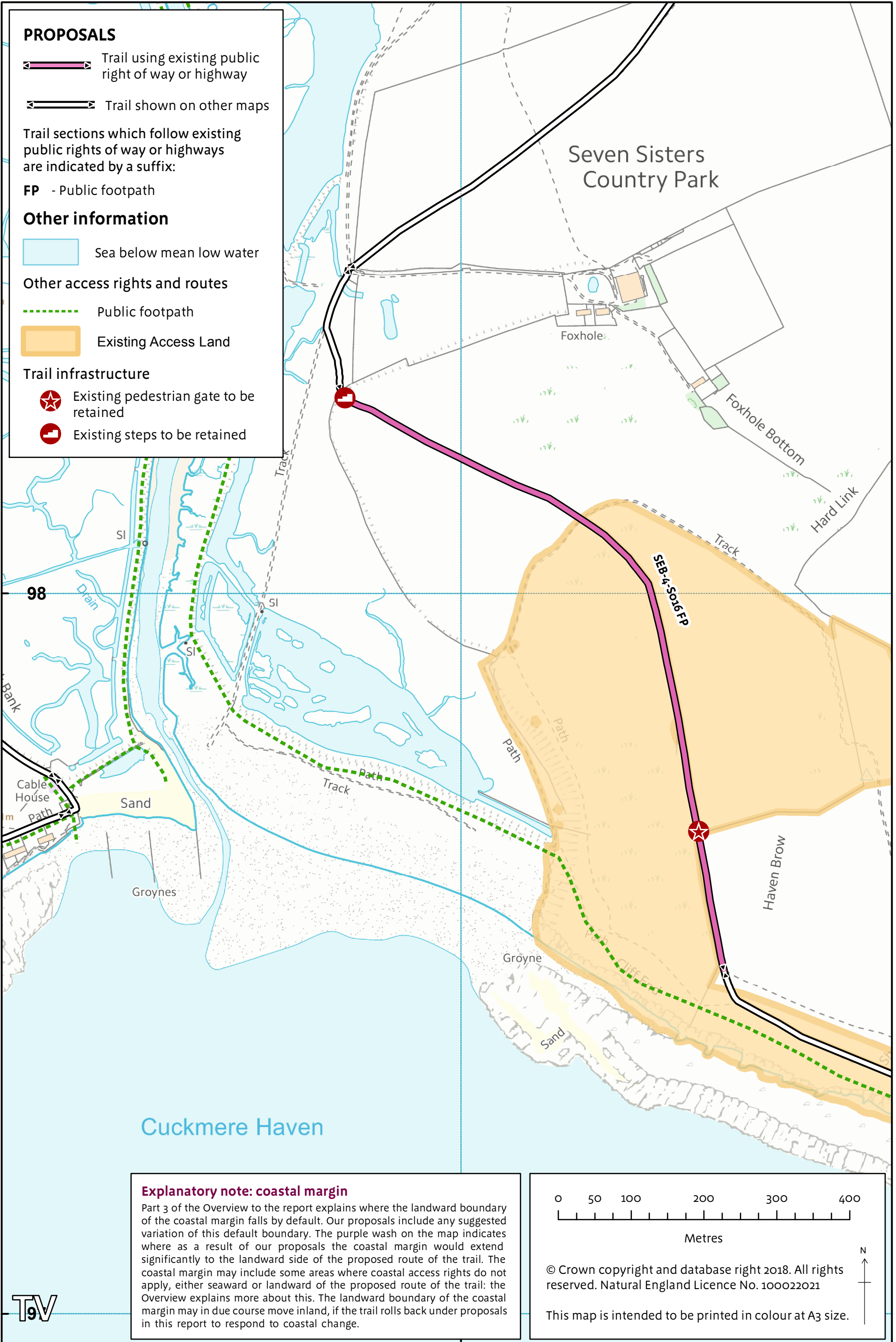



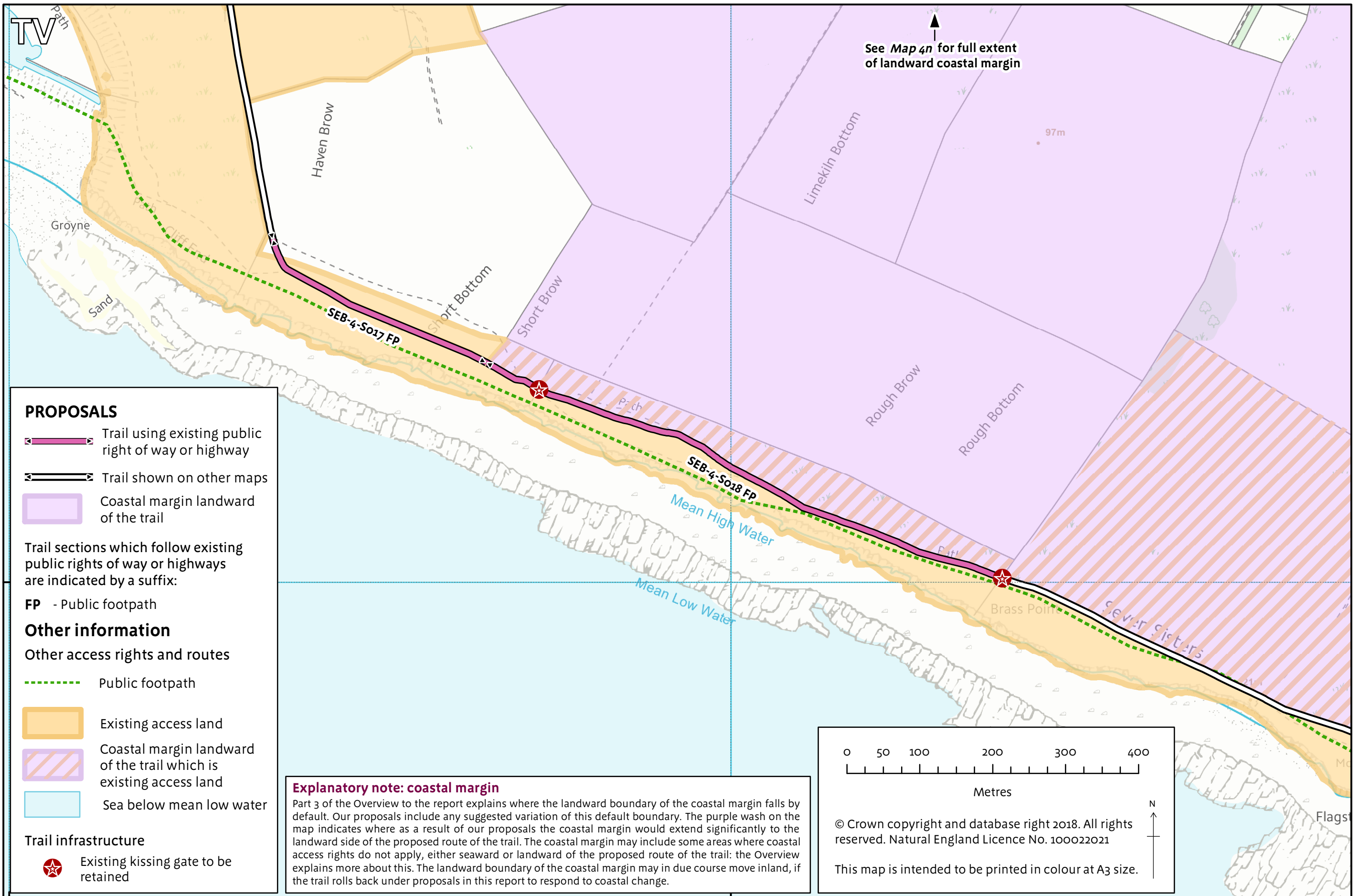

Map 4f: Haven Brow to Rough Bottom

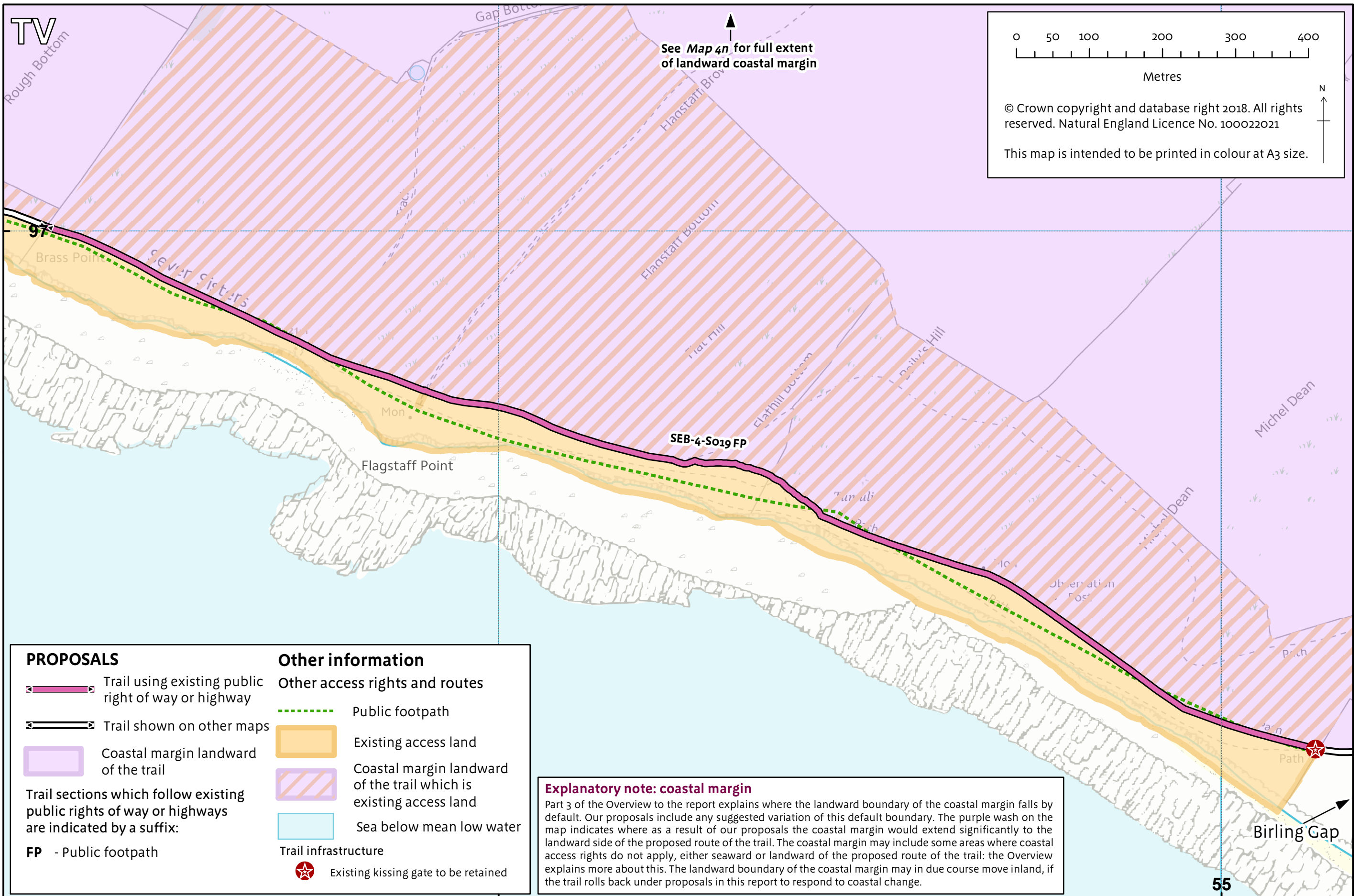

Map 4g: Rough Bottom to Birling Gap

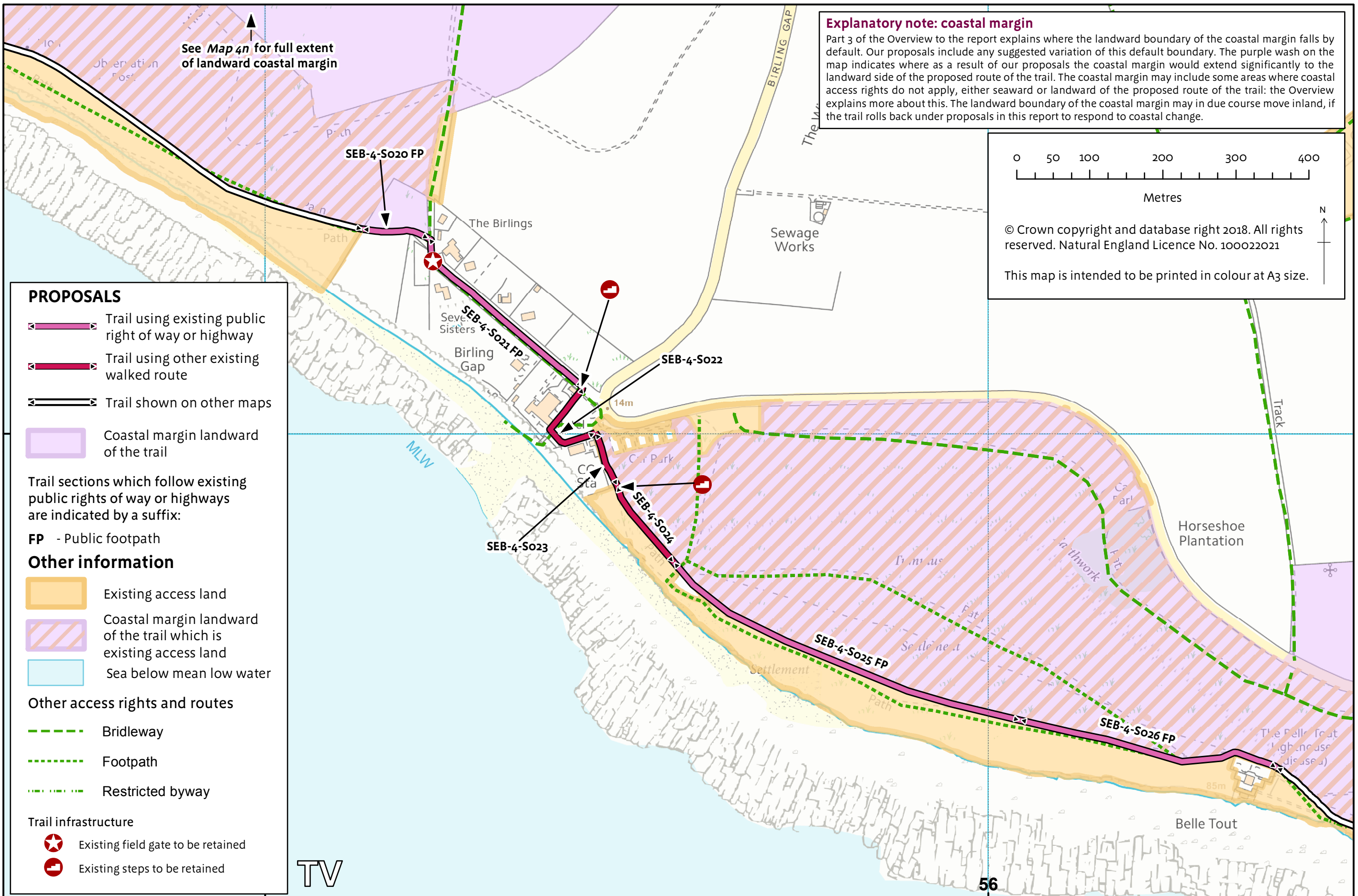

Map 4h: Birling Gap to Belle Tout Lighthouse

**Explanatory note: coastal margin**

Part 3 of the Overview to the report explains where the landward boundary of the coastal margin falls by default. Our proposals include any suggested variation of this default boundary. The purple wash on the map indicates where as a result of our proposals the coastal margin would extend significantly to the landward side of the proposed route of the trail. The coastal margin may include some areas where coastal access rights do not apply, either seaward or landward of the proposed route of the trail: the Overview explains more about this. The landward boundary of the coastal margin may in due course move inland, if the trail rolls back under proposals in this report to respond to coastal change.

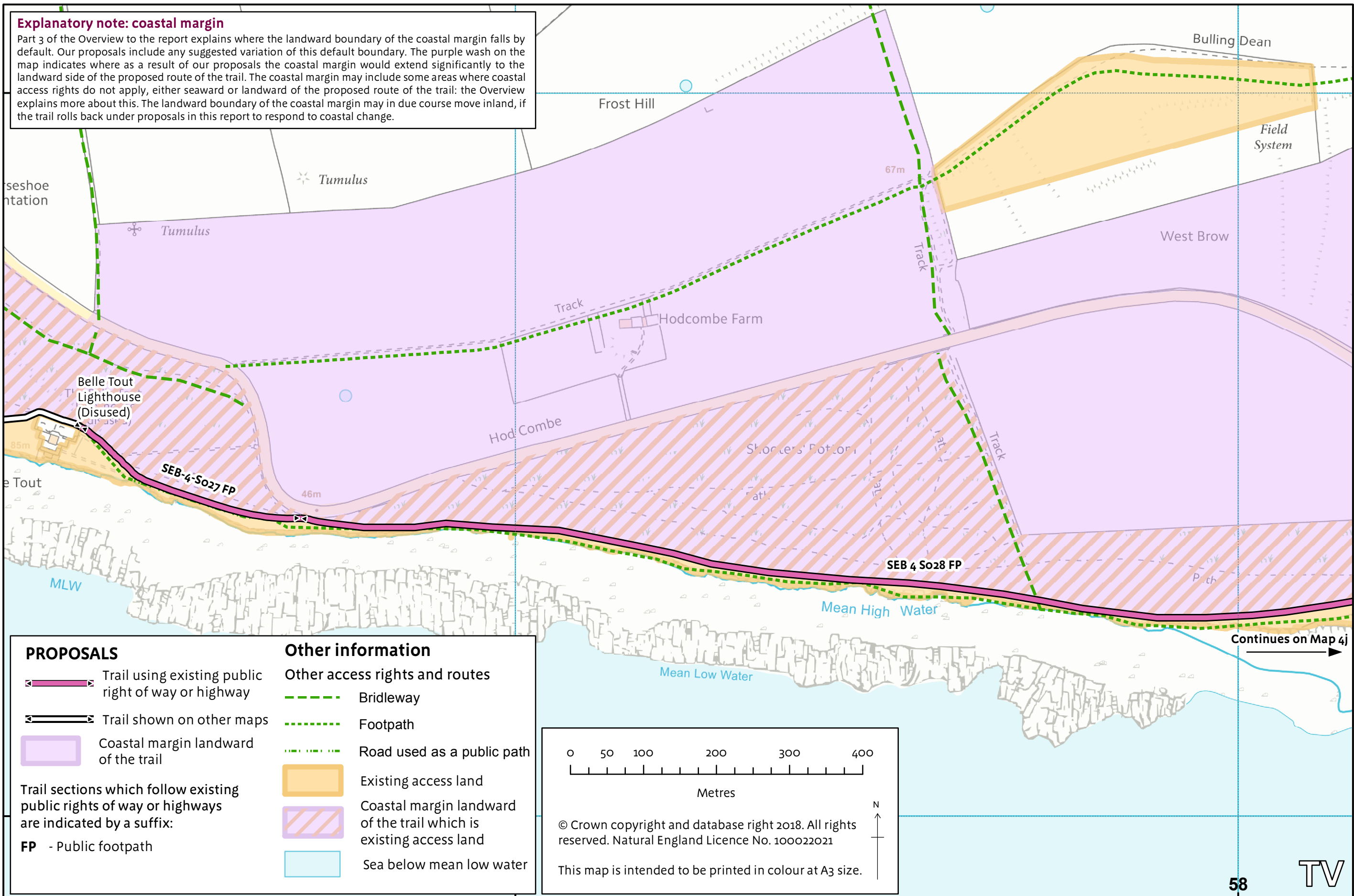

PROPOSALS	Other information
Trail using existing public right of way or highway	Bridleway
Trail shown on other maps	Footpath
Coastal margin landward of the trail	Road used as a public path
Trail sections which follow existing public rights of way or highways are indicated by a suffix: <b>FP</b> - Public footpath	Existing access land
	Coastal margin landward of the trail which is existing access land
	Sea below mean low water

0 50 100 200 300 400  
Metres

© Crown copyright and database right 2018. All rights reserved. Natural England Licence No. 100022021

This map is intended to be printed in colour at A3 size.

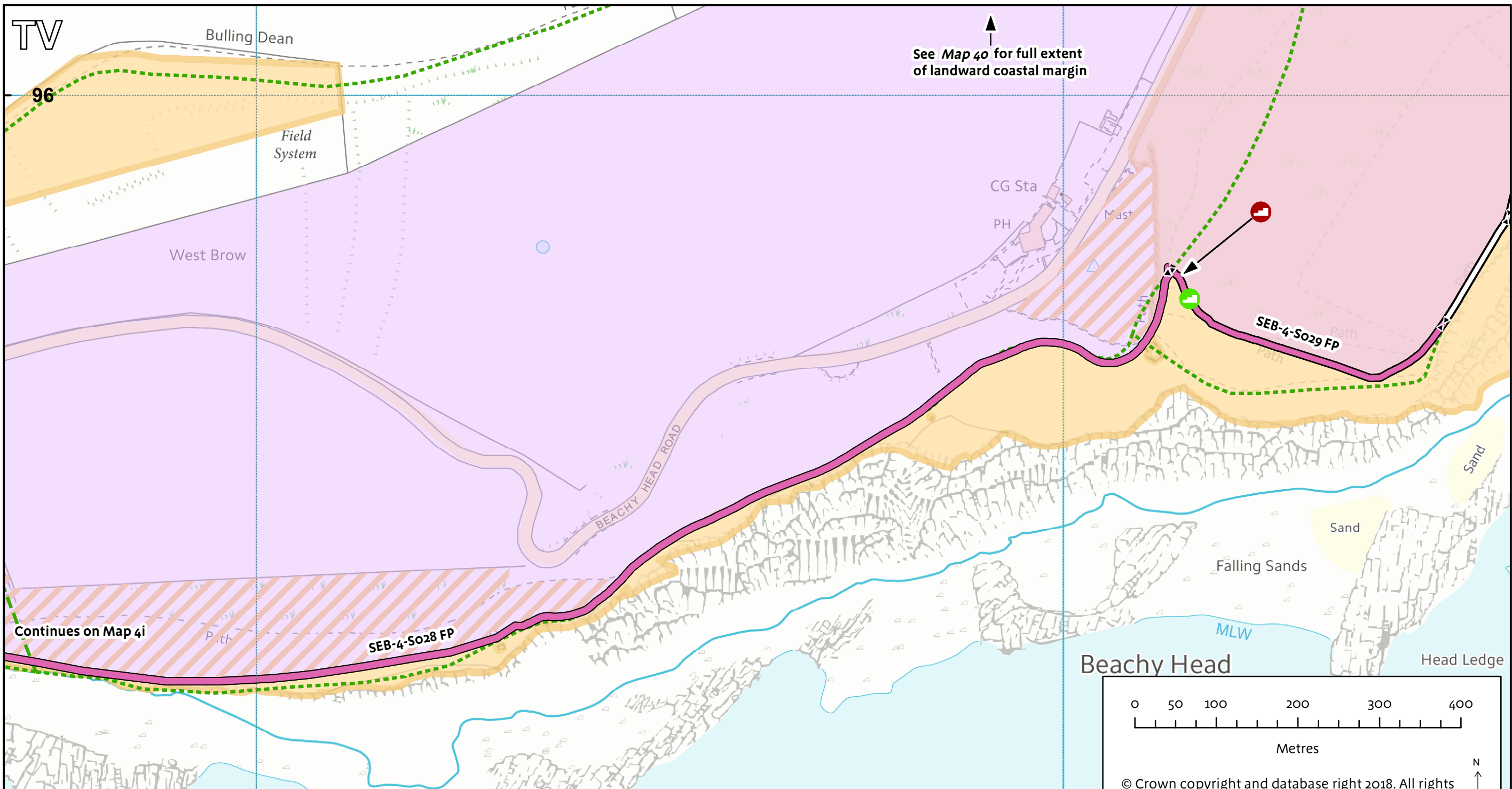

PROPOSALS	Other information	Other access rights and routes
Trail using existing public right of way or highway	Sea below mean low water	Bridleway
Trail shown on other maps	Existing access land	Footpath
Trail sections which follow existing public rights of way or highways are indicated by a suffix:	Coastal margin landward of the trail which is existing access land	<b>Trail infrastructure</b>
<b>FP</b> - Public footpath		New steps required
		Existing steps to be retained

Beachy Head

0 50 100 200 300 400

Metres

© Crown copyright and database right 2018. All rights reserved. Natural England Licence No. 100022021

This map is intended to be printed in colour at A3 size.

N

**Explanatory note: coastal margin**

Part 3 of the Overview to the report explains where the landward boundary of the coastal margin falls by default. Our proposals include any suggested variation of this default boundary. The purple wash on the map indicates where as a result of our proposals the coastal margin would extend significantly to the landward side of the proposed route of the trail. The coastal margin may include some areas where coastal access rights do not apply, either seaward or landward of the proposed route of the trail: the Overview explains more about this. The landward boundary of the coastal margin may in due course move inland, if the trail rolls back under proposals in this report to respond to coastal change.

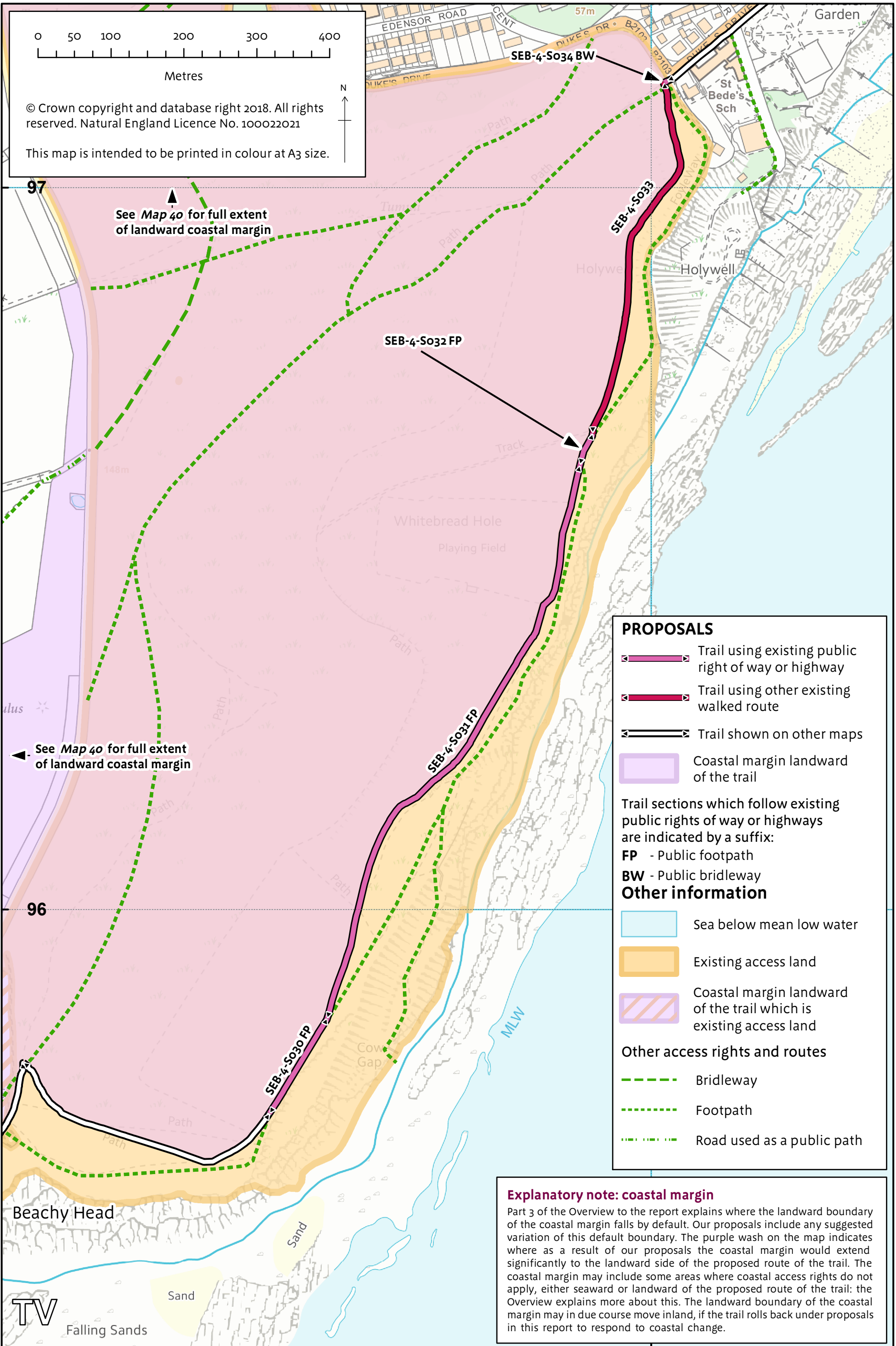

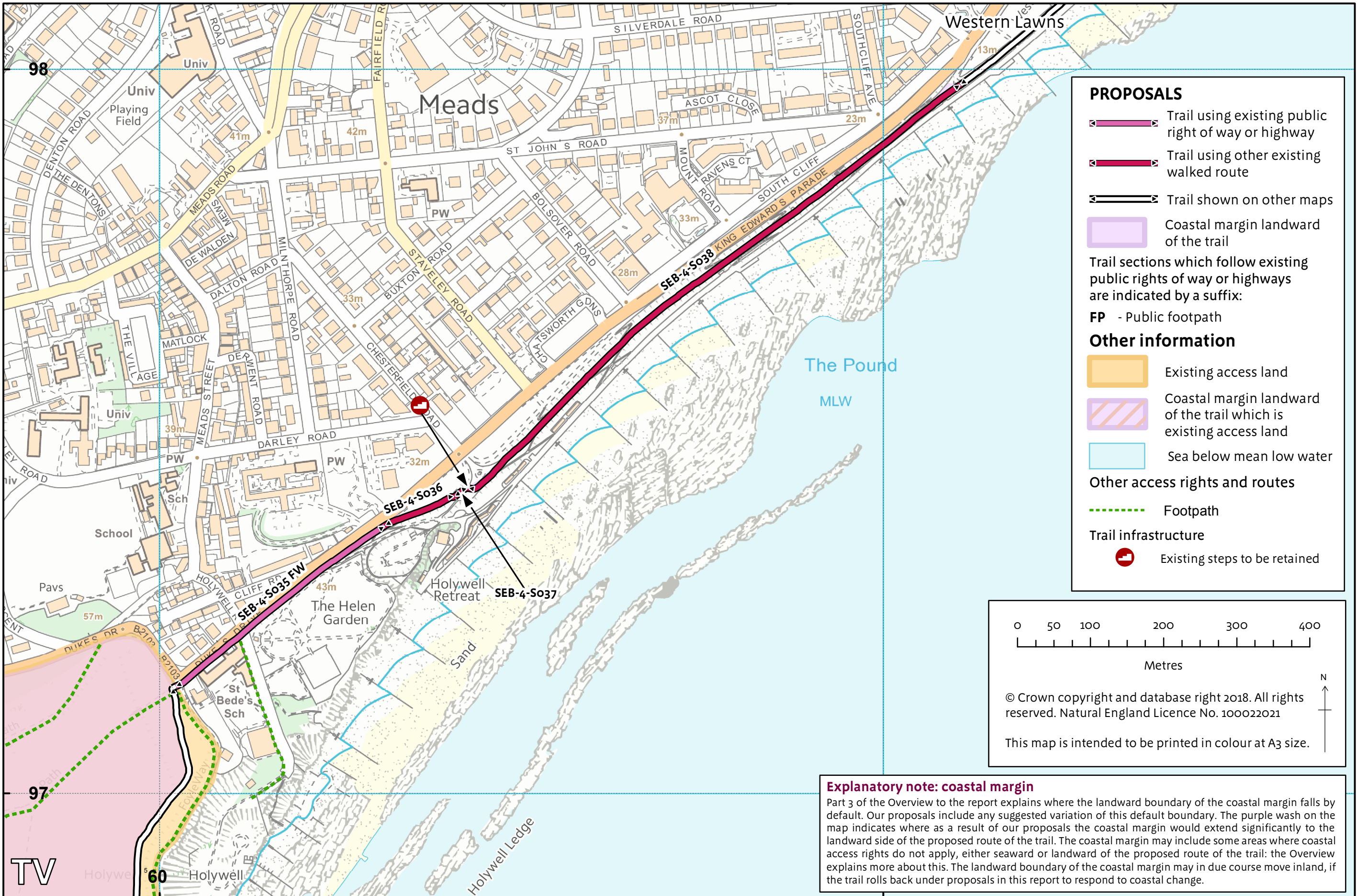

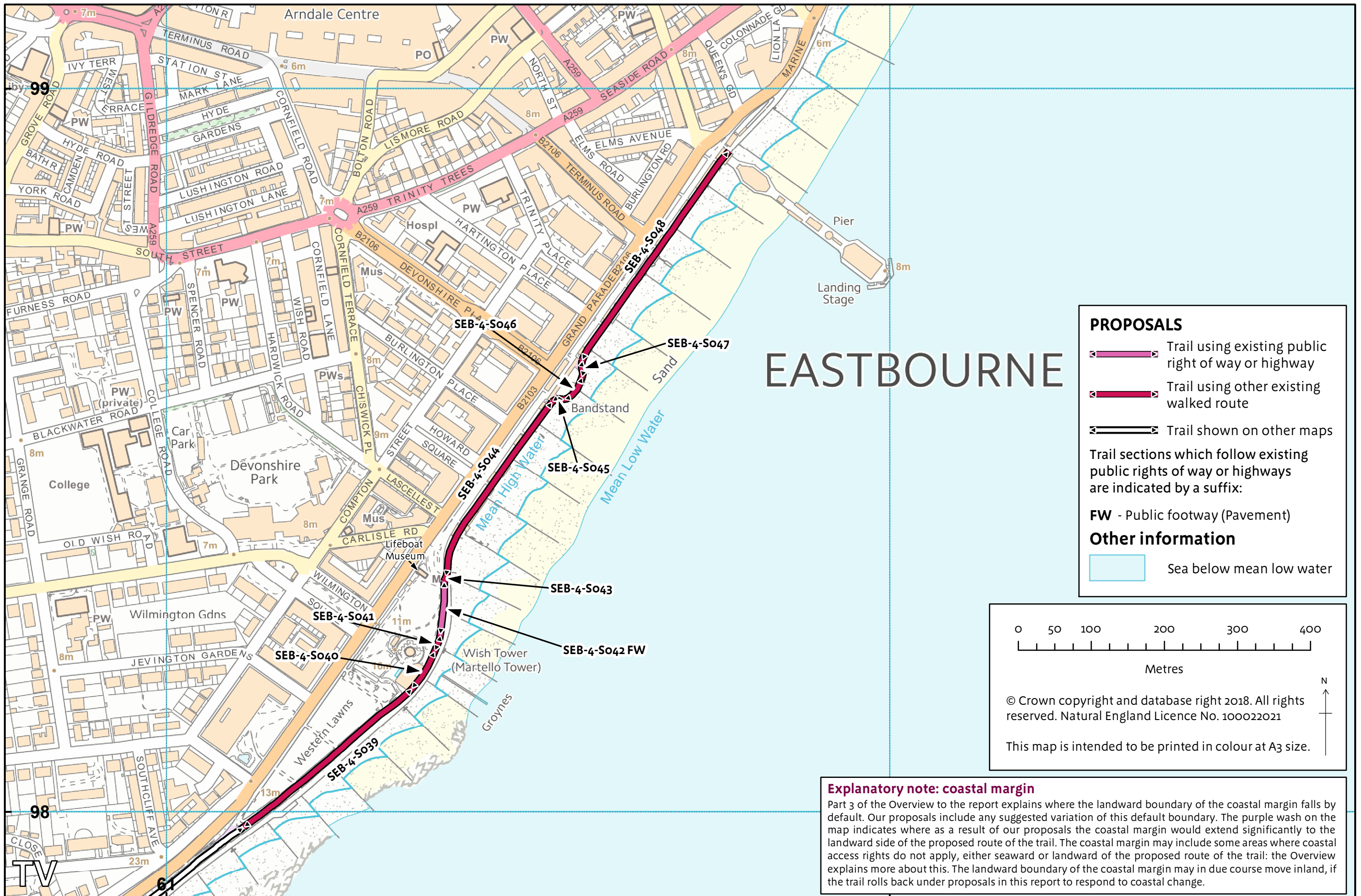

Map 4m: Western Lawns to Eastbourne Pier



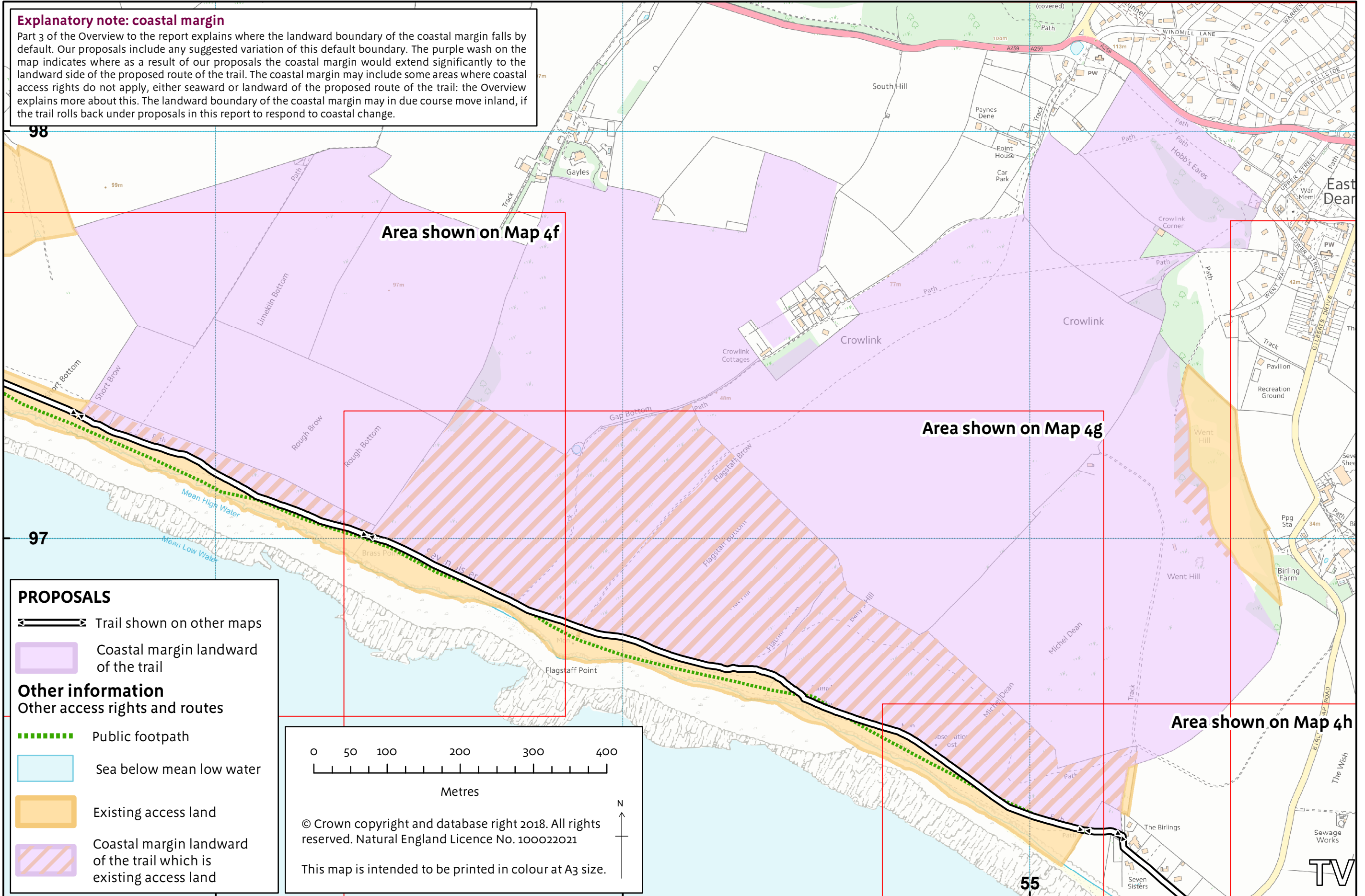

**Explanatory note: coastal margin**  
 Part 3 of the Overview to the report explains where the landward boundary of the coastal margin falls by default. Our proposals include any suggested variation of this default boundary. The purple wash on the map indicates where as a result of our proposals the coastal margin would extend significantly to the landward side of the proposed route of the trail. The coastal margin may include some areas where coastal access rights do not apply, either seaward or landward of the proposed route of the trail: the Overview explains more about this. The landward boundary of the coastal margin may in due course move inland, if the trail rolls back under proposals in this report to respond to coastal change.

**PROPOSALS**

- Trail shown on other maps
- Coastal margin landward of the trail

**Other information**  
 Other access rights and routes

- Public footpath
- Sea below mean low water
- Existing access land
- Coastal margin landward of the trail which is existing access land

0 50 100 200 300 400  
 Metres

© Crown copyright and database right 2018. All rights reserved. Natural England Licence No. 100022021  
 This map is intended to be printed in colour at A3 size.

