

Station Information:

Station	Easting (m)	Northing (m)	Level (m)
GH1	417601.034	290892.394	83.387
GH2	417616.300	290828.325	83.499
GH3	417531.439	290799.425	83.398
GH4	417471.870	290794.733	81.498
GH5	417409.542	290800.452	80.874
GH9	417676.362	290856.111	82.916
GH10	417689.538	290891.532	82.702

OS Note:
Some services may have been omitted due to parked vehicles.
The Ordnance Survey title is to be used as a guide only.

OS Buildings [Grey Box] Surveyed Buildings [Yellow Box]

This survey has been oriented to the Ordnance Survey (OS) National Grid (OSGB36 15) via Global Navigational Satellite Systems (GNSS) and the O.S. Active Network (OS Net).
A true OSGB36 coordinate has been established near to the site centre via a transformation using the OSTN15GB & OSGM15GB transformation models.
The survey has been correlated to this point and a further one or more OSGB36 (15) points established to create a true O.S. bearing for angle orientation.
No scale factor has been applied to the survey therefore the coordinates shown are arbitrary & not true O.S. Coordinates which have a scale factor applied.
Please refer to Survey Station Table to enable establishment of the on-site grid and datum.

Legend:

	Overhead Cable		Proposed drainage		Boundary
	Proposed Sewer		Proposed road		Proposed footpath
	Proposed Gas		Proposed path		Proposed fence
	Proposed Water		Proposed driveway		Proposed gate
	Proposed Drain		Proposed boundary		Proposed wall
	Proposed Sewer		Proposed boundary		Proposed wall
	Proposed Gas		Proposed boundary		Proposed wall
	Proposed Water		Proposed boundary		Proposed wall
	Proposed Drain		Proposed boundary		Proposed wall
	Proposed Sewer		Proposed boundary		Proposed wall

Rev	Date	Description	Drawn	Cd. Ref.
-----	------	-------------	-------	----------

greenhatch group

- Topographical Surveys
- Measured Building Surveys
- Site Engineering
- 3D Laser Scanning
- Utility / CCTV Surveys
- Revit & BIM Models

Rowan House
Duffield Road
Little Catton
Derby
DE21 5DR
Tel (01332) 830044 Fax (01332) 830055
admin@greenhatch-group.co.uk
www.greenhatch-group.co.uk

St Albans
Unit B, The Courtyard
Albany Park
Hertfordshire
AL4 0LA
t. (01727) 854981

Newcastle
24 Riverside Studios
Newcastle Bus Park
Newcastle-Upon-Tyne
NE4 7YL
t. (01912) 736391

Poland
ul. Piłsudskiego 91
40-763 Katowice
Poland
t. 0048 32 262 2292
www.greenhatch.pl

CLIENT
**Willmott Dixon
Construction Ltd**

PROJECT
**Plank Lane
Water Orton
Warwickshire**

TITLE
**Topographical
Survey**

SCALE	DATE
A1@ 1: 500	04.05.17
DRAWN	QUALITY REF
TC	GH0811

Level datum	See note
Grid orientation	See note

Job number	24216
------------	-------

Drawing No.	24216_T	Rev.	0
-------------	---------	------	---

Comments
This plan should only be used for its original purpose. Greenhatch Group accepts no responsibility for this plan if supplied to any party other than the original client.
All dimensions should be checked on site prior to design and construction.
Drainage information (where applicable) has been visually inspected from the surface and therefore should be treated as approximate only.

Notes:

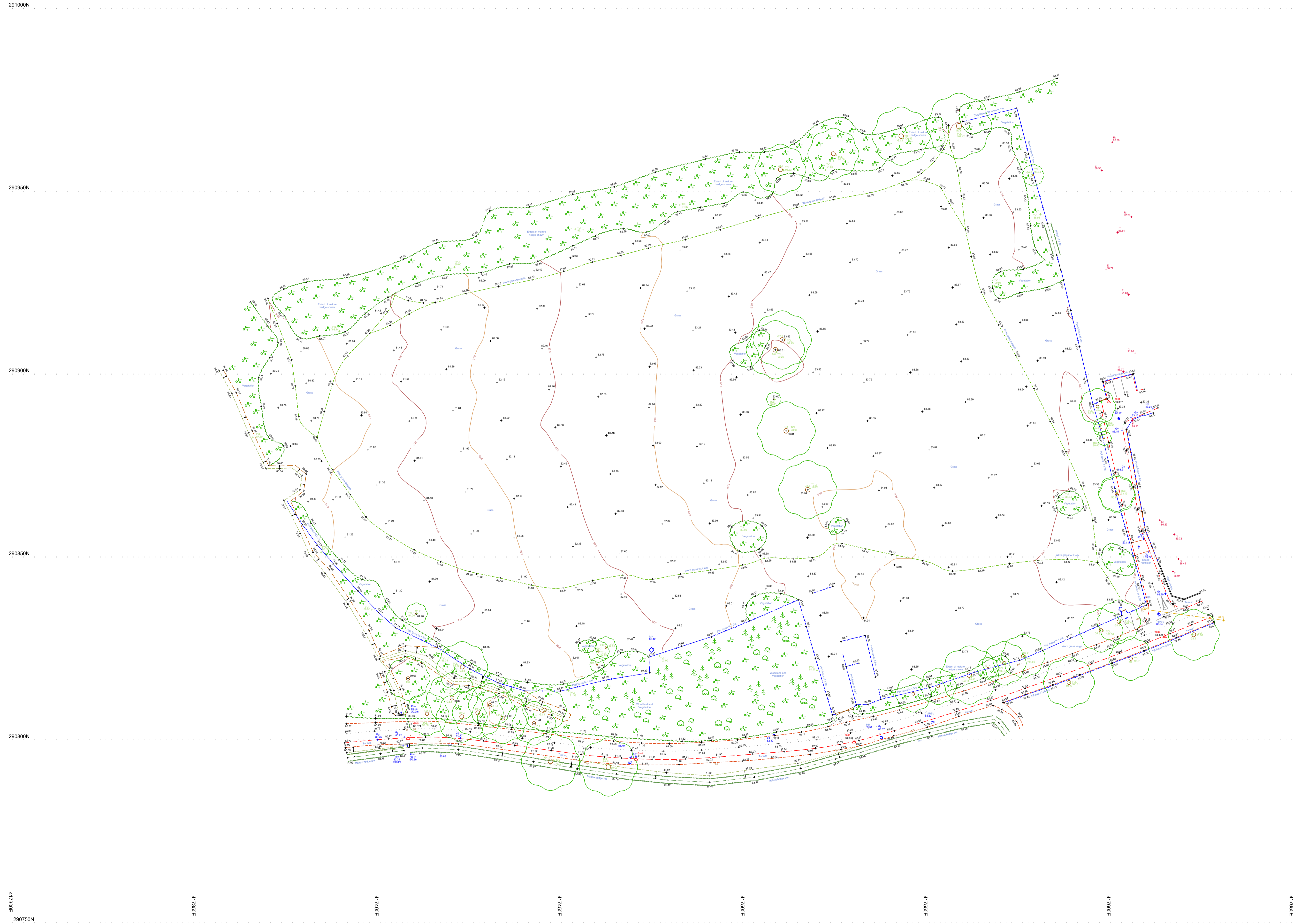

417300E 417350E 417400E 417450E 417500E 417550E
290750N 290800N 290850N 290900N 290950N 291000N

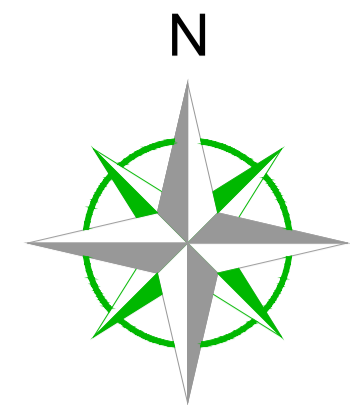
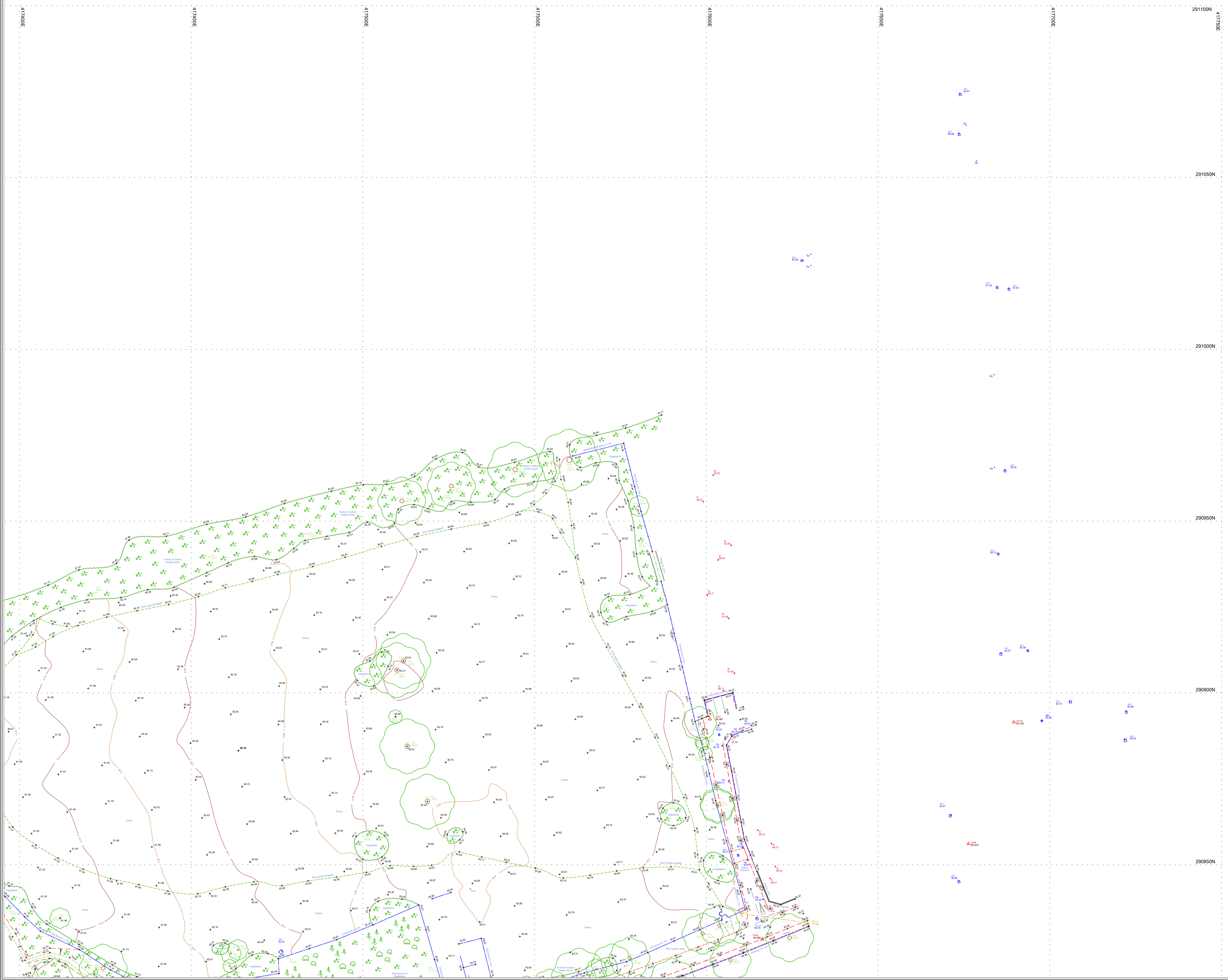

Station Information:

Station	Easting (m)	Northing (m)	Level (m)
GH1	417601.034	290892.394	83.387
GH2	417616.300	290828.325	83.499
GH3	417531.439	290799.425	83.398
GH4	417471.870	290794.733	81.498
GH5	417409.542	290800.452	80.874
GH9	417676.362	290856.111	82.916
GH10	417689.538	290891.532	82.702

OS Note:
 Some services may have been omitted due to parked vehicles. The Ordnance Survey title is to be used as a guide only.

OS Buildings ■ Surveyed Buildings ■

This survey has been orientated to the Ordnance Survey (OS) National Grid (OSGB36) via Global Navigational Satellite Systems (GNSS) and the O.S. Active Network (OS Net). A true OSGB36 coordinate has been established near to the site centre via a transformation using the OSTN15GB & OSGM15GB transformation models. The survey has been correlated to this point and a further one or more OSGB36 (15) points established to create a true O.S. bearing for angle orientation. No scale factor has been applied to the survey therefore the coordinates shown are arbitrary & not true O.S. Coordinates which have a scale factor applied. Please refer to Survey Station Table to enable establishment of the on-site grid and datum.

Legend:

	Overhead Cable		Inspection chamber		Ballast
	Water		Pipe level		Reinforced Inlet
	Trench edge		Gravel		Reinforced
	Manhole		Gravel pit		Verger
	Manhole cover		Gravel		Ground sign
	Manhole		Gravel		Level box
	Manhole		Gravel		Level box
	Manhole		Gravel		Level box

Rev	Date	Description	Drawn	Q. Ref.

greenhatch group

- Topographical Surveys
- Site Engineering
- Utility / CCTV Surveys
- Measured Building Surveys
- 3D Laser Scanning
- Revit & BIM Models

Rowan House
 Duffield Road
 Little Catton
 Derby
 DE21 5DR
 Tel (01332) 830044 Fax (01332) 830055
 admin@greenhatch-group.co.uk
 www.greenhatch-group.co.uk

Unit 8, The Courtyard, St Albans, Hertfordshire, AL4 6LA, T: (01727) 854881
 Newcastle, 24 Riverside Studios, Newcastle Bus Park, Newcastle-U-Tyne, NE4 7YL, T: (01912) 736391
 Poland, ul. Piątnicka 91, 40-763 Katowice, Poland, T: 0048 22 262 2292, www.greenhatch.pl

CLIENT
Willmott Dixon Construction Ltd

PROJECT
Plank Lane Water Orton Warwickshire

TITLE
Topographical Survey

SCALE A1@ 1: 500	DATE 04.05.17
DRAWN TC	QUALITY REF GH0811

Level datum: See note
 Grid orientation: See note
 Job number: 24216
 Drawing No: 24216_T
 Rev: 0

Comments
 This plan should only be used for its original purpose. Greenhatch Group accepts no responsibility for this plan if supplied to any party other than the original client.
 All dimensions should be checked on site prior to design and construction.
 Drainage information (where applicable) has been visually inspected from the surface and therefore should be treated as approximate only.
 Notes:

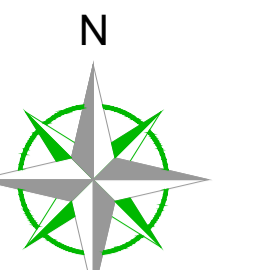
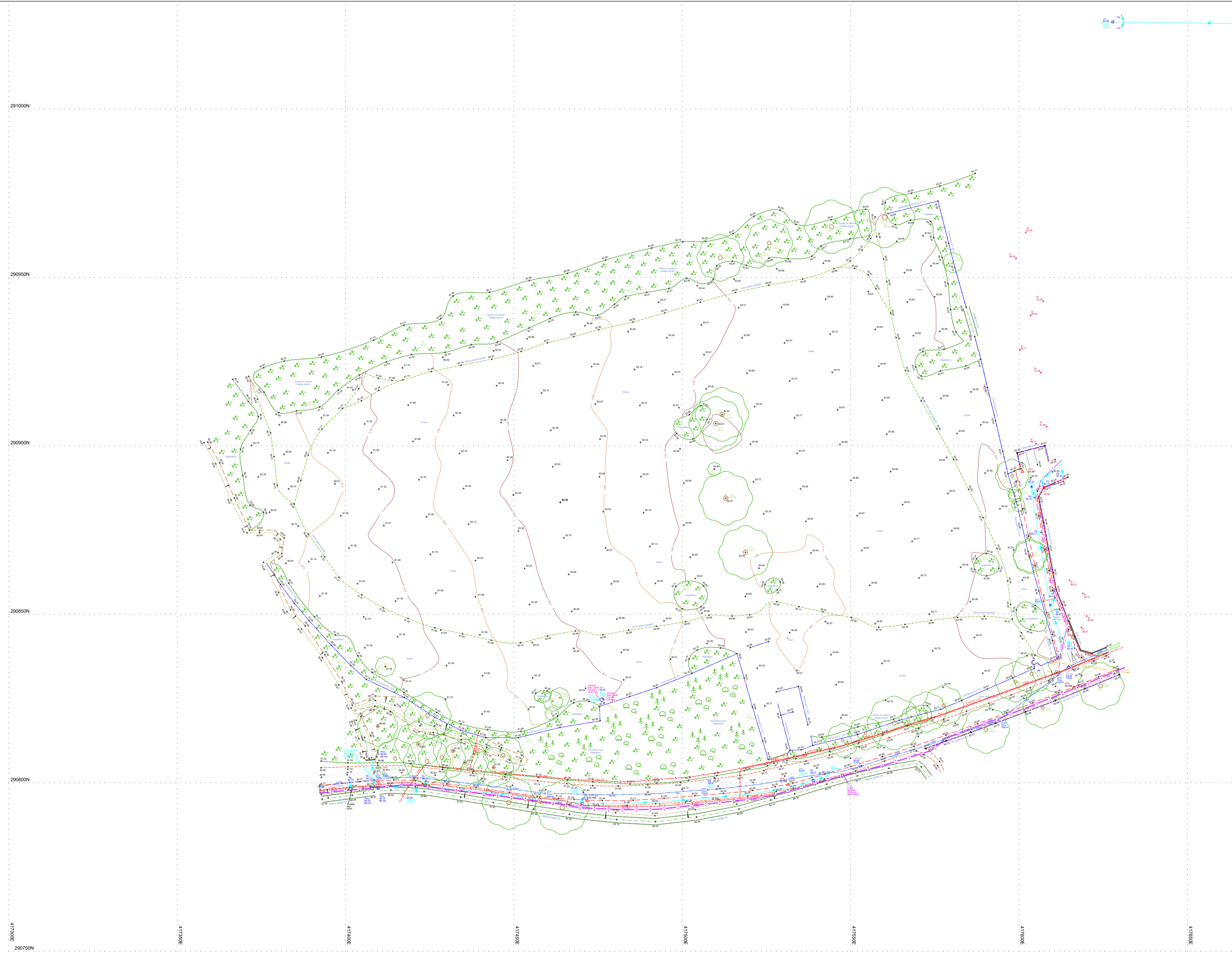

NOTES:
Only BT, Gas & Electric records available at time of survey.

UTILITY KEY

	ELECTRIC CABLE
	ELECTRIC & COMMS CABLE
	TRAFFIC SIGNAL CABLE
	TELECOMS CABLE
	CABLE TELEVISION
	COMMUNICATION CABLE
	WATER PIPE
	GAS PIPE
	FOUL DRAINAGE
	CONTAMINATED SURFACE DRAINAGE
	SURFACE DRAINAGE
	COMBINED DRAINAGE
	PUMPING MAIN
	FUEL PIPE
	VENT PIPE
	OFFSET FILL PIPE
	GAUGE LINE
	VAPOUR RECOVERY
	SERVICE DUCTS
	HEATING PIPES
	UNIDENTIFIED SIGNAL
	END OF TRACE

ABBREVIATIONS

AC	ASBESTOS CEMENT	MW	MONITORING WELL
AR	ASSUMED ROUTE	OH	OVERHEAD
BR	BASE BEND	OSA	OFF SURVEY AREA
BD	BACKDROP	PE	POLYETHYLENE
BR	BOREROLE	PL	PLASTIC
BR	BRICK	PVC	POLY(VINYL CHLORIDE)
CI	CAST IRON	RIP	ROCKING RIB
CL	COVER LEVEL	RWP	RAIN WATER PIPE
CO	CONCRETE	SI	SOMERSET
CR	CABLE RISER	SI	SPRINKLER
CP	CATCHPIT	ST	STOP TAP
DI	DUCTILE IRON	ST	STEEL
DF	DOWN FLOW	SUP	SOLE VENT PIPE
EO	END OF TRACE	TE	TRACED
ER	EARTHING ROD	TFR	TAKEN FROM RECORD
ER	ELECTRICITY POLE	TR	TRACED
FI	FIRE HYDRANT	UL	UNABLE TO LOCATE
GR	GROUND PENETRATING RADAR	UL	UNABLE TO FIND
GR	GLASS REINFORCED PLASTIC	UL	UNABLE TO SURVEY
GV	GAS VALVE	WC	WATER CLOSET
H	HIGH LEVEL	WC	WATER RECOVERY
HR	HEAD OF RUN	WR	WATER RECOVERY
IC	INSPECTION CHAMBER	WR	WATER LEVEL
JL	JUNCTION LEVEL	WM	WATER METER
LP	LAMP POST	WO	WASH OUT VALVE
MH	MANHOLE		
SWS	SURFACE WATER SEWER		
FWS	FOUL WATER SEWER		
CWS	COMBINED WATER SEWER		

DISCLAIMER

ELECTROMAGNETIC TECHNIQUES AND/OR GROUND PENETRATING RADAR HAVE BEEN USED IN THE LOCATION OF UNDERGROUND SERVICES AND SHOULD BE USED TO CONFIRM SERVICE IDENTIFICATION POSITIONS AND PARTICULARS WHERE THESE ARE OBTAINED THROUGH ALL REASONABLE EFFORT HAS BEEN MADE IN SEARCHING AVAILABLE RECORDS. UNLESS OTHERWISE STATED, THE METHOD OF SURVEY DOES NOT DIFFERENTIATE BETWEEN LIVE AND DEAD SERVICES AND AS SUCH ALL SERVICES SHOULD BE TREATED AS LIVE.

WHERE SERVICES ARE NON-METALLIC POSITIONS MAY BE TAKEN FROM RECORDS, TRENCH SCARES & SURFACE DETAILS.

WHERE QUOTED, DEPTH ESTIMATIONS ARE GENERALLY TO THE CENTRE OF THE SERVICE, DEPTHS TO GROUND SERVICES AND BRANDS ARE GENERALLY TO INVERT LEVELS UNLESS OTHERWISE STATED.

PIPE SIZES WHICH CANNOT BE OBTAINED BY VISUAL SURVEY ARE TAKEN FROM RECORD DRAWINGS OR MARKER PLATES WHERE AVAILABLE.

WHERE GROUND PENETRATING RADAR HAS BEEN USED IT WILL PRIMARILY HAVE BEEN TO IDENTIFY UNDERGROUND UTILITIES AND TRENCHES. IT IS NOT GUARANTEED TO HAVE LOCATED ALL SUCH ITEMS. THE USE OF RADAR CAN BE LIMITED BY SOIL TYPE, CONDITIONS AND ALSO BY SOIL TYPE. DEPTH ESTIMATES WOULD NOT NORMALLY BE PROVIDED FOR SERVICES LOCATED WITH GPR.

Rev	Date	Description	Drawn	C. No.

greenhatch group

Topographical Surveys Measured Building Survey
 Site Engineering 3D Laser Scanning
 Utility / CCTV Surveys Revit & BIM Models

Rowan House
 Duffield Road
 Little Eaton
 Derby
 DE21 5DR
 Tel (01332) 830044 Fax (01332) 830055
 admin@greenhatch-group.co.uk
 www.greenhatch-group.co.uk

33 Albion Newcastle 24 Riverside Studios 40-761 Kettlewell
 Unit 6, The Courtyard Albany Road Newcastle, Park 40-761 Kettlewell
 St Albans Hertfordshire AL3 6JA Newcastle-U-Tyne 20000 20000
 T. (01727) 854481 T. (01912) 736391 L. 0048 32 202 2292 www.greenhatch.gr

CLIENT
Willmott Dixon Construction Ltd

PROJECT
Plank Lane Water Orton Warwickshire

TITLE
Underground Utility Survey

SCALE A1@ 1: 500	DATE 04-05.05.17
DRAWN DS	QUALITY REF 12437

Level datum See note
Grid orientation See note
Job number 24216
Drawing No. **24216_UG** Rev. 0

Comments
This plan should only be used for its original purpose. Greenhatch Group accepts no responsibility for this plan if supplied to any party other than the original client.
All dimensions should be checked on site prior to design and construction.
Drainage information (where applicable) has been visually inspected from the surface and therefore should be treated as approximate only.

Notes:
Copyright Greenhatch Group, 2017

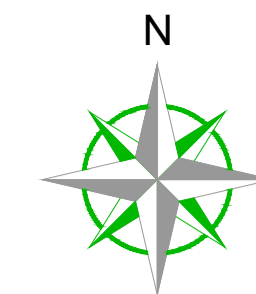

NOTES:
Only BT, Gas & Electric records available at time of survey.

UTILITY KEY	
	ELECTRIC CABLE
	ELECTRIC & COMM CABLE
	TRAFFIC SIGNAL CABLE
	TELECOMMS CABLE
	CABLE TELEVISION
	COMMUNICATION CABLE
	WATER PIPE
	GAS PIPE
	FOUL DRAINAGE
	CONTAMINATED SURFACE DRAINAGE
	SURFACE DRAINAGE
	COMBINED DRAINAGE
	PUMPING MAIN
	FUEL PIPE
	VENT PIPE
	OFFSET FILL PIPE
	GAUGE LINE
	VAPOUR RECOVERY
	SERVICE DUCTS
	HEATING PIPES
	UNIDENTIFIED SIGNAL
	END OF TRACE

ABBREVIATIONS			
AC	ASBESTOS CEMENT	MW	MONITORING WELL
AR	ASSUMED ROUTE	OH	OVERHEAD
BR	BASE BEND	OSA	OFF SURVEY AREA
BD	BACKDROP	PE	POLYETHYLENE
BR	BROOKHOLE	PL	PLASTIC
CI	CAST IRON	PVC	POLYVINYL CHLORIDE
CL	COVER LEVEL	RWP	RAIN WATER PIPE
CP	CONCRETE	SR	SONARWAY
CR	CABLE RISER	SI	STOP TAP
CP	CATCHMENT	SI	STOP TAP
DR	DUCTILE IRON	S/L	STEEL
DP	DOWN PIPE	S/S	SLICED VALVE
E	END OF TRACE	S/P	SOLE VENT PIPE
ER	EARTHING ROD	TR	TAKEN FROM RECORD
ER	ELECTRICITY POLE	TR	TRAFFIC LIGHT
FH	FIRE HYDRANT	TR	TRAFFIC LIGHT
GR	GROUND PENETRATING RADAR	UT	UNABLE TO FIND
GR	GLASS REINFORCED PLASTIC	UT	UNABLE TO SURVEY
GV	GAS VALVE	VC	VITRIFIED CLAY
H	HIGH LEVEL	VP	VENT PIPE
HC	HEAD OF CURB	WR	WAPOUR RECOVERY
IC	INSPECTION CHAMBER	WL	WATER LEVEL
IL	INVERT LEVEL	WM	WATER METER
L	LAMP POST	WO	WASH OUT VALVE
M	MANHOLE		
SWS	SURFACE WATER SEWER		
FWS	FOUL WATER SEWER		
CWS	COMBINED WATER SEWER		

DISCLAIMER

ELECTROMAGNETIC TECHNIQUES AND/OR GROUND PENETRATING RADAR HAVE BEEN USED IN THE LOCATION OF UNDERGROUND SERVICES AND THE RESULTS ARE NOT RELIABLE AND THEIR LOCATIONS SHOULD BE CARRIED OUT TO CONFIRM SERVICE IDENTIFICATION POSITIONS AND PARTICULAR DEPTHS WHERE THESE ARE CRITICAL. AS THERE IS NO REASONABLE EFFORT HAS BEEN MADE IN SEARCHING AVAILABLE RECORDS, DRAWINGS, THE COMPLETENESS OF THE UNDERGROUND SERVICES INFORMATION CANNOT BE GUARANTEED. THE METHOD OF SURVEY DOES NOT DIFFERENTIATE BETWEEN LIVE AND DEAD SERVICES AND AS SUCH ALL SERVICES SHOULD BE TREATED AS LIVE.

WHERE SERVICES ARE NON-METALLIC POSITIONS MAY BE TAKEN FROM RECORDS, TRENCH SCARES & SURFACE DETAIL.

WHERE QUOTED DEPTH ESTIMATIONS ARE GENERALLY TO THE CENTRE OF THE SERVICE, DEPTHS TO GRADUITY SEWERS AND BRANS ARE GENERALLY TO INVERT LEVELS UNLESS OTHERWISE STATED.

PIPE SIZES WHICH CANNOT BE OBTAINED BY VISUAL SURVEY ARE TAKEN FROM RECORD DRAWINGS OR MARKER PLATES WHERE AVAILABLE.

WHERE GROUND PENETRATING RADAR HAS BEEN USED IT WILL PRIMARILY HAVE BEEN TO IDENTIFY UNDERGROUND UTILITIES (UNDER TANKS ETC.) BUT CANNOT GUARANTEE TO HAVE LOCATED ALL SUCH ITEM. THE USE OF RADAR CAN BE LIMITED BOTH BY SOIL CONDITIONS AND ALSO BY SOIL TYPE. DEPTH ESTIMATES WOULD NOT NORMALLY BE PROVIDED FOR SERVICES LOCATED WITH GPR.

Rev	Date	Description	Drawn	C. No.

greenhatch group

- Topographical Surveys
- Measured Building Survey
- Site Engineering
- 3D Laser Scanning
- Utility / CCTV Surveys
- Revit & BIM Models

Rowan House
Duffield Road
Little Eaton
Derby
DE21 5DR

Tel (01332) 830044 Fax (01332) 830055
admin@greenhatch-group.co.uk
www.greenhatch-group.co.uk

<p>31 Albans Unit 6, The Courtyard St Albans Hertfordshire AL1 1EA t. (01727) 854881</p>	<p>Newcastle 24 Riverside Studios Armesyth Road Newcastle Bus Park Newcastle-U-Tyne NE4 7YL t. (0191) 736391</p>	<p>Round 4, Papevicka 91 40-761 Katowice Poland t. 0048 32 202 2292 www.greenhatch.pl</p>
--	--	---

CLIENT
Willmott Dixon Construction Ltd

PROJECT
Plank Lane Water Orton Warwickshire

TITLE
Underground Utility Survey

SCALE A1@ 1: 500	DATE 04-05.05.17
DRAWN DS	QUALITY REF 12437

Level datum	See note
Grid orientation	See note
Job number	24216

Drawing No 24216_UG	Rev. 0
-------------------------------	------------------

Comments
This plan should only be used for its original purpose. Greenhatch Group accepts no responsibility for this plan if supplied to any party other than the original client.
All dimensions should be checked on site prior to design and construction.
Drainage information (where applicable) has been visually inspected from the surface and therefore should be treated as approximate only.

Notes:

Copyright Greenhatch Group, 2017

