Order Decision

Inquiry held on 29 November 2017

by Barney Grimshaw BA DPA MRTPI(Rtd)

an Inspector appointed by the Secretary of State for Environment, Food and Rural Affairs

Decision date: 23 March 2018

Order Ref: ROW/3172071M

- This Order is made under Section 53(2)(b) of the Wildlife and Countryside Act 1981 (the 1981 Act) and is known as The Shropshire Council (Bridleway Additions, Parish of Richard's Castle) Modification Order 2015.
- The Order is dated 19 November 2015 and proposes to modify the Definitive Map and Statement for the area by adding 2 Bridleways linking two sections of Mitnell Lane, Richard's Castle as shown on the Order Maps and described in the Order Schedule.
- In accordance with Paragraph 8(2) of Schedule 15 to the 1981 Act I have given notice of my proposal to confirm the Order with modifications to omit one of the 2 bridleways to be added.

Summary of Decision: The Order is confirmed subject to the modifications proposed previously.

Procedural Matters

1. I held a public inquiry into this Order on Wednesday 29 November 2017 at Richard's Castle Village Hall. I made an unaccompanied site inspection on Tuesday 28 November when I was able to walk the whole of the Order routes. It was agreed by all parties at the inquiry that a further accompanied visit was not necessary although I did myself re-visit both ends of the Order routes after the inquiry.
2. In writing this decision I have found it convenient to refer to points marked on the Order Maps. I therefore attach copies of these maps.
3. The effect of this Order, if confirmed subject to the modifications I proposed in paragraph 40 of my interim decision issued on 19 December 2017, would be to add a single bridleway running along a field edge and linking two sections of Mitnell Lane, Richard's Castle (Points A-B, Order Map 1).
4. Following advertisement of the notice and deposit of the associated documents relating to the proposed modifications, one objection was received within the statutory period specified. However, this objection does not relate specifically to the proposed modifications but repeats an objection made to the original Order and does not contain any evidence that has not already been considered.

Conclusions

5. Bearing in mind the above, I conclude that the Order should now be confirmed subject to the modifications set out in paragraph 40 of my interim decision dated 19 December 2017.

Formal Decision

6. I confirm the Order subject to the following modifications:

Delete all references to Bridleway Addition – Order Map 2 from Parts I and II of the Schedule to the Order;

Delete Order Map 2.

Barney Grimshaw

Inspector

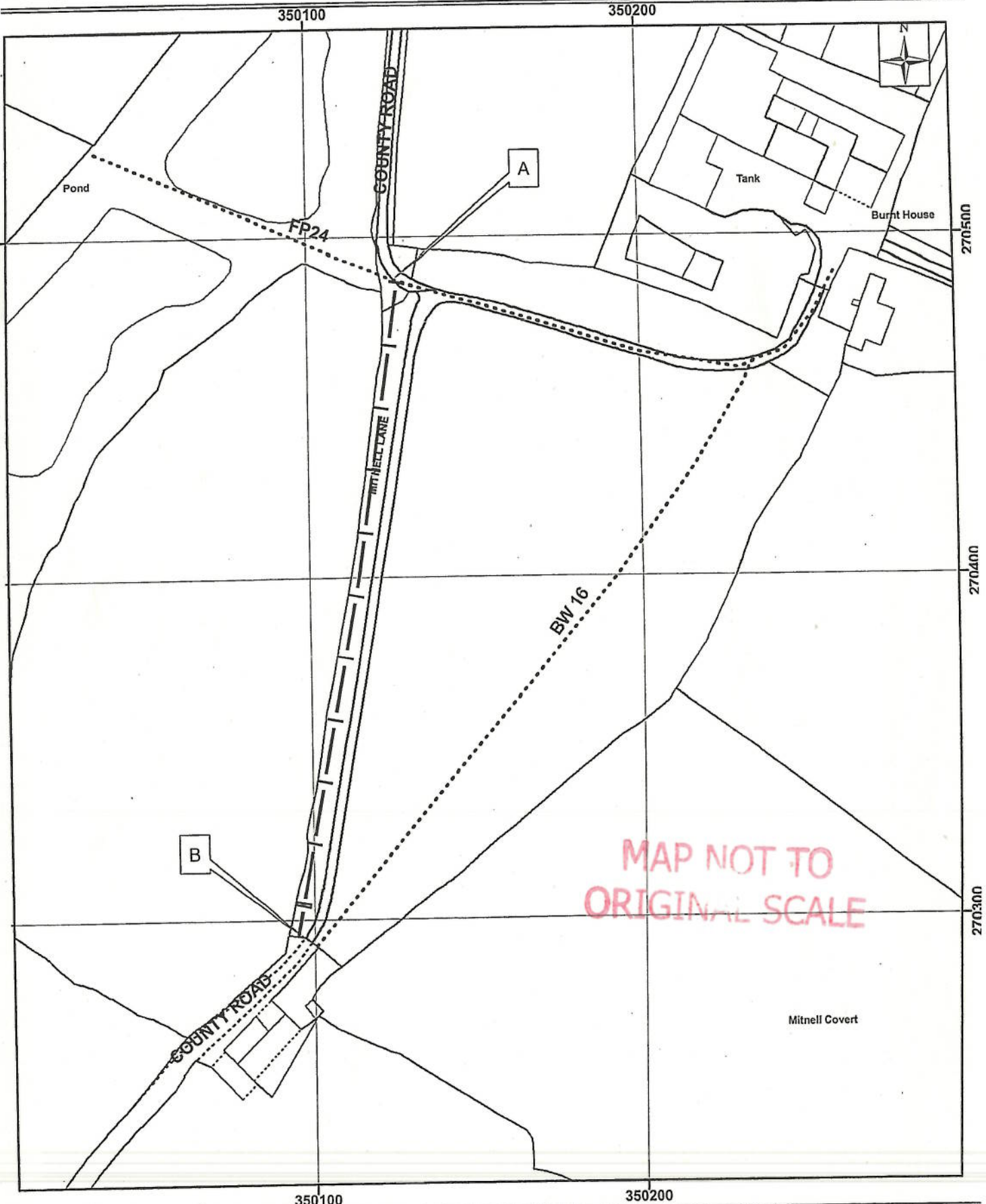

Key

Scale: 1:1,500

Route to be added
Existing to remain

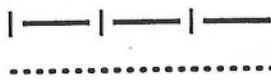

© Crown copyright (2015) Ordnance Survey
100049049
You are not permitted to copy, sub-licence, distribute
or sell any of this data to third parties in any form.

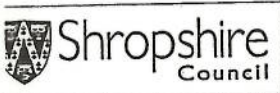

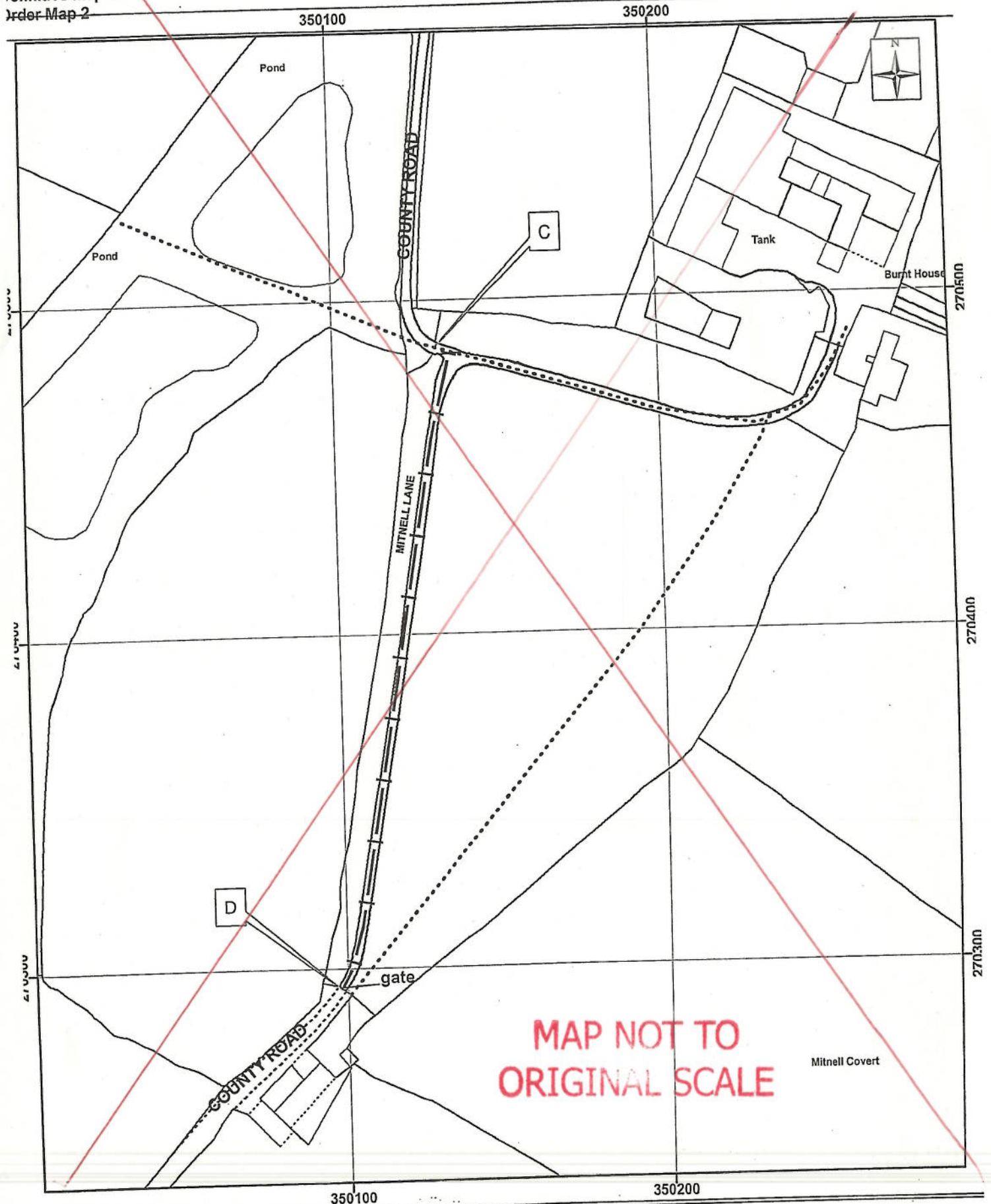

MAP NOT TO ORIGINAL SCALE

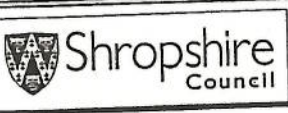

The Shirehall, Abbey Foregate
Shrewsbury, Shropshire, SY2 6ND

Key

Route to be added | — | — | —
Existing to remain
Scale: 1:1,500

© Crown copyright (2015) Ordnance Survey
100049049
You are not permitted to copy, sub-licence, distribute
or sell any of this data to third parties in any form.