

**NOTICE OF ORDER
HIGHWAYS ACT 1980
WILDLIFE AND COUNTRYSIDE ACT 1981
SECTION 53**

Hampshire County Council

The Hampshire (Basingstoke and Deane Borough No. 4) (Parish of Overton – Part of Bridleway No. 26) Public Path Diversion and Definitive Map and Statement Modification Order 2017

Notice is hereby given that the above referenced Order has been submitted to the Secretary of State for Environment, Food and Rural Affairs for determination. An Inspector will be appointed by the Secretary of State to determine the Order.

The **start date** for the above Order is **06 March 2018**.

Consideration of the Order will take the form of exchanges of statements of case and comments on statements of case.

The effect of the Order, if confirmed without modifications, will be to divert the public Bridleway running from SU 5158 4729 and proceeding north-westwards, along roughly metalled farm track to SU 5150 4743, to a line, 3 metres wide running from SU 5158 4729 proceeding generally north-westwards before curving north-eastwards via SU 5148 7472 to SU 5150 4743, as shown on the Order map. A total length of 213 metres.

Any queries relating to this Order should be referred to Clive Richards at The Planning Inspectorate, Rights of Way Section, Room 3/G Hawk Wing, Temple Quay House, 2 The Square, Temple Quay, Bristol, BS1 6PN. Telephone: 0303 444 5502. Email: clive.richards@pins.gsi.gov.uk. Please quote reference number ROW/3191733 on all correspondence.

Any person wishing to view the statements of case and other documents relating to this Order may do so by appointment at the offices of Hampshire County Council, The Castle, Winchester, Hampshire SO23 8UL, between the hours of 9:00am and 4:00pm. Council Contact: Ms Rohan Seeliger-Morley, tel: 01962 846981.

Timetable for sending in statements of case and comments

Within 2 weeks of the start date [by 20 March 2018]

The Order Making Authority must ensure their statement of case is received by the Secretary of State. As soon as possible after the deadline, the Secretary of State will send a copy (excluding copies of any supporting documents - these will be available to view at the Authority's offices) to everyone who has made an objection or representation, the applicant and any other person who has written to us in respect of the Order.

Within 8 weeks of the start date [by 01 May 2018]

Everyone who has made an objection or representation or any other written representation must ensure their statement of case is received by the Secretary of State. As soon as possible after the deadline, the Secretary of State will send full

copies to the Authority. Copies (excluding copies of any supporting documents - these will be available to view at the Authority's offices) will also be sent to the applicant, every person who has made an objection or representation and any other person who has written to us in respect of the Order.

Within the same period the applicant (if applicable) must ensure their statement of case is received by the Secretary of State. As soon as possible after the deadline, Secretary of State will send a full copy to the Authority. Copies will also be sent to everyone who has made an objection or representation and any other person who has written to us in respect of the Order (excluding copies of any supporting documents - these will be available to view at the Authority's offices).

Within 14 weeks of the start date [by 12 June 2018]

Everyone who has made an objection or representation, the Authority, the applicant (if applicable) and anyone who has written to us in respect of the Order must ensure that their comments on any or every other statement of case is received by the Secretary of State. As soon as possible after the deadline, the Secretary of State will send copies of these comments to everyone else.

Any other person wishing to make representations in writing to the Secretary of State in respect of the above Order(s) must do so in line with the timetable set out above.

In fairness to the other parties everyone should keep to the timetable to ensure that statements of case and comments are received on time. Late documents will be returned.

We cannot accept any libellous, racist or abusive comments. Any documents containing such comments will be returned.

Notice of order for w/r

HAMPSHIRE COUNTY COUNCIL

**HIGHWAYS ACT 1980
WILDLIFE AND COUNTRYSIDE ACT 1981**

**THE HAMPSHIRE (BASINGSTOKE AND DEANE BOROUGH NO. 4)
(PARISH OF OVERTON – PART OF BRIDLEWAY NO. 26)
PUBLIC PATH DIVERSION AND DEFINITIVE MAP AND STATEMENT
MODIFICATION ORDER 2017**

This Order is made by Hampshire County Council ("the authority") under Section 119 of the Highways Act 1980 ("the 1980 Act") because it appears to the authority that in the interests of the owner of the land crossed by the bridleway described in paragraph 1 of this order it is expedient that the line of the bridleway should be diverted.

This Order is also made under section 53A(2) of the Wildlife and Countryside Act 1981 ("the 1981 Act") because it appears to the authority that the Hampshire Definitive Map and Statement of Public Rights of Way (dated 15th December 2007) require modification in consequence of the occurrence of an event specified in section 53(3)(a)(i) of the 1981 Act, namely, the diversion (as authorised by this order) of a highway shown or required to be shown in the map and statement.

The owners of the land crossed by the bridleway, have agreed to defray any compensation which becomes payable in consequence of the coming into force of this Order and any expenses which are incurred in bringing the new bridleway into a fit condition for use by the public.

Basingstoke and Deane Borough Council has been consulted as required by Section 120(2) of the 1980 Act.

BY THIS ORDER:

1. The public right of way over the land situated at Overton and shown by a bold continuous line on the map contained in this Order and described in Part 1 of the Schedule to this Order shall be stopped up when Hampshire County Council has certified that the work necessary to bring the site of the new bridleway, specified in paragraph 3 below, into a fit condition for use by the public has been carried out, and thereupon the Hampshire Definitive Map of Public Rights of Way (dated 15th December 2007) shall be modified by deleting from it that public right of way.
2. Notwithstanding this Order all Statutory Undertakers shall have the same rights over the land referred to in paragraph 1 as they have hitherto enjoyed.

3. There shall be from the date of confirmation of this Order a public bridleway over the land situate at Overton described in Part 2 of the Schedule and shown by a bold broken line on the map contained in this Order, and thereupon the Hampshire Definitive Map of Public Rights of Way (dated 15th December 2007) shall be modified by adding that bridleway to it.
- 3A. The Hampshire Definitive Statement of Public Rights of Way (dated 15th December 2007) shall be modified as described in Part 4 of the Schedule to this Order.

SCHEDULE

PART 1

DESCRIPTION OF SITE OF EXISTING RIGHTS OF WAY

From SU 5158 4729 to SU 5150 4743

That part of Bridleway No.26 in the Parish of Overton, District of Basingstoke and Deane that commences at Point A on the map and proceeds north-westwards, along roughly metalled farm track to Point C.

A total length of 160 metres.

PART 2

DESCRIPTION OF SITE OF NEW RIGHT OF WAY

From SU 5158 4729 to SU 5150 4743 via SU 5148 4742

A Bridleway, 3 metres wide, in the Parish of Overton, District of Basingstoke and Deane, that commences at Point A on the map and proceeds generally north-westwards before curving north-eastwards to a junction with Footpath 15 at Point B, then north-eastwards for approximately 28 metres to re-join Bridleway 26 at Point C.

A total length of 213 metres.

NOTE: ALL LENGTHS ARE APPROXIMATE

PART 3
LIMITATIONS AND CONDITIONS

None

PART 4
MODIFICATION OF DEFINITIVE STATEMENT

Variation of particulars of path or way

Overton Bridleway 26

Add:

"The bridleway follows a diverted route between SU 5158 4729 and SU 5150 4743.
3 metres wide rough metalled surface between SU 5158 4729 and SU 5150 4743."

Overton Footpath 15

Delete:

"SU 5150 4743"

Add:

"SU 5148 4742
"That part of Footpath 15 which ran between SU 5148 4742 and SU 5150 4743 is now recorded as part of Overton Bridleway 26."

GIVEN this 13th day of June 2017

THE COMMON SEAL of HAMPSHIRE)
COUNTY COUNCIL was hereunto)
affixed in the presence of:-)

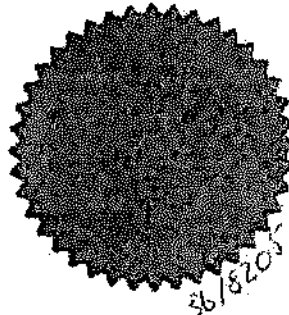

Authorised Signatory

[Handwritten signature]

HAMPSHIRE COUNTY COUNCIL

MAP REFERRED TO IN

THE HAMPSHIRE (BASINGSTOKE AND DEANE BOROUGH NO. 4)
(PARISH OF OVERTON - PART OF BRIDLEWAY NO. 26)

PUBLIC PATH DIVERSION AND DEFINITIVE MAP AND STATEMENT MODIFICATION ORDER 2017

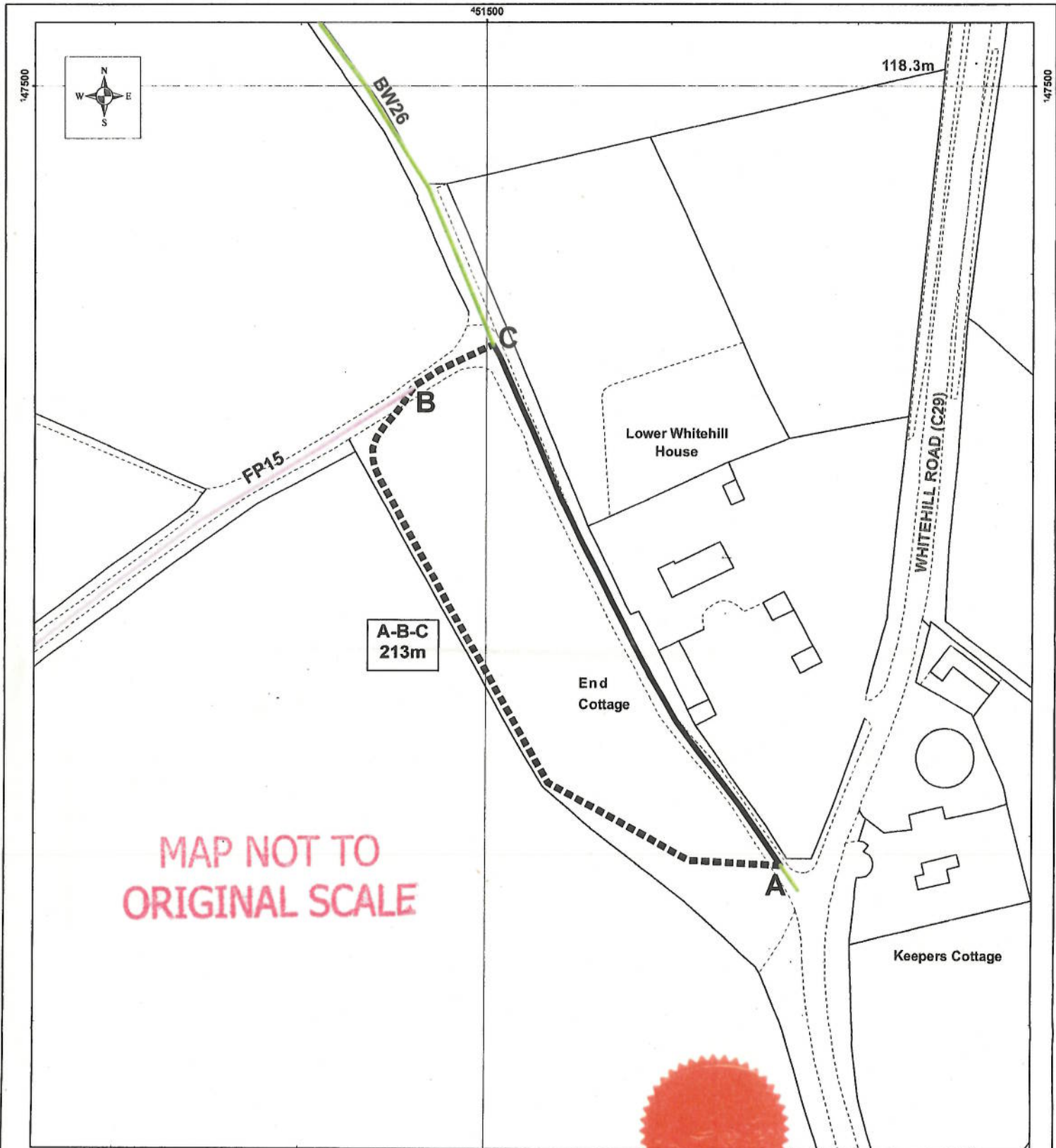

MAP NOT TO ORIGINAL SCALE

SCALE 1:1,000

LEGEND

BRIDLEWAY TO BE DELETED:-



NEW BRIDLEWAY TO BE ADDED TO THE MAP:-



EXISTING FOOTPATH TO BE RETAINED:-



EXISTING BRIDLEWAY TO BE RETAINED:-



MAP No.1617 PRODUCED FROM DIGITAL DATA SUPPLIED BY ORDNANCE SURVEY

THE COMMON SEAL OF HAMPSHIRE COUNTY COUNCIL WAS HEREUNTO AFFIXED IN THE PRESENCE OF:-

AUTHORISED SIGNATORY

DATE 13th June 2017

REPRODUCED FROM THE O.S. MAPPING WITH THE PERMISSION OF THE CONTROLLER OF HMSO © CROWN. UNAUTHORISED REPRODUCTION INFRINGES © CROWN AND MAY LEAD TO PROSECUTION OR CIVIL PROCEEDINGS. HCC LICENCE No.100019180 DATE (19.05.17)

KAREN MURRAY,
DIRECTOR OF CULTURE, COMMUNITIES AND BUSINESS SERVICES, WINCHESTER