

HSL12 ← → HSL13A

**Plan**  
Scale 1:10,000 @ A1

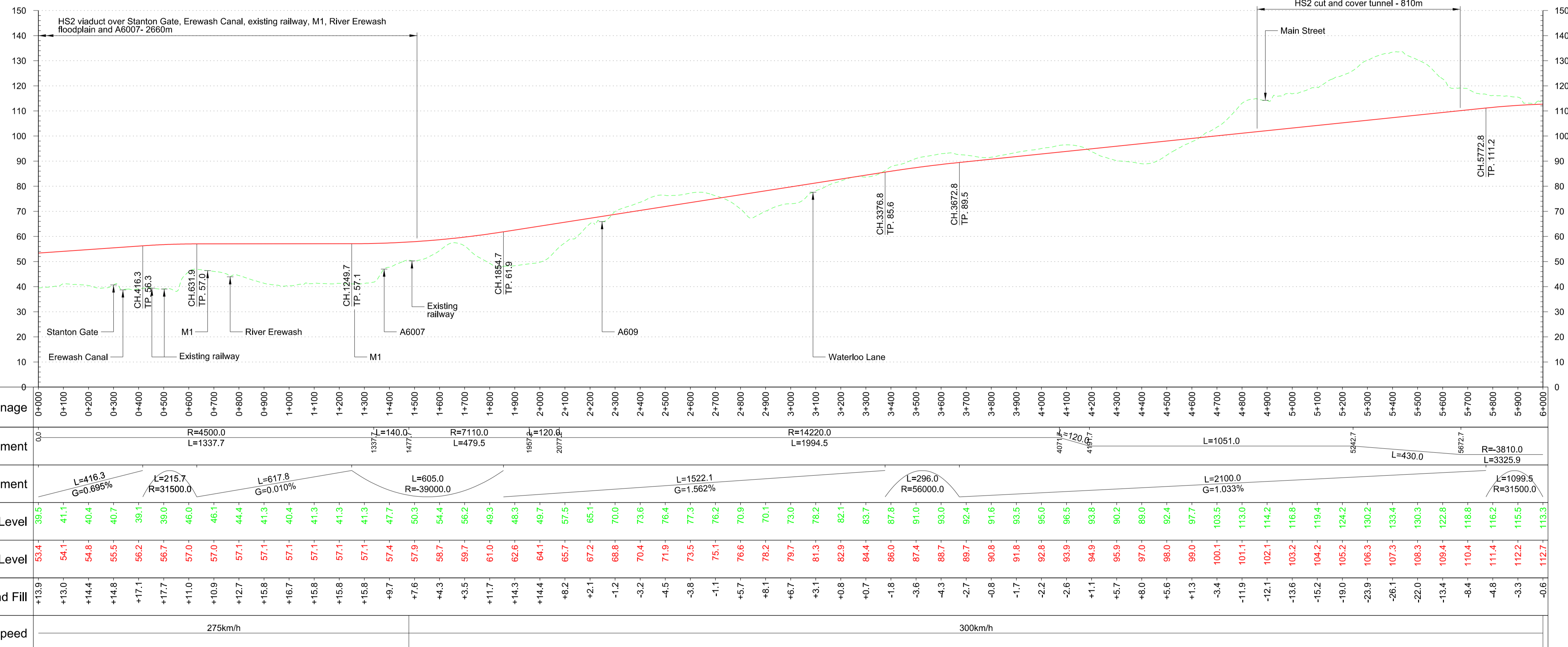

**Profile**  
Scale H:1:10,000 V:1:1000 @ A1

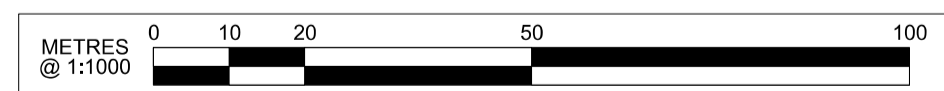
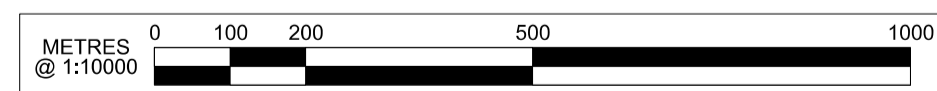

P02	Client's Comments Addressed	JV	AR	MM	11/07/17	11/07/17	11/07/17
P01	First Issue	JV	AR	MM	28/06/17	28/06/17	28/06/17
Rev	Description	Drawn	Checked	Con App	HS2 App		

HS2 accepts no responsibility for any circumstances which arise from the reproduction of this document after alteration, amendment or abbreviation or if it is issued in part or issued incompletely in any way.

© Crown Copyright and database right 2017. All rights reserved. Ordnance Survey Licence number 100049190

© Crown Copyright material is reproduced with the permission of Land Registry under delegated authority from the Controller of HMSO.

This material was last updated on 2017 and may not be copied, distributed, sold or published without the formal permission of Land Registry. Only an official copy of a title plan or register obtained from the Land Registry may be used for legal or other official purposes.

Scale with caution as distortion can occur.

**Key Environmental Features Legend**

World Heritage Site	Scheduled Monuments
Ramsar	Registered Parks and Gardens
Special Areas of Conservation	Historical Battlefields
Special Protection Areas	Active and/or Authorised Landfill
SSSI	Historical Landfill
National Nature Reserves	Flood Zones
Area of Outstanding Natural Beauty	Listed Building Grade I
National Park	Listed Building Grade II*
Major Development Sites	Listed Building Grade II
Additional Development Sites	

**Legend**

Track Centrelines	Viaduct	Engineering Earthworks
Tunnel	Railway Cutting	Railway Embankment
Existing Railway Connection	HS2 Connection	HS2 Depot/Station Operational Boundary
Fully Retained Cutting/Fill	Major Contour	
Ground Profile	Track Profile	
Minor Contour	Node	

Registered in England  
Registration No. 06791686  
Registered office:  
2 Snow Hill,  
Queensway,  
Birmingham, B4 6GA

Creator/Organiser  
**Mott MacDonald**

Zone	Leeds Leg Central	Project/Contract	West Midlands to Leeds Route
Design Stage	Post-Consultation	Discipline/Function	Railway Track
Drawing Title	HSL13A	Drawn	JV
	2017 Preferred Route	Checked	AR
	Sheet 1 of 4	Approved	MM
		Date	07/06/2017
		Scale	1:10000
		Size	A1
		Drawing No.	C321-MMD-RT-DPP-120-591301
		Rev.	P02