

Notice of variation and consolidation with introductory note

The Environmental Permitting (England & Wales) Regulations 2010

Patrick Dean Limited
Boothby Heath Farm
Old Rocket Site
Boothby Graffoe
Lincoln
LN5 0AS

Variation application number

EPR/BT4150IX/V004

Permit number

EPR/BT4150IX

Boothby Heath Farm

Permit number EPR/BT4150IX

Introductory note

This introductory note does not form a part of the notice.

Under the Environmental Permitting (England & Wales) Regulations 2010 (schedule 5, part 1, paragraph 19) a variation may comprise a consolidated permit reflecting the variations and a notice specifying the variations included in that consolidated permit.

Schedule 1 of the notice specifies the conditions that have been varied and schedule 2 comprises a consolidated permit which reflects the variations being made. Only the variations specified in schedule 1 are subject to a right of appeal.

Boothby Heath Farm is a farrow to finish pig unit with tree lined boundaries and surrounded by arable land. The farm is operated by Patrick Dean Limited. It is located near Boothby Graffoe, Lincoln, Lincolnshire and is approximately centred on National Grid Reference TF 00646 60278.

This variation authorises the following changes:

- an increase in pig places over 30kg from 3900 to 5380
- increase in sows' places from 738 to 794
- construction of 2 new finisher houses, which are marked H1 and H2 on the site layout plan. These 2 new houses do not require extra land but rather replace the original building H. Each building will have the capacity to house 960 pigs from 40kg to slaughter.

These new buildings will be fully controlled SKOV fan ventilated with an air speed of 11m/s. The height of discharge will be 6.5m. They will have fully slatted floors and a dry pump for frequent slurry removal from the under-slat storage. The depth of the slurry tank is 3 blocks deep with an effective depth below base of lintel of 590mm.

The farm consists of 18 houses represented by letters A – R and will house a total of 8822 pigs including:

- sows - 794
- weaners (7 - 15kg) - 930
- growers (15 – 30kg) - 1710
- finishers (>30kg) and unserved gilts - 5380
- boars – 8.

Nursery building P no longer exists and has been replaced by nursery building R.

The rest of the installation is unchanged and continues to be operated as follows.

Dirty water from the yards and the contents of footbath is added to the slurry store. Roof water is collected via gutters and down pipes, and is diverted into the soakaway.

There are two middens for temporary manure storage at the unit, with the manure being removed on a weekly basis and there is also a dirty water lagoon.

All solid manure is spread on farm-owned land in accordance with the Manure Management Plan. Carcasses are incinerated on site using a low capacity incinerator with Animal Health Approval.

Low energy lighting is used throughout and heating is applied only where it is needed. Nipple drinkers are used on site, water consumption is monitored and all feed rations are brought in with diets formulated to match the growth stage of the pigs.

Trees planted around the perimeter of the unit provide visual screening and help minimise dispersion of dust. Odour is minimised by keeping pens as clean as possible and ammonia production is reduced by optimising protein levels in the diet and minimising losses from slurry and manure.

The schedules specify the changes made to the permit.

The status log of a permit sets out the permitting history, including any changes to the permit reference number.

Status log of the permit		
Description	Date	Comments
Application BT4150IX received	Duly made 27/02/07	
Permit determined	29/06/07	
Application reference EPR/BT4150IX/V002 (variation)	27/01/14	Application to vary the permit to increase numbers of pig places, construct new housing, slurry containment and update the permit to modern conditions to include the requirements of IED.
Additional information received	27/01/14	Confirmation of site boundary and details regarding ammonia modelling.
Additional information received	14/04/14	Confirmation of emission points and type from pig housing.
Additional information received	14/04/14	Confirmation of maximum protein content of feed stock for each animal type. Weaners 17.44%, Growers 17.24%, Finishers 15.54%, Gilts 13.95%, Dry sows 11.3% and Farrowing sows 14.6%.
Variation issued EPR/BT4150IX/V002	17/04/14	Varied and consolidated permit issued in modern condition format.
Application EPR/BT4150IX/V003	Not duly made 09/05/16	Application to vary the permit to increase number of pig places and construct a new finisher house for pigs from 40kg to slaughter.
Application EPR/BT4150IX/V003	Returned 29/06/16	Application returned as operator did not provide relevant information in relation to the not duly made letter.
Application EPR/BT4150IX/V004 (variation and consolidation)	Duly made 10/05/17	Application to vary and update the permit to modern conditions.
Additional information received	10/05/17	Response to Request for Information providing: <ul style="list-style-type: none"> • Bioaerosol Risk Assessment, • Updated Site Drainage plan and Site Layout Plans.
Schedule 5 notice response received	14/06/17	Responses to questions 1, 2, and 3 in relation to the following: <ul style="list-style-type: none"> • Odour Management Plan • Noise Management Plan • Ammonia reduction measures to meet the new BAT AELs for new pig housing.
Additional information received	17/07/17	Response to Request for Information confirming the following: <ul style="list-style-type: none"> • feed protein content for each animal type for 2017. Weaners 17.43%, Growers 16.82%, Finishers 15.49%, Gilts 13.54%,

Status log of the permit		
Description	Date	Comments
		Dry Sow 11.29%, and Lactating sows 14.59% <ul style="list-style-type: none"> • replacement of nursery building P by nursery building R.
Variation determined EPR/BT4150IX (Billing reference: PP3538YB)	31/07/17	Varied and consolidated permit issued in modern condition format.

End of introductory note

Notice of variation and consolidation

The Environmental Permitting (England and Wales) Regulations 2010

The Environment Agency in exercise of its powers under regulation 20 of the Environmental Permitting (England and Wales) Regulations 2010 varies and consolidates

Permit number

EPR/BT4150IX

Issued to

Patrick Dean Limited ("the operator")

whose registered office is

The Estate Office

East Mere

Bracebridge Heath

Lincoln

LN4 2HU

company registration number 00505434

to operate an installation at

Boothby Heath Farm

Old Rocket Site

Boothby Graffoe

Lincoln

LN5 0AS

to the extent set out in the schedules.

The notice shall take effect from 31/07/2017

Name	Date
Claire Roberts	31/07/2017

Authorised on behalf of the Environment Agency

Schedule 1

All conditions have been varied by the consolidated permit EPR/BT4150IX as a result of the application made by the operator.

Schedule 2 – consolidated permit

Consolidated permit issued as a separate document.

Permit

The Environmental Permitting (England and Wales) Regulations 2010

Permit number

EPR/BT4150IX

This is the consolidated permit referred to in the variation and consolidation notice for application EPR/BT4150IX/V004 authorising,

Patrick Dean Limited (“the operator”),

whose registered office is

**The Estate Office
East Mere
Bracebridge Heath
Lincoln
LN4 2HU**

company registration number 00505434

to operate an installation at

**Boothby Heath Farm
Old Rocket Site
Boothby Graffoe
Lincoln
LN5 0AS**

to the extent authorised by and subject to the conditions of this permit.

Name	Date
Claire Roberts	31/07/2017

Authorised on behalf of the Environment Agency

Conditions

1 Management

1.1 General management

- 1.1.1 The operator shall manage and operate the activities:
- (a) in accordance with a written management system that identifies and minimises risks of pollution, including those arising from operations, maintenance, accidents, incidents, non-conformances, closure and those drawn to the attention of the operator as a result of complaints; and
 - (b) using sufficient competent persons and resources.
- 1.1.2 Records demonstrating compliance with condition 1.1.1 shall be maintained.
- 1.1.3 Any person having duties that are or may be affected by the matters set out in this permit shall have convenient access to a copy of it kept at or near the place where those duties are carried out.

1.2 Energy efficiency

- 1.2.1 The operator shall:
- (a) take appropriate measures to ensure that energy is used efficiently in the activities;
 - (b) review and record at least every four years whether there are suitable opportunities to improve the energy efficiency of the activities; and
 - (c) take any further appropriate measures identified by a review.

1.3 Efficient use of raw materials

- 1.3.1 The operator shall:
- (a) take appropriate measures to ensure that raw materials and water are used efficiently in the activities;
 - (b) maintain records of raw materials and water used in the activities;
 - (c) review and record at least every four years whether there are suitable alternative materials that could reduce environmental impact or opportunities to improve the efficiency of raw material and water use; and
 - (d) take any further appropriate measures identified by a review.

1.4 Avoidance, recovery and disposal of wastes produced by the activities

- 1.4.1 The operator shall take appropriate measures to ensure that:
- (a) the waste hierarchy referred to in Article 4 of the Waste Framework Directive is applied to the generation of waste by the activities;
 - (b) any waste generated by the activities is treated in accordance with the waste hierarchy referred to in Article 4 of the Waste Framework Directive; and
 - (c) where disposal is necessary, this is undertaken in a manner which minimises its impact on the environment.
- 1.4.2 The operator shall review and record at least every four years whether changes to those measures should be made and take any further appropriate measures identified by a review.

2 Operations

2.1 Permitted activities

2.1.1 The operator is only authorised to carry out the activities specified in schedule 1 table S1.1 (the “activities”).

2.2 The site

2.2.1 The activities shall not extend beyond the site, being the land shown edged in green on the site plan at schedule 7 to this permit.

2.3 Operating techniques

2.3.1 The activities shall, subject to the conditions of this permit, be operated using the techniques and in the manner described in the documentation specified in schedule 1, table S1.2, unless otherwise agreed in writing by the Environment Agency.

2.3.2 If notified by the Environment Agency that the activities are giving rise to pollution, the operator shall submit to the Environment Agency for approval within the period specified, a revision of any plan or other documentation (“plan”) specified in schedule 1, table S1.2 or otherwise required under this permit which identifies and minimises the risks of pollution relevant to that plan, and shall implement the approved revised plan in place of the original from the date of approval, unless otherwise agreed in writing by the Environment Agency.

2.3.3 The operator shall maintain and implement a system to record the number of animal places and animal movements.

2.3.4 Any raw materials or fuels listed in schedule 2 table S2.1 shall conform to the specifications set out in that table.

2.3.5 The operator shall take appropriate measures in off-site disposal or recovery of solid manure or slurry to prevent, or where this is not practicable, to minimise pollution.

2.3.6 The operator shall:

- (a) maintain and implement a manure management plan;
- (b) review and record at least every four years whether changes to the plan should be made; and
- (c) make any appropriate changes to the plan identified by the review.

2.3.7 The operator shall ensure that where waste produced by the activities is sent to a relevant waste operation, that operation is provided with the following information, prior to the receipt of the waste:

- (a) the nature of the process producing the waste;
- (b) the composition of the waste;
- (c) the handling requirements of the waste;
- (d) the hazardous property associated with the waste, if applicable; and
- (e) the waste code of the waste.

2.3.8 The operator shall ensure that where waste produced by the activities is sent to a landfill site, it meets the waste acceptance criteria for that landfill.

3 Emissions and monitoring

3.1 Emissions to water, air or land

- 3.1.1 There shall be no point source emissions to water, air or land except from the sources and emission points listed in schedule 3 tables S3.1 and S3.2.
- 3.1.2 The limits given in schedule 3 shall not be exceeded.
- 3.1.3 Periodic monitoring shall be carried out at least once every 5 years for groundwater and 10 years for soil, unless such monitoring is based on a systematic appraisal of the risk of contamination.

3.2 Emissions of substances not controlled by emission limits

- 3.2.1 Emissions of substances not controlled by emission limits (excluding odour) shall not cause pollution. The operator shall not be taken to have breached this condition if appropriate measures, including, but not limited to, those specified in any approved emissions management plan, have been taken to prevent or where that is not practicable, to minimise, those emissions.
- 3.2.2 The operator shall:
 - (a) if notified by the Environment Agency that the activities are giving rise to pollution, submit to the Environment Agency for approval within the period specified, an emissions management plan which identifies and minimises the risks of pollution from emissions of substances not controlled by emission limits; and
 - (b) implement the approved emissions management plan, from the date of approval, unless otherwise agreed in writing by the Environment Agency.
- 3.2.3 All liquids in containers, whose emission to water or land could cause pollution, shall be provided with secondary containment, unless the operator has used other appropriate measures to prevent or where that is not practicable, to minimise, leakage and spillage from the primary container.

3.3 Odour

- 3.3.1 Emissions from the activities shall be free from odour at levels likely to cause pollution outside the site, as perceived by an authorised officer of the Environment Agency, unless the operator has used appropriate measures, including, but not limited to, those specified in any approved odour management plan, to prevent or where that is not practicable to minimise the odour.

3.4 Noise and vibration

- 3.4.1 Emissions from the activities shall be free from noise and vibration at levels likely to cause pollution outside the site, as perceived by an authorised officer of the Environment Agency, unless the operator has used appropriate measures, including, but not limited to, those specified in any approved noise and vibration management plan to prevent or where that is not practicable to minimise the noise and vibration.

3.5 Monitoring

- 3.5.1 The operator shall, unless otherwise agreed in writing by the Environment Agency, undertake the monitoring specified in the following tables in schedule 3 to this permit:
 - (a) point source emissions specified in tables S3.1 and S3.2

3.6 Pests

- 3.6.1 The activities shall not give rise to the presence of pests which are likely to cause pollution, hazard or annoyance outside the boundary of the site. The operator shall not be taken to have breached this condition if appropriate measures, including, but not limited to, those specified in any approved pests management plan, have been taken to prevent or where that is not practicable, to minimise the presence of pests on the site.
- 3.6.2 The operator shall:
- (a) if notified by the Environment Agency, submit to the Environment Agency for approval within the period specified, a pests management plan which identifies and minimises risks of pollution, hazard or annoyance from pests;
 - (b) implement the pests management plan, from the date of approval, unless otherwise agreed in writing by the Environment Agency.

4 Information

4.1 Records

- 4.1.1 All records required to be made by this permit shall:
- (a) be legible;
 - (b) be made as soon as reasonably practicable;
 - (c) if amended, be amended in such a way that the original and any subsequent amendments remain legible, or are capable of retrieval; and
 - (d) be retained, unless otherwise agreed in writing by the Environment Agency, for at least 6 years from the date when the records were made, or in the case of the following records until permit surrender:
 - (i) off-site environmental effects; and
 - (ii) matters which affect the condition of the land and groundwater.
- 4.1.2 The operator shall keep on site all records, plans and the management system required to be maintained by this permit, unless otherwise agreed in writing by the Environment Agency.

4.2 Reporting

- 4.2.1 The operator shall send all reports and notifications required by the permit to the Environment Agency using the contact details supplied in writing by the Environment Agency.
- 4.2.2 A report or reports on the performance of the activities over the previous year shall be submitted to the Environment Agency by 31 January (or other date agreed in writing by the Environment Agency) each year. The report(s) shall include as a minimum:
- (a) the performance parameters set out in schedule 4 table S4.1 using the forms specified in table S4.2 of that schedule.
- 4.2.3 The operator shall, unless notice under this condition has been served within the preceding four years, submit to the Environment Agency, within six months of receipt of a written notice, a report assessing whether there are other appropriate measures that could be taken to prevent, or where that is not practicable, to minimise pollution.

4.3 Notifications

4.3.1 In the event:

- (a) that the operation of the activities gives rise to an incident or accident which significantly affects or may significantly affect the environment, the operator must immediately—
 - (i) inform the Environment Agency,
 - (ii) take the measures necessary to limit the environmental consequences of such an incident or accident, and
 - (iii) take the measures necessary to prevent further possible incidents or accidents;
- (b) of a breach of any permit condition the operator must immediately—
 - (i) inform the Environment Agency, and
 - (ii) take the measures necessary to ensure that compliance is restored within the shortest possible time;
- (c) of a breach of permit condition which poses an immediate danger to human health or threatens to cause an immediate significant adverse effect on the environment, the operator must immediately suspend the operation of the activities or the relevant part of it until compliance with the permit conditions has been restored.

4.3.2 Any information provided under condition 4.3.1 shall be confirmed by sending the information listed in schedule 5 to this permit within the time period specified in that schedule.

4.3.3 Where the Environment Agency has requested in writing that it shall be notified when the operator is to undertake monitoring and/or spot sampling, the operator shall inform the Environment Agency when the relevant monitoring and/or spot sampling is to take place. The operator shall provide this information to the Environment Agency at least 14 days before the date the monitoring is to be undertaken.

4.3.4 The Environment Agency shall be notified within 14 days of the occurrence of the following matters, except where such disclosure is prohibited by Stock Exchange rules:

Where the operator is a registered company:

- (a) any change in the operator's trading name, registered name or registered office address; and
- (b) any steps taken with a view to the operator going into administration, entering into a company voluntary arrangement or being wound up.

Where the operator is a corporate body other than a registered company:

- (a) any change in the operator's name or address; and
- (b) any steps taken with a view to the dissolution of the operator.

In any other case:

- (a) the death of any of the named operators (where the operator consists of more than one named individual);
- (b) any change in the operator's name(s) or address(es); and
- (c) any steps taken with a view to the operator, or any one of them, going into bankruptcy, entering into a composition or arrangement with creditors, or, in the case of them being in a partnership, dissolving the partnership.

4.3.5 Where the operator proposes to make a change in the nature or functioning, or an extension of the activities, which may have consequences for the environment and the change is not otherwise the subject of an application for approval under the Regulations or this permit:

- (a) the Environment Agency shall be notified at least 14 days before making the change; and

(b) the notification shall contain a description of the proposed change in operation.

4.3.6 The Environment Agency shall be given at least 14 days' notice before implementation of any part of the site closure plan.

4.4 Interpretation

4.4.1 In this permit the expressions listed in schedule 6 shall have the meaning given in that schedule.

4.4.2 In this permit references to reports and notifications mean written reports and notifications, except where reference is made to notification being made "immediately", in which case it may be provided by telephone.

Schedule 1 – Operations

Table S1.1 activities		
Activity listed in Schedule 1 of the EP Regulations	Description of specified activity	Limits of specified activity
Section 6.9 A(1)(a)(ii) Rearing of pigs intensively in an installation with more than 2,000 places for production pigs (over 30 kg)	Rearing of pigs intensively in an installation with a capacity for 5388 production pig (over 30kg) places, including 8 boars.	Keeping of production pigs (over 30kg), including from receipt of raw materials and fuels on to the site to finished pigs and associated wastes being removed from site.
Section 6.9 A(1)(a)(iii) Rearing of pigs intensively in an installation with more than 750 places for sows	Rearing of pigs intensively in an installation with a capacity for 794 sows.	Keeping of sows for production of piglets, from receipt of raw materials and fuels on to the site to removal of sows and associated wastes from site.
Directly Associated Activity	Description of specified activity	Limits of specified activity
Rearing of pigs (up to 30 kg)	Rearing of pigs to 30kg (piglets and weaners) 2640 places.	From receipt of pigs and receipt of raw materials and fuels on to the site up to pigs reaching 30kg and removal of pigs and associated wastes from site
Carcass incineration	Operation of an Incinerator for carcass disposal Animal and Plant Health Agency (APHA) approved < 50 kg/hr.	From receipt of raw materials, fuels and input of carcasses to release of combustion products to air and associated wastes removed from site.

Table S1.2 Operating techniques		
Description	Parts	Date Received
Application EPR/BT4150IX/A001	The responses to sections B2.3.1, B2.3.2, B2.3.3, B2.5.1, B2.5.2, B2.5.3, B2.7.1 and B2.7.2 in the Application.	27/02/07
Application EPR/BT4150IX/V002	Response to Parts C2 and C3 of the application form and supporting documents including Doc 5 revised site layout and drainage plan, Doc 8 ventilation and flooring, revised noise management plan and odour management plan.	27/01/14
Additional information EPR/BT4150IX/V002	Response to Request for Information: confirmation whether to consolidate permit (Part C2, 2c), provide a revised site boundary and provide ADMS 4.2 APL files.	27/01/14
Additional information EPR/BT4150IX/V002	Response to Request for Information: Confirmation of emission points and type from pig housing.	14/04/14
Additional information EPR/BT4150IX/V002	Response to Request for Information: confirmation of maximum protein content of feed stock for each animal type. Weaners 17.44%, Growers 17.24%, Finishers 15.54%, Gilts 13.95%, Dry sows 11.3% and Farrowing sows 14.6%.	14/04/14
Application EPR/BT4150IX/V004	Response to Part C3.5 of the application form and referenced supporting information.	15/02/17
Additional information requested 25/04/17 EPR/BT4150IX/V004	Response to Request for Information providing: <ul style="list-style-type: none"> Bioaerosol Risk Assessment, Updated Site Drainage and Site Layout Plans. 	10/05/17

Table S1.2 Operating techniques		
Description	Parts	Date Received
Response to Schedule 5 Notice dated 24/05/17 EPR/BT4150IX/V004	Responses to questions 1, 2, and 3 in relation to the following: <ul style="list-style-type: none"> • Odour Management Plan • Noise Management Plan • Ammonia reduction measures to meet the new BAT AELs for new pig housing. 	14/06/17
Additional information EPR/BT4150IX/V004	Response to Request for Information confirming the following: <ul style="list-style-type: none"> • feed protein content for each animal type for 2017. Weaners 17.43%, Growers 16.82%, Finishers 15.49%, Gilts 13.54%, Dry Sow 11.29%, and Lactating sows 14.59%. • replacement of nursery building P by nursery building R. 	17/07/17

Schedule 2 – Waste types, raw materials and fuels

Table S2.1 Raw materials and fuels	
Raw materials and fuel description	Specification
---	---

Schedule 3 – Emissions and monitoring

Table S3.1 Point source emissions to air – emission limits and monitoring requirements						
Emission point ref. & location	Source	Parameter	Limit (including unit)	Reference Period	Monitoring frequency	Monitoring standard or method
Finishing/grower houses ANCV roof fan outlets on buildings A - G as shown on the site layout plan in schedule 7	Finishing / grower houses A - G	---	---	---	---	---
Finisher house fully controlled SKOV fan ventilated outlets on building H1 as shown on the site layout plan in schedule 7	Finishing house H1	---	---	---	---	---
Finisher house fully controlled SKOV fan ventilated outlets on building H2 as shown on the site layout plan in schedule 7	Finishing house H2	---	---	---	---	---
Dry sow/boar house gable end fans on building I as shown on the site layout plan in schedule 7	Dry sow house I	---	---	---	---	---
Dry sow/boar house Yorkshire boarding / natural ventilation outlets on building J as shown on the site layout plan in schedule 7	Dry sow house J	---	---	---	---	---
Boar house natural ventilation outlets on building K as shown on the site layout plan in schedule 7	Dry sow house K	---	---	---	---	---
Sow service ANCV roof fan outlets on buildings L as shown on the site layout plan in schedule 7	Sow service L	---	---	---	---	---
Multi-purpose house natural ventilation outlets on building M as	Multi -purpose house M	---	---	---	---	---

Table S3.1 Point source emissions to air – emission limits and monitoring requirements						
Emission point ref. & location	Source	Parameter	Limit (including unit)	Reference Period	Monitoring frequency	Monitoring standard or method
shown on the site layout plan in schedule 7						
Farrowing house gable end fan outlet N as shown on the site layout plan in schedule 7	Farrowing house N	---	---	---	---	---
Farrowing house ANCV roof fan outlet on buildings O as shown on the site layout plan in schedule 7	Farrowing house O	---	---	---	---	---
Farrowing house gable end fans on building Q as shown on the site layout plan in schedule 7	Farrowing houses Q	---	---	---	---	---
Chimney from carcass incinerator as shown in schedule 7	Carcass incinerator	---	---	---	---	---
Vent from oil tank as shown on the site layout plan in schedule 7	Diesel Tank	---	---	---	---	---
Roof ventilation fans from Nursery R as shown on the site layout plan in schedule 7	Nursery R	---	---	---	---	---

Table S3.2 Point Source emissions to land – emission limits and monitoring requirements						
Emission point ref. & location	Source	Parameter	Limit (incl. unit)	Reference Period	Monitoring frequency	Monitoring standard or method
Buildings A - R emission to soakaway as shown on the site layout plan in schedule 7	Uncontaminated roof and surface water from pig housing A - R to soakaway (excluding periods of wash out).	---	---	---	---	---

Schedule 4 – Reporting

Table S4.1 Performance parameters		
Parameter	Frequency of assessment	Units
Feed protein content	Annually	Crude protein content %

Table S4.2 Reporting forms		
Media/parameter	Reporting format	Date of form
Feed protein content	Form protein 1 or other form as agreed in writing by the Environment Agency	31/07/17

Schedule 5 – Notification

These pages outline the information that the operator must provide.

Units of measurement used in information supplied under Part A and B requirements shall be appropriate to the circumstances of the emission. Where appropriate, a comparison should be made of actual emissions and authorised emission limits.

If any information is considered commercially confidential, it should be separated from non-confidential information, supplied on a separate sheet and accompanied by an application for commercial confidentiality under the provisions of the EP Regulations.

Part A

Permit Number	
Name of operator	
Location of Facility	
Time and date of the detection	

(a) Notification requirements for any malfunction, breakdown or failure of equipment or techniques, accident, or emission of a substance not controlled by an emission limit which has caused, is causing or may cause significant pollution	
To be notified within 24 hours of detection	
Date and time of the event	
Reference or description of the location of the event	
Description of where any release into the environment took place	
Substances(s) potentially released	
Best estimate of the quantity or rate of release of substances	
Measures taken, or intended to be taken, to stop any emission	
Description of the failure or accident.	

(b) Notification requirements for the breach of a limit	
To be notified within 24 hours of detection	
Emission point reference/ source	
Parameter(s)	
Limit	
Measured value and uncertainty	
Date and time of monitoring	

(b) Notification requirements for the breach of a limit	
To be notified within 24 hours of detection	
Measures taken, or intended to be taken, to stop the emission	

Time periods for notification following detection of a breach of a limit	
Parameter	Notification period

(c) Notification requirements for the detection of any significant adverse environmental effect	
To be notified within 24 hours of detection	
Description of where the effect on the environment was detected	
Substances(s) detected	
Concentrations of substances detected	
Date of monitoring/sampling	

Part B – to be submitted as soon as practicable

Any more accurate information on the matters for notification under Part A.	
Measures taken, or intended to be taken, to prevent a recurrence of the incident	
Measures taken, or intended to be taken, to rectify, limit or prevent any pollution of the environment which has been or may be caused by the emission	
The dates of any unauthorised emissions from the facility in the preceding 24 months.	

Name*	
Post	
Signature	
Date	

* authorised to sign on behalf of the operator

Schedule 6 – Interpretation

“accident” means an accident that may result in pollution.

“Animal and Plant Health Agency (APHA)” is the government agency that licences small on farm incinerators; formerly known as the Animal Health and Veterinary Laboratories Agency.

“application” means the application for this permit, together with any additional information supplied by the operator as part of the application and any response to a notice served under Schedule 5 to the EP Regulations.

“authorised officer” means any person authorised by the Environment Agency under section 108(1) of The Environment Act 1995 to exercise, in accordance with the terms of any such authorisation, any power specified in section 108(4) of that Act.

“building” means a construction that has the objective of providing sheltering cover and minimising emissions of noise, particulate matter, odour and litter.

“emissions to land” includes emissions to groundwater.

“emissions of substances not controlled by emission limits” means emissions of substances to air, water or land from the activities, either from the emission points specified in schedule 3 or from other localised or diffuse sources, which are not controlled by an emission limit.

“EP Regulations” means The Environmental Permitting (England and Wales) Regulations SI 2010 No.675 and words and expressions used in this permit which are also used in the Regulations have the same meanings as in those Regulations.

“groundwater” means all water, which is below the surface of the ground in the saturation zone and in direct contact with the ground or subsoil.

“Hazardous property” has the meaning in Annex III of the Waste Framework Directive.

“Industrial Emissions Directive” means DIRECTIVE 2010/75/EU OF THE EUROPEAN PARLIAMENT AND OF THE COUNCIL of 24 November 2010 on industrial emissions.

“List of Wastes” means the list of wastes established by Commission Decision 2000/532/EC replacing Decision 94/3/EC establishing a list of wastes pursuant to Article 1(a) of Council Directive 75/442/EEC on waste and Council Decision 94/904/EC establishing a list of hazardous waste pursuant to Article 1(4) of Council Directive 91/689/EEC on hazardous waste, as amended from time to time.

“Manure and slurry” have the following meaning:

- Manures may be either slurries or solid manures.
- Slurries consist of excreta produced by livestock whilst in a yard or building mixed with rainwater and wash water and, in some cases, waste bedding and feed. Slurries can be pumped or discharged by gravity.
- Slurry includes duck effluent, seepage from manure and wash water.
- Solid manures include farmyard manure (FYM) and comprise material from straw-based housing systems, excreta with lots of straw/sawdust/woodchips in it, or solids from mechanical separators.
- Most poultry systems produce solid manure (litter).
- Solid manure can generally be stacked.

“manure management plan” means the requirements described in Section 2.3 of SGN 6.09 How to Comply – Intensive Farming.

“MCERTS” means the Environment Agency’s Monitoring Certification Scheme.

“pests” means Birds, Vermin and Insects.

“SGN How to comply – Intensive Farming” The EPR Sector Guidance Note 6.09 for intensive pig and poultry farmers, Version 2 published January 2010.

“Waste code” means the six digit code referable to a type of waste in accordance with the List of Wastes and in relation to hazardous waste, includes the asterisk

“Waste Framework Directive” or “WFD” means Waste Framework Directive 2008/98/EC of the European Parliament and of the Council on waste.

“year” means calendar year ending 31 December.

Schedule 7 – Site plan

Site Plan



Site layout plan

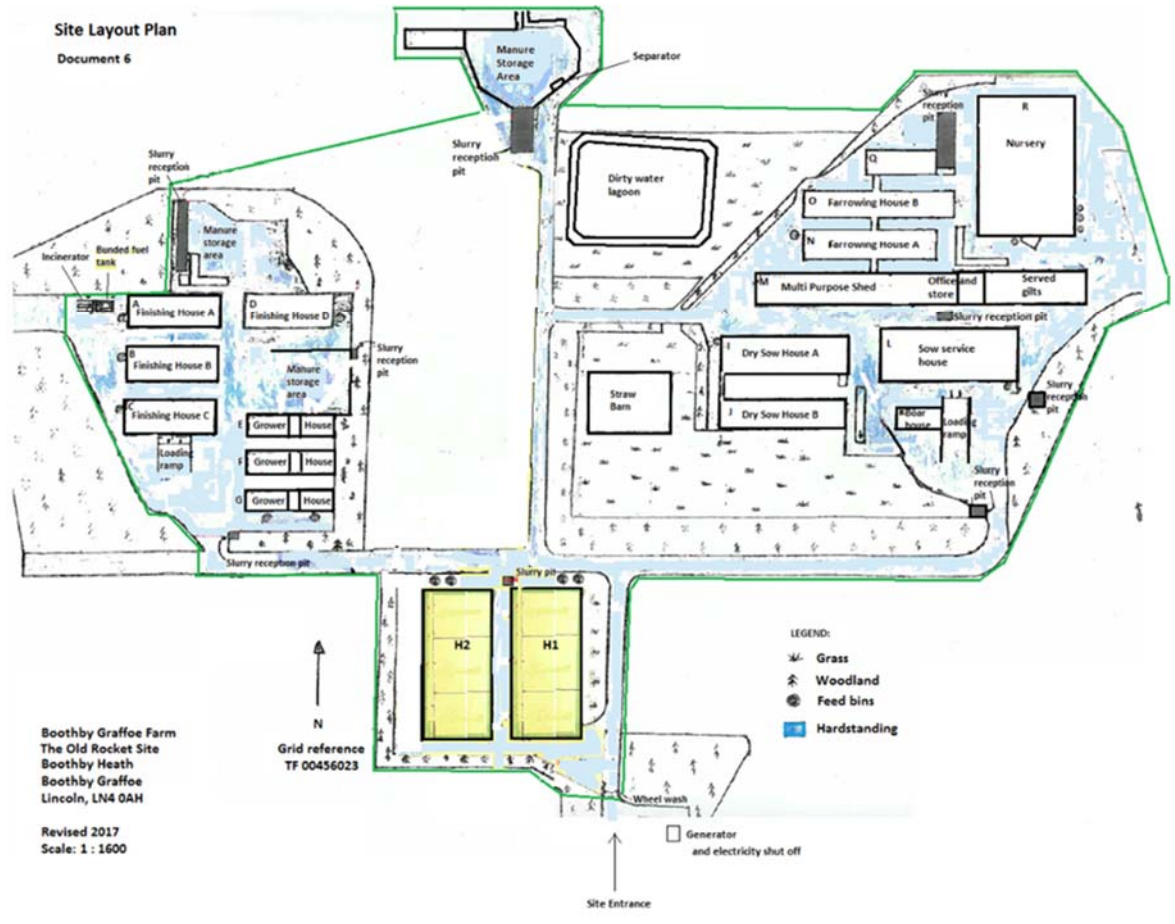

END OF PERMIT

Permit Number: EPR/BT4150IX

Operator: Patrick Dean Limited

Facility: Boothby Heath Farm Pig Unit

Form Number: Protein content1 / 31/07/17

Reporting of feed protein content for the period DD/MM/YYYY to DD/MM/YYYY

Date of delivery	Feed type e.g. weaner, grower, finisher, gilt, dry sow, farrowing sow	Quantity	Crude protein content %	Comments

Signed

Date.....

(Authorised to sign as representative of Operator)