

Plan
Scale 1:10,000 @ A1

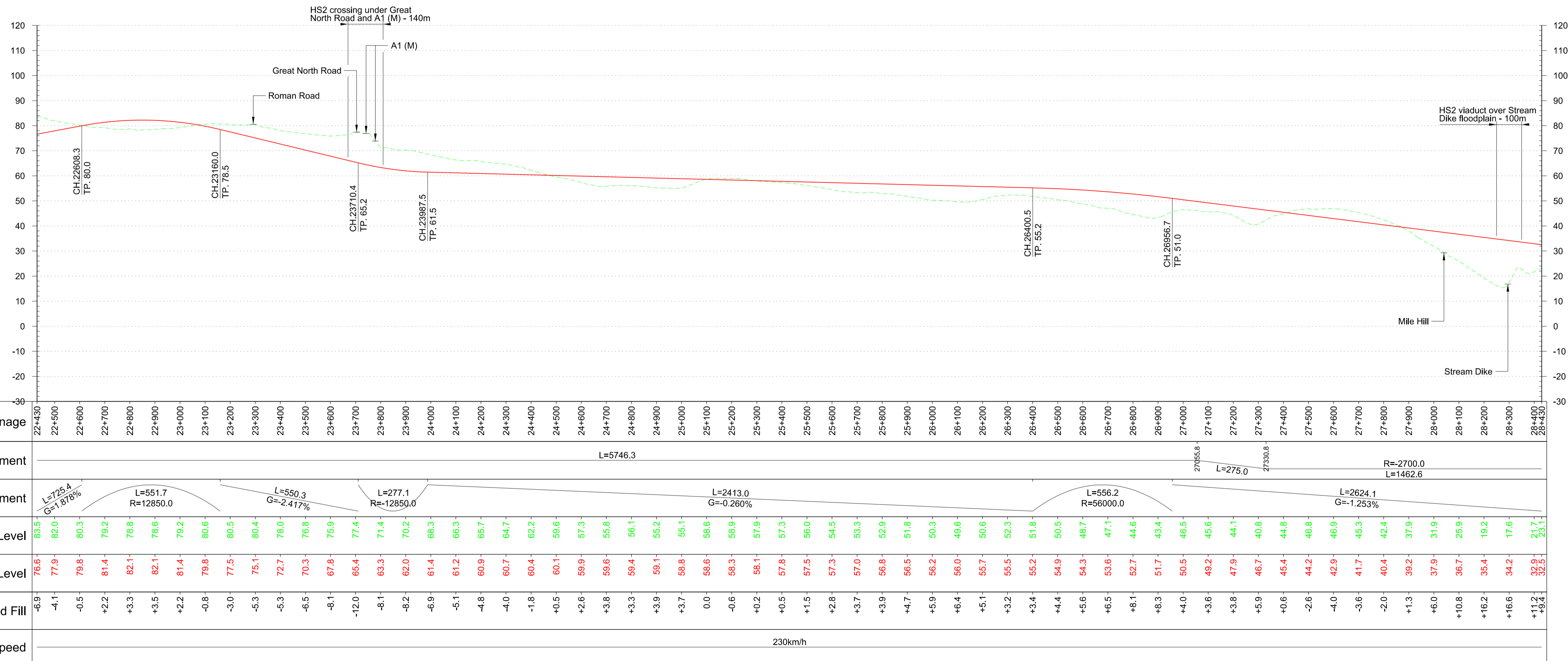

Profile
Scale H:1:10,000 V:1:1000 @ A1

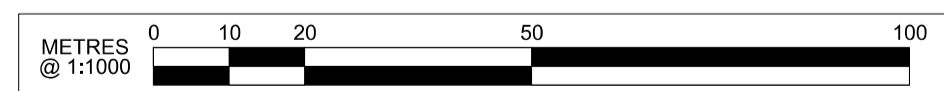
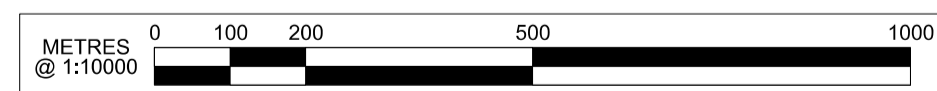

P02	Client's Comments Addressed	JV	AR	MM
		11/07/17	11/07/17	11/07/17
P01	First Issue	JV	AR	MM
		28/06/17	28/06/17	28/06/17
Rev	Description	Drawn	Checked	Con App
				HS2 App

HS2 accepts no responsibility for any circumstances which arise from the reproduction of this document after alteration, amendment or abbreviation or if it is issued in part or issued incompletely in any way.

© Crown Copyright and database right 2017. All rights reserved. Ordnance Survey Licence number 100049190

© Crown Copyright material is reproduced with the permission of Land Registry under delegated authority from the Controller of HMSO.

This material was last updated on 2017 and may not be copied, distributed, sold or published without the formal permission of Land Registry. Only an official copy of a title plan or register obtained from the Land Registry may be used for legal or other official purposes.

Scale with caution as distortion can occur.

Key Environmental Features Legend	
	World Heritage Site
	Ramsar
	Special Areas of Conservation
	Special Protection Areas
	SSSI
	National Nature Reserves
	Area of Outstanding Natural Beauty
	National Park
	Major Development Sites
	Additional Development Sites
	Scheduled Monuments
	Registered Parks and Gardens
	Historical Battlefields
	Active and/or Authorised Landfill
	Historical Landfill
	Flood Zones
	Listed Building Grade I
	Listed Building Grade II*
	Listed Building Grade II

Legend	
	Track Centrelines
	Viaduct
	Tunnel
	Existing Railway Connection
	HS2 Connection
	Fully Retained Cutting/Fill
	Major Contour
	Ground Profile
	Track Profile
	Minor Contour
	Node
	Engineering Earthworks
	Railway Cutting
	Railway Embankment
	HS2 Depot/Station Operational Boundary

Registered in England
Registration No. 06791686
Registered office:
2 Snow Hill,
Queensway,
Birmingham, B4 6GA

Creator/Organiser
Mott MacDonald

Zone	Leeds Leg North
Design Stage	Post-Consultation
Drawing Title	HSL17B 2017 Preferred Route Sheet 4 of 5

Project/Contract		West Midlands to Leeds Route	
Discipline/Function		Railway Track	
Drawn	Checked	Approved	
JV	AR	MM	
Date	Scale	Size	
07/06/2017	1:10000	A1	
Drawing No.		Rev.	
C321-MMD-RT-DPP-130-591705		P02	