

Surrender notice with introductory note

The Environmental Permitting (England & Wales) Regulations 2016B.

Unilever UK Limited

Gloucester Ice Cream Factory
Corinium Avenue
Barnwood
Gloucester
GL4 3BW

Variation application number

EPR/AP3530KM/S004

Permit number

EPR/AP3530KM

Gloucester Ice Cream Factory

Permit number EPR/AP3530KM

Introductory note

This introductory note does not form a part of the notice

The following notice gives notice of the variation of an environmental permit.

The operator wishes to surrender part of the permitted area. This comprises of a small area of land to the east of the site which has been sold for development. The land has never been used for any activity associated with the permit.

The rest of the installation continues to operate as follows.

The installation manufactures a range of ice cream and frozen desserts products for U.K. and European markets. Manufacturing activities include mixing, pasteurising, homogenising, chilling extrusion, refrigeration, packing and wrapping, auto-palletising and cold storage.

The activities directly associated with the manufacture of ice cream include storage and handling of raw materials and product, storage and use of detergents for cleaning processes, refrigeration plant, combustion plant, effluent treatment plant, and storage of waste. Air releases include oxides of nitrogen and oxides of sulphur from two boilers, running continually on gas, with a rating of 5.69MW each.

The site has a surface water drainage system that discharges to Horsebere Brook via W1, although this outlet is currently blocked off and all water is returned to the effluent lines, Unilever would wish to maintain the consent to discharge. Therefore, conditions have been set to permit uncontaminated site drainage only to be released via W1.

Effluent is treated on site in an effluent treatment plant to ensure compliance with trade effluent consents prior to discharge to sewer via 51. There are no emissions to land included in this installation. Recycled waste streams include metal, cardboard, liquid ice cream and effluent sludge, with other solid wastes being sent to landfill. Liquid waste goes into the effluent stream for treatment on site to recover recycled material before going off - site for final treatment by Severn Trent Water Limited. Hazardous waste is disposed of via accredited and approved procedures.

The site operates an Environmental Management System accredited to ISO 14001 and has in place a Climate Change Agreement.

To the North-west of the Birmingham-Bristol/London railway line, which borders the length of the site is a playing field adjacent to the housing estate. The Cotswold Beechwoods SAC is 5km from the installation.

Any changes made as a result of the part surrender are set out in the schedules.

The status log of a permit sets out the permitting history, including any changes to the permit reference number.

Status log of the permit		
Description	Date	Comments
Application SP3632SC received	30/03/05	
Additional information received	20/06/05 26/07/05	
Permit determined	01/11/05	

Status log of the permit		
Description	Date	Comments
Transfer application EPR/AP3530KM/T001 received	02/07/09	
Transfer determined	21/07/09	
Variation application EPR/AP3530KM/V002 received	07/07/09	
Additional information received	29/07/09 16/09/09 30/09/09	
Variation determined	21/10/09	
Agency initiated variation determined EPR/AP3530KM/V003	23/07/13	Agency initiated variation to implement the changed introduced by the IED.
Application EPR/AP3530KM/S004(part surrender)	Duly made 06/07/17	Application to amend the installation site boundary.
Additional information received	19/07/17	Updated site plan showing green site boundary.
Additional information received	28/09/17	Updated site plan including the cold store area.
Additional information received	16/10/17	Confirmation that no incidents have taken place on the area of land where the cold store is situated, appropriate pollution prevention and control measures have been taken, and that the area of land where the cold store is situated is in a satisfactory state.
Part surrender determined EPR/AP3530KM (Billing reference: MP3135YK)	25/10/17	Part surrender and Varied permit issued.

End of introductory note

Notice of surrender

The Environmental Permitting (England and Wales) Regulations 2016

The Environment Agency in exercise of its powers under regulation 25 of the Environmental Permitting (England and Wales) Regulations 2016 accepts the surrender in part of

Permit number

EPR/AP3530KM/S004

Issued to

Unilever UK Limited (“the operator”)

whose registered office is

**Unilever House
Springfield Drive
Leatherhead
KT22 7GR**

company registration number **00334527**

to operate a regulated facility at

**Gloucester Ice Cream Factory
Corinium Avenue
Barnwood
Gloucester
GL4 3BW**

to the extent set out in the schedules.

The notice shall take effect 25/10/2017

Name	Date
Anne Nightingale	25/10/2017

Authorised on behalf of the Environment Agency

Schedule 1 – conditions to be deleted

None

Schedule 2 – conditions to be amended

None

Schedule 3 – conditions to be added

None

Schedule 4 – amended plan

The area of the site is reduced to that shown in the attached amended plan.

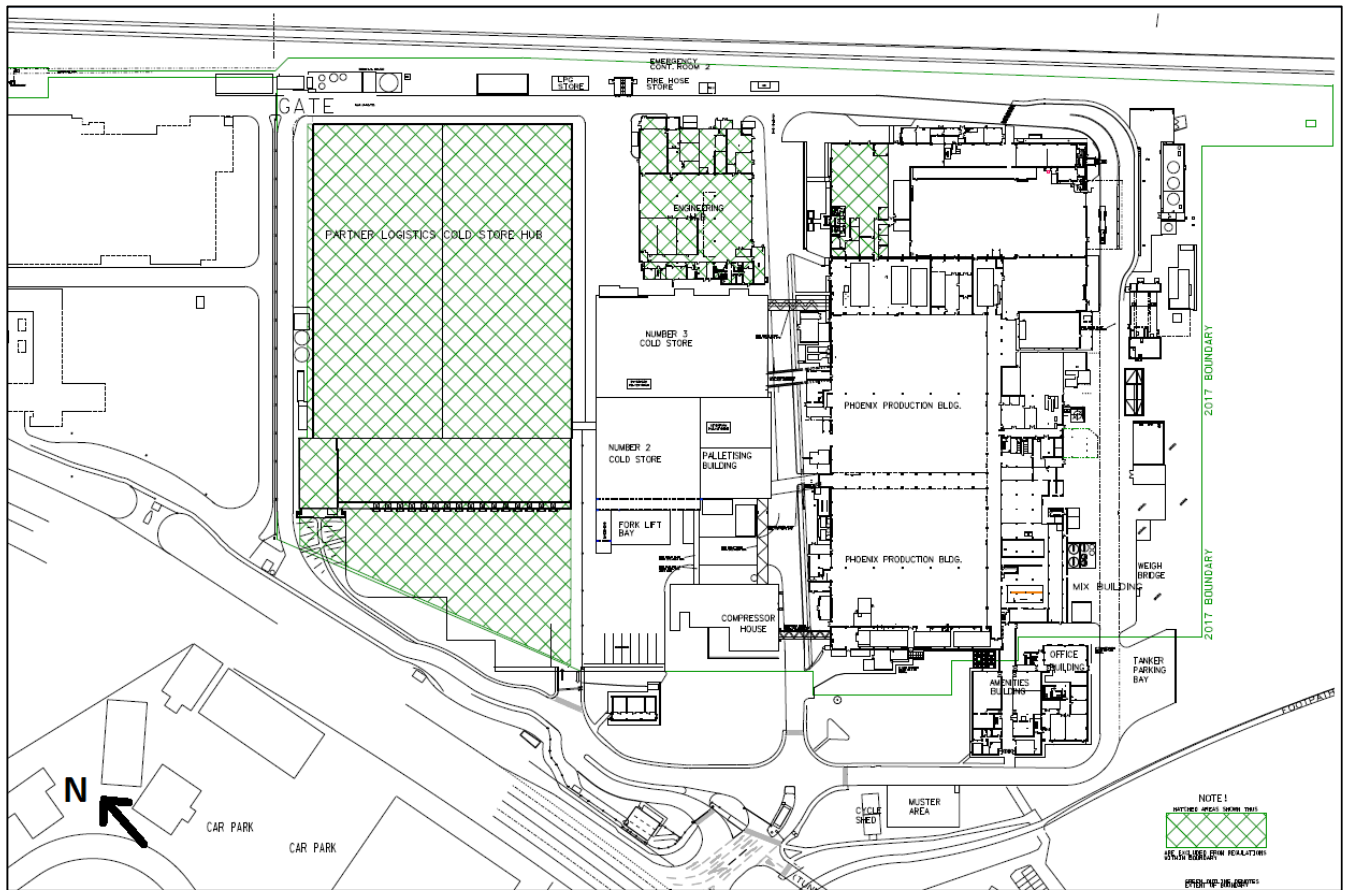

Key

 The hatched area is excluded from the permitted area within the boundary.

©Reproduced by permission of the operator.